

LOS ANGELES COUNTY
DEPARTMENT OF PUBLIC WORKS
BENCH MARK LIST

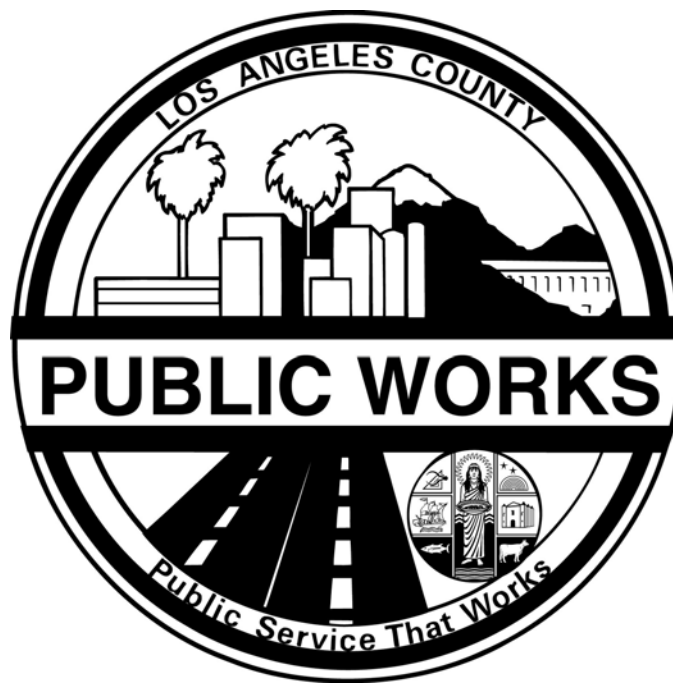

ARCADIA QUAD
ROSEMEAD QUAD

2005 ADJUSTMENT

NAVD 88 DATUM
METRIC

PREFACE

The Department of Public Works level net is composed of more than 1,700 miles or 2720 kilometers of levels supporting in excess of 9,000 bench marks. Previously when a major readjustment of the net was undertaken, to emphasize the complete break with previous elevations, the CY, CG, & CL, series bench marks were re-labeled DY, DG, & DL, respectively. Beginning in 1993 the baseline readjustment year will be indicated on baseline BM, s only indicated below (*). Henceforth all BM numbers will be labeled as a Y, G, or L, series that will no longer indicate the major adjustment year.

To facilitate the adjustment, indexing and distribution of adjusted values of the net, the county territory was divided into 33 quads or areas. For the identification purposes each quad was given a name, viz., "Rosemead," "La Mirada," "Santa Fe," etc. When bench marks and elevations in these quads are used, the name must be included in the bench mark description, e.g.,

* BASELINE 90.057 L&BR IN CTR OF CB RET @ NE COR Y 9191
(1990) 295.461 LA HABRA BLVD & VALLEY HOME AVE
10.7M N & 10.7M E/O C/L INT

It is expected that this general adjustment will for the most part remain sound for 8 to 12 years. Updating constrained adjustments will continue in the future. When a quad is readjusted, new elevations will be published and the date of readjustment will be noted in the bench mark description. Two bench marks with different adjustment dates will not normally agree with each other.

The basic accuracy of the net is reflected by an indicated field probable error of plus or minus 4mm per kilometer of leveling as determined from the conditions of closure. However, many years of experience in vertical control in the greater Los Angeles basin and Antelope Valley indicate that because of varying degrees of subsidence and heaving, the true datum is recovered only by obtaining substantial agreement of a number of bench marks.

The users of this net are invited to assist in its maintenance by notifying this department of cases of obliteration, apparent mistakes in description or elevations, and proven disturbance of bench marks.

DATUM: North American Vertical Datum of 1988 (NAVD88)

Note: NAVD 1988 minus approximately 700mm (2.3ft) equals
Previous NGVD 1929 Datums. For more accurate equations
At individual bench marks refer to previous publications

ABBREVIATIONS USED IN BENCH MARK LISTINGS

ABUT -----	Abutment	ECR -----	End of Curb
ALG -----	Along	EC -----	End of Curb
ANG PT -----	Angle Point	ENT -----	Entrance
B/W -----	Back of Walk	FL -----	Floor
BCR -----	Beginning of Curve Return	FTG -----	Footing
BLDG -----	Building	FRWY -----	Freeway
BM -----	Bench Mark	F/W -----	Front of Walk
BT SPK -----	Boat or Bolt Spike	GAR -----	Garage
BR CAP -----	Brass or Bronze Cap	HDWL -----	Headwall
C B -----	Catch Basin	HSE -----	House
CTR -----	Center	INT -----	Intersection
C/L -----	Center Line	IP -----	Iron Pipe
C/L INT -----	Center Line Intersection	LT -----	Left
C/L PROD ---	Center Line Produced	LACE -----	L.A. City Engineer
CONC -----	Concrete	LACS -----	L.A. Co. Engineer
COR -----	Corner	LAFC -----	L.A. Co. Flood Control
COE -----	Corps of Engineers	L&BN -----	Lead and Bench Nail
CULV -----	Culvert	L&BR -----	Lead and Brad
CYN -----	Canyon	L&N -----	Lead and Nail
CB -----	Curb	L&SPK -----	Lead and Spike
CS MON -----	Co. Eng. Monument	L&T -----	Lead and Tack
CT SPK -----	Cut Spike	MCR -----	Middle of Curb Return
DPW -----	Dept. of Public Works	MKD -----	Marked
DR -----	Drive or Driveway	MC -----	Middle of Curb
E/O -----	East of	MON -----	Monument

ABBREVIATIONS USED IN BENCH MARK LISTINGS (CON'T)

N/O ----- North of
NR ----- Near
OPP ----- Opposite
PI ----- Point of Intersection
PK&W ----- PK Nail and Washer
P/L ----- Property Line
POST ----- Point on Semi-Tangent
PP ----- Power Pole
PVMT ----- Pavement
PROD ----- Produced
RD ----- Road
RDBM ----- Road Dept. Bench Mark
RDBM TAG - Road Dept. Bench Mark Tag
RR ----- Railroad
RT ----- Right
R/W ----- Right of Way
SDMH ----- Storm Drain Manhole
SMH ----- Sewer Manhole
SPK ----- Spike
ST&W ----- Spike Tin and Washer
S/O ----- South of
TP ----- Telephone Pole
USC&GS --- U.S. Coast and Geodetic Survey
USGS ----- U.S. Geological Survey
WK ----- Walk
W/O ----- West of
D90/L-3

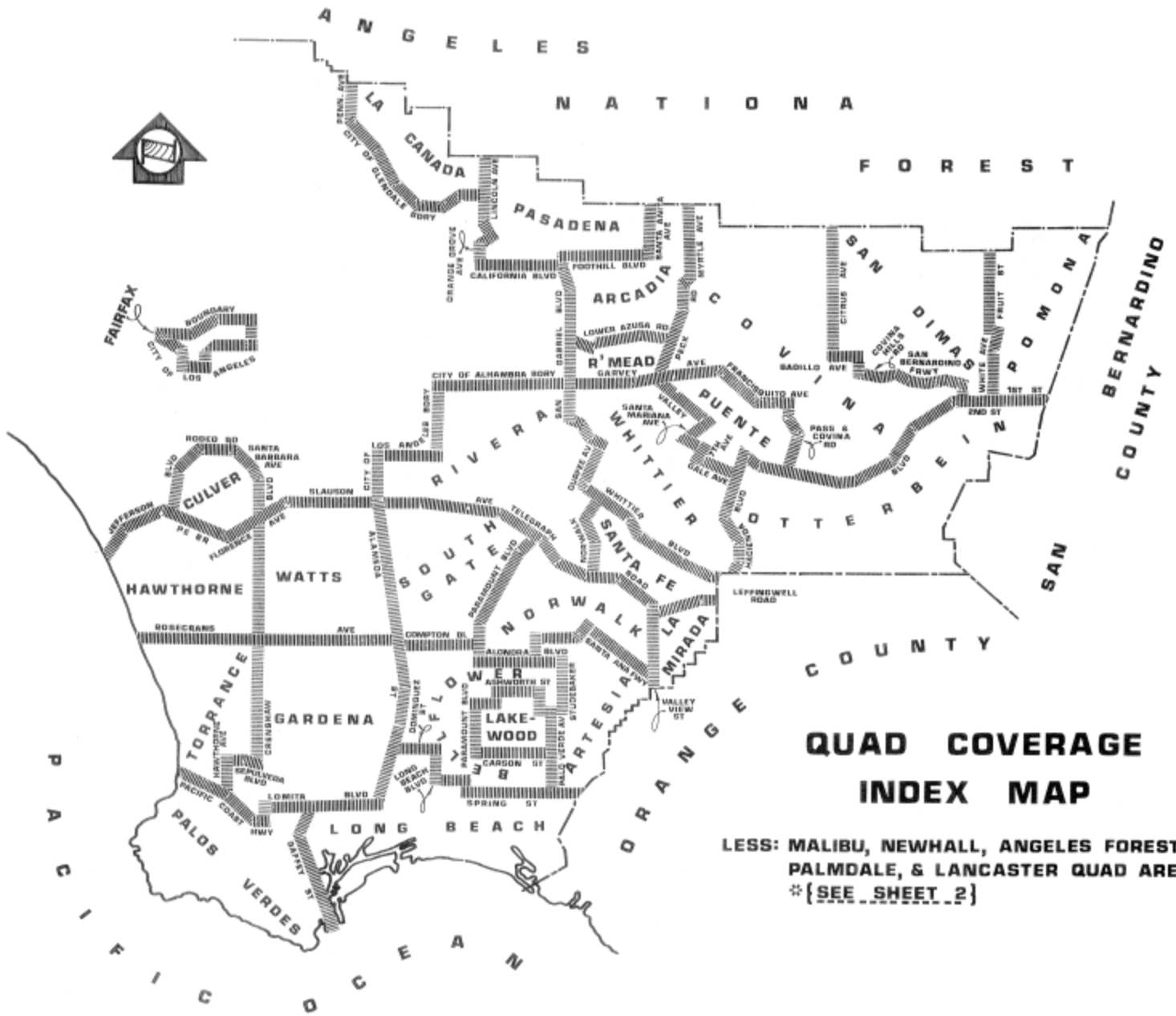

**QUAD COVERAGE
INDEX MAP**

LESS: MALIBU, NEWHALL, ANGELES FOREST,
PALMDALE, & LANCASTER QUAD AREAS.*
*{SEE SHEET 2}

K E R N C O U N T Y

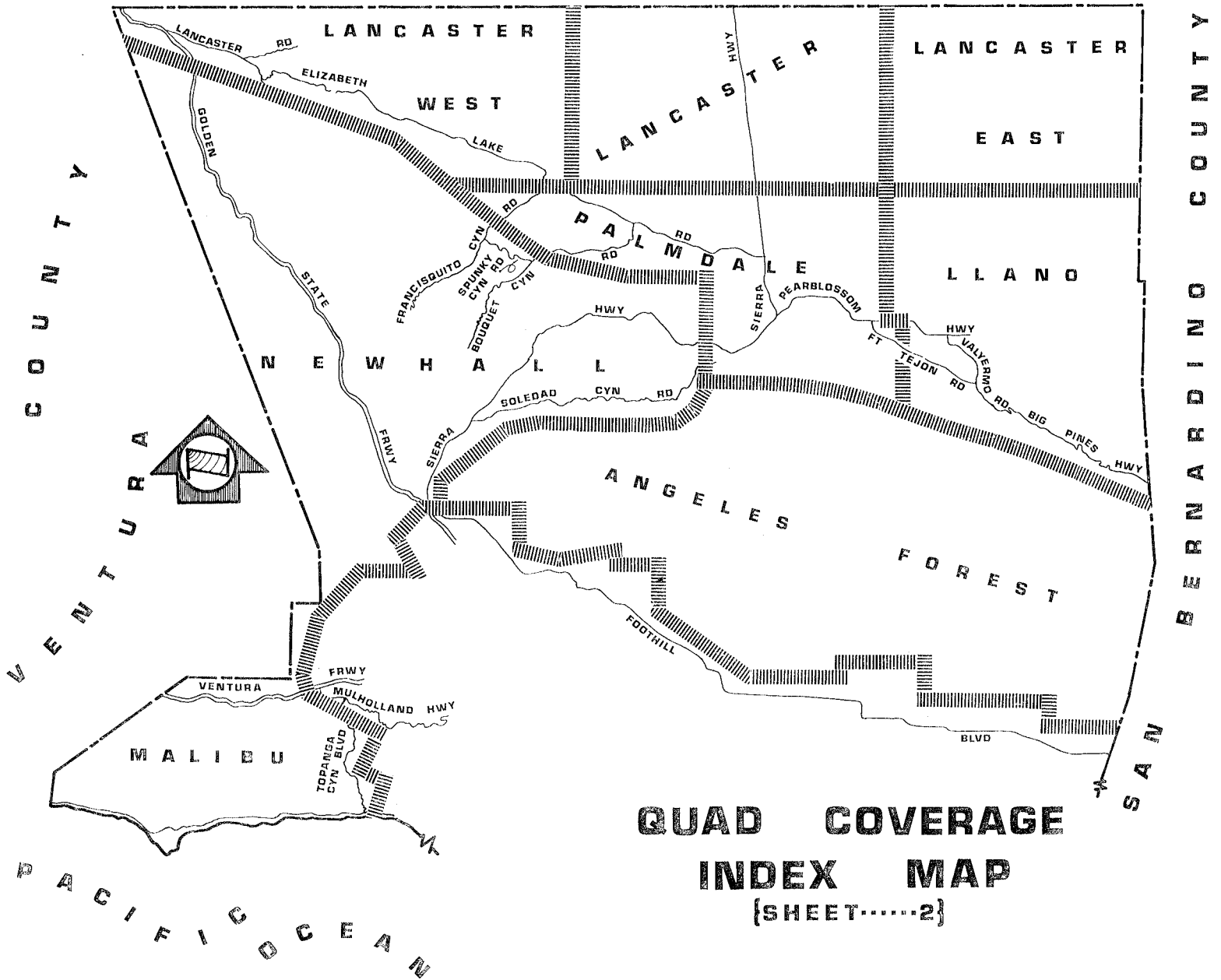

QUAD COVERAGE
INDEX MAP
 {SHEET.....2}

ARCADIA-ROSEMEAD QUAD



**NUMBERS REFER TO
THOMAS BROS PAGE
NUMBERS.**

**EACH THOMAS BROS
PAGE IS DIVIDED INTO
TWO INDEX PAGES
EAST AND WEST**

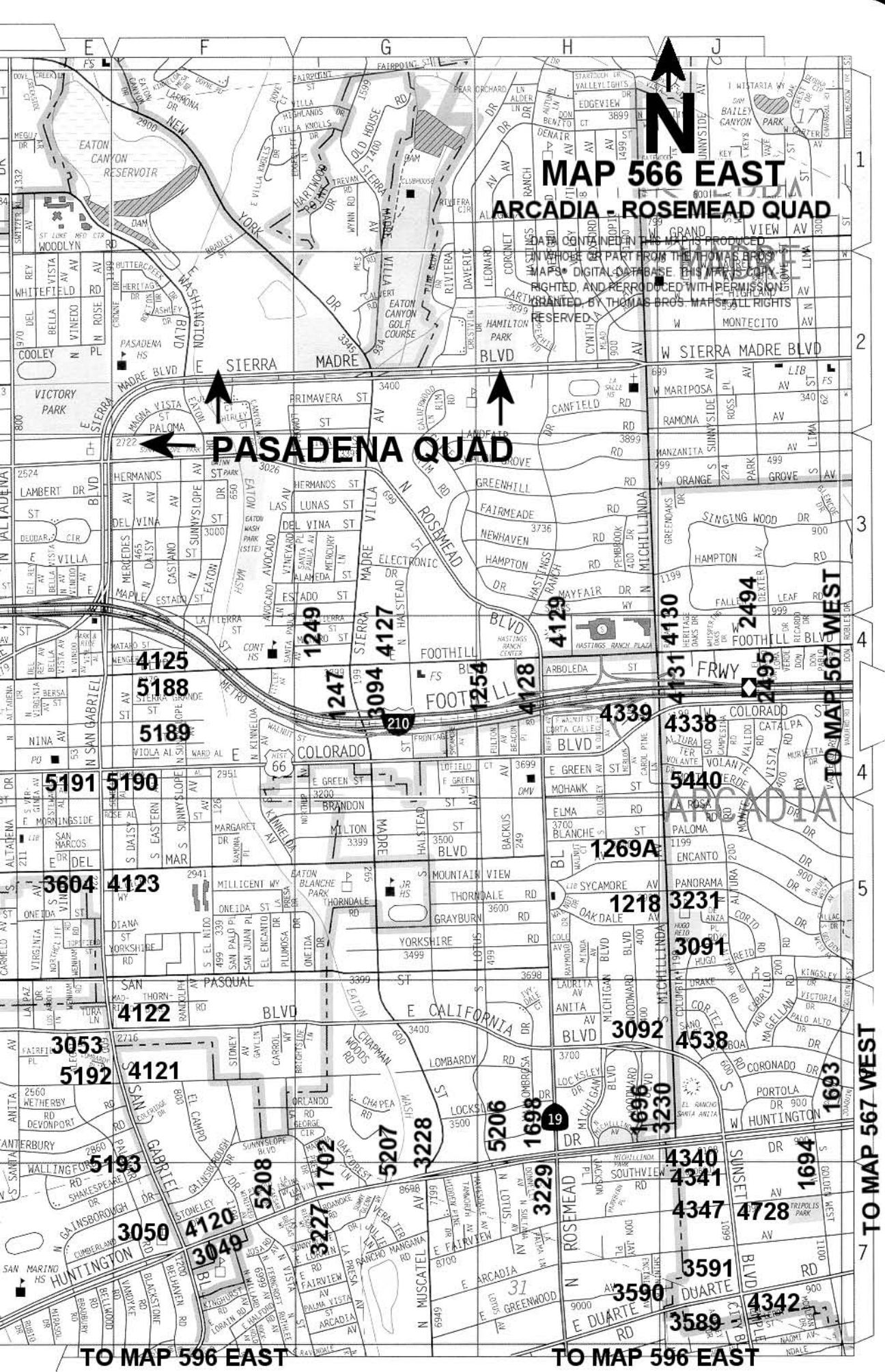

MAP 566 EAST

ARCADIA - ROSEMEAD QUAD

THIS MAP IS CONFINED TO THE MAPS PRODUCED IN THE PAST BY THOMAS BROS. MAPS. IT IS A PART OF THE THOMAS BROS. MAPS DIGITAL DATABASE. THIS MAP IS COPY-RIGHTED, AND REPRODUCED WITH PERMISSION BY THOMAS BROS. MAPS. ALL RIGHTS RESERVED.

PASADENA QUAD

TO MAP 567 WEST

TO MAP 596 EAST

TO MAP 596 EAST

TO MAP 567 WEST

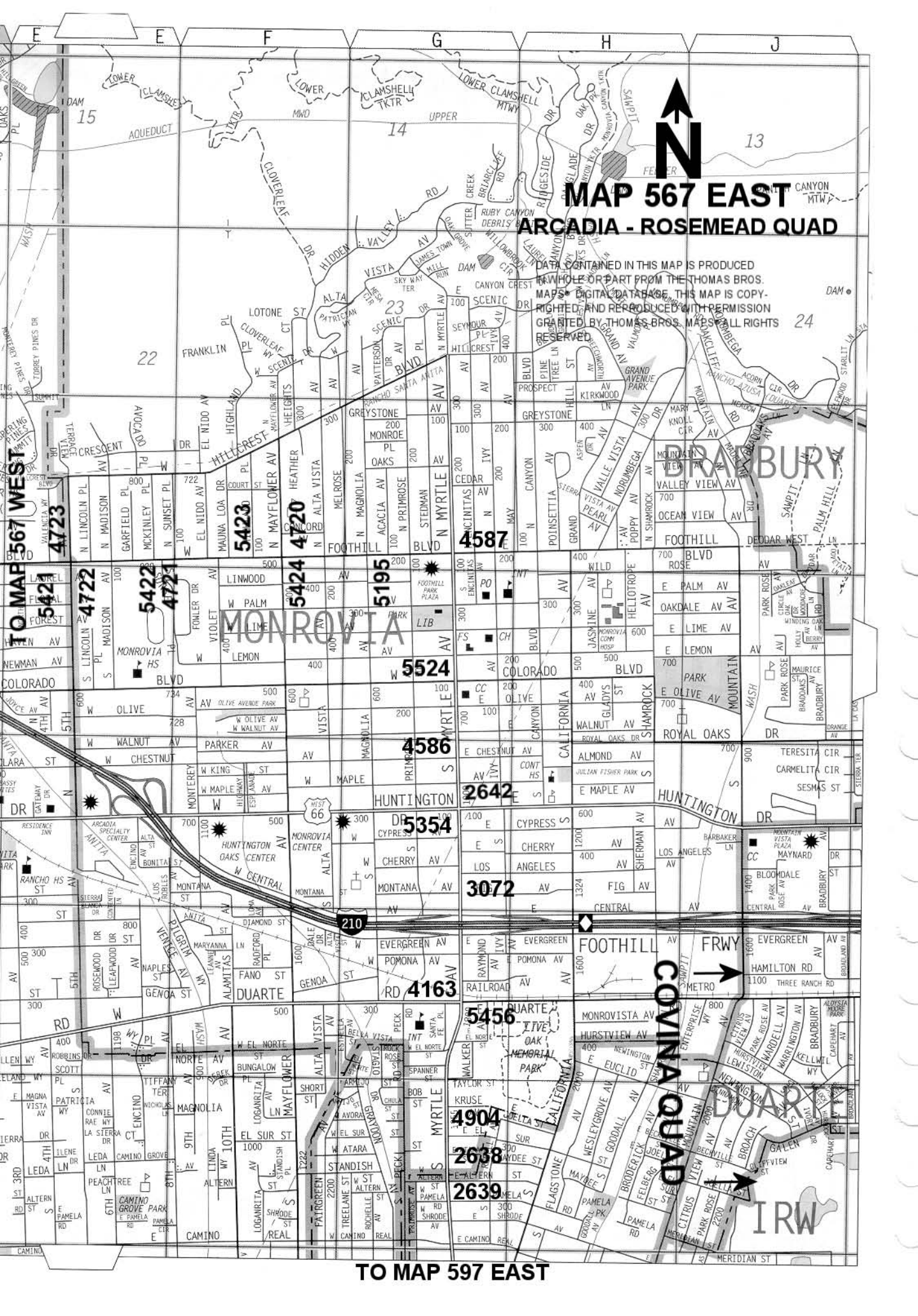

MAP 567 EAST ARCADIA - ROSEMEAD QUAD

DATA CONTAINED IN THIS MAP IS PRODUCED WHOLE OR PART FROM THE THOMAS BROS. MAPS DIGITAL DATABASE. THIS MAP IS COPY-RIGHTED AND REPRODUCED WITH PERMISSION GRANTED BY THOMAS BROS. MAPS ALL RIGHTS RESERVED.

TO MAP 567 WEST

TO MAP 597 EAST

COVINA QUAD

IRW

MONROVIA

BRADBURY

SR 66

SR 210

RD 4163

FRWY

METRO

4587

5524

4586

2642

3072

4163

5456

4904

2638

2639

22

14

13

24

15

4722

5422

4723

5423

4724

5424

5195

4587

5524

4586

2642

3072

4163

TO MAP 567 WEST

TO MAP 597 EAST

COVINA QUAD

IRW

MONROVIA

BRADBURY

SR 66

SR 210

RD 4163

FRWY

METRO

4587

5524

4586

2642

3072

4163

5456

4904

2638

2639

22

14

13

24

15

4722

5422

4723

5423

4724

5424

5195

4587

5524

4586

2642

3072

4163

TO MAP 566 EAST

TO MAP 566 EAST

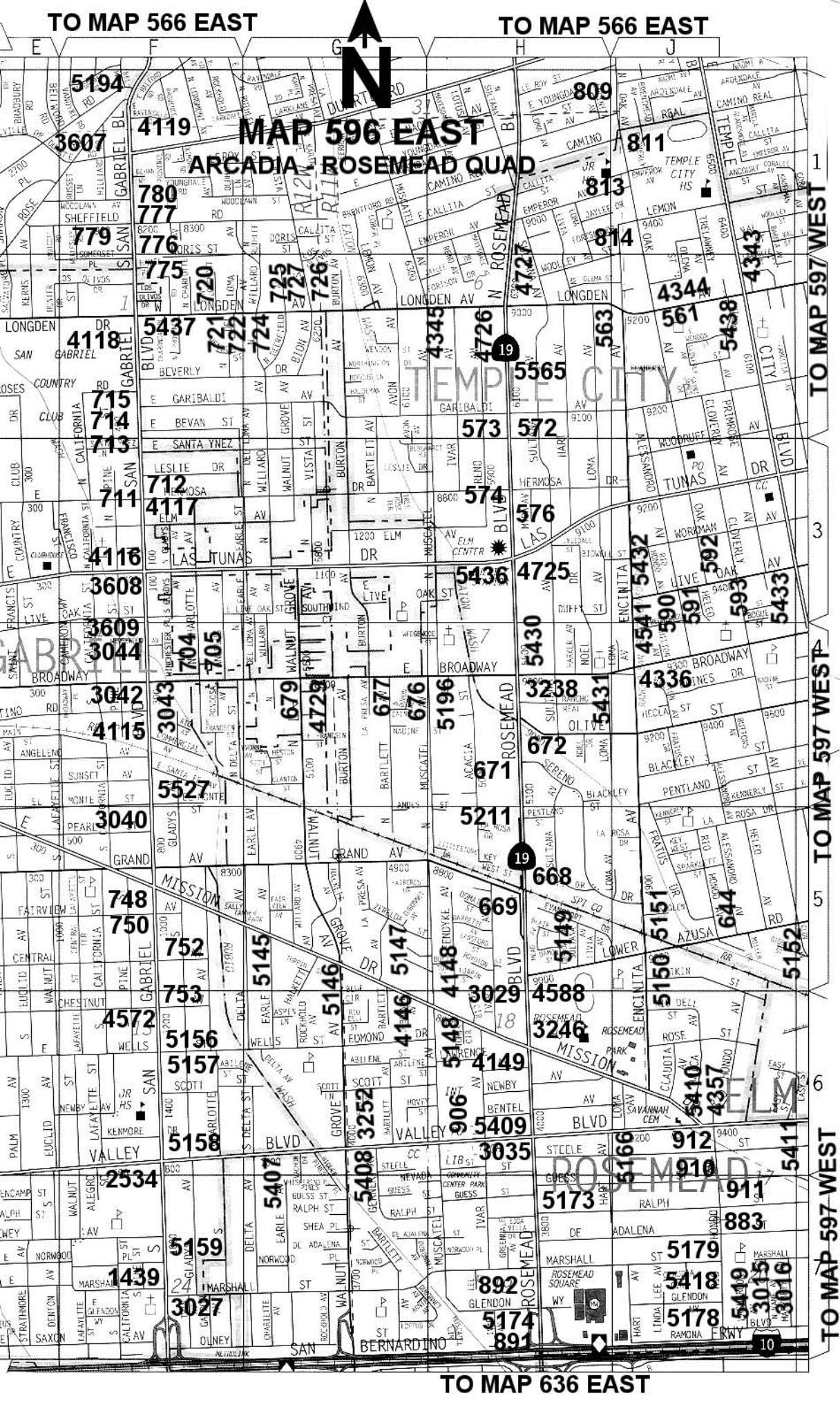

MAP 596 EAST
ARCADIA ROSEMEAD QUAD



TEMPLE CITY

ROSEMEAD

TO MAP 636 EAST

TO MAP 597 WEST

TO MAP 597 WEST

TO MAP 597 WEST

Map showing street names and house numbers. Key streets include San Gabriel Blvd, Mission Blvd, Rosemead Blvd, and various residential streets like Beverly, Garibaldi, and Encinita. House numbers are scattered throughout the grid, ranging from 300s to 900s.

TO MAP 567 EAST

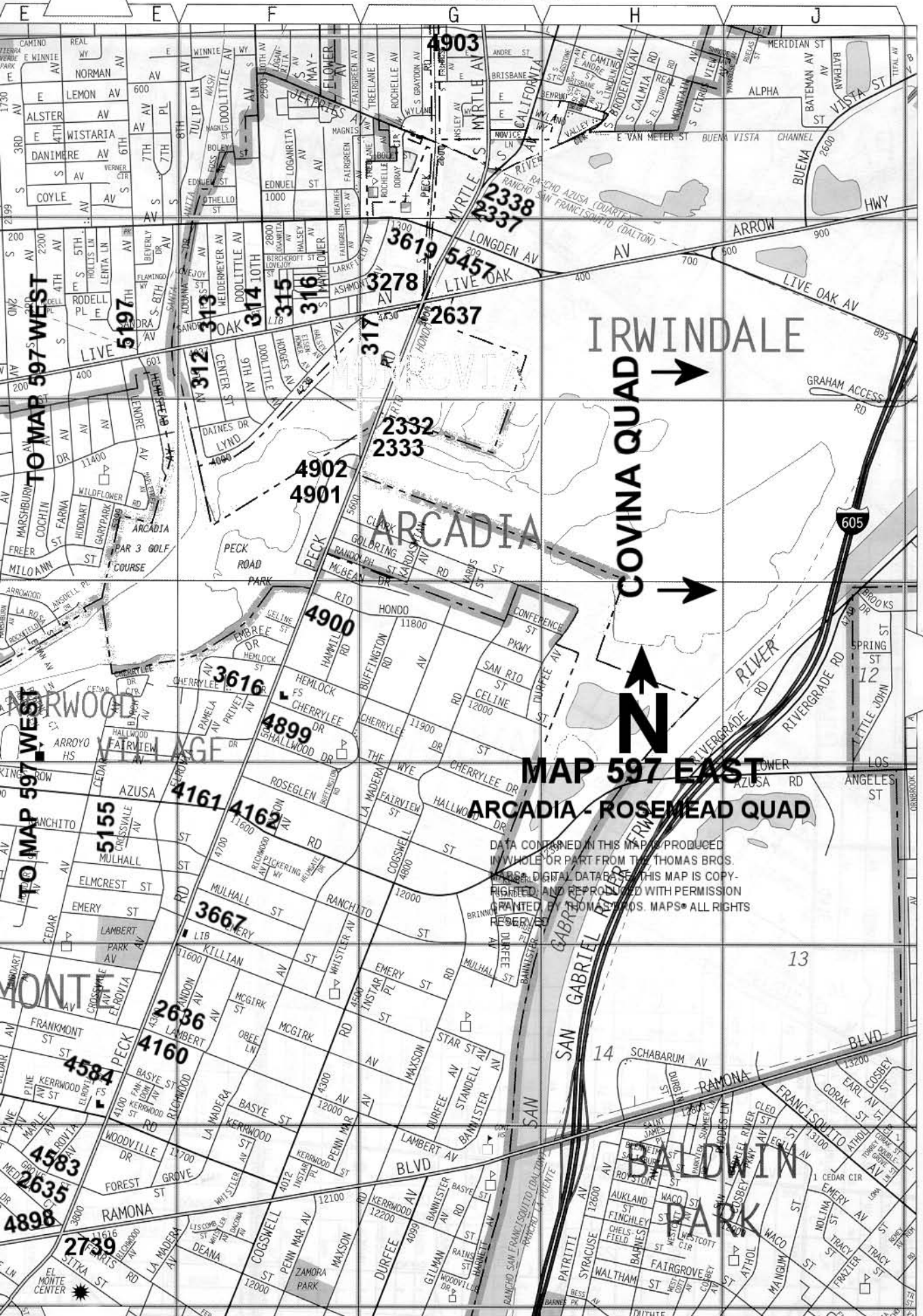

IRWINDALE

COVINA QUAD

MAP 597 EAST
ARCADIA - ROSEMEAD QUAD

DATA CONTAINED IN THIS MAP IS PRODUCED IN WHOLE OR PART FROM THE THOMAS BROS. DIGITAL DATABASE. THIS MAP IS COPYRIGHTED AND REPRODUCED WITH PERMISSION GRANTED BY THOMAS BROS. MAPS. ALL RIGHTS RESERVED.

13

BALDWIN PARK

TO MAP 597 WEST

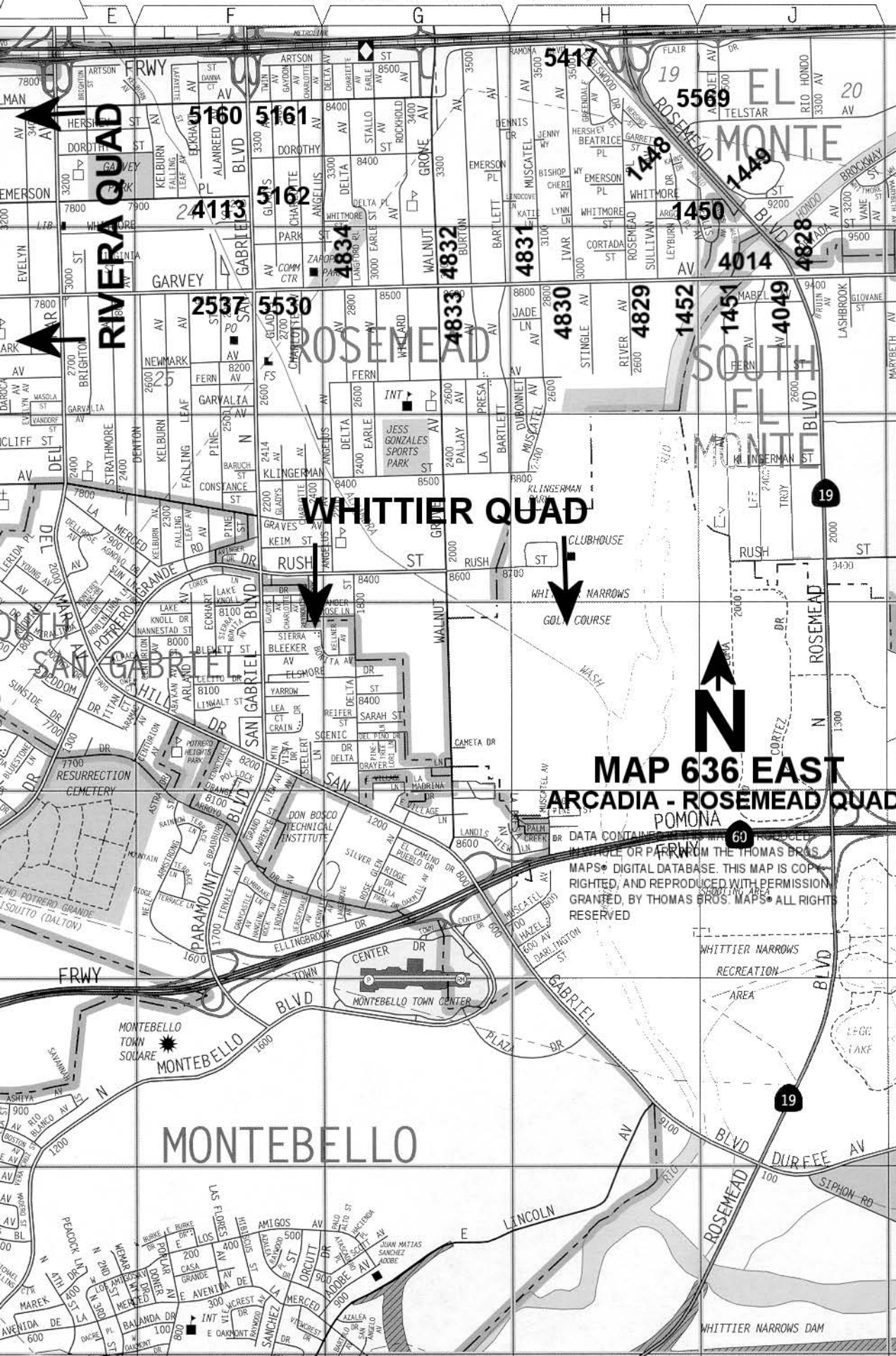

TO MAP 637 WEST

WHITTIER QUAD

MAP 636 EAST
ARCADIA - ROSEMEAD QUAD

DATA CONTAINED HEREIN IS THE PROPERTY OF THOMAS BROS. MAPS. DIGITAL DATABASE. THIS MAP IS COPYRIGHTED, AND REPRODUCED WITH PERMISSION GRANTED, BY THOMAS BROS. MAPS. ALL RIGHTS RESERVED

MONTEBELLO

RIVERA QUAD

MONTEBELLO

SOUTH EL MONTE

WHITTIER QUAD

WHITTIER NARROWS RECREATION AREA

WHITTIER NARROWS DAM

WHITTIER NARROWS DAM

WHITTIER NARROWS DAM

WHITTIER NARROWS DAM

TO MAP 597 WEST

TO MAP 636 EAST

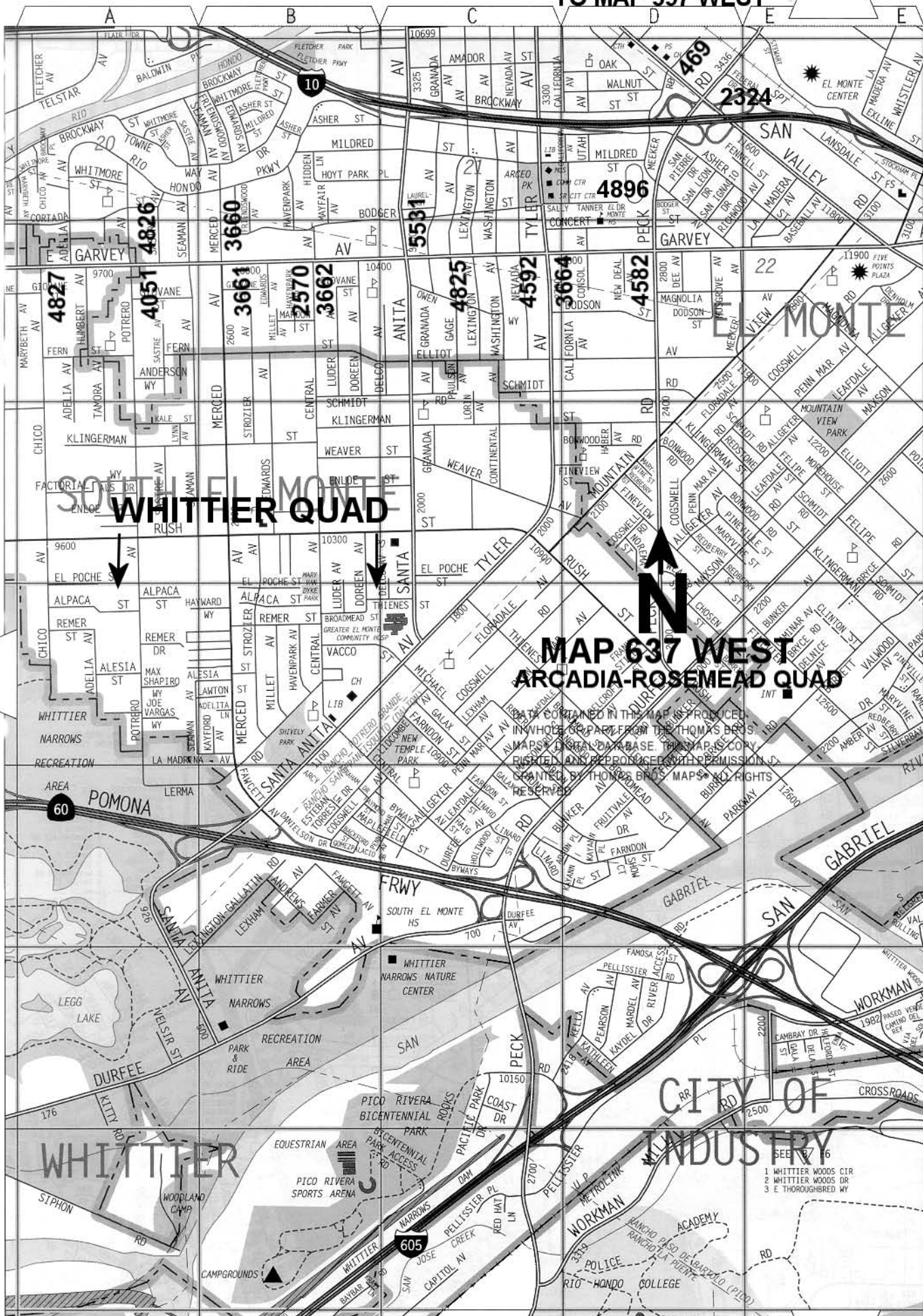

WHITTIER QUAD

**MAP 637 WEST
ARCADIA-ROSEMEAD QUAD**



DATA CONTAINED IN THIS MAP IS PRODUCED
 IN WHOLE OR PART FROM THE THOMAS BROS.
 MAPS DIGITAL DATABASE. THIS MAP IS COPY
 RIGHTED AND REPRODUCED WITH PERMISSION OF
 THOMAS BROS. MAPS. NO RIGHTS
 RESERVED.

**CITY OF
INDUSTRY**

SEE 7 6

- 1 WHITTIER WOODS CIR
- 2 WHITTIER WOODS DR
- 3 E THOROUGHBRED WY

QUAD YEAR	ELEV FOOT/METER	DESCRIPTION	BM NUMBER
ARCADIA (2005)	312.046 95.112	BT SPK IN E CB EL MONTE AVE 7.5M(25FT) N/O DRWY TO HSE #4850 152M(500FT) N/O LOWER AZUSA RD MKD (TE 466)	G 290
ARCADIA (2005)	325.487 99.209	BT SPK IN E CB EL MONTE AVE 20M(65FT) N/O C/L PROD MILOANN ST MKD (TE 462)	G 292
ARCADIA (2005)	329.152 100.326	BT SPK W CB 1.5M(5FT) S/O BCR @ SW COR EL MONTE AVE & FREER ST MKD (E 461)	G 293
ARCADIA (2005)	334.949 102.093	BT SPK IN E CB EL MONTE AVE 8.5M(28FT) S/O C/L PROD OLIVE ST MKD (TE 459)	G 294
ARCADIA (2005)	343.417 104.674	BT SPK IN W CB EL MONTE AVE 2M(7FT) S/O C/L PROD DANBURY ST MKD (TE 553)	G 296
ARCADIA (2005)	353.533 107.757	PK IN S CB 1.5M(5FT) E/O BCR @ SE COR LIVE OAK AVE & PERSIMMON AVE	G 300
ARCADIA (2005)	354.258 107.978	BT SPK IN S CB 2M(6FT) W/O BCR @ SW COR LIVE OAK AVE & MC CULLOCH AVE	G 301
ARCADIA (2005)	354.625 108.090	BT SPK IN S CB 2.5M(8FT) W/O BCR @ SW COR LIVE OAK AVE & WELLAND AVE	G 302
ARCADIA (2005)	351.142 107.028	BT SPK IN S CB LIVE OAK AVE 6M(20FT) W/O C/L PROD LOUISE AVE MKD (TE 526)	G 304
ARCADIA (2005)	350.388 106.799	BT SPK IN S CB 1M(4FT) W/O BCR @ SW COR LIVE OAK AVE & MYRTUS AVE	G 305
ARCADIA (2005)	349.273 106.459	L&T IN S CB 1M(3.3FT) W/O BCR @ SW COR LIVE OAK AVE & CENTER AVE	G 312
ARCADIA (2005)	349.701 106.589	L&BN IN S CB 1.5M(5FT) E/O BCR @ SW COR LIVE OAK AVE & NINTH AVE	G 313
ARCADIA (2005)	350.217 106.746	PK IN N CB (SERV RD) LIVE OAK AVE 5M(16FT) N/O C/L ON C/L PROD 10TH AVE	G 314
ARCADIA (2005)	350.088 106.707	L&T IN S CB 300MM(1FT) E/O BCR @ SE COR LIVE OAK AVE (SERV RD) & EISENHOWER AVE 13M(43FT) E/O & 5M(16FT) S/O C/L INT	G 315
ARCADIA (2005)	351.907 107.262	L&T IN S CB 300MM(1FT) W/O BCR @ SW COR LIVE OAK AVE & MAYFLOWER AVE	G 316
ARCADIA (2005)	354.319 107.997	L&SPK IN S CB LIVE OAK AVE 300MM(1FT) W/O BCR 11.6M(38FT) S/O C/L & 26M(85FT) W/O C/L LYND AVE	G 317
BASELINE (2005)	285.805 87.114	NAIL&W IN W END C. B. 1M(3FT) E/O BCR 12M(40FT) N/O C/L VALLEY BLVD & 20M(66FT) E/O C/L PECK RD	G 469
ARCADIA (2005)	362.276 110.422	L&PK IN E CB 1.5M(5FT) N/O BCR @ NE COR LIVE OAK AVE & WARREN WAY MKD (TE 512)	G 535
ARCADIA (2005)	366.069 111.578	L&SPK IN E CB 3M(10FT) N/O BCR @ NE COR LIVE OAK AVE & HOLLY AVE MKD (TE 508)	G 537
ARCADIA (2005)	368.867 112.431	PK IN W CB 1.5M(5FT) N/O BCR @ NW COR LIVE OAK AVE & WINTHROP AVE	G 538

QUAD YEAR	ELEV FOOT/METER	DESCRIPTION	BM NUMBER
ARCADIA (2005)	372.034 113.396	PK IN W CB 1.5M(5FT) N/O BCR @ NW COR LIVE OAK AVE & BRADFORD AVE	G 539
ARCADIA (2005)	390.303 118.965	L&BN IN S CB 4.5M(15FT) E/O BCR @ SE COR BALDWIN AVE & LAS TUNAS DR	G 545A
ARCADIA (2005)	432.948 131.963	L&T 300MM(1FT) E/O W EDGE CONC DRWY TO HSE #9846 LONGDEN AVE 4.5M(15FT) S/O CF 10.5M(34FT) S/O C/L & 5.5M(18FT) W/O C/L PROD AGNES AVE	G 553
ARCADIA (2005)	449.722 137.076	L&SPK IN S CB 1M(4FT) E/O BCR @ SE COR LONGDEN AVE & OAK AVE	G 561
ARCADIA (2005)	451.516 137.622	L&SPK IN W CB ENCINITA AVE 5.5M(18FT) W & 40M(131FT) S/O C/L INT LONGDEN AVE @ HSE #6261	G 563
ARCADIA (2005)	440.731 134.335	L&BN IN N CB 1M(3FT) W/O BCR @ NW COR ROSEMEAD BLVD & GARIBALDI AVE	G 572
ARCADIA (2005)	439.209 133.871	BT SPK IN E CB 2M(6FT) S/O BCR @ SE COR ROSEMEAD BLVD & GARIBALDI AVE	G 573
ARCADIA (2005)	430.046 131.078	L&BN IN W CB 2.5M(8FT) N/O C/L DRWY TO HSE #5947 ROSEMEAD BLVD	G 574
ARCADIA (2005)	414.964 126.481	L&SPK IN E CB 2M(6FT) S/O BCR @ SE COR ROSEMEAD BLVD & ELM AVE (TE 136)	G 576
ARCADIA (2005)	388.967 118.557	L&SPK IN E CB 3.7M(12FT) N/O BCR @ NE COR RIO HONDO AVE & LIVE OAK AVE	G 590
ARCADIA (2005)	389.425 118.697	L&SPK IN W CB 8.5M(28FT) N/O BCR @ NW COR LIVE OAK AVE & ALESSANDRO AVE	G 591
ARCADIA (2005)	388.471 118.406	L&SPK IN W CB 4.5M(15FT) N/O BCR @ NW COR LIVE OAK AVE & OAK AVE MKD (TE-26)	G 592
ARCADIA (2005)	386.707 117.869	L&SPK IN W CB 3M(10FT) N/O BCR @ NW COR LIVE OAK AVE & CLOVERLY AVE	G 593
ARCADIA (2005)	383.359 116.848	L&BN IN E CB 11.5M(38FT) N/O BCR @ NE COR LIVE OAK AVE & CAMELLIA AVE	G 598
ARCADIA (2005)	382.381 116.550	L&SPK IN W CB 7M(23FT) N/O BCR @ NW COR LIVE OAK AVE & KAUFFMAN AVE	G 599
ARCADIA (2005)	363.724 110.863	L&T IN W CB 300MM(1FT) S/O BCR @ SW COR BALDWIN AVE & BROADWAY	G 605
ARCADIA (2005)	360.105 109.760	L&T IN W CB 300MM(1FT) S/O BCR @ SW COR BALDWIN AVE & DAINES DR	G 607
BASELINE (2005)	312.549 95.265	L&SPK IN E CB 1M(3FT) N/O BCR @ NE COR BIRCHLAND PL & LOWER AZUSA RD	G 625
BASELINE (2005)	333.096 101.528	USC&GS DISK IN W CONC CHANNEL WALL @ SW COR BRIDGE OVER EATON CYN WASH 10.5M(34FT) S/O C/L LOWER AZUSA RD & 61M(203FT) W/O C/L RIO HONDO AVE MKD (S 1142 1961)	G 644

QUAD YEAR	ELEV FOOT/METER	DESCRIPTION	BM NUMBER
ARCADIA (2005)	350.593 106.861	L&SPK IN W CB ROSEMEAD BLVD (SERV RD) & GRAND AVE 2M(6FT) S/O BCR 7.5M(25FT) S/O & 3.5M(12FT) W/O C/L INT MKD (WM3)	G 668
ARCADIA (2005)	355.406 108.328	L&BN 300MM(1FT) UP ON TOP S WALL @ W END SPRR BRIDGE OVER ROSEMEAD BLVD 21M(70FT) N/O C/L GRAND AVE	G 669
ARCADIA (2005)	375.972 114.597	SPK IN E CB 3M(10FT) N/O BCR @ NE COR ROSEMEAD BLVD & SERENO DR	G 671
ARCADIA (2005)	385.144 117.392	FC DISC 1.5M(5FT) E/O E CF @ NE COR BRIDGE @ SE COR ROSEMEAD BLVD & OLIVE ST 18M(59FT) S/O & 14M(46FT) E/O C/L INT 1M(4FT) S/O BCR MKD (59-35)	G 672
ARCADIA (2005)	397.775 121.242	L&T IN W CB 11M(35FT) S/O BCR @ SW COR BROADWAY & MUSCATEL AVE	G 676
ARCADIA (2005)	401.897 122.499	L&T IN S CB 300MM(1FT) E/O BCR @ SE COR BROADWAY & N LA PRESA AVE	G 677
ARCADIA (2005)	401.863 122.488	L&T IN WALK 300MM(1FT) W/O BCR 2M(6.5FT) S/O S CF @ SW COR BROADWAY & WALNUT GROVE AVE 11M(36FT) W/O & 9M(30FT) S/O C/L INT	G 679
ARCADIA (2005)	400.754 122.150	L&T IN W CB 1M(3FT) N/O BCR @ NW COR BROADWAY & CHARLOTTE AVE	G 704
ARCADIA (2005)	400.709 122.136	L&T IN E CB 1M(3FT) N/O BCR @ NE COR BROADWAY & CHARLOTTE AVE	G 705
ARCADIA (2005)	449.333 136.957	SPK IN S CB 2M(6.5FT) E/O BCR @ SE COR SAN GABRIEL BL & HERMOSA DR MKD (BM 224)	G 711
ARCADIA (2005)	454.037 138.391	SPK IN E CB 1.5M(5FT) S/O BCR @ SE COR SAN GABRIEL BLVD & LESLIE DR	G 712
ARCADIA (2005)	459.211 139.968	L&T IN S CB 600MM(2FT) E/O BCR @ SE COR SAN GABRIEL BLVD & SANTA YNEZ ST	G 713
ARCADIA (2005)	464.104 141.459	L&T IN S CB 1M(3.3FT) E/O BCR @ SE COR SAN GABRIEL BLVD & BEVAN	G 714
ARCADIA (2005)	468.925 142.929	SPK IN E CB 2M(6.5FT) S/O BCR @ SE COR GARIBALDI AVE & SAN GABRIEL BLVD MKD (BM 228)	G 715
ARCADIA (2005)	478.248 145.770	SPK IN S CB LONGDEN AVE 1.5M(5FT) E/O C/L PROD CHARLOTTE AVE MKD (TE 612)	G 720
ARCADIA (2005)	476.791 145.326	SPK IN S CB LONGDEN AVE 1.5M(5FT) W/O C/L PROD LONGMONT AVE MKD (TE 611)	G 721
ARCADIA (2005)	471.706 143.776	L&T IN N CB 300MM(1FT) E/O BCR @ NE COR LONGDEN AVE & DEL LOMA AVE	G 722
ARCADIA (2005)	470.128 143.295	L&BN IN S CB 300MM(1FT) E/O BCR @ SE COR LONGDEN AVE & WILLARD AVE	G 724
ARCADIA (2005)	471.677 143.768	L&BN N CB 300MM(1FT) W/O BCR @ NW COR LONGDEN AVE & DEERFIELD AVE MKD (TE 608)	G 725

QUAD YEAR	ELEV FOOT/METER	DESCRIPTION	BM NUMBER
ARCADIA (2005)	472.831 144.119	L&BN IN N CB 1.5M(5FT) W/O BCR @ NW COR LONGDEN AVE & VISTA ST (N)	G 726
ARCADIA (2005)	471.790 143.802	L&BN IN E CB 300MM(1FT) S/O BCR @ SE COR LONGDEN AVE & BION AVE MKD (TE 607)	G 727
BASELINE (2005)	367.982 112.161	L&T IN W CB 7FT S/O BCR @ SW COR SAN GABRIEL BLVD & MISSION DR 38FT W & 30FT S/O C/L INT	G 748
BASELINE (2005)	364.302 111.040	L&T IN W CB 1M(3.3FT) S/O BCR @ SW COR FAIRVIEW AVE & SAN GABRIEL BLVD	G 750
BASELINE (2005)	358.823 109.370	L&T IN W CB 1M(3.3FT) N/O BCR @ NW COR SAN GABRIEL BLVD & CENTRAL AVE	G 752
BASELINE (2005)	351.928 107.268	L&T IN W CB 600MM(2FT) N/O BCR @ NW COR SAN GABRIEL BLVD & CHESTNUT AVE	G 753
ARCADIA (2005)	492.565 150.134	SPK IN W CB 2M(6.5FT) N/O BCR @ NW COR LOS OLIVOS DR & SAN GABRIEL BLVD MKD (TE 615)	G 775
ARCADIA (2005)	498.747 152.019	SPK IN W CB 3M(10FT) N/O BCR @ NW COR SAN GABRIEL BL & SOMERSET PL MKD (TE 616)	G 776
ARCADIA (2005)	506.597 154.411	SPK IN W CB 2M(6.5FT) S/O BCR @ SW COR SHEFFIELD RD & SAN GABRIEL BLVD MKD (TE 617)	G 777
ARCADIA (2005)	508.541 155.004	SPK IN E CB 2.5M(8.2FT) N/O BCR @ NE COR SHEFFIELD RD & SAN GABRIEL BLVD MKD (TE 618)	G 779
ARCADIA (2005)	516.017 157.282	SPK IN W CB 3M(10FT) N/O BCR @ NW COR SAN GABRIEL BL & WOODLAWN AVE MKD (TE 619)	G 780
ARCADIA (2005)	491.798 149.900	L&SPK IN E CB @ HSE #6734 OAK AVE & 3.5M(12FT) N/O C/L PROD ARDEN AVE MKD (TE 353)	G 809
ARCADIA (2005)	485.126 147.867	L&SPK IN E CB OAK AVE 1.5M(5FT) S/O C/L PROD CAMINO REAL (TO THE W) MKD (TE 355)	G 811
ARCADIA (2005)	474.087 144.502	SPK IN E CB OAK AVE 1M(3FT) N/O C/L PROD EMPEROR AVE (TO THE W) MKD (TE 357)	G 813
ARCADIA (2005)	468.719 142.866	L&SPK IN E CB 600MM(2FT) S/O BCR @ SE COR OAK AVE & LEMON AVE MKD (TE199)	G 814
ARCADIA (2005)	469.303 143.044	RDBM TAG IN E CB 15M(50FT) N/O BCR @ NE COR BALDWIN AVE & CAMINO REAL AVE	G 825B
ROSEMEAD (2005)	297.395 90.646	RE TAG #2000 IN E CB @ ANG PT SLY P/L TO HSE #4544 34M(111FT) S/O & 9M(30FT) E/O C/L INT ARDEN DR & ARDEN WAY	G 832
ROSEMEAD (2005)	302.411 92.175	RDBM TAG IN SE COR OF BRIDGE OVER EATON CYN WASH 9.5M(31FT) E/O C/L TEMPLE CITY BLVD & 20M(65FT) N/O SPRR TRACKS	G 854A
ROSEMEAD (2005)	281.133 85.690	L&SPK IN E CB ELLIS LANE NEAR C/L PROD STEELE ST	G 875

QUAD YEAR	ELEV FOOT/METER	DESCRIPTION	BM NUMBER
ROSEMEAD (2005)	275.395 83.941	L&SPK IN E CB 3M(10FRT) S/O BCR @ SE COR DE ADALENA ST & RIO HONDO AVE	G 883
ROSEMEAD (2005)	282.207 86.017	L&BN IN N CB 300MM(1FT) E/O BCR @ NE COR ROSEMEAD BLVD & GLENDON WAY	G 891
ROSEMEAD (2005)	283.612 86.445	L&BN IN N CB 3M(10FT) W/O BCR @ NW COR ROSEMEAD BLVD & GLENDON WAY	G 892
ROSEMEAD (2005)	325.050 99.076	CS MON IN WELL ON C/L MUSCATEL AVE 30.5M(100FT) N/O C/L VALLEY BLVD MKD (RE 329)	G 906
ROSEMEAD (2005)	290.407 88.516	L&SPK IN W CB 1.5M(5FT) S/O BCR @ SW COR RIO HONDO AVE & GUESS ST	G 910
ROSEMEAD (2005)	291.716 88.915	L&SPK IN E CB 1.5M(5FT) N/O BCR @ NE COR RIO HONDO AVE & GUESS ST	G 911
ROSEMEAD (2005)	298.386 90.948	L&SPK IN W CB 1M(3FT) S/O BCR @ SW COR RIO HONDO AVE & STEELE ST	G 912
ARCADIA (2005)	603.771 184.030	CSBM MON IN WELL 300MM(1FT) W/O & 300MM(1FT) N/O BCR @ NW COR MICHILLINDA AVE & SYCAMORE ST MKD (BM 20-8 1952 RE 63)	G 1218
BASELINE (2005)	716.650 218.436	L&BN IN E CB 9M(29.5FT) N/O BCR @ NE COR FOOTHILL BLVD & SIERRA MADRE VILLA	G 1247
BASELINE (2005)	723.090 220.398	RAMSET IN S CB 300MM(1FT) W/O BCR @ NW COR SANTA PAULA AVE & FOOTHILL BLVD	G 1249
BASELINE (2005)	689.945 210.296	L&BN IN S CB FOOTHILL BLVD 10.5M(34FT) S/O C/L IN CTR OF C. B. @ BLDG #3600 161M(530FT) W/O ROSEMEAD BLVD	G 1254
ARCADIA (2005)	615.676 187.659	L&BN IN W CB 300MM(1FT) N/O BCR @ NW COR MICHILLINDA AVE & BLANCHE AVE	G 1269A
BASELINE (2005)	309.765 94.417	SPK IN W CB 2.5M(8FT) S/O BCR @ SW COR MARSHALL ST & SAN GABRIEL BLVD	G 1439
ROSEMEAD (2005)	253.163 77.164	L&BN IN W CB (SERV RD) ROSEMEAD BLVD 4.5M(15FT) S/O BCR 33.5M(110FT) S/O & 5.5M(18FT) W/O C/L INT WITH TELSTAR AVE	G 1448
ROSEMEAD (2005)	247.978 75.584	L&BN IN E CB 300MM(1FT) N/O BCR @ NE COR ROSEMEAD BLVD & WHITMORE AVE	G 1449
ROSEMEAD (2005)	248.744 75.817	L&BN IN E CB 1.5M(5FT) S/O BCR @ SE COR ROSEMEAD BLVD & WHITMORE AVE	G 1450
BASELINE (2005)	249.286 75.983	FC BM MON IN NE ABUT OF BRIDGE OVER RIO HONDO RIVER 1M(3.3FT) N/O CF 12.5M(41FT) N/O C/L GARVEY AVE MKD (57-13)	G 1451
BASELINE (2005)	251.401 76.627	FC BM MON IN NW ABUT OF BRIDGE OVER RIO HONDO RIVER 1M(3.3FT) N/O CF 12.5M(41FT) N/O C/L GARVEY AVE MKD (57-11)	G 1452
ARCADIA (2005)	525.526 160.181	RDBM TAG IN N CB C/L MEDIAN 300MM(1FT) W/O ANG PT 9M(30FT) S/O C/L HUNTINGTON DR (N BBL) & 15M(50FT) W/O C/L GOLDEN WEST AVE	G 1693

QUAD YEAR	ELEV FOOT/METER	DESCRIPTION	BM NUMBER
ARCADIA (2005)	525.905 160.296	L&T IN N CB 1M(3FT) W/O BCR 9M(30FT) N/O C/L HUNTINGTON DR (N BARREL) & 16.5M(54FT) W/O C/L GOLDEN WEST AVE	G 1694
ARCADIA (2005)	552.725 168.471	CSBM MON IN WELL 300MM(1FT) DN 300MM(1FT) N/O CF @ BCR @ NW COR HUNTINGTON DR & MICHILLINDA AVE MKD (BM 20-7 1952 RE 63)	G 1696
ARCADIA (2005)	565.821 172.463	SQ HD SPK IN W CB 14M(45FT) N/O BCR @ NW COR ROSEMEAD BLVD & HUNTINGTON DR N	G 1698
ARCADIA (2005)	589.897 179.801	BT SPK IN W CB 7.5M(25FT) N/O BCR NR S END C. B. @ NW COR LA PRESA DR & HUNTINGTON DR (N BBL)	G 1702
BASELINE (2005)	285.039 86.880	CS MON IN WELL 450MM(1.5FT) N/O CF VALLEY BLVD 300MM(1FT) E/O BCR 12.5M(41FT) N/O C/L & 19.5M(64FT) E/O C/L PECK RD MKD (BM 15-1 1952) NR W END C. B.	G 2324
BASELINE (2005)	340.914 103.911	FC MON IN N END OF BRIDGE #B1270 12M(39FT) W/O C/L PECK RD & 305M(0.2MI) N/O CLARK ST MKD (BM 67-75 1959)	G 2332
BASELINE (2005)	341.597 104.119	RDBM TAG IN CONC CH WALL 1.5M(5FT) E/O CF @ NE COR BRIDGE #B1270 13.5M(44.3FT) E/O C/L PECK RD & 305M(0.2MI) N/O C/L CLARK ST	G 2333
BASELINE (2005)	366.579 111.734	L&T IN E CB MYRTLE AVE 12M E C/L 11.5M(38FT) S/O BCR OF ISLAND & 20M(65.6FT) S/O C/L CALIFORNIA AVE EXIT	G 2337
BASELINE (2005)	367.488 112.011	FC TAG IN W CB 1.5M(5FT) S/O NLY MOST C. B. 12M(39FT) W/O C/L MYRTLE AVE & 16M(52.5FT) N/O C/L PROD CALIF AVE W	G 2338
BASELINE (2005)	668.997 203.911	SPK&W IN N CB 300MM(1FT) E/O BCR @ NE COR FOOTHILL BLVD & DEXTER AVE MKD BM	G 2494
BASELINE (2005)	672.355 204.934	L&BN IN E CB 300MM(1FT) S/O BCR @ NE COR DEXTER AVE & FOOTHILL BLVD (N SERV RD) 7.5M(24.6FT) N/O & 6.5M(21.3FT) E/O C/L INT	G 2495
ARCADIA (2005)	568.673 173.332	SM SPK IN N CB 10M(32FT) E/O BCR @ NE COR BALDWIN AVE & CAMBRIDGE DR	G 2505
BASELINE (2005)	310.914 94.767	FC BM MON IN NE COR BRIDGE OVER RIO HONDO RIVER 10M(32FT) N/O C/L LOWER AZUSA RD & 141M(462FT) E/O C/L DALEVIEW AVE MKD (62-128 1959)	G 2506
ROSEMEAD (2005)	284.904 86.839	L&TAG(NO#) IN C. B. 2M(6.5FT) E/O BCR @ NE COR VALLEY BLVD & JOHNSON AVE	G 2521
ROSEMEAD (2005)	289.307 88.181	L&BR IN N CB 2M(6.5FT) W/O BCR @ NW COR VALLEY BLVD & TYLER AVE	G 2524
ROSEMEAD (2005)	278.150 84.780	L&T IN N CB 300MM(1FT) E/O BCR @ NW COR VALLEY BLVD & VELMA ST	G 2528
ROSEMEAD (2005)	278.524 84.894	L&T IN N CB 300MM(1FT) E/O BCR @ NW COR VALLEY BLVD & ROWLAND AVE	G 2529
BASELINE (2005)	328.903 100.250	L&BN IN W CB 300MM(1FT) S/O BCR @ SW COR SAN GABRIEL BLVD & VALLEY BLVD	G 2534

QUAD YEAR	ELEV FOOT/METER	DESCRIPTION	BM NUMBER
BASELINE (2005)	278.225 84.803	FC BM MON IN W WINGWALL 22.5M(74FT) N/O C/L GARVEY AVE & 69M(226FT) W/O C/L SAN GABRIEL BLVD MKD (BM 55-24) 34FT N/O CF	G 2537
BASELINE (2005)	264.992 80.770	CSBM MON IN WELL 600MM(2FT) S/O S CF 46M(151FT) E/O BCR & SE COR GARVEY AVE & CENTRAL AVE MKD (12-7 1952 RE 63)	G 2570
BASELINE (2005)	298.743 91.057	CSBM MON IN WELL 300MM(1FT) E/O CF @ SE COR PECK RD & FORREST GROVE ST 22M(71FT) S/O & 12.5M(41FT) E/O C/L INT MKD (BM 15-2A 1963)	G 2635
BASELINE (2005)	315.863 96.275	CSBM MON IN CONC LT BASE 3.5M(11.5FT) W/O W CF @ SW COR PECK RD & LAMBERT AVE 15.5M(51FT) W/O & 12M(39.5FT) S/O C/L INT MKD (15-3A 1963 RE 5869)	G 2636
BASELINE (2005)	356.226 108.578	FC MON IN S END W WINGWALL OF BRIDGE #944 @ SE COR PECK RD & LIVE OAK ST 25M(82FT) E/O & 14.5M(47.6FT) S/O APPROX C/L INT MKD (67-76 1959)	G 2637
BASELINE (2005)	389.176 118.621	L&SPK IN W CB 2M(6.5FT) S/O BCR @ SW COR MYRTLE AVE & ALTERN ST	G 2638
BASELINE (2005)	389.874 118.834	L&SPK IN S CB 3M(10FT) E/O BCR @ SE COR MYRTLE AVE & E ALTERN ST	G 2639
BASELINE (2005)	501.918 152.985	CSBM MON IN E END C. B. 21M(69FT) E/O BCR @ SE COR MYRTLE AVE & HUNTINGTON DR MKD (11-10A 1962 RE 5869)	G 2642
BASELINE (2005)	298.453 90.969	L&BR IN N CB 13.5M(44FT) E/O BCR @ NE COR PECK RD & RAMONA BLVD	G 2739
ROSEMEAD (2005)	259.325 79.042	L&T IN S CB OLNEY ST ON C/L PROD VANE AVE	G 3015
ROSEMEAD (2005)	259.684 79.152	L&T IN N CB 2.5M(8FT) W/O BCR @ NE COR OLNEY ST & VANE AVE	G 3016
BASELINE (2005)	309.727 94.405	STATE HWY BR DISC FL IN CTR DIVIDER STRIP C/L SAN GABRIEL BLVD 88M(290FT) S/O C/L MARSHALL ST (FR THE E)	G 3027
BASELINE (2005)	338.548 103.190	L&T IN E CB 3M(10FT) S/O BCR @ SE COR ROSEMEAD BLVD & LOWER AZUSA RD	G 3029
ROSEMEAD (2005)	318.031 96.936	BT SPK IN E CB 3M(10FT) S/O BCR @ SE COR ROSEMEAD BLVD & VALLEY BLVD	G 3035
ARCADIA (2005)	386.352 117.760	L&T IN E CB 3M(10FT) S/O BCR @ SE COR SAN GABRIEL BLVD & EL MONTE ST	G 3040
ARCADIA (2005)	407.912 124.332	L&BN IN E CB 3.5M(11FT) S/O BCR @ SE COR BROADWAY & SAN GABRIEL BLVD	G 3042
ARCADIA (2005)	408.762 124.591	L&BR IN W CB 3.5M(12FT) N/O BCR @ NW COR BROADWAY & SAN GABRIEL BLVD (IN CTR C. B.)	G 3043
ARCADIA (2005)	414.908 126.464	FC BM DISC IN NW BRIDGE ABUT OVER RUBIO WASH 15M(49FT) W/O & 19M(62FT) S/O C/L INT SAN GABRIEL BLVD & WEDGEWOOD PL MKD (BM 58-523)	G 3044

QUAD YEAR	ELEV FOOT/METER	DESCRIPTION	BM NUMBER
ARCADIA (2005)	600.355 182.989	L&BN IN S CB 18M(59FT) W/O BCR @ SW COR HUNTINGTON DR & SAN GABRIEL BLVD	G 3049
ARCADIA (2005)	600.002 182.881	L&BN IN N CB 7.5M(25FT) E/O BCR @ NE COR HUNTINGTON DR & SAN GABRIEL BLVD	G 3050
BASELINE (2005)	663.599 202.266	SPK IN E CB 2M(6.5FT) S/O BCR @ SE COR CALIFORNIA BLVD & SAN GABRIEL BLVD	G 3053
ARCADIA (2005)	541.732 165.120	MWD MON IN NE COR OF BRIDGE OVER SANTA ANITA WASH 15M(49FT) N/O C/L FOOTHILL BLVD & 84M(276FT) E/O C/L HIGHLAND OAKS MKD (53 K 1933)	G 3062
BASELINE (2005)	472.844 144.123	L&N IN W CB 1.5M(5FT) N/O BCR @ NW COR MONTANNA AVE & MYRTLE AVE	G 3072
ARCADIA (2005)	376.121 114.642	L&BN IN W CB 3.5M(11FT) S/O BCR @ SW COR LIVE OAK AVE & BALDWIN AVE	G 3080
ARCADIA (2005)	504.838 153.875	L&T IN W CB 300MM(1FT) S/O BCR @ SW COR BALDWIN AVE & HUGO REID DR	G 3083
ARCADIA (2005)	585.253 178.386	SPK IN W CB MICHILLINDA AVE 1.5M(5FT) N/O C/L PROD HUGO REID DR MKD(TE431)	G 3091
ARCADIA (2005)	562.941 171.585	SPK IN W CB 3M(9FT) N/O BCR @ NW COR MICHILLINDA AVE & CALIFORNIA BLVD MKD (TE 432)	G 3092
BASELINE (2005)	716.347 218.343	CS MON IN WELL 300MM(1FT) E/O CF 15M(49FT) N/O BCR @ NE COR FOOTHILL BLVD & SIERRA MADRE VILLA MKD (BM 10-9A RE 5869 1962)	G 3094
ARCADIA (2005)	458.400 139.721	L&PK IN W CB 2M(6FT) S/O BCR @ SW COR BALDWIN AVE & CALLITA AVE	G 3221
ARCADIA (2005)	431.323 131.468	RD HD SPK IN W CB 1.5M(5FT) N/O BCR @ NW COR BALDWIN AVE & LONGDEN AVE	G 3222
ARCADIA (2005)	429.805 131.005	L&BN IN W CB 300MM(1FT) S/O BCR & SW COR BALDWIN AVE & LONGDEN AVE MKD (BM)	G 3223
ARCADIA (2005)	342.245 104.317	L&BN IN E CB 3M(10FT) N/O BCR @ NE COR BALDWIN AVE & GREEN ST MKD (BM)	G 3225
ARCADIA (2005)	341.276 104.021	L&BN IN E CB 2M(6.5FT) S/O BCR @ SE COR BALDWIN AVE & GREEN ST MKD (BM)	G 3226
ARCADIA (2005)	586.761 178.845	L&T IN N CB C/L MEDIAN 2M(6FT) S/O C/L HUNTINGTON DR 35M(115FT) E/O C/L LA PRESA DR	G 3227
ARCADIA (2005)	569.644 173.628	L&BN IN N CB 6.5M(21FT) E/O BCR @ NE COR HUNTINGTON DR & MADRE ST	G 3228
ARCADIA (2005)	562.930 171.582	L&T IN E CB 2M(6FT) N/O BCR @ SE COR HUNTINGTON DR & ROSEMEAD BLVD MKD (BM)	G 3229
ARCADIA (2005)	554.820 169.110	L&T IN E CB 11M(35FT) N/O BCR @ NE COR HUNTINGTON DR & MICHILLINDA AVE	G 3230

QUAD YEAR	ELEV FOOT/METER	DESCRIPTION	BM NUMBER
ARCADIA (2005)	603.403 183.918	RD HD SPK IN W CB 2.5M(8FT) S/O BCR @ SW COR SYCAMORE AVE & MICHILLINDA AVE MKD (TE 428)	G 3231
ARCADIA (2005)	389.008 118.570	L&T IN S CB 600MM(2FT) W/O BCR @ SW COR ROSEMEAD BLVD & BROADWAY	G 3238
BASELINE (2005)	318.945 97.215	L&BN IN N CB 14M(45FT) E/O BCR @ NE COR LOWER AZUSA RD & SANTA ANITA AVE	G 3241
BASELINE (2005)	334.730 102.026	L&T IN CB 3FT N/O BCR @ NE COR ROSEMEAD BLVD & MISSION DR	G 3246
ROSEMEAD (2005)	264.451 80.605	RDBM TAG IN S CB 10.5M(34FT) W/O BCR @ SW COR MARSHALL BLVD & TEMPLE CITY BLVD	G 3247
ROSEMEAD (2005)	302.735 92.274	RDBM TAG IN SW COR OF BRIDGE OVER EATON WASH 10M(33FT) W/O C/L TEMPLE CITY BLVD & 30.5M(100FT) N/O SPRR TRACK	G 3249
ROSEMEAD (2005)	280.311 85.439	RDBM TAG IN N CB 300MM(1FT) E/O BCR @ NE COR VALLEY BLVD & ARDEN DR	G 3251
ROSEMEAD (2005)	323.394 98.571	RDBM TAG IN W CB 300MM(1FT) N/O BCR @ NW COR VALLEY BLVD & WALNUT GROVE AVE	G 3252
ROSEMEAD (2005)	286.917 87.453	RDBM TAG IN E CB 300MM(1FT) N/O BCR @ NE COR ARDEN DR & VENITA ST	G 3254
BASELINE (2005)	308.700 94.092	RDBM TAG IN S CB 2M(6.5FT) E/O BCR @ SE COR ARDEN DR & LOWER AZUSA RD	G 3255
BASELINE (2005)	356.109 108.542	L&BN IN N CB 600MM(2FT) E/O BCR @ NE COR PECK RD & LIVE OAK AVE	G 3278
ARCADIA (2005)	510.183 155.504	RDBM TAG IN S CB 600MM(2FT) W/O BCR @ SW COR DUARTE RD & OAK AVE	G 3589
ARCADIA (2005)	511.542 155.918	L&T IN N CB DUARTE RD 10M(32FT) N/O C/L & 13M(42FT) W/O C/L PROD OAK AVE (NR E END CB)	G 3590
ARCADIA (2005)	507.885 154.804	RDBM TAG S CB 300MM(1FT) W/O BCR @ SW COR DUARTE RD & TEMPLE CITY BLVD	G 3591
BASELINE (2005)	656.527 200.110	RDBM TAG IN N CB FOOTHILL BLVD 300MM(1FT) E/O BCR SERVICE RD 8M(26FT) N/O C/L & 23M(75.5FT) E/O C/L DON ROBLES DR	G 3594
BASELINE (2005)	318.054 96.943	RDBM TAG IN E CB 600MM(2FT) N/O BCR @ NE COR LOWER AZUSA RD & BALDWIN AVE	G 3601
BASELINE (2005)	697.074 212.469	L&BN IN S END C. B. 1M(3.3FT) N/O BCR @ NW COR DEL MAR BLVD & SAN GABRIEL BLVD	G 3604
ARCADIA (2005)	529.730 161.462	L&T IN W CB 300MM(1FT) S/O BCR @ SW COR SAN GABRIEL BLVD & DUARTE RD	G 3607
ARCADIA (2005)	434.337 132.386	L&SPK IN N CB 2M(6.5FT) E/O BCR @ NE COR SAN GABRIEL BLVD & LAS TUNAS DR	G 3608

QUAD YEAR	ELEV FOOT/METER	DESCRIPTION	BM NUMBER
ARCADIA (2005)	414.560 126.358	FC DISC IN SW COR BRIDGE OVER RUBIO WASH 15M(49FT) W/O & 30.5M(100FT) S/O C/L INT SAN GABRIEL BL & WEDGEWOOD PL MKD (RW 58-201 1940)	G 3609
BASELINE (2005)	309.776 94.420	L&BN IN W CB 300MM(1FT) S/O BCR @ SW COR LOWER AZUSA RD & SHIRLEY AVE	G 3611
BASELINE (2005)	333.464 101.640	CS MON 125MM(0.4FT) UP 2.5M(8.2FT) E/O CF @ NW COR FIRE STA 61M(197FT) N/O C/L CHERRYLEE DR & 15M(49FT) E/O C/L PECK RD MKD (NW COR LOT 5)	G 3616
BASELINE (2005)	360.600 109.911	FC MON IN SE RET 1M(3.3FT) S/O CF @ W END OF BRIDGE 19M(62.3FT) E/O C/L MYRTLE AVE & 10M(32.8FT) S/O C/L LONGDEN AVE MKD (BM 067-00565 1965)	G 3619
BASELINE (2005)	259.838 79.199	L&BN IN N CB 3.5M(11.5FT) W/O BCR @ NW COR GARVEY AVE & MERCED AVE MKD (BM)	G 3660
BASELINE (2005)	260.615 79.436	L&SPK IN N CB 3.5M(11.5FT) E/O BCR @ NE COR GARVEY AVE & MERCED AVE	G 3661
BASELINE (2005)	267.003 81.383	RD HD SPK IN S CB 2M(6.5FT) E/O BCR @ SE COR GARVEY AVE & CENTRAL AVE	G 3662
BASELINE (2005)	269.921 82.272	RD HD SPK IN W CB 1.5M(5FT) S/O BCR @ SW COR TYLER AVE & GARVEY AVE	G 3664
BASELINE (2005)	321.141 97.884	RDBM TAG IN E CB 1M(3.3FT) N/O BCR @ NE COR PECK RD & EMERY ST	G 3667
BASELINE (2005)	242.494 73.912	RDBM TAG E END C. B. 13.5M(44FT) W/O BCR @ NW COR GARVEY AVE & ROSEMEAD BLVD	G 4049
BASELINE (2005)	252.579 76.986	CSBM MON IN WELL 300MM(1FT) W/O W CF 12.5M(41FT) S/O BCR @ SW COR GARVEY AVE & POTRERO AVE MKD (BM 12-8A 1971 RE 7078)	G 4051
BASELINE (2005)	282.182 86.009	CSBM MON IN WELL 300MM(1FT) N/O CF @ BCR @ NW COR SAN GABRIEL BLVD & EMERSON PL MKD (BM 1-25C 1970)	G 4113
ARCADIA (2005)	399.864 121.879	CSBM MON @ N END C. B. 6M(20FT) N/O BCR @ NW COR SAN GABRIEL BLVD & ANGELINO AVE MKD (BM 1-28A 1971)	G 4115
ARCADIA (2005)	433.114 132.014	CSBM MON IN N END C. B. 13M(42.7FT) S/O BCR @ SW COR SAN GABRIEL BLVD & LAS TUNAS DR MKD (BM 10-1B 1971)	G 4116
ARCADIA (2005)	448.333 136.652	CSBM MON 300MM(1FT) W/O CF 22.5M(74FT) S/O BCR @ SW COR HERMOSA DR & SAN GABRIEL BL MKD (BM 10-1C 1971)	G 4117
ARCADIA (2005)	485.619 148.017	CSBM MON 300MM(1FT) W/O CF 1.5M(5FT) S/O BCR @ SW COR SAN GABRIEL BL & LONGDEN AVE MKD (BM 10-2A 1971 RE 5869)	G 4118
ARCADIA (2005)	533.191 162.517	CSBM MON IN N END C. B. 4M(13FT) N/O BCR @ NW COR SAN GABRIEL BL & DUARTE RD MKD (BM 10-4A 1975 RE 7078)	G 4119
ARCADIA (2005)	601.885 183.455	CSBM MON IN S END C. B. 1.5M(5FT) N/O BCR @ NE COR SAN GABRIEL BLVD & HUNTINGTON DR MKD (BM 10-5A 1966)	G 4120
ARCADIA (2005)	653.878 199.303	CSBM MON IN WELL 1M(3.3FT) N/O BCR 600MM(2FT) E/O CF @ SE COR LOMBARDY RD & SAN GABRIEL BL MKD (BM 10-6A 1971)	G 4121

QUAD YEAR	ELEV FOOT/METER	DESCRIPTION	BM NUMBER
BASELINE (2005)	664.025 202.395	RDBM TAG IN S END C. B. 2M(6.5FT) N/O BCR @ NE COR SAN GABRIEL BLVD & CALIFORNIA BLVD	G 4122
BASELINE (2005)	696.634 212.335	CSBM MON IN N END C. B. @ NE COR SAN GABRIEL BLVD & DEL MAR BLVD MKD (BM 10-7A 1971 RE 5869)	G 4123
BASELINE (2005)	744.291 226.861	CSBM MON IN N END C. B. 4.5M(14.8FT) N/O BCR @ NW COR FOOTHILL BLVD & DAISY AVE MKD (BM 10-8B 1971 RE 5869)	G 4125
BASELINE (2005)	703.929 214.558	RDBM TAG IN N CB 300MM(1FT) E/O BCR @ NE COR FOOTHILL BLVD & HALSTEAD ST	G 4127
BASELINE (2005)	694.076 211.555	RDBM TAG IN S CB 2M(6.5FT) E/O BCR @ SW COR ROSEMEAD BL & FOOTHILL BLVD	G 4128
BASELINE (2005)	695.676 212.043	CSBM MON 300MM(1FT) N/O CF 1M(3.3FT) E/O BCR @ NE COR ROSEMEAD BL & FOOTHILL BL MKD (BM 10-9C 1971 RE 5869)	G 4129
BASELINE (2005)	681.202 207.631	CSBM MON IN N END C. B. 3.5M(11.5FT) N/O BCR @ NW COR FOOTHILL BLVD & MICHILLINDA AVE MKD (BM 10-10A 1971)	G 4130
BASELINE (2005)	677.536 206.514	RDBM TAG IN S CB 300MM(1FT) E/O BCR @ SE COR FOOTHILL BLVD & MICHILLINDA AVE	G 4131
BASELINE (2005)	656.593 200.130	CSBM MON IN W END C. B. 2M(6.5FT) E/O BCR (SERV RD) @ NE COR FOOTHILL BLVD & DON ROBLES DR MKD (BM 10-11A 1971 RE 5869)	G 4132
BASELINE (2005)	552.316 168.346	FC BM DISC IN W WINGWALL OF FC CHANNEL 11.5M(37.7FT) N/O C/L FOOTHILL BLVD & 116M(380FT) E/O C/L RANCHO RD MKD (BM 062-31125 1967)	G 4133
BASELINE (2005)	356.787 108.749	CSBM MON IN WELL 6.5M(21FT) W/O BCR @ NW COR MISSION DR & BARTLETT AVE MKD (19-2A 1971 RE 7078)	G 4146
BASELINE (2005)	347.287 105.853	RD BM TAG IN S CB 1FT E/O BCR @ SE COR MISSION DR & MUSCATEL AVE	G 4148
BASELINE (2005)	335.708 102.324	CS BR CAP MON 1FT W/O W CB FACE 48FT N/O BCR @ NW COR MISSION DR & ROSEMEAD BLVD 152FT N & 43FT W/O C/L INT MKD (BM 19-3A 1971 RE 7078)	G 4149
BASELINE (2005)	316.935 96.602	CSBM MON NR W END C. B. 10M(32FT) W/O BCR @ SW COR LOWER AZUSA RD & TEMPLE CITY BLVD MKD (BM 19-5B 1975)	G 4150
BASELINE (2005)	314.967 96.002	RDBM TAG IN N CB @ W END C. B. 23M(75.5FT) E/O BCR @ NE COR LOWER AZUSA RD & ELLIS LN	G 4152
BASELINE (2005)	318.021 96.933	RDBM TAG S CB 300MM(1FT) E/O BCR @ SW COR LOWER AZUSA RD & SANTA ANITA AVE	G 4156
BASELINE (2005)	318.965 97.221	CSBM IN W END C. B. 14M(45FT) E/O BCR @ NE COR LOWER AZUSA RD & SANTA ANITA AVE MKD (BM 19-8A 1971)	G 4157
BASELINE (2005)	315.189 96.070	L&BN IN W CB 600MM(2FT) N/O BCR @ SW COR LAMBERT AVE & PECK RD	G 4160
BASELINE (2005)	324.957 99.047	RD BM TAG 1FT W/O BCR @ SW COR LOWER AZUSA RD & PECK RD 96FT W & 32FT S/O C/L INT	G 4161

QUAD YEAR	ELEV FOOT/METER	DESCRIPTION	BM NUMBER
BASELINE (2005)	325.838 99.316	CS BM MON FL IN S WALL C. B. 42FT N/O BCR @ NE COR PECK RD & LOWER AZUSA RD 39FT E & 107FT N/O C/L INT MKD (BM 15-4D 1971)	G 4162
BASELINE (2005)	434.477 132.429	L&T IN CB RET 5M(16.4FT) N/O BCR @ SW COR MYRTLE AVE & DUARTE RD	G 4163
ARCADIA (2005)	496.854 151.442	RDBM TAG IN W CB 300MM(1FT) S/O BCR @ NW COR BALDWIN AVE & L (N BARREL) HUNTINGTON DR	G 4334
ARCADIA (2005)	481.498 146.761	CSBM MON IN SE COR C. B. 16M(52.5FT) N/O BCR @ NE COR BALDWIN AVE & DUARTE RD MKD (BM 20-5A 1966 RE 5869)	G 4335
ARCADIA (2005)	374.776 114.232	RDBM TAG IN N CB 300MM(1FT) W/O BCR @ NW COR BROADWAY & N ENCINITA AVE	G 4336
ARCADIA (2005)	645.304 196.689	RDBM TAG IN N CB 300MM(1FT) W/O BCR @ NW COR COLORADO BLVD & MICHILLINDA AVE	G 4338
ARCADIA (2005)	642.787 195.922	RDBM TAG IN E CB 300MM(1FT) S/O BCR @ SE COR COLORADO BLVD & MICHILLINDA AVE	G 4339
ARCADIA (2005)	544.694 166.023	L&T IN S CB OF SMALL ISLAND 5M(17FT) W/O BCR 17M(55FT) W/O C/L SUNSET BLVD & 9M(30FT) N/O C/L HUNTINGTON DR (S BBL)	G 4340
ARCADIA (2005)	544.739 166.037	L&T IN N CB 1M(4FT) W/O BCR @ NW COR HUNTINGTON DR (N BBL) & SUNSET BLVD	G 4341
ARCADIA (2005)	508.673 155.044	L&T IN W CB 1M(3FT) N/O BCR @ NW COR SUNSET BLVD & DUARTE RD	G 4342
ARCADIA (2005)	440.454 134.251	L&T IN W CB RET 2M(7FT) N/O BCR @ SW COR LONGDEN AVE & TEMPLE CITY BLVD	G 4343
ARCADIA (2005)	450.583 137.338	RAMSET & WASHER IN N CB NR BCR @ NW COR LONGDEN AVE & OAK AVE	G 4344
ARCADIA (2005)	470.501 143.409	FC TAG IN C. B. 600MM(2FT) E/O CF @ NE COR LONGDEN AVE & MUSCATEL AVE 11M(37FT) N/O & 6.5M(22FT) E/O C/L INT	G 4345
ARCADIA (2005)	529.491 161.389	L&T IN CTR CB RET @ SW COR SUNSET BLVD & FAIRVIEW AVE (16FT N/O BCR)	G 4347
ARCADIA (2005)	330.053 100.600	FC TAG IN W CB 1M(4FT) N/O BCR @ NW COR FREER ST & EL MONTE AVE	G 4352
ROSEMEAD (2005)	279.924 85.321	RDBM TAG IN N CB 300MM(1FT) W/O BCR @ NW COR VALLEY BLVD & ARDEN DR	G 4354
ROSEMEAD (2005)	299.117 91.171	L&SPK IN S CB 5M(16FT) W/O BCR @ SW COR VALLEY BLVD & RIO HONDO AVE	G 4357
ROSEMEAD (2005)	274.643 83.711	L&T IN W CB 300MM(1FT) S/O BCR @ SW COR TEMPLE CITY BLVD & GUESS ST	G 4358
ROSEMEAD (2005)	262.450 79.995	L&T IN W CB TEMPLE CITY BLVD & 10.5M(34FT) S/O C/L PROD LOFTUS DR	G 4359
ROSEMEAD (2005)	261.122 79.590	L&BN IN W CB 2M(6.5FT) N/O BCR @ NW COR TEMPLE CITY BLVD & OLNEY ST	G 4360

QUAD YEAR	ELEV FOOT/METER	DESCRIPTION	BM NUMBER
ARCADIA (2005)	562.226 171.367	CSBM MON IN E END C. B. 11M(35FT) W/O BCR @ NW COR CALIFORNIA BLVD & MICHILLINDA AVE MKD (BM 20-7A 1969)	G 4538
BASELINE (2005)	306.972 93.565	RDBM TAG IN E CB 300MM(1FT) N/O BCR @ NE COR LOWER AZUSA RD & EL MONTE AVE	G 4539
BASELINE (2005)	307.132 93.614	L&T IN W CB 1M(3FT) N/O BCR @ NW COR LOWER AZUSA RD & EL MONTE AVE	G 4540
ARCADIA (2005)	387.210 118.022	L&T IN S CB 1M(4FT) E/O BCR @ SE COR LIVE OAK AVE & ENCINITA AVE	G 4541
ARCADIA (2005)	376.448 114.742	CSBM MON IN E END C. B. 3.5M(12FT) W/O BCR @ SW COR LIVE OAK AVE & BALDWIN AVE MKD (20-2A 1966)	G 4542
BASELINE (2005)	638.647 194.660	RDBM TAG IN SE COR EDISON BOX 600MM(2FT) W/O CF 2M(6.5FT) N/O BCR @ NW COR FOOTHILL BLVD & BALDWIN AVE	G 4545
BASELINE (2005)	351.909 107.262	L&T IN E CB 1M(3.3FT) N/O BCR @ NE COR SAN GABRIEL BLVD & CHESTNUT AVE	G 4572
BASELINE (2005)	546.976 166.719	DPW BM TAG IN S END C. B. 6M(20FT) N/O BCR @ NE COR FOOTHILL BLVD & SANTA ANITA AVE	G 4574
BASELINE (2005)	276.456 84.264	DPW BM TAG IN E CB 300MM(1FT) S/O BCR @ NE COR PECK RD & GARVEY AVE	G 4582
BASELINE (2005)	299.747 91.363	DPW BM TAG IN N CB 600MM(2FT) W/O BCR @ NE COR PECK RD & FOREST GROVE ST	G 4583
BASELINE (2005)	312.195 95.157	DPW BM TAG IN E CB 600MM(2FT) N/O BCR @ NE COR PECK RD & BAYSE ST	G 4584
BASELINE (2005)	518.748 158.115	DPW BM TAG IN E CB 300MM(1FT) S/O BCR @ SE COR MYRTLE AVE & CHESTNUT AVE	G 4586
BASELINE (2005)	578.660 176.376	DPW BM TAG IN W CB 300MM(1FT) N/O BCR @ NW COR MYRTLE AVE & FOOTHILL BLVD	G 4587
BASELINE (2005)	339.342 103.432	L&SPK IN W CB ROSEMEAD BLVD 12M(40FT) W/O C/L & 17.5M(57.4FT) N/O C/L PROD LOWER AZUSA RD	G 4588
BASELINE (2005)	270.320 82.394	DPW BM TAG IN S CB 2M(6.5FT) E/O BCR @ SE COR GARVEY AVE & TYLER AVE	G 4592
ARCADIA (2005)	551.936 168.231	DPW BM TAG IN W CB 2M(6.5FT) N/O BCR @ NW COR FOOTHILL BLVD & MAYFLOWER AVE (@ S END C. B.)	G 4720
ARCADIA (2005)	510.978 155.747	DPW BM TAG IN E CB 3.5M(11.5FT) N/O BCR @ NE COR FOOTHILL BLVD & MC KINLEY PL	G 4721
ARCADIA (2005)	512.857 156.319	DPW BM TAG IN N CB 600MM(2FT) E/O BCR @ NE COR FOOTHILL BLVD & FIFTH AVE	G 4722
ARCADIA (2005)	514.030 156.677	CSBM MON E END C. B. 10M(33FT) W/O BCR @ SW COR FOOTHILL BLVD & FIFTH ST MKD (BM 11-3A 1977 RE 22726)	G 4723

QUAD YEAR	ELEV FOOT/METER	DESCRIPTION	BM NUMBER
ARCADIA (2005)	541.792 165.139	FC BM MON @ SE COR OF BRIDGE OVER SANTA ANITA WASH 15M(49FT) S/O C/L FOOTHILL BLVD & 84M(276FT) E/O C/L HIGHLAND OAKS MKD (BM 63-70)	G 4724
ARCADIA (2005)	409.167 124.714	DPW BM TAG IN W CB 1.5M(5FT) S/O BCR @ SW COR ROSEMEAD BLVD & LAS TUNAS DR	G 4725
ARCADIA (2005)	462.646 141.015	DPW BM TAG IN W CB 2M(7FT) S/O BCR @ SW COR ROSEMEAD BLVD & LONGDEN AVE	G 4726
ARCADIA (2005)	464.154 141.475	DPW BM TAG IN W CB 300MM(1FT) S/O BCR @ NW COR ROSEMEAD BLVD & LONGDEN AVE	G 4727
ARCADIA (2005)	530.783 161.783	DPW BM TAG W CB 300MM(1FT) N/O BCR @ NW COR SUNSET BLVD & FAIRVIEW AVE	G 4728
ARCADIA (2005)	401.774 122.461	DPW BM TAG IN N CB @ NW COR BROADWAY & WALNUT GROVE AVE 14M(47FT) W/O & 7.5M(25FT) N/O C/L INT (2.5M(9FT) W/O E END C. B.)	G 4729
BASELINE (2005)	266.969 81.372	L&T IN S CB 2.5M(8FT) E/O BCR @ SE COR GARVEY AVE & LEXINGTON AVE	G 4825
BASELINE (2005)	252.841 77.066	DPW BM TAG IN N CB 3M(10FT) W/O BCR @ NW COR GARVEY AVE & POTERO AVE	G 4826
BASELINE (2005)	247.071 75.307	L&T IN N CB (DEP) GARVEY AVE ON C/L PROD CHICO AVE	G 4827
BASELINE (2005)	242.956 74.053	ARMY CORP OF ENG MON IN N CB 15M(49FT) E/O BCR @ NE COR GARVEY AVE & ROSEMEAD BLVD MKD (WS 118 1981 LADO) @ E END C. B.	G 4828
BASELINE (2005)	246.633 75.174	L&SPK IN W CB 9.5M(31FT) N/O BCR @ NW COR GARVEY AVE & ROSEMEAD PL	G 4829
BASELINE (2005)	249.154 75.942	DPW BM TAG IN N CB 1M(3.3FT) W/O BCR @ NW COR GARVEY AVE & IVAR AVE	G 4830
BASELINE (2005)	250.628 76.392	DPW BM TAG IN N CB 3M(10FT) W/O BCR @ NW COR GARVEY AVE & MUSCATEL AVE	G 4831
BASELINE (2005)	260.123 79.286	L&BR IN CB RET 3M(10FT) W/O BCR @ NE COR GARVEY AVE & WALNUT GROVE	G 4832
BASELINE (2005)	260.711 79.465	DPW BM TAG IN N CB 1M(3.3FT) W/O BCR @ NW COR GARVEY AVE & WALNUT GROVE	G 4833
BASELINE (2005)	266.132 81.117	L&BR IN N CB GARVEY AVE & 9M(29.5FT) E/O C/L PROD DELTA AVE	G 4834
BASELINE (2005)	289.905 88.363	L&BR IN S CB STEWART ST @ E END C. B. 600MM(2FT) W/O BCR 4.5M(15FT) S/O C/L & 25.5M(84FT) W/O C/L PECK RD	G 4897
BASELINE (2005)	298.528 90.992	L&BR IN N CB 300MM(1FT) E/O BCR @ NW COR PECK RD & RAMONA BLVD	G 4898
BASELINE (2005)	332.201 101.255	L&BR IN S CB 1M(3.3FT) E/O BCR @ SE COR PECK RD & CHERRY LEE DR	G 4899

QUAD YEAR	ELEV FOOT/METER	DESCRIPTION	BM NUMBER
BASELINE (2005)	336.294 102.503	DPW BM TAG IN E CB 1M(3.3FT) S/O BCR @ SE COR PECK RD & RIO HONDO PKWY	G 4900
BASELINE (2005)	334.393 101.923	DPW BM TAG IN E CB 1M(3.3FT) S/O BCR @ SE COR PECK RD & CLARK ST	G 4901
BASELINE (2005)	378.267 115.296	DPW BM TAG IN E CB 1M(3.3FT) S/O BCR @ SE COR PECK RD & ANDRE ST	G 4903
BASELINE (2005)	400.382 122.037	DPW BM TAG IN E CB 1M(3.3FT) S/O BCR @ SE COR MYRTLE AVE & KRUSE AVE	G 4904
BASELINE (2005)	364.071 110.969	L&T IN N CB 2M(6.5FT) W/O BCR @ NW COR MISSION DR & EARLE AVE	G 5145
BASELINE (2005)	358.330 109.219	DPW BM TAG IN W CB 1M(3.3FT) S/O BCR @ SW COR MISSION DR & WALNUT GROVE AVE	G 5146
BASELINE (2005)	355.861 108.467	L&BR IN N CB MISSION DR ON C/L PROD BARTLETT AVE S	G 5147
BASELINE (2005)	349.282 106.461	L&BR IN N CB 1M(3.3FT) W/O BCR @ NW COR MISSION DR & MUSCATEL AVE	G 5148
BASELINE (2005)	336.050 102.428	RAM SET&W IN W CB 1M(3.3FT) N/O BCR @ NW COR SULTAN AVE & LOWER AZUSA RD	G 5149
BASELINE (2005)	325.008 99.063	DPW BM TAG IN S CB 300MM(1FT) W/O BCR @ SW COR LOWER AZUSA RD & ENCINITA AVE	G 5150
BASELINE (2005)	324.861 99.018	DPW BM TAG IN S CB 3M(10FT) E/O BCR @ SE COR LOWER AZUSA RD & ENCINITA AVE	G 5151
BASELINE (2005)	318.096 96.956	DPW BM TAG IN W CB 300MM(1FT) S/O BCR @ SW COR LOWER AZUSA RD & CLOVERLY AVE	G 5152
BASELINE (2005)	310.767 94.722	L&SPK IN E ABUT @ SE COR BRIDGE OVER RIO HONDO RIVER 8M(26FT) S/O C/L LOWER AZUSA RD & 128M(420FT) E/O DALEVIEW AVE	G 5154
BASELINE (2005)	320.339 97.640	L&BR IN S CB 600MM(2FT) E/O BCR @ SE COR LOWER AZUSA RD & CEDAR AVE	G 5155
BASELINE (2005)	345.733 105.380	L&T IN N CB 1.5M(5FT) W/O BCR @ NW COR SAN GABRIEL BLVD & WELLS ST	G 5156
BASELINE (2005)	344.487 105.000	L&SPK IN W CB 3M(10FT) S/O BCR @ SW COR SAN GABRIEL BLVD & WELLS ST	G 5157
BASELINE (2005)	329.207 100.343	DPW BM TAG IN S CB 1M(3.3FT) E/O BCR @ SE COR VALLEY BLVD & SAN GABRIEL BLVD	G 5158
BASELINE (2005)	314.514 95.864	FC TAG IN W CB 1.5M(5FT) N/O BCR @ NW COR SAN GABRIEL BLVD & NORWOOD PL	G 5159
BASELINE (2005)	297.188 90.583	LACO BM TAG IN N CB 1M(3.3FT) W/O BCR @ NW COR HELLMAN AVE & SAN GABRIEL BL	G 5160

QUAD YEAR	ELEV FOOT/METER	DESCRIPTION	BM NUMBER
BASELINE (2005)	296.347 90.327	LACO BM TAG IN W CB 3M(10FT) S/O BCR @ SW COR HELLMAN AVE & SAN GABRIEL BLVD	G 5161
BASELINE (2005)	282.129 85.993	L&BR IN W CB 300MM(1FT) S/O BCR @ SW COR EMERSON PL & SAN GABRIEL BLVD	G 5162
ROSEMEAD (2005)	313.075 95.426	L&BR IN W CB 1M(3.3FT) S/O BCR @ SW COR VALLEY BLVD & HART AVE	G 5166
ROSEMEAD (2005)	276.234 84.196	L&PK IN N CB @ BCR @ NE COR VALLEY BLVD & GIBSON RD	G 5169
ROSEMEAD (2005)	284.972 86.860	FC BR DISC @ NE COR BRIDGE OVER RIO HONDO RIVER 11.5M(38FT) N/O C/L VALLEY BLVD MKD (BM 062-00100 1965)	G 5170
ROSEMEAD (2005)	287.507 87.632	DPW BM TAG IN N CB 300MM(1FT) W/O BCR @ NW COR VALLEY BLVD & MONTEREY AVE	G 5171
ROSEMEAD (2005)	289.104 88.119	L&BR IN E CB 1M(3.3FT) N/O BCR @ NE COR VALLEY BLVD & TYLER AVE	G 5172
ROSEMEAD (2005)	303.700 92.568	L&T IN E CB ROSEMEAD BLVD ON C/L PROD RALPH ST FROM THE W (3FT S/O BCR)	G 5173
ROSEMEAD (2005)	284.534 86.726	FC BM MON IN N CB 10.5M(34FT) W/O BCR @ NW COR ROSEMEAD BLVD & GLENDON WAY MKD (BM 058-00592 1967)	G 5174
ROSEMEAD (2005)	288.238 87.855	L&T IN W CB TEMPLE CITY BLVD ON C/L PROD ABILENE ST	G 5175
ROSEMEAD (2005)	277.058 84.448	L&SPK IN N CB 1M(3FT) E/O BCR @ NE COR ELLIS LN & GUESS ST	G 5176
ROSEMEAD (2005)	271.234 82.672	L&BR IN W CB 300MM(1FT) N/O BCR @ NW COR RIO HONDO AVE & GLENDON WAY	G 5178
ROSEMEAD (2005)	274.105 83.547	L&T IN E CB RIO HONDO AVE ON C/L PROD MARSHALL ST	G 5179
ROSEMEAD (2005)	289.973 88.384	L&FC TAG IN N CB 1M(3.3FT) E/O BCR @ NE COR ARDEN DR & BISBY ST	G 5180
ROSEMEAD (2005)	283.689 86.469	DPW BM TAG IN W CB 1M(3.3FT) S/O BCR @ SW COR ARDEN DR & ROSE ST	G 5181
BASELINE (2005)	547.090 166.754	L&BR IN N CB @ BCR @ NW COR SANTA ANITA AVE & FOOTHILL BLVD	G 5184
BASELINE (2005)	560.710 170.905	L&BR IN S CB @ W END C. B. 2M(6.5FT) W/O BCR @ SW COR RANCHO RD & FOOTHILL BLVD	G 5185
BASELINE (2005)	622.084 189.612	L&BN IN N CB FOOTHILL BLVD 10M(33FT) N/O C/L & 32M(105FT) E/O C/L PROD BALDWIN AVE (FROM THE S)	G 5186
BASELINE (2005)	637.631 194.351	DPW BM TAG IN S CB (SERV RD) 2M(6.5FT) E/O BCR @ NE COR FOOTHILL BLVD & BALDWIN AVE S	G 5187
BASELINE (2005)	742.453 226.300	RAMSET IN N CB 300MM(1FT) W/O BCR @ NE COR DAISY AVE & FOOTHILL BLVD	G 5188

QUAD YEAR	ELEV FOOT/METER	DESCRIPTION	BM NUMBER
BASELINE (2005)	730.494 222.655	CITY OF PASADENA L&TAG IN SW CB RET 1.5M(5FT) N/O BCR @ SW COR WALNUT ST & DAISY AVE	G 5189
BASELINE (2005)	722.431 220.198	DPW BM TAG IN S CB 2M(6.5FT) W/O BCR @ SW COR COLORADO BLVD & SAN GABRIEL BLVD	G 5190
BASELINE (2005)	720.743 219.683	DPW BM TAG IN E CB 1M(3.3FT) S/O BCR @ SE COR COLORADO BLVD & SAN GABRIEL BLVD	G 5191
ARCADIA (2005)	655.480 199.791	LACO DPW BM TAG IN E CB RET 300MM(1FT) S/O BCR @ NE COR SAN GABRIEL BLVD & LOMBARDY RD	G 5192
ARCADIA (2005)	635.113 193.583	L&BN IN N CB 3.5M(11.5FT) W/O BCR @ NW COR SHAKESPEARE DR & SAN GABRIEL BLVD	G 5193
ARCADIA (2005)	556.003 169.470	L&BR IN W CB 13M(43FT) N/O BCR @ NW COR SAN GABRIEL BLVD & ROSE AVE	G 5194
ARCADIA (2005)	570.849 173.995	DPW BM TAG IN E CB @ N END C. B. 6M(20FT) N/O BCR @ NE COR FOOTHILL BLVD & MAGNOLIA AVE	G 5195
ARCADIA (2005)	397.944 121.294	L&SPK IN W CB 6M(20FT) S/O BCR @ SW COR BROADWAY & MUSCATEL AVE S	G 5196
ARCADIA (2005)	347.033 105.776	L&SPK IN S CB 2M(6.5FT) W/O BCR @ SW COR LIVE OAK AVE & LENORE AVE	G 5197
ARCADIA (2005)	335.921 102.389	DPW BM TAG IN E CB 1M(3.3FT) S/O BCR @ SE COR BALDWIN AVE & LA ROSA DR	G 5198
ARCADIA (2005)	391.427 119.307	DPW BM TAG IN W CB 1M(3.3FT) S/O BCR @ SW COR BALDWIN AVE & LAS TUNAS DR	G 5199
ARCADIA (2005)	410.135 125.010	L&BR IN W CB 6M(20FT) S/O BCR @ SW COR BALDWIN AVE & GARIBALDI AVE	G 5200
ARCADIA (2005)	447.407 136.370	SPK&W IN E CB 1M(3.3FT) N/O BCR @ NE COR BALDWIN AVE & LEMON AVE E	G 5201
ARCADIA (2005)	519.215 158.257	L&T IN W CB 300MM(1FT) N/O BCR @ NW COR BALDWIN AVE & ENT TO ARBORETUM	G 5204
ARCADIA (2005)	540.401 164.715	L&SPK IN W CB BALDWIN AVE 12M(40FT) W/O C/L & 31M(102FT) N/O C/L STANFORD DR MKD (BM)	G 5205
ARCADIA (2005)	561.165 171.044	L&BN IN N CB @ BCR @ NW COR HUNTINGTON DR (N BBL) & LOTUS AVE	G 5206
ARCADIA (2005)	580.510 176.940	FC BM MON IN E WINGWALL OF BRIDGE OVER EATON WASH 2M(6.5FT) N/O CF & 11M(36FT) N/O C/L HUNTINGTON DR (N BBL) MKD (BM 059-04000 1965)	G 5207
ARCADIA (2005)	592.380 180.558	L&T IN NW CB RET HUNTINGTON DR (SERV RD) 1M(3FT) E/O BCR 4M(13FT) N/O C/L & 13M(43FT) W/O C/L WINIFRED AVE	G 5208
ARCADIA (2005)	435.329 132.689	LACO DPW TAG IN N CB 300MM(1FT) W/O BCR @ NW COR LONGDEN AVE & GOLDEN WEST AVE	G 5209

QUAD YEAR	ELEV FOOT/METER	DESCRIPTION	BM NUMBER
ARCADIA (2005)	364.649 111.145	DPW BM TAG IN N CB 1M(3.3FT) E/O BCR @ NE COR ROSEMEAD BLVD & PENTLAND ST	G 5211
ROSEMEAD (2005)	328.257 100.053	LACO BM TAG IN S CB 2M(6.5FT) E/O BCR @ SE COR VALLEY BLVD & DELTA AVE	G 5407
ROSEMEAD (2005)	322.823 98.397	LACO BM TAG IN S CB 4M(13FT) E/O BCR @ SE COR VALLEY BLVD & WALNUT GROVE AVE	G 5408
ROSEMEAD (2005)	320.122 97.573	LACO BM TAG IN N CB 300MM(1FT) W/O BCR @ NW COR VALLEY BLVD & ROSEMEAD BLVD (@ E END C. B.)	G 5409
ROSEMEAD (2005)	298.883 91.100	LACO BM TAG IN N CB 1M(3.3FT) W/O BCR @ NW COR VALLEY BLVD & RIO HONDO AVE	G 5410
ROSEMEAD (2005)	289.376 88.202	LS TAG #5301 IN S CB VALLEY BLVD ON C/L PROD MERWYN C. GILL WY (FORMERLY EASY ST)	G 5411
ROSEMEAD (2005)	284.182 86.619	L&SPK IN NE CB RET 3M(10FT) S/O BCR @ NE COR VALLEY BLVD & TEMPLE CITY BL	G 5412
ROSEMEAD (2005)	284.908 86.840	LACO FC MON IN NW COR BRIDGE OVER RIO HONDO RIVER 11.5M(38FT) N/O C/L VALLEY BLVD MKD (BM 062-00070 1965)	G 5413
ROSEMEAD (2005)	285.023 86.875	L&TAG(NO#) IN SE COR C. B. 2M(6.5FT) W/O BCR @ NW COR VALLEY BLVD & JOHNSON AVE	G 5415
ROSEMEAD (2005)	269.855 82.252	L&BR IN E CB RIO HONDO AVE & 7M(23FT) N/O C/L PROD GLENDON WAY	G 5418
ROSEMEAD (2005)	263.493 80.313	L&T IN W CB RIO HONDO AVE ON C/L PROD OLNEY ST	G 5419
ROSEMEAD (2005)	298.923 91.112	LACO BM TAG IN E CB @ S END C. B. 2.5M(8FT) N/O BCR @ NE COR ARDEN DR & ARDEN WAY	G 5420
ARCADIA (2005)	524.708 159.931	LACO BM TAG IN N CB FOOTHILL BLVD & 10M(32.8FT) E/O C/L PROD NORTH VIEW AVE	G 5421
ARCADIA (2005)	509.181 155.199	LACO BM TAG IN S CB FOOTHILL BLVD & 5M(16.4FT) W/O C/L PROD MCKINLEY PL	G 5422
ARCADIA (2005)	536.981 163.672	LACO BM TAG IN N CB 1M(3.3FT) E/O BCR @ NE COR FOOTHILL BLVD & MAUNA LOA DR	G 5423
ARCADIA (2005)	550.885 167.910	CS MON 500MM(1.6FT) S/O CF 8M(26FT) E/O BCR @ SE COR FOOTHILL BLVD & MAYFLOWER AVE MKD (RM NO 2 1959 SIERRA MADRE K6 RE 5869)	G 5424
ARCADIA (2005)	488.243 148.817	LACO BM TAG IN E CB @ N END C. B. 6M(20FT) N/O BCR @ NE COR BALDWIN AVE & FAIRVIEW AVE	G 5426
ARCADIA (2005)	504.896 153.893	LACO BM TAG IN E CB 1M(3.3FT) S/O BCR @ SE COR BALDWIN AVE & NLY ENT TO SANTA ANITA MALL (OPP HSE #307)	G 5427
ARCADIA (2005)	352.810 107.537	LS TAG #4743 IN W CB 2.5M(8FT) S/O BCR @ SW COR LIVE OAK AVE (W) & EL MONTE AVE	G 5428

QUAD YEAR	ELEV FOOT/METER	DESCRIPTION	BM NUMBER
ARCADIA (2005)	354.234 107.971	SM PK NAIL IN E CB 3M(10FT) N/O BCR @ NE COR LIVE OAK AVE (E) & EL MONTE AVE 24.5M(80FT) N/O & 8.5M(28FT) E/O C/L INT	G 5429
ARCADIA (2005)	389.350 118.674	L&BRAD IN N CB 2M(6.5FT) E/O BCR @ NW COR ROSEMEAD BLVD & BROADWAY	G 5430
ARCADIA (2005)	378.808 115.461	RAMSET&W IN NE CB RET 3M(10FT) W/O BCR @ BROADWAY & NOEL DR	G 5431
ARCADIA (2005)	387.677 118.164	L&T IN W CB ENCINITA AVE ON C/L PROD LIVE OAK AVE	G 5432
ARCADIA (2005)	383.764 116.972	RAMSET&W IN N CB 7M(23FT) W/O BCR @ NW COR TEMPLE CITY BLVD & LIVE OAK AVE	G 5433
ARCADIA (2005)	379.950 115.809	RAMSET&W IN N CB LIVE OAK AVE 1M(3.3FT) W/O C/L PROD CAMBURY AVE	G 5434
ARCADIA (2005)	345.168 105.208	LACO BM TAG IN S CB 1M(3.3FT) W/O BCR @ SW COR LIVE OAK AVE & TYLER AVE	G 5435
ARCADIA (2005)	410.958 125.260	LACO BM TAG IN E CB 1M(3FT) N/O BCR @ NE COR ROSEMEAD BLVD & LAS TUNAS DR	G 5436
ARCADIA (2005)	486.651 148.332	L&SPK IN E CB 1.5M(5FT) N/O BCR @ NE COR SAN GABRIEL BLVD & LONGDEN AVE	G 5437
ARCADIA (2005)	441.055 134.434	LACO BM TAG IN S CB 1M(3.3FT) E/O BCR @ SE COR LONGDEN AVE & TEMPLE CITY BLVD	G 5438
ARCADIA (2005)	434.223 132.352	LACO BM TAG IN W CB 400MM(1.3FT) S/O BCR @ SW COR LONGDEN AVE & GOLDEN WEST AVE	G 5439
ARCADIA (2005)	628.504 191.569	L&T IN W CB MICHILLINDA AVE 2.5M(8FT) S/O C/L PROD VOLANTE DR	G 5440
ARCADIA (2005)	502.912 153.288	L&T IN W CB 1M(3.3FT) N/O BCR @ NW COR HUNTINGTON DR (N BRL) & OLD RANCH RD	G 5441
BASELINE (2005)	439.506 133.962	L&T IN W CB 600MM(2FT) N/O BCR @ NW COR MYRTLE AV & DUARTE RD 19M(62.3FT) N/O & 13M(42.7FT) W/O C/L INT	G 5456
BASELINE (2005)	360.688 109.938	L&T IN E CB @ BCR @ NE COR MYRTLE AV & LONGDEN AV 17M(55.8FT) E/O & 11M(36.1FT) N/O C/L INT	G 5457
BASELINE (2005)	501.918 152.985	L&DPW BM TAG 900MM(3FT) S/O BCR @ SE COR MYRTLE AV & LEMON AV	G 5524
BASELINE (2005)	594.991 181.354	L&DPW BM TAG IN N CB FOOTHILL BL 12.2M(40FT) E/O C/L PROD BURNELL OAKS LN	G 5525
ARCADIA (2005)	386.333 117.755	L&T 2.1M(7FT) S/O BCR @ SW COR EL MONTE AV & SAN GABRIEL BL	G 5527
BASELINE (2005)	306.907 93.546	L&LS#5301 TAG 600MM(2FT) W/O BCR @ NW COR DOREEN AV & LOWER AZUSA RD	G 5528
BASELINE (2005)	306.862 93.532	L&TAG(NO#) 3M(10FT) N/O BCR @ NE COR DOREEN AV & LOWER AZUSA RD	G 5529

QUAD YEAR	ELEV FOOT/METER	DESCRIPTION	BM NUMBER
BASELINE (2005)	275.868 84.085	L&DPW BM TAG 300MM(1FT) W/O BCR @ NW COR SAN GABRIEL BL & GARVY AV	G 5530
BASELINE (2005)	266.803 81.322	L&LS#6771 TAG 900MM(3FT) W/O BCR @ NW COR GARVY AV & SANTA ANITA AV	G 5531
ARCADIA (2005)	361.204 110.095	SPK IN N CB 1.5M(5FT) W/O ECR @ NW COR BALDWIN AV & DAINES DR(W)	G 5562
ARCADIA (2005)	495.089 150.904	L&LS#2723 TAG IN E CB 3.4M(11FT) S/O ECR IN THE RETURN @ NE COR BALDWIN AV & HUNINGTON DR	G 5563
ARCADIA (2005)	481.131 146.649	L&DPW TAG IN S CB 300MM(1FT) W/O BCR @ SW COR BALDWIN AV & DUARTE RD	G 5564
ARCADIA (2005)	453.277 138.159	L&LS#6998 IN W CB ROSEMEAD BL @ P/L TO HSE#6169 & HSE#6203	G 5565
ROSEMEAD (2005)	286.704 87.388	L&T IN E CB @ BCR @ SE COR ARDEN DR & VENITA ST	G 5566
ROSEMEAD (2005)	287.805 87.723	L&T IN E CB 13M(4FT) N/O ECR @ NE COR VALLY BL & RAMONA BL (@ S END C.B.)	G 5567
ROSEMEAD (2005)	284.438 86.697	L&T IN S CB 2.1M(7FT) E/O BCR @ SW COR VALLEY BL & TEMPLE CITY BL	G 5568
ROSEMEAD (2005)	252.577 76.986	LACFC BRASS CAP MON ON E CB (SERVICE RD) ROSEMEAD BL 6.1M(20FT) S/O BCR @ SE COR TELSTAR AV MKD (BM 058-00250)	G 5569