

LOS ANGELES COUNTY
DEPARTMENT OF PUBLIC WORKS
BENCH MARK LIST



FAIRFAX QUAD
(WEST HOLLYWOOD)

2003 ADJUSTMENT

NAVD 88 DATUM
METRIC

PREFACE

The Department of Public Works level net is composed of more than 1,700 miles or 2720 kilometers of levels supporting in excess of 9,000 bench marks. Previously when a major readjustment of the net was undertaken, to emphasize the complete break with previous elevations, the CY, CG, & CL, series bench marks were re-labeled DY, DG, & DL, respectively. Beginning in 1993 the baseline readjustment year will be indicated on baseline BM, s only indicated below (*). Henceforth all BM numbers will be labeled as a Y, G, or L, series that will no longer indicate the major adjustment year.

To facilitate the adjustment, indexing and distribution of adjusted values of the net, the county territory was divided into 33 quads or areas. For the identification purposes each quad was given a name, viz., "Rosemead," "La Mirada," "Santa Fe," etc. When bench marks and elevations in these quads are used, the name must be included in the bench mark description, e.g.,

* BASELINE 90.057 L&BR IN CTR OF CB RET @ NE COR Y 9191
(1990) 295.461 LA HABRA BLVD & VALLEY HOME AVE
10.7M N & 10.7M E/O C/L INT

It is expected that this general adjustment will for the most part remain sound for 8 to 12 years. Updating constrained adjustments will continue in the future. When a quad is readjusted, new elevations will be published and the date of readjustment will be noted in the bench mark description. Two bench marks with different adjustment dates will not normally agree with each other.

The basic accuracy of the net is reflected by an indicated field probable error of plus or minus 4mm per kilometer of leveling as determined from the conditions of closure. However, many years of experience in vertical control in the greater Los Angeles basin and Antelope Valley indicate that because of varying degrees of subsidence and heaving, the true datum is recovered only by obtaining substantial agreement of a number of bench marks.

The users of this net are invited to assist in its maintenance by notifying this department of cases of obliteration, apparent mistakes in description or elevations, and proven disturbance of bench marks.

DATUM: North American Vertical Datum of 1988 (NAVD88)

Note: NAVD 1988 minus approximately 700mm (2.3ft) equals
Previous NGVD 1929 Datums. For more accurate equations
At individual bench marks refer to previous publications

ABBREVIATIONS USED IN BENCH MARK LISTINGS

ABUT -----	Abutment	ECR -----	End of Curb
ALG -----	Along	EC -----	End of Curb
ANG PT -----	Angle Point	ENT -----	Entrance
B/W -----	Back of Walk	FL -----	Floor
BCR -----	Beginning of Curve Return	FTG -----	Footing
BLDG -----	Building	FRWY -----	Freeway
BM -----	Bench Mark	F/W -----	Front of Walk
BT SPK -----	Boat or Bolt Spike	GAR -----	Garage
BR CAP -----	Brass or Bronze Cap	HDWL -----	Headwall
C B -----	Catch Basin	HSE -----	House
CTR -----	Center	INT -----	Intersection
C/L -----	Center Line	IP -----	Iron Pipe
C/L INT -----	Center Line Intersection	LT -----	Left
C/L PROD ---	Center Line Produced	LACE -----	L.A. City Engineer
CONC -----	Concrete	LACS -----	L.A. Co. Engineer
COR -----	Corner	LAFC -----	L.A. Co. Flood Control
COE -----	Corps of Engineers	L&BN -----	Lead and Bench Nail
CULV -----	Culvert	L&BR -----	Lead and Brad
CYN -----	Canyon	L&N -----	Lead and Nail
CB -----	Curb	L&SPK -----	Lead and Spike
CS MON -----	Co. Eng. Monument	L&T -----	Lead and Tack
CT SPK -----	Cut Spike	MCR -----	Middle of Curb Return
DPW -----	Dept. of Public Works	MKD -----	Marked
DR -----	Drive or Driveway	MC -----	Middle of Curb
E/O -----	East of	MON -----	Monument

ABBREVIATIONS USED IN BENCH MARK LISTINGS (CON'T)

N/O ----- North of
NR ----- Near
OPP ----- Opposite
PI ----- Point of Intersection
PK&W ----- PK Nail and Washer
P/L ----- Property Line
POST ----- Point on Semi-Tangent
PP ----- Power Pole
PVMT ----- Pavement
PROD ----- Produced
RD ----- Road
RDBM ----- Road Dept. Bench Mark
RDBM TAG - Road Dept. Bench Mark Tag
RR ----- Railroad
RT ----- Right
R/W ----- Right of Way
SDMH ----- Storm Drain Manhole
SMH ----- Sewer Manhole
SPK ----- Spike
ST&W ----- Spike Tin and Washer
S/O ----- South of
TP ----- Telephone Pole
USC&GS --- U.S. Coast and Geodetic Survey
USGS ----- U.S. Geological Survey
WK ----- Walk
W/O ----- West of
D90/L-3

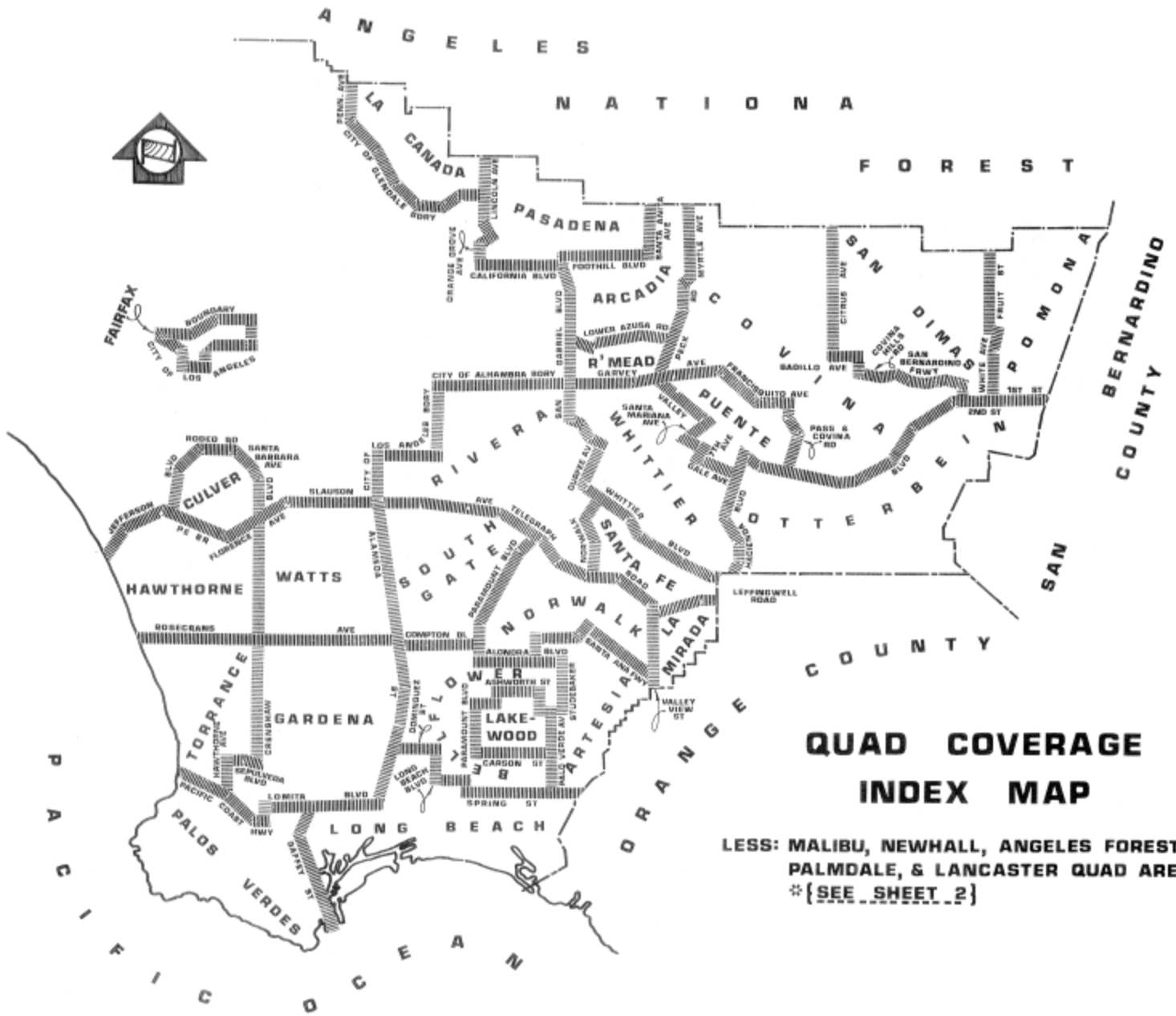

**QUAD COVERAGE
INDEX MAP**

LESS: MALIBU, NEWHALL, ANGELES FOREST,
PALMDALE, & LANCASTER QUAD AREAS.*
*{SEE SHEET 2}

K E R N C O U N T Y

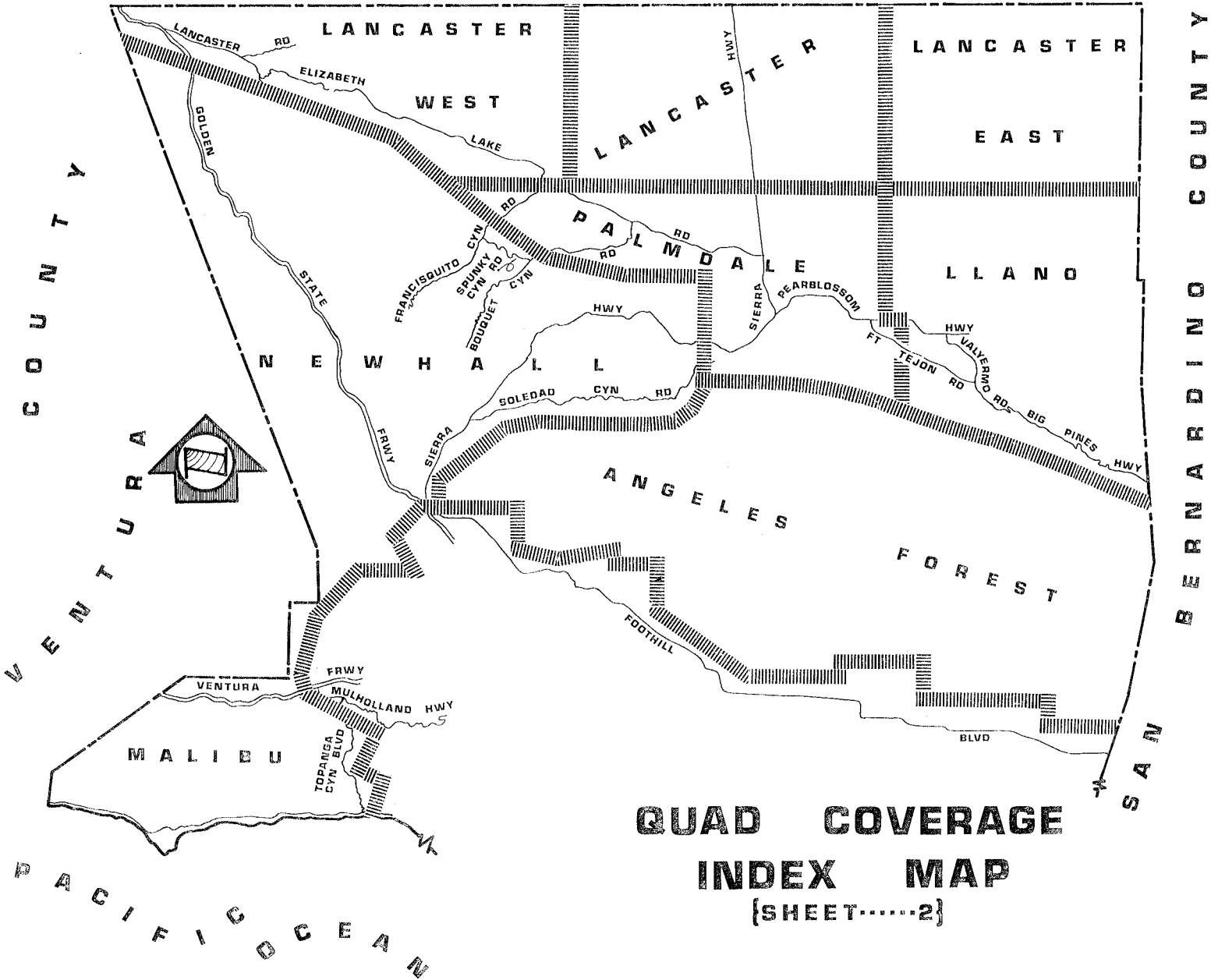

QUAD COVERAGE
INDEX MAP
{SHEET.....2}

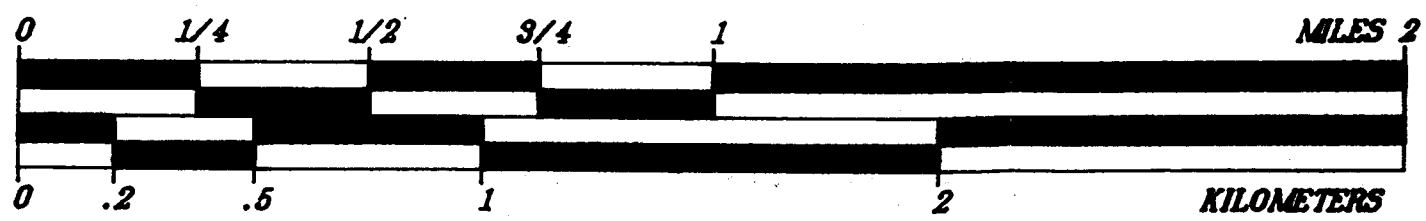
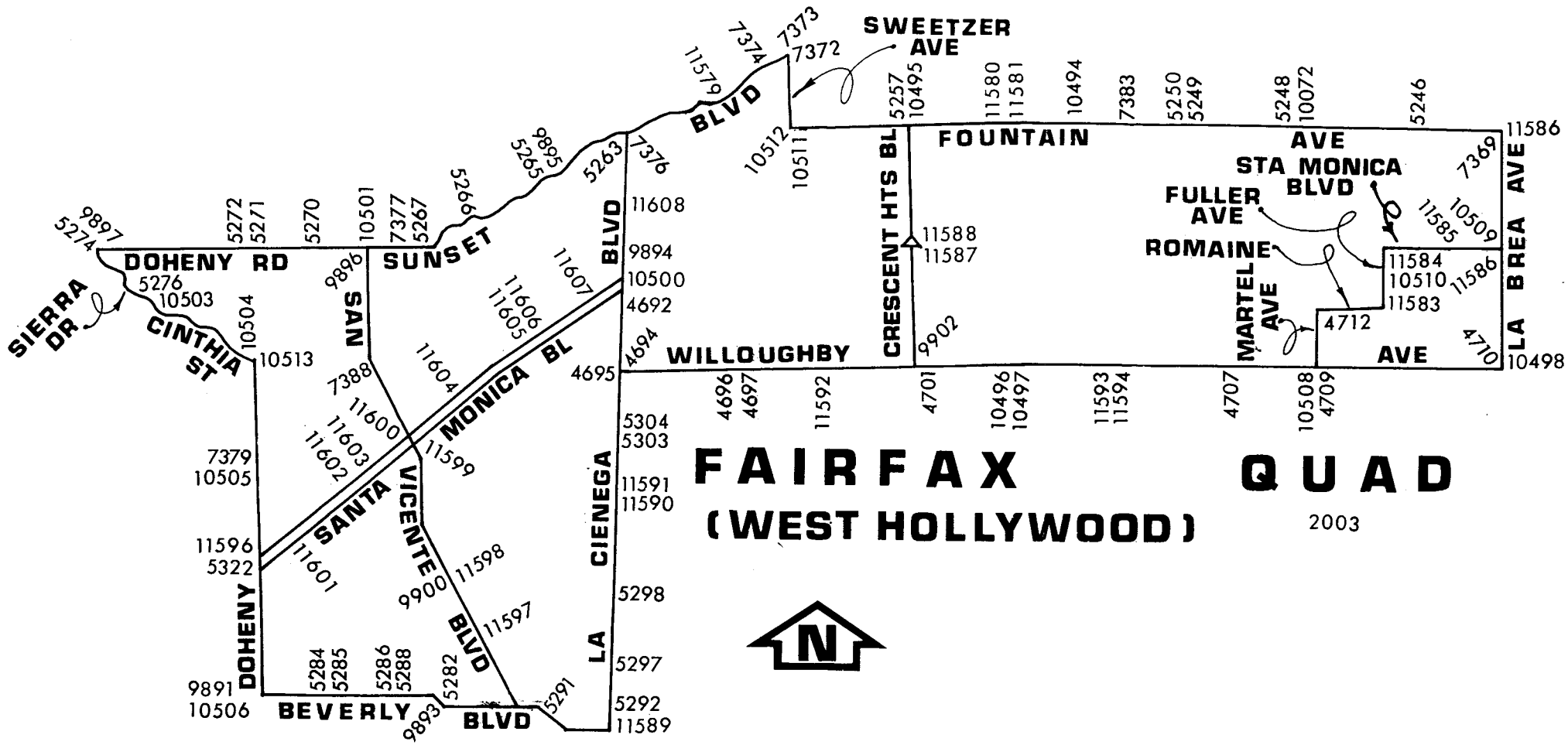

QUAD YEAR	ELEV FOOT/METER	DESCRIPTION	BM NUMBER
FAIRFAX (2003)	230.569 70.278	LA CITY SUR MON IN WELL 300MM DN ON C/L LA CIENEGA BLVD & 20M N/O C/L ROMAINE ST MKD (C-2A RESET 1970)	Y 4692
FAIRFAX (2003)	205.911 62.762	FLAT HD SPK IN E CB 2M N/O BCR @ NE COR LA CIENEGA BLVD & WILLOUGHBY AVE 10.5M N & 10M E/O C/L INT	Y 4694
FAIRFAX (2003)	205.273 62.567	WIRE SPK IN S CB 4.5M E/O BCR @ SE COR WILLOUGHBY AVE & LA CIENEGA BLVD 18M E & 4.5M S/O C/L INT	Y 4695
FAIRFAX (2003)	215.624 65.722	L&T IN W CB 1M N/O BCR @ NW COR WILLOUGHBY AVE & ORLANDO AVE 7.5M N & 5.5M W/O C/L INT	Y 4696
FAIRFAX (2003)	214.774 65.463	WIRE SPK IN E CB 1M S/O BCR @ SE COR WILLOUGHBY AVE & ORLANDO AVE 6M S & 6.5M E/O C/L INT	Y 4697
FAIRFAX (2003)	240.888 73.423	L&BN IN S CB 3.5M E/O BCR @ SE COR WILLOUGHBY AVE & CRESCENT HEIGHTS BLVD 15M E & 4.5M S/O C/L INT	Y 4701
FAIRFAX (2003)	263.659 80.364	WIRE SPK IN N CB 2M E/O BCR @ NE COR SIERRA BONITA AVE & WILLOUGHBY AVE 10M E & 4.5M N/O C/L INT	Y 4707
FAIRFAX (2003)	259.627 79.135	BT SPK IN E CB 1M S/O BCR @ SE COR WILLOUGHBY AVE & MARTEL AVE 10.5M S & 4.5M E/O C/L INT	Y 4709
FAIRFAX (2003)	271.174 82.654	WIRE SPK IN W CB 3M N/O BCR @ NW COR WILLOUGHBY AVE & LA BREA AVE 15M N & 12M W/O C/L INT	Y 4710
FAIRFAX (2003)	275.188 83.878	WIRE SPK IN W CB MARTEL AVE @ C/L PROD ROMAINE ST (FR E)	Y 4712
FAIRFAX (2003)	313.864 95.666	RDBM TAG IN W CB 17M N/O BCR @ NW COR ALTA VISTA BLVD & FOUNTAIN AVE 29M N & 6M W/O C/L INT	Y 5246
FAIRFAX (2003)	320.847 97.794	RDBM TAG IN W CB 27M N/O BCR @ NW COR VISTA ST & FOUNTAIN AVE 41M N & 5M W/O C/L INT	Y 5248
FAIRFAX (2003)	332.243 101.268	RDBM TAG IN E CB 32M N/O BCR @ NE COR FOUNTAIN AVE & CURSON AVE 44M N & 4M E/O C/L INT	Y 5249
FAIRFAX (2003)	332.247 101.269	RDBM TAG IN W CB 33.5M N/O BCR @ NW COR FOUNTAIN AVE & CURSON AVE 45.5M N & 4M W/O C/L INT	Y 5250
FAIRFAX (2003)	342.978 104.540	RDBM TAG IN W CB 9M S/O BCR @ SW COR FOUNTAIN AVE & CRESCENT HEIGHTS BLVD 24M S & 32FT11M W/O C/L INT	Y 5257
FAIRFAX (2003)	412.010 125.581	CUT SPK IN S CB MILLER DR 600MM W/O BCR & 38.5M W/O C/L PROD LA CIENEGA BLVD @ E END C B (N/O SUNSET BLVD)	Y 5263
FAIRFAX (2003)	387.093 117.986	L&BN IN W CB SUNSET PLAZA DR 9M W/O C/L & 30.5M N/O C/L SUNSET BLVD @ N END C B	Y 5265
FAIRFAX (2003)	362.506 110.492	CUT SPK IN N CB 1.5M E/O BCR @ NE COR SUNSET BLVD & SHERBOURN DR 10.5M N & 12.5M E/O C/L INT @ W END C B	Y 5266
FAIRFAX (2003)	345.559 105.327	CUT SPK IN N CB 1.5M W/O BCR @ NW COR SUNSET BLVD & HORN AVE 10.5M N & 13M W/O C/L INT @ E END C B	Y 5267

QUAD YEAR	ELEV FOOT/METER	DESCRIPTION	BM NUMBER
FAIRFAX (2003)	378.499 115.367	WIRE SPK IN E CB 1.5M N/O BCR @ NE COR SUNSET BLVD & HILLDALE AVE 18M N & 5M E/O C/L INT @ S END C B	Y 5270
FAIRFAX (2003)	413.511 126.039	CUT SPK IN W CB 15.5M N/O BCR @ NW COR SUNSET BLVD & DOHENY DR 32M N & 6M W/O C/L INT @ S END C B	Y 5271
FAIRFAX (2003)	408.773 124.594	CUT SPK IN N CB 1.5M W/O BCR @ NW COR SUNSET BLVD & DOHENY DR 14.5M W & 10.5M N/O C/L INT MKD (BM)	Y 5272
FAIRFAX (2003)	458.077 139.622	L&BR NR MCR @ SW COR DOHENY RD & SIERRA PL 10M S & 10.5M W/O C/L INT	Y 5274
FAIRFAX (2003)	401.629 122.417	CUT SPK IN N CB SUNSET BLVD 13M N/O C/L & 61.5M E/O C/L SIERRA DR (TO THE N) @ W END C B	Y 5276
FAIRFAX (2003)	201.585 61.443	SPK&W IN E CB 3M S/O BCR @ SE COR WETHERLY DR & BEVERLY BLVD & 21.5M S & 4.5M E/O C/L INT	Y 5284
FAIRFAX (2003)	196.008 59.743	L&N IN N CB @ BCR NW COR BEVERLY BLVD & ALMONT DR 10.5M N & 10.5M W/O C/L INT MKD (BM)	Y 5285
FAIRFAX (2003)	187.304 57.090	WIRE SPK IN S CB BEVERLY BLVD 5M W/O W P/L SWALL DR 10.5M S & 13.5M W/O C/L INT @ E END C B	Y 5286
FAIRFAX (2003)	183.859 56.040	LACE HEX MON IN WELL 200MM DN ON C/L BEVERLY BLVD & 43.5M E/O C/L SWALL DR	Y 5288
FAIRFAX (2003)	170.189 51.874	LA CITY HEX MON IN WELL ON C/L BEVERLY BLVD 76M W/O W CB LINE SHERBOURNE DR 81M W/O C/L INT MKD (LA 13-14750)	Y 5289
FAIRFAX (2003)	165.630 50.484	CUT SPK IN SE COR C B NR BCR NE COR HUNTLY DR & BEVERLY PL 8.5M N & 6M E/O C/L INT (N/O BEVERLY BLVD)	Y 5291
FAIRFAX (2003)	164.785 50.227	WIRE SPK IN N CB 4M E/O BCR @ NE COR BEVERLY BLVD & LA CIENEGA BLVD (NR W END C B)	Y 5292
FAIRFAX (2003)	170.804 52.061	CUT SPK IN SE COR C B 1.5M N/O BCR @ NE COR LA CIENEGA BLVD & OAKWOOD ST 11.5M E & 6M N/O C/L INT	Y 5297
FAIRFAX (2003)	176.941 53.932	WIRE SPK IN E END C B 1.5M E/O BCR @ SE COR LA CIENEGA BLVD & ROSEWOOD AVE 15M E/O & 4.5M S/O C/L INT MKD (BM)	Y 5298
FAIRFAX (2003)	189.422 57.736	CUT SPK IN NW COR C B 1M E/O BCR @ NE COR LA CIENEGA BLVD & MELROSE PL 15.5M E & 8.5M N/O C/L INT	Y 5303
FAIRFAX (2003)	195.556 59.606	WIRE SPK IN E CB 1.5M N/O BCR @ NE COR LA CIENEGA BLVD & WARING AVE 11M N & 10.5M E/O C/L INT @ S END C B MKD (BM)	Y 5304
FAIRFAX (2003)	229.003 69.800	CUT SPK N CB SANTA MONICA BLVD (N BARREL) 14M N/O C/L & 25 .5M W/O C/L DOHENY DR @ E END C B	Y 5322
FAIRFAX (2003)	311.795 95.035	L&BN IN S CB 3M W/O BCR @ SW COR LA BREA AVE & FOUNTAIN AVE 18M W & 8M S/O C/L INT	Y 7369
FAIRFAX (2003)	390.910 119.150	CSBM MON IN NW COR C B 1M E/O BCR @ NE COR SUNSET BLVD & SWEETZER AVE 11M N & 7.5M E/O C/L INT MKD (BM 62-6 1962 RE 5869)	Y 7372

QUAD YEAR	ELEV FOOT/METER	DESCRIPTION	BM NUMBER
FAIRFAX (2003)	390.984 119.172	WIRE SPK IN N CB SUNSET BLVD 3M E/O BCR 9M N/O C/L & 10.5M E/O C/L SWEETZER AVE (@ E END C B)	Y 7373
FAIRFAX (2003)	389.861 118.830	WIRE SPK IN N CB SUNSET BLVD 1.5M W/O BCR @ NW COR SUNSET BLVD & SWEETZER AVE 9M N & 9.5M W/O C/L INT	Y 7374
FAIRFAX (2003)	407.327 124.154	L&BN IN S CB SUNSET BLVD 3M E/O BCR 10M S/O C/L & 13.5M E/O C/L LA CIENEGA BLVD	Y 7376
FAIRFAX (2003)	345.897 105.430	USGS DISC IN B/W @ ENT TO BLDG #8820 SUNSET BLVD 24M W/O W CB HORN ST PROD & 14.5M S/O C/L SUNSET BLVD MKD (6-1922)	Y 7377
FAIRFAX (2003)	265.134 80.813	WIRE SPK IN E CB DOHENY DR 600MM S/O BCR @ SE COR ELEVADO AVE 6M E & 6.5M S/O C/L INT	Y 7379
FAIRFAX (2003)	336.651 102.612	L&BN IN E CB 12.5M N/O BCR @ NE COR FOUNTAIN AVE & SPAULDING AVE 28.5M N & 5M E/O C/L INT	Y 7383
FAIRFAX (2003)	278.223 84.803	L&T IN N CB 6M W/O BCR @ NW COR CYNTHIA ST & SAN VICENTE BLVD 29M W & 5.5M N/O C/L INT	Y 7388
FAIRFAX (2003)	210.765 64.241	L&N IN W CB 1M N/O BCR @ NW COR DOHENY DR & BEVERLY BLVD 16 .5M N & 7.5M W/O C/L INT	Y 9891
FAIRFAX (2003)	169.614 51.699	WIRE SPK IN E END C B 1M W/O BCR @ NW COR BEVERLY BLVD & SHERBOURNE DR 10.5M N & 28.5M W/O C/L INT MKD (LA 13-14740)	Y 9893
FAIRFAX (2003)	244.799 74.615	WIRE SPK IN S END C B 20.5M N/O BCR @ NW COR LA CIENEGA BLVD & SANTA MONICA BLVD 46.5M N & 10M W/O C/L INT	Y 9894
FAIRFAX (2003)	384.402 117.166	RDBM TAG IN N CB SUNSET BLVD 300MM E/O BCR 13M N/O C/L & 25M E/O C/L SUNSET PLAZA DR	Y 9895
FAIRFAX (2003)	357.576 108.989	L&T IN E CB 2M S/O BCR @ SE COR SUNSET BLVD & SAN VICENTE BLVD 20.5M S & 15M E/O C/L INT MKD (BM)	Y 9896
FAIRFAX (2003)	453.129 138.114	RD BM TAG IN S CB 300MM E/O BCR @ SE COR DOHENY DR & SIERRA PL 6.5M S/O & 24.5M E/O C/L INT	Y 9897
FAIRFAX (2003)	179.762 54.792	RD BM TAG IN W CB @ BCR @ NW COR SAN VICENTE BLVD & MELROSE AVE 14M W & 21M N/O C/L INT (S END C B)	Y 9900
FAIRFAX (2003)	242.974 74.059	L&SPK IN E CB 3M N/O BCR @ NE COR WILLOUGHBY AVE & CRESCENT HEIGHTS BLVD 14M N & 6.5M E/O C/L INT	Y 9902
FAIRFAX (2003)	316.824 96.568	BT SPK IN S CB 1.5M E/O BCR @ SE COR FOUNTAIN AVE & VISTA ST 12M E & 6M S/O C/L INT	Y 10072
FAIRFAX (2003)	337.598 102.900	L&SPK IN E CB 2M N/O BCR @ NE COR FOUNTAIN AVE & GENESEE AVE 17.5M N & 5M E/O C/L INT (@ N END CB)	Y 10494
FAIRFAX (2003)	349.602 106.559	DPW BM TAG IN E CB 2.5M N/O BCR @ NE COR CRESCENT HEIGHTS BLVD & FOUNTAIN AVE 18M N & 10.5M E/O C/L INT (@ N END C B)	Y 10495
FAIRFAX (2003)	256.307 78.123	SPK IN S CB 3M W/O BCR @ SW COR WILLOUGHBY AVE & FAIRFAX AVE 23M W & 4.5M S/O C/L INT	Y 10496
FAIRFAX (2003)	258.144 78.683	LA CITY DISK 8M N/O BCR 600MM W/O CF @ NW COR WILLOUGHBY AVE & FAIRFAX AVE 20M N & 14.5M W/O C/L INT MKD (13-15372 1970)	Y 10497

QUAD YEAR	ELEV FOOT/METER	DESCRIPTION	BM NUMBER
FAIRFAX (2003)	271.503 82.754	DPW BM TAG IN N CB 300MM E/O BCR @ NE COR LA BREA AVE & WILLOUGHBY AVE 15M E & 6M N/O C/L INT	Y 10498
FAIRFAX (2003)	243.778 74.304	DPW BM TAG IN E CB 8M N/O BCR @ NE COR SANTA MONICA BLVD (N BARREL) & LA CIENEGA BLVD 32M N & 10.5M E/O C/L INT	Y 10500
FAIRFAX (2003)	364.139 110.990	DPW BM TAG IN E CB 1.5M N/O BCR @ NE COR SUNSET BLVD & CLARK ST 17.5M N & 5.5M E/O C/L INT	Y 10501
FAIRFAX (2003)	399.081 121.640	DPW BM TAG IN S CB SUNSET BLVD 3M E/O BCR 13M S/O C/L & 64M E/O C/L SIERRA DR (N)	Y 10503
FAIRFAX (2003)	310.824 94.739	DPW BM TAG IN S CB 5.5M W/O BCR @ SW COR DOHENY DR & CINTHIA ST 22.5M W & 5M S/O C/L INT	Y 10504
FAIRFAX (2003)	257.882 78.603	DPW BM TAG IN E CB 600MM N/O BCR @ NE COR DOHENY DR & LLOYD PL 9M N & 7.5M E/O C/L INT	Y 10505
FAIRFAX (2003)	209.867 63.968	DPW BM TAG IN S CB 300MM E/O BCR @ SE COR DOHENY DR & BEVERLY BLVD 15M E & 10.5M S/O C/L INT	Y 10506
FAIRFAX (2003)	260.640 79.443	DPW BM TAG IN E CB 1M N/O BCR @ NE COR WILLOUGHBY AVE & MARTEL AVE 10M N & 4.5M E/O C/L INT	Y 10508
FAIRFAX (2003)	288.991 88.085	DPW BM TAG IN E CB 9M N/O BCR @ NE COR SANTA MONICA BLVD & LA BREA AVE 22.5M N & 10.5M E/O C/L INT	Y 10509
FAIRFAX (2003)	283.890 86.530	DPW BM TAG IN E CB 300MM S/O BCR @ SE COR SANTA MONICA BLVD & FULLER AVE 13M S & 5.5M E/O C/L INT	Y 10510
FAIRFAX (2003)	317.542 96.787	DPW BM TAG IN S CB 300MM E/O BCR @ SE COR SWEETZER AVE & FOUNTAIN AVE 13.5M E & 8.5M S/O C/L INT	Y 10511
FAIRFAX (2003)	318.613 97.114	DPW BM TAG IN W CB 3M N/O BCR @ NW COR SWEETZER AVE & FOUNTAIN AVE 14.5M N & 5.5M W/O C/L INT (@ S END C B)	Y 10512
FAIRFAX (2003)	314.971 96.003	L&SPK IN SE COR C B 2M N/O BCR @ NW COR DOHENY DR & CINTHIA ST 19M N & 7.5M W/O C/L INT	Y 10513
FAIRFAX (2003)	395.018 120.402	CITY LA DISK IN NW COR C B 3M W/O BCR @ NW COR SUNSET BLVD & KINGS RD 10.5M N & 13.5M W/O C/L INT MKD (13-16591 PBM 1987)	Y 11579
FAIRFAX (2003)	342.730 104.464	CITY LA DISK IN N END C B 6M N/O BCR @ NE COR FOUNTAIN AVE & FAIRFAX AVE 22.5M N & 12M E/O C/L INT MKD (13-04531 1970)	Y 11580
FAIRFAX (2003)	337.572 102.892	LA CITY TAG IN E CB 6.5M S/O BCXR @ SE COR FOUNTAIN AVE & FAIRFAX AVE 19M S & 11M E/O C/L INT	Y 11581
FAIRFAX (2003)	313.919 95.683	WIRE SPK IN E CB 2M N/O BCR @ NE COR FOUNTAIN AVE & LA BREA AVE 16M N & 10.5M E/O C/L INT	Y 11582
FAIRFAX (2003)	273.419 83.338	LACO BM TAG IN E CB 1M N/O BCR @ NE COR FULLER AVE & ROMAINE ST 13M N & 6M E/O C/L INT	Y 11583
FAIRFAX (2003)	284.652 86.762	CITY LA DISK 1M S/O CF 1.5M W/O BCR @ SW COR SANTA MONICA BLVD & FULLER AVE 9.5M S & 14.5M W/O C/L INT MKD (13-15373 2002)	Y 11584

QUAD YEAR	ELEV FOOT/METER	DESCRIPTION	BM NUMBER
FAIRFAX (2003)	283.450 86.396	CITY LA DISK 1M S/O CF 6.5M E/O BCR @ SE COR SANTA MONICA BLVD & FORMOSA AVE 16M E & 9.5M S/O C/L INT MKD (13-15306 2002)	Y 11585
FAIRFAX (2003)	288.803 88.027	LACO BM TAG IN N CB 1M W/O BCR @ NW COR SANTA MONICA BLVD & LA BREA AVE 16M W & 9.5M N/O C/L INT	Y 11586
FAIRFAX (2003)	283.650 86.457	WIRE SPK IN N CB 1M E/O BCR @ NE COR CRESCENT HEIGHTS BLVD & SANTA MONICA BLVD 18M E & 9M N/O C/L INT	Y 11587
FAIRFAX (2003)	283.022 86.265	LACO BM TAG IN N CB 1M W/O BCR @ NW COR CRESCENT HEIGHTS BLVD & SANTA MONICA BLVD 17.5M W & 9M N/O C/L INT	Y 11588
FAIRFAX (2003)	163.842 49.939	LACO BM TAG IN E CB 1M S/O BCR @ SE COR BEVERLY BLVD & LA CIENEGA BLVD 21.5M S & 12M E/O C/L INT	Y 11589
FAIRFAX (2003)	180.873 55.130	LACO BM TAG IN W CB 1M S/O BCR @ SW COR LA CIENEGA BLVD & MELROSE AVE 25M S & 10M W/O C/L INT	Y 11590
FAIRFAX (2003)	182.015 55.478	LACO BM TAG IN E CB 1M N/O BCR @ NE COR LA CIENEGA BLVD & MELROSE AVE 29.5M N & 15M E/O C/L INT	Y 11591
FAIRFAX (2003)	232.576 70.889	BT SPK 450MM E/O CF 4M N/O BCR @ NE COR WILLOUGHBY AVE & HARPER AVE 12M N & 5M E/O C/L INT	Y 11592
FAIRFAX (2003)	261.153 79.600	WIRE SPK IN W CB 3M N/O BCR @ NW COR WILLOUGHBY AVE & GENESEE AVE 12M N & 5M W/O C/L INT (@ E END C B)	Y 11593
FAIRFAX (2003)	260.755 79.478	LACO BM TAG IN S CB 5M E/O BCR @ SE COR WILLOUGHBY AVE & GENESEE AVE 13M E & 5M S/O C/L INT (@ E END C B)	Y 11594
FAIRFAX (2003)	260.341 79.352	BT SPK IN E CB 600MM S/O BCR @ SE COR WILLOUGHBY AVE & ALTA VISTA BLVD 7M S & 5M E/O C/L INT	Y 11595
FAIRFAX (2003)	224.702 68.489	LACO BM TAG IN W CB DOHENY DR 1M S/O BCR 7M W/O C/L & 29M S/O C/L SANTA MONICA BLVD (S BARREL)	Y 11596
FAIRFAX (2003)	169.851 51.771	L&PK NAIL IN W CB SAN VICENTE BLVD 14M W/O C/L ON C/L PROD ROSEWOOD AVE	Y 11597
FAIRFAX (2003)	178.722 54.475	L&T IN N CB MELROSE AVE 300MM E/O BCR 11.5M N/O C/L & 24M E/O C/L SAN VICENTE BLVD	Y 11598
FAIRFAX (2003)	218.487 66.595	LACO BM TAG IN W CB SAN VICENTE BLVD 1M S/O BCR 9.5M W/O C/L & 22M S/O C/L SANTA MONICA BLVD	Y 11599
FAIRFAX (2003)	220.830 67.309	LACO BM TAG IN E CB SAN VICENTE BLVD 1M N/O BCR 9.5M E/O C/L & 24M N/O C/L SANTA MONICA BLVD	Y 11600
FAIRFAX (2003)	227.045 69.204	LA CITY BM DISK IN NW COR C B 3M W/O BCR 15.5M N/O C/L SANTA MONICA BLVD & 11M W/O C/L NEMO ST MKD (13-15931 2003)	Y 11601
FAIRFAX (2003)	226.635 69.079	LA CITY BM DISK IN N CB SANTA MONICA BLVD 14M N/O C/L & 87M W/O C/L ROBERTSON BLVD 10M W/O C/L DRWY TO BLDG #8969 MKD (13-15911 2003)	Y 11602
FAIRFAX (2003)	223.693 68.182	LA CITY BM DISK IN E END C B 1.5M W/O BCR 11.5M N/O C/L SANTA MONICA BLVD & 10M W/O C/L HILLDALE AVE MKD (113-15891 2003)	Y 11603

QUAD YEAR	ELEV FOOT/METER	DESCRIPTION	BM NUMBER
FAIRFAX (2003)	212.001 64.618	LA CITY BM DISK IN N CB SANTA MONICA BLVD 3M W/O BCR 14M N/O C/L & 15.5M W/O C/L HANCOCK AVE W END C B MKD (13-15831 2003)	Y 11604
FAIRFAX (2003)	218.870 66.712	LA CITY BM DISK IN N CB SANTA MONICA BLVD 1M E/O BCR 14M N/O C/L & 14.5M E/O C/L WESTBOURNE DR MKD (13-15813 2003)	Y 11605
FAIRFAX (2003)	217.212 66.206	LACO BM TAG IN S CB SANTA MONICA BLVD 1.5M W/O BCR 14M S/O C/L & 15M W/O C/L WESTBOURNE DR	Y 11606
FAIRFAX (2003)	239.567 73.020	LA CITY BM DISK 1M N/O N CB SANTA MONICA BLVD 15.5M N/O C/L & 11.5M E/O C/L WEST KNOLL DR MKD (13-15793 2003)	Y 11607
FAIRFAX (2003)	310.408 94.613	BT SPK E CB 6.5M S/O BCR @ SE COR LA CIENEGA BLVD & FOUNTAIN AVE 32M S & 12M E/O C/L INT (S END C B)	Y 11608