

**LOS ANGELES COUNTY
DEPARTMENT OF PUBLIC WORKS**

BENCH MARK LIST



PALOS VERDES QUAD

**2005 ADJUSTMENT
2005 BASELINE
NAVD 88 DATUM**

PREFACE

The Department of Public Works level net is composed of more than 1,700 miles or 2720 kilometers of levels supporting in excess of 9,000 bench marks. Previously when a major readjustment of the net was undertaken, to emphasize the complete break with previous elevations, the CY, CG, & CL, series bench marks were re-labeled DY, DG, & DL, respectively. Beginning in 1993 the baseline readjustment year will be indicated on baseline BM, s only indicated below (*). Henceforth all BM numbers will be labeled as a Y, G, or L, series that will no longer indicate the major adjustment year.

To facilitate the adjustment, indexing and distribution of adjusted values of the net, the county territory was divided into 33 quads or areas. For the identification purposes each quad was given a name, viz., "Rosemead," "La Mirada," "Santa Fe," etc. When bench marks and elevations in these quads are used, the name must be included in the bench mark description, e.g.,

* BASELINE 90.057 L&BR IN CTR OF CB RET @ NE COR Y 9191
(1990) 295.461 LA HABRA BLVD & VALLEY HOME AVE
10.7M N & 10.7M E/O C/L INT

It is expected that this general adjustment will for the most part remain sound for 8 to 12 years. Updating constrained adjustments will continue in the future. When a quad is readjusted, new elevations will be published and the date of readjustment will be noted in the bench mark description. Two bench marks with different adjustment dates will not normally agree with each other.

The basic accuracy of the net is reflected by an indicated field probable error of plus or minus 4mm per kilometer of leveling as determined from the conditions of closure. However, many years of experience in vertical control in the greater Los Angeles basin and Antelope Valley indicate that because of varying degrees of subsidence and heaving, the true datum is recovered only by obtaining substantial agreement of a number of bench marks.

The users of this net are invited to assist in its maintenance by notifying this department of cases of obliteration, apparent mistakes in description or elevations, and proven disturbance of bench marks.

DATUM: North American Vertical Datum of 1988 (NAVD88)

Note: NAVD 1988 minus approximately 700mm (2.3ft) equals
Previous NGVD 1929 Datums. For more accurate equations
At individual bench marks refer to previous publications

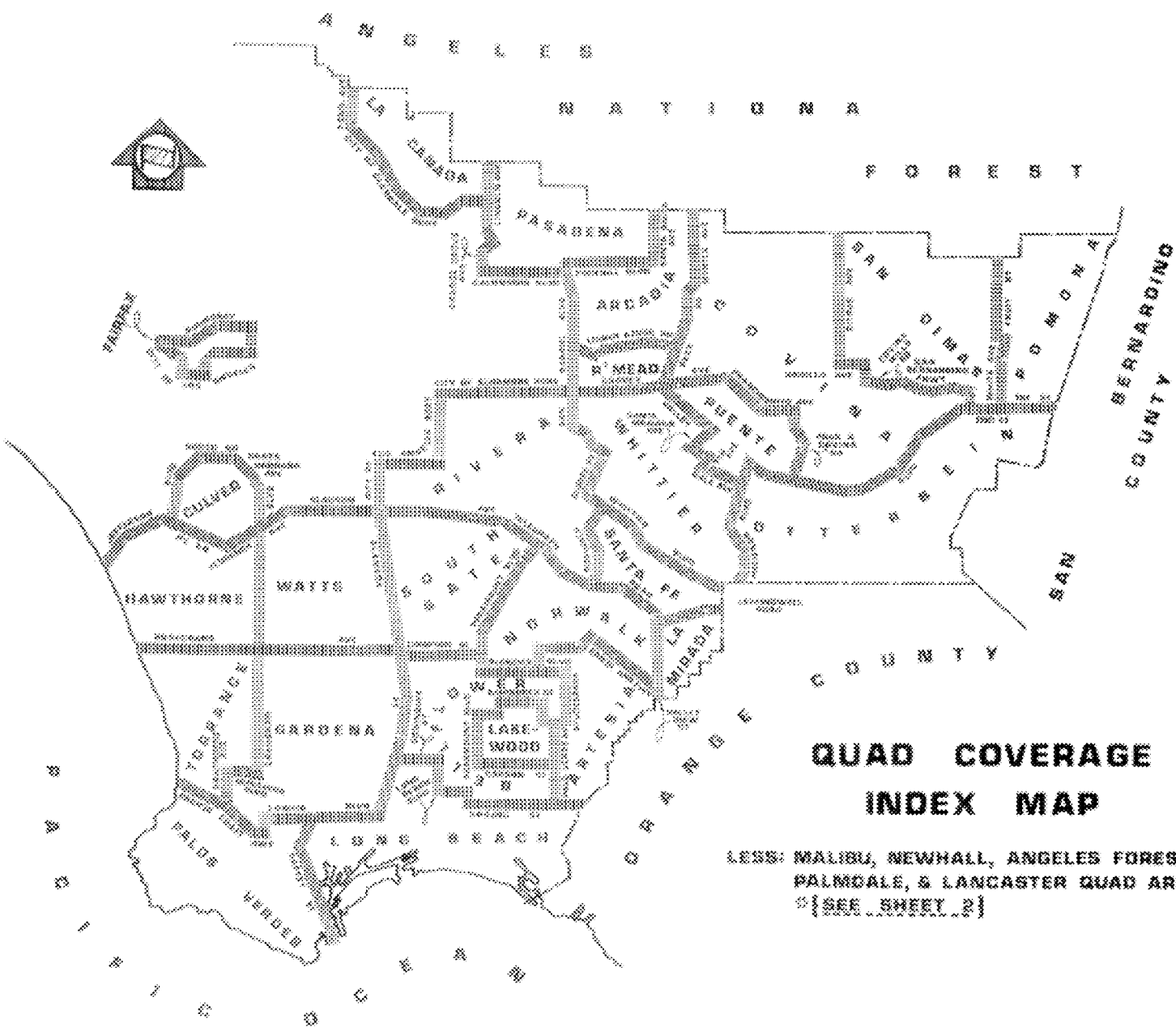

**QUAD COVERAGE
INDEX MAP**

LESS: MALIBU, NEWHALL, ANGELES FOREST,
PALMDALE, & LANCASTER QUAD AREAS.
☉ [SEE SHEET 2]

K E R N C O U N T Y

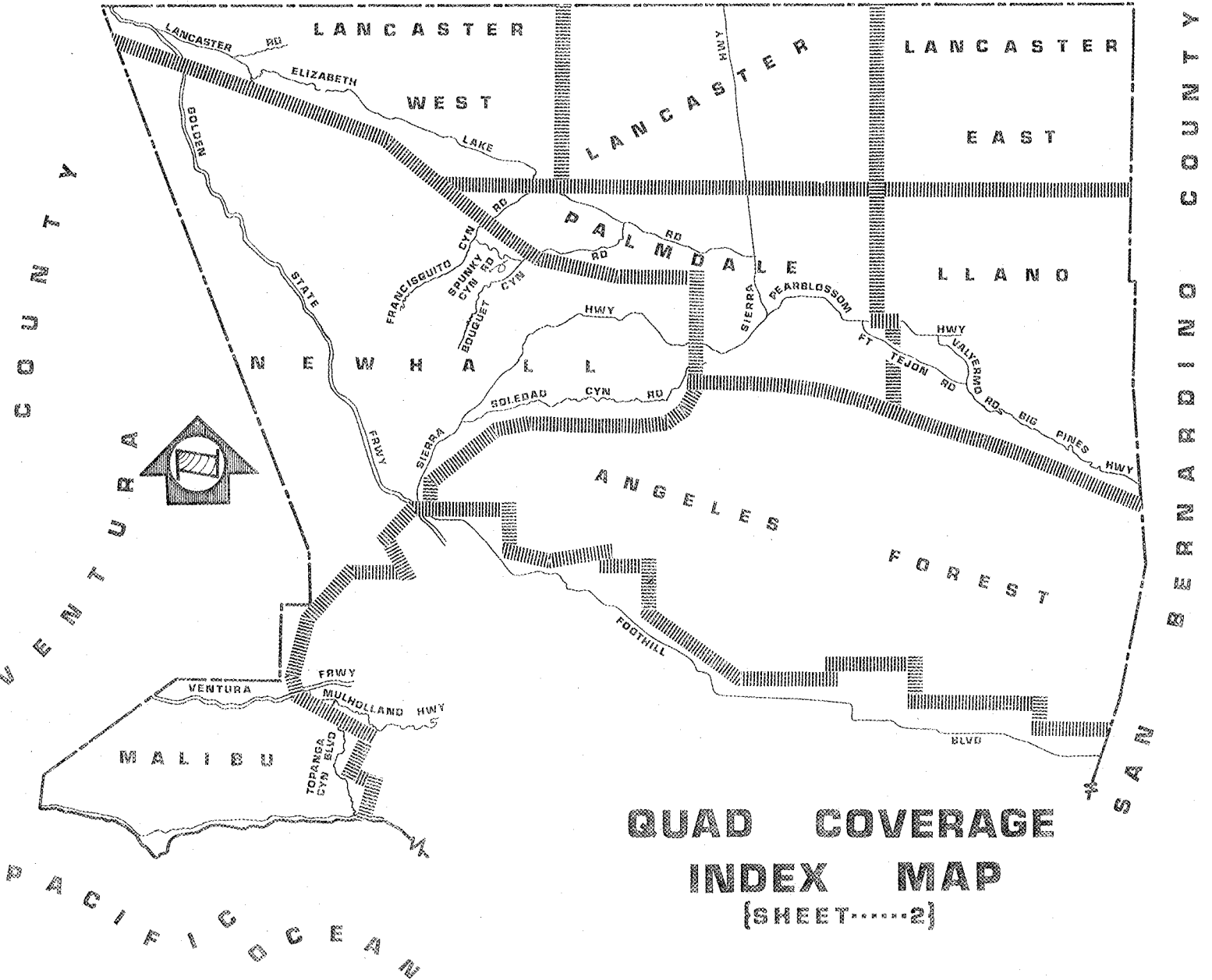

**QUAD COVERAGE
INDEX MAP
(SHEET.....2)**

ABBREVIATIONS USED IN BENCH MARK LISTINGS

ABUT -----	Abutment	LT -----	Left
ALG -----	Along	LACE -----	L.A. City Engineer
ANG PT -----	Angle Point	LACS -----	L.A. Co. Engineer
B/W -----	Back of Walk	LAFC -----	L.A. Co. Flood Control
BCR -----	Beginning of Curb Return	L&BN -----	Lead and Bench Nail
BC -----	Beginning of Curve	L&BR -----	Lead and Brad
BLDG -----	Building	L&N -----	Lead and Nail
BM -----	Bench Mark	L&SPK -----	Lead and Spike
BT SPK -----	Boat or Bolt Spike	L&T -----	Lead and Tack
BR CAP -----	Brass or Bronze Cap	MCR -----	Middle of Curb Return
C B -----	Catch Basin	MKD -----	Marked
CTR -----	Center	MC -----	Middle of Curve
C/L -----	Center Line	MON -----	Monument
C/L INT -----	Center Line Intersection	N/O -----	North of
C/L PROD ---	Center Line Produced	NR -----	Near
CONC -----	Concrete	OPP -----	Opposite
COR -----	Corner	PI -----	Point of Intersection
COE -----	Corps of Engineers	PK&W -----	PK Nail and Washer
CULV -----	Culvert	P/L -----	Property Line
CYN -----	Canyon	POST -----	Point of Semi-Tangent
CB -----	Curb	PP -----	Power Pole
CS MON -----	Co. Eng. Monument	PVMT -----	Pavement
CT SPK -----	Cut Spike	PROD -----	Produced
DPW -----	Dept. of Public Works	RD -----	Road
DR -----	Drive or Driveway	RDBM -----	Road Dept. Bench Mark
E/O -----	East of	RDBM TAG -----	Road Dept. Bench Mark Tag
ECR -----	End of Curb Return	RR -----	Railroad
EC -----	End of Curve	RT -----	Right
ENT -----	Entrance	R/W -----	Right of Way
FL -----	Floor	SDMH -----	Storm Drain Manhole
FTG -----	Footing	SMH -----	Sewer Manhole
FRWY -----	Freeway	SPK -----	Spike
F/W -----	Front of Walk	ST&W -----	Spike Tin and Washer
GAR -----	Garage	S/O -----	South of
HDWL -----	Headwall	TP -----	Telephone Pole
HSE -----	House	USC&GS -----	U.S. Coast and Geodetic Survey
HWY -----	Highway	USGS -----	U.S. Geological Survey
INT -----	Intersection	WK -----	Walk
IP -----	Iron Pipe	W/O -----	West of

PALOS VERDES QUAD INDEX

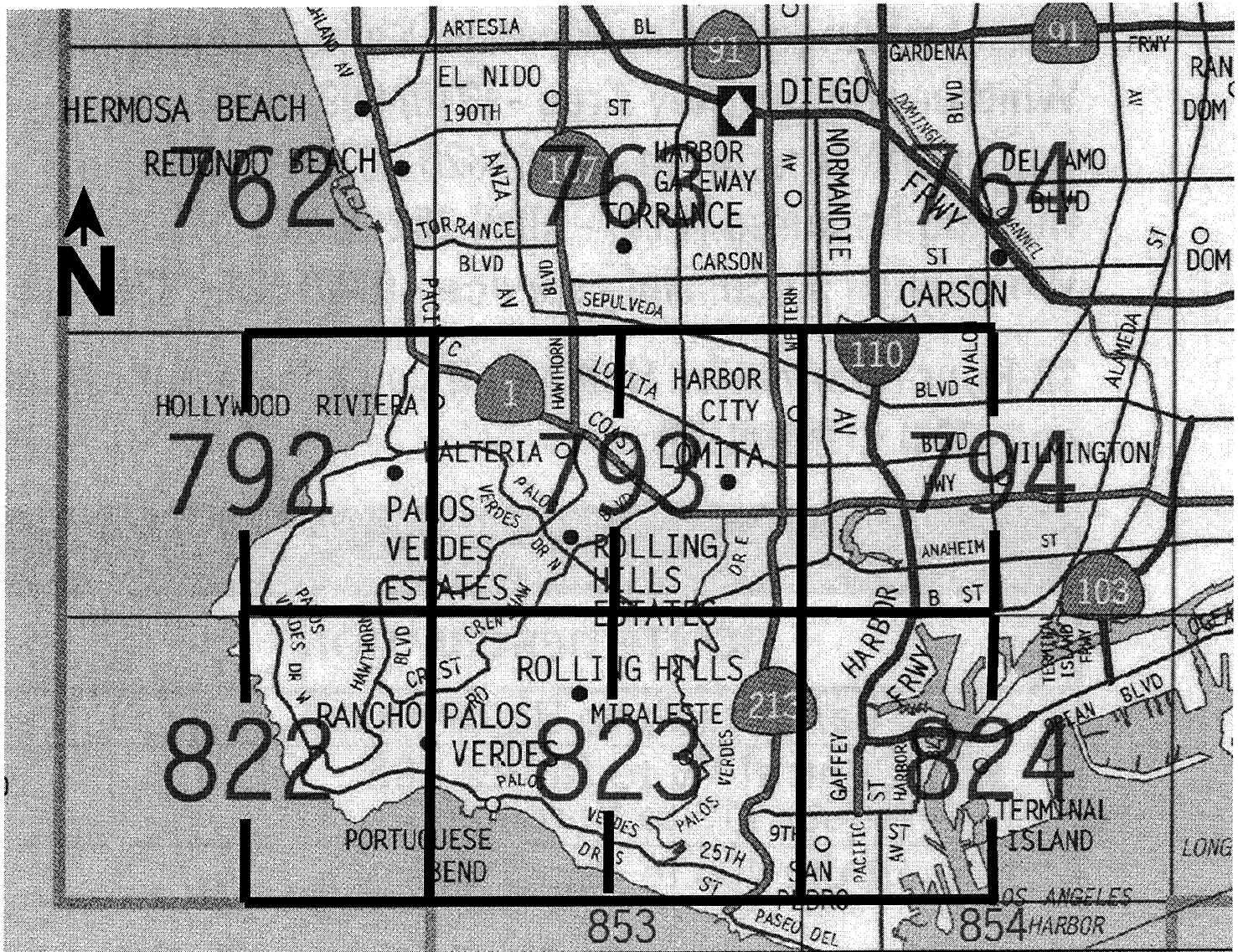

NUMBERS REFER TO THOMAS BROS PAGE NUMBERS

EACH THOMAS BROS PAGE IS DIVIDED INTO TWO INDEX PAGES EAST AND WEST

MAP 792 EAST
PALOS VERDES QUAD

OCEAN

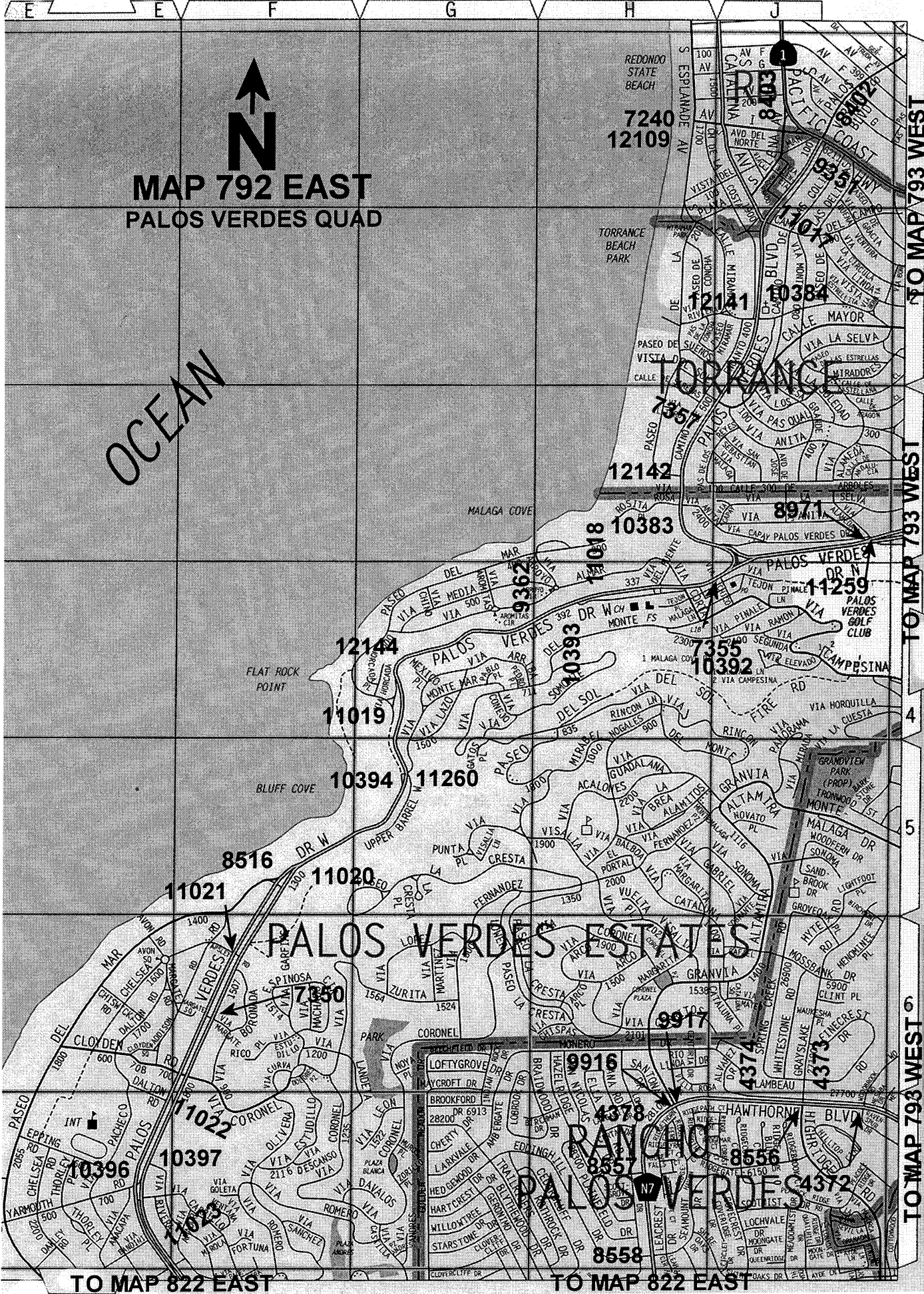

TO MAP 822 EAST

TO MAP 822 EAST

TO MAP 793 WEST

TO MAP 793 WEST

TO MAP 793 WEST

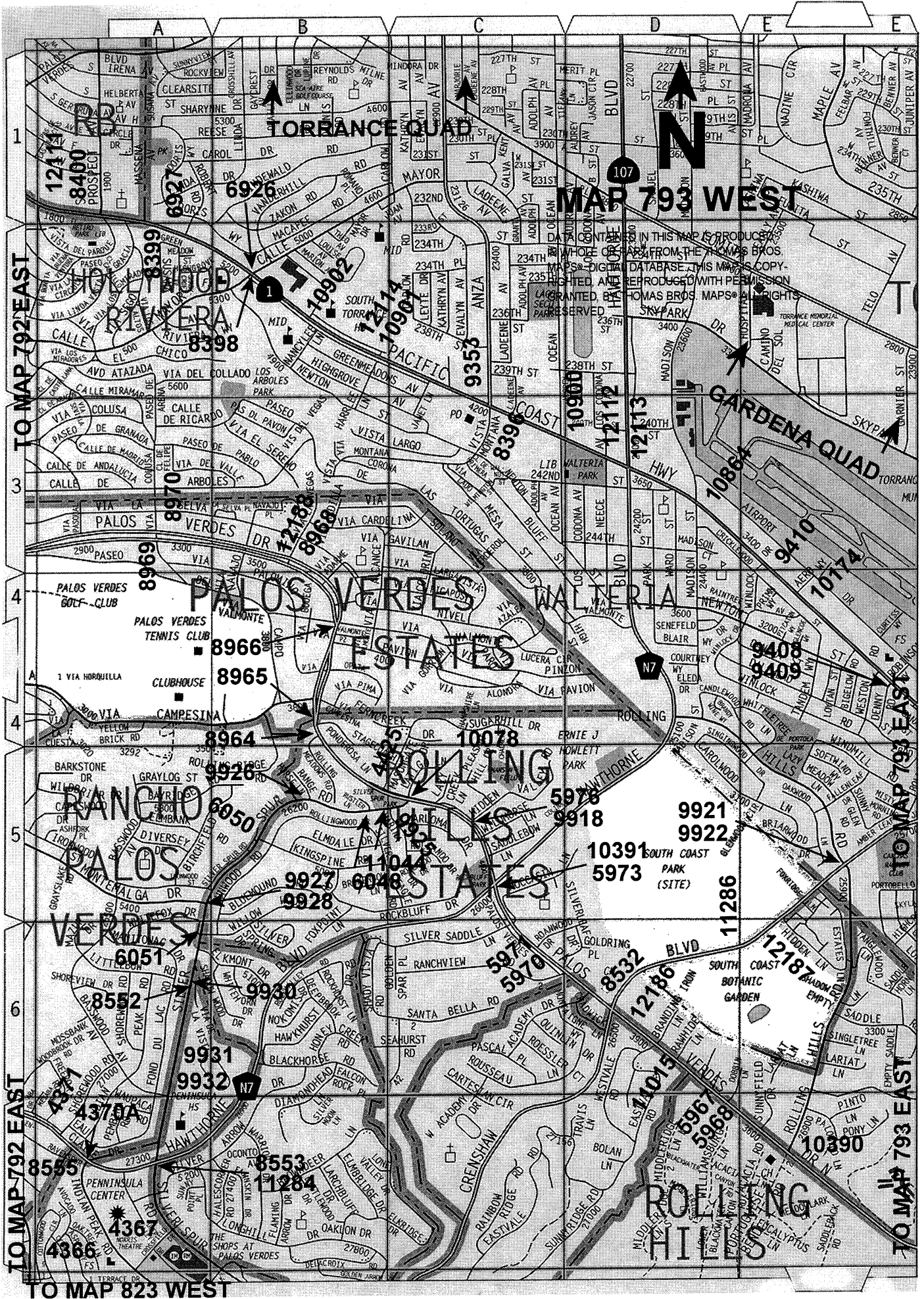

TORRANCE QUAD

MAP 793 WEST

ROLLING HILLS

TO MAP 792 EAST

TO MAP 792 EAST

TO MAP 823 WEST

TO MAP 793 EAST

TO MAP 793 EAST

12414
8400
PROSPECT

8399
RIVERA

8398
RIVERA

19902

15114

10904

9355

10900

12112

12113

8396

10900

12112

12113

10900

12112

8969

8970

2188

8968

8966

8965

8964

10078

5978

9918

9921

9922

10391

5973

11286

12187

12188

6050

9928

9927

6048

9928

1044

5978

9918

9921

9922

10391

5973

11286

12187

12188

8552

9931

9932

8553

11284

5978

5978

9918

9921

9922

10391

5973

11286

12187

12188

8555

4367

4366

8553

11284

5978

5978

9918

9921

9922

10391

5973

11286

12187

12188

10390

10390

TO MAP 792 EAST

TO MAP 792 EAST

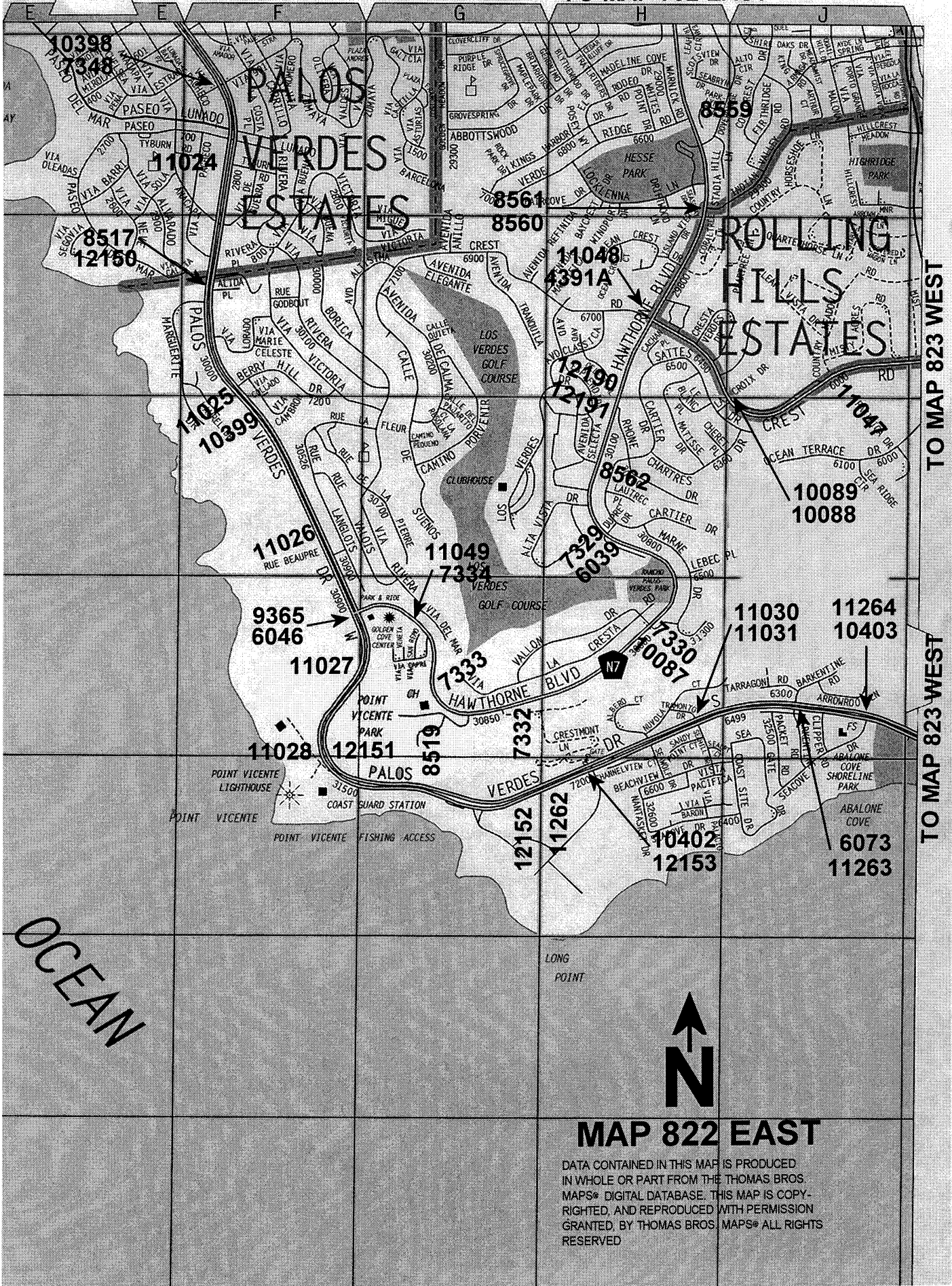

OCEAN



MAP 822 EAST

DATA CONTAINED IN THIS MAP IS PRODUCED IN WHOLE OR PART FROM THE THOMAS BROS. MAPS® DIGITAL DATABASE. THIS MAP IS COPYRIGHTED, AND REPRODUCED WITH PERMISSION GRANTED, BY THOMAS BROS. MAPS® ALL RIGHTS RESERVED

TO MAP 823 WEST

TO MAP 823 WEST

TO MAP 822 EAST

TO MAP 822 EAST

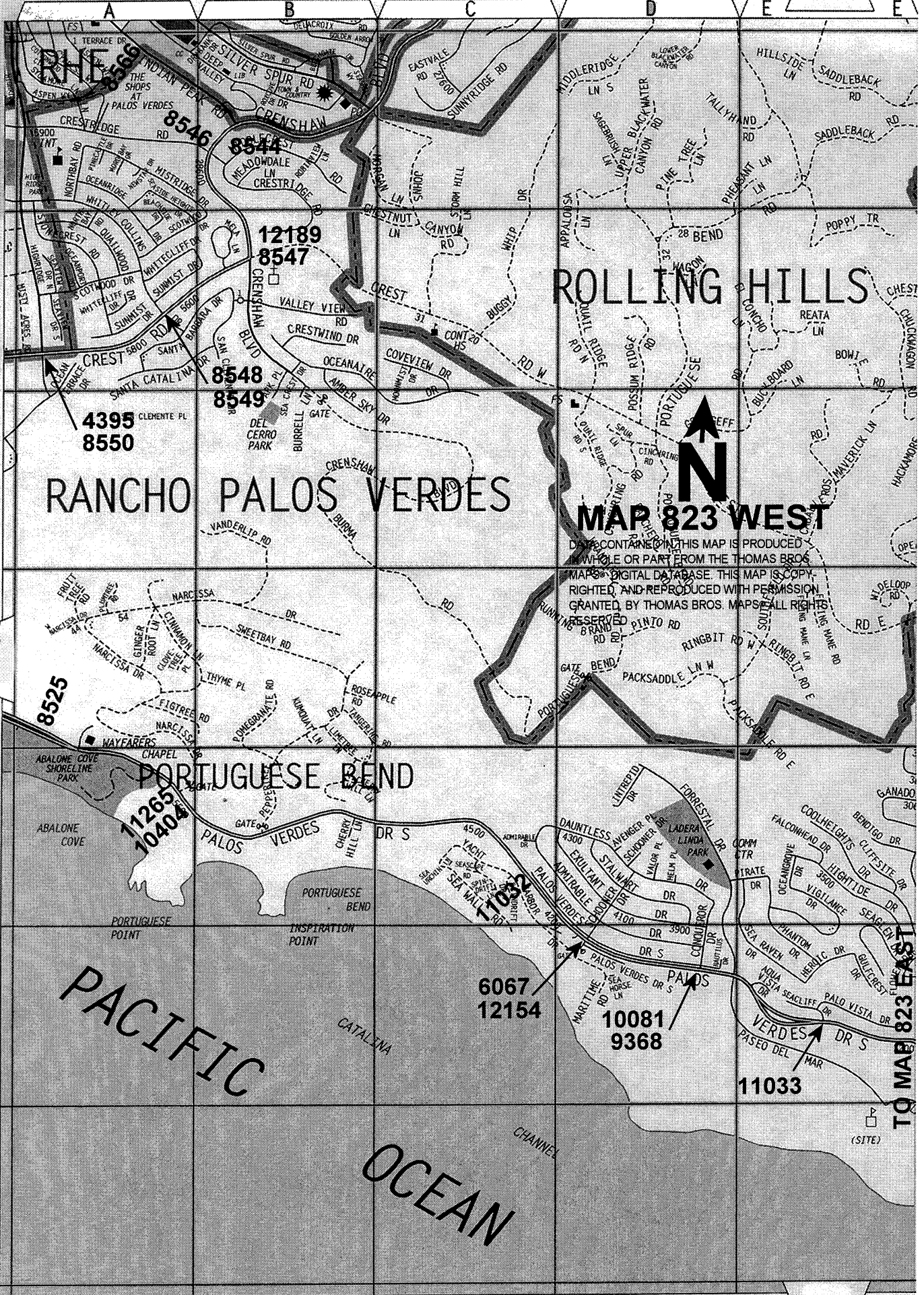

RANCHO PALOS VERDES

ROLLING HILLS

PORTUGUESE BEND

PACIFIC

OCEAN

TO MAP 823 EAST

8569

8546

12189
8547

8548
8549

4395
8550

8525

11265
10404

6067
12154

10081
9368

11033

MAP 823 WEST

THE INFORMATION CONTAINED IN THIS MAP IS PRODUCED WHOLE OR PART FROM THE THOMAS BROS. MAPS DIGITAL DATABASE. THIS MAP IS COPYRIGHTED AND REPRODUCED WITH PERMISSION GRANTED BY THOMAS BROS. MAPS. ALL RIGHTS RESERVED.

(SITE)

TO MAP 794 WEST

C

D

E

F

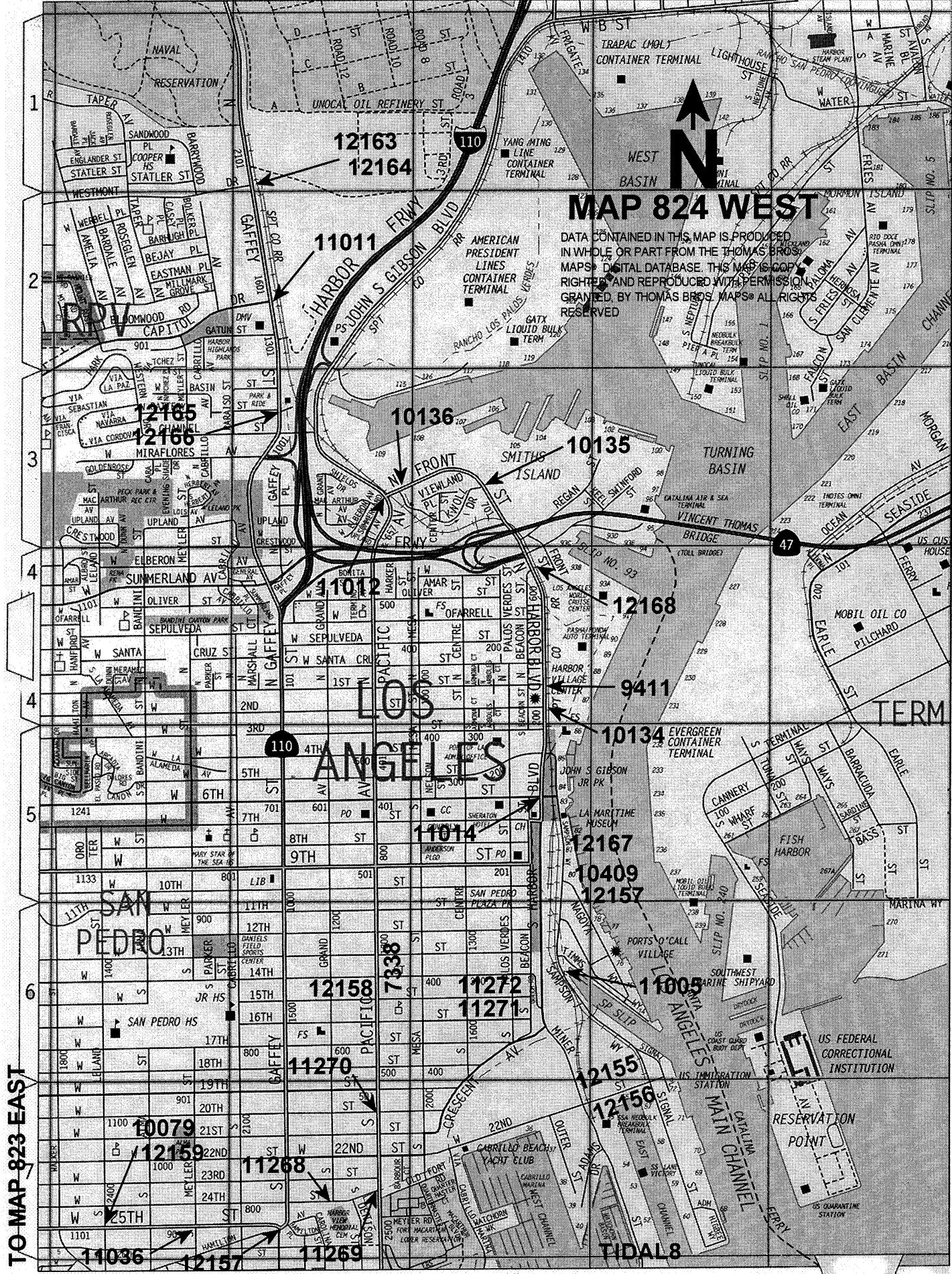

MAP 824 WEST

DATA CONTAINED IN THIS MAP IS PRODUCED IN WHOLE OR PART FROM THE THOMAS BROS. MAPS DIGITAL DATABASE. THIS MAP IS COPYRIGHTED AND REPRODUCED WITH PERMISSION GRANTED BY THOMAS BROS. MAPS. ALL RIGHTS RESERVED

LOS ANGELES

SAN PEDRO

TO MAP 823 EAST

11036

12157

11269

TIDAL8

US FEDERAL CORRECTIONAL INSTITUTION

RESERVATION POINT

US QUARANTINE STATION

US IMMIGRATION STATION

CATALINA MAIN CHANNEL

RESERVATION POINT

QUAD YEAR	ELEV FOOT/METER	DESCRIPTION	BM NUMBER
BASELINE (2005)	71.167 21.692	L&T IN W CB 300MM(1FT) S/O BCR @ SW COR LOMITA BLVD & OAK ST	Y 3518
BASELINE (2005)	71.468 21.784	L&BN IN S CB 300MM(1FT) E/O BCR @ SE COR LOMITA BLVD & WOODWARD AVE	Y 3519
BASELINE (2005)	123.521 37.649	L&BN IN N CB 600MM(2FT) W/O BCR @ NW COR NARBONNE AVE & PACIFIC COAST	Y 3529
PALOS VERDES (2005)	978.712 298.312	L&BN IN WLY CB INDIAN PEAK RD 9M WLY C/L & 100M NWLY/O C/L CROSSFIELD DR	Y 4366A
PALOS VERDES (2005)	979.955 298.691	L&BN IN ELY CB INDIAN PEAK RD 9M ELY/O C/L & 11.3M SLY C/L DRWY TO MALL @ BLDG #41 NR F HYD	Y 4367A
PALOS VERDES (2005)	998.458 304.331	RDBM TAG IN E CB 12.2M S/O BCR @ SE COR INDIAN PEAK RD & HAWTHORNE BL 32M S & 9M E/O C/L INT	Y 4370A
PALOS VERDES (2005)	1,036.011 315.777	L&SPK IN N CB 2.4M W/O BCR OF ISLE @ NW COR HAWTHORNE BLVD & SHOREWOOD RD 16.5M W & 12.2M N/O C/L INT	Y 4371
PALOS VERDES (2005)	1,085.606 330.894	L&SPK IN S CB 14.6M W/O BCR @ SW COR HAWTHORNE BLVD & WOODBROOK RD 32M W & 12.2M S/O C/L INT	Y 4372
PALOS VERDES (2005)	1,094.375 333.567	L&SPK IN N CB 3.4M E/O BCR @ NE COR HAWTHORNE BLVD & GRAYSLAKE RD 16.8M E & 12.5M N/O C/L INT	Y 4373
PALOS VERDES (2005)	1,095.832 334.011	L&SPK IN N CB HAWTHORNE BL 12.2M N/O C/L & 16M W/O WLY P/L HSE #27867 (@ EDISON SUB STA)	Y 4374
PALOS VERDES (2005)	1,059.247 322.859	L&BN S END C B 12.2M S/O C/L HAWTHORNE BLVD & 148M WLY/O RIDGEGATE DR	Y 4378
PALOS VERDES (2005)	936.148 285.339	RDBM TAG IN N CB NR C B @ NE COR HAWTHORNE BLVD & CREST RD 25M E & 12.2M N/O C/L INT	Y 4391A
PALOS VERDES (2005)	1,126.655 343.405	RDBM TAG N CB 600MM ELY/O ELY C B 12.2M NLY C/L CREST RD & 250M WLY/O C/L HIGHRIDGE RD	Y 4395
PALOS VERDES (2005)	504.401 153.742	RDBM TAG IN NLY END C B 500MM S/O CF 13.7M SLY OF C/L PALOS VERDES DR N & 1.2M ELY/O C/L PROD MASONGATE DR	Y 4425
PALOS VERDES (2005)	179.916 54.839	RDBM TAG IN S GATE POST BASE SLY MOST DRWY TO GREEN HILLS CEMETERY 27501 WESTERN AVE 21M(69FT) W/O C/L & 5M(16.4FT) S/O C/L DRWY 8.5M(28FT) W/O CF	Y 5672
PALOS VERDES (2005)	143.788 43.827	L&SCREW IN SW COR C. B. 14.6M(48FT) N/O BCR @ NW COR WESTERN AVE (SER RD W) & AVENIDA APRENDA 28M(92FT) N/O & 6.7M(22FT) W/O C/L INT	Y 5674
PALOS VERDES (2005)	194.414 59.258	L&BN IN CTR C. B. 2.7M(9FT) S/O BCR @ SW COR WESTERN AVE & DELASONDE DR	Y 5676
PALOS VERDES (2005)	338.899 103.297	L&T IN W CB 4.3M(14FT) N/O SLY MOST DRWY TO BLDG # 29601 WESTERN AVE (MOTEL) 12.2M(40FT) W/O C/L & 220M(0.1MI) S/O CRESTWOOD ST	Y 5681

QUAD YEAR	ELEV FOOT/METER	DESCRIPTION	BM NUMBER
BASILINE (2005)	139.352 42.475	L&BN IN S CB PACIFIC COAST HWY 11.6M(38FT) S/O C/L & 5.5M(18FT) W/O C/L PROD REED DR	Y 5794
BASILINE (2005)	141.481 43.124	L&SCREW IN N CB 300MM(1FT) W/O BCR @ NE COR PACIFIC COAST HWY & CRENSHAW BL	Y 5795
BASILINE (2005)	142.880 43.550	RDBM TAG IN N CB 300MM(1FT) E/O BCR @ NW COR PACIFIC COAST HWY & CRENSHAW BLVD	Y 5796
PALOS VERDES (2005)	285.506 87.022	RD BM TAG IN N CB 305M(0.2MI) W/O C/L WESTERN AVE & 17.1M(56FT) N/O C/L PALOS VERDES DR N (OPP BLDG #52) & 10.7M(35FT) E/O C.B.	Y 5949
PALOS VERDES (2005)	283.461 86.399	RDBM TAG IN S CB PALOS VERDES DR N 600MM(2FT) E/O C. B. & 305M(0.2MI) W/O C/L WESTERN AVE (@ BLDG #52 APT COMPLEX)	Y 5950
PALOS VERDES (2005)	303.645 92.551	RDBM TAG IN N CB 300MM(1FT) E/O C. B. 17M(56FT) N/O C/L PALOS VERDES DR N & 6.1M(20FT) W/O C/L PROD ELY MOST DRWY ROLLING HIUS COVENANT CHURCH #2222	Y 5953
PALOS VERDES (2005)	303.805 92.600	RDBM TAG IN S CB 300MM(2FT) E/O C. B. 17M(55.5FT) S/O C/L PALOS VERDES DR N & 14M(46FT) E/O C/L ELY MOST DRWY TO ROLLING HILLS COVENANT CHURCH #2222	Y 5954
PALOS VERDES (2005)	319.392 97.351	L&BR IN E CB 8.2M(27FT) N/O BCR @ NE COR PALOS VERDES DR N & MONTECILLO DR	Y 5955
PALOS VERDES (2005)	437.803 133.443	RDBM TAG IN E CB 300MM N/O BCR @ NE COR PALOS VERDES DR N & DOBBIN LN 21.3M N & 4M E/O C/L INT	Y 5967
PALOS VERDES (2005)	437.458 133.338	RDBM TAG IN W CB 300MM N/O BCR @ NW COR PALOS VERDES DR N & DOBBIN LN 21.3M N & 4M W/O C/L INT	Y 5968
PALOS VERDES (2005)	460.528 140.369	RDBM TAG IN E CB 300MM N BCR @ NE COR ROANWOOD DR & PALOS VERDES DR N 22M N & 4.6M E/O C/L INT	Y 5970
PALOS VERDES (2005)	463.053 141.139	L&BR NR MCR @ NW COR ROANWOOD DR & PALOS VERDES DR N 12.2M N & 9.1M W/O C/L INT MKD (BM)	Y 5971
PALOS VERDES (2005)	468.654 142.846	L&BN NR MCR @ SE COR HAWTHORNE BLVD & PALOS VERDES DR N 18.3M N & 17.4M E/O C/L INT	Y 5973
PALOS VERDES (2005)	506.011 154.233	RDBM TAG IN CONC FTG 150MM E/O E SIDE OF LARGE STONE MON @ NE COR PALOS VERDES DR N & HIDDEN VALLEY RD 18M E & 10.1M N/O C/L INT	Y 5976
PALOS VERDES (2005)	399.919 121.896	RD BM TAG IN N CB @ NE COR PALOS VERDES DR E & SPINNING WHEEL LN 12.5M E & 4M N/O C/L INT	Y 5977
PALOS VERDES (2005)	399.850 121.875	CS TAG IN S CB @ SE COR PALOS VERDES DR E & SPINNING WHEEL DR 12.5M E & 4M S/O C/L INT	Y 5978
PALOS VERDES (2005)	417.151 127.148	RDBM TAG N CB 600MM E BCR @ NE COR PALOS VERDES DR E & CONESTOGA DR 18.6M E & 9M N/O C/L INT	Y 5979
PALOS VERDES (2005)	845.639 257.752	RDBM TAG IN SLY ROCK WALL @ ENT TO ROCKING HORSE RD 12.2M S & 7.9M E/O C/L INT PALOS VERDES DR E	Y 5987

QUAD YEAR	ELEV FOOT/METER	DESCRIPTION	BM NUMBER
PALOS VERDES (2005)	807.292 246.063	RDBM TAG IN E CB @ NE COR PALOS VERDES DR E & COLT RD 13.4M N & 12.2M E/O C/L INT	Y 5989
PALOS VERDES (2005)	758.247 231.114	CS TAG IN N CB E END DRWY 13M N/O C/L CROWNVIEW DR & 22M W/O C/L PALOS VERDES DR E	Y 5992
PALOS VERDES (2005)	778.511 237.291	RDBM TAG IN CONC CLEAN OUT BOX OF 900MM CMP @ NE COR PALOS VERDES DR E & VIA COLINITA 22.3M N & 13.1M E/O C/L INT	Y 5997
PALOS VERDES (2005)	785.299 239.360	L&BR IN N CB VIA COLINITA 4.6M N/O C/L & 24.4M E/O C/L PALOS VERDES DR E STMPD (BM)	Y 5998
PALOS VERDES (2005)	914.073 278.610	CS TAG E CB 300MM N BCR @ NE COR PALOS VERDES DR E & CALLE AVENTURA 10.7M N & 11.6M E/O C/L INT	Y 6001
PALOS VERDES (2005)	915.328 278.993	CS TAG E CB 300MM S/O BCR @ SE COR PALOS VERDES DR E & CALLE AVENTURA 10.7M S & 11.6M E C/L INT	Y 6002
PALOS VERDES (2005)	919.499 280.264	RDBM TAG N CB 300MM E BCR @ NE COR PALOS VERDES DR E & CASILINA DR 12.2M N & 16.8M E/O C/L INT	Y 6003
PALOS VERDES (2005)	914.842 278.845	RDBM TAG N CB 4.6M W/O BCR @ NW COR PALOS VERDES DR E & CASILINA DR 12.2M N & 20.4M W/O C/L INT	Y 6004
PALOS VERDES (2005)	617.848 188.321	RDBM MON IN WELL 10IN DN 8.5M E/O C/L PALOS VERDES DR E & 966M S/O VISTA DEL MAR 1.2M E/O S END GUARD RAIL MKD (6009 - 1962)	Y 6009
PALOS VERDES (2005)	750.026 228.609	L&LS#5411 TAG IN N CB 600MM(2FT) W/O BCR @ NW COR HAWTHORNE BLVD & DUPRE DR	Y 6039
PALOS VERDES (2005)	250.907 76.477	USC&GS MON IN CTR C. B. 1.2M(4FT) S/O SLY CF 2.5M(8.2FT) E/O BCR @ SE COR HAWTHORNE BLVD & PALOS VERDES DR W MKD (S 1053 1960)	Y 6046
PALOS VERDES (2005)	541.755 165.127	RDBM TAG W CB 300MM S BCR @ NWLY COR 44.2M NLY C/L SILVER SPUR RD & 4M WLY C/L RUSTLER LN	Y 6048
PALOS VERDES (2005)	709.958 216.396	RDBM TAG IN SLY CB KINGPINE RD 300MM E/O BCR 5.5M S/O C/L & 27.4M ELY/O C/L SILVER SPUR RD	Y 6050
PALOS VERDES (2005)	805.177 245.419	RDBM TAG IN W CB (SERV ISL) 300MM N/O BCR @ NW COR 11.6M N/O C/L SILVER SPUR RD & 9.8M W/O C/L WILLOW WOOD RD	Y 6051
PALOS VERDES (2005)	233.710 71.235	USC&GS BR DISC IN W CB @ S END C. B. 5.5M(18FT) W/O C/L SCHOONER DR & 35.4M(116FT) N/O C/L PALOS VERDES DR S MKD (T 1053 1960)	Y 6067
PALOS VERDES (2005)	243.337 74.169	USC&GS BR DISC IN NW COR C. B. 9.8M(32FT) N/O C/L PALOS VERDES DR S (N BBL) & 18.6M(61FT) E/O C/L BARKENTINE RD MKD (U 1053 1960)	Y 6073
BASELINE (2005)	98.815 30.119	SPK&L IN NW COR C.B. IN S CB 11.6M(38FT) S/O & 64M(211FT) E/O C/L INT PACIFIC COAST HWY & CALLE MAYOR "BM 21-55A" CHISELED IN THE CONCRETE	Y 6926
BASELINE (2005)	132.164 40.284	USC&GS MON W END CONC CULV 11.3M(37FT) S/O C/L PACIFIC COAST HWY 141M(0.1MI) E/O INT PASEO DE GRACIA OPP FROM & 23.2M(76FT) E/O MCCORMICK MORTUARY MKD (X-1053 1960)	Y 6927

QUAD YEAR	ELEV FOOT/METER	DESCRIPTION	BM NUMBER
BASELINE (2005)	51.626 15.736	USC&GS BR DISC FL 2.4M(8FT) N/O CF & 3.8M(12.3FT) E/O CF @ NE COR AVE I & ESPLANADE AVE 12.2M(40FT) N/O & 13.4M(44FT) E/O C/L INT MKD (D 768 1945)	Y 7240
BASELINE (2005)	68.996 21.030	USC&GS MON FLUSH @ SW COR BRIDGE ON ANAHEIM ST 9.1M(30FT) SLY & 152M(498FT) ELY GAFFEY ST MKD (Z 50 1926 RESET 1945)	Y 7285
BASELINE (2005)	55.189 16.822	USC&GS MON FL NR S COR SQ CONC PAD 108M(354FT) SLY BCR @ SE COR GAFFEY ST & ANAHEIM ST 17M(56FT) ELY/O C/L GAFFEY ST MKD (E 770 1945) 5M(16.4FT) E/O ELY CB	Y 7286
PALOS VERDES (2005)	154.149 46.985	L&SPK IN E CB 1.2M(4FT) N/O MAIN ENT TO APT BLDG # 27980 WESTERN AVE & 100M(328FT) S/O C/L AVENIDA APRENDA	Y 7290
PALOS VERDES (2005)	231.977 70.707	CS BM MON IN C. B. 3.7M(12FT) W/O BCR @ SW COR WESTERN AVE & TOSCANINI DR MKD (BM 35-5A 1964 RE 5869)	Y 7291
PALOS VERDES (2005)	419.762 127.944	L&N IN N CB 300MM(1FT) E/O BCR @ NE COR WESTERN AVE & NINTH ST	Y 7296
PALOS VERDES (2005)	374.027 114.004	CS BM MON IN WELL 250MM(0.8FT) DN 500MM(1.6FT) S/O CF @ SWLY COR WESTERN AVE & 25TH ST 48M(158FT) WLY & 10M(33FT) S/O C/L INT MKD (BM 34-7 1953 RE 63)	Y 7300
PALOS VERDES (2005)	403.690 123.045	RD HD SPK IN NW COR C B @ NW COR PALOS VERDES DR E & HARBOR SIGHT DR 1.8M N/O BCR 15.2M N & 12.2M W/O C/L INT	Y 7301
PALOS VERDES (2005)	807.030 245.983	CS BM MON IN CONC FTG TO MOST NLY PILLAR @ ENT TO COLT RD 12.5M N/O C/L & 13.1M E/O C/L PALOS VERDES DR E MKD (BM 36-12 1964)	Y 7303
PALOS VERDES (2005)	808.280 246.364	RDBM TAG 300MM SLY BCR @ SWLY COR PALOS VERDES DR E & GANADO DR 18.9M SLY & 12.2M WLY C/L INT	Y 7305
PALOS VERDES (2005)	754.838 230.075	CSBM MON IN NE COR C B 12.5M N C/L HAWTHORNE BLVD & 43M W/O C/L DUPRE DR MKD (50-19 1965)	Y 7329
PALOS VERDES (2005)	571.855 174.302	CSBM MON IN SE COR C B 13.4M E/O C/L HAWTHORNE BLVD & 19M N/O C/L VALLON DR MKD (BM 50-20 1965)	Y 7330
PALOS VERDES (2005)	485.412 147.954	CSBM MON IN NELY COR C B 13M NLY C/L HAWTHORNE BLVD & 410M SWLY/O VALLON DR MKD (BM 50-21 1965)	Y 7332
PALOS VERDES (2005)	382.002 116.435	CSBM MON IN SMALL HDWL 15M NLY/O C/L HAWTHORNE BLVD & 26M W/O C/L PROD DRWY TO RANCHO PALOS VERDES CITY HALL MKD (BM 50-22 1965 RE 5869)	Y 7333
PALOS VERDES (2005)	298.352 90.938	CS MON IN C B 1.8M NLY BCR @ NELY COR HAWTHORNE BLVD & VIA RIVERIA 26M NLY & 6.1M ELY C/L INT MKD (BM 50-23 1965)	Y 7334
PALOS VERDES (2005)	72.094 21.974	USC&GS BR DISC IN CONC PAD FL @ SW COR MESA ST & 15TH ST 600MM(2FT) SW/O INT BK EDGES OF WK 9M(30FT) W/O & 9M(30FT) S/O C/L INT MKD (H 768 1945)	Y 7338
PALOS VERDES (2005)	385.013 117.352	CS BM MON IN WELL 300MM(1FT) S/O CF @ SWLY COR 25TH ST & GUNNELL AVE & 74M(243FT) W/O & 10M(33FT) S/O C/L INT MKD (BM 34-8 1953 RE 63)	Y 7343

QUAD YEAR	ELEV FOOT/METER	DESCRIPTION	BM NUMBER
PALOS VERDES (2005)	241.383 73.574	CS BR DISC IN C. B. 1.2M(4FT) N/O NLY CF 2.4M(8FT) E/O BCR @ NE COR PALOS VERDES DR W & VIA ZUMAYA MKD (BM 34-30A 1960 RE 5869)	Y 7348
PALOS VERDES (2005)	286.734 87.397	USC&GS BR DISC IN CONC PAD 450MM(1.5FT) W/O WLY CF NR S END C. B. @ HSE #1717 PALOS VERDES DR W (W BBL) 5.7M(18.5FT) W/O C/L & 9.6M(31.5FT) S/O C/L ALLEY 80M(263FT) S/O C/L VIA MARGATE MKD (E 169 1953)	Y 7350
PALOS VERDES (2005)	218.762 66.679	USC&GS BR DISC IN CONC BASE @ CTR & N SIDE OF A LARGE FOUNTAIN @ PALOS VERDES ESTATES MALAGA COVE PLAZA 38.4M(126FT) S/O C/L PALOS VERDES DR W & 50.5M(166FT) W/O C/L VIA CHICO MKD (G-169 1933)	Y 7355
PALOS VERDES (2005)	172.048 52.440	CSBM MON IN WELL @ BCR 1.2M(4FT) W/O CF NW COR PALO VERDES BLVD & CALLE MAYOR MKD (TOR 9.3 RE 55)	Y 7357
PALOS VERDES (2005)	642.394 195.802	CS MON IN WELL 11.6M SLY FR SELY COR CONC DRWY TO HSE #4201 MIRALESTE DR 500MM W/O W CB @ HSE #4205 MKD (BM 36-9 1945)	Y 7391
PALOS VERDES (2005)	638.573 194.638	L&BN 300MM NLY C B IN W CB MIRALESTE DR BETWEEN HSES #4205 & #4209 MKD (BM)	Y 7392
BASELINE (2005)	78.486 23.923	RDBM TAG IN E CB 1M(3.3FT) N/O BCR @ NE COR PACIFIC COAST HWY & ANZA AVE	Y 8396
BASELINE (2005)	106.022 32.316	RDBM TAG E CB 1.7M(5.6FT) S/O BCR @ NE COR PACIFIC COAST HWY & CALLE MAYOR	Y 8398
BASELINE (2005)	131.844 40.186	RDBM TAG IN N CB @ ST LIGHT 117.7M(386FT) E/O C/L PASEO DE GRACIA & 11.3M(37FT) N/O C/L PACIFIC COAST HWY @ ELY P/L #1998	Y 8399
BASELINE (2005)	112.047 34.152	RDBM TAG IN S CB 600MM(2FT) E/O BCR @ SE COR PACIFIC COAST HWY & VISTA DEL PARQUE	Y 8400
BASELINE (2005)	87.372 26.631	USC&GS BR DISC IN WK 430MM(1.4FT) S/O CF @ SE COR PACIFIC COAST HWY & PALOS VERDES BLVD (MOST ELY) 12.2M(40FT) S/O & 35.3M(115FT) E/O C/L INT MKD (E 768 RESET 1962)	Y 8402
BASELINE (2005)	70.348 21.442	RAMSET IN SW CB RET 3.7M(9FT) E/O BCR @ SW COR AVE I & PACIFIC COAST HWY	Y 8403
BASELINE (2005)	35.707 10.884	RDBM TAG IN E CB 1.2M(4FT) S/O BCR @ SE COR LOMITA BLVD & VERMONT AVE	Y 8417
BASELINE (2005)	38.428 11.713	LACE MON FL 1.2M(4FT) S/O CF @ SW COR LOMITA BLVD & VERMONT AVE 14M(46FT) S/O & 23.2M(76FT) W/O C/L INT MKD (PBM 21-06880)	Y 8418
BASELINE (2005)	57.958 17.666	LACE MON FL 1.2M(4FT) W/O CF @ SW COR LOMITA BLVD & PETROLEUM AVE 22.3M(73FT) S/O & 7M(23FT) W/O C/L INT MKD (PBM 21-06881 1967)	Y 8419
BASELINE (2005)	70.482 21.483	RDBM TAG IN CB 600MM(2FT) E/O BCR @ SE COR LOMITA BL & NORMANDIE AVE	Y 8420

QUAD YEAR	ELEV FOOT/METER	DESCRIPTION	BM NUMBER
BASILINE (2005)	140.240 42.745	USC&GS MON IN CB 600MM(2FT) W/O BCR @ SW COR PACIFIC COAST HWY & VIANNA AVE MKD (E 767 RESET 1960)	Y 8424
PALOS VERDES (2005)	297.148 90.571	CSBM MON FL 600MM(2FT) W/O WLY CF @ NWLY COR PALOS VERDES DR W & PASEO DEL MAR 23.5M(77FT) W C/L (W BBL) & 42M(138FT) N/O C/L INT MKD (BM 34-33A 1970 RE 5869)	Y 8516
PALOS VERDES (2005)	271.239 82.674	CS BR DISC ON E SIDE @ BASE OF LARGE ROCK 4M(13FT) W/O ELY CF C/L MEDIAN PALOS VERDES DR W & 9.4M(31FT) N/O C/L PROD ALIDA PL MKD (BM 34-29A 1964 RE 5869)	Y 8517
PALOS VERDES (2005)	202.390 61.689	CSBM BR CAP MON 10.4M(34FT) S/O C/L PALOS VERDES DR S (S BBL) & 1.9K(1.2MI) SELY/O HAWTHORNE BL @ 5.6M(18FT) S/O CREST OF HILL MKD (BM 34-24B 1964 RE 5869)	Y 8519
PALOS VERDES (2005)	184.055 56.100	RDBM TAG IN NW COR C. B. 7M(23FT) N/O C/L PALOS VERDES DR S (N BBL) & 236M(0.15MI) W/O ENT TO WAYFARERS CHAPEL	Y 8525
PALOS VERDES (2005)	154.439 47.073	FLAT HD SPK&L IN N CB NR C. B. 5.2M(17FT) W/O BCR @ NW COR PALOS VERDES DR N & SENATOR AVE	Y 8529
PALOS VERDES (2005)	324.412 98.881	LS TAG #2602 600MM(2FT) E/O BCR @ NE COR PALOS VERDES DR N & ROLLING VISTA DR	Y 8530
PALOS VERDES (2005)	424.088 129.262	L&BR IN WLY CB 900MM NLY BCR 28M NLY PALOS VERDE DR N & 12.8M WLY/O C/L CRENSHAW BLVD MKD (BM)	Y 8532
PALOS VERDES (2005)	255.949 78.013	RDBM TAG 600MM(2FT) N/O BCR @ NW COR WESTERN AVE & PENINSULAR VERDE DR	Y 8533
PALOS VERDES (2005)	255.461 77.865	RDBM TAG 300MM(1FT) E/O BCR IN RET @ SW COR WESTERN AVE & PENINSULA VERDE DR (NR C. B.)	Y 8534
PALOS VERDES (2005)	710.350 216.515	L&BN IN SE COR C B 900MM S/O S CF MIRALESTE PLAZA 12.2M S/O C/L & 35M E/O C/L PALOS VERDES DR E MKD (BM)	Y 8535
PALOS VERDES (2005)	1,057.289 322.263	L&LS#5411 TAG IN CB 300MM(1FT) S/O BCR @ SWLY COR INDIAN PEAK RD & CRENSHAW BLVD	Y 8544
PALOS VERDES (2005)	1,076.808 328.212	RDBM TAG 300MM N/O BCR @ NELY COR 12.2M ELY C/L CRENSHAW BLVD & 19M NLY C/L CRESTRIDGE RD	Y 8546
PALOS VERDES (2005)	1,204.373 367.094	RD TAG NR MCR @ SE COR CRENSHAW BLVD & CREST RD	Y 8547
PALOS VERDES (2005)	1,183.485 360.727	CO ENGR MON FL IN NELY COR C.B. 12.5M(41FT) SLY C/L CREST RD & 40M(131FT) NELY/O C/L WHITLEY COLLINS DR MKD (BM 50-14A 1970 RE 5869)	Y 8548
PALOS VERDES (2005)	1,182.632 360.467	L&BR IN CTR OF CB RET OF ISLAND @ C/L WHITLEY COLLINS DR 15.2M NLY C/L CREST RD	Y 8549
PALOS VERDES (2005)	1,137.326 346.658	RDBM TAG IN CB RET 300MM S/O BCR @ NELY COR 23M NLY C/L CREST RD & 11.6M ELY/O C/L HIGHRIDGE RD	Y 8550
PALOS VERDES (2005)	907.900 276.729	RDBM TAG IN E CB 300MM N/O C B 9.1M E/O C/L SILVER SPUR RD & 81M S/O C/L VIA DE LA VISTA	Y 8552

QUAD YEAR	ELEV FOOT/METER	DESCRIPTION	BM NUMBER
PALOS VERDES (2005)	991.052 302.074	L&BR IN N CB 9.8M W/O BCR @ NW COR HAWTHORNE BLVD & SILVER SPUR RD 10M N & 30.5M W/O C/L INT	Y 8553
PALOS VERDES (2005)	998.772 304.427	RD TAG IN NLY CB HAWTHORNE BLVD 12.2M N/O C/L & 15M ELY OF C/L INDIAN PEAK RD	Y 8555
PALOS VERDES (2005)	1,095.669 333.961	RDBM TAG IN CB 5.2M W/O BCR @ SWLY COR 12.2M S C/L HAWTHORNE BL & 27.4M W/O C/L HIGHRIDGE RD	Y 8556
PALOS VERDES (2005)	1,040.126 317.031	RD TAG IN NW CB RET 4.6M S/O BCR 12.8M W & 13M N/O C/L INT HAWTHORNE BLVD & SAN NICOLAS DR	Y 8557
PALOS VERDES (2005)	1,023.264 311.892	RDBM TAG IN E CB @ BCR NE COR HAWTHORNE BLVD & SEAMOUNT DR 12.2M E & 13.7M N/O C/L INT	Y 8558
PALOS VERDES (2005)	1,011.454 308.292	L&BN NR CTR C B 12.2M W/O C/L HAWTHORNE BLVD & 91.4M N/O C/L VERDE RIDGE RD	Y 8559
PALOS VERDES (2005)	991.688 302.267	L&BN IN NW COR C B 13.4M W/O C/L HAWTHORNE BLVD & 13.7M N/O C/L PROD INDIAN VALLEY RD	Y 8560
PALOS VERDES (2005)	989.084 301.474	L&RE TAG #9183 300MM S/O BCR @ SE COR HAWTHORNE BL & INDIAN VALLEY RD 12.2M E & 15.8M S C/L INT	Y 8561
PALOS VERDES (2005)	834.870 254.469	CS MON IN C B 12.2M W/O C/L HAWTHORNE BLVD & 85M N/O C/L LAS VERDES DR MKD (BM 50-18)	Y 8562
PALOS VERDES (2005)	1,000.639 304.996	L&T IN CONC STEP 11M ELY/O C/L INDIAN PEAK RD & 360M SLY/O CROSSFIELD DR @ PARKING LOT TO BLDG STMPD (BM) M NWLY OF CRENSHAW BLVD	Y 8566
BASELINE (2005)	24.598 7.497	USC&GS MON IN CONC 400MM(1.3FT) NE/O ANG PT IN CH LINK FENCE 13.4M(44FT) W/O C/L #2981 GAFFEY ST & 4.8M(15.5FT) N/O C/L AGA JANIAN DR (PVT) MKD (J 770 1945)	Y 8573
PALOS VERDES (2005)	489.474 149.192	L&BN IN SLY CB 5.8M S/O C/L ROLLING MEADOWS RD & 23M W/O C/L PALOS VERDES DR N	Y 8964
PALOS VERDES (2005)	468.793 142.889	RDBM TAG IN NLY CB 600MM E/O CB END @ NE COR PALOS VERDES DR N & PONDEROSA LN 30M E & 5.8M N/O C/L INT	Y 8965
PALOS VERDES (2005)	471.358 143.670	RDBM TAG S CB 300MM E BCR @ SE COR PALOS VERDES DR N & VIA VALMONTE 15.2M E & 5.2M E/O C/L INT	Y 8966
PALOS VERDES (2005)	416.230 126.867	RDBM TAG IN CB RET 300MM W/O BCR @ NE COR PALOS VERDES DR N & VIA LAS VEGAS 21.3M N & 16.8 M E/O C/L INT	Y 8968
PALOS VERDES (2005)	382.693 116.645	RDBM TAG 5.5M ELY BCR @ NELY COR PALOS VERDES DR N & VIA COLUSA 21.3M NLY & 16.5M ELY C/L INT (@ W END C B)	Y 8969
PALOS VERDES (2005)	382.234 116.505	RDBM TAG IN N CB ISLAND 1.2M E/O CB END @ SE COR PALOS VERDES DR N (W BOUND) & VIA COLUSA 14M E & 5.5M S/O C/L INT (@ W END C B)	Y 8970
PALOS VERDES (2005)	310.213 94.553	RDBM TAG IN CONC DRWY 5M N/O CF HSE #2905 PALOS VERDE DR N 20M N/O C/L & 36M E/O C/L VIA ALAMEDA	Y 8971
BASELINE (2005)	85.821 26.158	RDBM TAG IN N CB 1.5M(5FT) E/O BCR @ NE COR PACIFIC COAST HWY & PALOS VERDES BL	Y 9351

QUAD YEAR	ELEV FOOT/METER	DESCRIPTION	BM NUMBER
BASILINE (2005)	79.413 24.205	RDBM TAG IN S CB 300MM(1FT) E/O BCR @ SE COR PACIFIC COAST HWY & ANZA AVE	Y 9353
PALOS VERDES (2005)	167.804 51.147	CSBM MON IN SELY COR CONC JUNC BOX 3.7M(12FT) N/O N CB PALOS VERDES DR W & 97M(318FT) W/O INT (SER RD FR THE S) 483M(0.3MI) W/O VIA DEL PUENTE MKD (BM 34-36A 1964 RE 5869)	Y 9362
PALOS VERDES (2005)	251.863 76.768	RDBM TAG IN W END C. B. 1.8M(6FT) E/O BCR @ NE COR PALOS VERDES DR W & HAWTHORNE BLVD	Y 9365
PALOS VERDES (2005)	293.650 89.505	RD BM TAG IN N CB @ E END C. B. 3M(10FT) E/O BCR @ NE COR PALOS VERDES DR S & CONQUEROR DR	Y 9368
BASILINE (2005)	51.982 15.844	RDBM TAG IN N CB 9.6M(31.5FT) E/O BCR @ NE COR LOMITA BLVD & WESTERN AVE	Y 9404
BASILINE (2005)	72.011 21.949	L&BR IN CB RET 4.6M(15FT) E/O BCR @ NW COR LOMITA BL & NARBONNE AVE	Y 9405
BASILINE (2005)	134.889 41.114	RDBM TAG IN N CB 600MM(2FT) E/O BCR @ NE COR PACIFIC COAST HWY & ROBINSON WAY (TO THE N)	Y 9408
BASILINE (2005)	132.856 40.495	RDBM TAG IN CB RET 600MM(2FT) E/O BCR @ NW COR PACIFIC COAST HWY & ROBINSON WAY (TO THE N)	Y 9409
BASILINE (2005)	128.099 39.045	L&BR IN S CB 600MM(2FT) W/O BCR @ SW COR PACIFIC COAST HWY & WINLOCK DR	Y 9410
BASILINE (2005)	20.577 6.272	USC&GS MON IN C. B. 1.2M(4FT) E/O CF 1.8M(6FT) N/O BCR @ NE COR HARBOR BL & 1ST ST MKD (G 970 1964)	Y 9411
PALOS VERDES (2005)	246.859 75.243	RDBM TAG IN W CB 300MM(1FT) S/O BCR @ SW COR WESTERN AVE & PALOS VERDES DR N	Y 9914
PALOS VERDES (2005)	1,083.300 330.191	RDBM TAG 300MM E/O BCR @ NE COR HAWTHORNE BLVD & GRANVIA ALTAMIRA 19.5M E & 12.2M N/O C/L INT	Y 9916
PALOS VERDES (2005)	1,080.205 329.247	RDBM TAG 300MM E/O BCR @ SE COR HAWTHORNE BL & RIDGEGATE DR 15.8M E & 12.2M S/O C/L INT	Y 9917
PALOS VERDES (2005)	498.695 152.003	L&BN IN CB 2.1M N/O END NE COR PALOS VERDES DR N & HIDDEN VALLEY RD 26.5M N & 4.9M E/O C/L INT	Y 9918
PALOS VERDES (2005)	198.666 60.554	L&T IN ELY CB 1.5M NLY/O BCR @ NE COR CRENSHAW BLVD & CREST RD 15M NLY & 12.8 ELY/O C/L INT	Y 9919
PALOS VERDES (2005)	200.217 61.026	L&T IN ELY CB 300MM S/O BCR @ SE COR CRENSHAW BLVD & CREST RD 13.7M SLY & 12.8M ELY/O C/L INT	Y 9920
PALOS VERDES (2005)	243.185 74.123	L&BN IN ELY CB 300MM N/O BCR @ NE COR CRENSHAW BL & ROLLING HILLS RD 19.2M N & 12.8M E C/L INT	Y 9921
PALOS VERDES (2005)	251.272 76.588	L&T IN CB RET 1.8M N/O BCR @ SE COR CRENSHAW BL & ROLLING HILLS RD 16.2M S & 13.1M E/O C/L INT	Y 9922
PALOS VERDES (2005)	522.562 159.277	RDBM TAG IN ELY CB MARINA DR 300MM SLY BCR 4.6M ELY C/L & 23M SLY/O C/L SILVER SPUR RD	Y 9925

QUAD YEAR	ELEV FOOT/METER	DESCRIPTION	BM NUMBER
PALOS VERDES (2005)	604.599 184.282	RDBM TAG IN NWLY COR CONC VAULT 6.7M NLY/O C/L SILVER SPUR RD & 49.7M ELY C/L RANGE HORSE LANE	Y 9926
PALOS VERDES (2005)	768.037 234.098	RDBM TAG IN W CB 1.5M N/O BCR 9M W/O C/L SILVER SPUR RD & 23M N/O C/L MONTEMALAGA DR	Y 9927
PALOS VERDES (2005)	772.794 235.548	LA CO TAG IN S CB 3M(10FT) W/O BCR @ SW COR SILVER SPUR RD & MONTEMALAGA DR	Y 9928
PALOS VERDES (2005)	874.738 266.621	RDBM TAG IN E CB 5.5M N/O BCR 9M E/O C/L SILVER SPUR RD & 21M N/O C/L VIA DE LA VISTA	Y 9930
PALOS VERDES (2005)	969.032 295.362	RDBM TAG IN E CB 8.5M E/O C/L SILVER SPUR RD & 228M N/O C/L BASSWOOD AVE NR TOP OF HILL 17M S/O ENT GATE TO BALL FIELD	Y 9931
PALOS VERDES (2005)	959.295 292.394	RDBM TAG IN BOX CULVERT 1.8M W/O W BCR 22M W/O C/L SILVER SPUR RD & 5.5M S/O C/L BASSWOOD AVE	Y 9932
PALOS VERDES (2005)	759.707 231.559	L&SPK IN N CB CROWNVIEW DR 10.4M N/O C/L & 28M W/O C/L PALOS VERDES DR E MKD (BM)	Y 9938
PALOS VERDES (2005)	738.691 225.154	RDBM TAG IN C B NLY CB BRONCO DR 4.9M N/O C/L & 27M W/O C/L PALOS VERDES DR E	Y 9940
PALOS VERDES (2005)	499.792 152.337	RDBM TAG IN E CB 600MM N/O CB END 5.2M E/O C/L LATIGO LN & 29M N/O C/L PALOS VERDES DR N	Y 10078
PALOS VERDES (2005)	261.710 79.769	L&BN IN S CB 300MM(1FT) E/O BCR @ SE COR 25TH ST & LELAND ST	Y 10079
PALOS VERDES (2005)	370.017 112.782	USC&GS MON FL IN N END C. B. 14.3M(47FT) S/O BCR @ SE COR WESTERN AVE & 25TH ST MKD (Z 1217 1971)	Y 10080
PALOS VERDES (2005)	293.843 89.564	L&BN IN N CB (SERV RD) @ W END C. B. 25M(82FT) N/O C/L PALOS VERDES DR S & 15.2M(50FT) E/O C/L CONQUEROR DR	Y 10081
PALOS VERDES (2005)	330.959 100.877	SPK IN CONC CB 47FT S/O BCR 40FT W/O C/L WESTERN AVE & 102FT S/O C/L CRESTWOOD ST	Y 10083
PALOS VERDES (2005)	382.926 116.716	L&SPK IN CB @ BCR 25M(82FT) NELY/O C/L WESTERN AVE & 5.5M(18FT) W/O C/L DOBSON AVE	Y 10085
PALOS VERDES (2005)	570.208 173.800	L&DPW TAG IN W CB 600MM(2FT) N/O BCR @ NW COR HAWTHORNE BLVD & VALLON DR	Y 10087
PALOS VERDES (2005)	1,058.096 322.509	L&RCE TAG #5335 300MM WLY/O BCR 12.2M SWLY/O C/L CREST RD & 15.5M SELY/O C/L LA CROIX DR	Y 10088
PALOS VERDES (2005)	1,054.772 321.495	L&RCE TAG #5335 IN CB @ BCR 12.2M SWLY/O C/L CREST RD & 15.5M NWLY/O C/L LA CROIX DR	Y 10089
BASELINE (2005)	19.160 5.840	L&SPK IN E CB HARBOR BLVD @ S END C. B. 12.8M(42FT) E/O C/L & 7.6M(25FT) N/O C/L 2ND ST	Y 10134
BASELINE (2005)	12.908 3.934	L&SPK IN S CB 1.5M(5FT) W/O BCR 4.6M(15FT) S/O C/L KNOLL DR (EXIT SELY) & 19.8M(65FT) W/O C/L FRONT ST	Y 10135
BASELINE (2005)	16.786 5.116	L&T IN TOP N END CONC RET WALL @ SW COR FRONT ST & KNOLL DR (ENT FR N) 11.6M(38FT) S/O & 6.4M(21FT) W/O C/L INT	Y 10136

QUAD YEAR	ELEV FOOT/METER	DESCRIPTION	BM NUMBER
BASILINE (2005)	22.176 6.759	L&SPK IN CB RET 600MM(2FT) S/O BCR @ NE COR PACIFIC COAST HWY & VERMONT AVE	Y 10137
BASILINE (2005)	52.469 15.993	L&SPK IN N CB 4M(13FT) E/O BCR @ NE COR LOMITA BLVD & PRESIDENTE AVE	Y 10169
BASILINE (2005)	53.331 16.255	L&CALTRANS TAG IN CB RET 4.6M(15FT) E/O BCR @ NW COR LOMITA BL & WESTERN AVE	Y 10170
BASILINE (2005)	57.357 17.482	RDBM TAG IN S CB 300MM(1FT) W/O BCR @ SW COR LOMITA BL & EBONY LANE	Y 10171
BASILINE (2005)	58.348 17.785	RDBM TAG IN S CB 300MM(1FT) W/O BCR @ SW COR LOMITA BLVD & WALNUT ST	Y 10172
BASILINE (2005)	72.189 22.003	L&BR IN CB RET 4.9M(16FT) W/O BCR @ SE COR LOMITA BL NARBONNE AVE	Y 10173
BASILINE (2005)	128.958 39.307	RDBM TAG IN N CB 300MM(1FT) E/O BCR @ NE COR PACIFIC COAST HWY & ZAMPERINI WY	Y 10174
PALOS VERDES (2005)	245.564 74.848	L&TAG IN E CB 1.5M(5FT) S/O BCR @ SE COR WESTERN AVE & PALO VERDES DR N	Y 10376
PALOS VERDES (2005)	261.419 79.681	DPW BM TAG IN S CB 300MM(1FT) W/O BCR @ SW COR WESTERN & CADDINGTON DR	Y 10378
PALOS VERDES (2005)	301.452 91.883	RDBM TAG IN W CB 2.4M(8FT) N/O C/L PROD PARK WESTERN DR & 12.2M(40FT) W/O C/L WESTERN AVE	Y 10379
PALOS VERDES (2005)	393.624 119.977	DPW BM TAG IN CB 300MM(1FT) N/O BCR @ NW COR BYNNER DR & WESTERN AVE	Y 10381
PALOS VERDES (2005)	388.094 118.291	LACE BR DISC 1.2M(4FT) N/O BCR 300MM(1FT) E/O CF @ LT STD 12.2M(40FT) ELY/O C/L WESTERN AVE & 20M(65.6FT) NWLY/O C/L DODSON AVE MKD (PBM 24-06528 1984)	Y 10382
PALOS VERDES (2005)	209.679 63.910	COE BR DISC 2.1M(7FT) N/O 2ND BCR N IN W CB @ NW COR PALOS VERDES BLVD & VIA ROSA 8.5M(28FT) W/O & 49M(161FT) N/O C/L INT MKD (RDP-101 1988)	Y 10383
PALOS VERDES (2005)	134.503 40.997	COE BR DISC 300MM(1FT) E/O BCR IN S CB @ SE COR PALOS VERDES BLVD & CALLE MIRAMAR MKD (RDP -102 1988)	Y 10384
PALOS VERDES (2005)	326.088 99.392	L&T IN S CB 300MM(1FT) E/O BCR @ SE COR PALOS VERDES DR N & ROLLING VISTA DR	Y 10385
PALOS VERDES (2005)	370.173 112.829	DPW BM TAG IN S CB 7.3M(24FT) W/O BCR @ SW COR PALOS VERDES DR N & PALO VERDES DR E	Y 10386
PALOS VERDES (2005)	404.163 123.189	DPW BM TAG IN CB @ BCR NW COR PALOS VERDES DR N & DAPPLEGRAY LN 20.1M N & 6.7M W/O C/L INT	Y 10387
PALOS VERDES (2005)	453.378 138.190	DPW BM TAG IN N CB 300MM E/O BCR @ NE COR PALOS VERDES DR N & STRAWBERRY LN 15.2M E & 9.4M N/O C/L INT	Y 10388

QUAD YEAR	ELEV FOOT/METER	DESCRIPTION	BM NUMBER
PALOS VERDES (2005)	461.766 140.747	DPW BM TAG IN S CB 5.5M E/O C/L PROD @ ENTRANCE TO DAPPLEGRAY SCHOOL 8.2M S/O C/L PALOS VERDES DR N & 322M W/O STRAWBERRY LN	Y 10389
PALOS VERDES (2005)	477.572 145.564	DPW BM TAG IN CB 300MM N BCR 10.7M N/O C/L PALOS VERDES DR N & 5.8M E/O C/L ROLLING HILLS DR	Y 10390
PALOS VERDES (2005)	464.530 141.589	DPW BM TAG 300MM E/O BCR @ NE COR 17M N/O C/L PALOS VERDES DR N & 18M E/O C/L HAWTHORNE BLVD	Y 10391
PALOS VERDES (2005)	217.653 66.341	DPW BM TAG IN N CB OF PARKING LOT PALOS VERDES ESTATES (MALAGA COVE PLAZA) 22.6M(74FT) S/O C/L PALOS VERDES DR W & 50.6M(166FT) W/O C/L VIA CHICO 19.5M(64FT) N/O CTR OF FOUNTAIN	Y 10392
PALOS VERDES (2005)	166.645 50.794	L&T IN S CB @ E END C. B. 4.6M(15FT) S/O C/L PALOS VERDES DR W 63M(207FT) W/O C/L (RD TO S) 483M(0.3MI) W/O VIA DEL PUENTE	Y 10393
PALOS VERDES (2005)	326.834 99.619	DPW BM TAG IN WLY CB 1.3M(4.2FT) N/O BCR @ SW CB RET 7M(23FT) WLY/O C/L PALOS VERDES DR W & 17.7M(58FT) SLY/O C/L VIA MONTE MAR (19FT ELY/O LARGE STONE)	Y 10394
PALOS VERDES (2005)	254.539 77.584	CE BR CAP S END C. B. 1M(3.3FT) N/O BCR @ NE COR PALOS VERDES DR W (E BBL) & VIA CARRILLO MKD (BM 34-31B 1977 RE 22726)	Y 10396
PALOS VERDES (2005)	250.051 76.216	L&T IN N WALL C. B. 5.2M(17FT) W/O C/L PALOS VERDES DR W (W BBL) & 1.5M(5FT) S/O C/L PROD VIA CARRILLO	Y 10397
PALOS VERDES (2005)	241.151 73.503	DPW BM TAG IN E CB 600MM(2FT) S/O BCR @ SE COR PALOS VERDES DR W (E BBL) & VIA ZUMAYA (NR C. B.)	Y 10398
PALOS VERDES (2005)	254.003 77.420	DPW BM TAG IN S WALL C. B. 5.2M(17FT) E/O C/L PALOS VERDES DR W (E BBL) & 11.6M(38FT) N/O C/L DRWY TO HSE #30502 250M(820FT) S/O C/L BERRY HILL DR	Y 10399
PALOS VERDES (2005)	223.733 68.194	L&BR IN W END C. B. 1.4M(4.6FT) N/O CF 8M(26FT) N/O C/L PALOS VERDES DR S (N BBL) & 86M(282FT) E/O C/L CRESTMONT LANE	Y 10402
PALOS VERDES (2005)	233.296 71.109	DPW BM TAG IN E CB CONC DRWY TO CO FIRE STA #53 16.7M(54.8FT) S/O C/L PALOS VERDES DR S (S BBL) & 78M(256FT) W/O C/L SEA COVE DR	Y 10403
PALOS VERDES (2005)	161.607 49.258	DPW BM TAG IN N CB 2.7M(9FT) W/O BCR @ NW COR PALOS VERDES DR S & NARCISSA DR @ WLY END C. B.	Y 10404
PALOS VERDES (2005)	401.789 122.466	L&RCE TAG #13095 IN S CB 8.2M(27FT) E/O W END CONC CB 10M(33FT) S/O C/L 25TH ST & 483M(0.3MI) W/O C/L MERMAID DR @ LT STD NR PALOS VERDES CITY LIMITS	Y 10407
BASELINE (2005)	11.207 3.416	L&SPK IN CONC HDWL 900MM(3FT) S/O NW COR 24.4M(80FT) E/O C/L SAMPSON WAY & 20M(66FT) S/O UTROS RESTAURANT L.A.H.D. #4-76 BERTH 73	Y 10409
BASELINE (2005)	70.414 21.462	DPW BM TAG IN N CB 1.8M(6FT) E/O BCR @ NE COR LOMITA BL & NORMANDIE AVE	Y 10528
BASELINE (2005)	79.014 24.084	DPW BM TAG IN W CB 3.7M(12FT) S/O DRWY TO HSE #25107 NARBONNE AVE (PP #219613E)	Y 10550

QUAD YEAR	ELEV FOOT/METER	DESCRIPTION	BM NUMBER
BASELINE (2005)	78.606 23.959	DPW BM TAG IN E CB 16.2M(53FT) N/O C/L DRWY TO HSE #25118 NARBONNE AVE (NR PP #826780H)	Y 10551
BASELINE (2005)	95.980 29.255	DPW BM TAG IN W CB 9.8M(32FT) W/O BCR @ SW COR 254TH ST & NARBONNE AVE	Y 10552
BASELINE (2005)	123.290 37.579	DPW BM TAG IN S CB 11.6M(38FT) E/O BCR @ SE COR PACIFIC COAST HWY & NARBONNE AVE	Y 10553
BASELINE (2005)	66.777 20.354	DPW BM TAG IN E CB 1.2M(4FT) S/O BCR @ SE COR 248TH ST & NARBONNE AVE	Y 10861
BASELINE (2005)	131.017 39.934	DPW BM TAG IN N CB 1.2M(4FT) W/O BCR @ NW COR PACIFIC COAST HWY & AIRPORT DR	Y 10862
BASELINE (2005)	145.912 44.474	DPW BM TAG IN N CB 1M(3.3FT) W/O BCR @ NW COR PACIFIC COAST HWY & ROLLING HILLS WAY	Y 10863
BASELINE (2005)	111.174 33.886	DPW BM TAG IN N CB 1M(3.3FT) E/O BCR @ NE COR PACIFIC COAST HWY & MADISON ST	Y 10864
BASELINE (2005)	82.838 25.249	DPW BM TAG IN N CB 1M(3.3FT) W/O BCR @ NW COR PACIFIC COAST HWY & OCEAN AVE	Y 10900
BASELINE (2005)	85.765 26.141	DPW BM TAG IN CONC BASE ON S SIDE OF NLY MOST COLUMN OF PED OVERPASS PACIFIC COAST HWY 14.3M(47FT) N/O C/L 37.2M(122FT) W/O E DRWY (NR SO HIGH SCHOOL 4801 PCH)	Y 10901
BASELINE (2005)	86.504 26.366	DPW BM TAG IN N CB 1M(3.3FT) E/O BCR @ NE COR PACIFIC COAST HWY & W DRWY ENT TO SOUTH TORRANCE HIGH SCHOOL #4801 PCH	Y 10902
BASELINE (2005)	14.227 4.336	BT SPK IN CB RET @ SW COR OF RESTROOM # L.A.H.D. #240-63 23M(75.5FT)E/O C/L SAMPSON WAY & 402M(0.25MI) N/O C/L 22ND ST	Y 11005
BASELINE (2005)	48.826 14.882	L&T IN E CB 700MM(2.3FT) S/O BCR @ SE COR VERMONT AVE & 253RD ST	Y 11007
BASELINE (2005)	24.412 7.441	DPW BM TAG IN W CB 7M(23FT) N/O C/L EXIT DRWY KAISER PERMANENTE MED CTR 25825 VERMONT AVE 11.2M(37.1FT) W/O C/L (@ FIRE HYD)	Y 11008
BASELINE (2005)	16.164 4.927	L&SPK IN S CB 24M(79FT) W/O BCR @ SW COR GAFFEY ST & CAPITOL DR (@ W END C. B.)	Y 11011
BASELINE (2005)	15.326 4.671	L&SPK IN SLY CB 9M(29.5FT) NWLY/O C/L PROD FRONT ST & 11M(36FT) SW/O C/L PACIFIC AVE	Y 11012
BASELINE (2005)	18.339 5.590	L&T IN E CB 760MM(2.5FT) S/O BCR @ SE COR HARBOR BLVD & 6TH ST	Y 11014
PALOS VERDES (2005)	446.607 136.126	DPW BM TAG IN N CB 1M W/O BCR @ NW COR RAWHIDE LN & PALOS VERDES DR N 19.8M W & 8.2M N C/L INT	Y 11015
PALOS VERDES (2005)	92.308 28.136	DPW BM TAG IN E CB 16.8M(55FT) S/O C/L NLY MOST DRWY TO RIVERA HALL LUTHERAN SCHOOL #330 PALOS VERDES BLVD 9.8M(32FT) E/O C/L (@ LT STD #3007524E)	Y 11017

QUAD YEAR	ELEV FOOT/METER	DESCRIPTION	BM NUMBER
PALOS VERDES (2005)	182.461 55.614	RDBM TAG IN N CB 6.1M(20FT) E/O C/L DRWY TO HSE #357 PALOS VERDES DR W	Y 11018
PALOS VERDES (2005)	281.624 85.839	RDBM TAG IN CB RET 2.9M(10FT) N/O BCR @ SW COR PASEO DEL MAR & PALOS VERDES DR W	Y 11019
PALOS VERDES (2005)	286.777 87.410	USC&GS BR DISC IN S END C. B. 240MM(0.8FT) W/O W CF 56M(184FT) S/O BCR @ SW COR PASO DEL MAR & PALOS VERDES DR W (W BBL) MKD (T 1217 1971)	Y 11020
PALOS VERDES (2005)	301.246 91.820	RDBM TAG 600MM(2FT) N/O BCR @ NW COR PALOS VERDES DR W (W BBL) & APSLEY RD	Y 11021
PALOS VERDES (2005)	274.394 83.636	DPW BM TAG IN W CB 1M(3.3FT) S/O BCR @ SW COR PALOS VERDES DR W (W BBL) & DALTON RD	Y 11022
PALOS VERDES (2005)	215.561 65.703	L&BR IN W CB C/L MEDIAN 6.4M(21FT) S/O C/L PROD VIA MIROLA & 5.2M(17FT) E/O C/L PALOS VERDES DR W (W BBL) @ S END C. B.	Y 11023
PALOS VERDES (2005)	272.325 83.005	DPW BM TAG IN S CB 2M(6.5FT) E/O BCR @ SE COR TYBURN RD & PALOS VERDES DR W (E BBL)	Y 11024
PALOS VERDES (2005)	260.540 79.413	L&BN IN E CB @ S END C. B. 104M(34FT) S/O C/L BERRY HILL DR & 5.2M(17FT) E/O C/L PALOS VERDES DR W (E BBL) @ MI MKR 0.42	Y 11025
PALOS VERDES (2005)	264.905 80.743	DPW BM TAG IN E CB 1M(3.3FT) N/O BCR @ NE COR PALOS VERDES DR W (E BBL) & RUE BEAUPRE	Y 11026
PALOS VERDES (2005)	221.052 67.377	L&BR IN W CB 1M(3.3FT) S/O S END C. B. 4.3M(14FT) W/O C/L PALOS VERDES DR S (W BBL) & 320M(0.2MI) S/O C/L HAWTHORNE BL 4M(13FT) N/O NLY P/L POINT VICENTE PARK	Y 11027
PALOS VERDES (2005)	170.181 51.871	L&BR IN WLY CB 300MM(1FT) S/O NLY END C. B. 19.5M(64FT) NLY OF C/L MOST SLY DRWY TO POINT VICENTE PARK & LT HSE 31550 PALOS VERDES DR S 14.3M(47FT) W/O C/L	Y 11028
PALOS VERDES (2005)	248.570 75.764	L&N IN SW CB RET 6M(19.7FT) E/O BCR 5.5M(18FT) S/O C/L PALOS VERDES DR S (S BBL) & 13.8M(45FT) W/O C/L SEAHILL DR	Y 11030
PALOS VERDES (2005)	252.151 76.856	L&N IN S CB 5M(16.5FT) E/O BCR @ SE COR PALOS VERDES DR S (S BBL) & SEAHILL DR	Y 11031
PALOS VERDES (2005)	225.543 68.746	USC&GS BR DISC IN E END C. B. 10.4M(34FT) N/O C/L PALOS VERDES DR S & 312M(0.2MI) W/O C/L SCHOONER DR OPP HSE #4319 MKD (X 1312 1978)	Y 11032
PALOS VERDES (2005)	367.040 111.874	FC TAG IN N CB @ W END C. B. 2.4M(8FT) W/O BCR @ NW COR PALOS VERDES DR S & SEACLIFF DR	Y 11033
PALOS VERDES (2005)	406.531 123.911	L&SPK IN N CB 14.2M(46.6) W/O BCR @ W END 2ND C. B. @ NW COR 25TH ST & MERMAID DR	Y 11034
PALOS VERDES (2005)	387.417 118.085	L&N IN N CB 1M(3.3FT) W/O BCR @ E END C. B. @ NW COR 25TH ST & ANCHOVY AVE	Y 11035
PALOS VERDES (2005)	250.085 76.226	L&SPK IN S CB 1.3M(4.3FT) W/O BCR @ SW COR 25TH ST & MEYLER ST	Y 11036

QUAD YEAR	ELEV FOOT/METER	DESCRIPTION	BM NUMBER
PALOS VERDES (2005)	256.539 78.193	CS BM MON IN S END C. B. 8.2M(27FT) S/O BCR @ SW COR WESTERN AVE & PENINSULA VERDE DR MKD (BM 35-3A 1970 RE 5869)	Y 11037
PALOS VERDES (2005)	231.573 70.584	CO ENGR TAG IN E CB N END C B 2M S/O BCR @ SE COR WESTERN AVE & TOSCANINI DR 19.8M S & 12.2M E/O C/L INT	Y 11038
PALOS VERDES (2005)	295.825 90.168	L&T IN W CB 1.2M(4FT) S/O BCR @ SW COR WESTERN AVE & TRUDIE DR	Y 11039
PALOS VERDES (2005)	358.494 109.269	L&BR IN WLY CB 1.1M(3.6FT) NLY/O END OF CB @ GUARD RAIL 12.2M(40FT) W/O C/L WESTERN AVE & 402M(0.25MI) SLY/O 1ST ST	Y 11040
PALOS VERDES (2005)	695.203 211.899	DPW BM TAG IN CONC CB 7.3M S/O C/L PALOS VERDES DR E & NR C/L PROD HEADLAND DR @ E SIDE DRWY TO HSE #28328	Y 11042
PALOS VERDES (2005)	524.691 159.926	L&BN IN SLY CB SILVER SPUR RD E END C B 9.7M S 16.2M WLY/O C/L MARINA DR	Y 11044
PALOS VERDES (2005)	609.071 185.645	BT SPK IN CB RET NR E END C B @ NW COR 9.3M W/O C/L MIRALESTE DR (W BBL) & 4.3M N C/L VIA SIENA	Y 11045
PALOS VERDES (2005)	559.872 170.650	DPW BM TAG IN E CB 1M N BCR @ NE COR MIRALESTE DR (W BBL) & VIA COLINITA 11.5M N & 4.5M E/O C/L INT	Y 11046
PALOS VERDES (2005)	1,102.151 335.937	DPW BM TAG IN N CB 1M E/O BCR @ NE COR CREST RD & COUNTRY MEADOW RD 15.8M E & 12.2M N/O C/L INT	Y 11047
PALOS VERDES (2005)	937.602 285.782	DPW BM TAG IN W CB 1M N/O BCR @ NW COR CREST RD & HAWTHORNE BLVD 20.7M N & 12.2M W/O C/L INT	Y 11048
PALOS VERDES (2005)	296.566 90.394	L&T IN W CB NR BCR @ NW COR HAWTHORNE BLVD & VIA RIVERA 24M N & 6M W/O C/L INT	Y 11049
PALOS VERDES (2005)	303.907 92.631	CSBM MON 1M(3.3FT) S/O S CF @ C. B. 18M(59FT) S/O C/L PALOS VERDES DR N & 11M(36FT) E/O ELY MOST DRWY TO ROLLING HILLS CHURCH #2222 MKD (BM 49-13 1964 RE 5869)	Y 11258
PALOS VERDES (2005)	302.121 92.087	DPW BM TAG IN S CB MEDIAN 300MM W/O BCR 10M N C/L PALOS VERDES DR N & 18M W/O C/L VIA ALAMEDA	Y 11259
PALOS VERDES (2005)	332.808 101.440	DPW BM TAG IN E CB 1M(3.3FT) N/O BCR @ NE COR PALOS VERDES DR W & VIA MONTE MAR	Y 11260
PALOS VERDES (2005)	164.963 50.281	USGS MON IN LRG ROCK NR CTR OF MEDIAN 4.6M(15FT) N/O S CB MEDIAN 500M(0.3MI) W/O C/L CRESTMONT LN ON PALOS VERDES DR S MKD (Y 1312 1978) MKR 2FT E/O MON	Y 11262
PALOS VERDES (2005)	242.953 74.052	DPW BM TAG IN S CB @ BCR @ SE COR PALOS VERDES DR S & BARKENTINE RD (N)	Y 11263
PALOS VERDES (2005)	220.075 67.079	DPW BM TAG IN S CB 1M(3.3FT) W/O BCR @ SW COR PALOS VERDES DR S & SEACOVE DR	Y 11264
PALOS VERDES (2005)	160.523 48.928	DPW BM TAG IN S CB 150MM(0.5FT) W/O BCR @ SW COR PALOS VERDES DR S & NARCISSA DR	Y 11265
PALOS VERDES (2005)	329.078 100.303	DPW BM TAG IN S CB 31M(100FT) W/O BCR @ SW COR 25TH ST & PATTON AVE (@ LT STD)	Y 11267

QUAD YEAR	ELEV FOOT/METER	DESCRIPTION	BM NUMBER
PALOS VERDES (2005)	90.033 27.442	L&T IN S CB 700MM(2.3FT) E/O BCR @ SE COR 24TH ST & GRAND AVE @ PARK	Y 11268
PALOS VERDES (2005)	70.747 21.564	DPW BM TAG IN S CB 1M(3.3FT) W/O BCR @ SW COR PACIFIC AVE & HAMILTON AVE	Y 11269
PALOS VERDES (2005)	70.259 21.415	L&T IN E CB 1M(3.3FT) S/O BCR @ SE COR PACIFIC AVE & 20TH ST	Y 11270
PALOS VERDES (2005)	55.810 17.011	SPK IN S CB @ W END C. B. @ SW COR 15TH ST & BEACON ST	Y 11271
PALOS VERDES (2005)	40.281 12.278	L&T IN E CB HARBOR BLVD 9M(29.5FT) E/O C/L NR C/L PROD GULCH RD	Y 11272
PALOS VERDES (2005)	431.455 131.508	L&T IN ELY CB C/L MEDIAN 600MM(2FT) E/O C/L WESTERN AVE @ BC 483M(0.3MI) N/O C/L DODSON AVE	Y 11273
PALOS VERDES (2005)	423.290 129.019	DPW BM TAG IN E CB 300MM(1FT) S/O BCR @ SE COR 9TH ST & WESTERN AVE	Y 11274
PALOS VERDES (2005)	329.780 100.517	L&BN IN N CB 5M(16.5FT) E/O BCR @ NE COR WESTERN AVE & 1ST ST	Y 11275
PALOS VERDES (2005)	491.686 149.866	DPW BM TAG IN E CB PALOS VERDES DR E 7.5M S/O C/L & 3.4M E/O C/L DRWY TO HSE #27804	Y 11276
PALOS VERDES (2005)	726.269 221.367	CSBM MON IN SE COR OF DECORATIVE ROCK PILLAR @ NW COR PALOS VERDES DR E & HEADLAND DR (W) 4M W & 20M N/O C/L INT MKD (BM 36-6A 1975 RE 7078)	Y 11277
PALOS VERDES (2005)	715.008 217.935	L&T E CB 600MM N BCR @ NE COR PALOS VERDES DR (E) & MIRALESTE PLAZA 22M N & 5.4M E/O C/L INT	Y 11278
PALOS VERDES (2005)	848.936 258.756	DPW BM TAG IN DRWY CB @ HSE #4525 PALOS VERDES DR E 11M W/O C/L & 39M N/O C/L LA VISTA VERDE	Y 11279
PALOS VERDES (2005)	735.350 224.135	DPW BM TAG IN N END C B 5.5M W/O C/L PALOS VERDES DR E & 322M S/O C/L VISTA DEL MAR	Y 11280
PALOS VERDES (2005)	585.415 178.435	DPW BM TAG IN CONC HDWL NR SLY END 7.3M WLY/O C/L PALOS VERDES DR E & 1.75K S/O VISTA DEL MAR	Y 11281
PALOS VERDES (2005)	509.726 155.365	DPW BM TAG IN CONC HDWL NR SLY END 7.3M WLY/O C/L PALOS VERDES DR E & 1.75K S/O VISTA DEL MAR	Y 11282
PALOS VERDES (2005)	483.103 147.250	DPW BM TAG IN E CB 1M N BCR @ NE COR MIRALESTE DR & CHANDELEUR DR 16M N & 12M E/O C/L INT	Y 11283
PALOS VERDES (2005)	988.098 301.173	DPW BM TAG IN S CB HAWTHORNE BLVD 1M E/O BCR 12.8M S/O C/L & 30.5M E/O C/L SILVER SPUR RD	Y 11284
PALOS VERDES (2005)	396.898 120.975	SPK IN N END C. B. 4.3M(14FT) S/O BCR @ SW COR WESTERN AVE & BYNNER AVE	Y 11285
PALOS VERDES (2005)	367.486 112.010	DPW BM TAG IN S END OF CROSS GUTTER @ ENT TO RECYCLE CENTER 26301 CRENSHAW BLVD 18M W/O C/L & 5M S/O C/L DRWY	Y 11286

QUAD YEAR	ELEV FOOT/METER	DESCRIPTION	BM NUMBER
BASELINE (2005)	51.474 15.689	L&DPW TAG IN W CB ESPLANADE AV 2.4M(8FT) N/O CL PROD AVENUE I	Y 12109
BASELINE (2005)	111.125 33.871	L&DPW TAG IN S CB 300MM(1FT) W/O BCR @ SW COR PACIFIC COAST HWY & VISTA DEL PARQUE (WLY)	Y 12111
BASELINE (2005)	98.574 30.045	L&DPW TAG IN S CB 8.2M(27FT) W/O BCR @ SW COR PACIFIC COAST HWY & HAWTHORNE BL	Y 12112
BASELINE (2005)	99.761 30.407	L&DPW TAG IN S CB 6.1M(20FT) E/O ECR @ SE COR PACIFIC COAST HWY & HAWTHORNE BL	Y 12113
BASELINE (2005)	83.510 25.454	L&DPW TAG IN N CB 300MM(1FT) W/O ECR @ NW COR PACIFIC COAST HWY & E ENT TO SOUTH HIGH SCHOOL	Y 12114
PALOS VERDES (2005)	58.052 17.694	L&DPW TAG IN S CB 300MM(1FT) E/O ECR @ SE COR LOMITA BL & WALNUT ST	Y 12139
PALOS VERDES (2005)	72.044 21.959	L&DPW TAG IN N CB LOMITA BL & 12.2M(40FT) W/O C/L PROD BELLA PORTE	Y 12140
PALOS VERDES (2005)	126.177 38.459	COE BR DISK IN W CB 600MM(2FT) N/O BCR @ NW COR PALOS VERDES DR (SERVICE RD) & CALLE MIRAMAR MKD (RDP 103 1988)	Y 12141
PALOS VERDES (2005)	213.659 65.123	PK&W IN W CB 300MM(1FT) S/O ECR @ SW COR PALOS VERDES DR & PASO DE LA PLAYA	Y 12142
PALOS VERDES (2005)	224.288 68.363	L&DPW TAG IN N CB PALOS VERDES DR W 6.1M(20FT) W/O DRWY @ HSE #525 @ FH	Y 12144
PALOS VERDES (2005)	416.000 126.797	L&DPW TAG IN N CB 300MM(1FT) E/O BCR @ NWLY COR PALOS VERDES DR S & PALOS VERDES DR E	Y 12145
PALOS VERDES (2005)	416.054 126.814	L&DPW TAG IN N CB 300MM(1FT) E/O BCR @ NELY COR PALOS VERDES DR S & PALOS VERDES DR E	Y 12146
PALOS VERDES (2005)	405.074 123.467	L&DPW TAG IN S CB 300MM(1FT) E/O ECR @ SE COR PALOS VERDES DR S & LA ROTONDA DR	Y 12147
PALOS VERDES (2005)	390.487 119.021	L&TAG (# ILLEGIBLE) IN S CB 7.6M(25FT) W/O BCR @ SW COR 25TH ST & GUNNELL AV	Y 12148
PALOS VERDES (2005)	376.368 114.717	L&T IN S CB 300MM(1FT) E/O ECR @ SE COR 25TH ST & MORAY AV	Y 12149
PALOS VERDES (2005)	272.079 82.930	L&DPW TAG IN E CB 300MM(1FT) N/O ECR @ NE COR PALOS VERDES DR W & ALIDA DR	Y 12150
PALOS VERDES (2005)	170.677 52.023	L&DPW TAG IN S CB 13.7M(45FT) E/O C/L MOST SLY DRWY TO POINT VICENTE PARK & LIGHT HSE @ #31550 PALOS VERDES DR S	Y 12151
PALOS VERDES (2005)	157.994 48.157	L&BR IN S CB PALOS VERDES DR S & 548M(1800FT) W/O C/L CRESTMOUNT LN & 1.2M(4FT) W/O C.B.	Y 12152
PALOS VERDES (2005)	205.004 62.485	L&DPW TAG IN S CB 300MM(1FT) W/O BCR @ SW COR PALOS VERDES DR S & CRESTMOUNT LN	Y 12153
PALOS VERDES (2005)	232.770 70.949	L&DPW TAG IN N CB 300MM(1FT) W/O ECR @ NW COR PALOS VERDES DR S (SERVICE RD) & SCHOONER RD	Y 12154

QUAD YEAR	ELEV FOOT/METER	DESCRIPTION	BM NUMBER
PALOS VERDES (2005)	10.691 3.259	L&DPW TAG IN E CB 300MM(1FT) N/O ECR @ NE COR SIGNAL ST & SSND ST	Y 12155
PALOS VERDES (2005)	10.926 3.330	L&DPW TAG IN E CB 300MM(1FT) S/O BCR @ SE COR SIGNAL ST & 22ND ST	Y 12156
BASELINE (2005)	179.420 54.687	L&T IN CONC NR LT STD 600MM(2FT) S/O CF OF SLY CB RET ON C/L PROD S GAFFEY ST (TO THE NORTH) & HAMILTON PL @ HSE #715	Y 12157
BASELINE (2005)	78.904 24.050	L & RCE CITY ENG TAG IN E CB 300MM(1FT) S/O BCR @ SE COR PACIFIC AV & 15TH ST	Y 12158
PALOS VERDES (2005)	262.157 79.906	L&N IN N CB 600MM(2FT) W/O ECR @ NW COR 25TH ST & LELAND AV	Y 12159
PALOS VERDES (2005)	384.024 117.051	L&DPW TAG IN N CB 300MM(1FT) W/O ECR @ NW COR 25TH ST & CONSTELLATION WY	Y 12160
BASELINE (2005)	24.210 7.379	L&DPW TAG IN E CB OF PLANTER NR ENTRANCE TO 3171 N GAFFEY ST 15.2M(50FT) W/O C/L (6.1M(20FT) N/O & 4.6M(15FT) W/O PP#391286M)	Y 12161
BASELINE (2005)	25.062 7.639	L&DPW TAG IN CONC BASE OF SLY GATE POST @ ENT TO 3181 N GAFFEY ST (HARBOR CITY LITTLE LEAGUE PARK) 15.2M(50FT) W/O C/L (4.6M(15FT) S/O & 4.6M(15FT) W/O PP#17544M)	Y 12162
BASELINE (2005)	30.784 9.383	L&DPW TAG IN W CB 300MM(1FT) N/O BCR @ NW COR N GAFFEY ST & WESTMONT DR	Y 12163
BASELINE (2005)	29.483 8.986	L&DPW TAG IN W CB 300MM(1FT) S/O ECR @ SW COR N GAFFEY ST & WESTMONT DR	Y 12164
BASELINE (2005)	11.753 3.582	L&SPK IN E CB 300MM(1FT) N/O ECR @ NE COR N GAFFEY ST & BATTERY ST	Y 12165
BASELINE (2005)	12.178 3.712	L&SPK IN E CB 1.5M(5FT) S/O BCR @ SE COR N GAFFEY ST & BATTERY ST	Y 12166
BASELINE (2005)	13.066 3.983	SPK IN N CB OF MOST NLY ENT TO PARKING LOT 18.3M(60FT) W/O C/L SAMPSON WY 183M(600FT) S/O C/L 6TH ST 30.5M(100FT) S/O S SIDE ACAPULCO RESTAURANT (ACROSS FROM)	Y 12167
BASELINE (2005)	16.498 5.029	L&DPW TAG IN W CB 4.6M(15FT) S/O ECR @ SW COR N HARBOR BL & N BEACON ST @ S END OF C.B.	Y 12168
BASELINE (2005)	28.598 8.717	RR SPK IN E CB 7.6M(25FT) E/O C/L N GAFFEY ST 483M(0.3MI) N/O C/L WESTMONT DR 1.5M(5FT) W/O PP#54755M	Y 12169
BASELINE (2005)	21.468 6.543	L&DPW TAG IN E CB 300MM(1FT) S/O BCR @ SE COR PACIFIC COAST HWY & VERMONT AV	Y 12170
BASELINE (2005)	43.796 13.349	L&DPW TAG IN E CB VERMONT AV 15.2M(50FT) S/O C/L OF MOST SLY ENT TO KEN MALLOY HARBOR REG PARK IN S WALL C.B. NR INT NORMANDIE AV	Y 12171
PALOS VERDES (2005)	428.668 130.658	L&DPW TAG IN E CB @ 2020 S WEATERN AV (THE ESTATES) 91M(300FT) S/O C/L 19TH ST @ FH	Y 12172

QUAD YEAR	ELEV FOOT/METER	DESCRIPTION	BM NUMBER
PALOS VERDES (2005)	12.489 3.807	L&DPW TAG IN E CB 300MM(1FT) N/O ECR @ NE COR SAMPSON WY & NAGOYA WY	Y 12173
PALOS VERDES (2005)	151.269 46.107	L&DPW TAG IN N CB 300MM(1FT) E/O BCR @ NE COR PALOS VERDES DR N & SENATOR AV	Y 12174
PALOS VERDES (2005)	364.628 111.139	L&DPW TAG IN W CB 3M(10FT) S/O BCR @ NW COR PALOS VERDES DR N & PALOS VERDES DR E	Y 12175
PALOS VERDES (2005)	320.542 97.701	L&MWD TAG (MKD POT) IN W CB C/L MEDIAN MONTECILLO DR 30.5M(100FT) N/O C/L PALOS VERDES DR N & 15.2M(50FT) N/O S END OF MEDIAN	Y 12176
PALOS VERDES (2005)	846.117 257.897	L&DPW TAG IN NW COR C.B. 6.1M(20FT) E/O C/L PALOS VERDES DR E & 27.4M(90FT) S/O C/L ROCKINGHORSE RD	Y 12177
PALOS VERDES (2005)	629.028 191.728	SPK & DPW W ON TOP OF GUARD RAIL POST NR N END 13.7M(45FT) S/O & 4.6M(15FT) E/O C/L INT PALOS VERDES DR E & SUNNYSIDE RIDGE	Y 12178
PALOS VERDES (2005)	619.373 188.785	L&DPW TAG IN SE COR C.B. 33.5M(110FT) N/O & 6.1M(20FT) W/O C/L INT PALOS VERDES DR E & SUNNYSIDE RIDGE	Y 12179
PALOS VERDES (2005)	346.363 105.572	L&T IN E CB 12.2M(40FT) S/O BCR @ SE COR WESTERN AV & SUMMERLAND AV	Y 12180
PALOS VERDES (2005)	518.256 157.965	L&T IN E CB 300MM(1FT) N/O BCR @ SE COR MIRALESTE DR & 1ST ST NR END OF CB	Y 12181
PALOS VERDES (2005)	520.171 158.549	L&T IN E CB 300MM(1FT) S/O ECR @ NE COR MIRALESTE DR & 1ST ST NR END OF CB	Y 12182
PALOS VERDES (2005)	720.903 219.732	L&DPW TAG IN E CB PALOS VERDES DR E 4.6M(15FT) S/O C/L DR TO HSE#4224 61M(200FT) N/O C/L CORSINI PL	Y 12183
PALOS VERDES (2005)	813.957 248.095	L&T IN E CB PALOS VERDES DR E (SERVICE RD) 300MM(1FT) N/O ECR @ NW COR INT GANADO DR	Y 12184
PALOS VERDES (2005)	460.962 140.502	L&DPW TAG IN N CB PALOS VERDES DR N 300MM(1FT) E/O BCR @ NE COR TO ENT DAPPLEGRAY SCHOOL 0.2MI W/O C/L STRAWBERRY LN	Y 12185
PALOS VERDES (2005)	424.891 129.507	L&DPW TAG IN NLY CB 300MM(1FT) E/O BCR @ NE COR PALOS VERDES DR N & CRENSHAW BL	Y 12186
PALOS VERDES (2005)	332.262 101.274	SPK IN NW COR CONC LACFCD CLEAN OUT STRUCTURE 13.7M(45FT) E/O & 12.2M(40FT) S/O C/L INT CRENSHAW BL & HIDDEN LN 1.2M(4FT) E/O CF & 4.6M(15FT) S/O C.B.	Y 12187
PALOS VERDES (2005)	409.274 124.747	L&DPW TAG IN N CB 7.6M(25FT) W/O ECR @ NW COR PALOS VERDES DR N (N BARREL) & VIA LAS VEGAS	Y 12188
PALOS VERDES (2005)	1,204.862 367.243	L&DPW TAG IN E CB 300MM(1FT) N/O ECR @ NE COR CRENSHAW BL & CREST RD	Y 12189
PALOS VERDES (2005)	854.081 260.325	L&DPW TAG IN E CB 300MM(1FT) N/O ECR @ NE COR HAWTHORNE BL & RHONE DR	Y 12190

QUAD YEAR	ELEV FOOT/METER	DESCRIPTION	BM NUMBER
PALOS VERDES (2005)	851.309 259.480	L&LS#5411 TAG IN E CB 600MM(2FT) S/O BCR @ SE COR HAWTHORNE BL & RHONE DR	Y 12191
PALOS VERDES (2005)	13.553 4.131	COPPER BOLT AND DISC IN FLOOR OF WHARF 77FT S/O SW COR OF WHAREHOUSE @ BERTH #60 26FT E/O SW COR OF WHARF DESIGNATED TIDAL 8 BY USC&GS MKD (8 14FT ABOVE MLLW)	Y TIDAL 8