

**LOS ANGELES COUNTY**  
**DEPARTMENT OF PUBLIC WORKS**  
**BENCH MARK LIST**



**SANTA FE QUAD**

**2005 ADJUSTMENT**  
**2005 BASELINE**  
**NAVD 88 DATUM**

## PREFACE

The Department of Public Works level net is composed of more than 1,700 miles or 2720 kilometers of levels supporting in excess of 9,000 bench marks. Previously when a major readjustment of the net was undertaken, to emphasize the complete break with previous elevations, the CY, CG, & CL, series bench marks were re-labeled DY, DG, & DL, respectively. Beginning in 1993 the baseline readjustment year will be indicated on baseline BM, s only indicated below (\*). Henceforth all BM numbers will be labeled as a Y, G, or L, series that will no longer indicate the major adjustment year.

To facilitate the adjustment, indexing and distribution of adjusted values of the net, the county territory was divided into 33 quads or areas. For the identification purposes each quad was given a name, viz., "Rosemead," "La Mirada," "Santa Fe," etc. When bench marks and elevations in these quads are used, the name must be included in the bench mark description, e.g.,

\* BASELINE 90.057 L&BR IN CTR OF CB RET @ NE COR Y 9191  
(1990) 295.461 LA HABRA BLVD & VALLEY HOME AVE  
10.7M N & 10.7M E/O C/L INT

It is expected that this general adjustment will for the most part remain sound for 8 to 12 years. Updating constrained adjustments will continue in the future. When a quad is readjusted, new elevations will be published and the date of readjustment will be noted in the bench mark description. Two bench marks with different adjustment dates will not normally agree with each other.

The basic accuracy of the net is reflected by an indicated field probable error of plus or minus 4mm per kilometer of leveling as determined from the conditions of closure. However, many years of experience in vertical control in the greater Los Angeles basin and Antelope Valley indicate that because of varying degrees of subsidence and heaving, the true datum is recovered only by obtaining substantial agreement of a number of bench marks.

The users of this net are invited to assist in its maintenance by notifying this department of cases of obliteration, apparent mistakes in description or elevations, and proven disturbance of bench marks.

---

DATUM: North American Vertical Datum of 1988 (NAVD88)

Note: NAVD 1988 minus approximately 700mm (2.3ft) equals  
Previous NGVD 1929 Datums. For more accurate equations  
At individual bench marks refer to previous publications

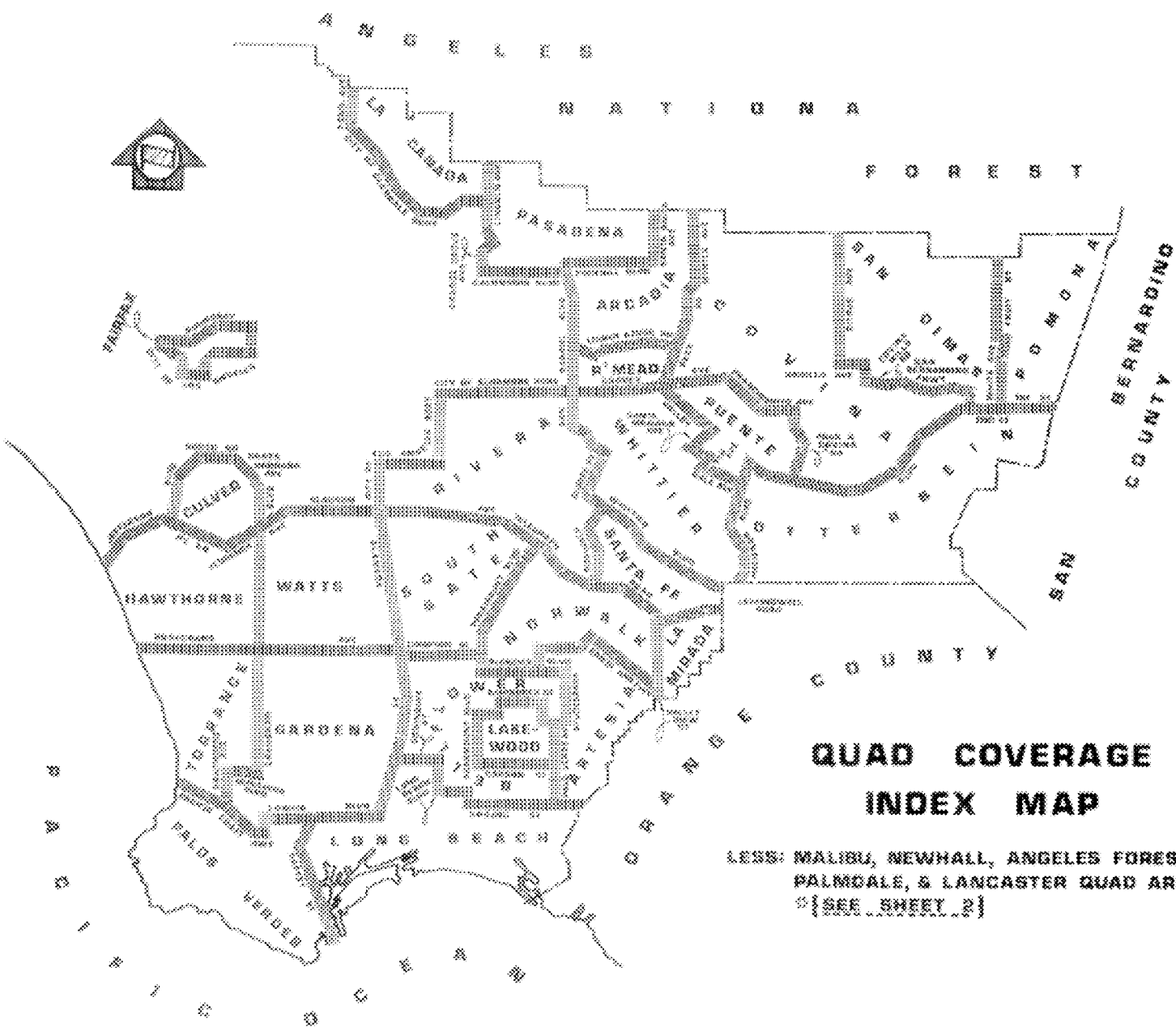

**QUAD COVERAGE  
INDEX MAP**

LESS: MALIBU, NEWHALL, ANGELES FOREST,  
PALMDALE, & LANCASTER QUAD AREAS.  
☉ [SEE SHEET 2]

K E R N C O U N T Y

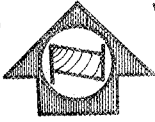
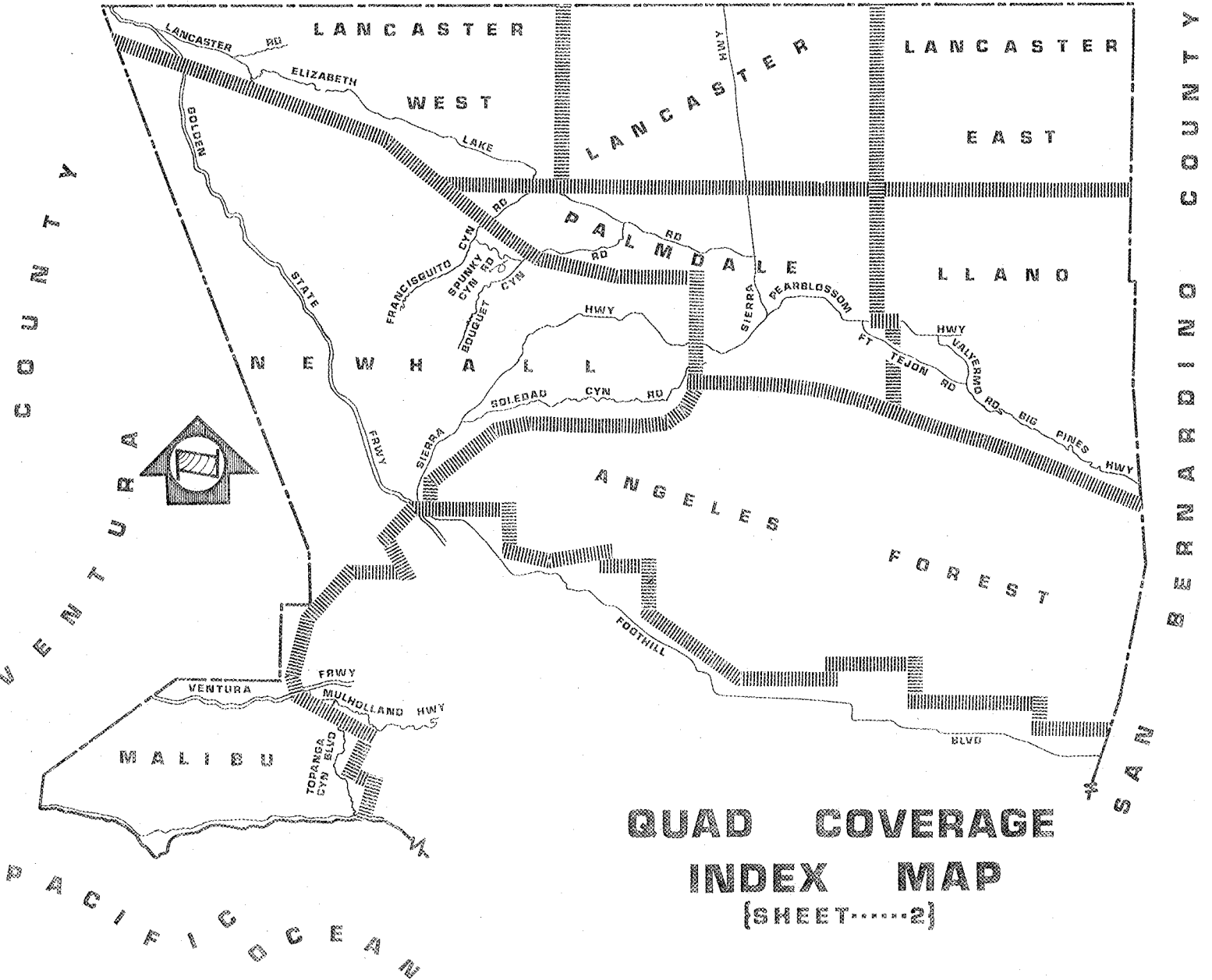

## ABBREVIATIONS USED IN BENCH MARK LISTINGS

ABUT -----	Abutment	LT -----	Left
ALG -----	Along	LACE -----	L.A. City Engineer
ANG PT -----	Angle Point	LACS -----	L.A. Co. Engineer
B/W -----	Back of Walk	LAFC -----	L.A. Co. Flood Control
BCR -----	Beginning of Curb Return	L&BN -----	Lead and Bench Nail
BC -----	Beginning of Curve	L&BR -----	Lead and Brad
BLDG -----	Building	L&N -----	Lead and Nail
BM -----	Bench Mark	L&SPK -----	Lead and Spike
BT SPK -----	Boat or Bolt Spike	L&T -----	Lead and Tack
BR CAP -----	Brass or Bronze Cap	MCR -----	Middle of Curb Return
C B -----	Catch Basin	MKD -----	Marked
CTR -----	Center	MC -----	Middle of Curve
C/L -----	Center Line	MON -----	Monument
C/L INT -----	Center Line Intersection	N/O -----	North of
C/L PROD ---	Center Line Produced	NR -----	Near
CONC -----	Concrete	OPP -----	Opposite
COR -----	Corner	PI -----	Point of Intersection
COE -----	Corps of Engineers	PK&W -----	PK Nail and Washer
CULV -----	Culvert	P/L -----	Property Line
CYN -----	Canyon	POST -----	Point of Semi-Tangent
CB -----	Curb	PP -----	Power Pole
CS MON -----	Co. Eng. Monument	PVMT -----	Pavement
CT SPK -----	Cut Spike	PROD -----	Produced
DPW -----	Dept. of Public Works	RD -----	Road
DR -----	Drive or Driveway	RDBM -----	Road Dept. Bench Mark
E/O -----	East of	RDBM TAG -----	Road Dept. Bench Mark Tag
ECR -----	End of Curb Return	RR -----	Railroad
EC -----	End of Curve	RT -----	Right
ENT -----	Entrance	R/W -----	Right of Way
FL -----	Floor	SDMH -----	Storm Drain Manhole
FTG -----	Footing	SMH -----	Sewer Manhole
FRWY -----	Freeway	SPK -----	Spike
F/W -----	Front of Walk	ST&W -----	Spike Tin and Washer
GAR -----	Garage	S/O -----	South of
HDWL -----	Headwall	TP -----	Telephone Pole
HSE -----	House	USC&GS -----	U.S. Coast and Geodetic Survey
HWY -----	Highway	USGS -----	U.S. Geological Survey
INT -----	Intersection	WK -----	Walk
IP -----	Iron Pipe	W/O -----	West of

# SANTA FE QUAD INDEX

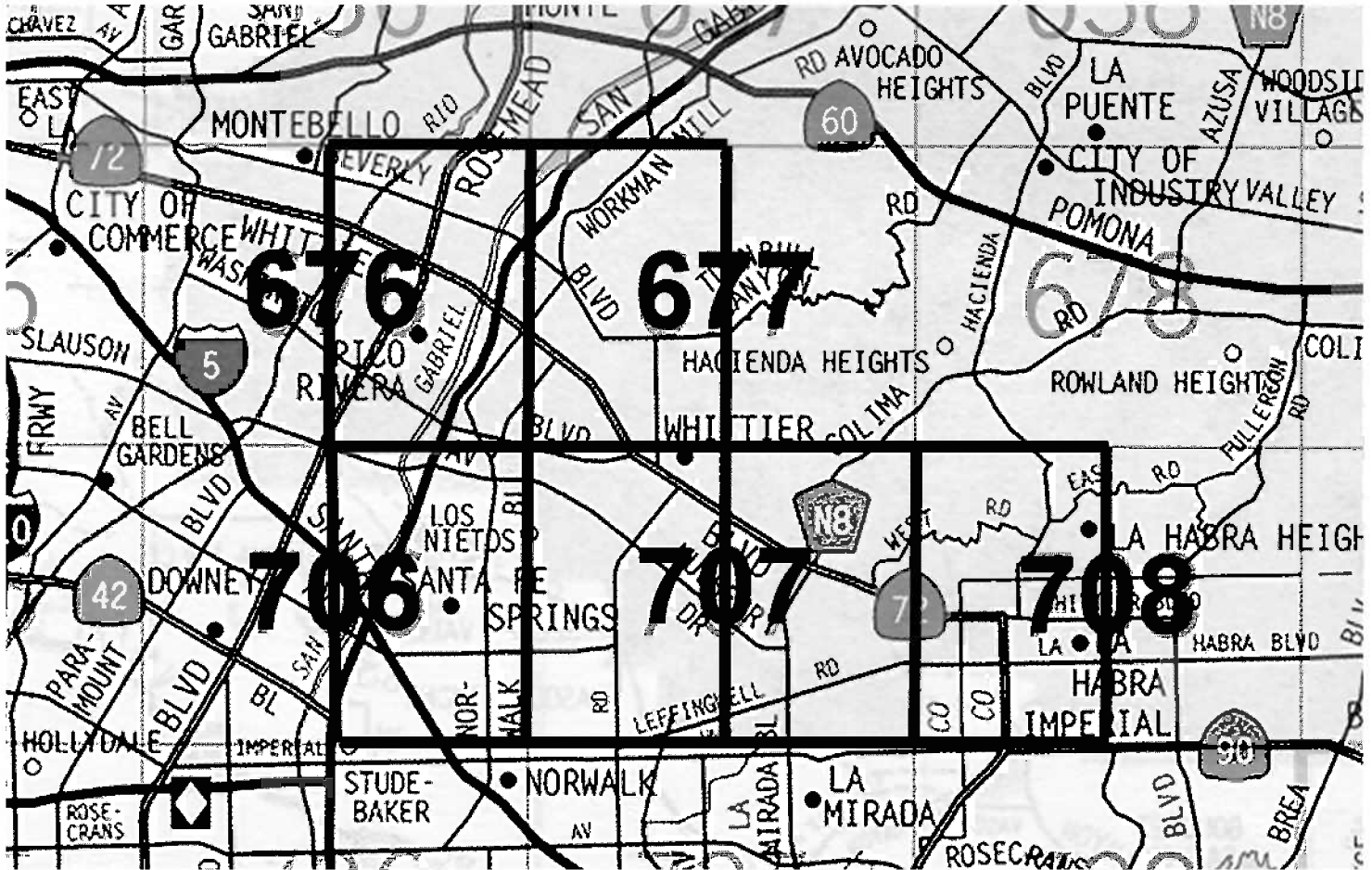

**NUMBERS REFER  
TO THOMAS BROS  
PAGE NUMBERS**

**EACH THOMAS BROS  
PAGE IS DIVIDED INTO  
TWO INDEX PAGES  
EAST AND WEST**

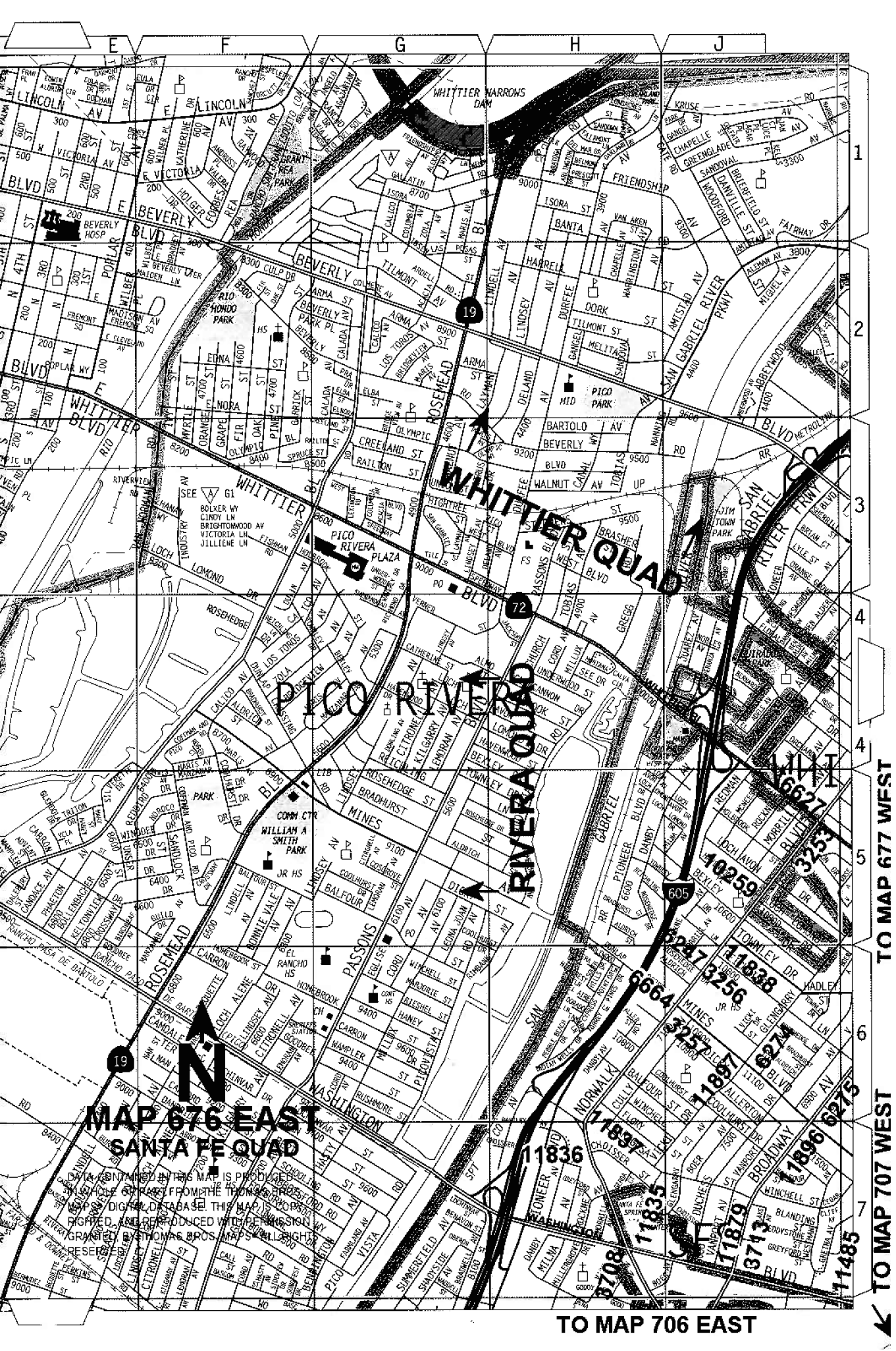

**MAP 676 EAST  
SANTA FE QUAD**

DATA CONTAINED IN THIS MAP IS PRODUCED  
WHOLE OR IN PART FROM THE THOMAS BROS.  
MAPS DIGITAL DATABASE. THIS MAP IS  
RIPPED, AND REPRODUCED WITH PERMISSION  
GRANTED BY THOMAS BROS. MAPS. ALL RIGHTS  
RESERVED.

**TO MAP 706 EAST**

**TO MAP 677 WEST**

**TO MAP 707 WEST**

**11485**

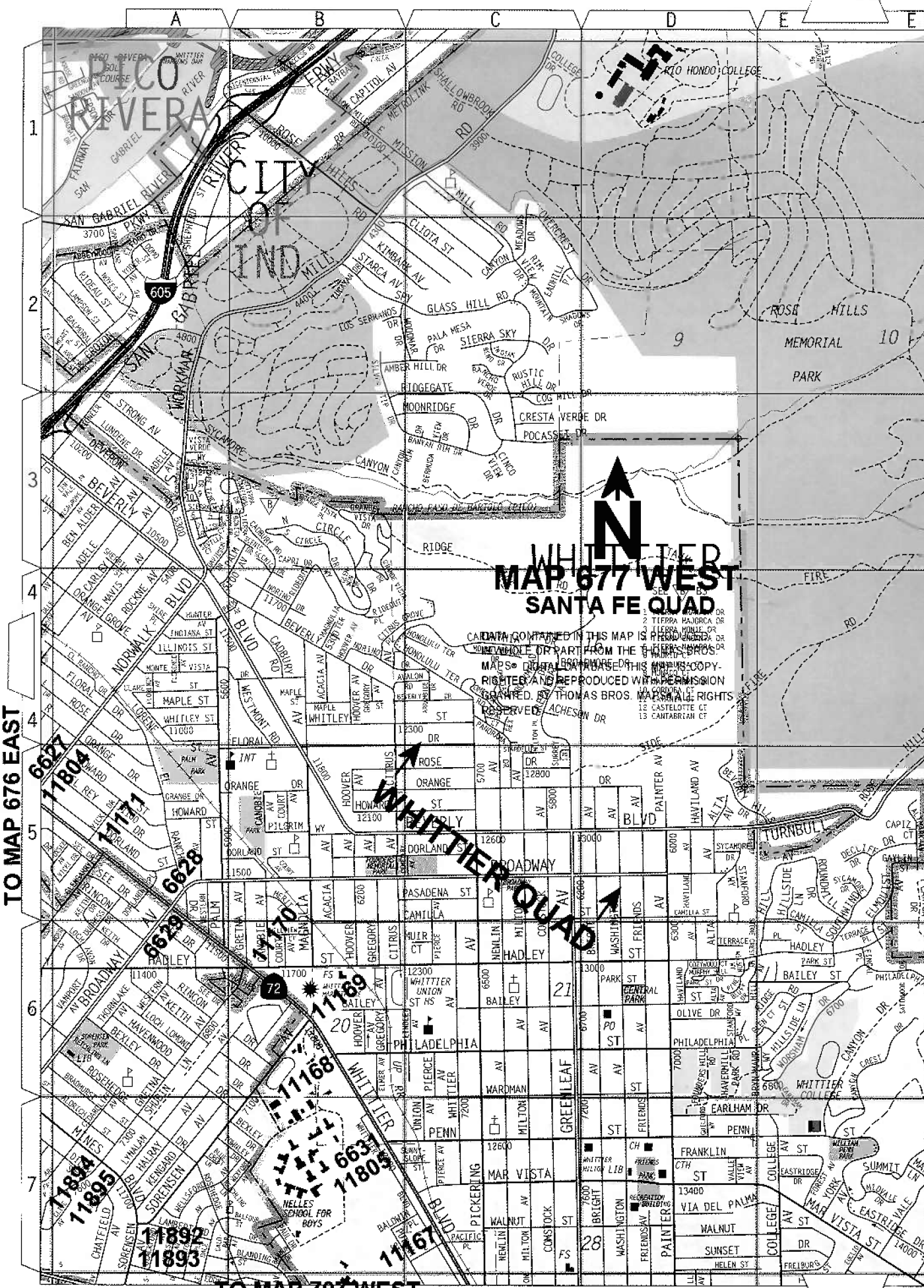

**WHITTIER  
MAP 677 WEST  
SANTA FE QUAD**

DATA CONTAINED IN THIS MAP IS ENTIRELY OR PARTLY FROM THE U.S. GEOLOGICAL SURVEY'S DIGITAL DATA. THIS MAP IS COPYRIGHTED AND REPRODUCED WITH PERMISSION GRANTED BY THOMAS BROS. MAPS. ALL RIGHTS RESERVED.



TO MAP 676 EAST

TO MAP 707 WEST

1  
2  
3  
4  
5  
6  
7

A

B

C

D

E

E

REVERA  
RIVERA

CITY  
OF  
IND

9

ROSE HILLS  
MEMORIAL  
PARK 10

WHITTIER QUAD

WHITTIER  
SCHOOL FOR BOYS

27

28

29

30

31

32

33

34

35

36

37

38

39

40

41

42

43

44

45

46

47

48

49

50

51

52

53

54

55

56

57

58

59

60

61

62

63

64

65

66

67

68

69

70

71

72

73

74

75

76

77

78

79

80

81

82

83

84

85

86

87

88

89

90

91

92

93

94

95

96

97

98

99

100

101

102

103

104

105

106

107

108

109

110

111

112

113

114

115

116

117

118

119

120

121

122

123

124

125

126

127

128

129

130

131

132

133

134

135

136

137

138

139

140

141

142

143

144

145

146

147

148

149

150

151

152

153

154

155

156

157

158

159

160

161

162

163

164

165

166

167

168

169

170

171

172

173

174

175

176

177

178

179

180

181

182

183

184

185

186

187

188

189

190

191

192

193

194

195

196

197

198

199

200

201

202

203

204

205

206

207

208

209

210

211

212

213

214

215

216

217

218

219

220

221

222

223

224

225

226

227

228

229

230

231

232

233

234

235

236

237

238

239

240

241

242

243

244

245

246

247

248

249

250

251

252

253

254

255

256

257

258

259

260

261

262

263

264

265

266

267

268

269

270

271

272

273

274

275

276

277

278

279

280

281

282

283

284

285

286

287

288

289

290

291

292

293

294

295

296

297

298

299

300

301

302

303

304

305

306

307

308

309

310

311

312

313

314

315

316

317

318

319

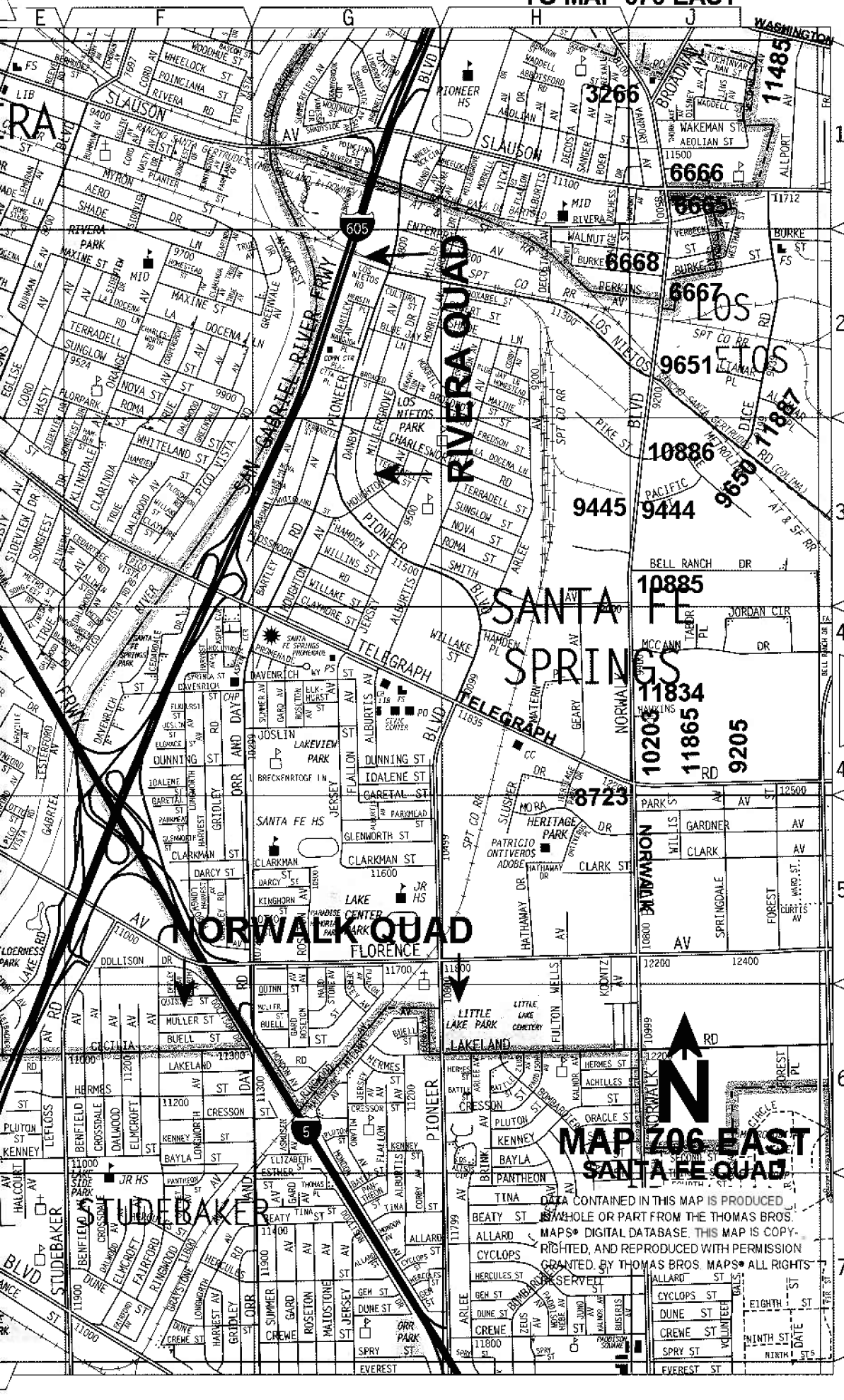

**MAP 706 EAST**  
**SANTA FE QUAD**

DATA CONTAINED IN THIS MAP IS PRODUCED BY WHOLE OR PART FROM THE THOMAS BROS. MAPS® DIGITAL DATABASE. THIS MAP IS COPYRIGHTED, AND REPRODUCED WITH PERMISSION GRANTED BY THOMAS BROS. MAPS®. ALL RIGHTS RESERVED.

# WHITTIER QUAD

# MAP 707 EAST SANTA FE QUAD

DATA OBTAINED IN THIS MAP IS PRODUCED  
IN WHOLE OR PART FROM THE THOMAS BROS.  
MAPS® DIGITAL DATABASE. THIS MAP IS COPY-  
RIGHTED AND REPRODUCED WITH PERMISSION  
GRANTED BY THOMAS BROS. MAP® ALL RIGHTS  
RESERVED

# WHITTIER

# LA MIRADA QUAD LA MIRADA



TO MAP 707 WEST

TO MAP 707 WEST

TO MAP 708 WEST

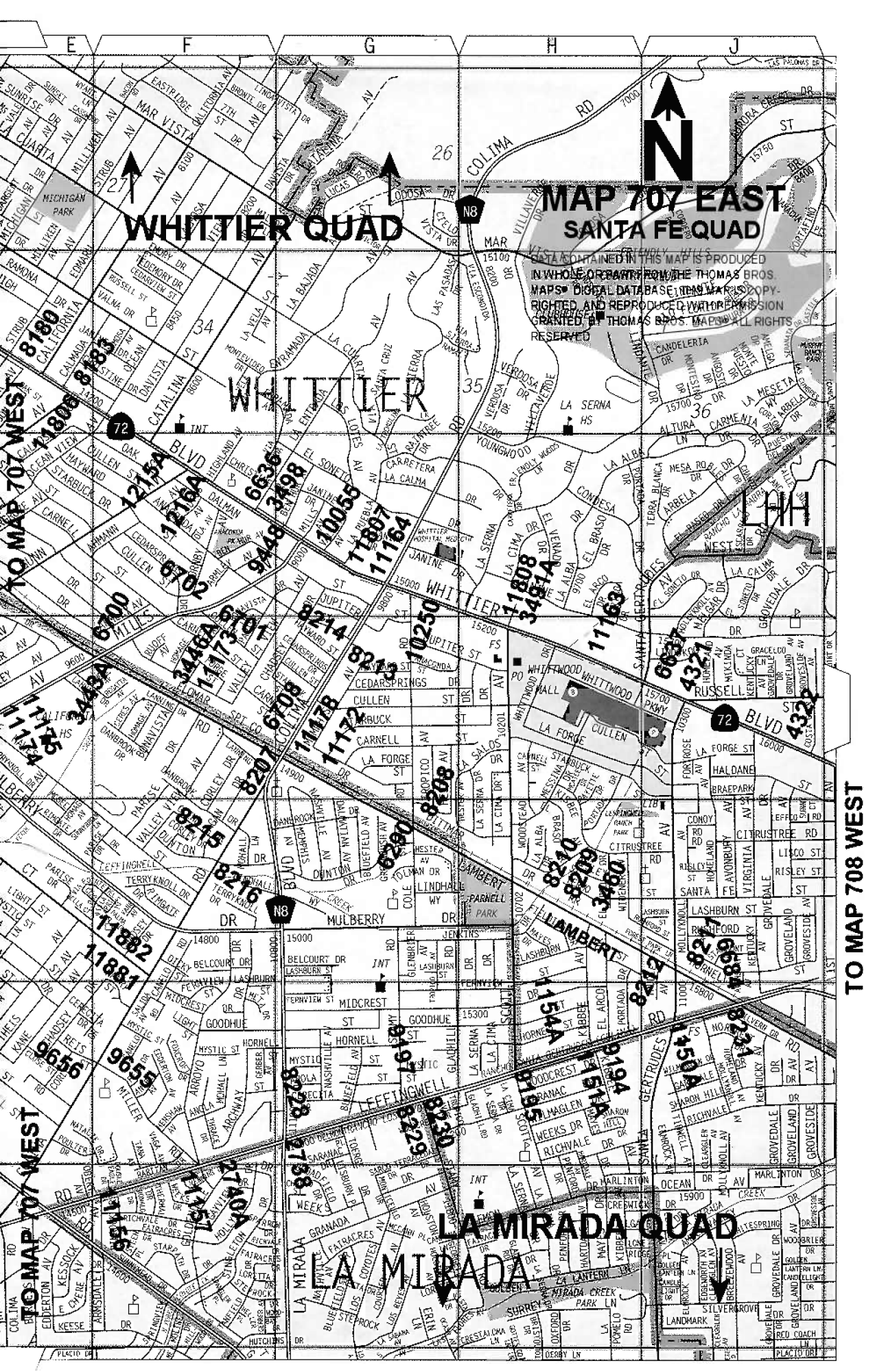

TO MAP 676 EAST

TO MAP 677 WEST

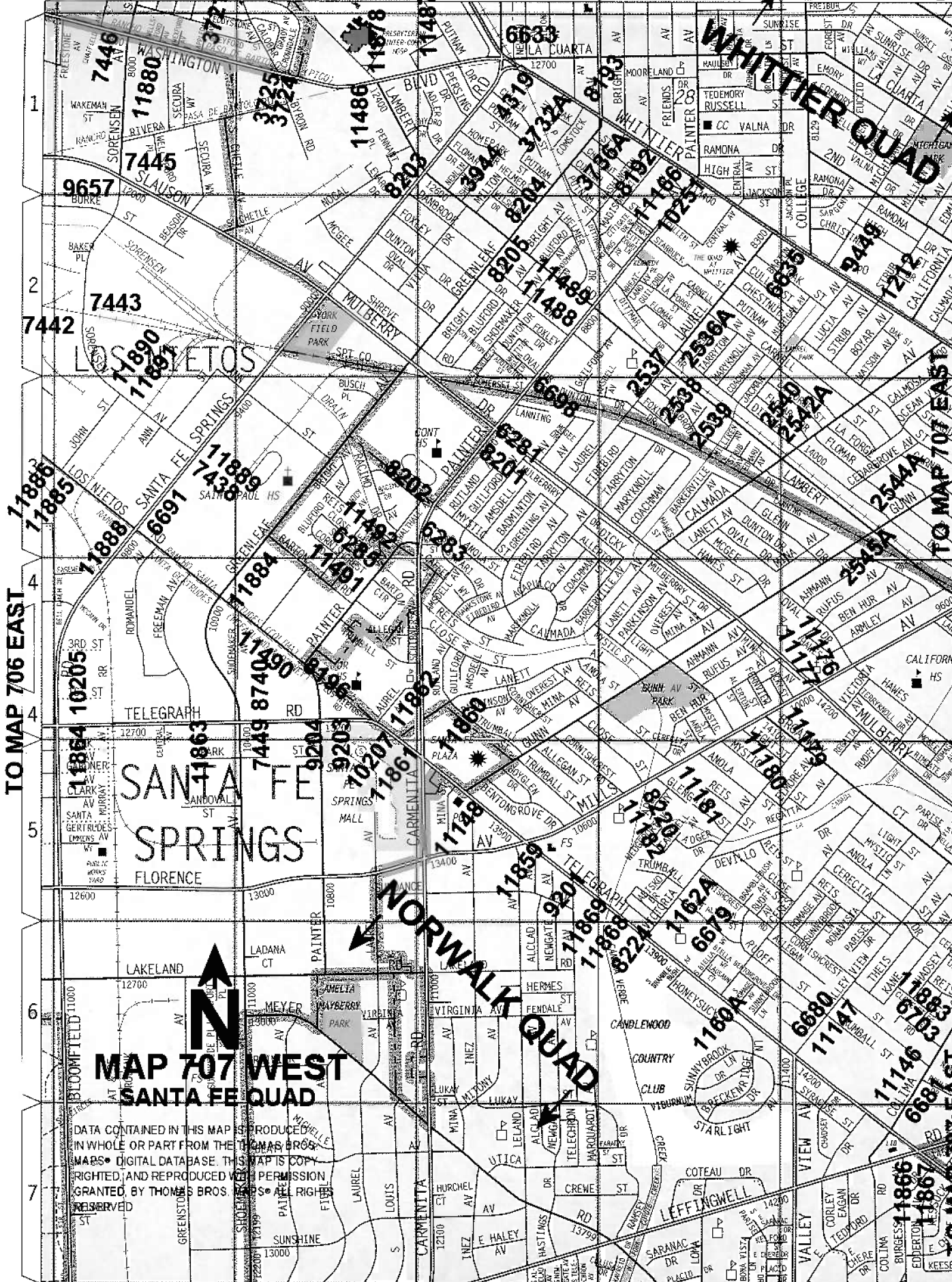

WHITTIER QUAD

LOS NIETOS

SANTA FE SPRINGS

LAKELAND  
MAP 707 WEST  
SANTA FE QUAD

NORWALK QUAD

DATA CONTAINED IN THIS MAP IS PRODUCED IN WHOLE OR PART FROM THE THOMAS BROS. MAPS® DIGITAL DATABASE. THIS MAP IS COPYRIGHTED, AND REPRODUCED WITH PERMISSION GRANTED BY THOMAS BROS. ALL RIGHTS RESERVED.

TO MAP 708 EAST  
TO MAP 709 EAST

TO MAP 707 EAST

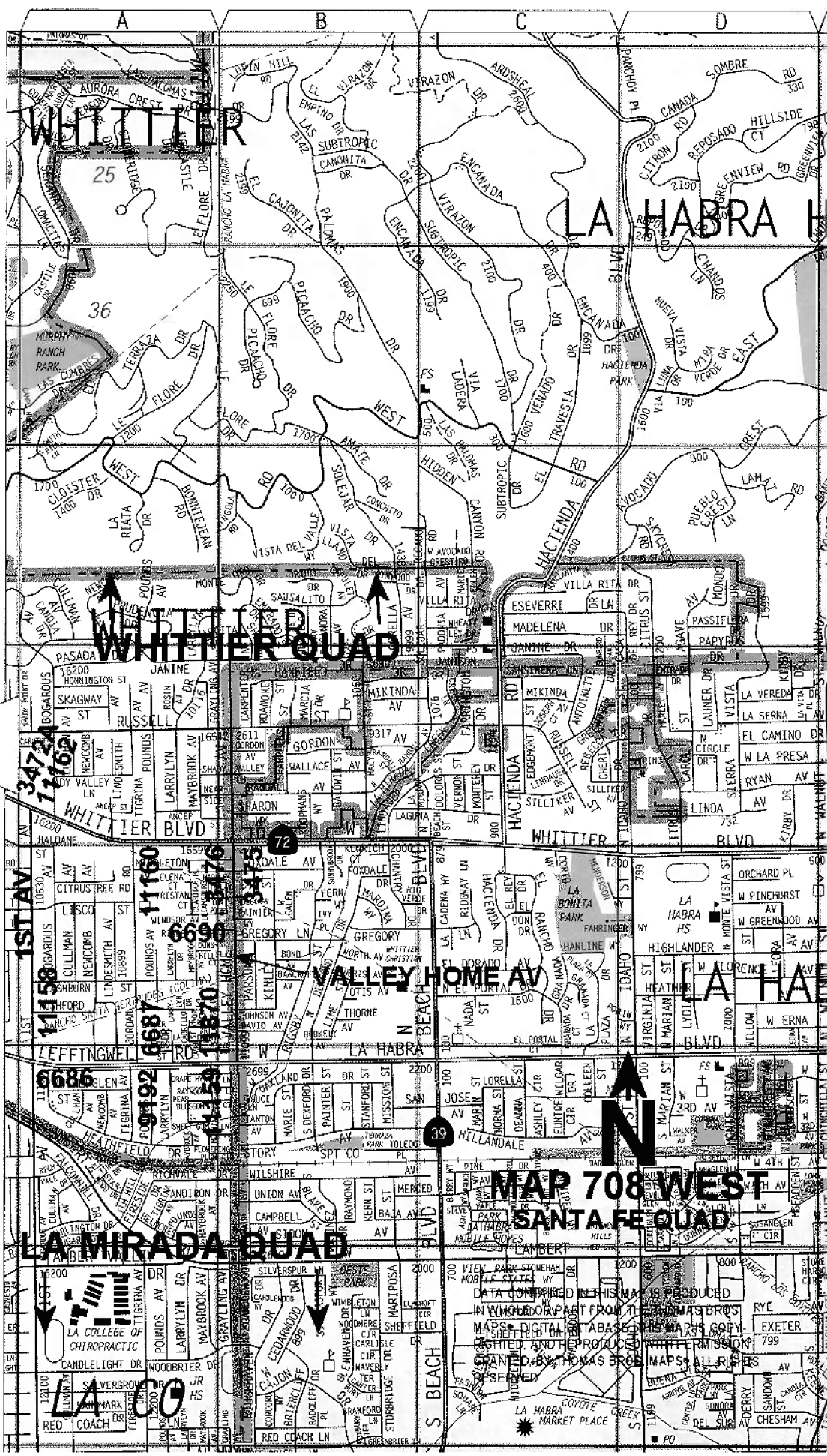

WHITTIER

LA HABRA

WHITTIER QUAD

LA MIRADA QUAD

MAP 708 WEST  
SANTA FE QUAD



DATA COMPILERS HIS MAP IS PRODUCED  
IN WHOLE OR PART FROM THE THOMAS BROS  
MAPS, DIGITAL DATABASES, AND MAPS COPY  
RIGHTED AND THE PRODUCED WITH PERMISSION  
GRANTED BY THOMAS BROS MAPS. ALL RIGHTS  
RESERVED.

LA COLLEGE OF  
CHIROPRACTIC  
CANDLELIGHT DR

LA HABRA MARKET PLACE  
COTOTE CREEK

QUAD YEAR	ELEV FOOT/METER	DESCRIPTION	BM NUMBER
BASELINE (2005)	243.473 74.211	L&BN IN N CB @ W END C. B. 11M(36FT) E/O BCR @ NE COR SANTA GERTRUDES AVE & LEFFINGWELL RD	Y 1150A
BASELINE (2005)	236.674 72.138	L&BN IN S CB LEFFINGWELL RD 12.5M(41FT) E/O C/L PROD EL ARCO DR	Y 1151A
BASELINE (2005)	230.700 70.318	CS MON IN WELL 300MM(1FT) S/O CF (IN ISLE) 13M(43FT) S/O C/L LEFFINGWELL RD OPP HSE #15462 & 188M(0.1MI) E/O SCOTT AVE MKD (RM 2 LA HABRA A 9 1960)	Y 1154A
BASELINE (2005)	177.404 54.073	L&SPK IN NELY COR IN E CB 1.2M(4FT) NLY BCR 25M(82FT) NLY C/L TELEGRAPH RD & 6M(19.7FT) ELY/O C/L CERES ST MKD (WZ)	Y 1160A
BASELINE (2005)	136.528 41.614	L&T 300MM(1FT) W/O BCR @ NW COR VICTORIA AVE & TELEGRAPH RD	Y 1162A
BASELINE (2005)	238.500 72.695	L&T IN N CB (SERV RD) @ BCR @ SW COR WHITTIER BLVD & BOYER AVE	Y 1212
BASELINE (2005)	268.273 81.770	L&SPK IN S CB WHITTIER BLVD 41.5M(136FT) E/O C/L PROD CATALINA AVE	Y 1215A
BASELINE (2005)	266.367 81.189	L&LS#5411 TAG IN S CB 300MM(1FT) W/O BCR @ SW COR WHITTIER BLVD & GUNN AVE	Y 1216A
SANTA FE (2005)	178.736 54.479	L&T IN W CB LAUREL AVE 300MM(1FT) S/O BCR @ SW COR LAMBERT RD	Y 2536A
SANTA FE (2005)	179.578 54.736	L&BN IN S CB LAMBERT RD 300MM(1FT) E/O BCR @ SE COR LAUREL AVE	Y 2537
SANTA FE (2005)	180.372 54.978	RDBM TAG IN S CB LAMBERT RD 2.4M(8FT) W/O C/L PROD TARRYTON AVE	Y 2538
SANTA FE (2005)	179.411 54.685	L&BN IN S CB LAMBERT RD 300MM(1FT) W/O BCR @ SW COR COACHMAN AVE	Y 2539
SANTA FE (2005)	181.848 55.427	L&BN IN S CB LAMBERT RD 1M(3.3FT) W/O C/L PROD EDMARU AVE (312FT W/O C/L CALMADA AVE)	Y 2540
SANTA FE (2005)	183.026 55.786	RDBM TAG IN W CB CALMADA AVE 300MM(1FT) S/O BCR @ SW COR LAMBERT RD	Y 2542A
SANTA FE (2005)	192.689 58.732	RDBM TAG IN S CB LAMBERT RD 300MM(1FT) W/O BCR @ SW COR GUNN AVE	Y 2544A
SANTA FE (2005)	194.039 59.143	L&BN IN S CB LAMBERT RD 18M(59FT) E/O BCR 9M(29.5FT) S/O C/L & 26M(85FT) E/O C/L GUNN AVE	Y 2545A
BASELINE (2005)	218.736 66.671	L&T IN CB OF DRWY 600MM(2FT) E/O BCR @ NW COR LA MIRADA BLVD & LEFFINGWELL RD	Y 2738
BASELINE (2005)	193.624 59.017	L&BN IN W END C. B. N/O C/L LEFFINGWELL RD & 39M(128FT) W/O C/L DRWY @ W END APT BLDG #14905 (490FT W/O C/L LA MIRADA BLVD)	Y 2740A
BASELINE (2005)	168.684 51.415	L&BR IN W CB 600MM(2FT) S/O BCR @ NW COR ROSEHEDGE DR & NORWALK BL	Y 3256

QUAD YEAR	ELEV FOOT/METER	DESCRIPTION	BM NUMBER
BASELINE (2005)	166.772 50.832	L&SPK IN E CB 1.5M(5FT) S/O BCR @ SE COR NORWALK BLVD & MINES BL	Y 3257
BASELINE (2005)	156.059 47.567	L&BN IN W CB 300MM(1FT) N/O BCR @ NW COR NORWALK BLVD & WADDELL ST	Y 3266
SANTA FE (2005)	196.590 59.921	L&BR IN SLY CB MILLS AVE 1.2M(3.9FT) E/O BCR @ SW COR LAMBERT RD	Y 3443A
SANTA FE (2005)	198.672 60.555	L&SPK IN ELY CB BONA VISTA LN 5.5M(18FT) E/O C/L & 26M(85FT) SLY/O C/L LAMBERT RD (8FT SLY/O BCR)	Y 3446A
SANTA FE (2005)	229.967 70.094	L&T IN SLY CB LAMBERT RD 9M(29.5FT) S/O C/L & 17M(56FT) W/O C/L KIBBEE AVE (4 FT W/O BCR)	Y 3460
BASELINE (2005)	294.297 89.702	L&SPK IN S CB 14.6M(48FT) W/O BCR @ SW COR WHITTIER BLVD & FIRST ST	Y 3472A
BASELINE (2005)	335.105 102.140	CSBM MON IN RET 4M(13FT) S/O BCR @ NE COR WHITTIER BLVD & VALLEY HOME AVE MKD (38-1 1964)	Y 3475
BASELINE (2005)	336.160 102.462	L&BN IN S END C. B. 300MM(1FT) N/O BCR @ NE COR VALLEY HOME AVE & WHITTIER BLVD	Y 3476
BASELINE (2005)	250.883 76.469	ST CAL DIV HWYS BR DISC IN E END C. B. 63M(207FT) E/O BCR 81M(266FT) E/O C/L SCOTT AVE & 11.6M(38FT) N/O C/L WHITTIER BLVD	Y 3491A
BASELINE (2005)	250.887 76.471	L&SPK IN N CB (SERV RD) 5.5M(18FT) E/O BCR @ NE COR LA ENTRADA AVE & WHITTIER BLVD (SERV RD)	Y 3498
BASELINE (2005)	159.851 48.723	RAMSET IN W CB 900MM(3FT) N/O BCR @ NW COR WASHINGTON BL & NORWALK BL	Y 3708
SANTA FE (2005)	156.700 47.762	L&T IN N CB 4.6M(15FT) E/O BCR @ NW COR WASHINGTON BLVD & BROADWAY MKD (BM)	Y 3713
SANTA FE (2005)	156.308 47.643	RDBM TAG IN N CB 300MM(1FT) W/O BCR @ NW COR WASHINGTON BLVD & APPLIEDALE AVE	Y 3721
SANTA FE (2005)	158.306 48.252	L&BN 300MM(1FT) W/O BCR IN N CB OF PKWY @ NW COR WASHINGTON BLVD & CROWDALE AVE 15M(50FT) N/O & 12.3M(40FT) W/O C/L INT	Y 3724
SANTA FE (2005)	158.859 48.420	L&BN IN N CB 300MM(1FT) E/O BCR @ NE COR WASHINGTON BLVD & CROWDALE AVE	Y 3725
BASELINE (2005)	222.363 67.776	RDBM TAG E CB RET 300MM(1FT) N/O BCR @ SE COR WHITTIER BLVD & COMSTOCK AVE	Y 3732A
BASELINE (2005)	233.516 71.176	RDBM TAG IN CB RET 1M(3.3FT) N/O BCR @ SE COR WHITTIER BLVD & WASHINGTON AVE	Y 3736A
SANTA FE (2005)	173.691 52.941	RAM SET IN N CB LAMBERT RD 600MM(2FT) E/O BCR @ NE COR NEWLIN AVE	Y 3944

QUAD YEAR	ELEV FOOT/METER	DESCRIPTION	BM NUMBER
BASILINE (2005)	212.634 64.811	RDBM TAG IN W END OF CONC BASE OF CTR PIER UPRR BRIDGE OVER WHITTIER BLVD 5M(16.4FT) N/O S CF & 46M(151FT) E/O C/L WASHINGTON BLVD (NR C/L PROD ALLEY TO THE N)	Y 4319
BASILINE (2005)	281.266 85.730	RDBM TAG IN TOP OF & @ E END OF CONC RET WALL 2.4M(8FT) N/O CF WHITTIER BLVD & 30.5M(100FT) NELY OF PROD RUSSELL ST	Y 4321
BASILINE (2005)	281.373 85.763	STATE HWY BR CAP IN N CB WHITTIER BLVD @ W END C. B. & 5.5M(18FT) W/O C/L PROD VIRGINIA AVE	Y 4322
BASILINE (2005)	168.730 51.429	CO ENGR BRASS CAP IN N END C. B. 7.4M(24.3FT) W/O BCR @ NW COR NORWALK BLVD & ROSEHEDGE DR MKD (BM 2-16 1961 RE 5869)	Y 6247
SANTA FE (2005)	163.305 49.776	L&T IN SLY CB 6FT ELY/O BCR @ SELY COR MINES BLVD & GLANGARRY AVE	Y 6274
SANTA FE (2005)	163.078 49.706	BT SPK IN NLY CB 4FT WLY/O BCR @ N WLY COR MINES BL & BROADWAY (SD 1518)	Y 6275
SANTA FE (2005)	146.999 44.805	BT SPK IN E CB PAINTER AVE 15M(49FT) S/O BCR @ SE COR MULBERRY DR MKD (SD 1619)	Y 6281
SANTA FE (2005)	140.970 42.968	RD HD SPK IN N CB MYSTIC ST 2M(6.5FT) E/O BCR @ NE COR PAINTER AVE (SD 1617)	Y 6283
SANTA FE (2005)	143.454 43.725	RDBM TAG S END OF BRIDGE 6M(20FT) W/O C/L PAINTER AVE & 117M(384FT) S/O REIS ST	Y 6285
SANTA FE (2005)	208.550 63.566	RDBM TAG IN W CB COLE RD 22M(72FT) S/O C/L PROD DITTMAR DR (@ N END C. B.) N/O LAMBERT RD	Y 6290
BASILINE (2005)	179.527 54.720	RDBM TAG IN W CB 11.3M(37FT) N/O BCR @ NW COR NORWALK BLVD & WHITTIER BLVD	Y 6627
BASILINE (2005)	203.525 62.035	CS MON FL 300MM(1FT) E/O E CF BROADWAY 8.8M(29FT) E/O C/L & 33M(108FT) N/O C/L WHITTIER BLVD MKD (BM 1-15A 1961)	Y 6628
BASILINE (2005)	200.667 61.163	L&T IN N CB 150MM(0.5FT) E/O BCR @ NW COR WHITTIER BLVD & BROADWAY	Y 6629
BASILINE (2005)	231.724 70.630	RDBM TAG IN NLY CB (SERV RD) WHITTIER BLVD 38M(125FT) W/O C/L NR C/L PROD PENN ST	Y 6631
BASILINE (2005)	215.048 65.547	CS MON IN N END C. B. 6M(20FT) N/O BCR 18M(59FT) E/O C/L WHITTIER BLVD & 27M(88FT) W/O C/L PICKERING AVE MKD (BM 1-14AB 1961 RE 5869)	Y 6633
BASILINE (2005)	236.371 72.046	CAL HWY BR DISC IN W END C. B. @ SW COR WHITTIER BLVD & BARTON RD	Y 6635
BASILINE (2005)	250.554 76.369	CSBM MON IN WELL @ BCR OF ISLAND 15M(49FT) N/O & 14.5M(47.6FT) E/O C/L INT LA ENTRADA AVE & WHITTIER BLVD MKD (BM 1-11A 1961 RE 5869)	Y 6636
BASILINE (2005)	276.252 84.202	ST CAL HWY MON @ E END C. B. 2M(6.5FT) W/O BCR 11.6M(38FT) N/O C/L WHITTIER BLVD & 2M(6.5FT) W/O C/L PROD SANTA GERTRUDES AVE	Y 6637

QUAD YEAR	ELEV FOOT/METER	DESCRIPTION	BM NUMBER
BASELINE (2005)	166.945 50.885	SPK IN S CB 3M(10FT) E/O BCR @ SE COR NORWALK BLVD & MINES BLVD	Y 6664
BASELINE (2005)	154.154 46.986	BT SPK IN W CB 1.5M(5FT) N/O BCR @ NW COR NORWALK BLVD & SLAUSON AVE	Y 6665
BASELINE (2005)	154.103 46.971	RDBM TAG IN E CB 600MM(2FT) N/O BCR @ SE COR NORWALK BLVD & SLAUSON AVE	Y 6666
BASELINE (2005)	155.430 47.375	L&T IN E CB NORWALK BLVD ON C/L PROD BURKE ST (TO THE W)	Y 6667
BASELINE (2005)	155.530 47.406	RDBM TAG IN E CB 600MM(2FT) S/O BCR @ SE COR NORWALK BLVD & BURKE ST	Y 6668
BASELINE (2005)	169.478 51.657	L&T CTR CB RET OF ISLE @ ENT TO CANDLEWOOD C C @ C/L BRAMBLEBUSH AVE & 14M(46FT) S/O C/L TELEGRAPH RD	Y 6679
BASELINE (2005)	198.416 60.477	RDBM TAG IN NLY CB 5.5M(18FT) ELY/O BCR @ NELY COR VALLEY VIEW AVE & TELEGRAPH RD	Y 6680
BASELINE (2005)	189.416 57.734	L&T IN SWLY CB RET 3M(10FT) ELY/O BCR 16.5M(54FT) WLY C/L COLIMA RD & 12.8M(42FT) SLY/O C/L TELEGRAPH RD	Y 6681
BASELINE (2005)	256.010 78.032	L&BN IN ELY CB 600MM(2FT) N/O C. B. @ SE COR LEFFINGWELL RD & LAMBERT RD	Y 6684
BASELINE (2005)	269.291 82.080	RDBM TAG N CB 600MM(2FT) E/O 1ST C. B. @ NE COR FIRST AVE & LEFFINGWELL RD	Y 6686
BASELINE (2005)	281.272 85.732	L&T IN S CB 1.5M(5FT) E/O BCR @ SE COR LEFFINGWELL RD & TIGRINA AVE	Y 6687
BASELINE (2005)	317.410 96.747	BR TAG & NAIL IN S CB 200MM(0.7FT) E/O BCR @ SE COR VALLEY HOME AVE & GREGORY LANE MKD (BM ORANGE CO#7872)	Y 6690
SANTA FE (2005)	161.424 49.202	RDBM TAG 2FT W/O BCR @ NW COR SANTA FE SPRINGS RD & LOS NIETOS RD	Y 6691
SANTA FE (2005)	158.236 48.230	CS TAG IN N CB OVAL DR 600MM(2FT) W/O BCR @ NW COR PAINTER AVE	Y 6698
SANTA FE (2005)	202.418 61.697	L&BN IN ELY CB 52M(171FT) N/O BCR 78M(256FT) NELY C/L LAMBERT RD & 9M(29.5FT) SELY/O C/L MILLS AVE (NR N END C. B.)	Y 6700
SANTA FE (2005)	221.707 67.576	L&BN IN SLY CB MILLS AVE 300MM(1FT) E/O BCR @ SE COR CULLEN ST MKD (BM)	Y 6702
SANTA FE (2005)	211.182 64.368	L&BN 12FT W BCR @ SW COR CORNISHCREST RD & COLIMA RD	Y 6703
SANTA FE (2005)	204.306 62.273	CS MON IN N END C. B. 12.5M(41FT) WLY/O C/L COLIMA RD & 67M(220FT) NLY/O C/L LAMBERT RD (161FT NLY/O BCR) MKD (BM 1-10C 1961 RE 5869)	Y 6708
SANTA FE (2005)	154.317 47.036	L&BN IN E CB SANTA FE SPRINGS RD 72FT S/O C/L PROD SORENSEN AVE MKD (BM)	Y 7438

QUAD YEAR	ELEV FOOT/METER	DESCRIPTION	BM NUMBER
SANTA FE (2005)	150.918 46.000	L&BN IN E HDWL 40FT E/O C/L SORENSEN AVE & 0.25MI N ELY/O C/L JOHN ST 40FT S/O SPRR TRACK MKD (BM)	Y 7442
SANTA FE (2005)	150.934 46.005	L&BN IN W HDWL 40FT W/O C/L SORENSEN AVE & 0.25MI N ELY C/L JOHN ST 28FT S/O SPRR TRACK MKD (BM)	Y 7443
SANTA FE (2005)	150.254 45.798	L&BN IN W CB 24FT N/O BCR @ NW COR SORENSEN AVE & SLAUSON AVE MKD (BM)	Y 7445
SANTA FE (2005)	155.400 47.366	L&BN IN E CB 11.6M(38FT) S/O BCR @ SE COR WASHINGTON BLVD & SORENSEN AVE MKD (BM)	Y 7446
BASELINE (2005)	161.652 49.272	L&BN IN W CB 600MM(2FT) N/O BCR @ NW COR TELEGRAPH RD & GREENLEAF AVE	Y 7449
BASELINE (2005)	243.817 74.316	CAL DIV HWYS MON 4.6M(15FT) W/O BCR @ NW COR WHITTIER BLVD & CALIFORNIA AVE	Y 8180
BASELINE (2005)	252.833 77.064	L&BN IN S CB 300MM(1FT) E/O BCR @ SE COR WHITTIER BLVD & CALMADA AVE MKD (BM)	Y 8183
BASELINE (2005)	234.924 71.605	SPK IN N CB 3.4M(11FT) W/O BCR @ NW COR WHITTIER BL & WASHINGTON AVE	Y 8192
BASELINE (2005)	223.094 67.999	RDBM TAG IN S CB 600MM(2FT) W/O BCR @ SW COR WHITTIER BLVD & COMSTOCK AVE	Y 8193
SANTA FE (2005)	159.058 48.481	L&BN IN S CB LOS NIETOS RD 300MM(1FT) W/O C. B. 10M33FT) S/O C/L & 11M(36FT) W/O C/L PAINTER AVE (MKD BM)	Y 8196
SANTA FE (2005)	147.467 44.948	RDBM TAG IN W CB PAINTER AVE 600MM(2FT) S/O BCR @ SW COR MULBERRY DR	Y 8201
SANTA FE (2005)	141.116 43.012	RDBM TAG IN W CB PAINTER AVE NR N END C. B. 10.6M(34.8FT) N/O C/L PROD MYSTIC AVE	Y 8202
SANTA FE (2005)	173.153 52.777	RDBM TAG IN N CB LAMBERT RD 1.5M(5FT) W/O BCR @ NW COR SANTA FE SPRINGS RD	Y 8203
SANTA FE (2005)	174.550 53.203	RDBM TAG IN S CB LAMBERT RD 300MM(1FT) W/O BCR @ SW COR GREENLEAF AVE	Y 8204
SANTA FE (2005)	173.979 53.029	RDBM TAG IN S CB LAMBERT RD 300MM(1FT) W/O BCR @ SE COR GREENLEAF AVE	Y 8205
SANTA FE (2005)	199.339 60.759	RDBM TAG IN WLY CB 300MM(1FT) N/O BCR @ SW COR COLIMA RD & LAMBERT RD	Y 8207
SANTA FE (2005)	206.939 63.075	RDBM IN SLY CB 300MM(1FT) E/O BCR @ SE COR LAMBERT RD & COLE RD	Y 8208
SANTA FE (2005)	219.755 66.982	RDBM TAG IN SLY CB LAMBERT RD 16.5M(54FT) W/O C/L PROD JENKINS DR (CUL-DE-SAC)	Y 8209
SANTA FE (2005)	220.231 67.127	L&T IN SLY CB LAMBERT RD 17M(56FT) E/O C/L PROD JENKINS DR (CUL-DE-SAC)	Y 8210
SANTA FE (2005)	243.879 74.335	RDBM TAG IN NLY CB LAMBERT RD 11.6M(38FT) N/O C/L & 29M(95FT) W/O C/L SANTA GERTRUDES AVE (1 FT W/O BCR)	Y 8211

QUAD YEAR	ELEV FOOT/METER	DESCRIPTION	BM NUMBER
SANTA FE (2005)	243.902 74.342	RAM SET IN WLY CB SANTA GERTRUDES AVE 8.2M(27FT) W/O C/L & 18M(59FT) S/O C/L LAMBERT RD (1 FT S/O BCR )	Y 8212
SANTA FE (2005)	231.493 70.559	RDBM TAG IN W CB COLIMA RD 84FT N/O & 38FT W/O C/L INT HAYWARD ST	Y 8213
SANTA FE (2005)	228.267 69.576	L&SPK NR BC OF TRANSITION ISL 38FT W C/L COLIMA RD & 80FT S C/L HAYWARD ST PAINTED (BM NO 3 266.52)	Y 8214
SANTA FE (2005)	180.184 54.920	L&BN 5FT E/O BCR @ NE COR COLIMA RD & DUNTON DR 18FT N/O & 53FT E/O C/L INT CB CUT (W Z 278)	Y 8215
SANTA FE (2005)	181.395 55.289	RDBM TAG 1FT N/O BCR @ NW COR COLIMA RD & HAWES ST	Y 8216
SANTA FE (2005)	135.746 41.376	SPK IN NLY CB MILLS AVE @ CTR C. B. 2.3M(7.5FT) E/O BCR 9M(29.5FT) N/O C/L & 16M(52FT) E/O C/L CLOSE ST	Y 8220
BASELINE (2005)	139.832 42.621	L&T IN NLY CB 300MM(1FT) ELY/O BCR @ NE COR VICTORIA AVE & TELEGRAPH RD	Y 8224
BASELINE (2005)	218.096 66.476	CS MON IN WELL 4.6M(15FT) E/O BCR 2M(6.5FT) S/O CF @ SW COR LEFFINGWELL RD & LA MIRADA BLVD MKD (K9 1960)	Y 8228
BASELINE (2005)	226.867 69.149	L & BN IN W CB 4M(13FT) N/O BCR @ NW COR LEFFINGWELL RD & STAMEY RD	Y 8229
BASELINE (2005)	227.127 69.229	L & BR IN S CB LEFFINGWELL RD 12.2M(40FT) E/O C/L PROD STAMEY RD (FR THE N)	Y 8230
BASELINE (2005)	256.067 78.049	CS BM MON FL IN CTR OF ISLAND LEFFINGWELL RD 52M(171FT) E/O C/L LAMBERT RD MKD (BM 4 - 18 1965)	Y 8231
BASELINE (2005)	143.477 43.732	CS MON IN WELL 300MM(1FT) W/O CF 600MM(2FT) S/O BCR @ SW COR NORWALK BLVD & TELEGRAPH RD MKD (BM 2-11B 1970 RE 5869)	Y 8723
BASELINE (2005)	161.003 49.074	CS MON IN WELL 300MM(1FT) W/O W CF @ BCR OF NW COR TELEGRAPH RD & GREENLEAF AVE MKD (BM 4-10C 1970 RE 5869)	Y 8740
BASELINE (2005)	280.840 85.600	L&T IN S CB 5M(16.4FT) W/O BCR @ SW COR LEFFINGWELL RD & TIGRINA AVE	Y 9192
BASELINE (2005)	236.417 72.060	FC MON IN S SIDE @ BK OF C. B. LEFFINGWELL RD & 2.4M(8FT) E/O C/L PROD EL ARCO DRIVE	Y 9194
BASELINE (2005)	226.850 69.144	LACE TAG IN S CB 3.7M(12FT) E/O BCR @ SE COR LEFFINGWELL RD & SCOTT RD	Y 9195
BASELINE (2005)	226.345 68.990	CS MON IN WELL 300MM(1FT) N/O N CF 300MM(1FT) E/O BCR @ NE COR LEFFINGWELL RD & STAMEY RD MKD (BM 4-3B 1970)	Y 9197
BASELINE (2005)	160.390 48.887	CSBM MON IN WELL 300MM(1FT) N/O N CF TELEGRAPH RD 6.5M(21.3FT) E/O C/L PROD TELECRON AVE MKD (BM 4-7C 1970 RE 5869)	Y 9201

QUAD YEAR	ELEV FOOT/METER	DESCRIPTION	BM NUMBER
BASELINE (2005)	160.576 48.944	RDBM TAG IN N CB 300MM(1FT) E/O BCR @ NE COR TELEGRAPH RD & PAINTER AVE	Y 9203
BASELINE (2005)	160.548 48.935	L&BN IN N CB 300MM(1FT) W/O BCR @ NW COR TELEGRAPH RD & PAINTER AVE	Y 9204
BASELINE (2005)	148.364 45.221	RDBM TAG IN N CB TELEGRAPH RD 8M(26FT) E/O C/L PROD SPRINGDALE AVE	Y 9205
BASELINE (2005)	154.944 47.227	RDBM TAG IN W CB NORWALK BLVD 3.4M(11FT) N/O C/L DRWY TO BLDG #9703 (29.5FT S/O ST LT)	Y 9444
BASELINE (2005)	154.785 47.179	RDBM TAG IN E CB NORWALK BLVD 36.6M(120FT) N/O C/L DRWY TO BLDG #9720 (@ S END C. B.)	Y 9445
BASELINE (2005)	249.093 75.924	CSBM MON IN W END C. B. 4M(13FT) W/O BCR @ NW COR BEN HUR AVE & WHITTIER BLVD (SERV RD) MKD (1-11C 1965 RE 5869)	Y 9448
BASELINE (2005)	231.954 70.700	L&T IN S CB (SERV RD) 300MM(1FT) W/O BCR @ SE COR WHITTIER BLVD & JACMAR AVE	Y 9449
SANTA FE (2005)	159.142 48.507	L&T 2FT E/O BCR @ NW COR LOS NIETOS RD & DICE RD	Y 9650
BASELINE (2005)	158.436 48.291	L&BR IN N CB 1M(3.3FT) E/O BCR @ NW COR NORWALK BLVD & LOS NIETOS RD	Y 9651
SANTA FE (2005)	222.124 67.704	L&T 1FT W/O BCR @ NW COR REIS ST & COLIMA RD	Y 9655
SANTA FE (2005)	222.112 67.700	L&T 1FT W/O BCR @ SW COR REIS ST & COLIMA RD	Y 9656
SANTA FE (2005)	150.189 45.778	RDBM TAG 2FT N/O BCR @ NE COR SLAUSON AVE & SORENSEN AVE	Y 9657
BASELINE (2005)	247.145 75.330	RDBM TAG IN N CB 2M(6.5FT) W/O BCR @ NW COR WHITTIER BLVD (SERV RD) & MILLS AVE 14M(46FT) W/O & 4.6M(15FT) N/O C/L INT	Y 10055
BASELINE (2005)	144.605 44.076	RDBM TAG IN S CB 300MM(1FT) E/O BCR @ SE COR NORWALK BLVD & TELEGRAPH RD	Y 10203
BASELINE (2005)	154.597 47.121	RDBM TAG IN S CB 300MM(1FT) W/O BCR @ SW COR TELEGRAPH RD & BLOOMFIELD AVE	Y 10205
BASELINE (2005)	160.549 48.935	RDBM TAG IN N CB RET 600MM(2FT) W/O BCR @ NE COR LAUREL AVE & TELEGRAPH RD	Y 10207
BASELINE (2005)	266.653 81.276	L&BR IN S CB 300MM(1FT) E/O BCR @ SE COR WHITTIER BLVD & COLE RD	Y 10250
BASELINE (2005)	240.344 73.257	RAMSET IN MCR @ SW COR WHITTIER BLVD & PAINTER AVE	Y 10251
BASELINE (2005)	171.767 52.355	L&BR IN W CB RET 2.4M(8FT) N/O BCR @ SW COR NORWALK BLVD & LOCH AVON DR	Y 10259

QUAD YEAR	ELEV FOOT/METER	DESCRIPTION	BM NUMBER
BASELINE (2005)	153.724 46.855	DPW BM TAG IN E CB 1M(3.3FT) S/O BCR @ SE COR NORWALK BLVD & BELL RANCH DR	Y 10885
BASELINE (2005)	158.583 48.336	DPW BM TAG IN E CB 2M(6.5FT) S/O BCR @ SE COR NORWALK BLVD & PIKE ST	Y 10886
BASELINE (2005)	189.995 57.911	DPW BM TAG IN N CB 6M(20FT) W/O BCR @ NW COR COLIMA RD & TELEGRAPH RD (E END C. B.)	Y 11146
BASELINE (2005)	197.325 60.145	DPW BM TAG IN N CB 1M(3.3FT) W/O BCR @ NW COR VALLEY VIEW AVE & TELEGRAPH RD	Y 11147
BASELINE (2005)	164.058 50.005	DPW BM TAG IN N CB 1M(3.3FT) W/O BCR @ NW COR GUN AVE & TELEGRAPH RD	Y 11148
BASELINE (2005)	205.854 62.744	DPW BM TAG IN N CB 1M(3.3FT) W/O BCR @ NW COR LEFFINGWELL RD & DOUBLE EAGLE DR	Y 11156
BASELINE (2005)	188.327 57.402	L&BN IN S CB 300MM(1FT) W/O BCR @ SW COR LEFFINGWELL RD & ARROYO DR	Y 11157
BASELINE (2005)	268.961 81.980	DPW BM TAG IN S CB 2M(6.5FT) E/O BCR @ SE COR FIRST AVE & LEFFINGWELL RD	Y 11158
BASELINE (2005)	297.814 90.774	ORANGE CO BM DISK IN N CB @ W END C. B. @ BCR @ NE COR LA HABRA BLVD & VALLEY HOME AVE MKD (BM 2K-21-75)	Y 11159
BASELINE (2005)	313.325 95.502	DPW BM TAG IN N CB WHITTIER BLVD 8M(26FT) W/O C/L PROD JORDAN RD	Y 11160
BASELINE (2005)	258.906 78.915	DPW BM TAG IN N CB WHITTIER BLVD 11.5M(37.7FT) N/O C/L & 7M(23FT) E/O C/L W DRWY ENT TO BLDG #15545	Y 11163
BASELINE (2005)	263.757 80.393	DPW BM TAG IN S CB 1M(3.3FT) W/O BCR @ SW COR WHITTIER BLVD & COLIMA RD	Y 11164
BASELINE (2005)	239.652 73.046	L&BN IN E CB 300MM(1FT) S/O BCR @ SE COR WHITTIER BLVD & PAINTER AVE	Y 11166
BASELINE (2005)	228.307 69.588	DPW BM TAG IN ELY CB WHITTIER BLVD 3M(10FT) N/O C/L PROD PACIFIC PLACE	Y 11167
BASELINE (2005)	237.651 72.436	DPW BM TAG IN NLY CB 1M(3.3FT) E/O BCR @ NE COR WHITTIER BLVD & PHILADELPHIA ST	Y 11168
BASELINE (2005)	234.762 71.556	DPW BM TAG WLY CB 3M(10FT) S/O BCR @ SELY COR WHITTIER BLVD & SORENSEN AVE	Y 11169
BASELINE (2005)	217.097 66.171	DPW BM TAG IN N CB 1M(3.3FT) W/O BCR @ NW COR WHITTIER BLVD & GRETNA AVE	Y 11170
BASELINE (2005)	188.013 57.307	BT SPK IN S CB 2.4M(8FT) W/O BCR @ SW COR WHITTIER BLVD & GLENGARRY AVE	Y 11171
SANTA FE (2005)	199.817 60.904	L&BR IN SLY CB LAMBERT RD 9M(29.5FT) S/O C/L & 42.4M(139FT) ELY/O C/L BONAVIDA LN (87 FT E/O BCR)	Y 11173

QUAD YEAR	ELEV FOOT/METER	DESCRIPTION	BM NUMBER
SANTA FE (2005)	184.411 56.209	DPW BM TAG IN NLY CB MILLS AVE 1.5M(5FT) W/O ELY P/L HSE #9709 9M(29.5FT) N/O C/L & 1M(3.3FT) W/O ST LT #1902623E	Y 11174
SANTA FE (2005)	176.220 53.712	L&BR IN SLY CB MILLS AVE 9M(29.5FT) S/O C/L & 300MM(1FT) E/O BCR OF WLY DRWY ENT TO CALIF HIGH SCHOOL OPP HSE #9753	Y 11175
SANTA FE (2005)	159.043 48.476	DPW BM TAG IN SLY CB MILLS AVE 2M(6.5FT) E/O BCR @ SE COR MULBERRY DR	Y 11176
SANTA FE (2005)	158.128 48.198	DPW BM TAG IN WLY CB MULBERRY DR 11.6M(38FT) W/O C/L & 33.6M(110FT) S/O C/L MILLS AVE (@ NLY END C. B.)	Y 11177
SANTA FE (2005)	202.305 61.663	CS MON IN WELL @ B/W MCR NWLY COR 14M(46FT) N/O C/L LAMBERT RD & 17.4M(57FT) W/O C/L COLIMA RD MKD (BM 1 -10E 1970 RE 5869)	Y 11178
SANTA FE (2005)	154.041 46.952	SPK IN SLY CB MILLS AVE 4.3M(14FT) W/O C/L PROD DICKEY ST	Y 11179
SANTA FE (2005)	151.722 46.245	DPW TAG IN NLY CB MILLS AVE 3.7M(12FT) E/O C/L PROD BROADWAY	Y 11180
SANTA FE (2005)	144.496 44.043	DPW BM TAG IN SLY CB MILLS AVE 1M(3.3FT) W/O BCR @ SW COR ANOLA ST	Y 11181
SANTA FE (2005)	136.573 41.628	L&T IN SLY CB MILLS AVE 5M(16.4FT) E/O C/L PROD CLOSE ST @ SW COR OF BRIDGE OVER FC CHANNEL	Y 11182
SANTA FE (2005)	157.869 48.119	LACO BM TAG IN S CB 1M(3.3FT) W/O BCR @ SW COR WASHINGTON BLVD & ALLPORT AVE	Y 11485
SANTA FE (2005)	174.532 53.198	L&T IN N CB 1.5M(5FT) E/O BCR @ NE COR WASHINGTON BLVD & LAMBERT RD	Y 11486
SANTA FE (2005)	189.932 57.891	RAMSET IN N CB WASHINGTON BLVD ON C/L PROD PERSING DR	Y 11487
SANTA FE (2005)	178.832 54.508	L&T IN NLY EDGE RAMP @ NW COR LAMBERT RD & PAINTER AVE 16M(52.5FT) N/O & 14M(46FT) W/O C/L INT	Y 11488
SANTA FE (2005)	178.385 54.372	LACO BM TAG IN S CB LAMBERT RD 1M(3.3FT) E/O BCR @ SE COR PAINTER AV	Y 11489
SANTA FE (2005)	159.083 48.489	LACO BM TAG IN E CB 2M(6.5FT) N/O BCR @ NE COR PAINTER AVE & LOS NIETOS RD	Y 11490
SANTA FE (2005)	154.790 47.180	LACO BM TAG IN E CB 1.5M(5FT) S/O BCR @ SE COR PAINTER AVE & BARTON CIR (S ENT)	Y 11491
SANTA FE (2005)	143.414 43.713	L&T IN E CB PAINTER AVE @ CTR OF BRIDGE & 113M(370FT) S/O C/L REIS ST	Y 11492
SANTA FE (2005)	179.210 54.623	L&DPW BM TAG N CB 300MM(1FT) W/O BCR @ W END C.B. @ NE COR WHITTIER BL & NORWALK BL	Y 11804
BASELINE (2005)	231.173 70.462	L&DPW BM TAG SLY CB (SERVICE RD) WHITTIER BL @ C/L PROD PENN ST	Y 11805

QUAD YEAR	ELEV FOOT/METER	DESCRIPTION	BM NUMBER
BASELINE (2005)	251.635 76.699	L&LS#2342 TAG 300MM(1FT) E/O BCR @ B/W @ SW COR WHITTIER BL & CALMADA AV	Y 11806
BASELINE (2005)	262.292 79.947	L&DPW BM TAG W CB 1.5M(5FT) N/O BCR @ SW COR WHITTIER BL & COLIMA RD	Y 11807
BASELINE (2005)	252.229 76.880	L&T IN MCR @ SE COR WHITTIER BL & SCOTT AV	Y 11808
BASELINE (2005)	150.062 45.739	L&DPW TAG IN E CB NORWALK BL @ N END DR TO BLDG #10110	Y 11834
BASELINE (2005)	160.202 48.830	L&LS#2428 TAG IN N CB 900MM(3FT) W/O BCR @ NW COR NORWALK BL & WASHINGTON BL	Y 11835
BASELINE (2005)	162.131 49.418	L&DPW TAG IN E CB 300MM(1FT) N/O BCR @ SE COR NORWALK BL & CHOISSER ST	Y 11836
BASELINE (2005)	162.035 49.388	L&DPW TAG IN E CB 2.1M(7FT) S/O ECR @ NE COR NORWALK BL & CHOISSER ST	Y 11837
BASELINE (2005)	171.268 52.203	SPK @ BW ON W SIDE NORWALK BL 7.6M(25FT) N/O C/L SLY DR TO WEST WHITTIER ELEM SCHOOL 46M(150FT) S/O C/L INT NORWALK BL & LOCH LOMOND DR	Y 11838
BASELINE (2005)	156.015 47.554	L&DPW TAG IN N CB 300MM(1FT) E/O BCR @ NE COR MILLS AV & TELEGRAPH RD	Y 11859
BASELINE (2005)	158.897 48.432	L&LS#5411 TAG @ MCR @ NW COR TELEGRAPH RD & CARMENITA RD	Y 11860
BASELINE (2005)	159.068 48.484	L&DPW TAG IN N CB 300MM(1FT) E/O ECR @ NW COR TELEGRAPH RD & CARMENITA RD	Y 11861
BASELINE (2005)	160.848 49.027	L&DPW TAG IN N CB 300MM(1FT) W/O ECR @ NW COR TELEGRAPH RD & LAUREL AV	Y 11862
BASELINE (2005)	158.820 48.408	L&DPW TAG @ MCR @ NW COR TELEGRAPH RD & FREEMAN AV	Y 11863
BASELINE (2005)	154.538 47.103	L&T IN N CB 300MM(1FT) W/O ECR @ NW COR TELEGRAPH RD & SANTA FE SPRINGS RD	Y 11864
BASELINE (2005)	146.629 44.693	L&DPW TAG IN N CB @ CTR C.B. IN FRONT OF BLDG #12309 ON TELEGRAPH RD	Y 11865
BASELINE (2005)	188.525 57.463	SPK IN S CB 1.5M(5FT) E/O BCR @ SE COR TELEGRAPH RD & LEFFINGWELL RD	Y 11866
BASELINE (2005)	185.794 56.630	L&LS#2996 TAG IN N CB 1.5M(5FT) W/O BCR @ NE COR TELEGRAPH RD & LEFFINGWELL RD	Y 11867
BASELINE (2005)	134.609 41.029	L&DPW TAG IN N CB @ E END OF BRIDGE OVER COYOTE CREEK ON TELEGRAPH RD	Y 11868
BASELINE (2005)	135.685 41.357	L&DPW TAG IN N CB @ W END OF BRIDGE OVER COYOTE CREEK ON TELEGRAPH RD	Y 11869

QUAD YEAR	ELEV FOOT/METER	DESCRIPTION	BM NUMBER
SANTA FE (2005)	295.932 90.200	L&LS#5411 IN N CB 300MM(1FT) E/O ECR @ NW COR LEFFINGWELL RD & VALLEY HOME AV	Y 11870
SANTA FE (2005)	172.712 52.643	L&RCE#8244 TAG IN N CB WASHINGTON BL @ ECR @ NW COR (ISLAND) LAMBERT RD (DAN ADAMS WAY) TO HOSPITAL ENT	Y 11878
SANTA FE (2005)	156.334 47.651	L&DPW TAG IN S CB 300MM(1FT) E/O ECR @ SE COR WASHINGTON BL & BROADWAY AV	Y 11879
SANTA FE (2005)	155.145 47.288	L&DPW TAG @ MCR @ SE COR WASHINGTON BL & SORENSEN AV	Y 11880
SANTA FE (2005)	219.419 66.879	L&T IN E CB COLIMA RD @ C/L PROD BROADWAY	Y 11881
SANTA FE (2005)	217.494 66.292	L&T NEAR MCR @ NW COR COLIMA RD & BROADWAY	Y 11882
SANTA FE (2005)	211.370 64.426	L&T IN N CB 1.5M(5FT) W/O BCR @ NW COR COLIMA RD & CORNISHCREST RD	Y 11883
SANTA FE (2005)	156.076 47.572	L&DPW TAG @ MCR @ NE COR LOS NIETOS RD & GREENLEAF AV	Y 11884
SANTA FE (2005)	163.615 49.870	L&T IN E CB 300MM(1FT) N/O BCR @ NE COR LOS NIETOS RD & JOHN ST	Y 11885
SANTA FE (2005)	163.683 49.891	L&T IN W CB 300MM(1FT) N/O BCR @ NW COR LOS NIETOS RD & JOHN ST	Y 11886
SANTA FE (2005)	158.700 48.372	L&DPW TAG IN W CB 2.4M(5FT) S/O BCR @ NW COR LOS NIETOS RD & DICE RD	Y 11887
SANTA FE (2005)	161.412 49.199	L&DPW TAG IN S CB 300MM(1FT) E/O ECR @ SE COR LOS NIETOS RD & SANTA FE SPRINGS RD	Y 11888
SANTA FE (2005)	155.030 47.253	L&T IN S CB 300MM(1FT) W/O BCR @ SW COR SANTA FE SPRINGS RD & SORENSEN AV	Y 11889
SANTA FE (2005)	148.163 45.160	L&LS#2427 TAG IN NLY CB SORENSEN AV @ C/L PROD JOHN ST	Y 11890
SANTA FE (2005)	147.890 45.077	L&T IN S CB 300MM(1FT) W/O ECR @ SE COR SORENSEN AV & JOHN ST	Y 11891
SANTA FE (2005)	162.599 49.560	L&T NEAR MCR @ NE COR SORENSEN AV & MINES BL	Y 11892
SANTA FE (2005)	162.887 49.648	L&T IN E CB 5.2M(17FT) N/O ECR @ NE COR SORENSEN AV & MINES BL	Y 11893
SANTA FE (2005)	164.627 50.178	L&T IN S CB 2.1M(7FT) E/O BCR @ SW COR MINES BL & GRETNA AV	Y 11894
SANTA FE (2005)	164.984 50.287	L&T IN W CB 300MM(1FT) N/O BCR @ NW COR MINES BL & GRETNA AV	Y 11895
SANTA FE (2005)	162.897 49.651	L&T @ NE COR C.B. 10FT E/O BCR @ NE COR MINES BL & BROADWAY AV	Y 11896

QUAD YEAR	ELEV FOOT/METER	DESCRIPTION	BM NUMBER
SANTA FE (2005)	163.273 49.766	L&DPW TAG IN W CB 300MM(1FT) S/O ECR @ SW COR MINES BL & GLENGARRY AV	Y 11897