

Los Angeles County Waterworks District No. 29, Malibu Owen Tank Replacement Project Water Shutdown

Los Angeles County Public Works began construction on Owen Tank Replacement Project to support greater water resilience for District 29 customers. A newly constructed 500,000-gallon tank replaces an aging 100,000-gallon tank, providing a reliable water supply for existing customers in the unincorporated LA County community of Topanga.

A brief water service shut down is required to allow for connecting the newly constructed surge tank to the existing water distribution system. The connection will take place on date and time shown below:

Location: 2300 S. Tuna Canyon Road, Topanga

Date: Thursday, November 30, 2023

Time: 9:00 a.m. to 12:00 p.m.

For more information, please visit the LA County Waterworks District No. 29 website linked page at:

[Webpage - Los Angeles County Waterworks District No 29.docx](#)

LA County Public Works Construction Inspector, Cyrus Ravaei will oversee construction. Cyrus can be reached Monday through Thursday from 7 a.m. to 3:30 p.m. at (626) 441-0305 or cravaei@dpw.lacounty.gov.

For emergency after hours, please contact:

LA County Public Works 24-hour Dispatch Center at (800) 675-4357 (HELP).

Media inquiries can be directed to pio@pw.lacounty.gov or 1-800-675-HELP (4357).

Si necesita asistencia con la traducción al Español, por favor comuníquese con el representante de Obras Públicas del Condado de Los Ángeles: Lisset Cárdenas al número (626) 300-3384



PROJECT LIMITS



OWEN TANK REPLACEMENT
LOS ANGELES COUNTY WATERWORKS DISTRICT 29, MALIBU
WWD2900041

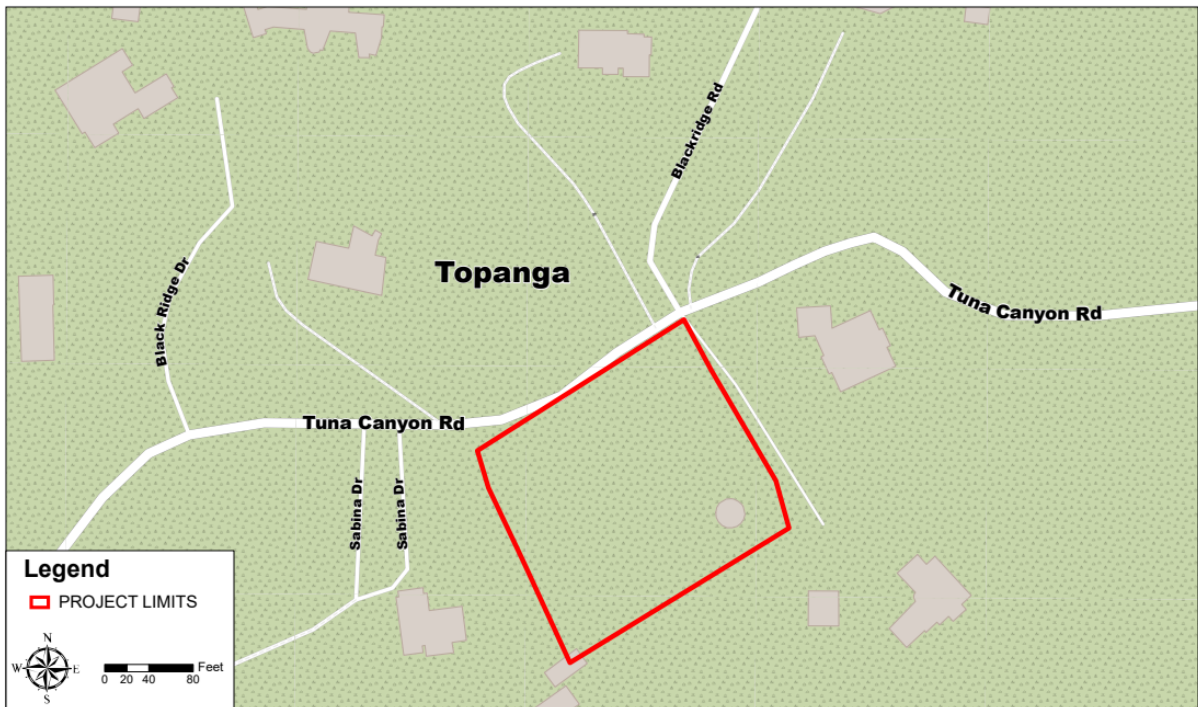

\\lacwd\wms\MapInfo\MapInfo\Projects\2014\OWEN TANK REPLACEMENT