

COUNTY OF LOS ANGELES

ROAD DEPARTMENT



BELLFLOWER QUAD

BENCH MARKS

1960

PREFACE

The Road Department level net is composed of some 1,000 miles of levels supporting more than 10,000 bench marks. In 1955, a major re-adjustment of the net was undertaken resulting in revised bench mark elevations of which the accompanying list is a part.

To facilitate the adjustment, indexing, and distribution of adjusted values of the net, the county territory was divided into 30 quads or areas. For identification purposes each quad was given a name, viz., "Rosemead", "La Mirada", "Santa Fe", etc. When bench marks and elevations in the Road Dept. net are used, the name of the quad in which the bench mark is located and the date of the adjustment of the elevation must be included in the bench mark description, e.g.,

SG 908 - L & T in E. cb. Muscatel Ave. on C/L prod.
Scott St. (Rosemead - 1955) Elev. 333.517

It is expected that this general adjustment will, for the most part, remain sound for the next 15 or 20 years. As new circuits are completed, however, re-adjustment of individual quads may become advisable. It is expected that these subsequent adjustments will be in the nature of a few hundredths of a foot. When a quad is re-adjusted, new elevation lists will be published and the date of the re-adjustment will replace the "1955" at the end of the bench mark description. Two bench marks in the same quad with different adjustment dates will not normally join each other. Since all adjustments taper out to nothing at the periphery of the quad, any bench mark in one quad will join any bench mark in another quad regardless of their respective adjustment dates.

The basic accuracy of the net is reflected by an indicated field probable error of ± 0.12 foot per mile of leveling as determined from 298 conditions of closure. However, many years experience in vertical control in the greater Los Angeles basin & Antelope Valley indicate that because of varying degrees of subsidence and heaving, the true datum is recovered only by obtaining substantial agreement of a number of bench marks.

The users of this net are invited to assist in its maintenance by notifying this Department of cases of obliteration, apparent mistakes in descriptions or elevations, and proven disturbance of bench marks.

Datum: U.S. Coast and Geodetic Survey Sea Level Datum of 1929, through the medium of the Los Angeles County Engineer Precise Level Net, 1952 Adjustment.

Abbreviations Used in Bench Mark Listings

ABUT--Abutment	L+BN--Lead and Bench Mark Nail
ANG PT--Angle Point	L+BR--Lead and Brad
BC--Beginning of Curve	L+N--Lead and Nail
BCR--Beginning of Curb Return	L+PK--Lead and PK Nail
BLDG--Building	L+SPK--Lead and Spike
BT SPK--Boat or Bolt Spike	L+T--Lead and Tack
CB RET--Curb Return	MCR--Middle of Curb Return
C/L INT--Center Line Intersection	MKD--Marked
C/L PROD--Center Line Produced	NR--Near
COE--Corps of Engineers	OPP--Opposite
CONC--Concrete	PI--Point of Intersection
CS MON--County Surveyor Monument	PK+W--PK Nail and Washer
CS BR CAP--County Surveyor Brass Cap Monument	P/L--Property Line
CT SPK--Cut Spike	P O S T--Point on Semi-tangent
CTR--Center	PP--Power Pole
DN--Down	PVMT--Pavement
DR--Driveway	R D--Road Department
EC--End of Curve	RDBM--Road Department Bench Mark
ENT--Entrance	RR--Railroad
FC--Flood Control (Dept. LA County)	SPK T+W--Spike, Tin and Washer
FTG--Footing	USC+GS--United States Coast and Geodetic Survey
HDWL--Headwall	USGS--United States Geological Survey
HSE--House	WK--Walk
IP--Iron Pipe	±--Plus or Minus
LACE--Los Angeles City Engineer	+--And

TO NORWALK QUAD

TO ARTESIA QUAD

COMPTON BLVD.

CLARK AVE.

ARDMORE AVE.

BELFLOWER BLVD.

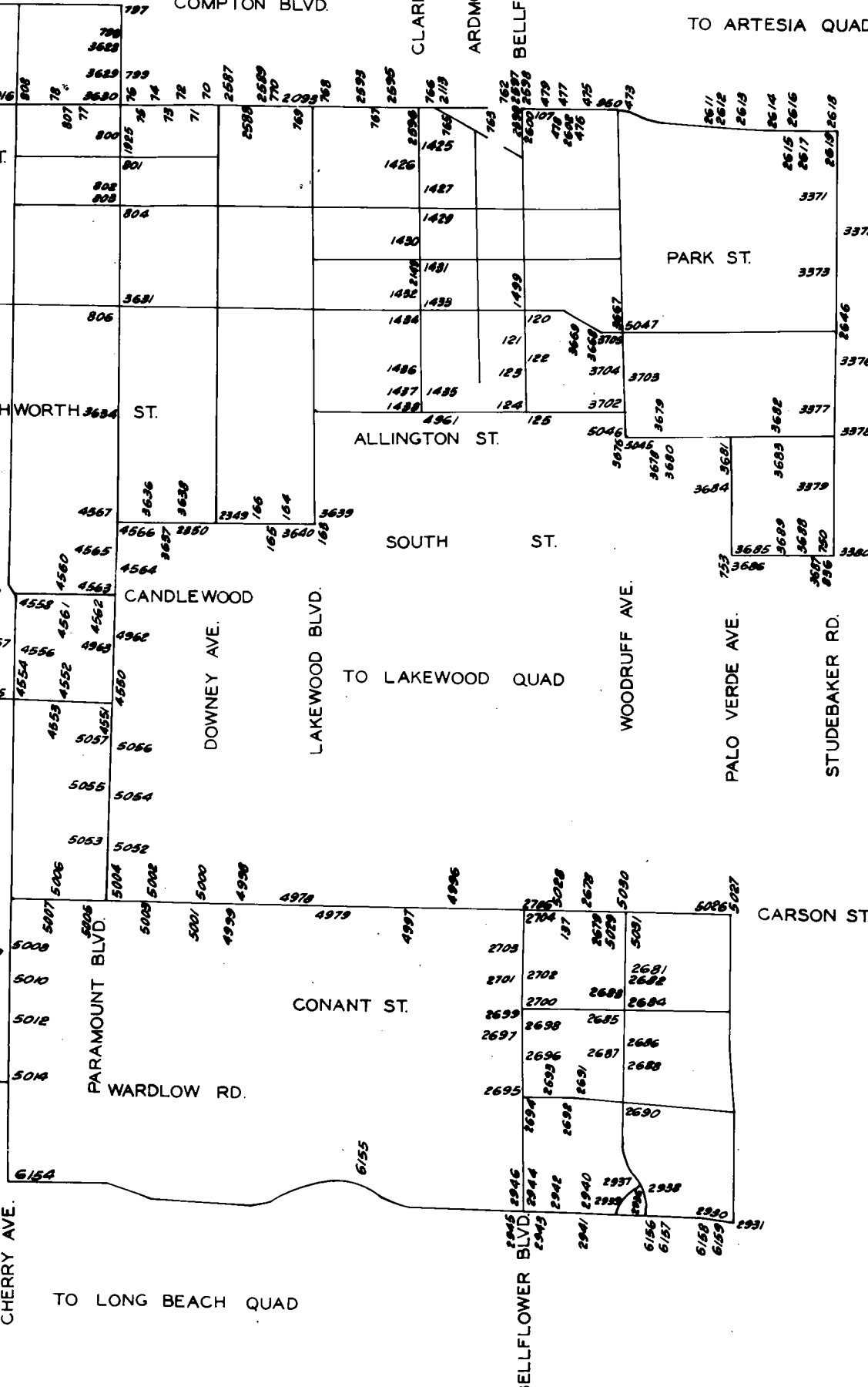

CHERRY AVE.

TO LONG BEACH QUAD

TO ARTESIA QUAD

TO SOUTH GATE QUAD

TO NOR

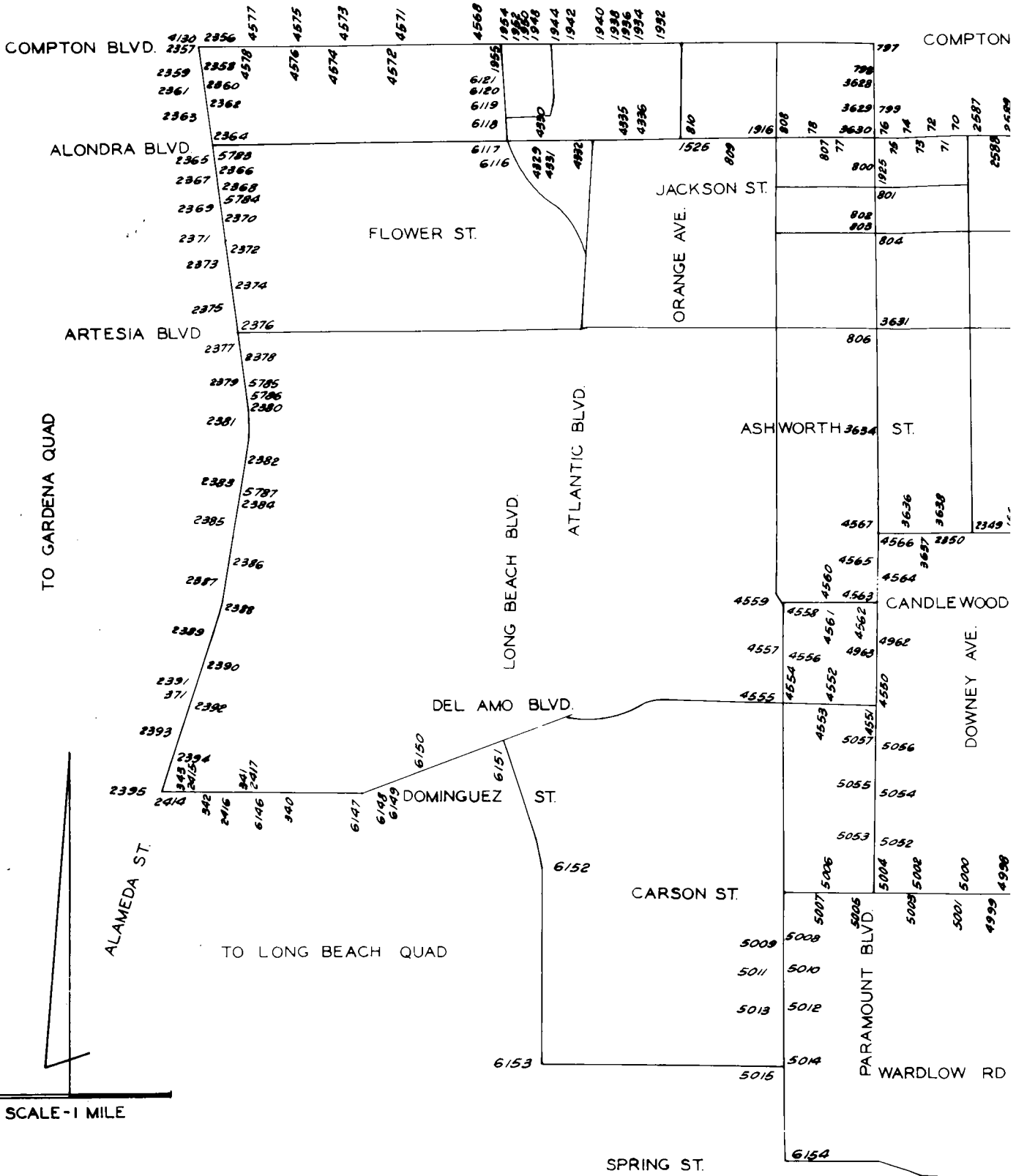

SCALE - 1 MILE

BELLFLOWER QUAD

LOS ANGELES COUNTY ROAD DEPARTMENT
SURVEY SECTION FIELD ENGINEERING DIVISION

TO LONG BEACH

JUL 1964

LOS ANGELES COUNTY ROAD DEPARTMENT
SURVEY SECTION FIELD ENGINEERING DIVISION

PAGE 1

QUAD-YEAR	ELEV	DESCRIPTION (INCLUDE QUAD AND YEAR IN DESCRIPTION)	BM	NUMBER
BASELINE (1955)	66.674	L+T C/L PVMT ALONDRA BLVD 100FT± W C/L DOWNEY AVE	SY	70A
BASELINE (1955)	67.312	L+T C/L INT INDIANA AVE + ALONDRA BLVD	SY	71A
BASELINE (1955)	67.929	CUT SPK 6FT± N C/L INT VIRGINIA AVE + ALONDRA BLVD	SY	72A
BASELINE (1955)	68.528	BT SPK PVMT 7FT± N C/L INT GEORGIA AVE + ALONDRA BLVD	SY	73
BASELINE (1955)	69.048	SPK PVMT 7FT± N C/L INT CRIZABA AVE + ALONDRA BLVD	SY	74A
BASELINE (1955)	68.779	SPK PVMT 8FT± N C/L INT CALIFORNIA AVE + ALONDRA BLVD	SY	75A
BASELINE (1955)	68.751	L+T IN N CB ALONDRA BLVD 15FT± W OF CB RET @ NW COR ALONDRA BLVD + PARAMOUNT BLVD	SY	76B
BELLFLWR (1960)	68.585	L+T PVMT 14FT± S + 19FT± W C/L INT COLORADO AVE + ALONDRA BLVD	SY	77
BELLFLWR (1960)	67.705	L+N E CB VERMONT AVE 63FT± S C/L ALONDRA BLVD	SY	78
BASELINE (1955)	74.665	L+T SW STRADDLER @ C/L INT BELLFLOWER BLVD + CENTER ST	SY	107A
BELLFLWR (1960)	65.298	L+BR T NR CTR CB RET @ SW COR ARTESIA AVE + BELLFLOWER BLVD 5FT± S CTR CB RET	SY	120A
BELLFLWR (1960)	64.070	FC BM 2FT± N CB RET NE COR RAMONA AVE + BELLFLOWER BLVD MKD (74-190)	SY	121A
BELLFLWR (1960)	62.369	L+BN 1FT± N CB RET @ NW COR CEDAR AVE + BELLFLOWER BLVD	SY	122B
BELLFLWR (1960)	60.769	L+SPK 5FT± N CB RET @ NW COR ROSE AVE + BELLFLOWER BLVD	SY	123
BASELINE (1955)	59.644	L+T 1FT± W CB RET @ NW COR ASHWORTH ST + BELLFLOWER BLVD	SY	124
BASELINE (1955)	59.288	RDBM TAG E CB 1FT± N BCR @ NE COR BELLFLOWER BLVD + ASHWORTH ST 56FT± N + 40FT± E C/L INT	SY	125A
BASELINE (1955)	54.326	NWLY OF L+T STRADDLERS NR C/L INT SOUTH ST + LAKEWOOD BLVD	SY	163A
BASELINE (1955)	53.861	L+T W CB 1FT± N CB RET @ NW COR OLIVA AVE + SOUTH ST	SY	164
BASELINE (1955)	53.466	L+T N CB SERVICE RD 2FT± W CB RET @ NW COR CASTANA AVE + SOUTH ST	SY	165
BASELINE (1955)	53.163	L+T N CB SERVICE RD 1FT± W CB RET @ NW COR HAYTER AVE + SOUTH ST	SY	166A
BASELINE (1955)	33.202	L+T CTR CB RET @ SW COR SANTA FE AVE + DOMINGUEZ ST	SY	340A
BASELINE (1955)	31.786	L+SPK 5FT± S CB RET @ SE COR PROSPECT AVE + DOMINGUEZ ST	SY	341A
BASELINE (1955)	31.278	L+T 6FT± S CB RET @ SE COR HARBOR VIEW AVE + DOMINGUEZ ST	SY	342A

JUL 1964

LOS ANGELES COUNTY ROAD DEPARTMENT
SURVEY SECTION FIELD ENGINEERING DIVISION

PAGE 2

QUAD-YEAR	ELEV	DESCRIPTION (INCLUDE QUAD AND YEAR IN DESCRIPTION)	BM NUMBER
BASELINE (1955)	31.931	L+T S CB 30FT± W C/L ALLEY BETWEEN HARBOR VIEW AVE + ALAMEDA BLVD ON DOMINGUEZ ST	SY 343A
BELLFLWR (1955)	.	MADISON ST + PARAMOUNT BLVD	SY 799A
BASELINE (1955)	.	AVE + ALAMEDA BLVD ON DOMINGUEZ ST	SY 343A
BASELINE (1955)	33.022	L+T E HDWL SPRR CULV NO 497.3 25FT± E C/L MAIN TRACK 68FT± W C/L ALAMEDA ST 140FT± N DOMINGUEZ ST	SY 347
BASELINE (1955)	38 ⁷ .795	L+T NW COR SP SIGNAL SWITCH BOX NO 4972 35FT± S C/L DEL AMC BLVD + 25FT± E C/L MAIN LINE SPRR	SY 371A
BASELINE (1955)	65.802	L+T 25FT± W C/L ALAMEDA ST E BARREL ON C/L PROD	SY 2358A
BASELINE (1955)	73.510	CS REF MON IN WELL 14IN DN ON NE COR ALONDRA BLVD + WOODRUFF BLVD 56FT± N + 60FT± E C/L INT MKD (CLEARWATER K 2A)	SY 473A
BASELINE (1955)	74.125	CSBM MON FLUSH ON NE COR ALONDRA BLVD + WOODRUFF AVE 39FT± N + 180FT± W C/L INT MKD (BM 6-6A1958)	SY 474A
BASELINE (1955)	74.844	L+N 80FTS8 S C/L ALONDRA BLVD W CB CORNUTA AVE	SY 475
BASELINE (1955)	75.150	L+N W CB EUCALYPTUS AVE 80FT± S C/L ALONDRA BLVD	SY 476A
BASELINE (1955)	75.083	L+N E CB EUCALYPTUS AVE 80FT± S C/L ALONDRA BLVD	SY 477A
BASELINE (1955)	75.556	L+T E CB LEAHY AVE 80FT± N C/L ALONDRA BLVD	SY 478A
BASELINE (1955)	75.541	L+T W CB LEAHY AVE 80FT± N C/L ALONDRA BLVD	SY 479A
BASELINE (1955)	49.807	SW ONE OF 4 L+T STRADDLERS NR C/L INT STUDEBAKER RD + SOUTH ST	SY 75CA
BASELINE (1955)	51.528	CT SPK CONC PVMT 14FT± S C/L SOUTH ST 85FT± W C/L PALO VERDE AVE	SY 753
BASELINE (1955)	73.092	L+T INT ORCHARD AVE + ALONDRA BLVD	SY 762A
BASELINE (1955)	72.138	L+T 2FT± W CB RET NW COR RYON AVE + ALONDRA BLVD	SY 763A
BASELINE (1955)	74.034	L+BN S CB ALONDRA BLVD 6IN E CB RET @ SE COR ALONDRA BLVD + PACIFIC AVE 70FT± W PERR	SY 765B
BASELINE (1955)	68.914	L + SPK 4FT± E CB RET @ NE COR CLARK AVE + ALONDRA BLVD	SY 766A
BASELINE (1955)	69.941	L+T C/L INT VIRGINIA DR + ALONDRA BLVD	SY 767A
BASELINE (1955)	69.796	L+T C/L INT LAKEWOOD BLVD + ALONDRA BLVD	SY 768
BASELINE (1955)	68.760	L+T C/L INT PITTS AVE + ALONDRA BLVD	SY 769A
BASELINE (1955)	67.894	L+T C/L HAYTER AVE 8FT± S C/L ALONDRA BLVD	SY 770A

QUAD-YEAR	ELEV	DESCRIPTION (INCLUDE QUAD AND YEAR IN DESCRIPTION)	BM NUMBER
BASELINE (1955)	72.955	BT SPK 1FT± S CB RET SE COR PARAMOUNT BLVD + 1ST ST SY	796A
BASELINE (1955)	72.657	CS MON 17FT± W INT PARAMOUNT BLVD + COMPTON BLVD SY	797A
BASELINE (1955)	72.712	L+T CTR CB RET SE COR PARAMOUNT BLVD + ADAMS ST SY	798
BASELINE (1955)	68.962	L+T W CB PARAMOUNT BLVD 2FT± N CB RET @ NW COR MADISON ST + PARAMOUNT BLVD SY	799A
BELLFLWR (1960)	66.768	L+BN W CB PARAMOUNT BLVD 1FT± S CB RET @ SW COR MONROE ST + PARAMOUNT BLVD SY	800A
BELLFLWR (1960)	66.413	SPK NR C/L PARAMOUNT BLVD 28FT± N C/L JACKSON ST SY	801
BELLFLWR (1960)	66.613	L+SPK S CB HARRISON ST 6FT± W CB RET @ SW COR HARRISON ST + PARAMOUNT BLVD SY	802A
BELLFLWR (1960)	66.056	L+T E CB 5FT± N BCR @ NE COR PARAMOUNT BLVD + 70TH ST 57FT± N + 33FT± E C/L INT SY	803A
BELLFLWR (1960)	65.727	CITY OF LONG BEACH MON IN WELL 6IN DN @ CR NR C/L INT PARAMOUNT BLVD + 70TH ST SY	804A
BELLFLWR (1960)	61.289	L+T CTR CB RET 6FT± E L+BRAD @ NW COR ARTESIA ST + PARAMOUNT BLVD SY	806A
BELLFLWR (1960)	67.320	CT SPK CONC PVMT 17FT± S C/L ALONDRA BLVD 35FT± W C/L ILLINOIS ST SY	807
BELLFLWR (1960)	66.712	CT SPK CONC PVMT @ C/L INT ALONDRA BLVD + GARFIELD AVE SY	808A
BELLFLWR (1960)	65.037	BT IN CONC PVMT 14FT± S C/L ALONDRA BLVD CPP HSE NO 7223 SY	809A
BELLFLWR (1960)	65.717	L+BN IN CHIS SQ W CB 25FT± N BCR @ NW COR ORANGE AVE + ALONDRA BLVD 100FT± N + 30FT± W C/L INT MKD (BM) SY	810A
BASELINE (1955)	71.816	L+N NW COR DAIRY PLATFORM 77FT± E C/L STUDEBAKER RD @ HSE NO 16528 SY	832
BASELINE (1955)	65.708	L+N NE COR DAIRY PLATFORM 80FT± W C/L STUDEBAKER RD @ HSE NO 16829 SY	833
BASELINE (1955)	55.184	L+N CB E SIDE STUDEBAKER RD NR N SIDE 4FT WK IN FRONT OF HSE NO 18406 SY	835A
BASELINE (1955)	73.861	L+T S CB ALONDRA BLVD 68FT± W C/L WOODRUFF AVE SY	960A
BASELINE (1955)	77.152	L+T NR S EDGE CONC DRWY 55FT± W C/L WOODRUFF AVE DRWY TO HSE NO 15509 SY	961
BASELINE (1955)	78.775	L+T NR S EDGE N STRIP CONC DRWY 50FT± E C/L WOODRUFF AVE @ HSE NO 15304 SY	962
BELLFLWR (1960)	67.655	L+T 10FT± S CB RET @ SW COR CLARK AVE + LOS ANGELES AVE SY	1425
BELLFLWR (1960)	66.852	L+T 6IN S CB RET @ SW COR CLARK AVE + MAYNE ST SY	1426
BELLFLWR (1960)	65.930	L+T 2FT± S CB RET W SIDE CLARK AVE @ N SIDE RAMONA SCHOOL SY	1427

QUAD-YEAR	ELEV	DESCRIPTION (INCLUDE QUAD AND YEAR IN DESCRIPTION)	BM NUMBER
BELLFLWR (1960)	65.352	L+T 6IN± N BCR @ SW COR CLARK AVE + FLOWER AVE	SY 1429
BELLFLWR (1960)	64.717	L+T 4FT± N CB RET @ NW COR WALNUT AVE + CLARK	SY 1430
BELLFLWR (1960)	63.792	L+T 4FT± N CB RET @ NW COR PARK AVE + CLARK AVE	SY 1431
BELLFLWR (1960)	63.041	L+T 2FT± N CB RET @ NW COR PALM AVE + CLARK AVE	SY 1432
BELLFLWR (1960)	61.624	CS MON IN WELL 8IN DN 6FT± W CB NW COR CLARK AVE + ARTESIA BLVD 67FT± N + 34 FT± W C/L INT MKD (32-2)	SY 1433B
BELLFLWR (1960)	61.727	BR CAP 7FT± S CB RET @ SW COR ARTESIA AVE + CLARK AVE MKD (LA CO FC BM 74-210)	SY 1434
BELLFLWR (1960)	59.893	L+SPK N CB 4FT± E BCR @ NE COR CLARK AVE + ROSE ST 15FT± N + 43FT± E C/L INT MKD (KN 207)	SY 1435A
BELLFLWR (1960)	60.326	L+T 1FT± S CB RET SW COR CEDAR AVE + CLARK AVE	SY 1436
BELLFLWR (1960)	59.693	L+T 2FT± S CB RET SW COR ROSE AVE + CLARK AVE	SY 1437
BASELINE (1955)	58.977	L+T CTR CB RET SW COR ASHWORTH ST + CLARK AVE	SY 1438A
BASELINE (1955)	61.655	L+T S EDGE CONC DRWY 160FT± S + 35FT± W C/L INT STUDEBAKER RD + ARTESIA BLVD NW COR HSE NO 17323	SY 1487
BELLFLWR (1960)	65.735	L+BR @ NW COR ARTESIA AVE + BELLFLOWER BLVD 5FT± W CTR CB RET	SY 1499A
BASELINE (1955)	72.509	L+T CONC PVMT @ C/L INT COMPTON BLVD + COLORADO AVE	SY 1514B
BASELINE (1955)	73.034	L+BN E END GAS ISLAND 75FT± W + 52FT± S C/L INT COMPTON BLVD + VERMONT AVE	SY 1515A
BASELINE (1955)	69.686	L+BN 63FT± E + 52FT± S C/L INT GARFIELD AVE + COMPTON BLVD CONC SERVICE STA YARD	SY 1518
BASELINE (1955)	70.989	L+T W END CONC SLAB 100FT± N + 60FT± E C/L INT GARFIELD AVE + COMPTON BLVD @ FARMER BOYS MKT	SY 1519A
BASELINE (1955)	70.305	L+T W CONC STRIP 53FT± N C/L COMPTON BLVD AT HSE 7243	SY 1520A
BASELINE (1955)	69.747	L+BN N CB COMPTON BLVD 80FT± W C/L INT TEXACO AVE 20FT± N C/L COMPTON BLVD	SY 1521A
BASELINE (1955)	70.528	SPK W CB SAN MARINO AVE 13FT± N BCR @ NW COR SAN MARINO AVE + COMPTON BLVD (MKD KT-5)	SY 1522A
BASELINE (1955)	70.100	L+T E EDGE CONC WK 65FT± E + 40FT± S C/L INT COMPTON BLVD + ORANGE AVE SE COR	SY 1523A
BASELINE (1955)	69.609	L+S W CB ORANGE AVE 13FT± N BCR @ NW COR COMPTON + ORANGE AVE	SY 1524A
BELLFLWR (1960)	64.686	CS MON IN WELL 8IN DN NR C/L ORANGE AVE 100FT± N C/L ALONDRA BLVD MKD (CO SUR RE 329)	SY 1525A
BELLFLWR (1960)	66.864	RDEM TAG N CB 1FT± W BCR @ NW COR ALONDRA BLVD + GARFIELD AVE 40FT± N + 78FT± W C/L INT	SY 1916A

JUL 1964

LOS ANGELES COUNTY ROAD DEPARTMENT
SURVEY SECTION FIELD ENGINEERING DIVISION

PAGE 5

QUAD-YEAR	ELEV	DESCRIPTION (INCLUDE QUAD AND YEAR IN DESCRIPTION)	BM NUMBER
BELLFLWR (1960)	66.163	L+T MCR NE COR PARAMOUNT BLVD + JACKSON ST	SY 1925
BASELINE (1955)	70.014	L+T IN CONC APRON TO BLDG 7002 COMPTON BLVD 45FT± E C/L ORANGE AVE + 35FT± S C/L COMPTON BLVD @ SE COR	SY 1930A
BASELINE (1955)	69.955	L+T W END OF CONC APRON TO BLVD 7000 COMPTON BLVD 25FT± E C/L ORANGE AVE + 45FT± S C/L COMPTON BLVD	SY 1931A
BASELINE (1955)	68.840	L+T W CB EL CAMINO AVE 6FT± N CB RET @ NW COR COMPTON BLVD + EL CAMINO AVE	SY 1932B
BASELINE (1955)	68.955	L+T E CB 15FT± S CB RET @ SE COR FAULKNER AVE + COMPTON BLVD	SY 1933A
BASELINE (1955)	68.922	L+T W CB SAN JOSE AVE 5FT± N CB RET @ NW COR SAN JOSE AVE + 1ST ALLEY N COMPTON BLVD	SY 1934B
BASELINE (1955)	68.763	L+BN W CB SAN JOSE AVE 2FT± N CB RET NW COR SAN JOSE AVE + 1ST ALLEY S COMPTON BLVD	SY 1935B
BASELINE (1955)	68.596	L+T W CB SAN JOSE AVE 8FT± S CB RET @ SW COR SAN JOSE AVE + 1ST ALLEY S COMPTON BLVD	SY 1936A
BASELINE (1955)	67.415	CS MON C/L SAN JOSE AVE + APPROX N P/L OF 1ST ALLEY S COMPTON 130FT± S C/L INT SAN JOSE AVE + COMPTON BLVD	SY 1937B
BASELINE (1955)	69.327	L+T W EDGE CONC APRON TO GARAGE OF HSE 15111 SAN JOSE AVE 135FT± W C/L SAN JOSE AV + 10FT± S C/L 1ST ALLEY S COMPTON BLVD	SY 1938A
BASELINE (1955)	67.099	CS MON @ C/L INT OF COMPTON BLVD + SAN ANTONIO AVE IN WELL W/COVER 1FT DEEP STAMPED (RE 329)	SY 1940A
BASELINE (1955)	88.545	RDBM TAG IN EAST ABUT. @ NE COR OF COMPTON BLVD BRIDGE OVER LA RIVER 0.4FT± N OF CB FACE	SY 1941B
BASELINE (1955)	91.909	SET RDBM TAG IN N CB @ CTR PIER OF COMPTON BLVD BRIDGE OVER LA RIVER	SY 1942A
BASELINE (1955)	90.124	RDBM TAG IN WEST ABUT. @ NW COR OF COMPTON BLVD BRIDGE OVER LA RIVER 0.65FT± N OF CB FACE	SY 1943B
BASELINE (1955)	78.240	RDBM TAG IN SOUTH CB COMPTON BLVD 65FT± W OF BRIDGE NO 53-823 OVER THE (LONG BEACH FREEWAY) 250FT± E OF GIBSON AVE	SY 1944B
BASELINE (1955)	68.709	L+T 2FT± N CB RET @ NW COR 1ST ALLEY N COMPTON BLVD ON GIBSON ST	SY 1945B
BASELINE (1955)	67.883	L+T 7FT± S CB RET @ SW COR 1ST ALLEY S COMPTON BLVD ON GIBSON ST	SY 1947B
BASELINE (1955)	67.551	L+T 2.5FT± S CB RET @ SE COR 1ST ALLEY S COMPTON BLVD ON WILLIAMS AVE	SY 1948A
BASELINE (1955)	67.142	CS MON @ C/L INT WILLIAMS AVE + 1ST ALLEY S COMPTON BLVD	SY 1949A
BASELINE (1955)	67.680	L+T S CB COMPTON BLVD 10FT± W CB RET @ SW COR COMPTON BLVD + WILLIAMS AVE	SY 1950A
BASELINE (1955)	68.466	L+T W CB WILLIAMS AVE 20FT± N CB RET @ NW COR WILLIAMS AVE + 1ST ALLEY N COMPTON BLVD	SY 1951A
BASELINE (1955)	67.260	L+T S CB COMPTON BLVD 8FT± W CB RET @ SW COR COMPTON BLVD + FRAILEY AVE	SY 1952A

JUL 1964

LOS ANGELES COUNTY ROAD DEPARTMENT
SURVEY SECTION FIELD ENGINEERING DIVISION

PAGE 6

QUAD-YEAR	ELEV	DESCRIPTION (INCLUDE QUAD AND YEAR IN DESCRIPTION)	BM NUMBER
BASELINE (1955)	66.905	L+SPK S CB COMPTON BLVD 12FT# W CB RET @ SW COR COMPTON BLVD + LIME AVE (SPK MKD T-376)	SY 1953A
BASELINE (1955)	66.900	L+T CTR CB RET @ SE COR COMPTON BLVD + ATLANTIC AVE	SY 1954B
BASELINE (1955)	66.684	LA METRO WATER DIST BR DISC IN CONC SQ 31.3FT# S OF C/L OF COMPTON BLVD 13.3FT# W OF CB RET @ SW COR COMPTON BLVD + ATLANTIC AVE 78FT# SW OF C/L INT MKD (MET WATER DIST 56-W)	SY 1955B
BASELINE (1955)	73.678	L+N SE COR CONC SIGNAL BASE 20FT# S @ C/L COMPTON BLVD W SIDE UPRR	SY 1993A
BASELINE (1955)	69.100	L+T 1FT# S CB RET @ SW COR CENTER ST + LAKEWOOD BLVD	SY 2093A
BASELINE (1955)	71.072	L+BN N CB PACIFIC AVE 65FT# E CB RET @ NE COR PACIFIC AVE + ALONDRA BLVD	SY 2113A
BASELINE (1955)	66.793	L+BN N CB ALONDRA BLVD 1FTS8 W CB RET @ NW COR ALONDRA BLVD + DOWNEY AVE	SY 2342A
BASELINE (1955)	66.864	L+T CTR CB RET @ SE COR ALONDRA BLVD + DOWNEY AVE	SY 2343A
BASELINE (1955)	51.858	L+T CONC WK NR NE COR GAS STATION 8/FT# S + 70FT# W C/L INT DOWNEY AVE + SOUTH ST	SY 2349
BASELINE (1955)	50.128	RDBM TAG S CB 1FT# W FUT BCR @ SE COR SOUTH ST DOWNEY AVE 40FT# S + 57FT# E C/L INT	SY 2350A
BASELINE (1955)	68.972	L+BN N CB COMPTON BLVD 13FT# E OF E RAIL OF SPRR 29FT# W CB RET @ NW COR ALAMEDA ST E DR + COMPTON BLVD 60FT# W C/L E DRIVE 28FT# N C/L COMPTON BLVD	SY 2356A
BASELINE (1955)	69.164	L+BN S CB COMPTON BLVD 5FT# E OF E RAIL OF SPRR 29FT# W CB RET @ SW COR ALAMEDA ST E DR + COMPTON BLVD 70FT# W C/L E DRIVE 28FT# N C/L COMPTON BLVD	SY 2357A
BASELINE (1955)	65.802	L+T 25FT# W C/L ALAMEDA ST E BARREL ON C/L PROD LAUREL ST TO THE E	SY 2358A
BASELINE (1955)	66.197	L+T W CB @ BCR @ NW COR ALAMEDA ST E BARREL + LAUREL ST TO THE W 25FT# W + 32FT# N C/L INT	SY 2359A
BASELINE (1955)	64.431	STEEL SPK WITH (X) ON TOP CTR S BCR TO DRWY OF COMPTON STREET DEPT NO 458 S ALAMEDA ST 29FT# E C/L E BARREL 180FT# N MYRRH ST	SY 2360A
BASELINE (1955)	65.448	CS MON IN WELL 10IN DN 50FT# E C/L SPRR 27FT# W C/L ALAMEDA ST E BARREL + 18FT# S C/L PROD MYRRH ST TO THE E MKD (BM 5-22A)	SY 2361A
BASELINE (1955)	64.997	L+BN W CB ALAMEDA ST E BARREL 12FT# E OF 5TH TELEGRAPH POLE N OF OLIVE ST 530FT# S OF MYRRH ST 25FT# W C/L	SY 2362A
BASELINE (1955)	66.096	L+T IN CB ALONDRA BLVD 20FT# E OF E RAIL OF SPRR 40FT# W C/L ALAMEDA ST E BARREL 30FT# N C/L ALONDRA BLVD	SY 2363A
BASELINE (1955)	65.257	L+T CTR CB RET @ SE COR ALONDRA BLVD + ALAMEDA ST W BARREL 45FT# E C/L W BARREL + 41FT# S C/L ALONDRA BLVD	SY 2364A
BASELINE (1955)	63.023	L+T E CB ALAMEDA ST C/L PROD RAYMOND AVE 27FT# E C/L ALAMEDA ST	SY 2365A

QUAD-YEAR	ELEV	DESCRIPTION (INCLUDE QUAD AND YEAR IN DESCRIPTION)	BM NUMBER
BASELINE (1955)	62.777	L+T E CB ALAMEDA ST C/L PROD REEVE ST	SY 2366A
BASELINE (1955)	62.408	L+T E CB ALAMEDA ST C/L PROD TICHNOR ST	SY 2367A
BASELINE (1955)	62.130	L+T E CB ALAMEDA ST C/L PROD CALDWELL ST 26FT± E C/L ALAMEDA ST	SY 2368A
BASELINE (1955)	61.826	L+T E ALAMEDA ST C/L PROD JOHNSON ST	SY 2369A
BASELINE (1955)	61.518	L+T E CB ALAMEDA ST C/L PROD BENNETT ST TO THE W	SY 2370A
BASELINE (1955)	60.757	L+BN E CB ALAMEDA ST OPP MILE POST NO 495 SPRR	SY 2373A
BASELINE (1955)	60.279	STD DISC TOP OF CONC POST 3FT± N OF MILE POST NO 495 SPRR + 38FT± E C/L SPRR 2FT± BELOW TOP OF RAIL MKD (Q 768 1945)	SY 2374A
BASELINE (1955)	59.741	L+BN E CB ALAMEDA ST OPP PP NO 1328507E W SIDE SPRR + 4TH TP N OF ARTESIA AVE	SY 2375A
BASELINE (1955)	63.442	L+BN E CB ALAMEDA ST @ ANGLE POINT OF WINGWALL @ NE COR BRIDGE NO 774 OVER COMPTON CREEK 22FT± E C/L + 174FT± N C/L CREEK + 400FT± S ARTESIA BLVD	SY 2377A
BASELINE (1955)	58.668	FC BR CAP @ S END OF WINGWALL @ NE COR SPRR BRIDGE 90FT± E C/L ALAMEDA ST + 450FT± S C/L ARTESIA BLVD MKD (RBM 44-33)	SY 2378A
BASELINE (1955)	63.474	FC BR CAP 5FT± S ANGLE POINT WINGWALL SW COR BRIDGE NO 774 ON ALAMEDA ST OVER COMPTON CREEK 28FT± W C/L + 600FT± S ARTESIA BLVD MKD (BM 44-33)	SY 2379A
BASELINE (1955)	52.041	FC BR CAP E CB ALAMEDA ST 22FT± E C/L OPP MAIN ENT DOMINQUEZ SEMINARY 0.25MI± N DOMINQUEZ JCT 18FT± S PP NO 241560E MKD (RBM 44-32)	SY 2380A
BASELINE (1955)	53.343	FC BR CAP SE COR 8X8FT CONC VALVE BOX 58FT± E C/L SPRR + 125FT± E C/L ALAMEDA ST OPP MAIN ENT TO DOMINQUEZ SEMINARY MKD (BM 44-32)	SY 2381A
BASELINE (1955)	51.101	L+BN W CB ALAMEDA ST 22FT± W C/L OPP NE COR 8FT CHAIN LINK FENCE AROUND SO CAL EDISON SUB-STATION PROPERTY 650FT± N DOMINGUEZ JCT	SY 2382A
BASELINE (1955)	51.999	CS MON IN CONC FLUSH APPROX C/L PERR TRACTS 50FT± W C/L ALAMEDA ST 56FT± N OF N COR DOMINGUEZ JCT STA HSE BET ARTESIA BLVD + DEL AMO BLVD MKD (K-5 RE 2177 1942)	SY 2383A
BASELINE (1955)	47.192	L+BN W CB ALAMEDA ST 22FT± W C/L + 530FT± S C/L LONG BEACH LINE PERR 37FT± N TP NO 16767R	SY 2384A
BASELINE (1955)	46.369	L+BN E CB ALAMEDA ST 22FT± E C/L + 1630FT± S C/L LONG BEACH LINE PERR 47FT± S TP NO 662675H	SY 2385A
BASELINE (1955)	44.715	L+BN E CB ALAMEDA ST 2 BARREL 22FT± E C/L 3FT± S TP NO 46810CH 2630FT± S C/L LONG BEACH LINE PERR	SY 2386A
BASELINE (1955)	43.410	L+T E CB ALAMEDA ST W BARREL 22FT± E C/L 3FT± S TP NO 4469US 0.5MI± N DEL AMO BLVD	SY 2387A

JUL 1964

LOS ANGELES COUNTY ROAD DEPARTMENT
SURVEY SECTION FIELD ENGINEERING DIVISION

PAGE 8

QUAD-YEAR	ELEV	D E S C R I P T I O N (INCLUDE QUAD AND YEAR IN DESCRIPTION)	BM NUMBER
BASELINE (1955)	43.403	STD USGS DISC IN CONC POST 3IN UP 30FT± E C/L SPRR 55FT± W C/L ALAMEDA ST E BARREL OPP BLDG NO 19600 (WOLF RANGE CORP) 4FT± N TP NO LU 2FT± W OF WHITE WOODEN WITNESS POST MKD (P768 1945)	SY 2388A
BASELINE (1955)	41.859	L+BN E CB ALAMEDA ST W BARREL 22FT± E C/L 3FT± S OF TP NO 429291H OPP BLDG NO 19722	SY 2389A
BASELINE (1955)	41.348	CUT SPK E CB ALAMEDA ST W BARREL 22FT± E C/L 1FT± W OF TP NO 457450H C.25MI± N OF DEL AMO BLVD	SY 2390A
BASELINE (1955)	34.332	CS MON IN WELL 2FT± N C/L DEL AMO BLVD @ APPROX C/L OF 2 SETS OF PERR TRACKS W ALAMEDA ST W BARREL MKD (COMP J-7 1942 RE 2177)	SY 2391A
BASELINE (1955)	38.192	L+T E CB 2FT± S OF END OF CB @ SE COR ALAMEDA ST W BARREL + DEL AMO BLVD 4FT± N TP NO 427134H 65FT± S + 22FT± E C/L INT	SY 2392A
BASELINE (1955)	33.128	L+SPK E CB ALAMEDA ST W BARREL 22FT± E C/L 48FT± N PP NO 577434 1400FT± S DEL AMO BLVD	SY 2393A
BASELINE (1955)	32.557	L+BN E CB ALAMEDA ST W BARREL 22FT± E C/L 23FT± PP NO 577803R 900FT± N OF DOMINGUEZ ST	SY 2394A
BASELINE (1955)	33.488	L+BN S CB TRAFFIC ISLAND @ NW COR ALAMEDA ST + DOMINGUEZ ST (HALF WAY BETWEEN SPRR + PERR)	SY 2395A
BASELINE (1955)	32.116	L+T MCR @ SE COR ALAMEDA ST + DOMINGUEZ ST	SY 2414A
BASELINE (1955)	31.764	L+T S CB DOMINGUEZ ST 1FT± W DRWY HSE NO 2638 DOMINGUEZ ST	SY 2415A
BASELINE (1955)	32.405	L+T S CB DOMINGUEZ ST 25FT± W DRWY HSE NO 2738 DOMINGUEZ ST (FRONT FIRE PLUG)	SY 2416A
BASELINE (1955)	33.268	L+SPK W CB SANTA FE AVE 3FT± S CB RET @ SW COR DOMINGUEZ ST + SANTA FE AVE	SY 2417A
BASELINE (1955)	65.246	C S MON 30FT± N + 80FT± E C/L INT ALONDRA BLVD + DOWNEY AVE 6FT± E OF CATCH BASIN	SY 2587
BASELINE (1955)	66.664	L+T NR W ED OF CONC WK 20FTS8 E OF BLDG NO 8549 ALONDRA BLVD 55FT± N OF C/L ALONDRA BLVD (WSIDE OF DRIVE ENT TO BURGE + GRAY MATERIALS CO YARD) 6FT± N OF BEG OF WK	SY 2588A
BASELINE (1955)	67.839	L+T NR W ED OF CONC WK AROUND HSE NO 8700 ALONDRA BLVD 57FT± S + 25FT± E C/L INT ALONDRA BLVD + HAYTER ST	SY 2589
BASELINE (1955)	69.866	L+T SE COR CONC APRON IN FRONT OF BLDG NO 9161 ALONDRA BLVD 85FT± N C/L ALONDRA BLVD 31FT± W C/L VIRGINIA DR	SY 2593A
BASELINE (1955)	69.045	SPK N EDGE CONC PVMT 22FT± N C/L ALONDRA BLVD 23FT± E TP NO M-1173-Y 10FT± W C/L SANTA ANA AVE 600FT± W CLARK AVE MKD (ML33)	SY 2595A
BASELINE (1955)	67.729	CS MON 30FT± N + 70FT± E C/L INT ALONDRA BLVD + CLARK AVE 6FTS8 S OF N CB + 20FT± E OF CB RET @ NE COR ALONDRA MKD (BM 6-8 RE NO 63-1951)	SY 2596A
BASELINE (1955)	73.636	L+T N CB 4FT± W CB RET @ NW COR ALONDRA BLVD + BLAINE AVE	SY 2597A
BASELINE (1955)	73.780	L+T N CB 2FT± E CB RET @ NE COR ALONDRA BLVD + BLAINE AVE	SY 2598

JUL 1964

LOS ANGELES COUNTY ROAD DEPARTMENT
SURVEY SECTION FIELD ENGINEERING DIVISION

PAGE 9

QUAD-YEAR	ELEV	DESCRIPTION (INCLUDE QUAD AND YEAR IN DESCRIPTION)	BM NUMBER
BELLFLWR (1955)	74.086	L+BN CB W OF BELLFLOWER WATER CO PLANT NO 1 10FT# S OF S CB ALONDRA BLVD + 18FT# E C/L BLAINE AVE PROD	SY 2599A
BASELINE (1955)	74.479	L+BN S CB 1FT# W CB RET @ SW COR ALONDRA BLVD + BELLFLOWER BLVD	SY 2600
BASELINE (1955)	75.177	L+B NW CB 10FT# S CB RET SW COR EUCALYPTUS AVE + ALONDRA BLVD	SY 2602A
BASELINE (1955)	92.444	CO FLOOD CONTROL BR DISC IN SW COR BRIDGE NO B977 OVER SAN GABRIEL RIV 25FT# C/L ALONDRA BLVD MKD (BM 75-46)	SY 2611A
BASELINE (1955)	89.640	CORP OF ENGINEERS BR DISC IN SE COR BRIDGE NO B977 OVER SAN GABRIEL RIV 25FT S C/L ALONDRA BLVD MKD (SG 18 1958)	SY 2612A
BASELINE (1955)	72.464	L+T NW COR OF CONC DRWY HSE NO 10658 ALONDRA BLVD 45FT# S C/L 2ND HSE E OF BRIDGE OVER SAN GABRIEL RIV	SY 2613A
BASELINE (1955)	72.475	L+T N CB 1FT# E CB RET @ NE COR ALONDRA BLVD SERVICE RD + PIUMA AVE	SY 2614
BASELINE (1955)	72.954	L+T N CB @ CB RET NE COR ALONDRA BLVD SERVICE RD + BEHRENS AVE	SY 2615
BASELINE (1955)	73.422	L+T N CB 1FT# E CB RET @ NE COR ALONDRA BLVD SERVICE RD + DUMONT AVE	SY 2616A
BASELINE (1955)	73.948	L+T N CB 1FT# E OF CB RET @ NE COR ALONDRA BLVD SERVICE RD + LEIBACHER AVE	SY 2617A
BASELINE (1955)	72.813	CS REF MON IN WELL 9IN DN DN NW COR STUDEBAKER RD + ALONDRA BLVD 56FT# N + 62FT# W C/L INT MKD (ARTESIA A-2 NO 3 1960)	SY 2618A
BASELINE (1955)	73.258	CS REF MON IN WELL 9IN DN DN NE COR STUDEBAKER RD + ALONDRA BLVD 85FT# N + 50FT# E C/L INT MKD (ARTESIA A-2 NO 4 1960)	SY 2619A
BASELINE (1955)	61.574	BT SPK CTR HDWL ON NE COR ARTESIA BLVD + STUDEBAKER RD 41FT# W 19FT# E C/L INT	SY 2646A
BASELINE (1955)	44.597	L+BN N CB CARSON ST @ NE COR CARSON ST + 1ST ALLEY W OF WOODRUFF AVE 1FT# E CB RET	SY 2678A
BASELINE (1955)	45.107	L+T N CB CARSON ST @ NW COR CARSON ST + WOODRUFF AVE 2FT# W CB RET	SY 2679A
BELLFLWR (1960)	41.320	L+T W CB 1FT# N CB RET @ NW COR WOODRUFF AVE + HARCO ST	SY 2681A
BELLFLWR (1960)	40.898	L+T W CB 1FT# S CB RET @ SW COR WOODRUFF AVE + HARCO ST	SY 2682A
BELLFLWR (1960)	36.029	L+T W CB 1FT# N CB RET @ NW COR WOODRUFF AVE + CONANT ST	SY 2683A
BELLFLWR (1960)	35.090	RD MON @ C/L INT CONANT ST + WOODRUFF AVE	SY 2684A
BELLFLWR (1960)	35.546	L+T W CB 1FT# S CB RET @ SW COR CONANT ST + WOODRUFF AVE	SY 2685A
BELLFLWR (1960)	32.781	L+T W CB SERVICE RD 1FT# N CB RET @ NW COR MONLACO RD + WOODRUFF AVE	SY 2686A

