

**COUNTY OF LOS ANGELES**  
**ROAD DEPARTMENT**

**PRECISE**  
**BENCH MARK LIST**



**COVINA QUAD**  
**1965 ADJUSTMENT**

## PREFACE

The Road Department level net is composed of more than 1,000 miles of levels supporting in excess of 10,000 bench marks. In 1964-65, a major readjustment of the net was undertaken. To emphasize the complete break with previous elevations, the SY, SG & SL series bench marks have been re-labeled BY, BG & BL, respectively.

To facilitate the adjustment, indexing, and distribution of adjusted values of the net, the County territory was divided into 31 quads or areas. For identification purposes each quad was given a name, viz., "Rosemead," "La Mirada," "Santa Fe," etc. When bench marks and elevations in the Road Department net are used, the name of the quad in which the bench mark is located and the date of the adjustment of the elevation must be included in the bench mark description, e.g.,

BG 1887 --L+BN IN CONC HDWL OF DRAIN PIPE UNDER DR 218 FT  
NE +18 FT SE C/L INT SAN JOSE HILLS RD +CAMERON AVE MKD (BM)  
( COVINA --1965 ) ELEV. 696.238

It is expected that this general adjustment will, for the most part, remain sound for the next 8 to 12 years. As new circuits are completed, however, re-adjustment of individual quads may become advisable. It is expected that these subsequent adjustments will be in the nature of a few hundredths of a foot. When a quad is re-adjusted, new elevation lists will be published and the date of the re-adjustment will replace the "1965" at the end of the bench mark description. Two bench marks in the same quad with different adjustment dates will not normally join each other. Since all adjustments taper out to nothing at the periphery of the quad, any bench mark in one quad will join any bench mark in another quad regardless of their respective adjustment dates.

The basic accuracy of the net is reflected by an indicated field probable error of plus or minus 0.012 foot per mile of leveling as determined from 298 conditions of closure. However, many years experience in vertical control in the greater Los Angeles basin and Antelope Valley indicate that because of varying degrees of subsidence and heaving, the true datum is recovered only by obtaining substantial agreement of a number of bench marks.

The users of this net are invited to assist in its maintenance by notifying this Department of cases of obliteration, apparent mistakes in descriptions or elevations, and proven disturbance of bench marks.

---

DATUM: U. S. Coast and Geodetic Survey Sea Level Datum  
of 1929, through the medium of the Los Angeles  
County Engineer Precise Level Net, 1963 Adjust-  
ment.

## Abbreviations Used in Bench Mark Listings

ABUT--Abutment	L+BN--Lead and Bench Mark Nail
ANG PT--Angle Point	L+BR--Lead and Brad
BC--Beginning of Curve	L+N--Lead and Nail
BCR--Beginning of Curb Return	L+PK--Lead and PK Nail
BLDG--Building	L+SPK--Lead and Spike
BT SPK--Boat or Bolt Spike	L+T--Lead and Tack
CB RET--Curb Return	MCR--Middle of Curb Return
C/L INT--Center Line Intersection	MKD--Marked
C/L PROD--Center Line Produced	NR--Near
COE--Corps of Engineers	OPP--Opposite
CONC--Concrete	PI--Point of Intersection
CS MON--County Surveyor Monument	PK+W--PK Nail and Washer
CS BR CAP--County Surveyor Brass Cap Monument	P/L--Property Line
CT SPK--Cut Spike	P O S T--Point on Semi-tangent
CTR--Center	PP--Power Pole
DN--Down	PVMT--Pavement
DR--Driveway	R D--Road Department
EC--End of Curve	RDBM--Road Department Bench Mark
ENT--Entrance	RR--Railroad
FC--Flood Control (Dept. LA County)	SPK T+W--Spike, Tin and Washer
FTG--Footing	USC+GS--United States Coast and Geodetic Survey
HDWL--Headwall	USGS--United States Geological Survey
HSE--House	WK--Walk
IP--Iron Pipe	±--Plus or Minus
LACE--Los Angeles City Engineer	+--And

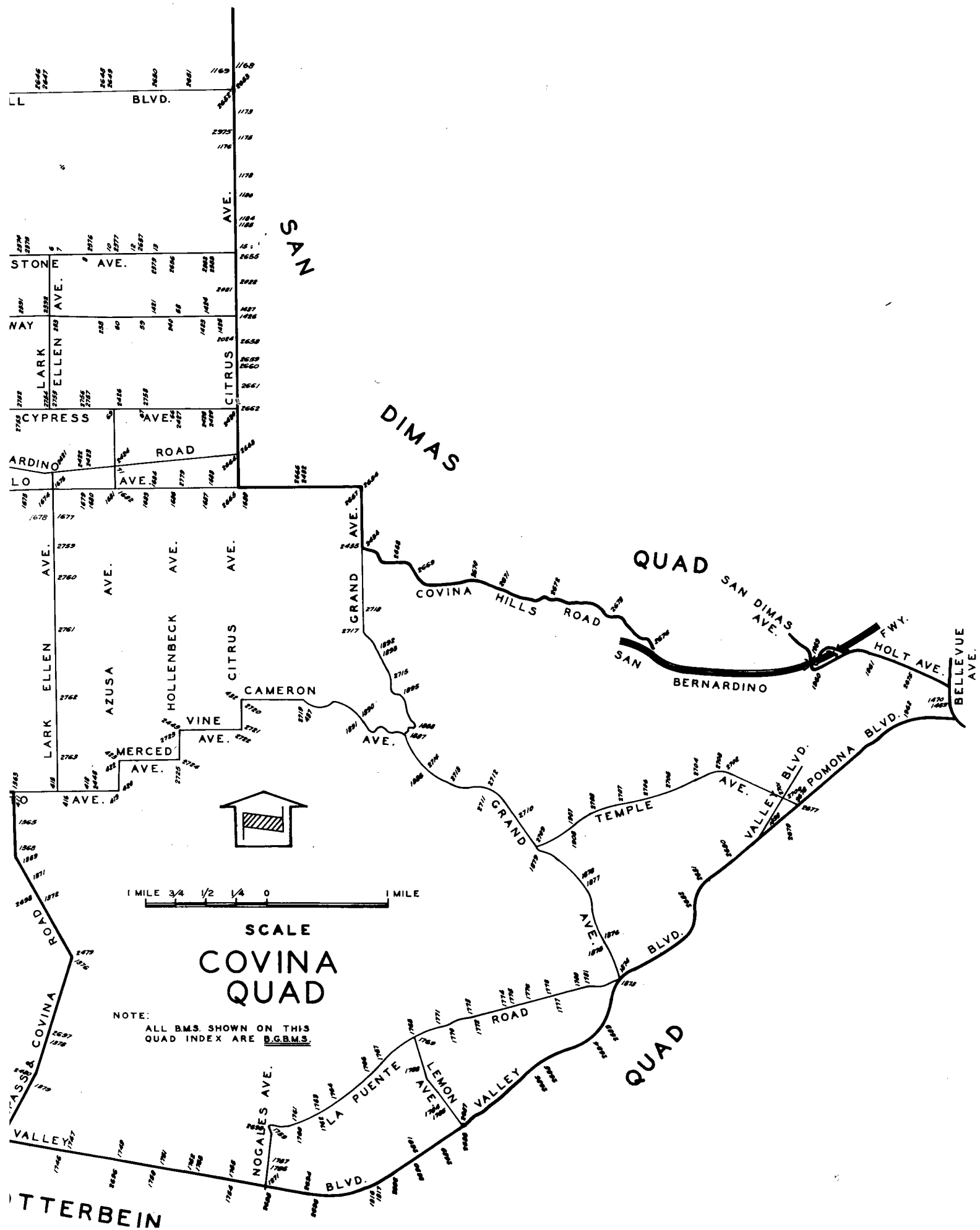

SAN

DIMAS

QUAD

SAN DIMAS AVE.

COVINA HILLS ROAD  
SAN BERNARDINO

FWY.

HOLT AVE.

BELLEVUE AVE.



SCALE  
COVINA  
QUAD

NOTE:  
ALL B.M.S. SHOWN ON THIS  
QUAD INDEX ARE B.G.B.M.S.

QUAD

BUTTERBEIN

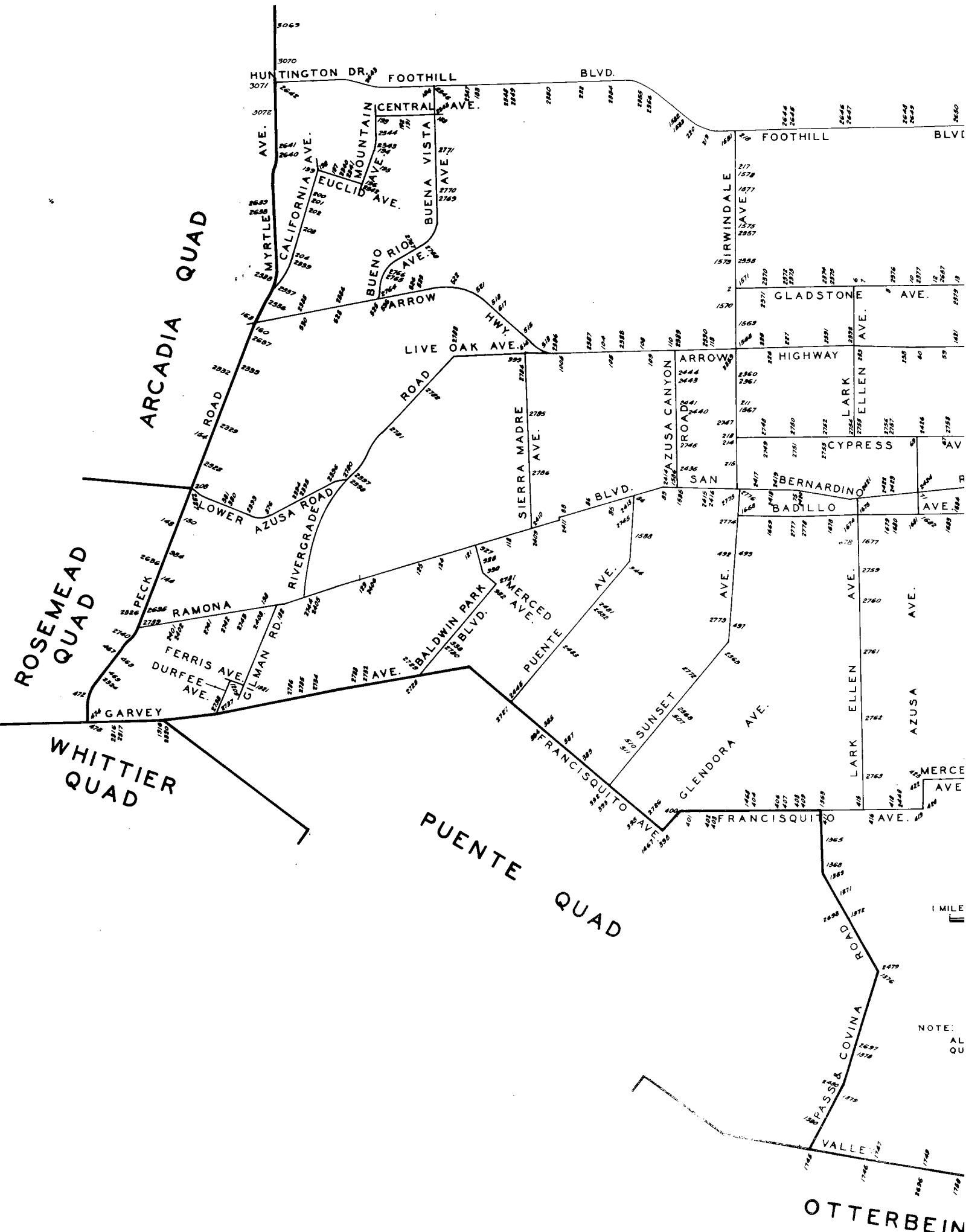

ARCADIA QUAD

ROSEMEAD QUAD

WHITTIER QUAD

PUENTE QUAD

OTTERBEIN

1 MILE

NOTE:  
ALL QUAD

QUAD-YEAR	ELEV	DESCRIPTION (INCLUDE QUAD AND YEAR IN DESCRIPTION)	BM NUMBER
COVINA (1965)	497.972	L+T W CB IRWINDALE AVE 60FT N C/L GLADSTONE ST 30FT N END OF CB	BG 2
COVINA (1965)	506.248	RDBM TAG N CB 2FT W BCR @ NW COR GLADSTONE ST + VERNON AVE (LARK ELLEN AVE) 30FT N + 65FT W C/L INT	BG 6
COVINA (1965)	505.961	L+T N CB 16FT BCR @ NE COR GLADSTONE ST + VERNON AVE (LARK ELLEN AVE) 75FT E + 30FT N C/L INT	BG 7
COVINA (1965)	512.640	L+N IN NE COR OF WEST BCR 30FT S C/L GLAD- STONE ST 75FT W C/L SUNSET AVE	BG 8
COVINA (1965)	517.976	L+BN N CB 1FT W BCR @ NW COR GLADSTONE ST + AZUSA AVE 30FT N + 70FT W C/L INT	BG 10
COVINA (1965)	536.797	L+T W CB 1FT N BCR @ NW COR GLADSTONE ST + PASADENA AVE 66FT N + 20FT W C/L INT	BG 12
COVINA (1965)	551.640	CS REF MON 6IN DN IN ISLAND @ NE COR GLAD- STONE ST + CERRITOS AVE 40FT N + 115FT E C/L INT MKD (GLENORA RM NO1)	BG 13
BASELINE (1965)	587.368	DISC TOP OF CONC ST 1FT DN UNDER CS CASTIRON CAP 65FT E + 12FT C/L INT CITRUS AVE + GLADSTONE ST	BG 15
COVINA (1965)	545.650	RD MON @ OIL INT CERRITOS AVE + ARROW HWY	BG 58
COVINA (1965)	530.572	L+T CTR CB RET @ SW COR ARROW HWY + ARMEL DR	BG 59
COVINA (1965)	520.860	L+BN W END OF GAS STA 105FT E C/L AZUSA AVE + 75FT S C/L ARROW HWY	BG 60
BASELINE (1965)	564.340	BT SPK E CB 5FT S C/L SE COR CITRUS AVE + CYPRESS ST 62FT W 30FT E C/L INT MKD (SD 137)	BG 64
COVINA (1965)	529.208	SQ HD SPK W CB 3FT N BCR @ SW COR CYPRESS ST + HOLLENBECK AVE 65FT S + 35FT W C/L INT	BG 66
COVINA (1965)	514.424	L+T 15FT W BCR @ SW COR ELSPETH WAY + CYPRESS ST	BG 67
COVINA (1965)	501.270	RDBM TAG W CB 2FT S BCR @ SW COR CYPRESS ST + AZUSA AVE 42FT W + 69FT S C/L INT	BG 69
COVINA (1965)	492.057	L+FLAT SPK E CB 45FT S BCR @ SE COR AZUSA AVE + SAN BERNARDINO RD 106FT S 43FT E C/L INT	BG 71
COVINA (1965)	437.458	L+BN CB 48FT S C/L SE COR SAN BERNARDINO RD + VINCENT AVE 30FT E 123FT S C/L INT	BG 75
COVINA (1965)	403.275	L+N IN CTR E CB RET OF ENT TO COVINA WATER CO 31FT S C/L SAN BERNARDINO RD	BG 83
COVINA (1965)	396.441	L+T IN E END PUMP ISLAND OF GAS STATION @ SE COR E RAMONA BLVD + PUENTE AVE	BG 84
COVINA (1965)	389.055	L+BN NE COR CONC SLAB OF BLDG 51FT S C/L E RAMONA BLVD + 4FT E C/L PROD PARK PL MKD (BM)	BG 85
COVINA (1965)	382.244	L+N IN W CB DOWNING AVE 95FT N C/L OF E ROMONA BLVD S OF ALLEY	BG 86

QUAD-YEAR	ELEV	DESCRIPTION (INCLUDE QUAD AND YEAR IN DESCRIPTION)	BM NUMBER
COVINA (1965)	375.825	L+T IN CTR CB RET NW COR MAINE AVE + RAMONA BLVD N OF PERR	BG 88
COVINA (1965)	440.958	CS MON IN WELL 8IN DN @ C/L INT ARROW HWY + HEINTZ ST MKD (AZUSA F18)	BG 104
COVINA (1965)	442.198	CS REF MON FLUSH IN CONC SLAB ON SE COR ARROW HWY + HEINTZ ST 55FT S + 35FT E C/L INT MKD (AZUSA F18)	BG 105
COVINA (1965)	453.848	L+T IN CONC RET WALL S SIDE ARROW HWY 45FT E OF GATE TO HSE NO 15250	BG 108
COVINA (1965)	455.064	L+T NE COR CONC STEP FRONT OF BLDG NO 15260 45FT S C/L ARROW HWY	BG 109
COVINA (1965)	458.805	L+BN CONC FOOTING OF FEN COR @ NW COR ARROW HWY + AZUSA CN RD 48FT N + 18FT W C/L INT. MKD (BM)	BG 110
COVINA (1965)	465.442	L+N SW COR <del>OF</del> NEAR E P/L 4TH ST 83FT N C/L ARROW HWY	BG 113
COVINA (1965)	357.092	RDBM TAG S CB 1FT W BCR @ SW COR RAMONA BLVD + STEWART AVE 41FT W + 35FT S C/L INT	BG 118
COVINA (1965)	347.814	L+T 1FT N BCR @ SW COR IDAHO ST + W RAMONA BLVD	BG 121
COVINA (1965)	338.594	L+T 4FT E BCR @ SE COR GRACE AVE + W RAMONA BLVD	BG 124
COVINA (1965)	336.364	L+T @ BCR @ SE COR FOSTER AVE + W RAMONA BLVD	BG 125
COVINA (1965)	325.728	RDBM TAG 1FT S BCR @ SW COR RAMONA BLVD + SAN FRANCISQUITO AVE 65FT S + 30FT W C/L INT	BG 129
COVINA (1965)	320.922	CS MON IN WELL 14IN DN 18FT S C/L RAMONA BLVD + 108FT E OF BRIDGE OVER RIVERGRADE MKD (PUENTE A3)	BG 132
COVINA (1965)	318.086	L+N IN E END GAS ISLAND GAS STA NO 12357 RAMONA BLVD 2FT N C/L PVMT 218158 W RAMONA BLVD + 300FT W OF BRIDGE	BG 133
BASELINE (1965)	308.608	L+T @ SW COR DRIVEWAY 48FT E C/L PECK RD + 100FT S C/L BASYE ST	BG 144
BASELINE (1965)	331.672	L+T MC COR PECK RD + HEMLOCK ST	BG 154
BASELINE (1965)	352.326	L+8N 3FT S BCR @ SE COR PECK RD + LIVE OAK AVE	BG 160
BASELINE (1965)	352.698	CS MON 21 FT W C/L PECK RD + 30FT N C/L LIVE OAK AVE	BG 163
COVINA (1965)	506.326	L+N 3FT S BCR @ SE COR BRYCEDALE AVE + HUNTINGTON DR	BG 183
COVINA (1965)	509.733	BT SPK W CB 40FT S BCR @ SW COR HUNTINGTON DR + BUENA VISTA ST 108FT S + 30FT W C/L INT	BG 184
COVINA (1965)	479.908	L+T IN CENTRAL AVE 30FT S C/L + 20FT E C/L BUENA VISTA ST	BG 188

QUAD-YEAR	ELEV	DESCRIPTION (INCLUDE QUAD AND YEAR IN DESCRIPTION)	BM NUMBER
COVINA (1965)	486.351	L+T IN W CB @ SW COR BROADLAND AVE + CENTRAL AVE	BG 191
COVINA (1965)	488.090	L+T 1FT @ SE COR BRADBURY AVE + CENTRAL AVE	BG 192
COVINA (1965)	489.368	L+T NR N EDGE FIRST CONC STEP TO W HSE ENT NO 906 @ SE COR CENTRAL AVE + MOUNTAIN AVE	BG 193
COVINA (1965)	455.508	L+T IN CTR @ SE COR DUARTE RD + MOUNTAIN AVE	BG 194
COVINA (1965)	440.267	L+T IN E CB 6FT N BCR @ NE COR MOUNTAIN AVE + HURST VIEW ST	BG 195
COVINA (1965)	421.255	L+T IN SW COR CONC ENT TO STORE NO 1974 55FT E C/L MOUNTAIN AVE	BG 196
COVINA (1965)	419.239	L+T IN CONC DRWY TO HSE NO 2003 @ SW COR EUCLID AVE + WESLEY GROVE AVE	BG 197
COVINA (1965)	419.944	L+T IN SE COR DRWY OF HSE NO 2003 @ SW COR FLAGSTONE AVE + EUCLID AVE	BG 198
COVINA (1965)	424.305	L+T IN W CB CALIFORNIA AVE 15FT N C/L PROC EUCLID AVE	BG 199
COVINA (1965)	400.562	L+T IN CTR CB RET NW COR JOELLA ST + CALIFORNIA AVE	BG 200
COVINA (1965)	396.858	L+T IN CTR CB RET @ NW COR EL SUR ST + CALIFORNIA AVE	BG 201
COVINA (1965)	393.262	L+T IN CTR CB RET @ NW COR MAYDEE ST + CALIFORNIA AVE	BG 202
COVINA (1965)	388.229	L+N IN W EDGE FIRST CONC STEP HSE NO 403 @ NE COR CALIFORNIA AVE + PAMELA ST	BG 203
COVINA (1965)	375.865	L+T IN CTR CB RET @ NW COR BRISBANE ST AND CALIFORNIA AVE	BG 204
COVINA (1965)	447.340	L+N IN CONC BASE OF N GATE POST @ ENT TO TRANSIT MIX CONC 120FT E C/L IRWINDALE AVE	BG 211
COVINA (1965)	433.268	CS TAG N CB 1FT E BCR @ NW COR IRWINDALE AVE CYPRESS ST 76FT W + 30FT N C/L INT	BG 213
COVINA (1965)	432.776	SQ HD SPK S CB 6FT W BCR @ SW COR IRWINDALE AVE + CYPRESS ST 80FT W + 30FT S C/L INT MKD (BM HV 87)	BG 214
COVINA (1965)	428.538	L+T IN CONC WALK FRONT OF HSE NO 751 50FT W C/L IRWINDALE AVE + 40FT S C/L KINGSIDE DR	BG 215
COVINA (1965)	566.258	L+BN @ SE COR CONC TO POWER BOX 11FT S OF S RAIL SFRR + 10FT E C/L IRWINDALE AVE	BG 217
COVINA (1965)	585.756	L+BM TAG IN E CB 1FT @ SE COR FOOTHILL BLVD + IRWINDALE 20FT + 75FT S C/L INT	BG 218
COVINA (1965)	592.672	L+N IN S CB BRIDGE ON FOOTHILL BLVD OVER SAN GABRIEL RIVER @ SE END OF BRIDGE	BG 219
COVINA (1965)	590.948	L+SPK 4FT FROM SW END BRIDGE NO 53-21 ON FOOTHILL BLVD OVER SAN GABRIEL RIVER 1FT FROM CONC RAILING	BG 220



QUAD-YEAR	ELEV	DESCRIPTION (INCLUDE QUAD AND YEAR IN DESCRIPTION)	BM NUMBER
COVINA (1965)	532.509	L+T E CB ELMHURST AVE 1FT S BCR @ SE COR FOOTHILL BLVD 70FT S + 17FT E C/L INT	BG 222
COVINA (1965)	474.703	RDBM TAG CONC DR 70FT N C/L ARROW HWY + 130FT W C/L MORADA ST	BG 225
COVINA (1965)	471.993	RD MON IN WELL 8IN DN @ C/L INT ARROW HWY + MORADA ST	BG 226
COVINA (1965)	474.038	CS MON IN WELL 10IN DN @ C/L INT ARROW HWY + VINCENT AVE MKD (SEC COR 3 4 9 10 R10W T1S)	BG 227
COVINA (1965)	484.849	CS REF MON IN CONC FLUSH @ SE COR LARK ELLEN AVE + ARROW HWY 45FT S + 45FT E C/L INT MKD (RM NC2 AZUSA K-12)	BG 233
COVINA (1965)	518.877	L+BN @ NE COR CONC SLAB OF GAS STA NO 17356 53FT S C/L ARROW HWY + 102FT W C/L AZUSA AVE	BG 238
COVINA (1965)	546.095	RDBM TAG E CB 7FT S BCR @ SE COR ARROW HWY + HOLLENBECK AVE 30FT E + 77FT S C/L INT	BG 240
COVINA (1965)	330.835	L+T 18FT E BCR @ NE COR FRANCISQUITO AVE + BALDWIN PARK BLVD	BG 338
COVINA (1965)	324.836	CS MON IN WELL 9IN DN C/L INT ROSEGLEN ST + LOWER AZUSA RD TO E	BG 376
COVINA (1965)	326.087	L+T CONC DR OF HSE NO 11741 40FT N C/L LOWER AZUSA RD + 750FT W LA MADERA AVE MKD (8M)	BG 381
BASELINE (1965)	336.268	L+T IN W CB OF WILLOW AVE 1FT N BCR @ NW COR FRANCISQUITO AVE 20FT W + 64FT N C/L INT	BG 385
BASELINE (1965)	337.533	RDBM TAG IN N CB FRANCISQUITO AVE 2FT E BCR @ NE COR RAMA DR 30FT N + 57FT E OF C/L INT	BG 387
BASELINE (1965)	338.506	PK IN E CB ORANGE AVE 2FT S BCR @ SE COR FRANCISQUITO AVE 66FT S + 18FT E C/L INT	BG 389
BASELINE (1965)	341.454	RDBM TAG CB 6FT E C/L PROD N END OF SERVICE RD 50FT S C/L FRANCISQUITO AVE + 55FT W C/L SUNSET AVE	BG 392
BASELINE (1965)	341.570	L+BRAD 6FT E BCR 30FT S C/L FRANCISQUITO AVE + 80FT E C/L SUNSET AVE	BG 393
BASELINE (1965)	343.209	L+BRAD 3FT E OF CATCH BASIN 30FT S C/L FRANCISQUITO AVE + 55FT W C/L CALIFORNIA AVE	BG 395
BASELINE (1965)	345.364	RDBM TAG IN CB 75FT S C/L FRANCISQUITO AVE 30FT E C/L HACIENDA BLVD	BG 398
BASELINE (1965)	354.082	CS MON @ C/L INT FRANCISQUITO AVE + HACIENDA BLVD	BG 400
BASELINE (1965)	356.215	L+T 2IN E BCR @ SE COR GRIFFITHS AVE + FRANCISQUITO AVE	BG 401
BASELINE (1965)	363.125	L+N @ BCR @ SW COR MULLENDER AVE + FRANCISQUITO AVE	BG 402
BASELINE (1965)	363.165	L+N @ S BCR @ SE COR MULLENDER AVE + FRANCISQUITO AVE	BG 403

QUAD-YEAR	ELEV	DESCRIPTION (INCLUDE QUAD AND YEAR IN DESCRIPTION)	BM NUMBER
BASELINE (1965)	371.914	SQ HD SPK IN N CB OF CATCH BASIN @ NE COR FRANCISQUITO AVE + WALNUT AVE 18FT N + 40FT E C/L INT MKD (AZ 202)	BG 404
BASELINE (1965)	382.250	L+T 1FT S BCR @ SW COR INDIAN SUMMER AVE + FRANCISQUITO AVE	BG 406
BASELINE (1965)	382.583	L+T 2FT S BCR @ SE COR INDIAN SUMMER AVE + FRANCISQUITO AVE	BG 407
BASELINE (1965)	390.237	CS TRI MON C/L INT FRANCISQUITO AVE + VALINDA AVE N MKD (PUENTE J6)	BG 408
BASELINE (1965)	392.479	SQ HD SPK E CB 6FT S BCR @ SE COR FRANCISQUITO AVE + VALINDA AVE 53FT S + 30FT E C/L INT MKD (A2207)	BG 409
BASELINE (1965)	407.060	L+BN S CB 10FT E BCR 20FT S + 55FT E C/L INT PASS+ COVINA RD + FRANCISQUITO AVE	BG 411
COVINA (1965)	429.452	CS MON @ C/L INT FRANCISQUITO AVE + LARK ELLEN AVE (S EDGE)	BG 415
COVINA (1965)	431.821	RE TAG NO 1797 S CB 3FT W BCR @ SE COR FRANCISQUITO AVE + LARK ELLEN AVE 21FT S + 62 FT E OF C/L INT	BG 416
COVINA (1965)	463.547	L+T N CB 1FT W BCR @ NW COR FRANCISQUITO AVE + GLENVIEW RD 20FT N + 46FT W C/L INT	BG 418
COVINA (1965)	494.950	L+SPK 4FT FROM N OF CB 20FT W C/L AZUSA AVE 30FT S C/L FRANCISQUITO AVE	BG 419
COVINA (1965)	493.968	L+T IN S CB OF DR HSE NO 1811 21FT W C/L AZUSA AVE 30FT N C/L FRANCISQUITO AVE	BG 420
COVINA (1965)	466.144	RAMSET S CB 6FT W BCR @ SW COR AZUSA AVE + MERCED AVE 80FT W + 30FT S C/L INT	BG 422
COVINA (1965)	467.505	NAIL IN CONC POST IN WELL 8IN DN @ C/L INT AZUSA AVE + MERCED AVE	BG 423
COVINA (1965)	526.804	L+T IN CTR OF CTR N SIDE OF DR SW COR CITRUS AVE + CAMDEN AVE	BG 432
BASELINE (1965)	288.364	L+BN CTR HDWL 34 FT W C/L PECK RD + 32FT N OF N RAIL SPRR	BG 467
BASELINE (1965)	288.513	L+BN CTR HDWL 34 FT W C/L PECK RD + 37FT N OF N RAIL SPRR	BG 468
BASELINE (1965)	283.439	RD HD NAIL IN LIN STEEL WASHER @ E BCR + W END OF CATCH BASIN @ NE COR PECK RD + VALLEY BLVD	BG 469
BASELINE (1965)	276.824	L+T IN W CB 3FT S CATCH BASIN @ NW COR PECK RD + MEEKER AVE	BG 472
BASELINE (1965)	273.384	L+T 8FT E OF CONC DR TO GAS STA @ NW COR GARVEY AVE + PECK RD	BG 474
BASELINE (1965)	273.320	L+BN 1FT W BCR @ SW COR GARVEY AVE + PECK RD	BG 475
COVINA (1965)	407.281	L+BN S CB 3FT E BCR 70FT W C/L SUNSET AVE 30FT S C/L PUENTE AVE	BG 492
COVINA (1965)	406.687	BT SPK E CB 20FT S BCR 77FT S C/L PUENTE AVE + 40FT E C/L SUNSET AVE	BG 493

QUAD-YEAR	ELEV	DESCRIPTION (INCLUDE QUAD AND YEAR IN DESCRIPTION)	BM NUMBER
COVINA (1965)	391.989	BT SPK E CB 11FT S BCR @ SE COR SUNSET AVE + WORKMAN AVE 40FT E + 44FT S C/L INT MKD (BM)	BG 497
COVINA (1965)	362.042	L+PK S CB 60FT E BCR @ SE COR SUNSET AVE + MERCED AVE 30FT S + 135FT E C/L INT	BG 507
COVINA (1965)	348.071	L+N W CB 3FT N BCR @ NW COR SUNSET AVE + FARLINGTON ST 60FT N + 40FT W C/L INT	BG 510
COVINA (1965)	347.893	L+T S CB 1FT W BCR @ SW COR SUNSET AVE + FARLINGTON ST 20FT S + 75FT W C/L INT	BG 511
COVINA (1965)	425.997	L+T S CB TRAFFIC ISLAND 15FT E OF W END 200FT NW C/L INT ARROW HWY + LIVE OAK AVE + 600FT NW OF MAINE AVE + ARROW HWY	BG 513
COVINA (1965)	421.929	L+BN ANG PT OF 6FT CHAIN LINK FEN @ END OF R R TRACK IN CONC PIPE YD 36FT S C/L ARROW HWY + 1500FT W MAINE AVE MKD (BM)	BG 514
COVINA (1965)	424.280	L+BN S EDGE OF CONC PVMT OF SERVICE RD UP SANTA FE DAM 30FT N C/L ARROW HWY	BG 515
COVINA (1965)	433.303	L+T CONC ABUT @ NE COR ARROW HWY BRIDGE OVER SANTA FE DAM SPILLWAY	BG 517
COVINA (1965)	433.295	L+T CONC ABUT @ NW COR ARROW HWY BRIDGE OVER SANTA FE DAM SPILLWAY	BG 518
COVINA (1965)	411.952	R D MON @ P O S T 300FT E EC ARROW HWY 15FT N C/L + 150FT E EDISON POWER LINE CROSSING	BG 521
COVINA (1965)	404.608	L+BN CTR CONC HDWL 33FT N C/L ARROW HWY + 700FT W OF CURVE TO SE NR SANTA FE DAM	BG 522
COVINA (1965)	391.200	L+T CONC HDWL 1FT W OF E END OF WALL 30FT N C/L ARROW HWY + 650FT E C/L BUENO RIO DR	BG 523
COVINA (1965)	390.251	R D MON 69FT SE PP NO 804653E 40FT SW OF CONC HDWL + 625FT E C/L INT BUENO RIO DR + ARROW HWY	BG 524
COVINA (1965)	388.118	R D MON @ C/L INT ARROW HWY + BUENO RIO DR	BG 525
COVINA (1965)	388.428	C S MON FLUSH 50FT S C/L ARROW HWY + 10FT E C/L BUENO RIO DR	BG 526
COVINA (1965)	374.737	R D MON @ C/L INT ARROW HWY + LIVE OAK AVE	BG 528
COVINA (1965)	359.597	L+T IN CONC PVMT 1FT SW C/L INT LONGDEN AVE + LIVE OAK AVE	BG 530
COVINA (1965)	349.417	L+BN S CB 1FT E BCR @ SE COR RAMONA BLVD + MERCED AVE	BG 927
COVINA (1965)	348.967	L+T IN S EDGE OF CONC CURB TO HSE NO 1802 50FT N + 38FT E C/L INT MERCED AVE + ILLINOIS ST	BG 928
COVINA (1965)	346.827	CS MON @ C/L INT MERCED AVE + FRAZIER ST	BG 930
COVINA (1965)	348.825	L+T IN CONC WK 28FT N + 29FT SE C/L INT MERCED AVE + BALDWIN BLVD	BG 932



QUAD-YEAR	ELEV	DESCRIPTION (INCLUDE QUAD AND YEAR IN DESCRIPTION)	BM NUMBER
BASELINE (1965)	426.871	CS MON IN WELL @ C/L INT AMAR RD + PASS + COVINA RD	BG 1372
BASELINE (1965)	400.798	FC MON IN N END HDWL 14FT E + 470FT N C/L INT PASS + COVINA RD + T M P L U VE MKD (BM 100-26 1948)	BG 1376
BASELINE (1965)	449.679	L+BN CTR CB RET OF SERV RD GEMINI ST 45FT E C/L PASS + COVINA RD	BG 1378
BASELINE (1965)	435.126	L+BN CTR CB RET OF SERV RENAULT ST 45FT E C/L PASS + COVINA RD	BG 1379
COVINA (1965)	539.391	L+BN S CB ARROW HWY SERV RD 170FT E DR TO HSE NO 610 + 585FT W CERRITOS AVE	BG 1421
COVINA (1965)	561.988	L+T N CB SERV RD 33FT W BCR @ SW COR FENIMORE AVE + ARROW HWY	BG 1423
COVINA (1965)	561.799	L+BN S CB SERV RD 2FT W BCR @ SW COR FENIMORE AVE + ARROW HWY	BG 1424
COVINA (1965)	569.327	L+BN S CB ARROW HWY 95FT E OF DR TO HSE NO 18252 670FT W CITRUS AVE	BG 1425
BASELINE (1965)	578.138	C S MON @ C/L CITRUS AVE 20FT S C/L ARROW HWY MKD (SEC COR 2 1 11 12 TIS R10W)	BG 1426
BASELINE (1965)	580.676	L+T SIDE CONC BASE OF LIGHT STANDARD 50FT N C/L ARROW HWY + 54FT E C/L CITRUS AVE	BG 1427
BASELINE (1965)	345.485	CS MON C/L INT FRANCISQUITO AVE TO W + HACIENDA BLVD	BG 1467
BASELINE (1965)	370.340	CS MON 6FT E + 1FT N C/L INT FRANCISQUITO AVE + WALNUT AVE	BG 1468
BASELINE (1965)	785.441	BRONZE DISK IN CTR OF CONC ABUT OF SPRR CULV 8FT N OF TRACKS 250FT W INT VERNON AVE + BELLEVUE AVE	BG 1469
BASELINE (1965)	794.707	L+T CTR OF S CURVE OF PKWY OF CORONA FRWY @ INT OF BELLEVUE AVE	BG 1470
COVINA (1965)	438.464	CS MON IN WELL 12FT E C/L IRWINDALE AVE + 0.5 MI S ARROW HWY ON N P/L PROD HSE NO 4748 MKD (BM 16-2 1952 RE 63)	BG 1567
COVINA (1965)	467.305	CS MON IN WELL 6IN DN @ C/L INT ARROW HWY + IRWINDALE AVE	BG 1568
COVINA (1965)	476.137	L+BN IN CONC BASE OF 3IN FENCE POST 48FT E C/L IRWINDALE AVE 66FT SE OF PP NO 464297E + 600FT N ARROW HWY	BG 1569
COVINA (1965)	490.001	L+BN IN CONC FOUNDATION OF COR FENCE POST @ S ENT TO CONCRETE CONDUIT CO 27FT W C/L IRWINDALE AVE + 700FT S GLADSTONE ST	BG 1570
COVINA (1965)	496.925	CS MON @ NE COR IRWINDALE AVE + GLADSTONE ST 23FT FROM S END + 10FT W OF E CB	BG 1571
COVINA (1965)	513.555	BR MON S CB 4FT W BCR @ SW COR IRWINDALE AVE + PARAMOUNT ST 34FT S + 55FT W C/L INT MKD (AZUSA 58-3)	BG 1573
COVINA (1965)	526.970	CS MON IN WELL 29FT E C/L IRWINDALE AVE + 22FT S OF S CB 1ST ST MKD (BM 11-22 1952 RE 63)	BG 1575

QUAD-YEAR	ELEV.	DESCRIPTION (INCLUDE QUAD AND YEAR IN DESCRIPTION)	BM	NUMBER
COVINA (1965)	547.020	L+BN IN CONC BASE TO COR POST OF CHAIN LINK FENCE 33FT E C/L IRWINDALE AVE 27FT N + 11FT E OF TP NO 14176Y + 1300FT N 1ST ST	BG	1577
COVINA (1965)	566.316	BOLT WITH X @ W EDGE OF CONC JUNCT BCX 10FT S OF S RAIL OF MAINLINE SFRR + 70FT E C/L IRWINDALE AVE	BG	1578
COVINA (1965)	585.230	L+BM TAG IN W CB 21FT BCR @ SW COR IRWINDALE AVE + FOOTHILL BLVD 60FT W + 60FT S C/L INT	BG	1581
COVINA (1965)	576.161	STATE HWY MON IN WELL 1 1/2 IN DN @ C/L INT HUNTINGTON DR + CROWNHAVEN DR (FISH CANYON RD)	BG	1582
COVINA (1965)	575.766	RDBM TAG IN W CB 1FT S BCR @ SW COR HUNTINGTON DR + CROWNHAVEN DR 90FT S + 18FT W C/L INT	BG	1583
COVINA (1965)	405.458	L+T IN S CB SAN BERNARDINO RD 30FT S C/L @ C/L PROD AZUSA CANYON RD	BG	1585
COVINA (1965)	405.635	L+BN IN W CB 5FT S BCR @ NW COR SAN BERNARDINO RD + AZUSA CANYON RD 60FT N + 21FT W C/L INT	BG	1586
COVINA (1965)	380.826	CS MON IN WELL 10 1/2 IN DN @ C/L INT CLEARY DR + PUENTE AVE	BG	1588
COVINA (1965)	414.339	SQ HD SPK N CB 6FT E BCR 75FT N C/L BADILLO ST + 115FT E C/L IRWINDALE AVE MKD (HV 64)	BG	1668
COVINA (1965)	422.454	BT SPK E CB 6FT N BCR 108FT N C/L BADILLO ST + 15FT E C/L ELLEN DR MKD (HV 76)	BG	1669
COVINA (1965)	446.640	RDBM TAG E CB 57FT N BCR 20FT E C/L CARVCL AVE + 95FT N C/L ELGENIA AVE	BG	1673
COVINA (1965)	458.421	RDBM TAG W CB 2FT S BCR 75FT S C/L BADILLO ST + 30FT W C/L LARK ELLEN AVE	BG	1674
COVINA (1965)	461.747	L+T CONC WK TO CHURCH @ NE COR BADILLO ST + LARK ELLEN AVE 75FT N + 133FT E C/L INT MKD (BM)	BG	1675
COVINA (1965)	450.299	CS MON IN WELL @ C/L INT LARK ELLEN AVE + PUENTE AVE MKD (CS RE 03)	BG	1677
COVINA (1965)	449.797	PK IN E CB 17FT S BCR @ C/L INTS C/L PUENTE AVE + 25FT E C/L LARK ELLEN AVE	BG	1678
COVINA (1965)	468.876	RDBM TAG W CB 24FT S BCR 60FT S C/L BADILLO ST + 18FT W C/L LEAF AVE	BG	1679
COVINA (1965)	472.076	RDBM TAG N CB 50FT N C/L BADILLO ST + 200FT E C/L LEAF AVE	BG	1680
COVINA (1965)	487.884	L+BRAD W CB 16FT S BCR 48FT W C/L AZUSA AVE + 60FT N C/L BADILLO ST MKD (BM C59)	BG	1681
COVINA (1965)	488.245	ST HWY MON IN WELL 8IN DN C/L INT BADILLO ST + AZUSA AVE MKD (L-2)	BG	1682
COVINA (1965)	504.726	RDBM TAG E CB 3FT S BCR 18FT E C/L ARMEL DR + 115FT S C/L BADILLO ST	BG	1683
COVINA (1965)	505.468	RDBM TAG E CB 31FT BCR 18FT E C/L ARMEL DR + 110FT N C/L BADILLO ST	BG	1684
COVINA (1965)	517.105	L+T E CB 15FT @ C/L INTS C/L HOLLENBECK AVE + 60FT S C/L BADILLO ST	BG	1686

QUAD-YEAR	ELEV	DESCRIPTION (INCLUDE QUAD AND YEAR IN DESCRIPTION)	BM NUMBER
COVINA (1965)	528.240	RDBM TAG W CB 18FT S BCR 15FT W C/L FOURTH AVE + 65FT S C/L BADILLO ST	BG 1687
COVINA (1965)	528.893	RDBM TAG W CB 14FT N BCR 25FT W C/L FOURTH AVE + 65FT N C/L BADILLO ST	BG 1688
BASELINE (1965)	546.047	USC+GS BR DISC 4FT ABOVE WALK IN N FACE OF BLDG @ SE COR BADILLO ST CITRUS AVE 2FT FROM NW COR MKD (USC+GS BM NO 35)	BG 1689
BASELINE (1965)	379.341	RD MON IN WELL 7IN DN @ C/L INT VALLEY BLVD + PASS + COVINA RD	BG 1745
BASELINE (1965)	390.096	RD MON IN WELL 8IN DN ON C/L INT VALLEY BLVD + HAMBLEDON AVE	BG 1746
BASELINE (1965)	389.843	L+T N CB VALLEY BLVD 3FT E BCR @ NE COR HAMBLEDON AVE 36FT N + 47FT E C/L INT	BG 1747
BASELINE (1965)	398.416	L+T N CB 6FT BCR 15FT N C/L VALLEY BLVD + 46FT E C/L GIARDINO AVE	BG 1749
BASELINE (1965)	412.372	L+BN IN RR SIGNAL BASE 75FT S C/L VALLEY BLVD + 35FT W C/L YORBITA RD	BG 1750
BASELINE (1965)	410.050	RDBM TAG CTR CONC HDWL 43FT N C/L VALLEY BLVD + 25FT E C/L YORBITA RD	BG 1751
BASELINE (1965)	419.894	RDBM TAG W CB 11FT N BCR 81FT N C/L VALLEY BLVD + 20FT W C/L LA SEDA RD	BG 1752
BASELINE (1965)	419.960	L+T E CB 12FT N BCR 82FT N C/L VALLEY BLVD + 20FT E C/L LA SEDA RD	BG 1753
BASELINE (1965)	429.646	L+BN E END CONC HDWL 70FT S C/L VALLEY BLVD + 0.2MI E LA SEDA RD MKD (BM 12)	BG 1754
BASELINE (1965)	432.923	RDBM TAG N CB 1FT W CATCH BASIN 40FT N VALLEY BLVD + 0.2 MI E LA SEDA RD	BG 1755
COVINA (1965)	458.697	L+T IN CONC WK TO HSE NO 537 NOGALES ST 60FT E C/L + 0.2 MI N VALLEY BLVD MKD (BM)	BG 1756
COVINA (1965)	453.904	L+T CONC SLAB TO FRONT DCOR TO HSE NO 537 NOGALES ST 94FT W C/L + 0.25 MI N VALLEY BLVD MKD (BM)	BG 1757
COVINA (1965)	458.322	RDBM TAG CONC WINGWALL OF CULV 70FT S C/L LA PUENTE RD + 130FT E C/L ROAD NOGALES ST	BG 1759
COVINA (1965)	471.484	RDBM TAG IN CONC WINGWALL OF CATCH BASIN 52FT S C/L LA PUENTE RD + 0.2 MI E NOGALES ST	BG 1760
COVINA (1965)	478.885	RDBM TAG IN CONC WINGWALL OF CATCH BASIN 30FT N C/L LA PUENTE RD + 0.2 MI E NOGALES ST	BG 1761
COVINA (1965)	496.366	RDBM TAG IN NW COR CONC RESERVOIR 43FT S C/L LA PUENTE RD + 0.4 MI E NOGALES ST	BG 1762
COVINA (1965)	497.058	RDBM TAG IN CONC WINGWALL OF CATCH BASIN 25FT N C/L LA PUENTE RD + 0.4 MI E NOGALES ST	BG 1763
COVINA (1965)	514.577	RDBM TAG IN CONC WINGWALL OF CATCH BASIN 28FT N C/L LA PUENTE RD + 0.6 MI E NOGALES ST	BG 1764
COVINA (1965)	572.553	RDBM TAG IN CONC HDWL OF CULV 24FT N C/L LA PUENTE RD + 1.1 MI E NOGALES ST	BG 1766
COVINA (1965)	579.365	L+BN IN CONC FOOTING OF 2IN CONC POST 30FT N LA PUENTE RD + 1.2MI E NOGALES ST	BG 1767

QUAD-YEAR	ELEV	DESCRIPTION (INCLUDE QUAD AND YEAR IN DESCRIPTION)	BM NUMBER
COVINA (1965)	568.145	CS MON IN WELL 9IN DN @ C/L INT LEMON AVE + LA PUENTE RD	BG 1768
COVINA (1965)	565.061	3/4IN STEEL STUD ON WINDWALL OF BRIDGE NO B166 18FT S C/L LA PUENTE RD + 176FT E C/L LEMON AVE MKD (BM)	BG 1769
COVINA (1965)	568.851	RDBM TAG IN W HDWL OF DR TO HSE NO 20205 LA PUENTE RD 16FT N C/L + 0.25 MI E LEMON AVE	BG 1770
COVINA (1965)	568.883	RDBM TAG IN E HDWL OF DR TO HSE NO 20205 LA PUENTE RD 16FT N C/L + 0.25 MI E LEMON AVE	BG 1771
COVINA (1965)	581.788	L+BN IN W HDWL OF DR TO HSE NO 20505 LA PUENTE RD 24FT N C/L + 0.6 MI E LEMON AVE	BG 1772
COVINA (1965)	582.336	L+BN IN E HDWL OF DR TO HSE NO 20505 LA PUENTE RD 24FT N C/L + 0.6 MI E LEMON AVE	BG 1773
COVINA (1965)	577.802	L+T IN CONC HDWL @ NW COR LA PUENTE RD + PIERRE RD 25FT N + 30FT W C/L INT MKD (BM)	BG 1774
COVINA (1965)	577.807	L+T IN CONC HDWL @ NE COR LA PUENTE RD + PIERRE RD 25FT N + 16FT E C/L INT MKD (BM)	BG 1775
COVINA (1965)	584.267	RDBM TAG IN CONC HDWL 24FT N C/L LA PUENTE RD + 198FT E C/L SUZANNE RD	BG 1776
COVINA (1965)	603.577	L+T CONC WK TO HSE NO 524 @ NE COR GARTEL DR + BENIK PL 31FT N + 30FT E C/L INT MKD (BM)	BG 1777
COVINA (1965)	604.259	L+T IN CONC DR TO HSE NO 524 @ NE COR GARTEL DR + BENIK PL 20FT N + 76FT E C/L INT MKD (BM)	BG 1778
COVINA (1965)	621.246	RDBM TAG IN E END OF CONC HDWL 24FT N C/L LA PUENTE RD + 0.15 MI E GARTEL DR	BG 1780
COVINA (1965)	616.874	RDBM TAG NR CTR OF CONC HDWL 24FT N C/L LA PUENTE RD + 0.2 MI W SAN JOSE HILLS RD	BG 1781
COVINA (1965)	546.703	RDBM TAG IN N CONC ABUT OF BRIDGE NO 169 16FT W C/L LEMON AVE + 110FT S C/L VEJAR RD	BG 1783
COVINA (1965)	533.961	L+BN CONC STAND OFF 46FT W C/L LEMON AVE + 10FT N C/L PROD CANREY RD	BG 1784
COVINA (1965)	534.660	L+BN CONC STAND OFF 21 FT LEMON AVE 92FT W C/L + 25 FT S C/L PROD CANREY RD (BM)	BG 1785
BASELINE (1965)	604.209	CS MON IN WELL 30IN DN NR CTR TRAFFIC ISL @ INT VALLEY BLVD LA PUENTE RD + GRAND AVE MKD (BM 11-95)	BG 1873
COVINA (1965)	609.539	RD MON IN WELL 6IN DN @ PI GRAND AVE 195FT N C/L VALLEY BLVD	BG 1874
COVINA (1965)	633.886	RDBM TAG CTR CONC HDWL 30FT W C/L GRAND AVE + 0.45MI N VALLEY BLVD	BG 1875
COVINA (1965)	638.428	RD MON IN WELL 8IN DN @ PI GRAND AVE 22FT W C/L + 0.6MI N VALLEY BLVD	BG 1876
COVINA (1965)	711.268	RD MON IN WELL 6IN DN @ PI GRAND AVE 18FT E C/L + 1.1MI N VALLEY BLVD	BG 1878
COVINA (1965)	722.691	RD MON IN WELL 4IN DN ON C/L PROD TEMPLE AVE 57FT W C/L GRAND AVE	BG 1879



