

**COUNTY OF LOS ANGELES
ROAD DEPARTMENT**

**PRECISE
BENCH MARK LIST**



**LA MIRADA QUAD
1970 ADJUSTMENT**

PREFACE

The Road Department level net is composed of more than 1,000 miles of levels supporting in excess of 10,000 bench marks. In 1964-65, a major readjustment of the net was undertaken. To emphasize the complete break with previous elevations, the SY, SG & SL series bench marks have been re-labeled BY, BG & BL, respectively.

To facilitate the adjustment, indexing, and distribution of adjusted values of the net, the County territory was divided into 31 quads or areas. For identification purposes each quad was given a name, viz., "Rosemead," "La Mirada," "Santa Fe," etc. When bench marks and elevations in the Road Department net are used, the name of the quad in which the bench mark is located and the date of the adjustment of the elevation must be included in the bench mark description, e.g.,

BG 1887 --L+BN IN CONC HDWL OF DRAIN PIPE UNDER DR 218 FT
NE +18 FT SE C/L INT GRAND AVE +CAMERON AVE MKD (BM)
(COVINA --1965) ELEV. 696.238

It is expected that this general adjustment will, for the most part, remain sound for the next 8 to 12 years. As new circuits are completed, however, re-adjustment of individual quads may become advisable. It is expected that these subsequent adjustments will be in the nature of a few hundredths of a foot. When a quad is re-adjusted, new elevation lists will be published and the date of the re-adjustment will replace the "1965" at the end of the bench mark description. Two bench marks in the same quad with different adjustment dates will not normally join each other. Since all adjustments taper out to nothing at the periphery of the quad, any bench mark in one quad will join any bench mark in another quad regardless of their respective adjustment dates.

The basic accuracy of the net is reflected by an indicated field probable error of plus or minus 0.012 foot per mile of leveling as determined from 298 conditions of closure. However, many years experience in vertical control in the greater Los Angeles basin and Antelope Valley indicate that because of varying degrees of subsidence and heaving, the true datum is recovered only by obtaining substantial agreement of a number of bench marks.

The users of this net are invited to assist in its maintenance by notifying this Department of cases of obliteration, apparent mistakes in descriptions or elevations, and proven disturbance of bench marks.

DATUM: U. S. Coast and Geodetic Survey Sea Level Datum
of 1929, through the medium of the Los Angeles
County Engineer Precise Level Net, 1963 Adjust-
ment.

ABBREVIATIONS USED IN BENCH MARK LISTINGS

ABUT - - - - -	Abutment	EC - - - - -	End of Curve
ALG - - - - -	Along	ENT - - - - -	Entrance
ANG PT - - - - -	Angle Point	FL - - - - -	Floor
B/W - - - - -	Back of Walk	FTG - - - - -	Footing
BCR - - - - -	Beginning of Curb Return	F/W - - - - -	Front of Walk
BC - - - - -	Beginning of Curve	GAR - - - - -	Garage
BLDG - - - - -	Building	HDWL - - - - -	Headwall
BM - - - - -	Bench Mark	HSE - - - - -	House
BT SPK - - - - -	Boat or Bolt Spike	INT - - - - -	Intersection
BR CAP - - - - -	Brass or Bronze Cap	IP - - - - -	Iron Pipe
C B - - - - -	Catch Basin	LT - - - - -	Left
CTR - - - - -	Center	LACE - - - - -	L. A. City Engineer
C/L - - - - -	Center Line	LACS - - - - -	L. A. County Engineer
C/L INT - - - - -	Center Line Intersection	LAFC - - - - -	L. A. Co. Flood Control
C/L PROD - - - - -	Center Line Produced	L+BN - - - - -	Lead and Bench Nail
CONC - - - - -	Concrete	L+BR - - - - -	Lead and Brad
COR - - - - -	Corner	L+N - - - - -	Lead and Nail
COE - - - - -	Corps of Engineers	L+RDEM TAG - - - - -	Lead and Road Dept. Bench Mark Tag
CULV - - - - -	Culvert	L+SPK - - - - -	Lead and Spike
CB - - - - -	Curb	L+T - - - - -	Lead and Tack
CS MON - - - - -	County Engineer Monument	MCR - - - - -	Middle of Curb Return
CS BR CAP - - - - -	County Engineer Brass Cap	MKD - - - - -	Marked
CT SPK - - - - -	Cut Spike	MC - - - - -	Middle of Curve
DR - - - - -	Drive or Driveway	MON - - - - -	Monument
E/O - - - - -	East of	N/O - - - - -	North of
ECR - - - - -	End of Curb Return	NR - - - - -	Near

ABBREVIATIONS USED IN BENCH MARK LISTINGS . . . CONTINUED

OPP - - - - - Opposite
PI - - - - - Point of Intersection
PK+W - - - - - PK Nail and Washer
P/L - - - - - Property Line
POST - - - - - Point on Semi-Tangent
PP - - - - - Power Pole
PVMT - - - - - Pavement
PROD - - - - - Produced
RD - - - - - Road
RDEM - - - - - Road Dept. Bench Mark
RR - - - - - Railroad
RT - - - - - Right
R/W - - - - - Right of Way
SDMH - - - - - Storm Drain Manhole
SMH - - - - - Sewer Manhole
SPK - - - - - Spike
ST+W - - - - - Spike Tin and Washer
S/O - - - - - South of
TP - - - - - Telephone Pole
USC+GS - - - - - U. S. Coast and Geodetic Survey
USGS - - - - - U. S. Geological Survey
WK - - - - - Walk
W/O - - - - - West of

QUAD

SANTA FE

NORWALK QUAD

NORWALK QUAD

ARTESIA QUAD

LA MIRADA QUAD

COUNTY

COUNTY

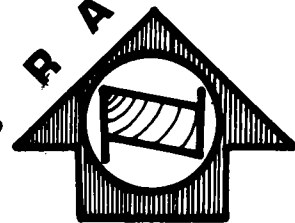
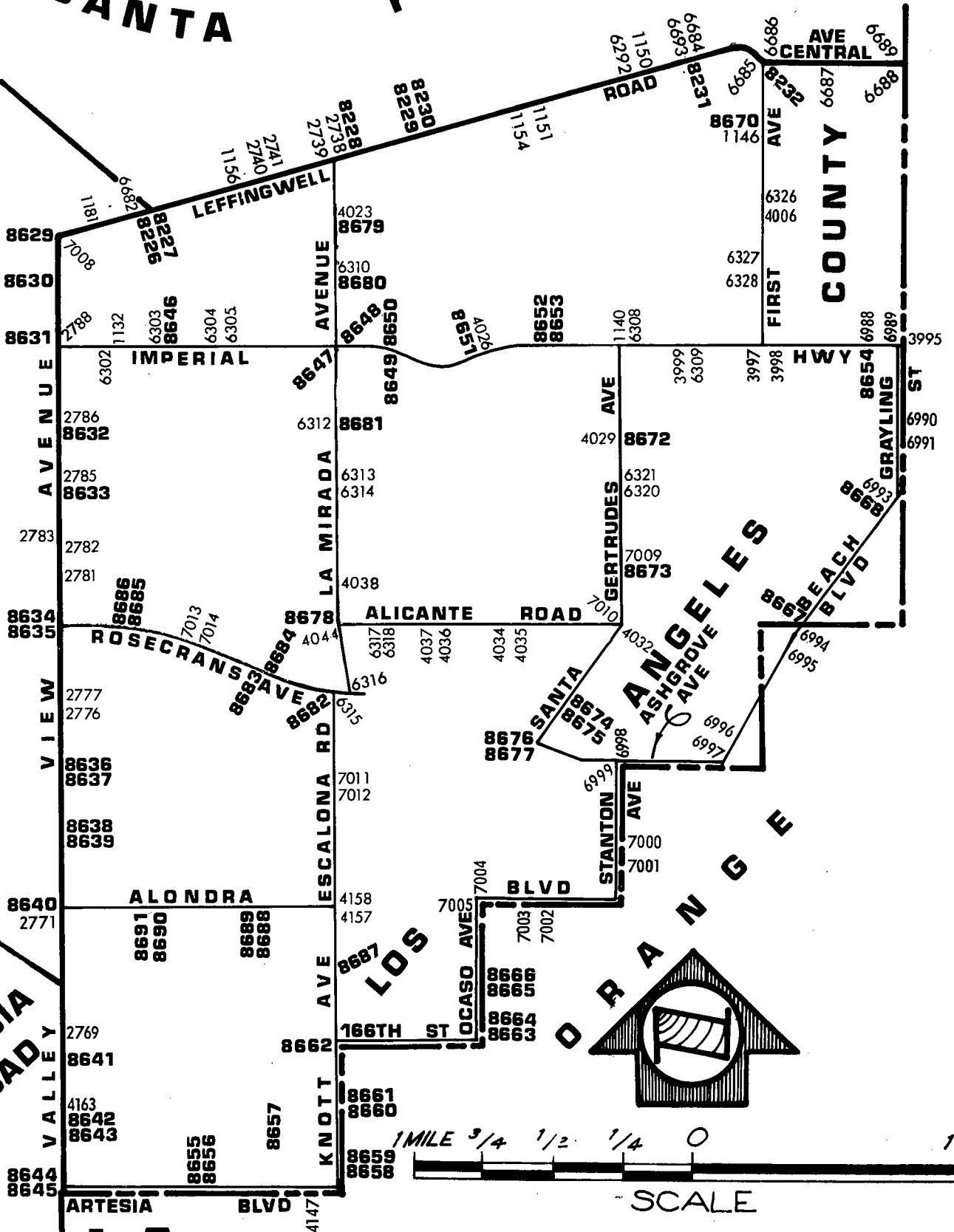

SCALE

APR 1971

LOS ANGELES COUNTY ROAD DEPARTMENT
SURVEY SECTION FIELD ENGINEERING DIVISION

PAGE 1

QUAD-YEAR	ELEV	DESCRIPTION (INCLUDE QUAD AND YEAR IN DESCRIPTION)	BM NUMBER
LAMIRADA (1970)	134.124	RDBM TAG N CB 3FT E BCR @ NW COR IMPERIAL HWY + CORLEY DR 40FT N + 43FT W C/L INT	BY 1132
LAMIRADA (1970)	256.743	CS MON IN WELL 12IN DN @ OR NR C/L INT IMPERIAL HWY + SANTA GERTRUDES AVE MKD (AUX LA HABRA A 10 A)	BY 1140
LAMIRADA (1970)	256.416	RDBM TAG IN W CB 1FT S/D BCR @ SW COR FIRST AVE + SHARONHILL DR 32FT W + 60FT S C/L INT	BY 1146
BASELINE (1965)	241.352	L+BN IN CB 36FT E BCR @ NE COR LEFFINGWELL RD + SANTA GERTRUDES AVE 40FT N + 145FT E C/L INT 1FT E ENT CATCH BASIN	BY 1150
BASELINE (1965)	234.542	L+BN IN CB 40FT S C/L LEFFINGWELL RD + 36 FT E C/L PROD EL ARCO DR OPP PP NO 1173876E	BY 1151
BASELINE (1965)	228.565	CS MON IN WELL 12IN DN IN OUT 12FT S C/L LEFFINGWELL RD + 619FT E C/L OUT AVE MKD (RM 2 LA HABRA A 9 1950)	BY 1154
BASELINE (1965)	212.510	CS MON IN WELL 13FT N C/L LEFFINGWELL RD 100FT W HSE NO 14701 + OPP PP NO 662000E MKD (WHITTIER J 9 AUX 1 1960)	BY 1156A
BASELINE (1965)	161.724	L+T E EDGE CONC DRWY HSE NO 14312 37FT± S C/L LEFFINGWELL RD OUT	BY 1181
BASELINE (1965)	216.660	L + T DEP CB DRWY GAS STA NW LA MIRADA BLVD + LEFFINGWELL RD 40FT N + 70FT W C/L INT	BY 2738
BASELINE (1965)	216.768	L + T IN S CB 7FT E BCR 41FT S + 50FT W C/L INT LEFFINGWELL RD + LA MIRADA BLVD	BY 2739
BASELINE (1965)	191.540	L+BN W END CATCH BASIN N SIDE LEFFINGWELL RD 40FT N C/L + 450FT W C/L LUITWIELER AVE 500FT E C/L ARROYO DR	BY 2740
BASELINE (1965)	186.363	L+BN 1FT W BCR @ SW COR LEFFINGWELL RD + ARROYO DR 40FT S + 50FT W C/L INT	BY 2741
BASELINE (1965)	60.246	USGS MON FL IN NW COR CONC CULV BR TO SPRR 26FT S/D C/L VALLEY VIEW AVE + 75FT S/D C/L FIRESTONE BLVD SO SIDE FRWY MKD T-33 1914	BY 2769
BASELINE (1965)	65.453	L+BN W CB 7FT± N OF BCR @ SW COR ALONDRA BLVD + VALLEY VIEW AVE 68FT± S + 40FT± W C/L INT	BY 2771
BASELINE (1965)	94.746	L+SPK N CB 4FT± E BCR @ NE COR VALLEY VIEW AVE + STAGE RD 30FT± N + 60FT± E C/L INT CB MKD (RBM 1)	BY 2776

QUAD-YEAR	ELEV	DESCRIPTION (INCLUDE QUAD AND YEAR IN DESCRIPTION)	BM NUMBER
BASELINE (1965)	94.776	USC+GS MON FLUSH ON NE COR VALLEY VIEW AVE + STAGE RD 31.5FT±N + 87FT± E C/L INT 1.5FT±N CB MKD (K 778-1945)	BY 2777
BASELINE (1965)	118.184	L + T IN CONC PVMT 2.5FT W/O W MED CB ON C/L VALLEY VIEW AVE 100FT S/O DE ACALA DR IN FRONT OF BLDG NO 13920 OUT	BY 2781
BASELINE (1965)	94.285	L+BN NR CTR OF BRIDGE NO 1273 40FT± E C/L VALLEY VIEW AVE + 130FT N MANSA DR	BY 2782
BASELINE (1965)	93.559	L + T IN CHIS SQ 75FT N + 5FT E/O C/L INT VALLEY BY VIEW AVE + BR NOB1273 200FT ± N/O MANSA DR OUT	2783
BASELINE (1965)	94.733	CS MON IN WELL 10IN DN ON NE COR VALLEY VIEW AVE BY + FOSTER RD 62FT± N + 41FT± E C/L INT 1FT± BACK CB MKD (BM 1=6A 1961)	2785
BASELINE (1965)	106.006	L+BN E CB 1FT± N BCR @ NE COR VALLEY VIEW AVE + ADOREE ST 57FT± N + 38FT± E C/L INT	BY 2786
BASELINE (1965)	115.916	L+BN E CB 1FT± S BCR @ SE COR VALLEY VIEW AVE + IMPERIAL HWY 76FT± S + 38FT± E C/L INT	BY 2788
LAMIRADA (1970)	285.983	CS BM MON IN WELL 8IN DN 40FT N + 385FT W/O C/L INT IMPERIAL HWY + SPRING MEADOW LN 50FT E/O LA + OR CO LINE MKD BM 3-13 A 1961	BY 3995
LAMIRADA (1970)	300.522	RD BM TAG S CB 1FT E BCR @ SE COR IMPERIAL HWY + FIRST AVE 40FT S + 56FT E C/L INT	BY 3997
LAMIRADA (1970)	299.895	CS TRI MON IN WELL 10IN DN @ OR NEAR C/L INT IMPERIAL HWY + FIRST AVE MKD (LA HABRA B-10-A)	BY 3998
LAMIRADA (1970)	268.100	L + T IN S CB 40FT S + 48FT W/O C/L INT IMPERIAL BY HWY + CLEARGLEN AVE IN FRONT P P NO 1254813E	3999
LAMIRADA (1970)	255.779	RD BM TAG E CB 1FT S BCR @ SE COR FIRST AVE + AMBER VALLEY DR 56FT S + 30 E C/L INT	BY 4006
LAMIRADA (1970)	207.561	RDBM TAG IN E CB 2FT N/O BCR @ NE COR LA MIRADA BY BLVD + GRANADA AVE 40FT E/O + 88FT N/O C/L INT	4023
LAMIRADA (1970)	226.883	L + BR S EDGE CONC WK NR NW COR BRICK WALL ON SE BY COR IMPERIAL HWY + OCASO AVE 70FT S + 32 E/O C/L INT TO SO	4026
LAMIRADA (1970)	268.587	L + BN END CONC APRON TO GARAGE OF HSE NO 13117 BY 80FT ± W + 15FT ± S/O C/L INT SANTA GERTRUDES AVE + GLAZEBROOK DR.	4029

QUAD-YEAR	ELEV	DESCRIPTION (INCLUDE QUAD AND YEAR IN DESCRIPTION)	BM NUMBER
LAMIRADA (1970)	223.155	L+BRAD S CB 11FT E BCR @ SE COR ALICANTE RD + SANTA GERTRUDES AVE 30FT S + 95FT E C/L INT	BY 4032
LAMIRADA (1970)	216.497	L+BN 2FT N CB RET @ SW COR ALICANTE RD + MANCITA DR 18FT W + 45FT S C/L INT	BY 4034
LAMIRADA (1970)	212.242	L+BN 2FT N CB RET @ SE COR ALICANTE RD + LA MESA DR 18FT E + 45FT S C/L INT	BY 4035
LAMIRADA (1970)	180.544	L+BN 2FT N CB RET @ SE COR ALICANTE RD + ADELFA DR 46FT S + 18FT E C/L INT	BY 4036
LAMIRADA (1970)	179.327	L+BN 2FT N CB RET @ SW COR ALICANTE RD + ADELFA DR 18FT W + 46FT S C/L INT	BY 4037
LAMIRADA (1970)	146.132	L + BN IN W CB 40FT W/O + 100FT S/O C/L INT LA MIRADA BLVD + WHITEROCK DR IN FRONT PPNO1063580E	BY 4038
LAMIRADA (1970)	141.148	L + BN IN W CB 40FT W/O + 200FT S/O C/L INT LA MIRADA BLVD + ALICANTE RD IN FRONT PP NO1081377E	BY 4044
LAMIRADA (1970)	64.722	L + BN IN SE COR CONC ANCHOR FOR U S NAVY PIPE LINE 50 FT S SPRR + 200FT E/O COYOTE CK	BY 4147
LAMIRADA (1970)	109.905	CS BM MON IN WELL 10IN DN +33FT SW C/L STAGE RD + 150FT SE ALONDRA BLVD MKD(BM 3-1A 1961	BY 4157
LAMIRADA (1970)	109.866	CS MON IN WELL 20IN DN @ C/L INT ALONDRA BLVD + ESCALONA RD MKD 22-23-27-26 USE N EDGE	BY 4158
BASELINE (1965)	57.944	L+BN N END WK TO CROWN FERTILIZER CO 55FT± W C/L VALLEY VIEW AVE	BY 4163
BASELINE (1965)	240.274	RD MON IN WELL 8IN DN 30FT E 7FT S C/L INT LEFFINGWELL RD + SANTA GERTRUDE AVE MKD (LA CO RD DEPT 1960)	BY 6292
LAMIRADA (1970)	135.776	L+T S CB IMPERIAL HWY 40FT S C/L ON DR NEAR C/L PROD CORLEY DR	BY 6302
LAMIRADA (1970)	160.760	CE TAG SW COR CONC BASE OF GAS VENT IN IS- LAND ON NE COR IMPERIAL HWY + BURGESS AVE 50FT N + 40FT E C/L INT	BY 6303
LAMIRADA (1970)	137.300	RD BM TAG 1FT E CB ON S SIDE IMPERIAL HWY 40FT S C/L + 84FT E C/L PROD SPRING VIEW RD	BY 6304
LAMIRADA (1970)	137.215	RD BM TAG SE COR CB ON NE COR IMPERIAL HWY + SPRINGVIEW RD 40FT N + 110FT E C/L INT	BY 6305

QUAD-YEAR	ELEV	DESCRIPTION (INCLUDE QUAD AND YEAR IN DESCRIPTION)	BM NUMBER
LAMIRADA (1970)	257.491	L+BN CTR CB RET @ NE COR IMPERIAL HWY + SANTA GERTRUDES AVE 50FT N + 40FT E C/L INT	BY 6308
LAMIRADA (1970)	280.779	L + T 1FT W/O BCR IN NO CB OF ISL OF SO SER RD @ SW COR IMPERIAL HWY + BREEZEWOOD DR 58FT S + 35FT W/O C/L INT	BY 6309
LAMIRADA (1970)	194.280	L + BN IN E CB 40FT E/O C/L LA MIRADA BLVD + 20FT S/O S ENT TO BAPTIST CHURCH @ 12000 LA MIRADA BLVD	BY 6310
LAMIRADA (1970)	176.559	L+BN E CB OF SERVICE RD @ SW COR LA MIRADA BLVD + TACUBA DR 45FT S + 80FT W C/L INT	BY 6312
LAMIRADA (1970)	155.012	L+BN E CB 1.0FT N BCR @ NE COR LA MIRADA AVE + FOSTER RD 66FT N + 40FT E C/L INT PAINTED BM NO2	BY 6313
LAMIRADA (1970)	155.532	CO ENG TAG + L 5FT E BCR @ SE COR LA MIRADA AVE + FOSTER RD 32FT S + 78FT E C/L INT	BY 6314
LAMIRADA (1970)	130.797	L+BRAD S CB 15FT E BCR @ SE COR ROSECRANS AVE + LA MIRADA AVE 40FT S + 90FT E C/L INT @ E END CB	BY 6315
LAMIRADA (1970)	128.936	RD DEPT BM TAG W CB 12FT S BCR @ SW COR ROSE- CRANS AVE + LA MIRADA AVE 40FT W + 87FT S C/L INT	BY 6316
LAMIRADA (1970)	138.871	RD BM TAG S CB 1.5FT W BCR @ SW COR ALICANTE RD + BLUE FIELD AVE 20FT S + 46FT W C/L INT	BY 6317
LAMIRADA (1970)	140.091	L+PK S CB 1.2FT E BCR @ SE COR ALICANTE RD + BLUEFIELD AVE 20FT S + 46FT E C/L INT	BY 6318
LAMIRADA (1970)	263.179	L+BRAD E CB SERVICE RD 5FT N BCR @ SE COR SANTA GERTRUDES AVE + FOSTER RD 33FT S + 71FT E C/L INT	BY 6320
LAMIRADA (1970)	263.309	L+T E CB SERVICE RD 5FT N BCR @ NE COR SANTA GERTRUDES AVE + FOSTER RD 45FT N + 74FT E C/L INT	BY 6321
LAMIRADA (1970)	250.792	CS BM BRASS DISK IN SW COR CULVERT 33FT E C/L FIRST AVE + 263FT N AMBER VALLEY DR MKD BM3-15A 1961	BY 6326
LAMIRADA (1970)	273.439	RD BM TAG W CB 1FT N BCR @ NW COR FIRST AVE + CANDLELIGHT DR 58FT N + 32FT W C/L INT	BY 6327

QUAD-YEAR	ELEV	DESCRIPTION (INCLUDE QUAD AND YEAR IN DESCRIPTION)	BM NUMBER
LAMIRADA (1970)	276.705	RD BM TAG E CB 1FT S BCR @ SE COR FIRST AVE + CANDLELIGHT DR 56FT S + 32FT E C/L INT	BY 6328
BASELINE (1965)	188.441	RDBM TAG 5FT W BCR @ SE COR 53FT E + 43FT S C/L INT TELEGRAPH RD + COLIMA RD	BY 6682
BASELINE (1965)	253.865	L+BN S CB 2FT E C B 437FT E C/L MILVERN DR + 40FT S C/L LEFFINGWELL RD	BY 6684A
BASELINE (1965)	265.717	L + BN MKD BM 2FT E BCR 28FT S + 48FT W C/L INT LEFFINGWELL RD + FIRST AVE	BY 6685
BASELINE (1965)	267.131	RDBM TAG N CB 113FT E + 38FT N C/L INT LEFFING- WELL RD + FIRST AVE 2FT E FIRST C B	BY 6686
BASELINE (1965)	279.207	L+T S CB LEFFINGWELL RD 40FT S + 55FT E C/L INT TIGRINA AVE + LEFFINGWELL RD	BY 6687
BASELINE (1965)	293.716	BN @ NW COR 2FT E BCR 48FT W + 34FT N C/L INT VALLEY HOME AVE + LEFFINGWELL RD	BY 6688
BASELINE (1965)	295.404	SPK @ NE COR 3FT S BCR 54FT N + OUT C/L INT VALLEY HOME AVE + LEFFINGWELL RD	BY 6689
BASELINE (1965)	253.084	RDBM TAG N CB 2FT E C.B. 40FT N C/L LEFFINGWELL RD 135FT E C/L LAMBERT RD	BY 6693
LAMIRADA (1970)	259.686	L + BN S CB IMPERIAL HWY 1FT W/O C B 40FT S + 564FT E C/L INT IMPERIAL HWY + TIGRINA AVE	BY 6988
LAMIRADA (1970)	286.789	L + T IN N CB 40FT N + 395FT W/O C/L INT IMPERIAL HWY + SPRINGMEADOW LN 10FT E/O P P NO 1214437E + 50FT E/O LA + OR CO LINE	BY 6989
LAMIRADA (1970)	258.256	LS TAG 2600 E CB 2FT S BCR @ NE COR GRAYLING AVE + BRASS LANTERN DR 41FT N + 18FT E C/L INT	BY 6990
LAMIRADA (1970)	259.948	LS TAG 2600 S CB BRASS LANTERN DR 15FT S C/L + @ C/L PROD GRAYLING AVE	BY 6991
LAMIRADA (1970)	197.378	L + BN IN N END CONC HDWALL 50FT E C/L BEACH BLVD + 1330FT @ S LA HABRA CITY SIGN + 300FT SLY CO LINE MKD BM	BY 6993
LAMIRADA (1970)	198.002	ORANGE CO BM TAG IN NELY COR 2 X 1.5FT CONC BASE OF STORM DRAIN VENT 60FT WLY C/L BEACH BLVD + 0.5MI NLY ROSECRANS AVE MKD OR CO SUR BM	BY 6994
LAMIRADA (1970)	194.479	L+BN CTR HDWL NO D89+23 LOC 58FT WLY C/L BEACH BLVD + 0.5MI NLY ROSECRANS BLVD MKD (BM)	BY 6995

QUAD-YEAR	ELEV	DESCRIPTION (INCLUDE QUAD AND YEAR IN DESCRIPTION)	BM NUMBER
LAMIRADA (1970)	149.099	CS MON IN NE END BR B 1220 ONNWL Y COR BEACH BLVD + ROSECRANS AVE 88FT NW + 44FT NE C/L INT	BY 6996
LAMIRADA (1970)	147.869	L+T SW COR BR B 1220 ON SW COR ROSECRANS BLVD + BEACH BLVD 40FT S + 160FT W C/L INT	BY 6997
LAMIRADA (1970)	133.382	L+BN N CB 1FT E BCR @ NE COR ASHGROVE DR + STAN- TON AVE 80FT N + 50FT E C/L INT MKD (BM)	BY 6998
LAMIRADA (1970)	132.711	L+BN W CB 1FT N BCR @ SW COR ASHGROVE DR + STANTON AVE 44FT S + 20FT W C/L INT MKD (BM)	BY 6999
LAMIRADA (1970)	114.018	L + BN INW CB 45FT S + 20FT W/O APPROX P I CALVERTON DR + STANTON AVE @ FIRE HYD MKD BM	BY 7000
LAMIRADA (1970)	108.254	L+BN NLY CB 1FT WLY BCR @ NWLY COR CALVERTON DR + 1 BLOCK NLY OF HAYFORD ST 47FT WLY + 25FT NLY C/L INT MKD (BM)	BY 7001
LAMIRADA (1970)	115.579	CS TAG NELY CB 40FT NLY BCR @ NELY COR ALONDRA BLVD + LUITWEILER AVE 100FT NWLY + 36FT NELY C/L INT	BY 7002
LAMIRADA (1970)	117.607	CS TAG NLY CB 2FT WLY BCR @ NWLY COR ALONDRA BLVD + LUITWEILER AVE 40FT NLY + 122FT WLY C/L INT	BY 7003
LAMIRADA (1970)	114.911	L + T IN NO CB 40FT N + 30FT W/O C/L INT ALONDRA BLVD + OCASO AVE	BY 7004
LAMIRADA (1970)	114.995	L+T S CB 2FT W BCR @ SW COR ALONDRA BLVD + OCASO AVE 40FT S + 55FT W C/L INT	BY 7005
BASELINE (1965)	162.513	L+BRAD ELY CB 12FT S BCR @ NELY COR VALLEY VIEW AVE + LEFFINGWELL RD 88FT N + 42FT E C/L INT	BY 7008
LAMIRADA (1970)	225.414	L + T IN W CB 40FT N/O N EDGE C B 32FT W + 1500 FT S C/L INT SANTA GERTRUDES AVE + FOSTER RD	BY 7009
LAMIRADA (1970)	228.756	L+BR N CB ALICANTE RD 40FT W BCR @ NW COR ALICANTE RD + SANTA GERTRUDES AVE 87FT W + 20FT N C/L INT	BY 7010
LAMIRADA (1970)	117.544	L+BN 5FT N BCR @ NE COR EXCELSIOR DR + ESCALONA RD 48FT N + 18FT E C/L INT	BY 7011
LAMIRADA (1970)	119.605	L+BN 1FT S BCR @ SE COR EXCELSIOR RD + ESCALONA RD 46FT S + 18FT E C/L INT	BY 7012

QUAD-YEAR	ELEV	DESCRIPTION (INCLUDE QUAD AND YEAR IN DESCRIPTION)	BM NUMBER
LAMIRADA (1970)	109.649	L+BM TAG S CB ROSECRANS AVE @ SW COR BIOLA AVE 2FT W BCR 86FT W + 38FT S C/L INT	BY 7013
LAMIRADA (1970)	109.018	L+BM TAG N CB ROSECRANS AVE @ NE COR BIOLA AVE 2FT E BCR 66FT E + 40FT N C/L INT	BY 7014
BASELINE (1965)	188.710	L + T 13FT W BCR @ NW COR TELEGRAPH RD + LEFFINGWELL RD 40FT N + 50FT W C/L INT	BY 8226
BASELINE (1965)	186.453	RD HD SPK 6FT E BCR @ SE COR TELEGRAPH RD + LEFFINGWELL RD 40FT S + 54FT E C/L INT CB CUT WZ 40Z	BY 8227
BASELINE (1965)	215.994	LACS MON IN WELL 12IN DN 60FT S + 47FT W C/L INT LEFFINGWELL RD + LA MIRADA BLVD MKD K9 1960	BY 8228
BASELINE (1965)	224.903	L + BN 13FT N BCR @ NW COR LEFFINGWELL RD + STAMEY RD 80FT N + 18FT W C/L INT	BY 8229
BASELINE (1965)	225.024	L + BRAD 42FT S C/L LEFFINGWELL RD + 40FT E C/L PROD STAMEY RD	BY 8230
BASELINE (1965)	253.992	CS BM MON FL CTR PKWY NR C/L LEFFINGWELL RD + 170FT E C/L LAMBERT RD MKD BM 4 - 18 1965	BY 8231
BASELINE (1965)	266.840	CS BM MON FL @ SE COR LEFFINGWELL RD + FIRST AVE 53FT S + 54FT E/O C/L INT MKD BM 3-16B 1965	BY 8232
BASELINE (1965)	157.602	L + BN IN E CB 1FT S/O BCR @ SE COR VALLEY VIEW AVE + LEFFINGWELL RD 60FT S + 42FT E/O C/L INT	BY 8629
BASELINE (1965)	145.323	RDBM TAG IN E CB 1FT S/O DRWY TO HSE =12110 VALLEY VIEW AVE 0.25 MI ± S/O LEFFINGWELL RD + 40FT E/O C/L VALLEY VIEW AVE	BY 8630
BASELINE (1965)	119.286	L + T IN CH SQ NR CTR CB RET @ NE COR VALLEY VIEW AVE + IMPERIAL HWY 50FT N + 51FT E/O C/L INT	BY 8631
BASELINE (1965)	103.094	RDBM TAG IN W CB 26FT S/O + 38FT W/O C/L INT @ VALLEY VIEW AVE + ADDEE ST	BY 8632
BASELINE (1965)	95.237	L + T IN W CB 2FT S/O BCR @ SW COR OF VALLEY VIEW AVE + FOSTER AVE 40FT W + 57FT S/O C/L INT	BY 8633
BASELINE (1965)	113.409	L + BN IN E CB 1FT N/O BCR @ NE COR VALLEY VIEW AVE + ROSECRANS AVE 77FT N/O + 40FT E/O C/L INT	BY 8634
BASELINE (1965)	111.789	L + T NR CTR CB RET @ SW COR VALLEY VIEW AVE + ROSECRANS AVE 56FT S/O + 50FT W/O C/L INT	BY 8635

QUAD-YEAR	ELEV	DESCRIPTION (INCLUDE QUAD AND YEAR IN DESCRIPTION)	BM NUMBER
BASELINE (1965)	79.964	RDBM TAG IN E CB 3FT N/O BCR @ NE COR VALLEY VIEW AVE + GANNET ST 70FT N + 38FT E/O C/L INT	BY 8636
BASELINE (1965)	79.462	RDBM TAG IN N CB 2FT W/O BCR @ NW COR VALLEY VIEW AVE + GANNET ST 26FT N + 78FT W/O C/L INT	BY 8637
BASELINE (1965)	74.148	LACS MON FL IN CONC ABUT @ NE COR BR NO1262 OVER LA MIRADA CK 46FT E/O C/L VALLEY VIEW AVE MKD BM 1-2A 1968	BY 8638
BASELINE (1965)	73.929	L + BN IN CHIS SQ IN W CB 40FT W/O C/L VALLEY VIEW AVE 1.5 N/O L + T @ C/L CHANNEL OF BR NO 1262 OVER LA MIRADA CREEK	BY 8639
BASELINE (1965)	67.024	L + T IN N CB 2FT E/O BCR @ NE COR OF VALLEY VIEW AVE + ALONDRA BLVD 40FT N + 76FT E/O C/L INT	BY 8640
BASELINE (1965)	57.461	RDBM TAG IN N CB 3FT W/O BCR @ NW COR VALLEY VIEW AVE + ARBOR PL 22FT N/O + 70FT W/O C/L INT	BY 8641
BASELINE (1965)	57.849	RDBM TAG IN SO END C B IN E CB 8FT N + 42FT E/O C/L INT VALLEY VIEW AVE + PARK PL	BY 8642
BASELINE (1965)	56.855	RDBM TAG IN S CB 3FT W BCR @ SW COR 22FT + S 79FT W C/L INT VALLEY VIEW AVE + PARK PL	BY 8643
BASELINE (1965)	54.649	CSBM MON FL IN S END C B 4FT N/O BCR @ NW COR VALLEY VIEW AVE + ARTESIA BLVD 82FT N + 43FT W/O C/L INT MKD BM 8-LA 1968	BY 8644
BASELINE (1965)	54.472	RDBM TAG IN NO CB 2FT E/O BCR @ NE COR VALLEY VIEW AVE + ARTESIA BLVD 42FT N + 79FT E/O C/L INT	BY 8645
LAMIRADA (1970)	159.358	CS REF MON IN WELL 8IN DN IN WALK @ SW COR IMPERIAL HWY + BURGESS AVE 43FT W + 45 FT S C/L INT MKD RM NO 3 1960	BY 8646
LAMIRADA (1970)	191.241	L + T IN S CB 8FT E/O BCR @ SW COR IMPERIAL HWY + LA MIRADA BLVD 41FT S + 68FT W/O C/L INT	BY 8647
LAMIRADA (1970)	191.980	RDBM TAG IN NO CB 1.5 W/O BCR @ NE COR IMPERIAL HWY + LA MIRADA BLVD 40FT N + 73FT E/O C/L INT	BY 8648
LAMIRADA (1970)	173.461	RDBM TAG IN S CB 40FT S + 20FT E/O APPROX. C/L INT IMPERIAL HWY + LAS FLORES AVE	BY 8649
LAMIRADA (1970)	171.532	RDBM TAG IN SO CB 1FT E/O C B 40FT S + 190FT E/O APPROX C/L INT IMPERIAL HWY + LAS FLORES AVE	BY 8650

QUAD-YEAR	ELEV	DESCRIPTION (INCLUDE QUAD AND YEAR IN DESCRIPTION)	BM NUMBER
LAMIRADA (1970)	226.432	RDBM TAG IN S CB 5FT W BCR 40FT S + 79FT W C/L INT IMPERIAL HWY + OCASO AVE	BY 8651
LAMIRADA (1970)	232.886	RDBM TAG IN NO CB 4FT W/O BCR @ NW COR IMPERIAL HWY + OXFORD DR 40FT N + 60FT W/O C/L INT	BY 8652
LAMIRADA (1970)	236.664	RDBM TAG IN S CB 40FT S + 20FT E/O C/L INT IMPERIAL HWY + OXFORD DR	BY 8653
LAMIRADA (1970)	259.697	RDBM TAG IN NO CB 1FT E/O C B 40FT N C/L IMPERIAL HWY + 571FT E/O TIGRINA AVE	BY 8654
LAMIRADA (1970)	63.417	OR CO S BM MON FL IN E ABUT @ SE COR BR NO53-298 OVER COYOTE CK 47FT S/O C/L ARTESIA BLVD MKD BM 1A 91 68	BY 8655
LAMIRADA (1970)	63.309	OR CO SUR TAG IN E ABUT @ NE COR BR NO 53-298 OVER COYOTE CK 47FT N/O ARTESIA BLVD MKD BM	BY 8656
LAMIRADA (1970)	62.980	USC + GS REF MON FL IN CONC HDWL 27FT S C/L FIRESTONE BLVD SO SIDE FRWY 5 FT E/O C/L LEMONT AVE PROD MKD BUENA NO 1 1983	BY 8657
LAMIRADA (1970)	64.725	L + OR CO SUR TAG IN CONC HDWL @ W COR KNOTT AVE + FIRESTONE BLVD NO SIDE FRWY 40FT N + 82FT W C/L INT	BY 8658
LAMIRADA (1970)	64.637	RDBM TAG IN E CB 2FT N BCR @ NE COR KNOTT AVE + FIRESTONE BLVD 28FT NO + 27FT E/O C/L INT MKD BM	BY 8659
LAMIRADA (1970)	69.752	OR CO SUR MON FL IN CONC ABUT @ NE COR BR =1657 OVER COYOTE CK 15FT E/O C/L KNOTT AVE	BY 8660
LAMIRADA (1970)	69.720	RDBM TAG IN CONC ABUT @ NW COR BR NO 1657 OVER COYOTE CK 14FT W/O C/L KNOTT AVE	BY 8661
LAMIRADA (1970)	64.280	L + PK IN CONC FTG 7FT CHAIN LINK FENCE @ NE COR BY STA KFI PROP 43FT W/O C/L KNOTT AVE + 10FT S/O C/L S FE RR SPUR LINE	BY 8662
LAMIRADA (1970)	99.247	RDBM TAG IN NO CB NR CO LINE 30FT NO + 348FT W/O C/L INT STAGE RD + MC COMBER RD	BY 8663
LAMIRADA (1970)	98.824	LACS MON IN WELL 8 IN DN @ BK WK 41FT S + 113FT W/O C/L INT STAGE RD + MC COMBER RD MKD BM 3-4A 1970	BY 8664
LAMIRADA (1970)	103.209	L + BR IN S CB 15FT S + 26FT E/O C/L INT SAN ARDO DR + OCASO AVE	BY 8665

QUAD-YEAR	ELEV	DESCRIPTION (INCLUDE QUAD AND YEAR IN DESCRIPTION)	BM NUMBER
LAMIRADA (1970)	103.985	L + BR IN E CB 5FT N BCR @ NE COR OCASO AVE + SAN ARDO DR 50FT N + 20FT E C/L INT	BY 8666
LAMIRADA (1970)	187.399	USC + GS MON IN WELL 22IN DN 53FT W C/L BEACH BLVD + 0.65 MI N ROSECRANS AVE MKD M779 1946	BY 8667
LAMIRADA (1970)	196.778	OR CO SUR BM MON FL @ NO END CONC DHWL 50FT E C/L BEACH BLVD + 800FT ± SO LA HABRA CITY SIGN MKD BM 20 - 68 - 69	BY 8668
LAMIRADA (1970)	257.533	RDBM TAG IN W CB SER RD 2FT N BCR @ NW COR FIRST AVE + SHARONHILL DR 46FT N/O + 70FT W/O C/L INT	BY 8670
LAMIRADA (1970)	265.665	L + T @ BK WK 45FT ± N + 39FT ± E/O C/L INT SANTA GERTRUDES AVE + GLAZEBROOK DR	BY 8672
LAMIRADA (1970)	225.444	L + T E CB 40FT N/O N END C B 32FT E + ± 1500FT S C/L INT SANTA GERTRUDES AVE + FOSTER RD	BY 8673
LAMIRADA (1970)	180.915	RDBM TAG IN E CB 6FT N/O BCR @ NE COR SANTA GERTRUDES AVE + ROSECRANS AVE 112FT N + 30FT E/O C/L INT	BY 8674
LAMIRADA (1970)	178.313	RDBM TAG IN S CB 10FT W/O BCR @ SE COR SANTA GERTRUDES AVE + ROSECRANS AVE 61FT E + 40FT S/O C/L INT	BY 8675
LAMIRADA (1970)	163.268	RDBM TAG IN W CB 1FT N/O BCR @ NW COR SANTA GERTRUDES AVE + ASHGROVE DR 56FT N + 30FT W/O C/L INT	BY 8676
LAMIRADA (1970)	162.943	RDBM TAG IN S CB 3FT E/O BCR @ SE COR SANTA GERTRUDES AVE + ASHGROVE DR 70FT E/O + 18FT S/O C/L INT	BY 8677
LAMIRADA (1970)	144.790	S + L IN S CB 5FT E/O BCR @ SE COR LA MIRADA BLVD + ALICANTE RD 20FT S/O + 82FT E/O C/L INT MKD BM NO 6	BY 8678
LAMIRADA (1970)	208.823	RDBM TAG IN S CB 2FT E/O BCR @ SE COR OF LA MIRADA BLVD + GRANADA AVE 20FT S/O C/L GRANADA + 65FT E/O C/L LA MIRADA	BY 8679
LAMIRADA (1970)	194.143	RDBM TAG IN W CB 40FT W/O C/L LA MIRADA BLVD + 16FT S/O SO ENT BAPTIST CHURCH @ 12000 LA MIRADA BLVD	BY 8680
LAMIRADA (1970)	179.021	RDBM TAG IN E CB 31FT N/O + 42FT E/O C/L INT LA MIRADA BLVD + TACUBA DR	BY 8681

APR 1971

LOS ANGELES COUNTY ROAD DEPARTMENT
SURVEY SECTION FIELD ENGINEERING DIVISION

PAGE 11

QUAD-YEAR	ELEV	DESCRIPTION (INCLUDE QUAD AND YEAR IN DESCRIPTION)	BM NUMBER
LAMIRADA (1970)	123.688	RDBM TAG IN N CB SO SER RD 52FT S + 14FT W/O APPROX C/L INT @ ROSECRANS AVE + ESCALONA RD	BY 8682
LAMIRADA (1970)	106.213	RDBM TAG IN S CB 2FT E/O BCR @ SE COR ROSECRANS AVE + FIGUERAS RD 40FT S + 57FT E/O C/L INT	BY 8683
LAMIRADA (1970)	105.903	L + BN IN N CB 2FT W/O BCR @ NW COR OF ROSECRANS AVE + FIGUERAS RD 40FT N + 70FT W/O C/L INT	BY 8684
LAMIRADA (1970)	116.764	RDBM TAG IN S CB 2FT E/O BCR @ SE COR ROSECRANS AVE + CASTELLON RD 80FT S + 49FT E/O C/L INT	BY 8685
LAMIRADA (1970)	117.159	L + BR IN S CB 2FT W/O BCR ISL @ SW COR OF ROSECRANS AVE + CASTELLON RD 42FT S + 37FT W/O C/L INT	BY 8686
LAMIRADA (1970)	87.708	L + NAIL IN CONC FTG 8FT CHAIN LINK FENCE @ SE COR NEFF HIGH SCHOOL ATH FIELD 35FT W/O APPROX C/L KNOTT AVE 1100FT S/O STAGE RD	BY 8687
LAMIRADA (1970)	90.296	L + BN IN S CB 20FT E/O BCR @ SE COR ALONDRA BLVD + LEMONT AVE 42FT S + 62FT E/O C/L INT	BY 8688
LAMIRADA (1970)	89.876	L + T IN N CB 42FT N + 44FT E/O C/L INT ALONDRA BLVD + LEMONT AVE	BY 8689
LAMIRADA (1970)	70.098	RDBM TAG IN N CB 42FT N + 23FT W/O C/L INT @ ALONDRA BLVD + CANARY ST	BY 8690
LAMIRADA (1970)	69.966	RDBM TAG IN S CB 1FT W/O BCR @ SW COR ALONDRA BLVD + CANARY ST 42FT S + 64FT W/O C/L INT	BY 8691