

**LOS ANGELES COUNTY  
DEPARTMENT OF PUBLIC WORKS**

**BENCHMARKS**



**LANCASTER WEST QUAD**

**2012 ADJUSTMENT  
2010 BASELINE  
NAVD 88 DATUM FOOT/METER**

**PREFACE**  
**Antelope Valley**

The Department of Public Works level net is composed of more than 1,700 miles or 2720 kilometers of levels supporting in excess of 12,000 benchmarks. Previously when a major readjustment of the net was undertaken, to emphasize the complete break with previous elevations, the CY, CG, and CL, series benchmarks were re-labeled DY, DG, and DL, respectively. Beginning in 1993 the Baseline readjustment year will be indicated on Baseline BM's, as indicated below (\*). Henceforth all BM numbers will be labeled as a Y, G, or L series that will no longer indicate the major adjustment year.

To facilitate the adjustment, indexing and distribution of the adjusted values of the net, the county territory was divided into 33 quads or areas. For the identification purposes each quad was given a name (i.e. "Rosemead", "La Mirada", and "Santa Fe"...etc). When benchmarks and elevations in the quad are used, the name of the bench and quad must be stated in the description, i.e.:

(*)	<b>BASELINE</b>	<b>90.057</b>	<b>L&amp;BR IN CTR OF CB RET @ NE COR</b>	<b>Y 9191</b>
	(1990)	295.461	LA HABRA BLVD & VALLEY HOME AVE	

It is expected that this general adjustment will for the most part remain sound for 8 to 10 years. Updating constrained adjustments will continue in the future. When a quad is readjusted, new elevations will be published and the date of readjustment will be noted in the benchmark description. Two benchmarks with different adjustment dates will not normally agree with each other.

The basic accuracy of the net is reflected by an indicated field probable error of  $\pm 0.017$  feet per mile (4mm per kilometer) of leveling as determined from conditions of closure. However, many years of experience in vertical control in the greater Los Angeles basin and Antelope Valley indicates that because of varying degrees of subsidence and heaving, the true datum is recovered only by obtaining substantial agreement of a number of benchmarks.

The users of this network of benchmarks are invited to assist in its maintenance by notifying this department of cases of obliteration, apparent mistakes in descriptions or elevations, and the disturbance of benchmarks.



**Datum: North American Vertical Datum of 1988 (NAVD88)**

Note: NAVD 1988 minus approximately 3.00 feet (90 cm) equals NGVD 1929 Datum. For more accurate equations at individual benchmarks refer to previous publications.

**Abbreviations used in Benchmark Descriptions**

<b>Abbreviations</b>	<b>Descriptions</b>	<b>Abbreviations</b>	<b>Descriptions</b>
<i>ABUT</i>	Abutment	<i>LT</i>	Lead and Tack
<i>ALG</i>	Along	<i>LACE</i>	Los Angeles City Engineer
<i>ANG PT</i>	Angle Point	<i>LACS</i>	La County Engineer
<i>B/W</i>	Back of Walk	<i>LAFC</i>	La County Flood Control
<i>BCR</i>	Begin Curb Return	<i>L&amp;BN</i>	Lead and Bench Nail
<i>BC</i>	Begin Curve	<i>L&amp;BR</i>	Lead and Brad
<i>BLDG</i>	Building	<i>L&amp;N</i>	Lead and Nail
<i>BM</i>	Benchmark	<i>L&amp;SPK</i>	Lead and Spike
<i>BT SPK</i>	Boat or Bolt Spike	<i>L&amp;T</i>	Lead and Tack
<i>BR CAP</i>	Brass Cap Monument	<i>MCR</i>	Middle Curb Return
<i>C B</i>	Catch Basin	<i>MKD</i>	Marked
<i>CTR</i>	Center	<i>MC</i>	Middle Curve
<i>C/L</i>	Centerline	<i>MON</i>	Monument
<i>C/L INT</i>	Centerline Intersection	<i>N/O</i>	North of
<i>C/L PROD</i>	Centerline Produced	<i>NR</i>	Near
<i>CONC</i>	Concrete	<i>OPP</i>	Opposite
<i>COR</i>	Corner	<i>PI</i>	Point of Intersection
<i>COE</i>	Corps of Engineers	<i>PK&amp;W</i>	PK Nail and Washer
<i>CULV</i>	Culvert	<i>P/L</i>	Property Line
<i>CYN</i>	Canyon	<i>POST</i>	Point on Simi-Tangent
<i>CB</i>	Curb	<i>PP</i>	Power Pole
<i>CS MON</i>	Co. Eng. Monument	<i>PVMT</i>	Pavement
<i>CT SPK</i>	Cut Spike	<i>PROD</i>	Produced
<i>DPW</i>	Dept of Public Works	<i>RD</i>	Road
<i>DR</i>	Driveway	<i>RDBM</i>	Road Dept Benchmark
<i>E/O</i>	East of	<i>RDBM TAG</i>	Road Dept Benchmark Tag
<i>ECR</i>	End Curb Return	<i>RR</i>	Railroad
<i>EC</i>	End Curve	<i>R/W</i>	Right of Way
<i>ENT</i>	Entrance	<i>SDMH</i>	Storm Drain Manhole
<i>FL</i>	Flow line	<i>SMH</i>	Sewer Manhole
<i>FTG</i>	Footing	<i>SPK</i>	Spike
<i>FRWY</i>	Freeway	<i>ST&amp;W</i>	Spike Tin and Washer
<i>F/W</i>	Front of Walk	<i>S/O</i>	South of
<i>GAR</i>	Garage	<i>TP</i>	Telephone Pole
<i>HDWL</i>	Head Wall	<i>USC&amp;GS</i>	US Coast and Geodetic Survey
<i>HSE</i>	House	<i>USGS</i>	US Geological Survey
<i>HWY</i>	Highway	<i>WK</i>	Walk
<i>INT</i>	Intersection	<i>W/O</i>	West of
<i>IP</i>	Iron Pipe		

# QUAD COVERAGE INDEX MAP



**LANCASTER WEST QUAD**

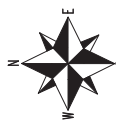
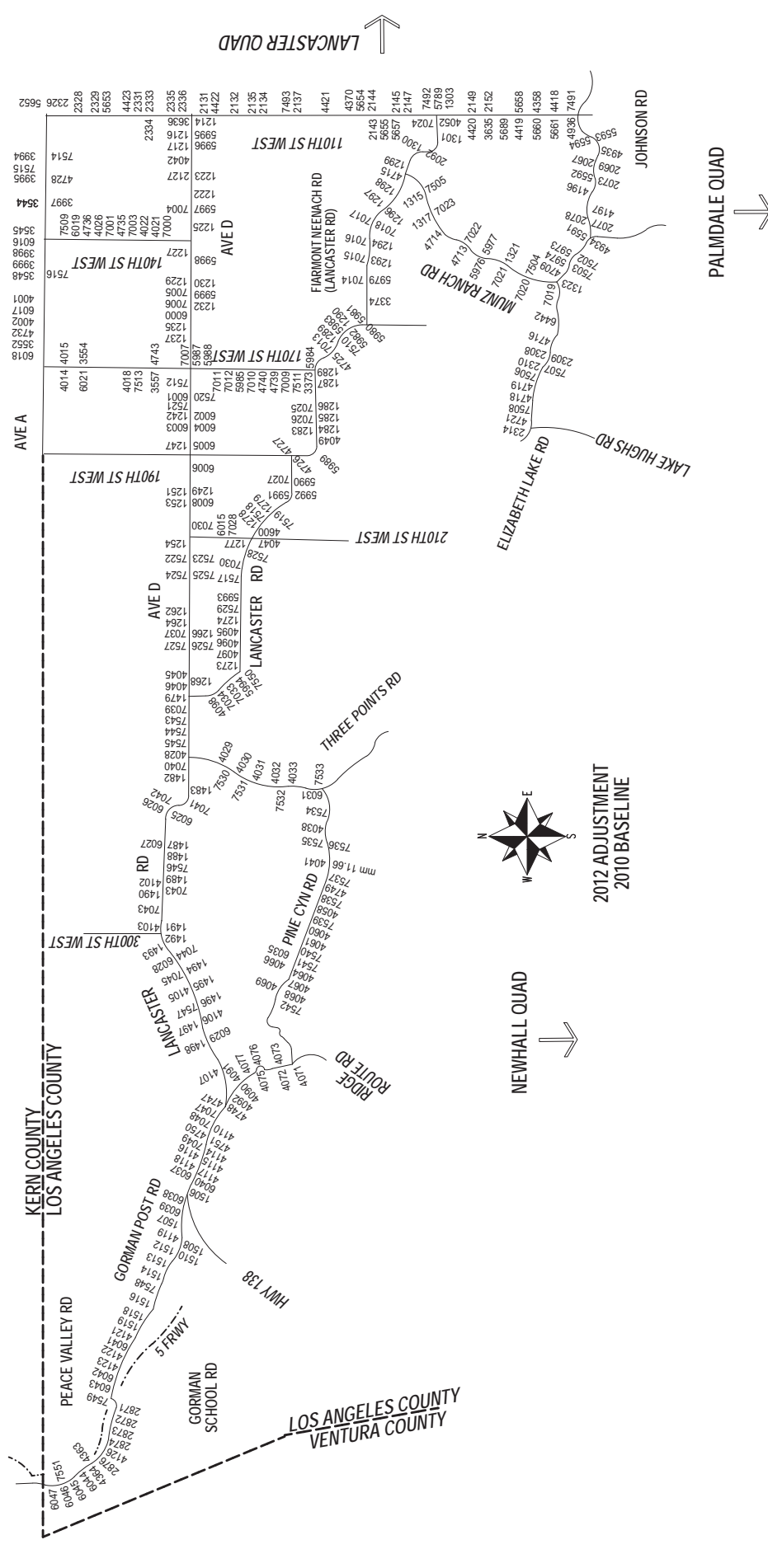

2012 ADJUSTMENT  
2010 BASELINE

NEWHALL QUAD

PALMDALE QUAD

LANCASTER QUAD

QUAD YEAR	ELEV FOOT/METER	DESCRIPTION	BM NUMBER
BASELINE ( 2010 )	2,490.787 759.194	RDBM MON IN WELL FL 236FT W/O C/L 110TH ST W & 27.9FT N/O C/L AVE D 11.8FT E/O PP #4244358E MKD (1961) MKR POST 2FT N/O MON	L 1214
LANCASTER (WEST ( 2012 )	2,504.554 763.390	RDBM MON 6.5FT E/O PP #4244370E 46FT N/O C/L AVE D & 194FT W/O C/L 115TH ST W (DIRT RD) MKD (1961) MKR POST 2FT N/O MON	L 1216
LANCASTER (WEST ( 2012 )	2,516.334 766.981	RDBM TAG IN W LEG OF WATER & POWER ELEC TOWER #212-4 141FT N/O & 164FT E/O C/L AVE D & 120TH ST W (PROPOSED)	L 1217
LANCASTER (WEST ( 2012 )	2,548.370 776.746	USC&GS MON IN CONC POST 0.7FT UP 36FT S/O & 31FT W/O C/L INT AVE D & 130TH ST W (PROPOSED) MKD (WIND 1952)	L 1222
LANCASTER (WEST ( 2012 )	2,548.031 776.642	USC&GS MON IN CONC POST 0.5FT UP 62FT S/O & 29.5FT W/O C/L INT AVE D & 130TH ST W (PROPOSED) MKD (WIND NO 1 1952)	L 1223
LANCASTER (WEST ( 2012 )	2,573.732 784.476	RDBM TAG IN CONC BASE OF S LEG OF EDISON TOWER ANTELOPE MAGUNDEN #1 59FT N/O C/L AVE D & 0.2M) W/O 135TH ST W (PROPOSED)	L 1225
LANCASTER (WEST ( 2012 )	2,580.047 786.401	RDBM MON 6.6FT E/O PP #1218923E 46FT N/O C/L AVE D & 154FT W/O C/L 140TH ST W MKR POST 2FT N/O MON	L 1227
LANCASTER (WEST ( 2012 )	2,597.929 791.851	RDBM MON IN WELL 1M(3.3FT) E/O PP #2287930E 45.9FT N/O & 183.7FT W/O C/L AVE D & 145TH ST W MKD (1961)	L 1229
LANCASTER (WEST ( 2012 )	2,613.998 796.749	RDBM MON IN WELL 3.3FT E/O PP #4306197E 39.4FT N/O & 190FT E/O C/L INT 150TH ST W & AVE D MKD (1961) MKR POST 2FT N/O MON	L 1230
LANCASTER (WEST ( 2012 )	2,628.375 801.131	RDBM MON IN WELL 6.6FT W/O PP (#2287918E) 39.4FT N/O & 118FT E/O C/L INT AVE D & 155TH ST W MKD (1961) MKR POST 2FT N/O MON	L 1232
LANCASTER (WEST ( 2012 )	2,649.893 807.690	RDBM MON 6.5FT E/O PP #1312422E 8.5M(28FT) N/O & 161FT W/O C/L INT AVE D & 160TH ST W (DIRT RD) MKR POST 2FT N/O MON	L 1235
LANCASTER (WEST ( 2012 )	2,670.768 814.053	RDBM MON 6.5FT E/O PP #1312410E 28FT N/O & 171FT W/O C/L INT AVE D & 165TH ST W (PROPOSED) MKR POST 2FT N/O MON	L 1237
LANCASTER (WEST ( 2012 )	2,734.784 833.565	RDBM MON IN WELL 3M(10FT) E/O PP #1312375E 46FT N/O & 48FT E/O C/L INT AVE D & 180TH ST W (PROPOSED) MKD (1961) MKR POST 2FT N/O MON	L 1242
LANCASTER (WEST ( 2012 )	2,776.262 846.207	RDBM IN WELL 7.9FT E/O PP #1312350E 46FT N/O & 190FT W/O C/L INT AVE D & 190TH ST W MKD (1961) MKR POST 2FT N/O MON	L 1247
LANCASTER (WEST ( 2012 )	2,791.585 850.878	RDBM MON IN WELL 6.5FT E/O PP #1312339 46FT N/O & 118FT W/O C/L INT AVE D & 195TH ST W (PROPOSED) MKD (1961)	L 1249
LANCASTER (WEST ( 2012 )	2,804.212 854.726	RDBM IN WELL 6.5 E/O PP (NO #) 46FT N/O & 184FT W/O C/L INT AVE D & 200TH ST W MKD (1961) MKR POST 2FT N/O MON	L 1251
LANCASTER (WEST ( 2012 )	2,816.635 858.513	RDBM MON IN WELL 6.5FT E/O PP #1312315E 46FT N/O & 144FT W/O C/L INT AVE D & 205TH ST W (PROPOSED) MKR POST 2FT N/O MON	L 1253
LANCASTER (WEST ( 2012 )	2,820.765 859.772	RDBM TAG IN CONC FTG OF CHAIN LINK FENCE POST @ SW COR EDISON SUB-STA 49FT N/O & 49FT E/O C/L INT AVE D & 210TH ST W (DIRT RD)	L 1254

QUAD YEAR	ELEV FOOT/METER	DESCRIPTION	BM NUMBER
LANCASTER (WEST ( 2012 )	2,827.305 861.765	RDBM MON 1FT DN 1.5FT N/O PP #2287786E 28FT N/O & 180FT W/O C/L INT AVE D & 225TH ST W (PROP) MKD (1961) MKR POST 2FT N/O MON	L 1262
LANCASTER (WEST ( 2012 )	2,852.191 869.350	RDBM MON IN WELL 10FT E/O PP #4053218E 29.5FT N/O & 171FT W/O C/L INT AVE D & 230TH ST W MKD (1961) MKR POST 2FT N/O MON	L 1264
LANCASTER (WEST ( 2012 )	2,885.095 879.380	RDBM MON IN WELL 2.3FT NW/O PP #4053216E 180FT W/O & 29.5FT N/O C/L INT AVE D & 235TH ST W MKD (1961)	L 1266
LANCASTER (WEST ( 2012 )	2,923.400 891.055	RDBM MON IN WELL 13FT E/O PP #4053205E 28FT N/O & 161FT W/O C/L INT AVE D & 240TH ST W MKR POST 2FT N/O MON	L 1268
LANCASTER (WEST ( 2012 )	2,975.195 906.842	CSBM MON 4IN UP 56FT S/O C/L LANCASTER RD & 570FT W/O C/L 235TH ST W 25FT E/O PP #GT8034 MKD (BM 102-55 1957) MKR POST 2FT E/O MON	L 1273
LANCASTER (WEST ( 2012 )	2,946.197 898.004	CSBM MON 0.5FT UP 29.5FT N/O C/L LANCASTER RD & 21FT W/O C/L 227TH ST W MKD (BM 102-54 1957)	L 1274
LANCASTER (WEST ( 2012 )	2,900.333 884.024	CSBM MON 0.5FT UP 49FT N/O C/L LANCASTER RD & 0.2MI W/O C/L 210TH ST W MKD (BM 102-51 1957) 23FT E/O C/L DIRT RD 1IN IP MKR 1FT N/O MON	L 1277
LANCASTER (WEST ( 2012 )	2,933.397 894.102	CSBM MON (0.5FT UP 49FT S/O C/L LANCASTER RD & 0.4MI E/O 210TH ST W MKD (BM 102-50 1957) MKR POST 1FT N/O MON	L 1278
LANCASTER (WEST ( 2012 )	2,955.909 900.964	USC&GS MON IN TOP OF 0.7FT CONC POST 1.1FT UP 30FT W/O C/L LANCASTER RD & 0.5MI NWLY 200TH ST W (DIRT) MKD (X-305 1935) MKR POST 1FT E/O MON	L 1279
LANCASTER (WEST ( 2012 )	2,898.698 883.526	CSBM MON 0.5FT UP 56FT S/O C/L AVE LANCASTER RD & 82FT E/O C/L PROD 190TH ST W 26FT E PP #2163801E MKD (BM 102-45 1957) MKR POST 2.3FT S/O MON	L 1283
LANCASTER (WEST ( 2012 )	2,874.761 876.230	CSBM MON 4IN UP 51FT S/O C/L LANCASTER RD & 118FT E/O C/L 185TH ST W (DIRT) 3.3FT N/O PP (NO#) MKD (BM 102-44 1957) MKR POST 2FT N/O MON	L 1284
LANCASTER (WEST ( 2012 )	2,834.425 863.935	CSBM MON 4IN UP 56FT S/O C/L LANCASTER RD & 15FT W/O C/L 180TH ST W 3.3FT N/O PP (NO#) MKD (BM 102-43 1957) MKR SIGN 2FT N/O MON	L 1285
LANCASTER (WEST ( 2012 )	2,810.807 856.737	CSBM MON FLUSH 57FT S/O C/L LANCASTER RD & 0.5MI W/O 170TH ST W 51FT E/O PP (#4629646E) MKD (BM 102-42 1957) MKR POST 1.5FT N/O MON	L 1286
LANCASTER (WEST ( 2012 )	2,787.949 849.769	CSBM MON 4IN UP 36FT S/O C/L AVE F-8 & 21FT E/O C/L PROD 170TH ST W MKD (BM 102-41 1957) 2.3FT NW/O NW PROP FENCE COR	L 1287
LANCASTER (WEST ( 2012 )	2,793.930 851.592	CS MON 3' ABOVE RD, 24' N/O TRAVELED LANCASTER RD & 0.20MI E/O 167TH ST W, 90 E/O PP#4631296E	L 1289
LANCASTER (WEST ( 2012 )	2,785.553 849.039	CS MON 4" UP, 90' NE & 0.40MI N/O CL INT LANCASTER RD & 160TH ST W., 33' E/O PP#1491138E, MRK'D BM 102-38, 1957, 2' S/O MKR POST SIGN 1 W/O MON	L 1290
LANCASTER (WEST ( 2012 )	2,751.714 838.725	USGS MON 4IN UP 43FT S/O C/L LANCASTER RD & 2.9MI W/O MUNZ RANCH RD 70FT E/O C/L PROD DIRT RD TO N 80FT E/O SEC LINE 5,6,T7N,R14W, MKD (R 39 1929) MRK POST 1FT N/O MON	L 1293

QUAD YEAR	ELEV FOOT/METER	DESCRIPTION	BM NUMBER
LANCASTER (WEST ( 2012 )	2,682.681 817.684	CSBM MON FLUSH 113FT S/O C/L LANCASTER RD & 2.4MI W/O MUNZ RANCH RD ON LEVEL AREA MIDWAY UP A RISE 75.5FT SW/O PP (#1560009E) MKD (BM 102-34 1957 RE 5869) MKR POST 2FT N/O MON	L 1294
LANCASTER (WEST ( 2012 )	2,607.256 794.694	CSBM MON FLUSH 25FT N/O C/L LANCASTER RD & 1.1M) W/O MUNZ RANCH RD NR PI OF CURVE 1M(3.3FT) S/O FENCE POST MKD (BM 102-32 1957 RE 5869) 27.4M(81FT) W/O PVT ST MKR POST 23FT S/O MON 32FT NW/O GUY POLE #1559817E	L 1296
LANCASTER (WEST ( 2012 )	2,587.821 788.770	USC&GS MON FLUSH 3.9FT BELOW RD GRADE 43FT S/O C/L LANCASTER RD & 0.7MI W/O MUNZ RANCH RD 72FT SE/O PP(#1559808E) MKD (Z 305 1935) MKR 1FT N/O MON	L 1297
LANCASTER (WEST ( 2012 )	2,584.330 787.706	CSBM MON FLUSH 46FT S/O C/L LANCASTER RD & 0.5MI W/O MUNZ RANCH RD 56FT SE/O PP #1559802E MKD (BM 102-30 1957 RE 5869) MKR POST 1FT N/O MON	L 1298
LANCASTER (WEST ( 2012 )	2,570.724 783.559	CSBM MON FLUSH 27FT N/O C/L LANCASTER RD & 29.5FT W/O C/L MUNZ RANCH RD 4FT E/O PP #402818E MKD (BM 102-29 1957 RE 5869)	L 1299
LANCASTER (WEST ( 2012 )	2,538.285 773.672	CSBM MON 4IN DN 42.6FT N/O C/L LANCASTER RD & 233FT W/O 120TH ST W MKD (102-28 1958 RE 5869) BUTTON GONE MKR 2FT S/O MON NR MI MKR #12.03	L 1300
LANCASTER (WEST ( 2012 )	2,549.443 777.073	CSBM MON UP 3IN 25FT N/O C/L PROD AVE I & 55.8FT E/O C/L PROD 120TH ST W 49.2FT SE/O PP #3002085E MKD (BM 102-27 1957 RE 5869) BUTTON GONE	L 1301
BASELINE ( 2010 )	2,500.260 762.082	CS MON IN WELL 1.5FT DN ON C/L 110TH ST W 4.9FT N/O C/L AVE I MKD (CO SUR 11,12,13,14,T7N,R14W, RE 2177)	L 1303
LANCASTER (WEST ( 2012 )	2,588.969 789.120	CSBM MON FLUSH 34FT NW/O C/L MUNZ RANCH RD & 0.4MI S/O LANCASTER RD 160FT S/O DIRT DRWY TO HSE # 45715 1FT W/O INT 4FT BARBED WIRE FENCES MKD (BM 113-8 1960 RE 5869) MKR POST 600MM(2FT) SE/O MON	L 1315
LANCASTER (WEST ( 2012 )	2,679.735 816.786	CSBM MON FLUSH 32FT N/O C/L MUNZ RANCH RD & 3MI N/O ELIZABETH LAKE RD 0.2MI NE/O POWER LINE CROSSING MKD (BM 113-6 1960 RE 5869) MKR 2FT E/O MON	L 1317
LANCASTER (WEST ( 2012 )	3,072.255 936.426	CSBM MON FLUSH 33FT NW/O C/L MUNZ RANCH RD & 1.1MI N/O ELIZABETH LAKE RD 39.4FT NE/O MI MKR #3.26 MKD (BM 113-2 1960) MKR POST 2FT S/O MON	L 1321
LANCASTER (WEST ( 2012 )	3,299.744 1,005.765	CSBM MON FLUSH 44FT E/O C/L MUNZ RANCH RD & 71FT N/O C/L ELIZABETH LAKE RD 3.3FT N/O PP #29176M MKD (BM 111-32 1960 RE 5869) MKR 2FT E/O MON	L 1323
LANCASTER (WEST ( 2012 )	2,974.655 906.678	CSBM MON FL 62.3FT N/O C/L HWY 138 & 0.4MI W/O 245TH W ON W SIDE DIRT DR TO HSE #24715 9.8FT NW/O PP #1120495E MKD (BM 102-59 1957)	L 1479
LANCASTER (WEST ( 2012 )	3,055.411 931.292	CSBM MON FL 29.5FT N/O C/L LANCASTER RD & 0.3MI W/O THREE POINTS RD 6.5FT W/O PP #1123627E MKD (BM 102 -62 1957) MKR POST 2FT W/O MON	L 1482



QUAD YEAR	ELEV FOOT/METER	DESCRIPTION	BM NUMBER
LANCASTER (WEST ( 2012 )	3,054.177 930.916	CSBM MON FL 69FT S/O C/L LANCASTER RD & 417FT E/O C/L 269TH ST W OPP HSE #26803 6.5FT E/O C/L PROD OF DRWY MKD (BM 102-63 1957 RE 5869) MKR SIGN 0.5FT N/O MON	L 1483
LANCASTER (WEST ( 2012 )	3,040.183 926.651	CSBM MON 3IN UP 49FT S/O C/L LANCASTER RD @ 280TH ST W 3.3FT W/O PP #1122597E MKD (BM 102-66 1957) USC&GS MKR SIGN 1FT N/O MON	L 1487
LANCASTER (WEST ( 2012 )	3,046.383 928.540	CSBM MON FL 49FT S/O C/L LANCASTER RD & 190FT W/O C/L MARGALO DR (DIRT RD) 3.3FT W/O PP #1123690E MKD (BM 102-67 1957) MKR SIGN 1FT N/O MON	L 1488
LANCASTER (WEST ( 2012 )	3,023.651 921.612	CS BM MON FLUSH, 49' S/O HWY 138, 0.50MI E/O 300TH ST W., 4' E/O PP#4053165E, 246' E/O DWY HSE # 29826, MRK'D BM 102-69, 1957	L 1489
LANCASTER (WEST ( 2012 )	3,045.037 928.130	CSBM MON FL 49FT S/O C/L HWY 138 & 0.5MI E/O 300TH ST W 3.3FT W/O PP #4053165E 246' E/O C/L DRWY TO HSE #29826 MKD (BM 102-69 1957)	L 1490
LANCASTER (WEST ( 2012 )	3,047.126 928.767	CSBM MON FL 49FT S/O C/L HWY 138 & 217FT E/O C/L 300TH ST W OPP HSE #29853 3.3FT W/O PP #1123722E MKD (BM 102-70 1957) USC&GS MKR 1FT N/O MON	L 1491
LANCASTER (WEST ( 2012 )	3,091.394 942.260	CSBM MON FL 49FT NW C/L HWY 138 & 0.6MI W/O 300TH ST W 9.8FT N/O PP #1049047E 5FT SW/O FENCE COR MKD (BM 102-71 1957) MKR SIGN 1FT S/O MON	L 1492
LANCASTER (WEST ( 2012 )	3,126.457 952.947	CSBM MON 0.5FT UP 49FT S/O C/L HWY 138 & 3.4MI E/O OLD RIDGE RTE 1.1M) W/O 300TH ST W NR N&S PP LINE MKD (BM 102-72 1957) USC&GS MKR 1FT N/O MON	L 1493
LANCASTER (WEST ( 2012 )	3,146.961 959.197	CSBM MON FL 49FT S/O C/L HWY 138 & 2.8MI E/O OLD RIDGE RTE 20FT S/O S END HDWL CULV #156+09 MKD (BM 102-73 1957) USC&GS MKR 1FT N/O MON	L 1494
LANCASTER (WEST ( 2012 )	3,172.456 966.968	CSBM MON 0.5FT UP 49FT S/O C/L HWY 138 & 2.4MI E/O OLD RIDGE RTE 18FT S/O S END CULV #A133+60 MKD (BM 102-74 1957) MKR POST 1.5FT E/O MON	L 1495
LANCASTER (WEST ( 2012 )	3,213.110 979.359	CSBM MON 4IN UP 49FT S/O C/L LANCASTER RD (HWY 138) 16.4FT S/O S END CONC HDWL & 1.8MI E/O OLD RIDGE RTE RD MKD (BM 102-75 1957) MKR 1FT N/O MON	L 1496
LANCASTER (WEST ( 2012 )	3,274.075 997.941	USC & GS MON FL. 49' N/O CL HWY 138 & 1.4MI E/O OLD RIDGE RTE. RD., 482' E/O MM 75+75 & 75' E/O PP#1061987E, MKD 'R 305,1935'. MKR 1' S/O MON	L 1497
LANCASTER (WEST ( 2012 )	3,342.483 1,018.792	CSBM MON 6" UP, 49' S/O CL HWY 138 & 0.75MI E/O OLD RIDGE RTE RD., 16.4' S/O S'LY END CONC HDWL CULVERT 51+15, MRK'D BM 102-77,1957, USC&GS MKR 1' N/O MON	L 1498
LANCASTER (WEST ( 2012 )	3,338.528 1,017.586	USC&GS MON 0.5FT UP 36FT S/O C/L GORMAN POST RD 6.6FT N/O PP #1699201E 530FT W/O INT LANCASTER RD MKD (Q 452 1953) METAL MKR POST 2FT N/O MON	L 1506
LANCASTER (WEST ( 2012 )	3,386.188 1,032.113	USC&GS MON 0.7FT UP 95FT SE/O C/L GORMAN POST RD & 0.4MI W/O INT LANCASTER RD ON SW SIDE OF SMALL HILL @ MI MKR #0.50 MKD (Z 53 1926 RESET 1953) MKR POST 2FT W/O MON	L 1507

QUAD YEAR	ELEV FOOT/METER	DESCRIPTION	BM NUMBER
LANCASTER (WEST ( 2012 )	3,402.204 1,036.995	USC&GS MON 3.3FT W/O E END N HDWL OF CULV 21FT N/O C/L GORMAN POST RD & 0.5MI W/O LANCASTER RD MKD (P 452 1953) @ MI MKR #0.60	L 1508
LANCASTER (WEST ( 2012 )	3,588.372 1,093.739	USC&GS MON 0.5FT UP 49FT NE C/L GORMAN POST RD 1.1MI W/O LANCASTER RD 24FT S/O C/L DIRT RD TO E MKD (B 370 1953) MKR POST 2FT NW/O MON	L 1510
LANCASTER (WEST ( 2012 )	3,485.346 1,062.337	USC&GS MON 1FT W/O E END S HDWL OF CULV #1.66 28FT S/O C/L GORMAN POST RD 1.6MI W/O LANCASTER RD MKD (1 452 1953)	L 1512
LANCASTER (WEST ( 2012 )	3,462.120 1,055.257	USC&GS MON 4IN UP 41FT S/O C/L GORMAN POST RD & 1.8MI W/O LANCASTER RD 29FT SW/O S END OF CULV #1.89 MKD (A 370 1953) MKR POST 1.5FT W/O MON	L 1513
LANCASTER (WEST ( 2012 )	3,484.942 1,062.214	USC&GS MON 0.5FT UP 43FT S/O C/L GORMAN POST RD 2MI W/O LANCASTER RD NR POWER LINE CROSSING 49FT W/O NW END OF S HDWL OF CULV #2.07 MKD (K 452 1953) MKR POST 1.5FT NW/O MON	L 1514
LANCASTER (WEST ( 2012 )	3,516.208 1,071.743	USC&GS MON 0.5FT UP 36FT SW C/L GORMAN POST RD & 2.6MI W/O LANCASTER RD 69FT SE/O END OF S HDWL OF CULV #2.73 15FT W/O PP #15-41 MKD (A 54 1926) MKR POST 1.5FT E/O MON	L 1516
LANCASTER (WEST ( 2012 )	3,561.758 1,085.627	USC&GS MON 0.5FT UP 39FT NE C/L GORMAN POST RD & 3.1MI W/O LANCASTER RD 79FT SE/O PP (#1061807E) MKD (G 452 1953) MKR POST 1.6FT SE/O MON	L 1518
LANCASTER (WEST ( 2012 )	3,603.316 1,098.294	USC&GS MON 0.5FT UP 49FT N/O C/L GORMAN POST RD 1.5MI E/O GORMAN SCHOOL RD 2FT W/O SE COR FENCE AROUND EDISON GORMAN SUB-STA 42.7FT NE/O PP (NO #) MKD (F 452 1953) MKR POST 1.6FT W/O MON	L 1519
BASELINE ( 2010 )	3,195.907 974.115	RDBM TAG IN ROCK & CONC HDWL 18' N/O APPROX C/L JOHNSON RD & 1.4MI E/O LIMERIDGE DR 7' W/O MI MKR #11.79	L 2067
BASELINE ( 2010 )	3,350.405 1,021.207	CSBM MON FLUSH 35' N/O C/L JOHNSON RD 85' W/O C/L WLY DRWY TO HSE #12215 & 0.9MI E LIMERIDGE DR MKD (BM 119-32 1961) MKR PIPE 1' S/O MON	L 2069
BASELINE ( 2010 )	3,458.505 1,054.156	CS MON DN 10" 55' S/O C/L JOHNSON RD & 0.3MI E/O LIMERIDGE DR 70' E/O MI MKR #12.93 MKD (SEC COR 28,27,33,34,T7N,R14W) MKR 2' N MON	L 2073
BASELINE ( 2010 )	3,411.289 1,039.764	DN IN SE CONC LEG OF TOWER #220/6 141'M N/O C/L JOHNSON RD & 0.4MI E/O ELIZABETH LAKE RD	L 2077
BASELINE ( 2010 )	3,398.397 1,035.835	CSBM MON 6" UP 28' N/O C/L JOHNSON RD & 0.35MI E/O ELIZABETH LAKE RD 65' W/O MKR #13.59 MKD (BM 119-35 1961)	L 2078
LANCASTER (WEST ( 2012 )	2,537.329 773.380	CS MON 2FT DN @ C/L INT 120TH ST W & FUT AVE H-8 MKD (1/4 COR 10,11,R14W,T7N,RE 2177) MKR POSTS 1FT E/O & W/O MON	L 2092
LANCASTER (WEST ( 2012 )	2,530.779 771.384	USC&GS MON FLUSH 46FT N/O & 23FT E/O C/L INT AVE D & 125TH ST W (DIRT RD) MKD (WIND 1952)	L 2127
BASELINE ( 2010 )	2,491.801 759.503	CSBM MON 1FT DN @ SE COR 110TH ST W & AVE D-8 72.2FT S/O & 32.2FT E/O C/L INT MKD (BM 119-42 1961) MKR POST 2FT W/O MON	L 2131

QUAD YEAR	ELEV FOOT/METER	DESCRIPTION	BM NUMBER
BASELINE (2010)	2,484.185 757.182	CS MON IN WELL 1.5FT DN @ C/L INT 110TH ST W & AVE E MKD (SEC COR 23,24,25,26,R14W,T8N)	L 2132
BASELINE (2010)	2,497.120 761.124	CS MON IN WELL 450MM(1.5FT) DN @ C/L INT 110TH ST W & AVE E-8 10.7M(35.1FT) E/O PP #1222609 MKD (CO SUR 1/4 SEC COR 25,26,T8N,R14W)	L 2134
BASELINE (2010)	2,499.211 761.762	CSBM MON 0.5FT DN @ SW COR 110TH ST W & AVE E-8 110FT S/O & 32.8FT W/O C/L INT MKD (BM 119-44 1961) MKR POST 2FT E/O MON	L 2135
BASELINE (2010)	2,519.060 767.812	CSBM MON FL 259FT S/O C/L FUT AVE F & 35.1FT W/O C/L 110TH ST W MKD (BM 119-45 1961) MKR POST 2.3FT E/O MON	L 2137
BASELINE (2010)	2,497.337 761.191	CS MON IN WELL 1FT DN @ C/L INT 110TH ST W & AVE G-8 MKD (1/4 COR 1,2,R14W,T7N)	L 2143
BASELINE (2010)	2,501.947 762.596	CSBM MON 35.1FT W/O C/L 110TH ST W & 364FT S/O AVE G-8 MKD (BM 119-21 1961) MKR 2FT E/O MON	L 2144
BASELINE (2010)	2,499.632 761.890	CS MON IN WELL 2FT DN @ C/L INT 110TH ST W & AVE H MKD (SEC COR 1,2,11,12,T7N,R14W)	L 2145
BASELINE (2010)	2,502.983 762.912	CS MON IN WELL 1FT DN @ C/L INT 110TH ST W & AVE H-8 MKD (1/4 COR 11,12,T7N,R14W)	L 2147
BASELINE (2010)	2,507.580 764.313	CS MON IN WELL @ C/L INT 110TH ST W & AVE I-8 MKD (1/4 COR 13,14,T7N,R14W,RE 5869)	L 2149
BASELINE (2010)	2,538.502 773.738	USC&GS MON FLUSH @ SW COR AVE J & 110TH ST W 44.9FT W & 39.4FT S/O C/L INT MKD (SUR 1932) MKR POST 1.1FT W/O MON	L 2152
LANCASTER (WEST (2012)	3,298.716 1,005.452	USGS MON 4IN UP 123FT S/O C/L ELIZABETH LAKE RD & 1MI W/O MUNZ RANCH RD MKD (K 19 1929) MKR POST 2FT N/O MON W/O W END PARKING LOT	L 2308
LANCASTER (WEST (2012)	3,290.291 1,002.884	CSBM MON 0.5FT UP 29.5FT N/O C/L ELIZABETH LAKE RD & 530FT W/O CHAPPAREL FOREST DR 32.8FT E/O MI MKR 18.85 MKD (BM 111-35 1960 RE 5869) MKR 1FT S/O MON 200FT W/O W END PARKING LOT	L 2309
LANCASTER (WEST (2012)	3,292.652 1,003.603	USC&GS MON 3.3FT UP @ GATE POST NE COR DRWY TO 16633 ELIZABETH LAKE RD & ENT TO UNION SCHOOL 75.5FT N/O & 19FT E/O C/L INT MKD (S 975 1964)	L 2310
LANCASTER (WEST (2012)	3,252.271 991.295	USGS MON 0.5FT UP 55.8FT N/O C/L ELIZABETH LAKE RD & 37FT E/O C/L LAKE HUGHES RD MKD (R 23 1929) MKR POST 3FT S/O MON	L 2314
BASELINE (2010)	2,486.749 757.963	CS MON IN WELL 2FT DN @ C/L INT 110TH ST W & AVE A MKD (35,36,2,1,R14W,T8N,T9N)	L 2326
BASELINE (2010)	2,488.754 758.575	CS MON IN WELL 1FT DN @ C/L INT 110TH ST W & AVE A-8 MKD (1/4 COR 2,1,T8N,R14W)	L 2328
BASELINE (2010)	2,485.458 757.570	CS MON IN WELL 1.8FT DN @ C/L INT 110TH ST W & AVE B MKD (2,1,11,12,R14W,T8N)	L 2329
BASELINE (2010)	2,487.100 758.070	CS MON IN WELL 1.3FT DN @ C/L INT 110TH ST W & FUT AVE B-8 MKD (1/4 COR 11,12,R14W,T8N)	L 2331

QUAD YEAR	ELEV FOOT/METER	DESCRIPTION	BM NUMBER
BASELINE (2010)	2,486.252 757.812	CS MON IN WELL 1.6FT DN @ C/L INT 110TH ST W & AVE C MKD (11,12,13,14,R14W,T8N)	L 2333
BASELINE (2010)	2,488.959 758.637	CSBM MON 0.5FT DN @ SE COR 110TH ST W & AVE C 85.3FT S/O & 26.9FT E/O C/L INT MKD (BM 119-39 1961) MKR POST 2FT W/O MON	L 2334
BASELINE (2010)	2,485.437 757.563	CS MON IN WELL 1.3FT DN @ C/L INT 110TH ST W & AVE C-8 MKD (1/4 COR 14,13,T8N,R14W)	L 2335
BASELINE (2010)	2,488.395 758.465	CSBM MON 0.5FT UP @ SW COR 110TH ST W & AVE C-8 95.1FT S & 30FT W/O C/L INT MKD (BM 119-40 1961) MKR POST 2FT E/O MON	L 2336
LANCASTER (WEST (2012)	3,820.051 1,164.355	L&T IN CONC HDWL 59FT S/O & 59FT W/O C/L INT PEACE VALLEY RD & GORMAN SCHOOL RD 500FT S/O GOLDEN STATE FRWY OVERPASS	L 2871
LANCASTER (WEST (2012)	3,846.500 1,172.417	L&T W'LY END OF N'LY WING WALL CONC DRN, 59' S/O & 59' W/O CL INT PEACE VALLEY RD & GORMAN SCHOOL RD, 500' S/O I-5 FRWY OVERPASS	L 2872
LANCASTER (WEST (2012)	3,844.271 1,171.737	L&BN IN W END OF CONC HDWL 46FT N/O C/L PEACE VALLEY RD & 0.15MI W/O GORMAN SCHOOL RD NR MI MKR #2.80 MKD (BM) BRIDGE #3365	L 2873
LANCASTER (WEST (2012)	3,909.884 1,191.736	L&BN 5FT W/O E END OF CONC HDWL 39FT S/O C/L PEACE VALLEY RD & 0.5MI W/O GORMAN SCHOOL RD NR MI MKR #2.50 MKD (BM)	L 2874
LANCASTER (WEST (2012)	3,965.675 1,208.741	L&BN IN CTR OF CONC HDWL 56FT S/O C/L PEACE VALLEY RD & 0.7MI W/O GORMAN SCHOOL RD NR MI MKR #2.26 MKD (BM)	L 2876
LANCASTER (WEST (2012)	2,789.255 850.167	CS MON FLUSH ON C/L PROD 170TH ST W 120FT S/O C/L AVE F-8 MKD (1/4 COR 35,36,T8N,R15W,RE 5869) MKR POST 2FT NE/O MON	L 3373
LANCASTER (WEST (2012)	2,773.183 845.269	CSBM MON DN 14IN 4.9FT E/O PP (#1560034E) 35FT S/O C/L LANCASTER RD & 0.5MI E/O 160TH ST W MKD (BM 102- 36A 1967) MKR POST 3.3FT NE/O MON	L 3374
LANCASTER (WEST (2012)	2,540.894 774.467	CSBM MON FL @ SW COR AVE A & 130TH ST W 82FT S/O & 28FT W/O C/L INT MKD (BM 117-24 1961) MKR POST 2FT E/O MON (BENT OVER)	L 3544
LANCASTER (WEST (2012)	2,549.293 777.027	CS MON IN WELL 1.5FT DN @ C/L INT AVE A & (FUT) 135TH ST W MKD (1/4 COR 33,4,R14W,T8N,T9N)	L 3545
LANCASTER (WEST (2012)	2,586.519 788.373	CS MON IN WELL 1.6FT DN @ C/L INT AVE A & (FUT) 150TH ST W MKD (SEC COR 5,6,32,31,R14W,T8N,T9N)	L 3548
LANCASTER (WEST (2012)	2,612.722 796.360	CSBM MON 0.5FT UP @ SE COR FUT 165TH ST W & AVE A 39.4FT S/O & 50FT E/O C/L INT MKD (BM 117-31 1961) MKR POST 2FT N/O MON	L 3552
LANCASTER (WEST (2012)	2,625.227 800.172	CS MON IN WELL 2FT DN @ C/L INT 170TH ST W & AVE B MKD (1,2,11,12,T8N,R15W) 7.9FT E/O C/L RDWY	L 3554
LANCASTER (WEST (2012)	2,684.498 818.237	CSBM MON FL @ SE COR 170TH ST W & (FUT) AVE C-8 (59FT) E/O RD WAY & 98FT S/O C/L INT MKD (BM 117-37 1961) MKR 2FT W/O MON	L 3557
BASELINE (2010)	2,539.755 774.120	USC&GS REF MON FL 41FT S/O & 108.3 W/O C/L INT 110TH ST W & AVE J MKD (SUR 2 NO 5 1968)	L 3635
BASELINE (2010)	2,490.462 759.095	CSBM MON 1.5FT DN @ SW COR 110TH ST W & AVE D 86.9FT S/O & 29.5FT W/O C/L INT MKD (BM 119-41 1961) MKR POST 2FT E/O MON	L 3636

QUAD YEAR	ELEV FOOT/METER	DESCRIPTION	BM NUMBER
LANCASTER (WEST ( 2012 )	2,498.532 761.555	CS MON IN WELL 1FT DN @ C/L INT AVE A & (FUT) 115TH S W MKD (1/4 COR 35,2,T8N,T9N,R14W)	L 3994
LANCASTER (WEST ( 2012 )	2,513.821 766.215	RDBM TAG IN NW LEG OF ELEC TOWER #41-1 51FT E/O C/L (FUT) 120TH ST W & 65FT S/O C/L AVE A	L 3995
LANCASTER (WEST ( 2012 )	2,539.463 774.031	1-1/2IN IP W/CONC PLUG & BRAD FL 49FT E/O & 49FT S/O C/L INT AVE A & 130TH ST W MKR POST 2FT W/O MON	L 3997
LANCASTER (WEST ( 2012 )	2,564.135 781.551	CS MON IN WELL 1.3FT DN @ C/L INT AVE A & 140TH ST W MKD (SEC COR 32,33,5,4,T8N,T9N,R14W)	L 3998
LANCASTER (WEST ( 2012 )	2,574.538 784.722	CS MON IN WELL 1FT DN @ C/L INT AVE A & 145TH ST W MKD (1/4 COR 32,5,T8N,T9N,R14W)	L 3999
LANCASTER (WEST ( 2012 )	2,597.832 791.822	RDBM TAG IN CONC COLLAR OF IRRIGATION VALVE 33FT N/O C/L AVE A & 36FT E/O C/L (FUT) 155TH ST W WOODEN MKR POST 2FT W/O MON	L 4001
LANCASTER (WEST ( 2012 )	2,606.063 794.330	CS MON IN WELL 400MM(1.3FT) DN @ C/L INT AVE A & (FUT) 160TH ST W MKD (SEC COR 36,31,1,6,T9N,T8N,R15W, R14W)	L 4002
LANCASTER (WEST ( 2012 )	2,616.610 797.545	RDBM TAG IN SW COR OF CONC SLAB 42FT N/O & 105FT E/O C/L INT 170TH ST W & (FUTURE) AVE A-8	L 4014
LANCASTER (WEST ( 2012 )	2,622.251 799.265	CS MON IN WELL 1.4FT DN @ C/L INT 170TH ST W & (FUTURE) AVE A-8 MKD (1/4 COR 2,1,T8N,R15W)	L 4015
LANCASTER (WEST ( 2012 )	2,668.095 813.238	CSBM MON 4IN UP 80FT S/O & 39FT E C/L INT 170TH ST W & (FUT) AVE C MKD (BM 117-36B 1972 RE 7078) MKR POST 2FT W/O MON (NR C/L PROD DIRT RD W)	L 4018
LANCASTER (WEST ( 2012 )	2,562.799 781.143	2IN IP W/CONC PLUG & CE TAG 4IN UP 49FT N/O & 49FT E/O C/L INT 140TH ST W & (FUT) AVE C-8 MKR POST 1FT W/O MON	L 4021
LANCASTER (WEST ( 2012 )	2,554.566 778.634	CS BR CAP MON FLUSH 44FT S/O & 46FT W/O C/L INT 140TH ST W & (FUT) AVE C MKD (FAIRMONT BUTTE RM 2 1970 RE 5869) MKR POST 2FT E/O MON	L 4022
LANCASTER (WEST ( 2012 )	2,556.555 779.240	RDBM TAG IN NE COR CONC PAD OF IRRIGATION PUMP SHED 69FT E/O C/L 140TH ST W & 56FT S/O C/L AVE B 25FT ELY/O PP (NO#)	L 4026
LANCASTER (WEST ( 2012 )	3,051.831 930.201	RDBM MON IN WELL 55.8FT S/O & 36FT W/O C/L INT THREE POINTS RD & LANCASTER RD MKD (1973) MKR POST 1.3FT E/O MON	L 4028
LANCASTER (WEST ( 2012 )	3,126.571 952.982	CSBM MON 25FT E/O C/L THREE POINTS RD & 0.4MI S/O LANCASTER RD 2FT E/O PP (#1200393E) MKD (BM 111-6 1960 RE 5869)	L 4029
LANCASTER (WEST ( 2012 )	3,135.794 955.793	CSBM MON 25FT W/O C/L THREE POINTS RD & 0.9MI S/O LANCASTER RD 2FT W/O GUY POLE (NO#) N/O DIRT RD TO #48601 MKD (BM 111-60 1960 RE 5869)	L 4030
LANCASTER (WEST ( 2012 )	3,208.796 978.044	RDBM MON 26FT E/O C/L THREE POINTS RD & 1.5MI S/O LANCASTER RD 3.3FT W/O PP (NO #) MKD (BM 111-59 1960 RE 5869) MKR POST 2FT W/O MON	L 4031
LANCASTER (WEST ( 2012 )	3,278.652 999.336	CSBM MON 23FT W/O C/L THREE POINTS RD & 2MI S/O LANCASTER RD 2FT W/O PP #1938415E MKD (BM 111 -58 1960 RE 5869)	L 4032

QUAD YEAR	ELEV FOOT/METER	DESCRIPTION	BM NUMBER
LANCASTER (WEST ( 2012 )	3,345.205 1,019.622	CSBM MON 41FT W/O C/L THREE POINTS RD & 2.5MI S/O LANCASTER RD 3.3FT N/O PP #1938408E MKD (BM 111- 57 1960 RE 5869) MKR POST 2FT N/O MON	L 4033
LANCASTER (WEST ( 2012 )	3,555.152 1,083.614	RDBM MON IN WELL 20FT N/O C/L PINE CYN RD & 0.4MI W/O THREE POINTS RD 5FT W/O PP #2227471E MKD MKD (1973) 2FT N/O MON	L 4038
LANCASTER (WEST ( 2012 )	3,813.926 1,162.488	RDBM MON IN WELL 30FT N/O C/L PINE CYN RD & 23FT E/O C/L DRWY TO #28765 (ROYAL OAKS) 2MI W/O THREE POINTS RD 398FT W/O MI MKR #11.66 MKD (1973) MKR POST 2FT S/O MON	L 4041
LANCASTER (WEST ( 2012 )	2,531.074 771.474	RDBM MON IN WELL 0.7FT DN 10FT E/O PP #1443367E 46FT N/O AVE D & 157FT W/O 125TH ST W MKD (1961) MKR POST 1FT N/O MON	L 4042
LANCASTER (WEST ( 2012 )	2,974.010 906.481	STATE CALIF DWR MON IN N CB CALIF AQUEDUCT 21FT W/O E END CB 23FT N/O C/L AVE D & 390FT E/O C/L 245TH ST W MKD (3136A 1971)	L 4045
LANCASTER (WEST ( 2012 )	2,974.333 906.579	BOLT IN S CB OF CALIF AQUADUCT 24FT E/O W END CB 23FT S/O C/L AVE D & 302FT E/O C/L 245TH ST W	L 4046
LANCASTER (WEST ( 2012 )	2,906.218 885.818	LACS MON 4IN UP 95FT N/O & 42FT E/O C/L INT 210TH ST W & LANCASTER RD MKD (NEENACH SCHOOL O-14 RM1 1970) MKR POST 2FT W/O MON	L 4047
LANCASTER (WEST ( 2012 )	2,863.918 872.925	RDBM TAG 1FT N/O ANGLE PT @ S END HDWL 21FT N/O C/L LANCASTER RD & 528FT E/O C/L 185TH ST W NR E P/L HSE #18303	L 4049
LANCASTER (WEST ( 2012 )	2,521.151 768.449	USC&GS MON FLUSH 4FT E/O PP #4521529E 28FT N/O C/L AVE I & 315FT E/O C/L 115TH ST W MKD (B 1220 1971) MKR POST 2FT E/O MON	L 4052
LANCASTER (WEST ( 2012 )	3,835.113 1,168.946	RDBM MON IN WELL 23FT N/O C/L PINE CYN RD & 2.9MI W/O THREE POINTS RD MKD (1973) MKR POST 2FT S/O MON ON E SIDE OF PACIFIC CREST TRAIL	L 4058
LANCASTER (WEST ( 2012 )	3,970.172 1,210.112	RDBM MON IN WELL 26FT N/O C/L PINE CYN RD & 3.7MI W/O THREE POINTS RD 26FT E/O C/L DIRT RD TO CAMP GR HORSE TAIL MKD (1973) MKR POST 2FT S/O MON 240M(780FT) W/O MI MRK #13.60	L 4060
LANCASTER (WEST ( 2012 )	3,969.398 1,209.876	RDBM MON IN WELL 26FT S/O C/L PINE CYN RD & 3.7MI W/O THREE POINTS RD 20FT W/O DIRT RD TO CAMP GR HORSE TRAIL MKD (1973) MKR POST 3.3FT N/O MON 20FT W/O PP#2383263E	L 4061
LANCASTER (WEST ( 2012 )	3,773.177 1,150.068	RDBM MON IN WELL 20' S/O C/L PINE CYN RD & 5MI W/O THREE POINTS RD 10' S/O 1M DIA OAK TREE MKD (1963) MKR POST 2' N/O MON	L 4064
LANCASTER (WEST ( 2012 )	3,588.085 1,093.652	RDBM MON IN WELL 36FT N/O C/L PINE CYN RD & 5.8MI W/O THREE POINTS RD 20FT S/O PP #1185314E MKD (1973) MKR POST 2FT S/O MON	L 4066
LANCASTER (WEST ( 2012 )	3,566.591 1,087.100	RDBM MON IN WELL 25FT S/O C/L PINE CYN RD & 6.2MI W/O THREE POINTS RD 36FT SE/O MI MKR #15.91 79FT E/O PP #1185324E MKD (1973) MKR 2FT N/O MON	L 4067
LANCASTER (WEST ( 2012 )	3,749.445 1,142.834	RDBM MON IN WELL 30FT W/O C/L PINE CYN RD & 7MI W/O THREE POINTS RD MKD (1973) MKR 3.3FT E/O MON	L 4068

QUAD YEAR	ELEV FOOT/METER	DESCRIPTION	BM NUMBER
LANCASTER (WEST ( 2012 )	3,845.073 1,171.982	2IN IP W/RCE TAG #11467 FL 18FT W/O C/L PINE CYN RD & 7.5MI W/O THREE POINTS RD 25FT S/O SE COR BARN 2FT SE/O IP FENCE COR MKD (LINE)	L 4069
LANCASTER (WEST ( 2012 )	4,012.985 1,223.162	CSBM MON 4IN UP 25FT W/O C/L OLD RIDGE RTE RD & 20FT S/O C/L PINE CYN RD MKD (BM 208-9 1968) 6.6FT S/O STOP SIGN	L 4071
LANCASTER (WEST ( 2012 )	4,011.873 1,222.823	RDBM TAG IN CTR CONC HDWL OF C B #2.55 20FT W/O C/L OLD RIDGE RTE RD & 26FT N/O C/L PINE CYN RD	L 4072
LANCASTER (WEST ( 2012 )	3,935.420 1,199.520	USC&GS MON 75MM(3IN) UP 15M(49FT) N/O C/L OLD RIDGE RTE RD & 724M(0.4MI) N/O PINE CYN RD @ WLY TURN-OUT 3K(1.9MI) SELY OF LANCASTER RD MKD (D-370 1953)	L 4073
LANCASTER (WEST ( 2012 )	3,827.339 1,166.576	CSBM MON IN CONC HDWL MRK'D BM 208-6, 1968, 1.5' E/O W'LY END OF WALL, 21' N/O CL OLD RIDGE RTE RD & 1.5MI SE'LY LANCASTER RD, MM #1.48	L 4075
LANCASTER (WEST ( 2012 )	3,788.593 1,154.767	CS MON FL 28FT E/O C/L OLD RIDGE RTE RD & 1.4MI SE/O LANCASTER RD NR SLY END TURN OUT MKD (LA LIEBRE RANCH E-15 1971 RE 7078) MKR POST 3.3FT W/O MON	L 4076
LANCASTER (WEST ( 2012 )	3,772.125 1,149.747	CSBM MON 0.5FT DN 33FT N/O C/L OLD RIDGE RTE RD & 1.4MI SLY OF LANCASTER RD MKD (BM 208-5 1968 RE 5869) MKR POST 2FT E/O MON	L 4077
LANCASTER (WEST ( 2012 )	3,671.304 1,119.017	CSBM MON FL 59FT S/O C/L OLD RIDGE RTE RD & 1MI SELY LANCASTER RD 13FT ELY/O 5FT DIA OAK TREE MKD (BM 208-4 1968) MKR POST 2FT N/O MON	L 4090
LANCASTER (WEST ( 2012 )	3,596.479 1,096.210	USC&GS MON 0.7FT UP 54FT S/O C/L OLD RIDGE RTE RD & 0.7MI SELY OF LANCASTER RD MKD (X-53 1926) SURVEY MKR 1FT S/O MON	L 4091
LANCASTER (WEST ( 2012 )	3,512.998 1,070.765	CSBM MON NR E END CONC HDWL #0.70 23FT S/O OLD RIDGE ROUTE ROAD & 0.5MI SELY OF LANCASTER RD MKD (BM 208-2 1968 RE 5869)	L 4092
LANCASTER (WEST ( 2012 )	2,955.803 900.931	CSBM MON 0.4FT UP 35FT N/O C/L LANCASTER RD & 530FT E/O 229TH ST W (DIRT) MKD (BM 102-54A 1972) MKR POST 2FT S/O MON	L 4095
LANCASTER (WEST ( 2012 )	2,969.791 905.195	SPK&L 2FT W/O E END CONC CB OF BRIDGE OVER CALIF AQUEDUCT 16FT S/O C/L LANCASTER RD & 213FT W/O C/L 235TH ST W	L 4096
LANCASTER (WEST ( 2012 )	2,970.379 905.374	STATE OF CALIF DWR MON 1.5FT W/O E END CONC WK 249FT W/O C/L 235TH ST W & 16.4FT N/O C/L LANCASTER RD MKD (3149-A 1971)	L 4097
LANCASTER (WEST ( 2012 )	3,008.636 917.035	CSBM MON FLUSH 46FT W C/L (LANCASTER RD) 245TH ST W & 0.4MI S/O AVE D NR MI MKR #26.66 NR MOC MKD (BM 102-57A 1972) MKR POST 2FT E/O MON	L 4098
LANCASTER (WEST ( 2012 )	3,024.496 921.869	RDBM TAG IN CTR CONC HDWL 23FT S/O C/L LANCASTER RD & 36FT E/O C/L 290TH ST W (DIRT) @ DIRT DRWY TO HSE #29300	L 4102
LANCASTER (WEST ( 2012 )	3,047.248 928.804	RDBM TAG IN CTR OF CONC HDWL 22FT S/O C/L LANCASTER RD & 135FT W/O C/L 300TH ST W	L 4103
LANCASTER (WEST ( 2012 )	3,171.976 966.821	RDBM TAG IN NE COR CONC HDWL OF CULV 22FT S/O C/L LANCASTER RD & 2.4MI E/O OLD RIDGE RTE RD	L 4105
LANCASTER (WEST ( 2012 )	3,290.649 1,002.993	RDBM TAG IN CTR CONC HDWL #A-75+78 22FT N/O C/L LANCASTER RD & 1.3MI E/O OLD RIDGE RTE RD 105FT E/O PP #1061984E	L 4106

QUAD YEAR	ELEV FOOT/METER	DESCRIPTION	BM NUMBER
LANCASTER (WEST ( 2012 )	3,411.254 1,039.753	USC&GS MON IN E END OF CONC HDWL BRIDGE #53-5 23FT N/O C/L LANCASTER RD & 0.3MI E/O OLD RIDGE RTE RD MKD (H 1044 1960)	L 4107
LANCASTER (WEST ( 2012 )	3,331.063 1,015.311	DWR MON 0.5FT UP 141FT S/O C/L LANCASTER RD & 0.6MI W/O OLD RIDGE RTE RD 174FT W/O DIRT DR TO #34710 MKD (ORP-7 1968) MKR POST 3.3FT S/O MON	L 4110
LANCASTER (WEST ( 2012 )	3,333.891 1,016.173	DWR MON 0.5FT UP 39.4FT N/O C/L LANCASTER RD & 1.9MI W/O OLD RIDGE RTE RD 108FT W/O AC DR TO STATE OF CAL PROP 16.4FT NW/O PP #1061900E MKD (OC W2 1968) SUR MKR 0.7FT W/O MON	L 4114
LANCASTER (WEST ( 2012 )	3,333.465 1,016.043	USC&GS MON FLUSH 42.5FT N/O C/L (N BBL) LANCASTER RD 2.2MI W/O OLD RIDGE RTE RD 49FT W/O PP ( #4053152E) MKD (Z 973 1964 RESET 1965) MKR POST 1FT E/O MON	L 4115
LANCASTER (WEST ( 2012 )	3,332.366 1,015.708	USC&GS MON FL 77FT N/O C/L LANCASTER RD (N BBL) & 2.2MI W/O OLD RIDGE RTE RD 105FT E/O PP #1061891E MKD (X-973 1964 RESET 1965) MKR SIGN 1.5FT E/O MON	L 4116
LANCASTER (WEST ( 2012 )	3,332.144 1,015.641	USC&GS MON 0.5FT UP 88FT N/O C/L LANCASTER (N BBL) RD & 2.3MI W/O OLD RIDGE RTE RD 62FT W/O PP # 1061891E MKD (W 973 1964 RESET 1965) MKR SIGN 2FT W/O MON	L 4117
LANCASTER (WEST ( 2012 )	3,329.012 1,014.686	USC&GS MON FL 95FT N/O C/L LANCASTER RD (N BBL) & 2.3MI W/O OLD RIDGE RTE RD 3.3FT W/O PP #1061890E MKD (V 973-1964 RESET 1965) MKR SIGN 1.5FT W/O MON	L 4118
LANCASTER (WEST ( 2012 )	3,506.406 1,068.756	CSBM MON 4IN UP 36FT N/O C/L GORMAN POST RD & 0.8MI W/O LANCASTER RD MKD (BM 102-88A 1968) MKR POST 2FT S/O MON	L 4119
LANCASTER (WEST ( 2012 )	3,649.583 1,112.396	USC&GS MON. 39.5' N/O GORMAN POST RD. & 1.2MI E/O GORMAN SCHOOL RD, 16.5' NE'LY/O PP(NO#), MRK'D E 452,1953, @ FENCE COR, MRK'R SIGN 1' W/O MON	L 4121
LANCASTER (WEST ( 2012 )	3,751.120 1,143.345	RDBM TAG IN CONC WALL OF DROP INLET #4.45 16.4FT N/O C/L GORMAN POST RD & 0.5MI E/O GORMAN SCHOOL RD 16.4FT W/O PP #1699131E	L 4122
LANCASTER (WEST ( 2012 )	3,785.636 1,153.865	USC&GS MON 1.8FT UP 88FT N/O C/L GORMAN POST RD & 0.3MI E/O GORMAN SCHOOL RD 13FT SWLY/O PP (NO#) INSIDE DPW MAINTENANCE YD S END MKD (Z 368 1953)	L 4123
LANCASTER (WEST ( 2012 )	3,909.920 1,191.747	USC&GS MON IN CONC HDWL #2.50 1FT E/O W END 48FT S/O C/L PEACE VALLEY RD & 0.5MI W/O GORMAN SCHOOL RD MKD (N 1219 1971)	L 4126
BASELINE ( 2010 )	3,421.206 1,042.787	RD BM TAG IN E CB @ BCR NE COR JOHNSON RD & LEADHILL DR 51FT N/O & 16FT E/O C/L INT	L 4196
BASELINE ( 2010 )	3,480.940 1,060.994	RDBM TAG IN E CB NR BCR NE COR JOHNSON RD & LEADHILL DR 46FT N/O & 20FT E/O C/L INT	L 4197
BASELINE ( 2010 )	2,679.144 816.606	RDBM MON IN WELL DN 0.5FT 49.2FT N/O & 60FT E/O C/L INT AVE K & 110TH ST W MKD (BM 1974) MKR POST 2FT S/O MON	L 4358
LANCASTER (WEST ( 2012 )	4,183.855 1,275.243	LACO ENG'R BM MON IN S'LY END CONC HDWL, 52.5' E'LY & 1.6MI S/O CL INT PEACE VALLEY RD & FRAZIER MTN PARK RD @MM 1.56, MRK'D BM 107-106 RE5869	L 4363



QUAD YEAR	ELEV FOOT/METER	DESCRIPTION	BM NUMBER
LANCASTER (WEST ( 2012 )	4,098.862 1,249.337	CSBM MON IN SLY CONC HDWL 2FT E/O C/L W END 52.5FT ELY/O C/L PEACE VALLEY RD 1.6MI S/O FRAZIER MTN PARK RD @ MI MKR #1.56	L 4364
BASELINE ( 2010 )	2,496.532 760.945	2IN IP W/CONC PLUG & CS TAG FL @ SE COR AVE G & 110TH ST W 49.2FT S/O & 49.2FT E/O C/L INT	L 4370
BASELINE ( 2010 )	2,788.225 849.854	CALIF DIV OF HWY MON 4IN UP 52.5FT W C/L 110TH ST W & 0.3M) S/O AVE K MKD (DEL SUR G10 1972) MKR POSTS 3.3FT N/O MON & 3.9FT S/O MON	L 4418
BASELINE ( 2010 )	2,587.850 788.779	CSBM MON 4IN UP 64FT S/O & 59.1FT W/O C/L INT 110TH ST W & AVE J-8 MKD (119-26A 1972) MKR POST 1FT E/O MON	L 4419
BASELINE ( 2010 )	2,507.850 764.395	CSBM MON FL 55.8FT E/O C/L 110TH ST W & 348FT S/O AVE I-8 MKD (119-24A 1972) MKR POST 2FT E MON	L 4420
BASELINE ( 2010 )	2,491.095 759.288	1.5IN IP W/CONC PLUG & BR 0.5FT DN 52.5FT W C/L INT 110TH ST W & AVE F-8 20.8M SWLY/O PP #1222583 MKR POST 9.8FT S/O MON (USE NW EDGE)	L 4421
BASELINE ( 2010 )	2,488.546 758.511	CS MON IN WELL 0.8FT DN @ C/L INT 110TH ST W & AVE D-8 MKD (1/4 COR 23,24,T8N,R14W,RE 7078)	L 4422
BASELINE ( 2010 )	2,488.052 758.361	RDBM MON IN WELL 0.3FT DN 170.6FT N/O & 41FT W/O C/L INT 110TH ST W & AVE B-8 6.6FT W/O PP #1222691 MKD (1974) MKR POST 2FT W/O MON	L 4423
LANCASTER (WEST ( 2012 )	2,907.493 886.207	CS MON IN WELL @ C/L 210TH ST W & 49FT N/O C/L LANCASTER RD MKD (19,20,30,29,R15W,T8N,RE 2177)	L 4600
LANCASTER (WEST ( 2012 )	3,289.014 1,002.494	L&T IN CONC WALL W SIDE OF DRWY TO HSE #15003 ELIZABETH LAKE RD 30.8FT N/O C/L & 361FT SELY/O C/L INT HUNGRY JACK RD	L 4709
LANCASTER (WEST ( 2012 )	2,799.504 853.291	RDBM MON FLUSH 49.2FT NW/O C/L MUNZ RANCH RD & 2.1MI N/O ELIZABETH LAKE RD 250FT NE/O MI MKR #2.30 MKR POST 2FT E/O MON	L 4713
LANCASTER (WEST ( 2012 )	2,741.433 835.591	CSBM MON FLUSH 35FT W/O C/L MUNZ RANCH RD & 2.5MI N/O ELIZABETH LAKE RD & 5FT N/O PP #294508E MKD (BM 113-5A 1976 RE 22726) MKR 2FT E/O MON	L 4714
LANCASTER (WEST ( 2012 )	2,558.269 779.763	RDBM TAG @ S END HDWL 25FT N/O C/L DIRT DR TO HSE #45740 MUNZ RANCH RD 28FT E/O C/L & 440FT S C/L LANCASTER RD MKD (BM)	L 4715
LANCASTER (WEST ( 2012 )	3,309.005 1,008.588	CSBM MON IN W END HDWL NR MI MKR #18.13 18FT N/O C/L ELIZABETH LAKE RD & 0.65MI W/O MUNZ RANCH MKD (BM 111-33B 1972 RE 7078)	L 4716
LANCASTER (WEST ( 2012 )	3,243.273 988.553	USC&GS MON @ S END OF E WING WALL @ MILE MKR #19.99 29.5FT S/O C/L ELIZABETH LAKE RD & 39.4FT E/O C/L MOUNTAIN VIEW RD MKD (R 975 RESET 1967)	L 4718
LANCASTER (WEST ( 2012 )	3,243.339 988.573	LACE TAG IN NW COR WALK ON BRIDGE #1686 @ MI MKR #19.99 19.6FT N/O C/L ELIZABETH LAKE RD & 25FT E/O C/L INT MOUNTAIN VIEW RD	L 4719
LANCASTER (WEST ( 2012 )	3,245.170 989.131	CS MON IN WELL 1FT DN @ OR NEAR C/L INT LAKE HUGHS RD & ELIZABETH LAKE RD MKD (RE 5869)	L 4721

QUAD YEAR	ELEV FOOT/METER	DESCRIPTION	BM NUMBER
LANCASTER (WEST ( 2012 )	2,785.753 849.100	CALIF DIV OF HWYS MON 1FT DN 36FT E/O C/L LANCASTER RD (167TH ST W) & 394FT S/O C/L PROD AVE F-8 22.87FT S/O PP #1955042E MKD (BM 2786 RM 2 1972) MKR POST 2.5FT S/O MON	L 4725
LANCASTER (WEST ( 2012 )	2,874.916 876.277	L&T IN E END OF HDWL 23FT S/O CTR OF TRAVELED LANCASTER RD (CURVE) & 115FT W/O C/L PROD 190TH ST W NR C/L PROD AVE F	L 4726
LANCASTER (WEST ( 2012 )	2,873.813 875.941	L&T IN E END OF HDWL 36FT N/O CTR OF TRAVELED LANCASTER RD (CURVE) & 74FT W/O C/L PROD 190TH ST W 53FT N/O C/L PROD AVE F	L 4727
LANCASTER (WEST ( 2012 )	2,524.273 769.401	CS MON IN WELL 1.2FT DN @ C/L INT AVE A & (FUT) 125TH ST W MKD (1/4 COR 34,3,T8N,T9N,R14W)	L 4728
LANCASTER (WEST ( 2012 )	2,611.140 795.878	CS MON IN WELL 1.1FT DN @ C/L INT FUT 165TH ST W & AVE A MKD (1/4 SEC 36,1,T8N,T9N,R15W,RE 5869)	L 4732
LANCASTER (WEST ( 2012 )	2,550.574 777.417	L & DPW TAG IN N EDGE CONC AROUND WATER M H 29.5FT W/O & 49.2FT S/O C/L 140TH ST W & AVE B-8	L 4735
LANCASTER (WEST ( 2012 )	2,554.937 778.747	CS MON IN WELL 1.7FT DN @ C/L INT AVE B & 140TH ST W MKD (SEC 5,4,8,9,T8N,R14W)	L 4736
LANCASTER (WEST ( 2012 )	2,759.833 841.200	CS MON FLUSH 49FT S/O & 62FT W/O C/L INT TRAVELED ROADWAYS 170TH ST W & AVE E-8 (DIRT RD) MKD (FAIRMONT BUTTE RM-1 I 15 1971 RE 5869)	L 4739
LANCASTER (WEST ( 2012 )	2,759.594 841.127	CS MON FLUSH 49FT N/O & 62FT W/O C/L TRAV ROADWAYS 170TH ST W & AVE E-8 (DIRT ROAD) MKD (FAIRMONT BUTTE I 15,RM 2,1971,RE 5869) MKR 2FT N/O MON	L 4740
LANCASTER (WEST ( 2012 )	2,682.617 817.664	CSBM MON FL 56FT E/O C/L 170TH ST W (TRAVELED) & 146FT N/O AVE C-8 (FUT) MKD (BM 117-37A RE 22726 1976) MKR POST 2FT SW/O MON	L 4743
LANCASTER (WEST ( 2012 )	3,381.705 1,030.747	RDBM MON 42.7FT N/O C/L LANCASTER RD & 197FT E/O C/L INT OLD RIDGE RTE RD 5FT N/O PP #1061954E MKD (1981)	L 4747
LANCASTER (WEST ( 2012 )	3,380.731 1,030.450	RDBM TAG IN CTR OF CONC HDWL TO CULV 56FT S/O C/L LANCASTER RD & 56FT E/O C/L OLD RIDGE RTE RD (FROM MC OF CURVE) 105FT W/O GUY POLE #1061955E	L 4748
LANCASTER (WEST ( 2012 )	3,977.966 1,212.488	RDBM TAG IN TOP OF STONE & MORTAR GATE COR POST 3.3FT UP ON W SIDE OF DRWY TO HSE #28963 PINE CYN RD 20FT N/O C/L & 2.5MI W/O THREE POINTS RD	L 4749
LANCASTER (WEST ( 2012 )	3,333.055 1,015.918	RDBM TAG IN W CB 2FT S/O W END IN W MOST ENT TO HSE #68 CIRCLE K RANCH 54FT S C/L LANCASTER RD & 1.1MI W/O OLD RIDGE RTE RD	L 4750
LANCASTER (WEST ( 2012 )	3,325.739 1,013.688	RDBM TAG IN CTR OF HDWL #108+17 37FT S/O C/L LANCASTER RD & 1.3MI W/O OLD RIDGE RTE RD	L 4751
BASELINE ( 2010 )	3,330.702 1,015.201	DPW BM TAG IN E END CONC WALK (2FT FROM END) @ SW COR ELIZABETH LAKE RD & JOHNSON RD 72FT W/O & 58FT S/O C/L INT	L 4934
BASELINE ( 2010 )	3,067.559 934.995	CS BR CAP IN SE END CONC WINGWALL CULV #11.47 30' S/O C/L JOHNSON RD & 1.7MI E/O LIMERIDGE DR MKD (BM 119-30A 1976) IP MKR 2' E/O MON	L 4935

QUAD YEAR	ELEV FOOT/METER	DESCRIPTION	BM NUMBER
BASELINE (2010)	2,856.772 870.747	DPW BM TAG IN WELL 32.8FT SE/O C/L MOC JOHNSON RD & 110TH ST W 30.8FT W/O C/L PROD #2109688E MKD (BM 1990) IP MKR 3.3FT W MON	L 4936
BASELINE (2010)	3,324.484 1,013.306	L&T IN S END CONC HDWL 15' E/O C/L ELIZABETH LAKE RD & 330' S/O C/L JOHNSON RD	L 5591
BASELINE (2010)	3,478.378 1,060.213	LACO BM TAG IN E END CONC HDWL 15' N/O C/L JOHNSON RD & 105' E/O C/L DRWY TO HSE #12601 @ MI MKR #12.54	L 5592
BASELINE (2010)	2,951.884 899.737	CSBM MON IN SLY END CONC HDWL 63' N/O C/L JOHNSON RD & 20' W/O C/L ENT TO AQUEDUCT 0.4MI W/O 110TH ST W	L 5593
BASELINE (2010)	2,918.262 889.489	DWR MON DN 8" 30' SLY C/L JOHNSON RD & 0.3MI W/O 110TH ST W 56' S/O PP #2109682E MKD (M3-159 1968) MKR PIPE 1' N/O MON	L 5594
BASELINE (2010)	2,490.447 759.091	2IN IP W/CONC PLUG & DPW BM TAG @ SW COR AVE A & 110TH ST W 52.5FT S/O & 37.7FT W/O C/L INT 5FT W/O PP #1222730	L 5652
BASELINE (2010)	2,491.700 759.472	DPW BM TAG IN TOP OF 3.3FT CONC IRRIGATION VALVE N SIDE 3.6FT UP @ SE COR 110TH ST W & AVE B 57.7FT S/O & 61FT E/O C/L INT	L 5653
BASELINE (2010)	2,499.650 761.896	CSBM MON FL @ SW COR 110TH ST W & AVE G 139.4FT S & 29.5FT W/O C/L INT MKD (119-20 1961 RE 5869) 48.9FT S/O PP#1222569, 1' E/O MKR POST	L 5654
BASELINE (2010)	2,503.151 762.963	CS MON FL IN CONC PAD 42.7FT W/O C/L 110TH ST W & 581FT S/O AVE G-8 105FT S/O PP #1222554 MKD (DEL SUR G 4A 1968 RE 5869) MKR 5.2FT E/O MON	L 5655
BASELINE (2010)	2,500.850 762.261	2IN IP W/CONC PLUG & DPW BM TAG @ SW COR AVE H & 110TH ST W 41F S/O & 41.7FT W/O C/L INT 4.9FT W/O PP #1222543	L 5657
BASELINE (2010)	2,685.902 818.665	DPW BM TAG IN NW COR CONC GTE PAD @ SE COR AVE K & 110TH ST W 128FT E & 38.4FT S/O C/L INT	L 5660
BASELINE (2010)	2,785.589 849.050	CAL DIV HWY MON FL 0.3M S/O AVE K & 26.2FT E/O C/L 110TH ST W MKD (DEL SUR G 10 RM 1 1972) MKR POST 2FT S/O MON	L 5661
BASELINE (2010)	2,501.435 762.440	2IN IP W/CONC PLUG & DPW TAG 1IN UP 2FT N/O PP #2175728E @ NE COR AVE I & 110TH ST W 47.2FT E/O & 27.6FT N/O C/L INT	L 5789
LANCASTER (WEST (2012)	3,289.753 1,002.720	L&T IN N WINGWALL 1.5FT FROM END @ SE COR ELIZABETH LAKE RD & RANCH CLUB RD 70.5FT S/O & 36FT E/O C/L INT	L 5973
LANCASTER (WEST (2012)	3,290.990 1,003.097	DPW BM TAG IN SE COR OF CONC DRWY APRON TO HSE #15031 ELIZABETH LAKE RD 19.6FT N/O C/L & 110FT E/O C/L HUNGRY JACK DR	L 5974
LANCASTER (WEST (2012)	2,944.111 897.368	USC&GS BM MON @ W END SLY HDWL 19.7FT N/O C/L ACCESS RD CALIF AQUEDUCT & 108FT E/O C/L MUNZ RANCH RD MKD (T 1221 1971) 1.6MI N/O ELIZABETH LAKE RD	L 5976
LANCASTER (WEST (2012)	2,943.214 897.094	DPW BM TAG IN W END NLY HDWL 19.7FT N/O C/L ACCESS RD CALIF AQUEDUCT & 108FT E/O C/L MUNZ RANCH RD 1.6MI N/O ELIZABETH LAKE RD	L 5977

QUAD YEAR	ELEV FOOT/METER	DESCRIPTION	BM NUMBER
LANCASTER (WEST ( 2012 )	2,753.751 839.346	2IN IP W/CONC PLUG & DPW BM TAG 4.5FT E/O GUY POLE 30FT N/O C/L LANCASTER RD & 2.9MI W/O MUNZ RANCH RD 16FT E/O C/L DIRT RD TO N	L 5979
LANCASTER (WEST ( 2012 )	2,828.518 862.135	2"IP W/DPW BM TAG, 25' S. & 92' E/O CL INT LANCASTER RD & 160TH ST W.	L 5980
LANCASTER (WEST ( 2012 )	2,832.132 863.236	CS MON 1FT DN 20FT W/O C/L 160TH ST W & 2FT N/O WLY PROD LANCASTER RD MKD (1/4 COR 1,6,T7N,R14W,RE 2177) 3IN MKR POST (IN CONC FOOTING) 1FT W/O MON	L 5981
LANCASTER (WEST ( 2012 )	2,788.641 849.980	2IN IP W/CONC PLUG & DPW BM TAG 3.3FT W/O PP (#1491135E) 528FT W/O 160TH ST W PROD & 26.2FT NLY C/L LANCASTER BLVD	L 5982
LANCASTER (WEST ( 2012 )	2,803.562 854.528	CAL DIV OF HWY BM MON 24' N & 528' E/O CL INT LANCASTER RD & 167TH ST W., 46' E/O PP#1560350E, 2' N/O MKR POST	L 5983
LANCASTER (WEST ( 2012 )	2,736.897 834.209	2IN IP W/CONC PLUG & DPW BM TAG FLUSH 3' N/O ARROW (HWY SIGN )MKR @ SE COR 170TH ST W & AVE E 39FT E/O & 3.3FT S/O C/L INT	L 5985
LANCASTER (WEST ( 2012 )	2,692.698 820.737	CSBM MON 6.5FT NW/O PP #1312398E @ NW COR AVE D & 170TH ST W 33FT N/O & 157FT W/O C/L INT MKD ( BM 117 -38B 1972 RE 7078)	L 5987
LANCASTER (WEST ( 2012 )	2,897.255 883.086	DPW BM TAG IN NW COR CONC MAIL BOX PAD 33FT E/O C/L PROD 190TH ST W & 51FT N/O C/L PROD AVE F-8 (LANCASTER RD)	L 5989
LANCASTER (WEST ( 2012 )	2,905.201 885.508	2IN IP W/CONC PLUG & DPW BM TAG FLUSH 49FT N/O C/L LANCASTER RD (AVE E-15) & 0.5MI W/O 190TH ST W MKR POST 2FT N/O MON	L 5990
LANCASTER (WEST ( 2012 )	2,952.614 899.959	2IN IP W/CONC PLUG & DPW BM TAG FLUSH 85FT N/O C/L LANCASTER RD (AVE E-15) & 14FT W/O C/L 200TH ST W (DIRT RD) 5FT N/O ST CALIF P/L BNDRY SIGN	L 5991
LANCASTER (WEST ( 2012 )	2,957.034 901.307	CS MON 174FT S/O C/L LANCASTER RD (AVE E-15) & 75.5FT W/O C/L PROD 200TH ST W MKD (SEC COR 29 ,28,33,32,R15W,T8N,RE 7078) TWO MKR POST 2FT W/O & 2FT E/O MON	L 5992
LANCASTER (WEST ( 2012 )	2,886.437 879.789	2IN IP W/CONC PLUG & DPW BM TAG FLUSH 42.7FT N/O C/L LANCASTER RD (AVE D-15) 0.6MI W/O 210TH ST W 0.2MI E/O 224TH ST W MKR POST 1FT N/O MON	L 5993
LANCASTER (WEST ( 2012 )	3,016.980 919.578	2IN IP W/CONC PLUG & DPW BM TAG FLUSH 24.3FT SW OF C/L LANCASTER RD & 0.5MI W/O 235TH ST W 190FT W/O BC OF CURVE FROM E MKR POST 2FT W/O MON	L 5994
LANCASTER (WEST ( 2012 )	2,505.832 763.780	CAL-TRANS BR DISK MON IN CONC PAD FL @ SW COR AVE D & 115TH ST W (DIRT) 92FT S/O & 135FT W/O C/L INT MKD (VOLT NO.2 1983) MKR POST 2.3FT SW/O MON	L 5995
LANCASTER (WEST ( 2012 )	2,517.691 767.395	2IN IP W/DPW BM TAG 3.3FT E/O PP #2287951E @ NE COR AVE D & (FUT) 120TH ST W 42.6FT N/O & 102FT E/O C/L INT 49FT W/O DIRT RD FOR EDISON TOWERS	L 5996
LANCASTER (WEST ( 2012 )	2,567.487 782.572	2IN IP W/DPW BM TAG 3.3FT E/O PP #2287946E @ NE COR AVE D & (FUT) 135TH ST W 44FT N/O & 38FT E/O C/L INT	L 5997

QUAD YEAR	ELEV FOOT/METER	DESCRIPTION	BM NUMBER
LANCASTER (WEST ( 2012 )	2,580.630 786.578	DPW BM TAG IN SW COR OF CONC TELE VAULT @ SW COR AVE D & 140TH ST W 36FT W/O & 84FT S/O C/L INT	L 5998
LANCASTER (WEST ( 2012 )	2,619.999 798.578	2IN IP W/SPK&W @ SW COR AVE D & 150TH ST W 82FT S/O & 169FT W/O C/L INT MKD (CAL-TRANS 150D) MKR POST 2FT NE/O MON	L 5999
LANCASTER (WEST ( 2012 )	2,647.425 806.938	2IN IP W/DPW BM TAG FL 1.3FT S/O PP #1219170E @ NE COR AVE D & 160TH ST W 43FT N/O & 36FT E/O C/L INT	L 6000
LANCASTER (WEST ( 2012 )	2,716.318 827.936	CAL-TRANS MON FL 33FT N/O PP #1312387E @ NW COR AVE D & 175TH ST W 77FT N/O & 6.6FT W/O C/L INT MKD (FAIRMONT BUTTES H-12 RM 1 1972) MKR POST 2.6FT NW/O MON	L 6001
LANCASTER (WEST ( 2012 )	2,736.805 834.181	2IN IP W/DPW BM TAG FL 5FT S/O PP (#1115272E) @ SE COR AVE D & 180TH ST W 53FT E/O & 34.1FT S/O C/L INT	L 6002
LANCASTER (WEST ( 2012 )	2,757.268 840.418	DPW BM TAG IN SE COR CONC SIGN PAD @ SE COR AVE D & 185TH ST W 60FT S/O & 15FT E/O C/L INT	L 6003
LANCASTER (WEST ( 2012 )	2,756.086 840.058	2IN IP W/DPW BM TAG FL 6.6FT E/O PP #1312363E @ NW COR AVE D & 185TH ST W 46FT N/O & 13FT W/O C/L INT MKR POST 1.5FT N/O MON	L 6004
LANCASTER (WEST ( 2012 )	2,775.360 845.932	2IN IP W/DPW BM TAG FLUSH 3.3FT E/O PP #1871481E 2FT N/O C/L AVE D & 69FT E/O C/L 190TH ST W	L 6005
LANCASTER (WEST ( 2012 )	2,785.656 849.071	CAL-TRANS MON 0.3MI W/O 190TH ST W & 33FT S/O C/L AVE D MKD (FAIRMONT BUTTES D-13 1972) MKR POST 3.3FT E/O MON	L 6006
LANCASTER (WEST ( 2012 )	2,804.664 854.864	2IN IP W/DPW BM TAG FL 3.3FT E/O PP #1312328E @ NE COR AVE D & 200TH ST W 42.7FT N/O & 36FT E/O C/L INT	L 6008
LANCASTER (WEST ( 2012 )	2,859.103 871.457	2" IP W/ DPW BM TAG, SW COR 210TH ST W. & AVE D-8, 47.5' W. & 12' S/O CL INT	L 6015
LANCASTER (WEST ( 2012 )	2,566.197 782.179	DPW BM TAG IN E CB OF VAULT @ SW COR AVE A & 140TH ST W 59FT S/O & 72FT W/O C/L INT	L 6016
LANCASTER (WEST ( 2012 )	2,596.701 791.477	CSBM MON FL @ SW COR AVE A & 155TH ST W 85FT W/O & 369FT S/O C/L INT MKD (BM 117-29 RE 5869 1961) MKR POST 2FT E/O MON	L 6017
LANCASTER (WEST ( 2012 )	2,618.118 798.005	CS MON IN WELL 12" DN @ C/L INT AVE A & 170TH ST W MKD (SEC COR 35,36,2,1,T8N,R15W,RE 5869)	L 6018
LANCASTER (WEST ( 2012 )	2,559.990 780.287	DPW BM TAG IN CTR E CB AROUND WATER WELL(MARKED 7.5R) @ SE COR 140TH ST W & AVE A-8 45FT S/O & 75FT E C/L INT	L 6019
LANCASTER (WEST ( 2012 )	2,626.413 800.533	2IN IP W/DPW BM TAG FLUSH @ NW COR 170TH ST W & AVE B 38FT W/O & 28FT N/O C/L INT (TRAV RDS) 2FT E/O (NOT A THROUGH ST SIGN)	L 6021
LANCASTER (WEST ( 2012 )	3,023.589 921.593	DPW BM TAG IN E END HDWL 138FT E/O C/L BARNES RANCH RD & 21.3FT SLY/O LANCASTER RD (HWY 138)	L 6025
LANCASTER (WEST ( 2012 )	3,021.869 921.068	DPW BM TAG 5FT W/O E END HDWL 123FT E/O C/L BARNES RANCH RD & 36FT NLY/O C/L LANCASTER RD (HWY 138)	L 6026
LANCASTER (WEST ( 2012 )	3,035.951 925.361	DPW BM TAG IN SW COR CONC ELEC BOX SLAB @ NE COR 280TH ST W & LANCASTER RD (HWY 138) 115FT E/O & 141FT N/O C/L INT	L 6027

QUAD YEAR	ELEV FOOT/METER	DESCRIPTION	BM NUMBER
LANCASTER (WEST ( 2012 )	3,125.301 952.595	DPW BM TAG IN CONC CB FLUSH 3.3FT W/O E END 51FT S/O C/L LANCASTER RD (HWY 138) 25FT E/O N&S PP LINE 102FT S/O PP #1950487E	L 6028
LANCASTER (WEST ( 2012 )	3,381.720 1,030.751	DPW BM TAG IN CTR OF WINGWALL CULV 29.5FT S/O C/L LANCASTER RD (HWY 138) & 85FT E/O C/L GATE TO DIRT RD @ E SIDE OF BLDG #33628	L 6029
LANCASTER (WEST ( 2012 )	3,433.023 1,046.389	LACO BM TAG IN LOWER CONC PORCH SLAB @ BLDG # 26486 SW COR THREE POINTS RD & PINE CYN RD 49FT W/O & 36FT S/O C/L INT	L 6031
LANCASTER (WEST ( 2012 )	3,669.102 1,118.346	DPW BM TAG IN CONC FTG OF WIRE MESH FENCE POST 30FT SWLY OF C/L DRWY TO 31008 PINE CYN RD 97FT WLY/O C/L	L 6035
LANCASTER (WEST ( 2012 )	3,320.305 1,012.032	USC&GS MON FLUSH 28' S/O C/L GORMAN POST RD & 470F) E/O CONNECTOR RD WITH LANCASTER RD (HWY 138) MKD (S 973 1964) MKR SIGN 2FT W/O MON	L 6037
LANCASTER (WEST ( 2012 )	3,323.370 1,012.966	USC&GS MON FLUSH 28FT S/O C/L GORMAN POST RD & 305FT E/O CONNECTOR INT WITH LANCASTER RD (HWY 138) MKD (R 973 1964) MKR SIGN 2FT W/O MON	L 6038
LANCASTER (WEST ( 2012 )	3,326.453 1,013.906	USC&GS MON FLUSH 29.5FT S/O C/L GORMAN POST RD & 141FT E/O CONNECTOR INT WITH LANCASTER RD (HWY 138) MKD (Q 973 1964) MKR SIGN 2FT W/O MON	L 6039
LANCASTER (WEST ( 2012 )	3,329.594 1,014.863	USC&GS MON FLUSH @ SW COR OF CONNECTOR RD FROM LANCASTER RD (HWY 138) & GORMAN POST RD 29.5FT S/O & 38FT W/O C/L INT MKD (P 973 1964) MKR SIGN 2FT W/O MON	L 6040
LANCASTER (WEST ( 2012 )	3,656.361 1,114.462	CA DIV OF HWY MON, 39' N/O CL GORMAN POST RD & 1.2MI E/O GORMAN SCHOOL RD, MRK'D E-10, 1973, MIDDLE OF 3 MKR POST, 8.5' S/O PP(NO#)	L 6041
LANCASTER (WEST ( 2012 )	3,816.730 1,163.343	DPW TAG IN N.CURB, 41' E/O CL PROD GORMAN SCHOOL RD & 39.5' N/O GORMAN POST RD, 8' E/O FH	L 6042
LANCASTER (WEST ( 2012 )	3,819.130 1,164.074	DPW BM TAG IN W CB 31FT S/O BCR @ SW COR GORMAN POST RD & GORMAN SCHOOL RD 32.8FT W/O & 70FT S/O C/L INT	L 6043
LANCASTER (WEST ( 2012 )	4,183.879 1,275.250	CAL-TRANS MON IN NW COR OF BRIDGE OVER (5 FRWY) 14FT N/O C/L BRIDGE & 59FT ELY C/L PEACE VALLEY RD MKD (LA 05 PM 87.37 LS 4965 1992)	L 6044
LANCASTER (WEST ( 2012 )	3,992.145 1,216.809	DPW BM TAG IN N'LY EDGE OF CONC DROP INLET ON CL ISLAND PEACE VALLEY RD & 200' N/O CL FALCON WAY @MM 0.60	L 6045
LANCASTER (WEST ( 2012 )	3,926.828 1,196.901	CSBM DISK IN HDWL, 4.5' S/O N/END, 33' W/O PEACE VALLEY RD & 0.3MI S/O FRAZIER MTN PARK RD, NR MM#0.35, MRK'D 102-110, 1968	L 6046
LANCASTER (WEST ( 2012 )	3,837.686 1,169.730	DPW BM TAG IN WCURB, N/END OF CATCH BASIN, 4.6' S/O BCR @SW COR PEACE VALLEY RD & FRAZIER MTN PARK RD	L 6047
LANCASTER (WEST ( 2012 )	3,309.845 1,008.844	L&BM TAG IN CTR HDWL @ MI MRK 17.81 30FT N/O ELIZABETH LAKE RD & 0.4MI W/O MUNZ RANCH RD 35FT E/O PP#4576171E	L 6442
LANCASTER (WEST ( 2012 )	2,564.395 781.630	L & DPW TAG IN NE COR TELEPHONE VAULT 41FT W/O & 59FT N/O C/L INT 140TH ST W & AVE C-8	L 7000

QUAD YEAR	ELEV FOOT/METER	DESCRIPTION	BM NUMBER
LANCASTER (WEST ( 2012 )	2,551.040 777.559	L & DPW TAG E SIDE GUARD POST CONC BASE FOR VENT 50FT S/O & 67FT W/O C/L INT 140TH ST W & AVE B-8	L 7001
LANCASTER (WEST ( 2012 )	2,554.874 778.728	CS BR CAP MON 6IN UP 42.7FT S/O & 46FT E/O C/L INT 140TH ST W & AVE C MKD (FAIRMONT BUTTE RM 1 1970 RE 5869) 6.6FT SE/O PP(NO#) (MON HAS BEEN CHIPPED)	L 7003
LANCASTER (WEST ( 2012 )	2,567.390 782.543	1IN IP W/DPW TAG 3FT S/O UNDERGROUND TEL CABLE MARKER 32FT S/O C/L AVE D & 37FT W/O C/L 135TH ST W	L 7004
LANCASTER (WEST ( 2012 )	2,597.474 791.712	1IN IP W/DPW TAG FLUSH 3FT E/O PP#4194334E 68FT E/O & 46FT N/O C/L INT AVE D & 145TH ST W	L 7005
LANCASTER (WEST ( 2012 )	2,632.601 802.419	L & DPW TAG IN NE COR 6FT X 6FT WELL PAD 165FT E/O & 185FT S/O C/L INT AVE D & 155TH ST W	L 7006
LANCASTER (WEST ( 2012 )	2,668.445 813.344	1IN IP W/DPW TAG 3FT E/O PP#1312411E 30FT N/O & 30FT E/O C/L INT AVE D & 165TH ST W	L 7007
LANCASTER (WEST ( 2012 )	2,779.128 847.081	2IN IP & DPW BM TAG UP 2IN, 50FT W/O & 50FT N/O C/L INT 170TH ST W & AVE F	L 7009
LANCASTER (WEST ( 2012 )	2,740.239 835.227	2IN IP & DPW TAG UP 2IN, 55FT W/O & 28FT N/O INT TRAVELED WAY 170TH ST W & AVE E 4IN MRK POST 1FT S/O IP	L 7010
LANCASTER (WEST ( 2012 )	2,718.505 828.603	2IN IP & LACO DPW TAG 0.6MI S/O AVE D & 33FT W/O C/L TRAVELED WAY 170TH ST W CABLE ROUTE MKR POST 3FT E/O MON	L 7011
LANCASTER (WEST ( 2012 )	2,717.694 828.356	2IN IP & LACO DPW TAG 0.6MI S/O AVE D & 46FT E/O C/L TRAVELED WAY 170TH ST W MKR POST 3FT W/O MON	L 7012
LANCASTER (WEST ( 2012 )	2,783.103 848.292	L&LACO DPW TAG IN CTR TOP HDWL @ MI MRK #17.80 36FT S/O PROD AVE F (LANCASTER RD) & 65FT W/O PROD 167TH ST W (LANCASTER RD) 60FT NE/O TRAV WAY @ MC	L 7013
LANCASTER (WEST ( 2012 )	2,771.906 844.879	CO ENG MON IN WELL MKD (CTR SEC6 RE7078) @ SLY EDGE PAV @ LANCASTER RD & FUTURE AVE 155TH ST W	L 7014
LANCASTER (WEST ( 2012 )	2,681.632 817.364	2IN IP & DPW TAG UP 2IN, 42FT S/O C/L LANCASTER RD & 2.3MI W/O MUNZ RANCH RD 3FT E/O PP#1560009E	L 7015
LANCASTER (WEST ( 2012 )	2,620.662 798.780	2IN IP & LACO DPW TAG 5FT S/O PP#1559840E 30FT S/O C/L LANCASTER RD & 1.7MI W/O MUNZ RANCH RD	L 7016
LANCASTER (WEST ( 2012 )	2,623.814 799.741	2IN IP & LACO DPW TAG 5FT S/O PP#1559838E 50FT S/O C/L LANCASTER RD & 1.7MI W/O MUNZ RANCH RD	L 7017
LANCASTER (WEST ( 2012 )	2,601.046 792.801	2IN IP & LACO DPW TAG UP 2IN, 30FT S/O C/L LANCASTER RD 1.1MI W/O MUNZ RANCH RD 50FT W/O PROD PRIVATE RD 5FT S/O PP#1559818E	L 7018

QUAD YEAR	ELEV FOOT/METER	DESCRIPTION	BM NUMBER
LANCASTER (WEST ( 2012 )	3,306.771 1,007.907	L&LACO DWP TAG IN SE COR GTE CONC PAD 28FT W/O MUNZ RANCH RD & 120FT N/O ELIZABETH LAKE RD	L 7019
LANCASTER (WEST ( 2012 )	3,212.400 979.142	L&LACO DPW TAG IN CTR HDWL @ MI MRK #3.71 22FT W/O MUNZ RANCH RD & 0.6MI N/O ELIZABETH LAKE RD	L 7020
LANCASTER (WEST ( 2012 )	3,072.385 936.466	L&LACO DPW TAG IN ANG PT HDWL @ MI MRK #3.26 20FT NW/O C/L MUNZ RANCH RD & 1.1MI N/O ELIZABETH LAKE RD	L 7021
LANCASTER (WEST ( 2012 )	2,813.068 857.426	L&LACO DPW TAG IN CTR HDWL @ MI MRK #2.30 20FT NW/O C/L MUNZ RANCH RD & 2.05MI N/O ELIZABETH LAKE RD	L 7022
LANCASTER (WEST ( 2012 )	2,690.222 819.982	L&LACO DPW TAG IN CTR HDWL @ MI MRK #1.55 20FT NW/O C/L MUNZ RANCH RD & 2.9MI N/O ELIZABETH LAKE RD	L 7023
LANCASTER (WEST ( 2012 )	2,522.537 768.872	LACO DPW TAG IN SE COR OF CONC ELECT. PAD, 30' N & 170' E/O CL INT AVE I & 115TH ST W.	L 7024
LANCASTER (WEST ( 2012 )	2,807.392 855.696	2" IP & LACO DPW TAG UP 1IN, 57FT S/O CTR TRAV WAY LANCASTER RD & 0.5MI W/O 170TH ST W 5FT E/O PP(NO#) & 115FT SE/O TEL RISER #3979A	L 7025
LANCASTER (WEST ( 2012 )	2,831.875 863.158	2IN IP & LACO DPW TAG UP 2IN, 51FT N/O C/L LANCASTER RD & 43FT E/O C/L 180TH ST W 5FT S/O PP(#2139430E)	L 7026
LANCASTER (WEST ( 2012 )	2,905.791 885.688	2" IP W/ DPW TAG UP 1", 50' S. & 0.50MI W/O CL INT LANCASTER RD & 190TH ST W, 2' S/O MKR POST	L 7027
LANCASTER (WEST ( 2012 )	2,858.122 871.158	CO SUR MON IN WELL DN 1.1FT @ C/L INT 210TH ST W & AVE D-8 MKD (1/4 COR 19,20 RE2177)	L 7028
LANCASTER (WEST ( 2012 )	2,820.294 859.628	1-1/2IN IP CONC PL & BRAD FL 57FT N/O & 57FT W/O C/L INT AVE D & 210TH ST W	L 7030
LANCASTER (WEST ( 2012 )	3,022.207 921.171	2IN IP & LACO BM TAG UP 1IN 31FT SW/O C/L LANCASTER RD & 0.6MI W/O 235TH ST W 36.6M(120FT) NW/O EC LANCASTER RD 3FT SW/O TEL RISER	L 7033
LANCASTER (WEST ( 2012 )	3,015.741 919.201	2IN IP & LACO BM TAG UP 1IN, 31FT SW/O C/L LANCASTER RD & 0.5MI S/O AVE D 3FT SW/O TEL RISER 30FT N/O C/L DIRT RD TO W	L 7034
LANCASTER (WEST ( 2012 )	2,848.669 868.277	L&LACO BM TAG IN S COR CONC PAD @ GAS PUMPS 73FT N/O & 155FT E/O C/L INT AVE D & 230TH ST W	L 7037
LANCASTER (WEST ( 2012 )	3,016.498 919.431	2IN IP & LACO BM TAG FL 3FT S/O GUY POLE #1123605E 45FT S/O AVE D & 650FT W/O LA PETITE AV	L 7039
LANCASTER (WEST ( 2012 )	3,055.764 931.400	L&LACO BM TAG IN NE COR MAILBOX PAD @ SE COR LANCASTER RD (HWY138) & 265TH SE W 63FT S/O & 20FT E/O INT TRAV WAY	L 7040
LANCASTER (WEST ( 2012 )	3,048.457 929.172	2IN IP & LACO BM TAG 2FT UP SLOPE 50FT S/O LANCASTER RD (HWY138) NEAR SLY PROD 269TH ST W MRK POST 2FT N/O MON	L 7041
LANCASTER (WEST ( 2012 )	3,033.530 924.623	L&LACO BM TAG IN FENCE FTG 6FT S/O CORNER 77FT NELY OF CTR LANCASTER RD (HWY138) & 0.3MI NWLY OF 269TH ST W	L 7042



QUAD YEAR	ELEV FOOT/METER	DESCRIPTION	BM NUMBER
LANCASTER (WEST ( 2012 )	3,046.617 928.612	2IN IP & LACO BM TAG UP 1IN, 50FT S/O CTR LANCASTER RD & 0.5MI E/O 300TH ST W 5FT E/O PP#4053164E 25FT E/O CTR DRIVE TO HSE#29826	L 7043
LANCASTER (WEST ( 2012 )	3,090.934 942.120	L&LACO BM TAG IN CTR HDWL 32FT NW/O CTR HWY 138 & 0.6MI W/O 300TH ST W 100FT E/O PP#1049047E	L 7044
LANCASTER (WEST ( 2012 )	3,148.213 959.578	LA CO BM TAG, 4' S/O HDWL ANG PT. 30' S/O HWY 138 & 1.6MI W/O 300TH ST W.	L 7045
LANCASTER (WEST ( 2012 )	3,330.665 1,015.190	L&LACO BM TAG IN FENCE FTG 5FT SELY OF COR FENCE POST 42FT S/O CTR HWY 138 0.6MI W/O OLD RIDGE ROUTE 43FT W/O DIRT RD TO HSE#34710	L 7047
LANCASTER (WEST ( 2012 )	3,327.623 1,014.263	L&LACO DPW BM TAG 1FT W/O E END HDWL 38FT S/O HWY138 & 1.2MI W/O OLD RIDGE ROUTE 105FT SWLY OF PP#1871736E	L 7048
LANCASTER (WEST ( 2012 )	3,333.368 1,016.014	L&LACO BM TAG IN FENCE FTG 27FT W/O CTR OF ENTRANCE TO AQUADUCT FAC. 44FT S/O CTR HWY138 & 1.8MI W/O OLD RIDGE ROUTE	L 7049
BASELINE ( 2010 )	2,847.247 867.844	2" IP W/LA COUNTY BM DISK, STMP'D 7491, UP 3", 50' W. & 0.7MI S/O AVE K & 110TH ST W., 25' W/O PP#4759491E, 2' N/O MKR POST	L 7491
BASELINE ( 2010 )	2,504.159 763.270	1-1/2"IP W/BRAD, DN 8", 74' SW/O CL INT 110TH ST W. & AVE H-8, 2' W/O MKR POST	L 7492
BASELINE ( 2010 )	2,516.544 767.045	1-1/2"IP W/BRAD, DN 9", 74' SW/O CL INT 110TH ST W. & AVE F, 2' W/O MKR POST	L 7493
LANCASTER (WEST ( 2012 )	3,289.617 1,002.678	L&DPW TAG IN CONC PAD, 45' S/O & 37' W/O CL INT ELIZABETH LAKE RD & RANCH CLUB DR, 7' W/O SE'LY COR OF PAD	L 7502
LANCASTER (WEST ( 2012 )	3,296.889 1,004.895	L&DPW TAG IN CONC GATE APRON, 28' S/O & 7' W/O CL INT ELIZABETH LAKE RD & WALKATOP RD	L 7503
LANCASTER (WEST ( 2012 )	3,238.582 987.123	LA CO BR DISK STMP'D 7504 IN 2" IP DN 2", 27' E/O CL MUNZ RANCH RD & 0.55MI N/O ELIZABETH LAKE RD, 3' E/O PP NO. 307245E	L 7504
LANCASTER (WEST ( 2012 )	2,621.942 799.170	2" IP W/SPK & DPW W. UP 12", 26' E'LY OF MUNZ RANCH RD & 0.8MI S/O LANCASTER RD	L 7505
LANCASTER (WEST ( 2012 )	3,260.787 993.891	L&BRAD IN N'LY EDGE CONC DRWY, NORTH ENT TO LACO FIRE STA. 78, 22' N/O ELIZABETH LAKE RD	L 7506
LANCASTER (WEST ( 2012 )	3,257.717 992.955	LACO BR DISK STMP'D 7507 IN COR OF CONC HDWL, 16' N/O ELIZABETH LAKE RD & NEAR MM 19.57	L 7507
LANCASTER (WEST ( 2012 )	3,242.890 988.436	LACO BR DISK STMP'D 7508 IN N'LY EDGE OF FIRE HYD PAD, 23' S/O ELIZABETH LAKE RD & 200' E/O NOBLETT DR	L 7508
LANCASTER (WEST ( 2012 )	2,558.297 779.771	CS MON IN WELL DN 20", CL INT AVE A-8 & 140TH ST W.	L 7509
LANCASTER (WEST ( 2012 )	2,803.883 854.626	2"IP W/ BR DISK STMP'D 7510, 8"UP, 25' SW & 270' W/O CL INT LANCASTER RD & 167TH ST W, 2' N/O BLK WALL HSE #16700	L 7510
LANCASTER (WEST ( 2012 )	2,774.901 845.792	CS MON IN WELL DN 12" @W'LY EP, CL INT AVE F & 170TH ST W	L 7511

QUAD YEAR	ELEV FOOT/METER	DESCRIPTION	BM NUMBER
LANCASTER (WEST ( 2012 )	2,691.733 820.443	2"IP W/ LACO BR DISK STMP'D 7512 UP 4", 95' NW/O 170TH ST W. & AVE D, 3' S/O PP#477727E	L 7512
LANCASTER (WEST ( 2012 )	2,670.974 814.115	2" IP W/ LACO BR DISK STMP'D 7513 FLUSH, 78' N/O FUTURE AVE C & 30' W/O CL TRAVELED 170TH ST W, 3' W/O MKR POST	L 7513
LANCASTER (WEST ( 2012 )	2,501.547 762.474	2"IP W/BR DISK STMP'D 7514 UP 5", 70' N/O AVE A @ 115TH ST W., 3' N/O PP#4619151E	L 7514
LANCASTER (WEST ( 2012 )	2,511.656 765.555	CS MON IN WELL DN 10", CL INT 120TH ST W. & AVE A	L 7515
LANCASTER (WEST ( 2012 )	2,587.915 788.799	2" IP W/LACO BR DISK STMP'D 7516 FLUSH, 30' E. & 73' S/O CL INT 150TH ST W & AVE A, 3' N/O PP(NO#)	L 7516
LANCASTER (WEST ( 2012 )	2,882.686 878.645	2" IP W/ LACO BR DISK STMP'D 7517 UP 5", 52' N. & 0.7MI W/O CL INT LANCASTER RD & 210TH ST W, 18' N/O MKR POST	L 7517
LANCASTER (WEST ( 2012 )	2,951.968 899.763	1" IP W/CE TAG UP 1", 0.45MI NW/O 205TH ST W. & 50' S/O CL LANCASTER RD, 10' S/O MKR POST	L 7518
LANCASTER (WEST ( 2012 )	2,943.492 897.179	DWR BR MON 1964 DN 6", 0.55MI S'LY 210TH ST W. & 54' W/O LANCASTER RD, 2' W/O MKR POST	L 7519
LANCASTER (WEST ( 2012 )	2,716.821 828.090	CAL DIV OF HWY MON STMP'D FAIRMONT BUTTES H-12, 1972, 30' N & 24' W/O CL INT 175TH ST W, & AVE D, 24' SW/O PP#1312387E	L 7520
LANCASTER (WEST ( 2012 )	2,715.716 827.753	CAL DIV OF HWY MON STMP'D FAIRMONT BUTTES H-12 RM-2, 1972, 105' NW/O CL INT AVE D & 175TH ST W.	L 7521
LANCASTER (WEST ( 2012 )	2,820.828 859.791	1"IP W/LS 3871 TAG UP 2", 45' N/O AVE D @ CL 215TH ST W., 45' NW/O PP#1120416E, 3" S/O R/W MKR POST	L 7522
LANCASTER (WEST ( 2012 )	2,821.476 859.988	2" IP W/LACO BR DISK STMP'D 7523 DN 12", 30' S'LY/O CL AVE D @ 215TH ST W.	L 7523
LANCASTER (WEST ( 2012 )	2,814.796 857.952	2" IP W/LACO BR DISK STMP'D 7524, 65' NW/O CL INT AVE D & 220TH ST W., 2' N/O PP#2287797E	L 7524
LANCASTER (WEST ( 2012 )	2,815.888 858.285	2" IP W/LACO BR DISK STMP'D 7525, 285' W/O & 33' N/O CL INT AVE D & 220TH ST W., 5' E/O PP#2287796E	L 7525
LANCASTER (WEST ( 2012 )	2,829.072 862.304	2" IP W/LACO BR DISK STMP'D 7526, 315' W/O & 45' N/O CL INT AVE D & 225TH ST W., 1' S/O MKR POST	L 7526
LANCASTER (WEST ( 2012 )	2,882.291 878.525	2" IP W/LACO BR DISK STMP'D 7527, 5' W/O & 30' N/O CL INT AVE D & 235TH ST W., 2' S/O METAL PP#1120460E	L 7527
LANCASTER (WEST ( 2012 )	2,890.539 881.039	2" IP W/ SPK&DPW W UP 4", 36' S/O & 50' W/O CL INT LANCASTER RD & FUTURE 215TH ST W.	L 7528
LANCASTER (WEST ( 2012 )	2,890.371 880.988	2" IP W/ SPK&DPW W DN 4", 27' S/O & 0.2MI E/O CL INT LANCASTER RD & 224TH ST W., 5' E/O PP#4486205E	L 7529
LANCASTER (WEST ( 2012 )	3,141.461 957.520	CS MON DN 4", 72' E. & 0.50MI S/O CL INT AVE D & THREE PTS RD, 72' N/O PP#1200386E, 1' W/O WIRE FENCE	L 7530

QUAD YEAR	ELEV FOOT/METER	DESCRIPTION	BM NUMBER
LANCASTER (WEST ( 2012 )	3,196.117 974.179	2" IP W/LACO BR DISK STMP'D 7531 UP 3", 1.3MI S/O AVE D (LANCASTER RD) & 44' NW/O THREE PTS RD, 3' S/O PP#4423317E	L 7531
LANCASTER (WEST ( 2012 )	3,337.408 1,017.245	2" IP W/DPW TAG DN 6", 2.4MI S/O AVE D, 75' E/O THREE PTS RD, 15' S/O DIRT DWY HSE #47540, 2' N/O MKR POST	L 7532
LANCASTER (WEST ( 2012 )	3,431.651 1,045.970	2" IP/ SPK&DPW W. UP 2", 33' E. & 20' N/O PINE CYN RD & THREE PTS RD, 4' S/O PP#1200318E	L 7533
LANCASTER (WEST ( 2012 )	3,469.234 1,057.426	2" IP W/& DPW W. DN 5", 0.5MI W/O THREE POINTS RD & 18' S/O PINE CYN RD, 50' W/O DRWY TO HSE NO.26876, 1' N/O FENCE POST	L 7534
LANCASTER (WEST ( 2012 )	3,586.783 1,093.255	2" IP W/SPK*DPW W. UP 2", 26' N/O PINE CYN RD & 1.1MI W/O THREE POINTS RD, 18' W/O GATE, 2' E/O COR FENCE	L 7535
LANCASTER (WEST ( 2012 )	3,627.599 1,105.696	CE MON DN 8", 15' S/O PINE CYN RD & 1.35MI W/O THREE POINTS RD, MRK'D PROP COR RE 5869, 14' N/O PP#4203552E	L 7536
LANCASTER (WEST ( 2012 )	3,822.370 1,165.062	L&T IN S.END CURB @ S'LY PILLER OF DRWY GATE HSE NO.28765, 2.0MI W/O THREE POINTS RD & 62' N/O PINE CYN RD	L 7537
LANCASTER (WEST ( 2012 )	3,835.120 1,168.948	L&T IN LRG ROCK, 24' N/O PINE CYN RD & 2.9MI W/O THREE POINTS RD, ON WEST SIDE OF PACIFIC CREST TRAIL	L 7538
LANCASTER (WEST ( 2012 )	3,819.271 1,164.117	2" IP & LACO BM BR DISK STMP'D 7539 UP 3", 48' S/O PINE CYN RD & 3.3MI W/O THREE POINTS RD, 5' N/O 55" OAK TREE	L 7539
LANCASTER (WEST ( 2012 )	3,802.688 1,159.063	2" IP W/SPK & DPW W. UP 11", 4.2MI W/O THREE POINTS RD & 23' S/O PINE CYN RD , 2' S/O RR FENCE POST	L 7540
LANCASTER (WEST ( 2012 )	3,802.719 1,159.072	2" IP W/SPK&DPW W. DN 6", 4.6MI W/O THREE POINTS RD & 24' S/O PINE CYN RD, 2" NE/O E'LY GATE POST TO HSE #30100 (RANCHO MONTE NIDO)	L 7541
LANCASTER (WEST ( 2012 )	3,859.164 1,176.277	DPW TAG IN CONC FENCE POST FTG, 0.6MI E/O RIDGE RTE RD & 16' W/O PINE CYN RD, 45' N/O DRWY TO HSE#32633, 2' S/O PP#1185341E	L 7542
LANCASTER (WEST ( 2012 )	3,019.381 920.310	2" IP W/SPK & DPW W. DN 5", 0.15MI W/O LA PETITE AVE, 30' N/O AVE D (HWY 138), 5' W/O PP#4752134E	L 7543
LANCASTER (WEST ( 2012 )	3,050.230 929.713	2" IP W/ CALTRANS SPK&W STMP'D 258D DN 3", 0.20MI E/O THREE PTS RD & 36' S/O AVE D (HWY 138), 2' NE/O NE'LY COR FENCE, 2' S/O MKR POST	L 7544
LANCASTER (WEST ( 2012 )	3,048.370 929.146	2" IP W/SPK&DPW W. DN 4", 75' E/O THREE PTS RD, 28' N/O AVE D, 2' E/O PP#1123619E	L 7545
LANCASTER (WEST ( 2012 )	3,042.289 927.292	DPW TAG IN COR CON HDWL, 22' S/O AVE D & 0.10MI W/O MARGADO DR, 42' NE/O PP#1123692E	L 7546
LANCASTER (WEST ( 2012 )	3,213.468 979.468	DPW TAG IN HDWL, 4' S/O ANG PT. 26' S/O HWY 138 & 1.8MI E/O OLD RIDGE RTE RD	L 7547
LANCASTER (WEST ( 2012 )	3,481.900 1,061.286	DPW TAG TOP CONC HDWL @MM 2.47, 28' N/O GORMAN POST RD & 2.5MI SE'LY/O GORMAN SCHOOL RD, 65' SE'LY PP#4539410E	L 7548
LANCASTER (WEST ( 2012 )	3,783.233 1,153.133	DPW TAG TOP W'LY END CONC HDWL, 25' N. & 0.3MI SE/O CL INT GORMAN POST RD & GORMAN SCHOOL RD, NR MM 4.46	L 7549

QUAD YEAR	ELEV FOOT/METER	DESCRIPTION	BM NUMBER
LANCASTER (WEST ( 2012 )	2,980.185 908.363	USGS MON STMP'D K-1044, 1960, 50' S. & 700' W/O CL INT LANCASTER RD & 235TH ST W., 5' W/O PP#GT8033	L 7550
LANCASTER (WEST ( 2012 )	3,854.590 1,174.883	USC&GS MON IN 4" PLASTIC SCREW PLUG DN 3", 380' S/O & 25' E/O CL INT FRAZIER MTN PARK RD & PEACE VALLEY RD, MRK'D M-1298, 1977, 2' S/O PP#955460E	L 7551