

FIELD COPY

COUNTY OF LOS ANGELES

ROAD DEPARTMENT

PRECISE

BENCH MARK LIST



LANCASTER QUAD

1972 ADJUSTMENT

FIELD COPY

PREFACE

The Road Department level net is composed of more than 1,000 miles of levels supporting in excess of 10,000 bench marks. In 1964-65, a major readjustment of the net was undertaken. To emphasize the complete break with previous elevations, the SY, SG & SL series bench marks have been re-labeled BY, BG & BL, respectively.

To facilitate the adjustment, indexing, and distribution of adjusted values of the net, the County territory was divided into 31 quads or areas. For identification purposes each quad was given a name, viz., "Rosemead," "La Mirada," "Santa Fe," etc. When bench marks and elevations in the Road Department net are used, the name of the quad in which the bench mark is located and the date of the adjustment of the elevation must be included in the bench mark description, e.g.,

BG 1887 --L+BN IN CONC HDWL OF DRAIN PIPE UNDER DR 218 FT
NE +18 FT SE C/L INT GRAND AVE +CAMERON AVE MKD (BM)
(COVINA --1965) ELEV. 696.238

It is expected that this general adjustment will, for the most part, remain sound for the next 8 to 12 years. As new circuits are completed, however, re-adjustment of individual quads may become advisable. It is expected that these subsequent adjustments will be in the nature of a few hundredths of a foot. When a quad is re-adjusted, new elevation lists will be published and the date of the re-adjustment will replace the "1965" at the end of the bench mark description. Two bench marks in the same quad with different adjustment dates will not normally join each other. Since all adjustments taper out to nothing at the periphery of the quad, any bench mark in one quad will join any bench mark in another quad regardless of their respective adjustment dates.

The basic accuracy of the net is reflected by an indicated field probable error of plus or minus 0.012 foot per mile of leveling as determined from 298 conditions of closure. However, many years experience in vertical control in the greater Los Angeles basin and Antelope Valley indicate that because of varying degrees of subsidence and heaving, the true datum is recovered only by obtaining substantial agreement of a number of bench marks.

The users of this net are invited to assist in its maintenance by notifying this Department of cases of obliteration, apparent mistakes in descriptions or elevations, and proven disturbance of bench marks.

DATUM: U. S. Coast and Geodetic Survey Sea Level Datum
of 1929, through the medium of the Los Angeles
County Engineer Precise Level Net, 1963 Adjust-
ment.

ABBREVIATIONS USED IN BENCH MARK LISTINGS

ABUT - - - - -	Abutment	EC - - - - -	End of Curve
ALG - - - - -	Along	ENT - - - - -	Entrance
ANG PT - - - - -	Angle Point	FL - - - - -	Floor
B/W - - - - -	Back of Walk	FTG - - - - -	Footing
BCR - - - - -	Beginning of Curb Return	F/W - - - - -	Front of Walk
BC - - - - -	Beginning of Curve	GAR - - - - -	Garage
BLDG - - - - -	Building	HDWL - - - - -	Headwall
BM - - - - -	Bench Mark	HSE - - - - -	House
BT SPK - - - - -	Boat or Bolt Spike	INT - - - - -	Intersection
BR CAP - - - - -	Brass or Bronze Cap	IP - - - - -	Iron Pipe
C B - - - - -	Catch Basin	LT - - - - -	Left
CTR - - - - -	Center	LACE - - - - -	L. A. City Engineer
C/L - - - - -	Center Line	LACS - - - - -	L. A. County Engineer
C/L INT - - - - -	Center Line Intersection	LAFC - - - - -	L. A. Co. Flood Control
C/L PROD - - - - -	Center Line Produced	L+BN - - - - -	Lead and Bench Nail
CONC - - - - -	Concrete	L+BR - - - - -	Lead and Brad
COR - - - - -	Corner	L+N - - - - -	Lead and Nail
COE - - - - -	Corps of Engineers	L+RDEM TAG - - - - -	Lead and Road Dept. Bench Mark Tag
CULV - - - - -	Culvert	L+SPK - - - - -	Lead and Spike
CB - - - - -	Curb	L+T - - - - -	Lead and Tack
CS MON - - - - -	County Engineer Monument	MCR - - - - -	Middle of Curb Return
CS BR CAP - - - - -	County Engineer Brass Cap	MKD - - - - -	Marked
CT SPK - - - - -	Cut Spike	MC - - - - -	Middle of Curve
DR - - - - -	Drive or Driveway	MON - - - - -	Monument
E/O - - - - -	East of	N/O - - - - -	North of
ECR - - - - -	End of Curb Return	NR - - - - -	Near

ABBREVIATIONS USED IN BENCH MARK LISTINGS . . . CONTINUED

OPP - - - - - Opposite
PI - - - - - Point of Intersection
PK+W - - - - - PK Nail and Washer
P/L - - - - - Property Line
POST - - - - - Point on Semi-Tangent
PP - - - - - Power Pole
PVMT - - - - - Pavement
PROD - - - - - Produced
RD - - - - - Road
RDEM - - - - - Road Dept. Bench Mark
RR - - - - - Railroad
RT - - - - - Right
R/W - - - - - Right of Way
SDMH - - - - - Storm Drain Manhole
SMH - - - - - Sewer Manhole
SPK - - - - - Spike
ST+W - - - - - Spike Tin and Washer
S/O - - - - - South of
TP - - - - - Telephone Pole
USC+GS - - - - - U. S. Coast and Geodetic Survey
USGS - - - - - U. S. Geological Survey
WK - - - - - Walk
W/O - - - - - West of

C O U N T Y

L A N C A S T E R
Q U A D

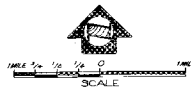

V I S T A
H I
L L A N D
Q U A D

P A L M D A L E

Q U A D

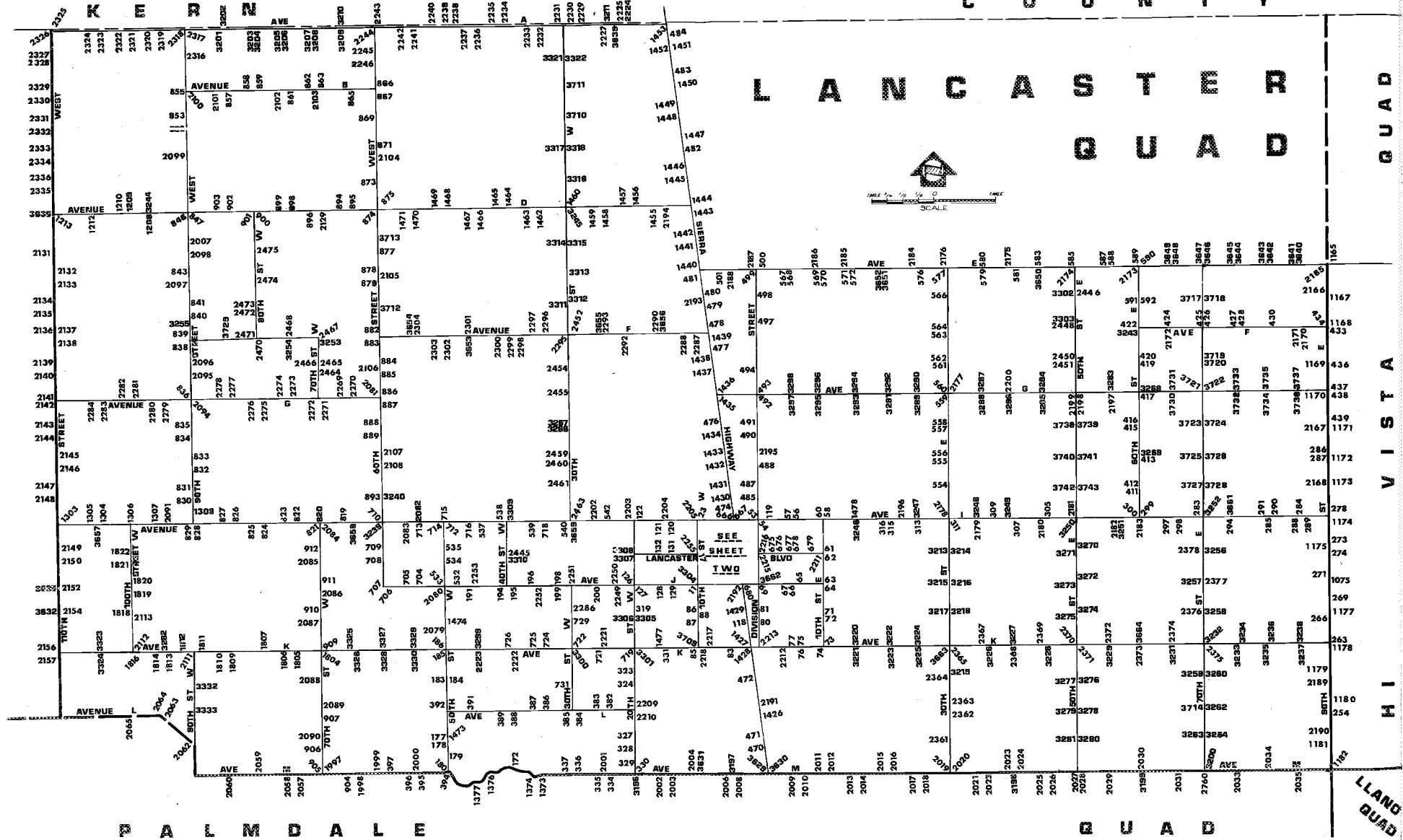

QUAD-YEAR	ELEV	DESCRIPTION (INCLUDE QUAD AND YEAR IN DESCRIPTION)	BM NUMBER
LANCASTR (1972)	2359.602	L+T MCR @ SE COR BEECH AVE + NEWGROVE ST 22FT E + 23FT S C/L INT	BL 2
LANCASTR (1972)	2361.207	L+T E CB CEDAR AVE 20FT E C/L + 35FT S C/L NEWGROVE ST	BL 3
LANCASTR (1972)	2364.838	L+BN MCR NW COR CEDAR AVE + OLDFIELD ST 24FT N + 24FT W C/L INT	BL 4
LANCASTR (1972)	2368.425	L+T MCR NW COR CEDAR AVE + PILLSBURY ST 23FT N + 22FT W C/L INT	BL 5
LANCASTR (1972)	2368.747	L+BN W CB 1FT N BCR @ NW COR ELM AVE + AVE J 18FT W + 66FT N C/L INT	BL 7
LANCASTR (1972)	2367.043	WLY L+T S CB AVE J 60FT S C/L ON C/L PROD FERN AVE IN FRONT OF PARK VIEW SCHOOL	BL 9
LANCASTR (1972)	2360.251	L+BN MCR SW COR AVE J + TENTH ST W 57FT S + 50FT W C/L INT	BL 11
LANCASTR (1972)	2345.646	L+T IN CONC SLAB 69FT E + 104FT N LANCASTER BLVD + TENTH ST W OUT	BL 17
LANCASTR (1972)	2337.975	L+BN W CB 10TH ST W 28FT W C/L 3FT N OF S P/L BLDG 44913 + 570FT S JACKMAN ST 3FT N PP 271449E	BL 18
LANCASTR (1972)	2337.222	L+BN E CB 10TH ST W 28FT E C/L + 86FT N OF N EDGE DRWY BLDG 44902 480FT S JACKMAN ST	BL 19
LANCASTR (1972)	2335.507	L+T IN CB RET 10FT N BCR @ SW COR 10TH ST W + JACKMAN ST 33FT S + 30FT W C/L INT	BL 20
LANCASTR (1972)	2329.737	L+T MCR @ NW COR AVE I + 10TH ST W 50FT N + 39FT W C/L INT	BL 23
LANCASTR (1972)	2331.791	L+T N CB AVE I 40FT N C/L ON C/L PROD FERN AVE	BL 24
LANCASTR (1972)	2334.849	L+T N CB AVE I 40FT N C/L ON C/L PROD ALLEY W OF DATE AVE	BL 25
LANCASTR (1972)	2335.383	L+T N CB AVE I 40FT N C/L ON C/L PROD CEDAR AVE	BL 27
LANCASTR (1972)	2339.495	L+T W CB DATE AVE 0.5FT N BCR @ NW COR DATE AVE + JACKMAN ST 33FT N + 18FT W C/L INT	BL 30
LANCASTR (1972)	2340.123	L+BN S CB JACKMAN ST 20FT S C/L + 25FT W C/L ALLEY TO S BETWEEN FIG AVE + ELM AVE 5FT W BCR	BL 31
LANCASTR (1972)	2339.530	L+BN S CB JACKMAN ST 6FT W BCR @ SW COR FIG AVE + JACKMAN ST 20FT S + 52FT W C/L INT	BL 32
LANCASTR (1972)	2350.223	L+T CONC STEP HSE NO 45027 N DIVISION ST 295FT N + 54FT W C/L INT KETTERING ST + DIVISION ST	BL 34
LANCASTR (1972)	2347.554	L+BN W CB YUCCA AVE 6FT N BCR @ NW COR YUCCA AVE + KETTERING ST 60FT N + 34FT W C/L INT	BL 38
LANCASTR (1972)	2348.535	L+T CONC BASE FENCE POST 30FT N OF C/L KETTERING ST + 209FT W C/L YUCCA AVE	BL 39
LANCASTR (1972)	2346.220	L+BRAD E CB SIERRA HWY 30FT E C/L + 25FT N C/L KETTERING ST	BL 40
LANCASTR (1972)	2346.556	L+T IN SW CB RET 26FT S C/L KETTERING ST + 30FT W C/L SIERRA HWY	BL 41

QUAD-YEAR	ELEV	DESCRIPTION (INCLUDE QUAD AND YEAR IN DESCRIPTION)	BM NUMBER
LANCASTR (1972)	2372.340	L+T IN CONC APRON IN NE COR GROCERY STORE @ SW COR NUGENT ST + DIVISION ST 23FT S + 33FT W C/L INT	BL 44
LANCASTR (1972)	2364.096	CS BR CAP MON @ C/L INT OF DIVISION ST + NEWGROVE ST (E EDGE)	BL 47
LANCASTR (1972)	2359.728	CS MON (E EDGE) IN WELL @ C/L INT NEWGROVE ST TO E + TREVOR AVE	BL 49
LANCASTR (1972)	2362.145	L+BN E CB SIERRA HWY 25FT E C/L + 115FT S C/L PROD NEWGROVE ST 16FT S OF END CB	BL 51
LANCASTR (1972)	2361.400	L+T @ MCR SW COR NEWGROVE ST + SIERRA HWY 23FT S + 37FT W C/L INT	BL 52
LANCASTR (1972)	2344.133	L+T @ MCR NW COR AVE I + DIVISION ST 42FT N + 43FT W C/L INT	BL 53
LANCASTR (1972)	2344.233	L+T @ MCR SW COR AVE I + DIVISION ST 42FT S + 44FT W C/L INT	BL 54
LANCASTR (1972)	2353.631	CSBM MON IN CONC FLUSH 1FT N OF N CB + 19FT W BCR @ NW COR 5TH ST E + AVE I 41FT N + 82FT W C/L INT MKD (BM 105-20 1958)	BL 56
LANCASTR (1972)	2353.473	L+T N CB 3FT W BCR 40FT N + 62FT W C/L INT AVE I + 5TH ST E	BL 57
LANCASTR (1972)	2360.541	USC+GS BR CAP IN CONC POST 8IN UP 48FT N + 56FT E C/L INT AVE I + 10TH ST E MKD (Z1155, 1961)	BL 58
LANCASTR (1972)	2360.532	USC+GS BR CAP 78FT W + 40FT S C/L INT AVE I + 10TH ST E MKD (Y 488 RESET 1961)	BL 60
LANCASTR (1972)	2377.554	CS MON IN WELL 36IN DN @ C/L INT LANCASTER BLVD + 10TH ST E MKD (1/4 COR 14 13 T7N R12W)	BL 61
LANCASTR (1972)	2380.912	L+T W EDGE OF CONC DR OF GARAGE TO HSE NO 1016 LANCASTER BLVD 45FT S C/L + 145FT E C/L 10TH ST E	BL 62
LANCASTR (1972)	2397.495	L+T NR MCR @ SW COR 10TH ST E + AVE J 48FT W + 45FT S C/L INT	BL 63
LANCASTR (1972)	2396.461	CS MON IN WELL 18IN DN @ C/L INT AVE J + 10TH ST E MKD (SEC COR 14 13 23 24 T7N R12W)(W EDGE)	BL 64
LANCASTR (1972)	2391.290	CS MON IN WELL @ C/L INT AVE J + 5TH ST E MKD (T7N R12W 1/4 COR 14 23)(E EDGE)	BL 65
LANCASTR (1972)	2384.641	L+BN @ MCR SE COR 4TH ST E + AVE J (SERVICE RD) 80FT S + 24FT E C/L INT	BL 66
LANCASTR (1972)	2383.759	L+BN @ MCR SE COR KIRKLAND AVE + AVE J 75FT S + 27FT E C/L INT	BL 67
LANCASTR (1972)	2380.268	CS MON (N EDGE) IN WELL @ C/L INT AVE J + DIVISION ST MKD (15 14 22 23 T7N R12W)	BL 69
LANCASTR (1972)	2413.367	L+T E SIDE 36IN STANDPIPE 215FT W C/L 10TH ST E + 5FT N C/L AVE J-8 263FT NW PP 917614E	BL 71
LANCASTR (1972)	2414.013	CS MON IN WELL 8IN DN @ C/L INT 10TH ST E + AVE J-8 0.5 MI S AVE J MKD (T7N, R12W 1/4 COR, 23-24)(W EDGE)	BL 72
LANCASTR (1972)	2434.604	CS MON IN WELL 15IN DN @ C/L INT 10TH ST E + AVE K MKD (SEC COR 23 24 25 26 T7N R12W)(N EDGE)	BL 73

QUAD-YEAR	ELEV	DESCRIPTION (INCLUDE QUAD AND YEAR IN DESCRIPTION)	BM NUMBER
LANCASTR (1972)	2436.043	CHIS X IN TOP OF BOLT ON S SIDE OF FIRE HYDRANT BASE 50FT W C/L 10TH ST E + 28FT S C/L AVE K	BL 74
LANCASTR (1972)	2425.923	CS MON IN WELL @ C/L INT AVE K + 6TH ST E (W EDGE)	BL 75
LANCASTR (1972)	2426.539	CS MON IN CONC POST 3IN UP 40FT S + 55FT W C/L INT AVE K + 6TH ST E MKD (BM 105-9 1958)	BL 76
LANCASTR (1972)	2425.475	CHIS X IN TOP OF BOLT ON W SIDE OF FIRE HYDRANT BASE 24FT S + 40FT W C/L INT AVE K + 5TH ST E 135FT W DRWY TO HSE 504	BL 77
LANCASTR (1972)	2400.549	L+BN @ MCR @ NE COR DIVISION ST + AVE J-8 28FT N + 41FT E C/L INT	BL 80
LANCASTR (1972)	2399.353	L+BN @ MCR SE COR DIVISION ST + AVE J-7 36FT S + 35FT E C/L INT	BL 81
LANCASTR (1972)	2414.011	CS MON IN WELL 18IN DN @ C/L INT AVE K + 5TH ST W MKD (22 27 T7N R12W)(N SIDE)	BL 83
LANCASTR (1972)	2405.296	L+BN @ NE COR OF SO CAL GAS CO VALVE BOX 44FT N C/L AVE K + 115FT W C/L 10TH ST W	BL 85
LANCASTR (1972)	2380.637	CS MON IN WELL @ C/L INT 10TH ST W + AVE J-8 MKD (1/4 COR 21 22 T7N R12W)(W EDGE)	BL 86
LANCASTR (1972)	2380.889	L+T 1FT N BCR @ NE COR 10TH ST W + AVE J-8 51FT N + 30FT E C/L INT	BL 87
LANCASTR (1972)	2377.128	L+T S CB AVE J-6 1FT E BCR @ SE COR 10TH ST W + AVE J-6 18FT S + 65FT E C/L INT	BL 88
LANCASTR (1972)	2362.909	CS MON IN WELL 8IN DN @ C/L INT OLDFIELD ST + DATE AVE	BL 91
LANCASTR (1972)	2363.186	L+T @ MCR NW COR OLDFIELD ST + DATE AVE 21FT N + 24FT W C/L INT	BL 92
LANCASTR (1972)	2397.395	USC+GS DISK IN CONC 6IN DN 60FT E + 125FT S C/L INT SIERRA HWY + AVE J-8 MKD (S 811 1947 RESET 1955)	BL 118
LANCASTR (1972)	2346.240	USC+GS BRASS DISK IN CONC 4IN UP 65FT E DR TO ANTELOPE VALLEY FAIR 681FT E OF C/L DIVISION ST + 41FT N C/L AVE I MKD (X 488 1955)	BL 119
LANCASTR (1972)	2324.666	L+T IN N SERVICE ROAD CB @ NE COR AVE I + 15TH ST W 51FT E + 80FT N C/L INT	BL 120
LANCASTR (1972)	2324.869	RDBM TAG IN S SERVICE ROAD CB @ SW COR AVE I + 15TH ST W 51FT W + 80FT S C/L INT	BL 121
LANCASTR (1972)	2322.192	CS MON 5IN UP @ NE COR AVE I + 20TH ST W 40FT N + 66FT E C/L INT MKD (BM 102-3 1957)	BL 122
LANCASTR (1972)	2342.247	CS MON IN WELL 12IN DN @ C/L INT AVE J + 20TH ST W MKD (SEC COR 17 16 20 21 R12W T7N) (N EDGE)	BL 126
LANCASTR (1972)	2344.120	RDBM TAG IN N CB @ NE COR AVE J + 20TH ST W 108FT E + 30FT N C/L INT	BL 127
LANCASTR (1972)	2349.709	RDBM TAG 6FT W BCR @ SW COR AVE J + 15TH ST W 66FT W + 30FT S C/L INT	BL 128
LANCASTR (1972)	2350.447	RDBM TAG 40FT S BCR @ SE COR AVE J + 15TH ST W 100FT S + 30FT E C/L INT	BL 129

QUAD-YEAR	ELEV	DESCRIPTION (INCLUDE QUAD AND YEAR IN DESCRIPTION)	BM NUMBER
LANCASTR (1972)	2338.807	L+BN 3FT W OF BCR @ SW COR LANCASTER BLVD + LOWTREE AVE 53FT W + 30FT S C/L INT	BL 131
LANCASTR (1972)	2336.305	L+BN 4FT N BCR @ NE COR LANCASTER BLVD + 15TH ST W 69FT N + 30FT E C/L INT	BL 132
BASELINE (1965)	2494.079	USC+GS DISK IN CONC POST 92FT N + 65FT W C/L INT AVE M + 40TH ST W MKD (F 489 1955)	BL 172
LANCASTR (1972)	2461.849	L+T NE COR CONC SLAB 100FT W + 66FT S C/L INT 50TH ST W + AVE L-8	BL 177
LANCASTR (1972)	2477.891	L+T CONC WLK IN FR OF CHURCH 45FT N + 65FT W C/L INT 50TH ST W + AVE L-12	BL 178
LANCASTR (1972)	2485.350	L+T CONC PORCH 50FT W + 45FT N C/L INT 50TH ST W + AVE L-14	BL 179
BASELINE (1965)	2495.234	L+T CONC SLAB NW COR PORCH TO HSE NO 42002 50TH ST W 48FT N + 66FT E C/L INT 50TH ST W + AVE M	BL 180A
LANCASTR (1972)	2411.788	2IN IRON PIPE 6IN UP 40FT W OF C/L 50TH ST W ON C/L AVE K-8	BL 183
LANCASTR (1972)	2410.110	CS MON (E EDGE) IN WELL 18IN DN @ C/L INT 50TH ST W + AVE K-8 MKD (1/4 COR 25 26 T7N R13W)	BL 184
LANCASTR (1972)	2380.020	CS MON (W EDGE) IN WELL 12IN DN @ C/L INT 50TH ST W + AVE K MKD (SEC COR 23 24 25 26 T7N R13W)	BL 185
LANCASTR (1972)	2382.262	L+T NW COR CONC PORCH HSE NO 4849 AVE K 115FT E + 120FT N C/L INT AVE K + 50TH ST W	BL 186
LANCASTR (1972)	2350.313	RDBM TAG S SIDE WIER BOX 97FT E + 85FT N C/L INT AVE J + 45TH ST W (TO THE N)	BL 191
LANCASTR (1972)	2343.680	ENG TAG + BRAD IN 2IN IP RP TO C/L INT IN HP @ SW COR AVE J + 40TH ST W 50FT S + 50FT W C/L INT	BL 194
LANCASTR (1972)	2343.732	CS MON IN WELL 8IN DN @ C/L INT AVE J + 40TH ST W MKD (T7N, R12W 13-18-19-24) USE N EDGE	BL 195
LANCASTR (1972)	2341.299	L+T CONC SLAB IN FRONT OF CHURCH @ NE COR AVE J + 35TH ST W 130FT N + 170FT E C/L INT MKD (BM)	BL 196
LANCASTR (1972)	2341.814	L+T IN SE COR CONC PORCH TO HSE NO 3129 W AVE J 75FT N C/L + 895FT W 30TH ST W	BL 198
LANCASTR (1972)	2341.663	PM IN DIAMOND ON NW QUAD SMH RIM ON C/L AVE J + 500FT W 30TH ST W 385FT E HSE 3129 + 90FT E RP 800770E	BL 199
LANCASTR (1972)	2338.462	CS MON (N EDGE) IN WELL 18IN DN @ C/L INT AVE J + 25TH ST W MKD (1/4 COR 17 20 T7N R12W)	BL 200
BASELINE (1965)	2496.435	CS MON IN WELL @ C/L INT AVE L+ 90TH ST E MKD (T7N R10W, SEC COR 29,30,31,32)	BL 254B
BASELINE (1965)	2473.301	CS MON 30IN DN @ C/L INT AVE K + 90TH ST E MKD (T7N R10W SEC 19 20 29 30) USE E EDGE	BL 263B
BASELINE (1965)	2454.169	CS MON 30IN DN @ C/L INT AVE J-8 + 90TH ST E MKD (R10W T7N 1/4 SEC 19 20)	BL 266B
BASELINE (1965)	2449.591	L+T N END 1ST STEP OF PORCH OF HSE NO 44207 90TH ST E 100FT W C/L + 1000FT S AVE J	BL 269B

QUAD-YEAR	ELEV	DESCRIPTION (INCLUDE QUAD AND YEAR IN DESCRIPTION)	BM NUMBER
BASELINE (1965)	2441.794	CS MON 15IN DN @ C/L INT 90TH ST E + AVE J MKD (T7N R10W SEC COR 18 17 19 20)	BL 271B
BASELINE (1965)	2431.384	L + T NR E EDGE CONC PORCH @ HSE NO 44709 90TH ST E 79FT W C/L + 600FT S AVE I-8 6FT N/D S END OF PORCH	BL 273B
BASELINE (1965)	2425.056	CS MON 20IN DN @ C/L INT 90TH ST E + AVE I-8 MKD (1/4 SEC 17 18 T7N R10W)	BL 274B
BASELINE (1965)	2412.568	CS MON 12IN DN @ C/L INT 90TH ST E + AVE I MKD (R10W T7N COR SEC 7,8,17,18)	BL 278B
LANCASTER (1972)	2400.324	CS MON IN CONC SQ 2IN UP 3FT S PP NO 991755E 39FT S C/L AVE I + 70FT W C/L 70TH ST E MKD (BM 107-30 1961)	BL 283
LANCASTER (1972)	2411.036	CS MON IN CONC SQ 2IN UP 1FT N TP NO K3143Y 30FT N C/L AVE I + 27FT W C/L PROP 85TH ST E MKD (BM 107-27 1961)	BL 284
LANCASTER (1972)	2413.264	CS MON 2FT S PP NO 991781E 30FT S C/L AVE I + 47FT W C/L 80TH ST E MKD (BM 107-28 1961)	BL 285
BASELINE (1965)	2392.783	LACS MON IN WELL 16IN DN @ C/L INT 90TH ST E + AVE H MKD SEC COR R10W T7N 5 6 7 8 USE NW EDGE	BL 286B
BASELINE (1965)	2394.247	RDBM TAG @ CTR OF OLD CONC BASE OF MTR MOUNT 40FT W C/L 90TH ST E + 100FT N C/L AVE H	BL 287B
LANCASTER (1972)	2409.311	LACS MON IN WELL 18IN DN @ C/L INT AVE I + 85TH ST E MKD SEC M-18 T7N R10W USE N EDGE	BL 288
LANCASTER (1972)	2410.801	RDBM TAG @ SE COR CONC FTG OF WATER TOWER @ HSE NO 8359 AVE I 60FT N + 20FT W C/L INT AVE I + 85TH ST E	BL 289
LANCASTER (1972)	2416.636	RDBM TAG TOP OF CONC SUPPORT OF LGE WATER TANK 90FT N C/L AVE I + 45FT W C/L 80TH ST E	BL 290
LANCASTER (1972)	2414.857	L+T @ SW COR OF CONC WLK TO HSE NO 7848 AVE I 200FT W C/L 80TH ST E + 80FT N C/L AVE I	BL 291
LANCASTER (1972)	2403.210	CSBM MON FLUSH 25FT S C/L AVE I + 25FT W C/L 75TH ST E 15FT W PP 482159E MKD (BM 107-29 1961)	BL 294
LANCASTER (1972)	2398.176	CS MON IN CONC 2IN UP 33FT S C/L AVE I + 142FT W C/L 65TH ST E 3FT S PP NO 1121124 MKD (BM 107- 31 1961)	BL 297
LANCASTER (1972)	2401.250	RDBM TAG TOP OF CONC WEIR BOX 35FT N C/L AVE I 400FT E OF 65TH ST E 50FT E OF DRWY TO HSE NO 6535 AVE I	BL 298
LANCASTER (1972)	2400.150	L+T E CB DRWY HSE NO 6007 AVE I 40FT N + 100FT E C/L INT E AVE I + 60TH ST E	BL 299
LANCASTER (1972)	2400.048	L+T W CB DRWY HSE NO 6007 AVE I 42FT N + 90FT E C/L INT E AVE I + 60TH ST E	BL 300
LANCASTER (1972)	2385.455	2IN IP 1FT ABOVE GROUND 40FT S OF C/L INT AVE I + 45TH ST E (USE E EDGE)	BL 305
LANCASTER (1972)	2383.610	L+T NE COR CONC WLK HSE NO 4010 AVE I 90FT S + 140FT E C/L INT AVE I + 40TH ST E	BL 307
LANCASTER (1972)	2381.794	L+T SE COR CONC SLAB @ NE COR BLDG NO 3606 AVE I 82FT S C/L + 150FT E C/L 36TH ST E	BL 309

QUAD-YEAR	ELEV	DESCRIPTION (INCLUDE QUAD AND YEAR IN DESCRIPTION)	BM NUMBER
LANCASTR (1972)	2379.852	CS MON IN CONC OUT ON 21 FT S C/L INT AVE I + 30TH ST MKD (1/4 COR 7-18) (E EDGE)	BL 311
LANCASTR (1972)	2375.859	CS MON IN WELL @ C/L INT AVE I + 25TH ST E MKD (T7N, R11W, 1/4 COR 7-18) (E EDGE)	BL 313
LANCASTR (1972)	2373.509	USGS MON W/BR CAP 6IN UP 30FT S + 35FT E C/L INT 20TH ST E + AVE I MKD (LS 11 1929)	BL 315
LANCASTR (1972)	2372.769	L+T SE COR OF CONC APRON OF GAS STA 55FT N C/L AVE I + 65FT W C/L 20TH ST E	BL 316
LANCASTR (1972)	2353.400	L+T IN NW COR OF 4FT SQ CONC SLAB AT NW COR HSE NO 44126 20TH ST W 1700FT S OF AVE I 65FT E OF C/L 20TH ST W	BL 319
LANCASTR (1972)	2414.007	CS BR CAP MON 18IN DN @ C/L INT 20TH ST W + AVE K-8 MKD (1/4 COR SEC 29-28 T7N R12W)	BL 323
LANCASTR (1972)	2418.493	L+T IN CONC SLAB ON SE COR TO HSE NO 43111 20TH ST W 100FT W C/L + 260FT S C/L AVE L-8	BL 324
LANCASTR (1972)	2480.589	L+T IN CONC SLAB IN FRONT OF DOOR TO HSE 42423 20TH ST W 100FT W C/L + 250FT N C/L AVE L-8	BL 327
LANCASTR (1972)	2482.075	CS MON IN WELL 18IN DN @ C/L INT 20TH ST W + AVE L-8 MKD (SEC COR 28 29 32 33 T7N R12W)	BL 328
LANCASTR (1972)	2520.845	RDBM TAG IN NE COR 3FT SQ CONC BASE IN CONC PUMP 200FT N C/L AVE M + 125FT W C/L 20TH ST W	BL 329
BASELINE (1965)	2523.175	USC+GS BRASS DISK IN TOP OF CONC POST 4IN UP 208FT E OF C/L 20TH ST W + 33FT N C/L AVE M MKD (D 489 1955)	BL 330
LANCASTR (1972)	2391.531	CS MON IN WELL 18IN DN @ C/L INT 15TH ST W + AVE K MKD (1/4 SEC 21 28 T7N R12W)	BL 331
BASELINE (1965)	2518.134	CS MON IN WELL 18IN DN @ C/L INT AVE M + 25TH ST W MKD (1/4 COR 32 5 T6N R12W)	BL 334A
BASELINE (1965)	2523.287	L+T IN SE COR OF CONC DR TO HSE NO 2524 AVE M 140FT S C/L + 215FT W C/L 25TH ST W	BL 335
BASELINE (1965)	2520.165	USC+GS MON TOP OF CONC POST 4IN UP 300FT E C/L 30TH ST W + 34FT N C/L AVE M 6FT W PP NO 1054594E MKD (E 489 1955)	BL 336
BASELINE (1965)	2514.874	CS MON IN WELL @ C/L INT AVE M + 30TH ST W MKD (SEC COR 31 32 5 6 T7N T6N R12W)	BL 337A
LANCASTR (1972)	2448.706	CS MON 24IN DN @ C/L INT OF AVE L + 25TH ST W MKD (1/4 SEC COR 29 32 T7N R12W)	BL 382
LANCASTR (1972)	2448.903	L+T IN BOTTOM STEP @ W EDGE OF CONC STEPS TO HSE NO 2507 AVE L 73FT N C/L + 78FT W C/L 25TH ST W	BL 383
LANCASTR (1972)	2441.190	CS MON 18IN DN @ C/L INT OF AVE L + 30TH ST W MKD (SEC COR 29 30 31 32 T7N R12W)	BL 384
LANCASTR (1972)	2441.234	L+T NE COR CONC DR TO HSE NO 3018 AVE L 75FT S C/L + 195FT W C/L 30TH ST W	BL 385
LANCASTR (1972)	2434.956	L+T NW COR CONC SLAB TO HSE NO 3550 AVE L 65FT S C/L + 139FT E C/L 35TH ST W	BL 386
LANCASTR (1972)	2433.345	CS MON 6IN DN @ C/L INT AVE L + 35TH ST W MKD (1/4 COR SEC 30 31 T7N R12W) (S EDGE)	BL 387

QUAD-YEAR	ELEV	DESCRIPTION (INCLUDE QUAD AND YEAR IN DESCRIPTION)	BM NUMBER
LANCASTR (1972)	2428.373	CS MON 8IN DN @ C/L INT OF AVE L + 40TH ST W MKD (T7N R12W R13W SEC COR 25 30 36 31)(SE EDGE)	BL 388
LANCASTR (1972)	2431.875	L+T IN W EDGE OF 2FT CONC WLK TO APT NO 4012 AVE L 50FT S C/L + 110FT W C/L 40TH ST W	BL 389
LANCASTR (1972)	2428.403	USGS MON @ NW COR AVE L + 45TH ST W 38FT N + 37FT W C/L INT MKD (R 49 1929 RESET 1942)	BL 391
LANCASTR (1972)	2432.354	L+T IN CONC PORCH OF HSE ON NW COR 50TH ST W + AVE L 109FT N + 232FT W C/L INT MKD OUT	BL 392
BASELINE (1965)	2491.236	CS MON IN WELL 14IN DN @ C/L INT AVE M + 50TH ST W MKD (SEC COR 35 36 2 1 T7N T6N R13W) (W EDGE)	BL 394B
BASELINE (1965)	2496.566	CS MON IN WELL 15IN DN @ C/L INT OF AVE M + 55TH ST W MKD (1/4 COR SEC 35, 2 R-13W T-7N T-6N) USE S EDGE	BL 395
BASELINE (1965)	2500.800	L+T IN CONC WLK TO HSE ON AVE M + 55TH ST W MKD (1/4 COR SEC 35, 2 R-13W T-7N T-6N) USE S EDGE DISTURBED	BL 396
BASELINE (1965)	2513.834	CS MON IN WELL 22IN DN @ C/L INT OF AVE M + 60TH ST W MKD (SEC COR 34 35 3 2 T7N T6N R13W)	BL 397
LANCASTR (1972)	2382.937	CS MON IN WELL 18IN DN @ C/L INT 60TH ST E + AVE H-8 PROP MKD (1/4 SEC COR 11 10 R11W T7N) (S EDGE)	BL 411
LANCASTR (1972)	2385.967	RDBM TAG IN SE COR CONC RESERVOIR @ HSE NO 45609 60TH ST E 110FT W C/L + 55FT N C/L AVE H-8 PROP	BL 412
LANCASTR (1972)	2370.369	CS MON IN WELL 18IN DN @ C/L INT 60TH ST E + AVE H MKD (SEC COR 3 2 10 11 R11W T7N)(S EDGE)	BL 413
LANCASTR (1972)	2360.728	CS MON 18IN DN @ C/L INT 60TH ST E + AVE G-8 MKD (1/4 SEC COR 3 2 R11W T7N)(N EDGE)	BL 415
LANCASTR (1972)	2362.047	L+T NR S EDGE OF CONC WK TO HSE NO 46415 60TH ST E 130FT W C/L + 145FT N C/L AVE G-8 MKD (SLBM)	BL 416
LANCASTR (1972)	2352.376	LACS MON IN WELL 16IN DN @ C/L INT 60TH ST E + AVE G MKD SEC COR 34 35 3 2 T7N R11W USE SW EDG CS MON 16IN DN @ C/L INT 60TH ST E + AVE G MKD (SEC COR 34 35 3 2 R11W T8N)	BL 417
LANCASTR (1972)	2345.740	L+T IN CONC FENCE POST @ SE COR 60TH ST E + AVE F-8 20FT S + 22FT E C/L INT MKD (SLBM)	BL 419
LANCASTR (1972)	2344.152	LACS MON IN WELL 24IN DN @ C/L INT 60TH ST E + AVE F-8 MKD 1/4 COR 34 35 T7N R11W USE W EDGE CS MON @ C/L INT 60TH ST E + AVE F-8 MKD (1/4 SEC COR 34 35 R11W T8N)(W EDGE)	BL 420
LANCASTR (1972)	2336.872	RD MON 8IN DN @ SW COR AVE F + 60TH ST E 47FT W + 25FT S C/L INT	BL 422
LANCASTR (1972)	2339.155	RD MON IN WELL WITH COVER @ NE COR 65TH ST E + AVE F 24FT N + 42FT E C/L INT 4FT E GUY POLE NO 627428E	BL 424
LANCASTR (1972)	2343.353	RD MON IN WELL W/COVER 8IN DN @ NW COR AVE F + 70TH ST E 34FT N + 25FT W C/L INT 4FT N OF PP NO 373290E	BL 425
LANCASTR (1972)	2343.797	CS MON 8IN DN @ C/L INT AVE F + 70TH ST E MKD (SEC COR 26 25 35 36 R11W T8N)(N EDGE)	BL 426

QUAD-YEAR	ELEV	DESCRIPTION (INCLUDE QUAD AND YEAR IN DESCRIPTION)	BM NUMBER
LANCASTR (1972)	2347.757	L+BN IN CONC FTG OF 36IN STANDPIPE 40FT N C/L AVE F + 31FT W C/L 75TH ST E PROP MKD (SLBM)	BL 427
LANCASTR (1972)	2346.326	CS MON 12IN DN @ C/L INT AVE F + 75TH ST E MKD (1/4 SEC COR 25 36 R11W T8N)(N EDGE)	BL 428
LANCASTR (1972)	2348.987	CS MON @ C/L INT AVE F + 80TH ST E MKD (SEC COR 25 30 36 31 R10W R11W T8N)(E EDGE)	BL 430
BASELINE (1965)	2354.853	L+T CONC FOUNDATION OF WATER TOWER 6FT W + 1.5FT N OF SE COR @ NW COR 90TH ST E + AVE F 45FT N + 95FT W C/L INT MKD (SLBM)	BL 433B
BASELINE (1965)	2354.502	CS MON 12IN DN @ C/L INT 90TH ST E + AVE F MKD (SEC COR 30 29 31 32 R10W T8N)(E EDGE)	BL 434B
BASELINE (1965)	2365.094	2IN IP WITH CONC PLUG + BT SPK @ C/L INT 90TH ST E + AVE F-8	BL 436B
BASELINE (1965)	2372.935	CS MON IN WELL 15IN DN @ C/L INT 90TH ST E + AVE G MKD (SEC COR 31 32 6 5 R10W T8N T7N)	BL 437B
BASELINE (1965)	2374.275	RD MON IN WELL WITH CONC COLLAR @ SE COR 90TH ST E + AVE G 30FT E + 40FT S C/L INT	BL 438B
BASELINE (1965)	2385.018	2IN IP IN CONC WITH BR CAP ON C/L AVE G-8 30FT W C/L 90TH ST E MKD (WC SEC 6 R10W T7N)	BL 439B
LANCASTR (1972)	2497.847	USC+GS MON 3IN UP 60FT E C/L SIERRA HWY OPP BLDG NO 42445 2200FT S AVE L MKD U 811 1947	BL 470
LANCASTR (1972)	2486.633	USC+GS MON 12IN DN 60FT E C/L SIERRA HWY OPP BLDG NO 42607 1250FT S AVE L MKD B 57 1926 RESET 1955	BL 471
LANCASTR (1972)	2447.454	USC+GS MON 3IN UP 59FT E C/L SIERRA HWY + 75FT N C/L PROP AVE K-8 MKD T 811 1947	BL 472
LANCASTR (1972)	2332.743	USGS MON ON 3IN IP 2IN UP IN REAR OF A V PLUMBIN SUPPLY @ NO 45358 SIERRA HWY 161FT E/O C/L + 1100FT N AVE I MKD 2335 B 1902	BL 474
LANCASTR (1972)	2317.405	USC+GS MON S EDGE HDWL CULV G90+50 25FT W C/L SIERRA HWY + 0.4MI S AVE G MKD (Z 811 1947)	BL 476
LANCASTR (1972)	2305.363	USC+GS MON 10IN UP 34FT E C/L SIERRA HWY + 1450FT S AVE F MKD (Y 56 1926)	BL 477
LANCASTR (1972)	2302.182	USGS MON ON 3IN IP 8IN UP 85FT E C/L SIERRA HWY + 800FT N AVE F MKD (2302 B 1902 33)	BL 478
LANCASTR (1972)	2304.315	USGS TRI STA MON 15IN UP 227FT W C/L SIERRA HWY + 2200FT N AVE F MKD (OBAN 1929 LINT)	BL 479
LANCASTR (1972)	2301.558	USC+GS REF MON 8IN UP 227FT W C/L SIERRA HWY + 2280FT N AVE F MKD (OBAN NO 2 1941)	BL 480
LANCASTR (1972)	2300.920	USC+GS MON FLUSH W END S CONC ABUT OF RR BRIDGE 73FT N C/L AVE E + 121FT E C/L SIERRA HWY MKD (H 487 1955)	BL 481
LANCASTR (1972)	2303.946	USC+GS MON FLUSH TOP OF E END OF S CONC ABUT OF SPRR BRIDGE 88FT N C/L AVE C + 141FT E C/L SIERRA HWY MKD (J 487 1955)	BL 482
LANCASTR (1972)	2305.757	USC+GS MON FLUSH S END W HDWL CULV UNDER SPRR 35FT N C/L AVE B + 122FT E C/L SIERRA HWY MKD (N 487 1955)	BL 483

QUAD-YEAR	ELEV	DESCRIPTION (INCLUDE QUAD AND YEAR IN DESCRIPTION)	BM NUMBER
LANCASTR (1972)	2307.921	USC+GS MON FLUSH N END HDWL OF SPRR CULV 123FT E C/L SIERRA HWY + 175FT S C/L AVE A (KERN CO LINE) MKD (M 487 1955)	BL 484
LANCASTR (1972)	2334.119	RDBM TAG E CB 60FT S BCR @ SE COR DIVISION ST + AVE H-8 20FT E + 135FT S C/L INT	BL 485
LANCASTR (1972)	2332.340	CS MON (N EDGE) IN WELL 18IN DN @ C/L INT AVE H-8 + DIVISION ST MKD (1/4 SEC COR 10 11 T7N R12W)	BL 487
LANCASTR (1972)	2333.361	CS MON 12IN DN @ C/L INT DIVISION ST + AVE H MKD (SEC COR 3-2 10-11 T7N R12W) USE W EDGE	BL 488
LANCASTR (1972)	2327.784	L+T NW COR CONC WALK BLDG NO 46350 @ SE COR OF DIVISION ST + AVE G8 (PROP) 205FT S + 45FT E OF C/L INT	BL 490
LANCASTR (1972)	2325.775	CS BR CAP MON 24IN DN @ C/L INT OF AVE G8 PROP + DIVISION ST MKD (1/4 SEC COR 2-3 T7N R12W)	BL 491
LANCASTR (1972)	2322.818	2IN IP WITH CONC PLUG 12IN UP @ SE COR DIVISION ST + AVE G ³⁵ / ₂₂ FT S + ³⁵ / ₂₂ FT E OF C/L INT (S EDGE)	BL 492
LANCASTR (1972)	2320.702	CS BR CAP MON IN WELL 15IN DN @ C/L INT DIVISION ST + AVE G MKD (SEC COR 34-35-3-2 T8N T7N R12W)	BL 493
LANCASTR (1972)	2315.257	L+T @ NE COR CONC SLAB @ SIDE ENT N SIDE OF HSE NO 47159 DIVISION ST 100FT W C/L + 80FT S C/L AVE F-8	BL 494
LANCASTR (1972)	2306.535	CS MON 14IN DN @ C/L INT OF AVE F + DIVISION ST MKD (SEC COR 26-27 34-35 R12W T8N)(E EDGE)	BL 497
LANCASTR (1972)	2301.132	CS BR CAP MON 14IN DN @ C/L INT AVE E-8 + DIVISION ST MKD (26-27 R12W T8N)	BL 498
LANCASTR (1972)	2295.723	RD DEPT BM MON IN WELL 6IN DN @ SW COR DIVISION ST + AVE E 27FT W + 51FT S C/L INT 4 FT WLY PP NO 306431E	BL 499
LANCASTR (1972)	2294.181	CS MON (NE EDGE) IN WELL 31IN DN @ C/L INT AVE E + DIVISION ST MKD (SEC COR 22 23 26 27 T8N)	BL 500
LANCASTR (1972)	2296.009	CS MON 18IN DN ON C/L AVE E 2677FT W OF DIVISION ST MKD (T8N 22-27 R12W 1/4 COR)(N EDGE)	BL 501
LANCASTR (1972)	2348.816	RDBM TAG CONC SLAB NR 36IN STANDPIPE 40FT N C/L AVE J + 640FT E 50TH ST W	BL 532
LANCASTR (1972)	2348.120	CS MON IN WELL 20IN DN @ C/L INT AVE J + 50TH ST W MKD (SEC COR 14 13 23 24 T7N R13W)	BL 533
LANCASTR (1972)	2337.875	2IN IP 6IN DN 50FT S + 50FT E C/L INT 50TH ST W + AVE I-8	BL 534
LANCASTR (1972)	2337.824	2IN IP 6IN DN 50FT N + 50FT E C/L INT 50TH ST W + AVE I-8	BL 535
LANCASTR (1972)	2329.742	CS MON IN TOP 12IN CONC POST 5IN UP 89FT N C/L AVE I + 30FT E C/L 45TH ST W MKD (BM 102-9 1957)	BL 537
LANCASTR (1972)	2328.018	US GS MON 12IN UP 36FT W C/L 40TH ST W + 147FT S C/L AVE I 33FT E OFFE SIDE HSE 4011 MKD LINT ALKALI 1929	BL 538
LANCASTR (1972)	2317.995	CS MON TOP 12IN CONC POST 6IN UP 42FT N C/L AVE I + 63FT E C/L 35TH ST W 39FT E OF DRWY HSE 3355 + 25FT W PP 865024E MKD (BM 102-7 1957)	BL 539