

COUNTY OF LOS ANGELES
ROAD DEPARTMENT

PRECISE
BENCH MARK LIST



LANCASTER QUAD

1975 ADJUSTMENT

+ PARTIAL 1977 ADJUSTMENT

NOTE !

In lieu of a complete readjustment of this Quad in 1977, alterations were applied to 1975 elevations in high subsidence pockets. These changes are reflected by the "As and Ds" following the bench numbers i.e. CL 2240 A and CL 2241 D. The "A" benches are compatible with the 1975 adjustment of the unlettered benches and the "D" benches. The "D" benches are compatible with the closest "A" bench and other "D" benches but not the unlettered benches.

P R E F A C E

The Road Department level net is composed of more than 2,000 miles of levels supporting in excess of 12,000 bench marks. In 1975, a major readjustment of the net was undertaken. To emphasize the complete break with previous elevations, the BY,BG & BL series bench marks have been relabeled CY,CG & CL, respectively.

To facilitate the adjustment, indexing, and distribution of adjusted values of the net, the County territory is divided into 34 quads or areas. For identification purposes each quad is given a name, viz., "Rosemead," "La Mirada," "Santa Fe," etc. When bench marks and elevations in the Road Department net are used, the name of the quad in which the bench mark is located and the date of the adjustment of the elevation must be included in the bench mark description, e.g.,

CG 6234 --L&BN IN CONC HDWL OF DRAIN PIPE UNDER DR 218 FT
NE&18 FT SE C/L INT GRAND AVE & CAMERON AVE MKD (BM)
(COVINA -1975) ELEV. 696.238

Experience indicates that this general adjustment will, for the most part, remain sound for the next 10 years. Updating constrained adjustments will be made in 5 years. It is expected that these updating adjustments will be in the nature of a few hundredths of a foot. When a quad is readjusted, new elevation lists will be published and the date of the readjustment will replace the "1975" at the end of the bench mark description. Two bench marks with different adjustment dates will not normally agree with each other.

The basic accuracy of the net is reflected by an indicated field probable error of plus or minus 0.012 foot per mile of leveling as determined from over 600 conditions of closure. However, many years experience in vertical control in the greater Los Angeles basin and Antelope Valley indicate that because of varying degrees of subsidence and heaving, the true datum is recovered only by obtaining substantial agreement of a number of bench marks.

The users of this net are invited to assist in its maintenance by notifying this Department of cases of obliteration, apparent mistakes in descriptions or elevations, and proven disturbance of bench marks.

DATUM: U. S. Coast and Geodetic Survey Sea Level Datum
of 1929, through the medium of the Los Angeles
County Engineer Precise Level Net.

ABBREVIATIONS USED IN BENCH MARK LISTINGS

ABUT - - - - -	Abutment	EC - - - - -	End of Curve
ALG - - - - -	Along	ENT - - - - -	Entrance
ANG PT - - - - -	Angle Point	FL - - - - -	Floor
B/W - - - - -	Back of Walk	FTG - - - - -	Footing
BCR - - - - -	Beginning of Curb Return	FRWY - - - - -	Freeway
BC - - - - -	Beginning of Curve	F/W - - - - -	Front of Walk
BLDG - - - - -	Building	GAR - - - - -	Garage
EM - - - - -	Bench Mark	HDWL - - - - -	Headwall
BT SPK - - - - -	Boat or Bolt Spike	HSE - - - - -	House
BR CAP - - - - -	Brass or Bronze Cap	HWY - - - - -	Highway
C B - - - - -	Catch Basin	INT - - - - -	Intersection
CTR - - - - -	Center	IP - - - - -	Iron Pipe
C/L - - - - -	Center Line	LT - - - - -	Left
C/L INT - - - - -	Center Line Intersection	LACE - - - - -	L. A. City Engineer
C/L PROD - - - - -	Center Line Produced	LACS - - - - -	L. A. Co. Engineer
CONC - - - - -	Concrete	LAFC - - - - -	L. A. Co. Flood Control
COR - - - - -	Corner	L&BN - - - - -	Lead and Bench Nail
COE - - - - -	Corps of Engineers	L&BR - - - - -	Lead and Brad
CULV - - - - -	Culvert	L&N - - - - -	Lead and Nail
CYN - - - - -	Canyon	L&SPK - - - - -	Lead and Spike
CB - - - - -	Curb	L&T - - - - -	Lead and Tack
CS MON - - - - -	Co. Engineer Monument	MCR - - - - -	Middle of Curb Return
CT SPK - - - - -	Cut Spike	MKD - - - - -	Marked
DR - - - - -	Drive or Driveway	MC - - - - -	Middle of Curve
E/O - - - - -	East of	MON - - - - -	Monument
ECR - - - - -	End of Curb Return	N/O - - - - -	North of

ABBREVIATIONS USED IN BENCH MARK LISTINGS . . . CONTINUED

NR - - - - - Near
OPP - - - - - Opposite
PI - - - - - Point of Intersection
PK&W - - - - - PK Nail and Washer
P/L - - - - - Property Line
POST - - - - - Point on Semi-Tangent
PP - - - - - Power Pole
PVMT - - - - - Pavement
PROD - - - - - Produced
RD - - - - - Road
RDEM - - - - - Road Dept. Bench Mark
RDEM TAG - - - - - Road Dept. Bench Mark Tag
RR - - - - - Railroad
RT - - - - - Right
R/W - - - - - Right of Way
SDMH - - - - - Storm Drain Manhole
SMH - - - - - Sewer Manhole
SPK - - - - - Spike
ST&W - - - - - Spike Tin and Washer
S/O - - - - - South of
TP - - - - - Telephone Pole
USC&GS - - - - - U. S. Coast and Geodetic Survey
USGS - - - - - U. S. Geological Survey
WK - - - - - Walk
W/O - - - - - West of

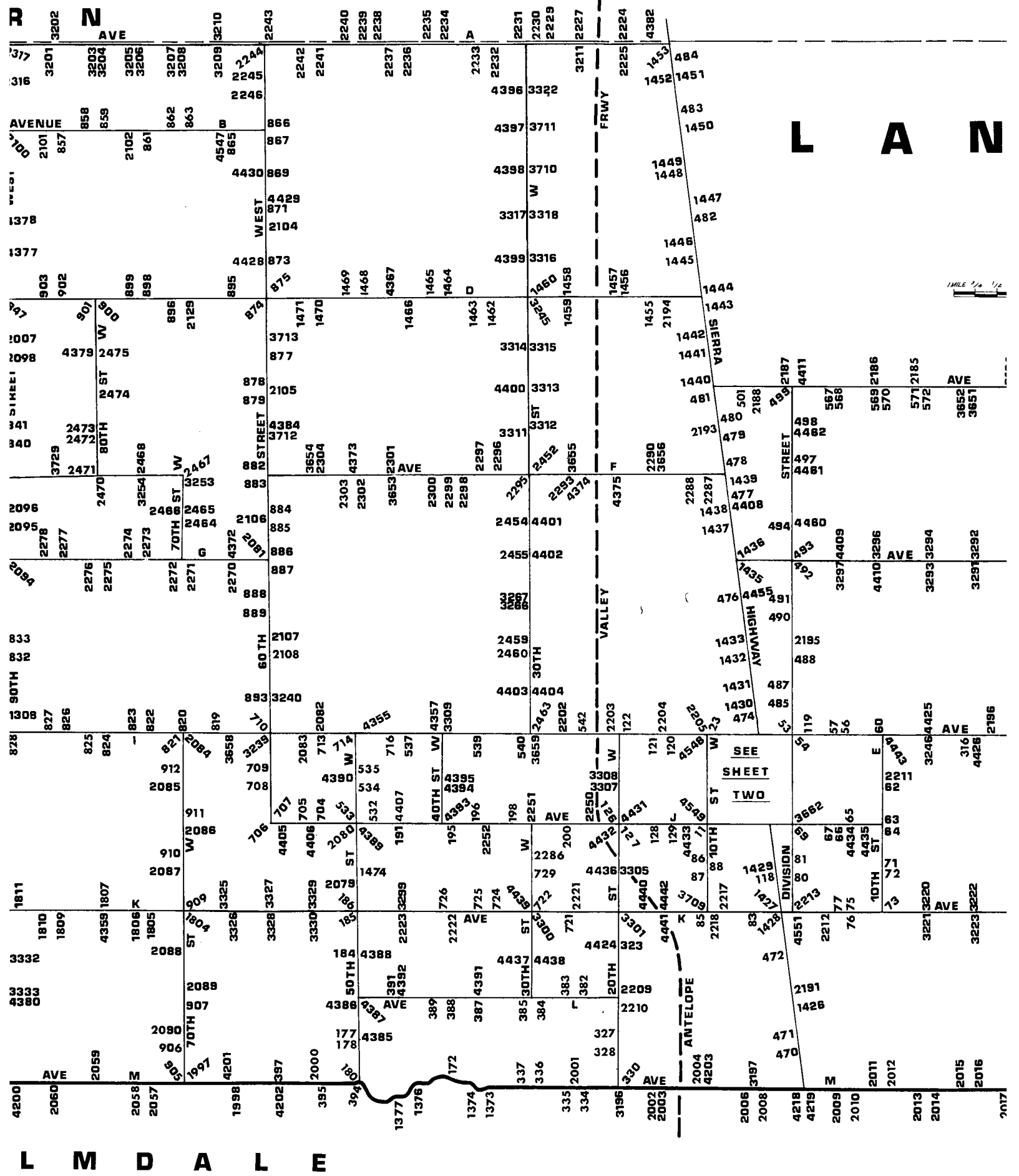

L A N



SEE SHEET TWO

DIVISION

ANTELOPE

FRWY

VALLEY

R N AVE
317
316
3201
3202
3203
3204
3205
3206
3207
3208
3209
3210
2242
2241
2240
2239
2238
2237
2236
2235
2234
2233
2232
2231
2230
2229
2227
2224
4382

AVENUE

1378
1377

903
902
899
898

341
340

2096
2095

833
832

1308
828

1811
1810
1809

3332
3333
3380

4200
2060

2058
2057

1998
4202
395

858
859
862
863
4547
865
866
867
869
871
872
873
875
879
1471
1470
1469
1468
4367
1466
1465
1464
1463
1462
3225
3224
3223
3222
3221
3220
3219
3211
2225
2224
4382

2101
857
2102
861

907
900

2007
2098

3729
2471

2278
2277

827
826

825
824

911
910

1806
1805

2088
2089

2059
2090
906

4201
4202
395

2246
4430
4428
2104
873
875
879
878
879
883
884
885
886
887
888
889
2106
2107
2108
893
3240
710
2082
4355
716
537
4357
3309
539
540
3659
2251
198
2252
195
196
197
198
2251
2286
200
729
722
721
2221
4438
3305
3304
4441
4442
4443
85
2218
2217
1429
1428
4551
2212
76
75
2011
2012
2013
2014
2015
2016

4430
4428
2104
873
875
879
878
879
883
884
885
886
887
888
889

3713
877
2105
878
879
883
884
885
886
887

2096
2095

827
826

825
824

911
910

1806
1805

2088
2089

2059
2090
906

4201
4202
395

2246
4430
4428
2104
873
875
879
878
879
883
884
885
886
887
888
889
2106
2107
2108
893
3240
710
2082
4355
716
537
4357
3309
539
540
3659
2251
198
2252
195
196
197
198
2251
2286
200
729
722
721
2221
4438
3305
3304
4441
4442
4443
85
2218
2217
1429
1428
4551
2212
76
75
2011
2012
2013
2014
2015
2016

4430
4428
2104
873
875
879
878
879
883
884
885
886
887
888
889

3713
877
2105
878
879
883
884
885
886
887

2096
2095

827
826

825
824

911
910

1806
1805

2088
2089

2059
2090
906

4201
4202
395

2246
4430
4428
2104
873
875
879
878
879
883
884
885
886
887
888
889
2106
2107
2108
893
3240
710
2082
4355
716
537
4357
3309
539
540
3659
2251
198
2252
195
196
197
198
2251
2286
200
729
722
721
2221
4438
3305
3304
4441
4442
4443
85
2218
2217
1429
1428
4551
2212
76
75
2011
2012
2013
2014
2015
2016

4430
4428
2104
873
875
879
878
879
883
884
885
886
887
888
889

3713
877
2105
878
879
883
884
885
886
887

2096
2095

827
826

825
824

911
910

1806
1805

2088
2089

2059
2090
906

4201
4202
395

2246
4430
4428
2104
873
875
879
878
879
883
884
885
886
887
888
889
2106
2107
2108
893
3240
710
2082
4355
716
537
4357
3309
539
540
3659
2251
198
2252
195
196
197
198
2251
2286
200
729
722
721
2221
4438
3305
3304
4441
4442
4443
85
2218
2217
1429
1428
4551
2212
76
75
2011
2012
2013
2014
2015
2016

4430
4428
2104
873
875
879
878
879
883
884
885
886
887
888
889

3713
877
2105
878
879
883
884
885
886
887

2096
2095

827
826

825
824

911
910

1806
1805

2088
2089

2059
2090
906

4201
4202
395

2246
4430
4428
2104
873
875
879
878
879
883
884
885
886
887
888
889
2106
2107
2108
893
3240
710
2082
4355
716
537
4357
3309
539
540
3659
2251
198
2252
195
196
197
198
2251
2286
200
729
722
721
2221
4438
3305
3304
4441
4442
4443
85
2218
2217
1429
1428
4551
2212
76
75
2011
2012
2013
2014
2015
2016

4430
4428
2104
873
875
879
878
879
883
884
885
886
887
888
889

3713
877
2105
878
879
883
884
885
886
887

2096
2095

827
826

825
824

911
910

1806
1805

2088
2089

2059
2090
906

4201
4202
395

2246
4430
4428
2104
873
875
879
878
879
883
884
885
886
887
888
889
2106
2107
2108
893
3240
710
2082
4355
716
537
4357
3309
539
540
3659
2251
198
2252
195
196
197
198
2251
2286
200
729
722
721
2221
4438
3305
3304
4441
4442
4443
85
2218
2217
1429
1428
4551
2212
76
75
2011
2012
2013
2014
2015
2016

4430
4428
2104
873
875
879
878
879
883
884
885
886
887
888
889

3713
877
2105
878
879
883
884
885
886
887

2096
2095

827
826

825
824

911
910

1806
1805

2088
2089

2059
2090
906

4201
4202
395

2246
4430
4428
2104
873
875
879
878
879
883
884
885
886
887
888
889
2106
2107
2108
893
3240
710
2082
4355
716
537
4357
3309
539
540
3659
2251
198
2252
195
196
197
198
2251
2286
200
729
722
721
2221
4438
3305
3304
4441
4442
4443
85
2218
2217
1429
1428
4551
2212
76
75
2011
2012
2013
2014
2015
2016

4430
4428
2104
873
875
879
878
879
883
884
885
886
887
888
889

3713
877
2105
878
879
883
884
885
886
887

2096
2095

827
826

825
824

911
910

1806
1805

2088
2089

2059
2090
906

4201
4202
395

2246
4430
4428
2104
873
875
879
878
879
883
884
885
886
887
888
889
2106
2107
2108
893
3240
710
2082
4355
716
537
4357
3309
539
540
3659
2251
198
2252
195
196
197
198
2251
2286
200
729
722
721
2221
4438
3305
3304
4441
4442
4443
85
2218
2217
1429
1428
4551
2212
76
75
2011
2012
2013
2014
2015
2016

4430
4428
2104
873
875
879
878
879
883
884
885
886
887
888
889

3713
877
2105
878
879
883
884
885
886
887

2096
2095

827
826

825
824

911
910

1806
1805

2088
2089

2059
2090
906

4201
4202
395

1377
1378
1374
1373

335
334
3196
2002
2003

2006
2008
4218
4219
2009
2010
2013
2014
2015
2016

LANCASTER WEST QUAD

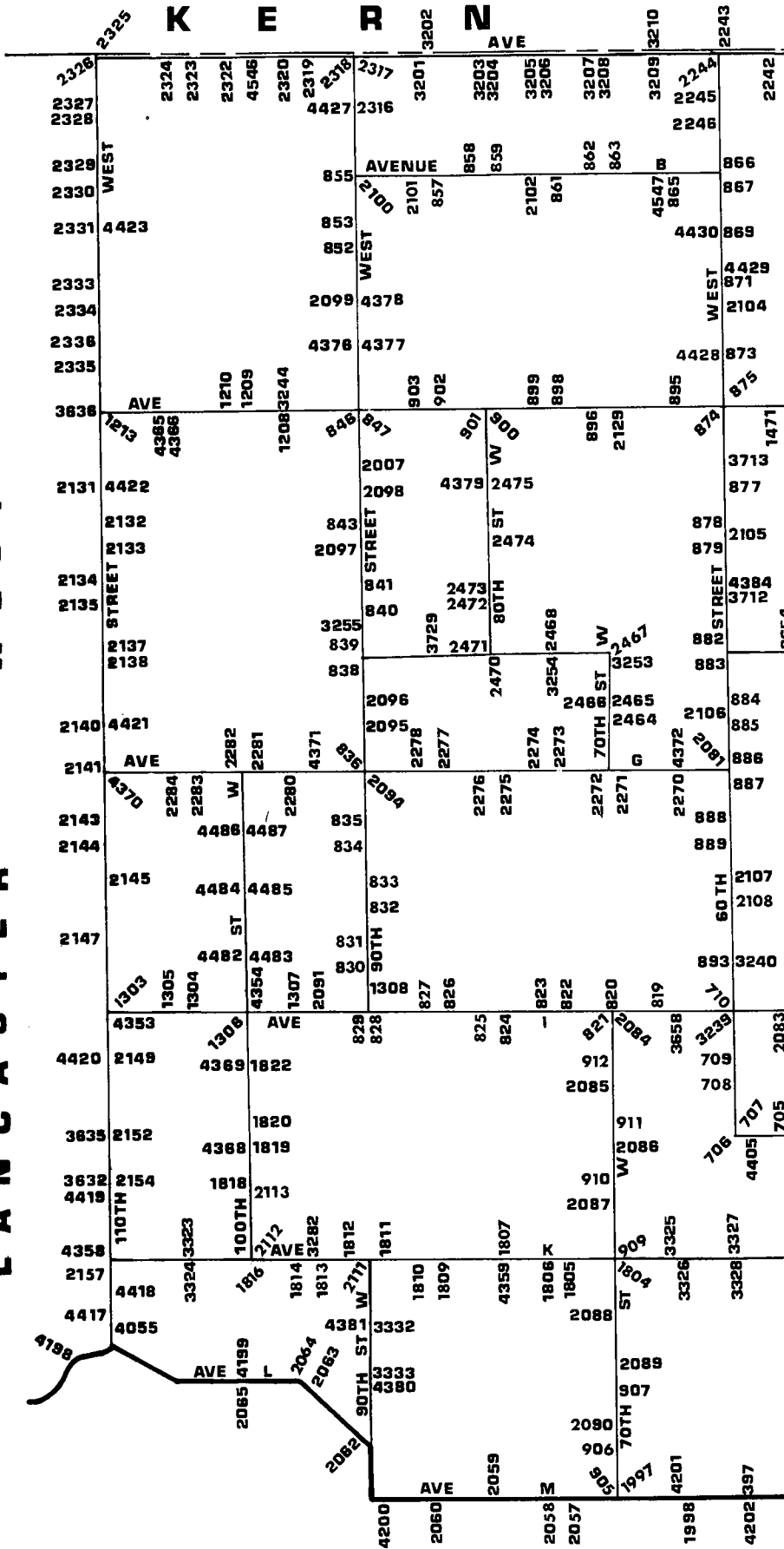

PALMDALE

LANCASTER (SHEET 2)

QUAD

1-20-78

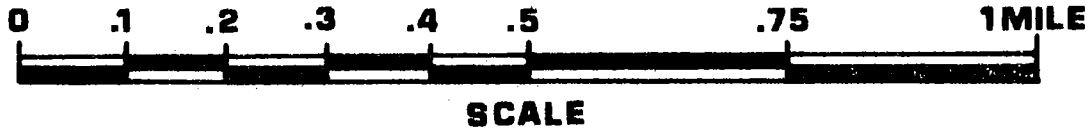
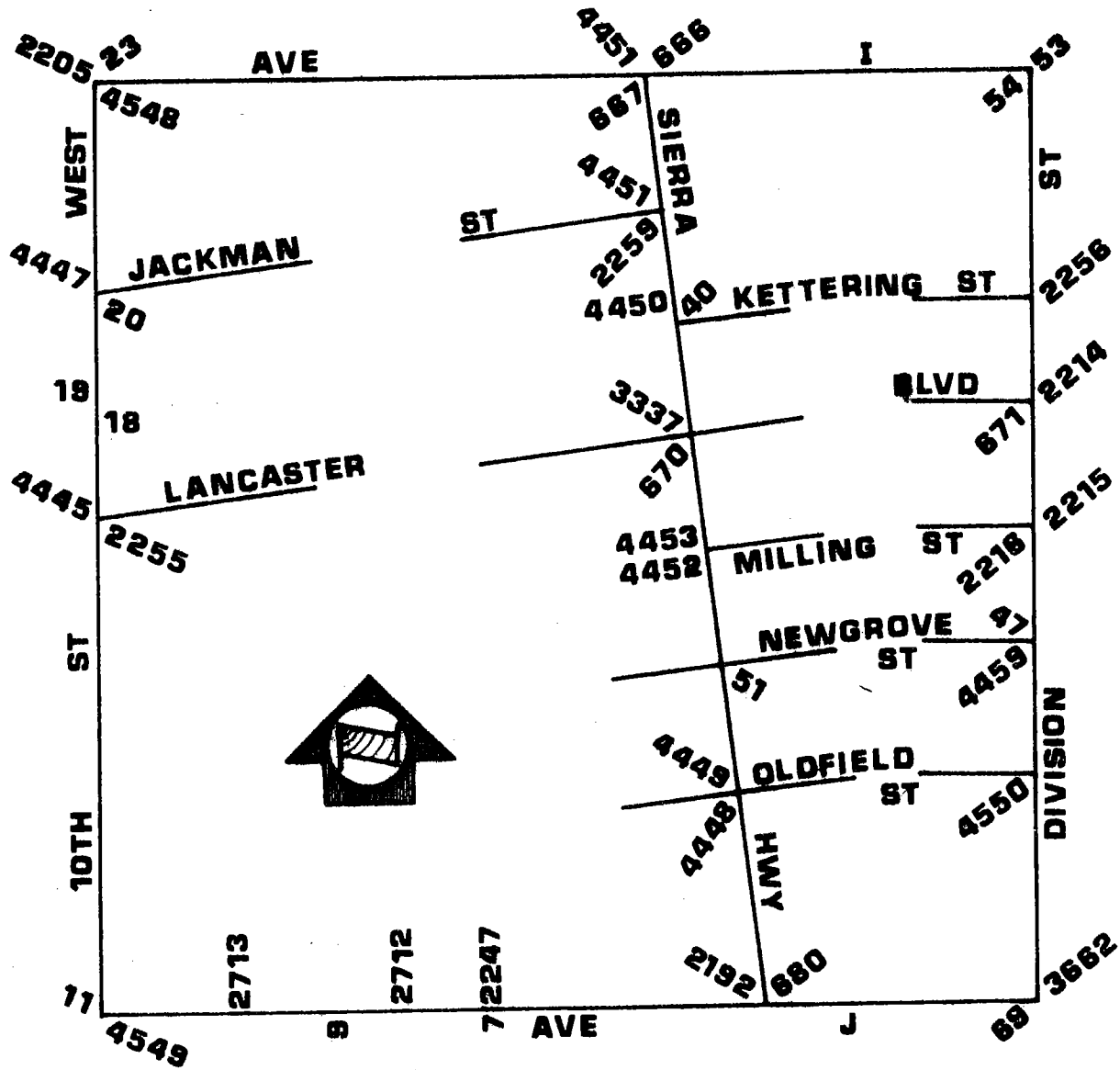

QUAD-YEAR	ELEV	DESCRIPTION (INCLUDE QUAD AND YEAR IN DESCRIPTION)	BM NUMBER
LANCASTR (1975)	2368.179	L&BN W CB 1FT N BCR @ NW COR ELM AVE & AVE J 18FT W & 66FT N C/L INT	CL 70
LANCASTR (1975)	2366.509	WLY L&T S CB AVE J 60FT S C/L ON C/L PROD FERN AVE IN FRONT OF PARK VIEW SCHOOL	CL 90
LANCASTR (1975)	2359.807	L&BN MCR SW COR AVE J & TENTH ST W 57FT S & 50FT W C/L INT	CL 110
LANCASTR (1975)	2337.052	L&BN W CB 10TH ST W 28FT W C/L 3FT N OF S P/L BLDG 44913 & 570FT S JACKMAN ST 3FT N PP 271449E	CL 180
LANCASTR (1975)	2336.330	L&BN E CB 10TH ST W 28FT E C/L & 86FT N OF N EDGE DRWY BLDG 44902 480FT S JACKMAN ST	CL 190
LANCASTR (1975)	2334.590	L&T IN CB RET 10FT N BCR @ SW COR 10TH ST W & JACKMAN ST 33FT S & 30FT W C/L INT	CL 200
LANCASTR (1975)	2329.113	L&T MCR @ NW COR AVE I & 10TH ST W 50FT N & 39FT W C/L INT	CL 23
LANCASTR (1975)	2345.363	L&BRAD E CB SIERRA HWY 30FT E C/L & 25FT N C/L KETTERING ST	CL 400
LANCASTR (1975)	2363.349	CS MON IN WELL 21IN DN @ C/L INT DIVISION ST & NEWGROVE ST MKD (CO SUR RE 2177) W EDGE	CL 470
LANCASTR (1975)	2361.363	L&BN E CB SIERRA HWY 25FT E C/L & 115FT S C/L PROD NEWGROVE ST 16FT S OF END CB	CL 510
LANCASTR (1975)	2343.406	L&T NR MCR NW COR AVE I & DIVISION ST 42FT N & 43FT W/O C/L INT	CL 530
LANCASTR (1975)	2343.465	L&T NR MCR SW COR AVE I & DIVISION ST 42FT S & 44FT W/O C/L INT	CL 540
LANCASTR (1975)	2352.944	CSBM MON IN CONC FLUSH 1FT N OF N CB & 19FT W BCR @ NW COR 5TH ST E & AVE I 41FT N & 82FT W C/L INT MKD (BM 105-20 1958)	CL 560
LANCASTR (1975)	2352.790	L&T N CB 3FT W/O BCR 40FT N & 66FT W/O C/L INT AVE I & 5TH ST E	CL 570
LANCASTR (1975)	2359.950	USC&GS BR CAP 78FT W & 40FT S C/L INT AVE I & 10TH ST E MKD (Y 488 RESET 1961)	CL 600
LANCASTR (1975)	2380.492	L&T W EDGE OF CONC GARAGE APRON TO HSE NO 1016 LANCASTER BLVD 49FT S C/L & 145 FT E C/L 10TH ST E	CL 620
LANCASTR (1975)	2397.226	L&T NR MCR @ SW COR 10TH ST E & AVE J 48FT W & 45FT S C/L INT	CL 630

QUAD-YEAR	ELEV	DESCRIPTION (INCLUDE QUAD AND YEAR IN DESCRIPTION)	BM NUMBER
LANCASTR (1975)	2396.157	CS MON IN WELL 18IN DN @ C/L INT AVE J & 10TH ST E MKD (CO SUR 14 13 23 24 T7N R12W RE 5869) USE E EDGE	CL 640
LANCASTR (1975)	2390.898	CS MON IN WELL 10IN DN @ C/L INT AVE J & 5TH ST E MKD (1/4 COR 14 23 T7N R12W RE 5869) USE E EDGE	CL 650
LANCASTR (1975)	2384.174	L&BN @ MCR SE COR 4TH ST E & AVE J 80FT S & 24FT E C/L INT	CL 660
LANCASTR (1975)	2383.263	L&BN @ MCR SE COR KIRKLAND AVE & AVE J 75FT S & 27FT E C/L INT	CL 670
LANCASTR (1975)	2379.652	CS MON IN WELL 14IN DN @ C/L INT AVE J & DIVISION ST MKD (CO SUR 15 14 22 23 T7N R12W 1927) USE N EDGE	CL 690
LANCASTR (1975)	2413.174	L&T E SIDE 36IN STANDPIPE 215FT W C/L 10TH ST E & 5FT N C/L AVE J-8 263FT NW PP 917614E	CL 710
LANCASTR (1975)	2413.813	CS MON IN WELL 8IN DN @ C/L INT 10TH ST E & AVE J-8 0.5 MI S AVE J MKD (T7N, R12W 1/4 COR, 23-24) (W EDGE)	CL 720
LANCASTR (1975)	2434.427	CS MON IN WELL 15IN DN @ C/L INT 10TH ST E & AVE K MKD (CO SUR 23 24 25 26 T7N R12W) N EDGE	CL 73
LANCASTR (1975)	2425.754	CS MON IN WELL 9IN DN @ C/L INT AVE K & 6TH ST E MKD (RE 5869) W EDGE	CL 75
LANCASTR (1975)	2426.371	CS MON IN CONC POST 3IN UP 40FT S & 55FT W C/L INT AVE K & 6TH ST E MKD (BM 105-9 1958)	CL 76
LANCASTR (1975)	2425.307	CHIS X IN TOP OF BOLT ON W SIDE OF FIRE HYDRANT BASE 24FT S & 40FT W C/L INT AVE K & 5TH ST E 135FT W DRWY TO HSE 504	CL 77
LANCASTR (1975)	2400.281	L&BN @ MCR @ NE COR DIVISION ST & AVE J-8 28FT N & 41FT E C/L INT	CL 800
LANCASTR (1975)	2399.047	L&BN @ MCR SE COR DIVISION ST & AVE J-7 36FT S & 35FT E C/L INT	CL 810
LANCASTR (1975)	2413.834	CS MON IN WELL 18IN DN @ C/L INT AVE K & 5TH ST W MKD (CO SUR 1/4 SEC COR 22 27 T7N R12W) N SIDE	CL 83
LANCASTR (1975)	2405.153	L&BN @ NE COR OF SO CAL GAS CO VALVE BOX 44FT N C/L AVE K & 115FT W C/L 10TH ST W	CL 85

QUAD-YEAR	ELEV	DESCRIPTION (INCLUDE QUAD AND YEAR IN DESCRIPTION)	BM NUMBER
LANCASTR (1975)	2380.407	CS MON IN WELL 14IN DN @ C/L INT 10TH ST W & AVE J-8 MKD (CO SUR 1/4 SEC COR 21 22 T7N R12W) W EDGE	CL 86
LANCASTR (1975)	2380.657	L&T 1FT N BCR @ NE COR 10TH ST W & AVE J-8 51FT N & 30FT E C/L INT	CL 87A
LANCASTR (1975)	2376.887	L&T S CB AVE J-6 1FT E BCR @ SE COR 10TH ST W & AVE J-6 18FT S & 65FT E C/L INT	CL 88D
LANCASTR (1975)	2397.101	USC&GS DISK IN CONC 6IN DN 60FT E & 125FT S C/L INT SIERRA HWY & AVE J-8 MKD (S 811 1947 RESET 1955)	CL 118D
LANCASTR (1975)	2345.488	USC &GS BRASS DISC FLUSH 16FT W & 41FT N/O C/L INT AVE I & 2ND ST E MKD (X-488 1955)	CL 119D
LANCASTR (1975)	2323.798	L&T IN N SERVICE ROAD CB @ NE COR AVE I & 15TH ST W 51FT E & 80FT N C/L INT	CL 120D
LANCASTR (1975)	2324.033	RDBM TAG IN S SERVICE ROAD CB @ SW COR AVE I & 15TH ST W 51FT W & 80FT S C/L INT	CL 121D
LANCASTR (1975)	2321.613	CS MON 5IN UP @ NE COR AVE I & 20TH ST W 40FT N & 66FT E C/L INT MKD (BM 102-3 1957)	CL 122D
LANCASTR (1975)	2349.332	RDBM TAG 6FT W BCR @ SW COR AVE J & 15TH ST W 66FT W & 30FT S C/L INT	CL 128D
LANCASTR (1975)	2350.082	RDBM TAG 40FT S BCR @ SE COR AVE J & 15TH ST W 100FT S & 30FT E C/L INT	CL 129D
BASELINE (1973)	2494.020	USC&GS DISK IN CONC POST 92FT N & 65FT W C/L INT AVE M & 40TH ST W MKD (F 489 1955)	CL 172
LANCASTR (1975)	2461.796	L&T NE COR CONC SLAB 100FT W & 66FT S C/L INT 50TH ST W & AVE L-8	CL 177
LANCASTR (1975)	2477.842	L&T CONC WLK IN FR OF CHURCH 45FT N & 65FT W C/L INT 50TH ST W & AVE L-12	CL 178
BASELINE (1973)	2495.190	L&T IN CONC SLAB 1.5FT S/O SW COR PORCH HSE NO. 42002, 50TH ST W 48FT N & 66FT E/O C/L INT 50TH ST W & AVE M	CL 180
LANCASTR (1975)	2410.012	CS MON (E EDGE) IN WELL 18IN DN @ C/L INT 50TH ST W & AVE K-8 MKD (CO SUR 1/4 COR 25, 26, T7N R13W, 1928)	CL 184
LANCASTR (1975)	2379.924	CS MON (W EDGE) IN WELL 16 IN DN @ C/L INT 50 TH ST W & AVE K MKD (CO SUR 23, 24, 25, 26, T7N, R13W, 1927)	CL 185

QUAD-YEAR	ELEV	DESCRIPTION (INCLUDE QUAD AND YEAR IN DESCRIPTION)	BM NUMBER
LANCASTR (1975)	2382.150	L&T NW COR CONC PORCH HSE NO 4849 AVE K 115FT E & 120FT N C/L INT AVE K & 50TH ST W	CL 186
LANCASTR (1975)	2350.167	RDBM TAG S SIDE WIER BOX 97FT E & 85FT N C/L INT AVE J & 45TH ST W (TO THE N)	CL 191
LANCASTR (1975)	2343.517	CS MON IN WELL 13IN DN @ C/L INT AVE J & 40TH ST W MKD (T7N R12 W R13W 13 18 24 19 RE 5869) USE N EDGE	CL 195
LANCASTR (1975)	2340.999	L&T CONC WALK IN FRONT OF CHURCH @ NE COR AVE J & 35TH ST W 130FT N & 170FT E C/L INT MKD (BM)	CL 196
LANCASTR (1975)	2341.550	L&T IN SE COR CONC PORCH TO HSE NO 3129 W AVE J 75FT N & 895FT W/O C/L INT 30TH ST W	CL 198
LANCASTR (1975)	2338.217	CS MON IN WELL 21IN DN @ C/L INT AVE J & 25TH ST W MKD (CO SUR 1/4 SEC COR 17 20 T7N R12W) N EDGE	CL 200
LANCASTR (1975)	2441.061	CS MON IN WELL 15IN DN @ C/L INT 90TH ST E & AVE J MKD (CO SURV 18 17 19 20 T7N R10W 1926) USE S EDGE	CL 271D
LANCASTR (1975)	2423.929	CS MON IN WELL 20IN DN @ C/L INT 90TH ST E & AVE I-8 MKD (CO SURV 1/4 SEC COR 17 18 T7N R10W) USE S EDGE	CL 274D
LANCASTR (1975)	2411.406	CSMON IN WELL 12IN DN @ C/L INT 90TH ST E & AVE I MKD (CO SURV 7 8 17 18 T7N R10W) USE N EDGE	CL 278D
LANCASTR (1975)	2399.233	CS BM MON 2IN UP 39FT S & 70FT W C/L INT AVE I & 70ST E MKD (BM 107-30 1961)	CL 283D
LANCASTR (1975)	2409.743	CS MON IN CONC SQ 2IN UP 1FT N TP NO K3143Y 30FT N C/L AVE I & 27FT W C/L PROP 85TH ST E MKD (BM 107-27 1961)	CL 284D
LANCASTR (1975)	2412.208	CS MON 2FT S PP NO 991781E 30FT S C/L AVE I & 47FT W C/L 80TH ST E MKD (BM 107-28 1961)	CL 285D
LANCASTR (1975)	2392.965	RDBM TAG @ CTR OF OLD CONC BASE OF MTR MOUNT 40FT W C/L 90TH ST E & 100FT N C/L AVE H	CL 287D
LANCASTR (1975)	2409.501	RDBM TAG @ SE COR CONC SLAB (OLD WATER TOWER) @ NW COR AVE I & PROP 85TH ST E 60FT N & 20FT W/O C/L INT	CL 289D
LANCASTR (1975)	2415.581	RDBM TAG TOP OF CONC SUPPORT OF LGE WATER TANK 90FT N C/L AVE I & 45FT W C/L 80TH ST E	CL 290D

QUAD-YEAR	ELEV	DESCRIPTION (INCLUDE QUAD AND YEAR IN DESCRIPTION)	BM NUMBER
LANCASTR (1975)	2402.240	CSBM MON FLUSH 25FT S C/L AVE I & 25FT W C/L 75TH ST E 15FT W PP 482159E MKD (BM 107-29 1961)	CL 294D
LANCASTR (1975)	2396.935	CS MON IN CONC 2IN UP 33FT S C/L AVE I & 142FT W C/L 65TH ST E 3FT S PP NO 1121124 MKD (BM 107- 31 1961)	CL 297D
LANCASTR (1975)	2399.979	RDBM TAG TOP OF CONC WEIR BOX 35FT N C/L AVE I 400FT E/O 65TH ST E	CL 298D
LANCASTR (1975)	2398.820	L&T E CB DRWY HSE NO 6007 AVE I 40FT N & 100FT E C/L INT E AVE I & 60TH ST E	CL 299D
LANCASTR (1975)	2384.581	2IN IP 1FT ABOVE GROUND 40FT S OF C/L INT AVE I & 45TH ST E (USE E EDGE)	CL 305D
LANCASTR (1975)	2382.961	L&T NE COR CONC WLK HSE NO 4010 AVE I 90FT S & 140FT E C/L INT AVE I & 40TH ST E	CL 307D
LANCASTR (1975)	2381.248	L&T SE COR CONC SLAB @ NE COR BLDG NO 3606 AVE I 82FT S C/L & 150FT E C/L 36TH ST E	CL 309D
LANCASTR (1975)	2375.562	CS MON IN WELL @ C/L INT AVE I & 25TH ST E MKD (T7N, R11W, 1/4 COR 7-18)(E EDGE)	CL 313
LANCASTR (1975)	2372.378	L&T SE COR OF CONC APRON OF GAS STA 55FT N C/L AVE I & 65FT W C/L 20TH ST E	CL 316
LANCASTR (1975)	2413.879	CS MON IN WELL 20IN DN @ C/L INT 20TH ST W & AVE K-8 MKD (SUR 1/4 SEC COR 29 28 T7N R12W) N EDGE	CL 323
LANCASTR (1975)	2480.485	L&T IN CONC SLAB IN FRONT OF DOOR TO HSE 42423 20TH ST W 100FT W C/L & 250FT N C/L AVE L-8	CL 327
LANCASTR (1975)	2481.968	CS MON IN WELL 22IN DN @ C/L INT 20TH ST W & AVE L-8 MKD (CO SUR 1/4 SEC COR 32 33 T7N R12W)	CL 328
BASELINE (1973)	2523.094	USC&GS BRASS DISK IN TOP OF CONC POST 4IN UP 208FT E OF C/L 20TH ST W & 33FT N C/L AVE M MKD (D 489 1955)	CL 330
BASELINE (1973)	2518.075	CS MON IN WELL 18IN DN @ C/L INT AVE M & 25TH ST W MKD (1/4 COR 32 5 T6N R12W)	CL 334
BASELINE (1973)	2523.214	L&T IN SE COR OF CONC DR TO HSE NO 2524 AVE M 140FT S C/L & 215FT W C/L 25TH ST W	CL 335
BASELINE (1973)	2520.107	USC&GS MON TOP OF CONC POST 4IN UP 300FT E C/L 30TH ST W & 34FT N C/L AVE M 6FT W PP NO 1054594E MKD (E 489 1955)	CL 336

QUAD-YEAR	ELEV	DESCRIPTION (INCLUDE QUAD AND YEAR IN DESCRIPTION)	BM NUMBER
BASELINE (1973)	2514.806	CS MON IN WELL @ C/L INT AVE M & 30TH ST W MKD (SEC COR 31 32 5 6 T7N T6N R12W)	CL 337
LANCASTR (1975)	2448.604	CS MON IN WELL 21IN DN @ C/L INT AVE L & 25TH ST W MKD (CO SUR 1/4 SEC COR 29, 32, T7N, R12W)	CL 382
LANCASTR (1975)	2448.798	L&T IN BOTTOM STEP @ W EDGE OF CONC STEPS TO HSE NO 2507 AVE L 73FT N C/L & 78FT W C/L 25TH ST W	CL 383
LANCASTR (1975)	2441.097	CS MON IN WELL 13IN DN @ C/L INT AVE L & 30TH ST W MKD (CO SUR 29, 30, 31, 32, T7N, R12W)	CL 384
LANCASTR (1975)	2441.135	L&T E EDGE CONC DR 75FT S & 195FT W C/L INT AVE L & 30TH ST W	CL 385
LANCASTR (1975)	2433.248	CS MON IN WELL 10 IN DN @ C/L INT AVE L & 35TH ST W MKD (1/4 COR 30, 31, T7N, R12W, RE5869) (E EDGE)	CL 387
LANCASTR (1975)	2428.278	CS MON IN WELL 10IN DN @ C/L INT AVE L & 40TH ST W MKD (T7N, R12W, R13W, 25, 30, 36, 31, RE 5869) (SE EDGE)	CL 388
LANCASTR (1975)	2431.834	L&T IN W EDGE 2FT CONC WALK 50FT S & 110FT W/O C/L INT AVE L & 40TH ST W	CL 389
LANCASTR (1975)	2428.327	USGS MON @ NW COR AVE L & 45TH ST W 38FT N & 37FT W C/L INT MKD (R 49 1929 RESET 1942)	CL 391
BASELINE (1973)	2491.198	CS MON IN WELL 14IN DN @ C/L INT AVE M & 50TH ST W MKD (CO SUR 35 36 2 1 T7N T6N R13W 1927) (W EDGE)	CL 394
BASELINE (1973)	2496.524	CS MON IN WELL 18IN DN @ C/L INT OF AVE M & 55TH ST W MKD (CO SUR 1/4 COR SEC 35, 2 R-13W T-7N T-6N USE S EDGE)	CL 395
BASELINE (1973)	2513.813	CS MON IN WELL 22IN DN @ C/L INT OF AVE M & 60TH ST W MKD (SEC COR 34 35 3 2 T7N T6N R13W)	CL 397
LANCASTR (1975)	2381.930	CS MON IN WELL 18IN DN @ C/L INT 60TH ST E & AVE H-8 PROP MKD (CO SUR 1/4 SEC COR 10 11 T7N R11W) S EDGE	CL 411D
LANCASTR (1975)	2384.906	RDBM TAG IN SE COR CONC WEIR BOX @ HSE NO 45609 60TH ST E 110FT W C/L & 55FT N C/L AVE H-8 PROP	CL 412D
LANCASTR (1975)	2369.410	CS MON IN WELL 18IN DN @ C/L INT 60TH ST E & AVE H MKD (CO SUR 2 3 10 11 T7N R11W) S EDGE	CL 413D

QUAD-YEAR	ELEV	DESCRIPTION (INCLUDE QUAD AND YEAR IN DESCRIPTION)	BM NUMBER
LANCASTR (1975)	2359.670	CS MON IN WELL 23IN DN @ C/L INT 60TH E & AVE G-8 MKD (CO SUR 1/4 SEC COR 2 3 T7N R11W) N EDGE	CL 415D
LANCASTR (1975)	2360.925	L&T NR S EDGE OF CONC WK 145FT N & 130FT W C/L INT 60TH ST E & AVE G-8	CL 416D
LANCASTR (1975)	2351.605	CS MON IN WELL 20IN DN @ C/L INT AVE G & 60TH ST E MKD (CO SUR 2 3 34 35 T7N T8N R11W) USE N EDGE	CL 417D
LANCASTR (1975)	2343.550	CS MON IN WELL 24IN DN @ C/L INT 60TH ST E & AVE F-8 MKD (CO SUR 1/4 COR 34 35 T8N R11W)	CL 420D
LANCASTR (1975)	2336.360	RD MON IN WELL 8IN DN @ SW COR AVE F & 60TH ST E 47FT W & 25FT S C/L INT MKD (1958)	CL 422D
LANCASTR (1975)	2338.493	RD MON IN WELL @ NE COR AVE F & 65TH ST E 24FT N & 42 FT E C/L INT MKD (1958)	CL 424D
LANCASTR (1975)	2342.690	RD MON IN WELL @ NW COR AVE F & 70TH ST E 34FT N & 25FT W C/L INT MKD (1958)	CL 425D
LANCASTR (1975)	2343.133	CS MON IN WELL 8IN DN @ C/L INT AVE F & 70TH ST ST E MKD (26 25 35 36 R11W T8N RE 5869) N EDGE	CL 426D
LANCASTR (1975)	2346.856	L&BN ON E EDGE CONC FTG OF 36IN STANDPIPE 40FT N/O C/L AVE F & 31FT W/O C/L 75TH ST E PROP	CL 427D
LANCASTR (1975)	2345.419	CS MON IN WELL 12IN DN @ C/L INT AVE F & 75TH ST E MKD (CO SUR 1/4 COR 25 36 R11W T8N RE 2177) N EDGE	CL 428D
LANCASTR (1975)	2347.918	CS MON IN WELL 9IN DN @ C/L INT AVE F & 80TH ST E MKD (25 30 36 31 T8N R10W R11W RE 5869) W EDGE	CL 430D
LANCASTR (1975)	2353.572	CS MON 16IN DN @ C/L INT 90TH ST E & AVE F MKD (CO SURV 30 29 31 32 R10W T8N RE 2177) E EDGE	CL 434D
LANCASTR (1975)	2364.074	2IN IP CONC PLUG & BT SPK IN WELL 15IN DN @ C/L INT 90TH ST E & AVE F-8 (USE SPK)	CL 436D
LANCASTR (1975)	2373.241	RD MON IN WELL WITH CONC COLLAR @ SE COR 90TH ST E & AVE G 30FT E & 40FT S C/L INT MKD (1958)	CL 438D
LANCASTR (1975)	2497.672	USC&GS MON 3IN UP 60FT E C/L SIERRA HWY OPP BLDG NO 42445 2200FT S AVE L MKD (U 811 1947)	CL 470
LANCASTR (1975)	2486.467	USC&GS MON 12IN DN 60FT E C/L SIERRA HWY OPP BLDG NO 42607 1250FT S AVE L MKD (B 57 1926 RESET 1955)	CL 471

QUAD-YEAR	ELEV	DESCRIPTION (INCLUDE QUAD AND YEAR IN DESCRIPTION)	BM NUMBER
LANCASTR (1975)	2447.343	USC & GS MON 12IN DN 59FT E C/L SIERRA HWY & 75FT N C/L PROP AVE K-8 MKD (T811 1947)	CL 472
LANCASTR (1975)	2332.052	USGS MON DN 3IN IP FLUSH 49FT W/O SLY RAIL MAIN LINE SPRR 1199FT N/O C/L AVE I MKD (USGS 2335 1902) IN BACK OF 45354 SIERRA HWY	CL 474
LANCASTR (1975)	2317.009	USC&GS MON S EDGE HDWL CULV G 90&50 26FT W/O C/L SIERRA HWY & 0.3MI S AVE G MKD (Z 811 1947)	CL 476
LANCASTR (1975)	2304.913	USC&GS MON 10IN UP 34FT E C/L SIERRA HWY & 1450FT S AVE F MKD (Y 56 1926)	CL 477
LANCASTR (1975)	2301.771	USGS MON DN 3IN IP 8IN UP 85FT E C/L SIERRA HWY & 800FT N/O AVE F MKD (BM 33 2302B 1902)	CL 478
LANCASTR (1975)	2303.926	USGS TRI STA MON 15IN UP 227FT W C/L SIERRA HWY & 2200FT N AVE F MKD (OBAN 1929 LINT)	CL 479
LANCASTR (1975)	2301.128	USC&GS REF MON 8IN UP 227FT W C/L SIERRA HWY & 2280FT N AVE F MKD (OBAN NO 2 1941)	CL 480
LANCASTR (1975)	2300.473	USC&GS MON FLUSH W END S CONC ABUT OF RR BRIDGE 73FT N C/L AVE E & 121FT E C/L SIERRA HWY MKD (H 487 1955)	CL 481
LANCASTR (1975)	2303.630	USC&GS MON FLUSH TOP OF E END OF S CONC ABUT OF SPRR BRIDGE 88FT N C/L AVE C & 141FT E C/L SIERRA HWY MKD (J 487 1955)	CL 482
LANCASTR (1975)	2305.536	USC&GS MON FLUSH S END W HDWL CULV UNDER SPRR 35FT N C/L AVE B & 122FT E C/L SIERRA HWY MKD (N 487 1955)	CL 483
LANCASTR (1975)	2307.793	USC&GS MON FLUSH N END HDWL OF SPRR CULV 123FT E C/L SIERRA HWY & 213FT S/O C/L AVE A (KERN CO LINE) MKD (M 487-1955)	CL 484
LANCASTR (1975)	2333.720	RDBM TAG E CB 60FT S BCR @ SE COR DIVISION ST & AVE H-8 20FT E & 135FT S C/L INT	CL 485D
LANCASTR (1975)	2331.853	CS MON (N EDGE) IN WELL 18IN DN @ C/L INT AVE H-8 & DIVILION ST MKD (CO SUR 1/4 SEC COR 10 11 T7N R12W 1927)	CL 487D
LANCASTR (1975)	2332.951	CS MON 10IN DN @ C/L INT DIVISION ST & AVE H MKD (CO SUR 3 2 10 11 T7N R12W 1927) W EDGE	CL 488D
LANCASTR (1975)	2327.388	L&T NW COR CONC WK BLDG NO 46350 205FT S & 45FT E C/L INT DIVISION ST & AVE G-8	CL 490A

QUAD-YEAR	ELEV	DESCRIPTION (INCLUDE QUAD AND YEAR IN DESCRIPTION)	BM NUMBER
LANCASTR (1975)	2325.382	CS MON IN WELL 8IN DN @ C/L INT DIVISION ST & AVE G-8 MKD (1/4 COR 2 3 T7N R12W RE 5869) USE SE EDGE	CL 491
LANCASTR (1975)	2322.475	2IN IP CONC PLUG & NAIL 12IN UP @ SE COR AVE G & DIVISION ST 35FT S & 35FT E/O C/L INT USE E EDGE	CL 492
LANCASTR (1975)	2320.357	CS BR CAP MON IN WELL 18IN DN @ C/L INT DIVISION ST & AVE G MKD (CO SUR 34 35 3 2 T8N T7N R12W 1927)	CL 493
LANCASTR (1975)	2314.862	L&T @ NE COR CONC SLAB @ SIDE ENT N SIDE OF HSE NO 47159 DIVISION ST 100FT W C/L & 80FT S C/L AVE F-8	CL 494
LANCASTR (1975)	2306.126	CS MON IN WELL 17IN DN @ C/L INT AVE F & DIVISION ST MKD (CO SUR 26 27 34 35 T8N R12W RE 329)	CL 497
LANCASTR (1975)	2300.715	CS MON IN WELL 17IN DN @ C/L INT DIVISION ST & AVE E-8 MKD (CO SUR 1/4 COR 26 27 T8N R12W RE329)	CL 498
LANCASTR (1975)	2295.274	RD BM MON IN WELL 6IN DN @ SW COR DIVISION ST & AVE E 27FT W & 51FT S/O C/L INT 4FT WLY PP NO 1404026E MKD (1957)	CL 499
LANCASTR (1975)	2295.579	CS MON IN WELL 18IN DN @ C/L INT AVE E & 5TH ST W MKD (CO SUR 1/4 COR 22 27 T8N R12W RE 329) (N EDGE)	CL 501
LANCASTR (1975)	2348.676	RDBM TAG CONC SLAB NR 36IN STANDPIPE 40FT N C/L AVE J & 640FT E 50TH ST W	CL 532
LANCASTR (1975)	2348.013	CS MON IN WELL 24IN DN @ C/L INT AVE J & 50TH ST W MKD (CO SUR 14, 13, 23, 24, T7N, R13W)	CL 533
LANCASTR (1975)	2337.748	2IN IP 6IN DN 50FT S & 50FT E C/L INT 50TH ST W & AVE I-8	CL 534
LANCASTR (1975)	2337.665	2IN IP 6IN DN 50FT N & 50FT E C/L INT 50TH ST W & AVE I-8	CL 535
LANCASTR (1975)	2329.636	CSBM MON IN TOP 12IN CONC POST, 5IN UP, 89FT N C/L AVE I & 30FT E C/L 45TH ST W MKD (BM 102-9 1957)	CL 537
LANCASTR (1975)	2317.654	CSBM MON TOP 12IN POST 6IN UP 42FT N C/L AVE I & 63FT E C/L 35TH ST W, 39FT E OF DRVWY HSE 3355 & 25FT W PP NO. 865024E MKD (BM 102-7 1957)	CL 539

QUAD-YEAR	ELEV	DESCRIPTION (INCLUDE QUAD AND YEAR IN DESCRIPTION)	BM NUMBER
LANCASTR (1975)	2317.410	L&PK TOP NW COR N HDWL OF BRIDGE NO 53-406 22FT N C/L AVE I & 100FT E C/L 30TH ST W	CL 540
LANCASTR (1975)	2316.761	CS MON TOP CONC POST 4IN UP 86FT N C/L AVE I & 2FT W C/L 25TH ST W 4FT S PP 1162700E MKD (BM 102-5 1957)	CL 542
LANCASTR (1975)	2368.232	CS MON 12IN DN 40FT S/O C/L INT 30TH ST E & AVE H-8 MKD (1/4 COR 7 8 T7N R11W) USE E EDGE	CL 5540
LANCASTR (1975)	2358.851	CS MON 15IN DN @ C/L INT 30TH ST E & AVE H MKD (SEC COR 5 6 7 8 T7N R11W CO SUR RE 2177) USE S EDGE	CL 5560
LANCASTR (1975)	2352.791	2IN IP CONC PL & NAIL (PT UP) FL 50FT E/O C/L 30TH ST E & 50FT S/O C/L AVE G-8 USE SE RIM	CL 5570
LANCASTR (1975)	2349.832	CS MON 18IN DN @ C/L INT 30TH ST E & AVE G-8 MKD (1/4 SEC COR 6 7 T7N R11W) USE S EDGE	CL 5580
LANCASTR (1975)	2343.178	CS MON IN WELL 9IN DN @ C/L INT 30TH ST E & AVE G MKD (CO SUR 31 32 5 6 T7N T8N R11W) USE SW EDGE	CL 560A
LANCASTR (1975)	2334.955	CS MON 14IN DN @ C/L INT 30TH ST E & AVE F-8 MKD (1/4 SEC COR 31 32 CO SUR T8N R11W) S EDGE	CL 561
LANCASTR (1975)	2336.290	1 1/2 IN IP 50FT E/O C/L 30TH ST E & 50FT N/O C/L AVE F-8 (USE NE RIM)	CL 562
LANCASTR (1975)	2328.565	1 1/2 IN IP CONC PL & NAIL (PT UP) 47FT E/O C/L 30TH ST E & 47FT S/O C/L AVE F	CL 563
LANCASTR (1975)	2327.227	CS MON 20IN DN @ C/L INT 30TH ST E & AVE F MKD (CO SUR 29 30 31 32 T8N R11W RE329) USE E EDGE	CL 564
LANCASTR (1975)	2318.844	CS MON (E EDGE) IN WELL 15IN DN @ C/L INT 30TH ST E & AVE E-8 MKD (CO SUR 1/4 COR 29 30 T8N R11W 1925)	CL 566
LANCASTR (1975)	2296.422	RD BM MON IN WELL 8IN DN 5FT S/O PP NO 1270585E 36FT S C/L AVE E & 240 FT W C/L 5TH ST E PROP MKD (1959)	CL 567
LANCASTR (1975)	2296.552	CS MON (E EDGE) IN WELL 9IN DN @ C/L INT AVE E & PROP 5TH ST E MKD (CO SUR 1/4 COR 23 26 T8N R12W 1928)	CL 568
LANCASTR (1975)	2300.276	CS MON (N EDGE) IN WELL 16IN DN @ C/L INT AVE E & 10TH ST E PROP MKD (CO SUR 23 24 25 26 T8N R12W 1928)	CL 569

QUAD-YEAR	ELEV	DESCRIPTION (INCLUDE QUAD AND YEAR IN DESCRIPTION)	BM NUMBER
LANCASTR (1975)	2301.955	RD BM MON IN WELL 8IN DN 6FT S/O PP NO 1270596E 36FT S/O C/L AVE E & 70FT E/O C/L 10TH ST E PROP MKD (1959)	CL 570
LANCASTR (1975)	2302.960	RD BM MON IN WELL 8IN DN 5FT S/O PP NO 1270605E 36FT S/O C/L AVE E & 240FT W/O C/L 15TH ST E PROP MKD (1959)	CL 571
LANCASTR (1975)	2302.583	CS MON IN WELL 24IN DN @ C/L INT AVE E & 15TH ST E MKD (CO SUR 1/4 COR 24 25 T8N R12W 1928) (W EDGE)	CL 572
LANCASTR (1975)	2310.402	RD BM MON IN WELL 8IN DN 6FT S/O PP NO 1270627E 39FT S/O C/L AVE E & 225FT E/O C/L 25TH ST E PROP MKD (1959)	CL 576
LANCASTR (1975)	2311.829	1 1/2IN IP CONC PLUG & NAIL FL 50FT S & 50FT E/O C/L INT AVE E & 30TH ST E (N EDGE)	CL 577
LANCASTR (1975)	2313.345	RD BM MON IN WELL 8IN DN 5FT S/O PP NO 1270648E 28FT S/O C/L AVE E & 260FT W/O C/L 35TH ST E PROP MKD (1959)	CL 579
LANCASTR (1975)	2312.582	CS MON (N EDGE) IN WELL 22IN DN @ C/L INT AVE E & 35TH ST E MKD (CO SUR 1/4 SEC COR 20 29 T8N R11W)	CL 580
LANCASTR (1975)	2315.782	RD BM MON IN WELL 8IN DN 5FT S/O PP NO 1273708E 30FT S/O C/L AVE E & 250FT W/O C/L 40TH ST E PROP MKD (1959)	CL 581
LANCASTR (1975)	2314.412	CS MON IN WELL 22IN DN @ C/L INT AVE E & 45TH ST E PROP MKD (CO SUR 1/4 SEC COR 21 28 T8N R11W) USE N EDGE	CL 583
LANCASTR (1975)	2316.932	CS MON IN WELL 16IN DN @ C/L INT AVE E & 50TH ST E MKD (CO SUR 21 22 27 28 T8N R11W) USE N EDGE	CL 585A
LANCASTR (1975)	2321.176	CS MON IN WELL 10IN DN @ C/L INT AVE E & 55TH ST E MKD (CO SUR 1/4 COR 22 27 R11W T8N RE 329) N EDGE	CL 587D
LANCASTR (1975)	2321.874	CS MON IN WELL 14IN DN @ C/L INT AVE E & 60TH ST ST E MKD (CO SUR 22 23 26 27 T8N R11W) USE N EDGE	CL 589D
LANCASTR (1975)	2328.633	CS MON (E EDGE) IN WELL 18IN DN @ C/L INT 60TH ST E & PROP AVE E-8 MKD (CO SUR 1/4 COR 26 27 T8N R11W)	CL 591D
LANCASTR (1975)	2329.618	L&T SW COR CONC PUMP BASE 35FT N/O C/L AVE E-8 PROP & 170FT E/O C/L 60TH ST E MKD (BM)	CL 592D

