

COUNTY OF LOS ANGELES
ROAD DEPARTMENT

PRECISE
BENCH MARK LIST



HI VISTA QUAD
1972 ADJUSTMENT
(LANCASTER EAST)
NGVD29 DATUM

PREFACE

The Road Department level net is composed of more than 1,000 miles of levels supporting in excess of 10,000 bench marks. In 1964-65, a major readjustment of the net was undertaken. To emphasize the complete break with previous elevations, the SY, SG & SL series bench marks have been re-labeled BY, BG & BL, respectively.

To facilitate the adjustment, indexing, and distribution of adjusted values of the net, the County territory was divided into 31 quads or areas. For identification purposes each quad was given a name, viz., "Rosemead," "La Mirada," "Santa Fe," etc. When bench marks and elevations in the Road Department net are used, the name of the quad in which the bench mark is located and the date of the adjustment of the elevation must be included in the bench mark description, e.g.,

BG 1887 --L+BN IN CONC HDWL OF DRAIN PIPE UNDER DR 218 FT
NE +18 FT SE C/L INT GRAND AVE +CAMERON AVE MKD (BM)
(COVINA --1965) ELEV. 696.238

It is expected that this general adjustment will, for the most part, remain sound for the next 8 to 12 years. As new circuits are completed, however, re-adjustment of individual quads may become advisable. It is expected that these subsequent adjustments will be in the nature of a few hundredths of a foot. When a quad is re-adjusted, new elevation lists will be published and the date of the re-adjustment will replace the "1965" at the end of the bench mark description. Two bench marks in the same quad with different adjustment dates will not normally join each other. Since all adjustments taper out to nothing at the periphery of the quad, any bench mark in one quad will join any bench mark in another quad regardless of their respective adjustment dates.

The basic accuracy of the net is reflected by an indicated field probable error of plus or minus 0.012 foot per mile of leveling as determined from 298 conditions of closure. However, many years experience in vertical control in the greater Los Angeles basin and Antelope Valley indicate that because of varying degrees of subsidence and heaving, the true datum is recovered only by obtaining substantial agreement of a number of bench marks.

The users of this net are invited to assist in its maintenance by notifying this Department of cases of obliteration, apparent mistakes in descriptions or elevations, and proven disturbance of bench marks.

DATUM: U. S. Coast and Geodetic Survey Sea Level Datum of 1929, through the medium of the Los Angeles County Engineer Precise Level Net, 1963 Adjustment.

ABBREVIATIONS USED IN BENCH MARK LISTINGS

ABUT - - - - -	Abutment	EC - - - - -	End of Curve
ALG - - - - -	Along	ENT - - - - -	Entrance
ANG PT - - - - -	Angle Point	FL - - - - -	Floor
B/W - - - - -	Back of Walk	FTG - - - - -	Footing
BCR - - - - -	Beginning of Curb Return	F/W - - - - -	Front of Walk
BC - - - - -	Beginning of Curve	GAR - - - - -	Garage
BLDG - - - - -	Building	HDWL - - - - -	Headwall
EM - - - - -	Bench Mark	HSE - - - - -	House
BT SPK - - - - -	Boat or Bolt Spike	INT - - - - -	Intersection
BR CAP - - - - -	Brass or Bronze Cap	IP - - - - -	Iron Pipe
C B - - - - -	Catch Basin	LT - - - - -	Left
CTR - - - - -	Center	LACE - - - - -	L. A. City Engineer
C/L - - - - -	Center Line	LACS - - - - -	L. A. County Engineer
C/L INT - - - - -	Center Line Intersection	LAFC - - - - -	L. A. Co. Flood Control
C/L PROD - - - - -	Center Line Produced	L+BN - - - - -	Lead and Bench Nail
CONC - - - - -	Concrete	L+BR - - - - -	Lead and Brad
COR - - - - -	Corner	L+N - - - - -	Lead and Nail
COE - - - - -	Corps of Engineers	L+RDEM TAG - - - - -	Lead and Road Dept. Bench Mark Tag
CULV - - - - -	Culvert	L+SPK - - - - -	Lead and Spike
CB - - - - -	Curb	L+T - - - - -	Lead and Tack
CS MON - - - - -	County Engineer Monument	MCR - - - - -	Middle of Curb Return
CS BR CAP - - - - -	County Engineer Brass Cap	MKD - - - - -	Marked
CT SPK - - - - -	Cut Spike	MC - - - - -	Middle of Curve
DR - - - - -	Drive or Driveway	MON - - - - -	Monument
E/O - - - - -	East of	N/O - - - - -	North of
ECR - - - - -	End of Curb Return	NR - - - - -	Near

ABBREVIATIONS USED IN BENCH MARK LISTINGS . . . CONTINUED

OPP - - - - - Opposite
PI - - - - - Point of Intersection
PK+W - - - - - PK Nail and Washer
P/L - - - - - Property Line
POST - - - - - Point on Semi-Tangent
PP - - - - - Power Pole
PVMT - - - - - Pavement
PROD - - - - - Produced
RD - - - - - Road
RDEM - - - - - Road Dept. Bench Mark
RR - - - - - Railroad
RT - - - - - Right
R/W - - - - - Right of Way
SDMH - - - - - Storm Drain Manhole
SMH - - - - - Sewer Manhole
SPK - - - - - Spike
ST+W - - - - - Spike Tin and Washer
S/O - - - - - South of
TP - - - - - Telephone Pole
USC+GS - - - - - U. S. Coast and Geodetic Survey
USGS - - - - - U. S. Geological Survey
WK - - - - - Walk
W/O - - - - - West of

G U A D

H I V I S T A

Q U A D

L A N C A S T E R

PALMDALE QUAD

L A N O

D U A D

SAN

BERNARDINO

COUNTY

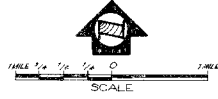
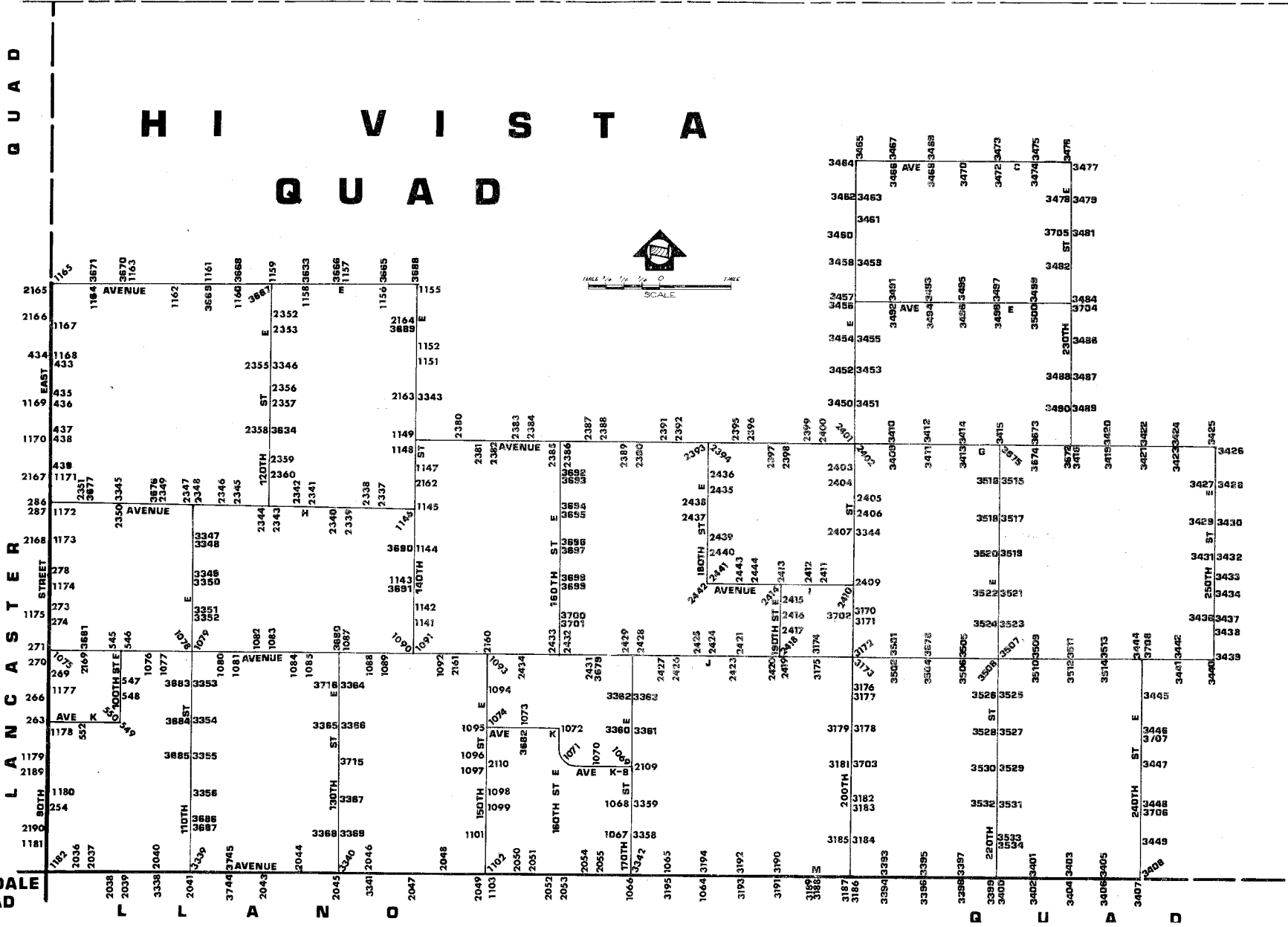

QUAD-YEAR	ELEV	DESCRIPTION (INCLUDE QUAD AND YEAR IN DESCRIPTION)	BM NUMBER
BASELINE (1965)	2496.435	CS MON IN WELL @ C/L INT AVE L + 90TH ST E MKD (T7N R10W, SEC COR 29,30,31,32)	BL 254B
BASELINE (1965)	2473.301	CS MON 24IN DN @ C/L INT AVE K + 90TH ST E MKD (T7N R10W SEC 19 20 29 30) USE E EDGE	BL 263B
BASELINE (1965)	2454.169	CS MON 30IN DN @ C/L INT AVE J-8 + 90TH ST E MKD (R10W T7N 1/4 SEC 19 20)	BL 266B
BASELINE (1965)	2449.591	L+T N END 1ST STEP OF PORCH OF HSE NO 44233 90TH ST E 100FT W C/L + 1000FT S AVE J	BL 269B
BASELINE (1965)	2444.163	L+T NR SE EDGE CONC PUMP CTR DRAIN PUMP ISL 60FT W C/L 90TH ST E + 60FT N C/L AVE J	BL 270A
BASELINE (1965)	2441.794	CS MON 15IN DN @ C/L INT 90TH ST E + AVE J MKD (T7N R10W SEC COR 18 17 19 20)	BL 271B
BASELINE (1965)	2431.384	L+T NR E EDGE CONC PORCH HSE NO 44709 90TH ST E 79FT W C/L + 2200FT N AVE J 6FT N OF S EDGE PORCH	BL 273B
BASELINE (1965)	2425.056	CS MON 20IN DN @ C/L INT 90TH ST E + AVE I-8 MKD (1/4 SEC 17 18 T7N R10W)	BL 274B
BASELINE (1965)	2412.568	CS MON 12IN DN @ C/L INT 90TH ST E + AVE I MKD (R10W T7N COR SEC 7,8,17,18)	BL 278B
BASELINE (1965)	2392.783	CS MON @ C/L INT AVE H + 90TH ST E MKD (R10W T7N COR SEC 5 6 7 8)	BL 286B
BASELINE (1965)	2394.247	RDBM TAG @ CTR OF OLD CONC BASE OF MTR MOUNT 40FT W C/L 90TH ST E + 100FT N C/L AVE H	BL 287B
BASELINE (1965)	2354.853	L+T CONC FOUNDATION OF WATER TOWER 6FT W + 1.5FT N OF SE COR @ NW COR 90TH ST E + AVE F 45FT N + 95FT W C/L INT MKD (SLBM)	BL 433B
BASELINE (1965)	2354.502	CS MON 12IN DN @ C/L INT 90TH ST E + AVE F MKD (SEC COR 30 29 31 32 R10W T8N) (E EDGE)	BL 434B
BASELINE (1965)	2366.329	L+T 1ST STEP OF CONC PORCH OF APT UNIT NO 47205 @ THE NW COR 90TH ST E + AVE F-8 140FT W + 70FT N C/L INT	BL 435A
BASELINE (1965)	2365.094	2IN IP WITH CONC PLUG + BT SPK @ C/L INT 90TH ST E + AVE F-8	BL 436B
BASELINE (1965)	2372.935	CS MON IN WELL 15IN DN @ C/L INT 90TH ST E + AVE G MKD (SEC COR 31 32 6 5 R10W T8N T7N)	BL 437B
BASELINE (1965)	2374.275	RD MON IN WELL WITH CONC COLLAR @ SE COR 90TH ST E + AVE G 30FT E + 40FT S C/L INT	BL 438B
BASELINE (1965)	2385.018	2IN IP IN CONC WITH BR CAP ON C/L AVE G-8 30FT W C/L 90TH ST E MKD (WC SEC 6 R10W T7N)	BL 439B
HI VISTA (1972)	2450.969	RDBM TAG CONC LID OF FLAT JUNCTION BOX 250FT W C/L 100TH ST E + 36FT N C/L AVE J SE EDGE/ LID	BL 545
HI VISTA (1972)	2448.076	L+T 2IN DN @ C/L INT AVE J + 100TH ST E	BL 546
HI VISTA (1972)	2466.320	RDBM TAG CONC PUMP BASE (OLD) 60FT W C/L 100TH ST E + 130FT N C/L AVE J-8	BL 547
HI VISTA (1972)	2463.909	CS MON 14IN DN @ C/L INT 100TH ST E + AVE J-8 MKD (1/4 SEC COR 20-21 R-10-W T-7-N)	BL 548

QUAD-YEAR	ELEV	DESCRIPTION (INCLUDE QUAD AND YEAR IN DESCRIPTION)	BM NUMBER
HI VISTA (1972)	2478.378	CS MON 12IN DN @ C/L INT 100TH ST E + AVE K MKD (T7N R10W 20-21-28-29 SEC COR) USE W EDGE	BL 549
HI VISTA (1972)	2479.988	L+T CONC PORCH TO HSE NO 9861 40FT N + 45FT W C/L INT 100TH ST E + AVE K MKD BM	BL 550
HI VISTA (1972)	2474.615	CS MON (S EDGE) IN WELL 18IN DN @ C/L INT AVE K + 95TH ST E PROP MKD (1/4 COR 20 29 T7N R10W)	BL 552
BASELINE (1965)	2606.353	USC+GS MON IN TOP OF 6IN CONC POST FL 26FT E C/L 180TH ST E DIRT RD 32FT S C/L AVE M MKD L S 18 1929-RESET 1941	BL 1064
BASELINE (1965)	2593.968	CSBM MON 6IN UP 30FT N C/L AVE M + 34FT W C/L 175TH ST E 39FT SW 2IN IP WITH CS TAG 12IN UP MKD (BM 106-89 1959)	BL 1065
BASELINE (1965)	2584.501	CSBM MON 6IN UP ON SW COR AVE M + 170TH ST E 124FT S + 23FT W C/L INT MKD (BM 106-90 1959)	BL 1066
HI VISTA (1972)	2581.217	CS MON IN WELL 10IN DN ON C/L 170TH ST E @ DIRT RD (AVE L-8) TO LINDA MIA RANCH NO 42200 47FT NE PP 423645E MKD (1/4 COR 33 34 T7N R9W)	BL 1067
HI VISTA (1972)	2578.448	CS MON IN WELL 10IN DN @ C/L INT 170TH ST E + AVE L (DIRT) 64FT SE PP 423633E MKD (SEC COR 33 34 27 28 R9W T7N)	BL 1068
HI VISTA (1972)	2561.839	USGS MON 6IN UP 27FT S C/L AVE K-8 + 250FT W C/L 170TH ST E 7FT SW PP 423619E MKD (LS 17 1929)	BL 1069
HI VISTA (1972)	2551.754	CSBM MON 6IN UP 19FT S C/L AVE K-8 + 0.5MI W 170TH ST E MKD (BM 106-94 1959)	BL 1070
HI VISTA (1972)	2538.845	CSBM MON 6IN UP 18FT W C/L 160TH ST E + 550FT N AVE K-8 3FT S PP 423723E MKD (BM 106-95 1959)	BL 1071
HI VISTA (1972)	2534.104	CSBM MON 6IN UP 23FT N C/L AVE K + 205FT W C/L 160TH ST E 5FT N PP 423712E MKD (BM 106-96 1959)	BL 1072
HI VISTA (1972)	2526.028	CSBM MON 6IN UP 23FT N C/L AVE K + 16FT E C/L 155TH ST E 5FT N PP K7746Y 74FT SE WATER WELL SHAFT MKD (BM 106-97A 1959 USE W EDGE)	BL 1073
HI VISTA (1972)	2516.754	CSBM MON 6IN UP 17FT E C/L 150TH ST E + 83FT N C/L AVE K 10FT S PP 274145E MKD (BM 106-98 1959)	BL 1074
BASELINE (1965)	2442.674	CSBM MON 4IN UP NR SW COR EDISON PIUTE SUBSTA 45FT N C/L AVE J + 40FT E C/L 90TH ST E MKD (BM 107-24 1961)	BL 1075B
HI VISTA (1972)	2461.527	RD BR CAP MON IN WELL W/COVER 5FT E PP NO K8333Y 30FT N C/L AVE J + 195FT W C/L 105TH ST E (PROP) 2IN IP WITNESS 3FT UP 2FT N	BL 1076
HI VISTA (1972)	2458.332	RD BR CAP MON IN WELL W/COVER 5FT W PP NO K8335Y 30FT N C/L AVE J + 200FT E C/L 105TH ST E (PROP) 2IN IP WITNESS 3FT UP 2FT N	BL 1077
HI VISTA (1972)	2452.399	CS MON 15IN DN @ C/L INT AVE J + 110TH ST E MKD (15 16 21 22 T7N R10W) USE W EDGE	BL 1078
HI VISTA (1972)	2453.513	RD MON IN WELL W/COVER 72FT N C/L AVE J + 30FT E C/L 110TH ST E 2IN IP WITNESS 3FT UP 2FT S	BL 1079
HI VISTA (1972)	2459.475	RD MON IN WELL W/COVER 4FT E PP NO 918158E 30FT N C/L AVE J + 105FT W C/L 115TH ST E (PROP) 2IN IP WITNESS 3FT UP 2FT N	BL 1080

QUAD-YEAR	ELEV	DESCRIPTION (INCLUDE QUAD AND YEAR IN DESCRIPTION)	BM NUMBER
HI VISTA (1972)	2457.847	RD MON IN WELL W/COVER 4FT W PP NO 918590E 30FT N C/L AVE J + 190FT E C/L 115TH ST E (PROP) 2IN IP WITNESS 3FT UP 2FT N	BL 1081
HI VISTA (1972)	2459.265	RD MON IN WELL 13FT E PP NO 918598E 30FT N C/L AVE J + 66FT W C/L 120TH ST E (PROP) 2IN IP WITNESS 3FT UP 2FT N	BL 1082
HI VISTA (1972)	2457.619	RD MON IN WELL W/COVER 5FT W PP NO 104830E 30FT N C/L AVE J + 195FT E C/L 120TH ST E (PROP) 2IN IP WITNESS 3FT UP 2FT N	BL 1083
HI VISTA (1972)	2462.313	RD MON IN WELL W/COVER 7FT E PP NO 1048301E 30FT N C/L AVE J + 180FT W C/L 125TH ST E 2IN IP WITNESS 3FT UP 2FT N	BL 1084
HI VISTA (1972)	2463.170	RD MON IN WELL W/COVER 7FT W PP NO 1014867E 30FT N C/L AVE J + 145FT E C/L 125TH ST E 2IN IP MKR 3FT UP 2FT N	BL 1085
HI VISTA (1972)	2465.872	CS MON IN WELL @ C/L INT AVE J + 130TH ST E MKD (13 14 23 24 T7N R10W) 15IN DN	BL 1087
HI VISTA (1972)	2473.637	CS MON IN WELL @ C/L INT AVE J + 135TH ST E MKD (1/4 COR 13 24 T7N R10W)	BL 1088
HI VISTA (1972)	2477.313	RD MON IN WELL W/COVER 5FT NE PP NO 1014874E 35FT N C/L AVE J + 360FT E 135TH ST E 2IN IP WITNESS 3FT UP 2FT N	BL 1089
HI VISTA (1972)	2484.330	CS MON IN WELL @ C/L INT AVE J + 140TH ST E MKD (13 24 18 19 T7N R10W R9W)	BL 1090
HI VISTA (1972)	2487.282	CSBM MON 6IN UP ON NW COR AVE J + 140TH ST E 90F N + 35FT W C/L INT MKD BM 106-102 1959	BL 1091
HI VISTA (1972)	2488.627	CSBM MON 6IN UP 39FT S C/L AVE J NR C/L 145TH ST E 57FT S PP 390499E MKD (BM 106-101 1959)	BL 1092
HI VISTA (1972)	2490.831	CSBM MON 6IN UP ON SE COR AVE J + 150TH ST E 18F E + 39FT S C/L INT MKD BM 106-100 1959	BL 1093
HI VISTA (1972)	2503.817	CSBM MON 2IN DN 19FT E C/L 150TH ST E @ DIRT RD 0.5MI N AVE K 4FT E PP 951510E MKD (BM 106-99 1959)	BL 1094
HI VISTA (1972)	2516.463	L+T SE COR OF 3FT SQ CONC SLAB 52FT W C/L 150TH ST E + 140FT N C/L AVE K	BL 1095
HI VISTA (1972)	2529.636	RDBM MON IN WELL W/COVER 35FT E C/L 150TH ST E + 100FT N C/L AVE K-8 (UNIMPROVED) 2IN IP WITNESS 3FT UP 2FT E	BL 1096
HI VISTA (1972)	2530.995	RDBM MON IN WELL W/COVER 35FT E C/L 150TH ST E + 100FT S C/L AVE K-8 (UNIMPROVED) 2IN IP WITNESS 3FT UP 2FT E	BL 1097
HI VISTA (1972)	2548.225	RDBM MON IN WELL W/COVER 35FT E C/L 150TH ST E + 100FT N C/L AVE L (UNIMPROVED) 2IN IP WITNESS 3FT UP 2FT E	BL 1098
HI VISTA (1972)	2547.275	CS MON IN WELL @ C/L INT 150TH ST E + AVE L MKD (SEC COR 29 30 31 32 T7N R9W)	BL 1099
HI VISTA (1972)	2560.805	CS MON IN WELL @ C/L INT 150TH ST E + AVE L-8 MKD (1/4 COR 31 32 T7N R9W)	BL 1101
BASELINE (1965)	2575.451	CS MON IN WELL 8IN DN @ C/L INT AVE M + 150TH ST E MKD (SEC COR 31 32 5 6 T6N T7N R9W)	BL 1102

QUAD-YEAR	ELEV	DESCRIPTION (INCLUDE QUAD AND YEAR IN DESCRIPTION)	BM NUMBER
BASELINE (1965)	2576.140	RDBM MON IN WELL @ SE COR AVE M + 150TH ST E 193FT S + 28FT E C/L INT 2IN IP MKR 3FT UP 2FT N	BL 1103
HI VISTA (1972)	2469.771	CS MON IN WELL 12IN DN @ C/L INT 140TH ST E + PROP AVE I-8 105FT S PP 1014890E MKD (1/4 COR 13 18 R9W T7N)	BL 1141
HI VISTA (1972)	2469.036	CSBM MON 6IN UP 32FT W C/L 140TH ST E + 690FT N AVE I-8 4FT S PP 1014882E MKD (BM 106-103 1959)	BL 1142
HI VISTA (1972)	2459.252	CS MON IN WELL 21IN DN @ C/L INT 140TH ST E + FUT AVE I MKD (SEC COR 12 13 17 18 R10W T7N) USE W EDGE	BL 1143
HI VISTA (1972)	2449.597	CS MON IN WELL 9IN DN @ C/L INT 140TH ST E + AVE H-8 225FT S OF S SIDE PROD HSE 45615 MKD (1/4 COR 12 7 R10W R9W T7N)	BL 1144
HI VISTA (1972)	2442.009	CSBM MON 6IN UP @ NW COR 140TH ST E + AVE H 33FT W + 68FT N C/L INT MKD (BM 106-106 1959)	BL 1145
HI VISTA (1972)	2440.522	CS MON IN WELL 20IN DN @ C/L INT 140TH ST E + AVE H MKD (SEC COR 1 6 12 7 R10W R9W T7N)	BL 1146
HI VISTA (1972)	2449.224	CS MON IN WELL 21IN DN ON C/L 140TH ST E 10FT S C/L AVE G-8 65FT SE PP 767477E + 80FT SW PP 878100E MKD (1/4 COR 1 6 R10W R9W T7N)	BL 1147
HI VISTA (1972)	2451.499	CSBM MON 4IN DN ON NW COR 140TH ST E + AVE G 60FT W + 32FT N C/L INT MKD (BM 106-108 1959)	BL 1148
HI VISTA (1972)	2450.752	CS MON IN WELL 24IN DN @ C/L INT 140TH ST E + AVE G MKD (SEC COR 36 31 1 6 T7N T8N R9W R10W)	BL 1149
HI VISTA (1972)	2460.666	CSBM MON 6IN UP 49FT E C/L 140TH ST E + 31FT N C/L FUT AVE F MKD (BM 106-110 1959)	BL 1151
HI VISTA (1972)	2458.202	CS MON IN WELL 10IN DN @ C/L INT 140TH ST E + FUT AVE F 71FT NW 2IN IP + PLUG 6IN UP MKD (SEC COR 25 30 31 36 R10W R9W T8N)	BL 1152
HI VISTA (1972)	2424.318	CS MON IN WELL 6IN DN @ C/L INT 140TH ST E + AVE E MKD (SEC COR 19 24 25 30 R10W R9W T8N) USE S EDGE	BL 1155
HI VISTA (1972)	2372.004	CSBM MON 6IN UP 32FT S C/L AVE E + 13FT W C/L 135TH ST E 14FT S PP 759331E MKD (BM 106-113 1959)	BL 1156
HI VISTA (1972)	2367.579	CSBM MON 6IN UP 29FT S C/L AVE E + 36FT W C/L 130TH ST E 33FT W PP 759325E MKD (BM 106-114 1959)	BL 1157
HI VISTA (1972)	2363.028	LACS MON 33IN DN @ C/L INT AVE E + 125TH ST E 25FT N PP NO 1587001E MKD 1/4COR 23 26 R10W T8N USE W EDGE	BL 1158
HI VISTA (1972)	2357.581	CSBM MON 6IN UP 23FT N C/L AVE E + 196FT W C/L 120TH ST E MKD BM 106-116 1959 IP 4IN UP 2FT N	BL 1159
HI VISTA (1972)	2361.798	CSBM MON 6IN UP 28FT N C/L AVE E + 259FT W C/L 115TH ST E 51FT E CTR DIRT RD TO HSE 11337 MKD BM 106-117 1959	BL 1160
HI VISTA (1972)	2356.566	CSBM MON 6IN UP 24FT N C/L AVE E + 48FT E C/L 110TH ST E MKD BM 106-118 1959	BL 1161
HI VISTA (1972)	2353.131	CSBM MON 6IN UP 25FT S C/L AVE E + 36FT E C/L 105TH ST E MKD BM 106-119 1959	BL 1162

OUT

QUAD-YEAR	ELEV	DESCRIPTION (INCLUDE QUAD AND YEAR IN DESCRIPTION)	BM NUMBER
HI VISTA (1972)	2349.282	CSBM MON 6IN UP 48FT N C/L AVE E + 22FT E C/L 100TH ST E 14FT S TP K2318Y MKD (BM 106-120 1959)	BL 1163
HI VISTA (1972)	2343.524	CSBM MON 6IN UP 21FT S C/L AVE E + 247FT W C/L 95TH ST E MKD BM 106-121 1959 IP 2FT E 3FT UP	BL 1164
BASELINE (1965)	2342.585	CSBM MON 6IN UP 32FT E C/L 90TH ST E + 46FT S C/L AVE E 7FT SE PP 538296E MKD (BM 106-122 1959)	BL 1165B
BASELINE (1965)	2347.538	RDBM TAG CONC FOOTING OF SUPPORT @ NW COR HAY SHED 50FT E C/L 90TH ST E + 50FT S C/L AVE E-8	BL 1167B
BASELINE (1965)	2356.293	CSBM MON 2IN UP 30FT N C/L AVE F + 77FT E C/L 90TH ST E MKD (BM 116-6 1961)	BL 1168B
BASELINE (1965)	2365.866	CSBM MON 2IN UP 80FT N C/L AVE F-8 + 30FT E C/L 90TH ST E MKD (BM 116-5 1961)	BL 1169B
BASELINE (1965)	2375.401	CSBM MON 2IN UP 27FT W C/L 90TH ST E + 70FT S C/L AVE G MKD (BM 116-4 1961)	BL 1170B
BASELINE (1965)	2384.640	CSBM MON 4IN UP 80FT E C/L 90TH ST E + 20FT S C/L AVE G-8 25FT W PP 951530E MKD (BM 116-3 1961)	BL 1171B
BASELINE (1965)	2395.866	CSBM MON 4IN UP 35FT N + 115FT E C/L INT AVE H + 90TH ST E MKD (BM 116-2 1961)	BL 1172B
BASELINE (1965)	2403.308	CSBM MON 3IN UP 30FT E C/L 90TH ST E + 155FT N C/L AVE H-8 MKD (BM 116-1 1961)	BL 1173B
BASELINE (1965)	2414.089	CSBM MON 4IN UP 68FT W C/L 90TH ST E + 30FT S C/L AVE I 2FT E PP 955497E MKD (BM 107-26 1961)	BL 1174B
BASELINE (1965)	2424.728	CSBM MON 4IN UP 35FT E C/L 90TH ST E + 550FT N AVE I-8 3FT E PP 771405E MKD (BM 107-25 1961)	BL 1175B
BASELINE (1965)	2456.082	CSBM MON 4IN UP 90FT W C/L 90TH ST E + 29FT S C/L AVE J-8 1FT N OF N P/L GLENDALE AUTO PARTS YD MKD (BM 107-23 1961)	BL 1177B
BASELINE (1965)	2475.322	CSBM MON 27FT W C/L 90TH ST E + 60FT S C/L AVE K 2FT W TP K9248Y MKD (BM 107-22 1961)	BL 1178B
BASELINE (1965)	2490.428	CSBM MON 3IN UP 33FT E C/L 90TH ST E + 45FT S C/L AVE K-8 3FT E PP 771366E MKD (BM 107-21 1961)	BL 1179B
BASELINE (1965)	2498.198	CSBM MON 60FT W C/L 90TH ST E + 30FT S C/L AVE L 3FT S PP 800334E MKD (BM 107-20 1961)	BL 1180B
BASELINE (1965)	2513.399	CSBM MON 34FT E C/L 90TH ST E + 35FT N C/L AVE L-8 3FT S PP 771347E MKD (BM 107-19 1961)	BL 1181B
BASELINE (1965)	2526.141	CSBM MON 4IN UP 36FT N C/L AVE M + 36FT E C/L 90TH ST E MKD (BM 107-18 1961)	BL 1182A
BASELINE (1965)	2530.176	CS MON IN WELL 36IN DN @ C/L INT AVE M + FUT 95TH ST E MKD (1/4 COR 32 5 T6N T7N R10W)	BL 2036A
BASELINE (1965)	2533.031	CSBM MON 4IN UP 38FT S C/L AVE M + 89FT E C/L 95TH ST E BET PP 1001560E + 1001561E MKD (BM 122-1 1961) 2IN IP MKR 3FT UP 2FT N	BL 2037
BASELINE (1965)	2539.330	CS MON 8IN DN IN WELL @ C/L INT AVE M + 100TH ST E MKD (SEC COR 32 33 5 4 T6N T7N R10W)	BL 2038

QUAD-YEAR	ELEV	DESCRIPTION (INCLUDE QUAD AND YEAR IN DESCRIPTION)	BM NUMBER
BASELINE (1965)	2541.484	CSBM MON 4IN UP @ SE COR AVE M + 100TH ST E 26FT S + 75FT E C/L INT MKD (BM 122-2 1961) 2IN IP MKR 3FT UP 2FT N	BL 2039A
BASELINE (1965)	2547.132	CSBM MON 4IN UP @ SE COR AVE M + 105TH ST E 66FT E + 28FT S C/L INT MKD (BM 122-3 1961) 2IN IP MKR 3FT UP 2FT N	BL 2040
BASELINE (1965)	2550.037	CSBM MON 4IN UP @ SE COR AVE M + 110TH ST E 48FT S + 52FT E C/L INT MKD (BM 122-4 1961) 2IN IP MKR 3FT UP 2FT W	BL 2041
BASELINE (1965)	2546.672	CS MON FLUSH @ FUT C/L INT AVE M + 120TH ST E MKD (SEC COR 34 35 3 2 T6N T7N R10W) 2IN IP MKR 3FT UP 2FT E	BL 2043
BASELINE (1965)	2537.774	CS MON 6IN UP @ FUT C/L INT AVE M + 125TH ST E MKD (1/4 COR 2 35 T6N T7N R10W)	BL 2044
BASELINE (1965)	2537.915	CS MON 6IN UP @ FUT C/L INT AVE M + 130TH ST E MKD (SEC COR 35 36 2 1 T6N T7N R10W)	BL 2045
BASELINE (1965)	2551.888	CS MON 6IN UP @ FUT C/L INT AVE M + 135TH ST E MKD (1/4 SEC COR 36 1 T6N T7N R10W)	BL 2046
BASELINE (1965)	2655.044	CS MON 10IN UP @ FUT C/L INT AVE M + 140TH ST E MKD (SEC COR 1 6 31 36 T6N T7N R10W R9W)	BL 2047
BASELINE (1965)	2688.857	2IN IP WITH CUT SPK IN CONC 6IN UP @ 1/4 COR 31 6 R9W T6N T7N (FUT C/L INT AVE M + 145TH ST E)	BL 2048
BASELINE (1965)	2575.722	CSBM MON 2IN DN ON NE COR AVE M + 150TH ST E 53FT N + 33FT E C/L INT MKD (BM 115-11 1961)	BL 2049
BASELINE (1965)	2575.756	CS MON IN WELL @ C/L INT AVE M + FUT 155TH ST E MKD (1/4 SEC COR 32 5 T6N T7N R9W)	BL 2050
BASELINE (1965)	2579.384	2IN IP CONC PLUG + NAIL 8IN UP ON NE COR AVE M + FUT 155TH ST E 50FT N + 50FT E C/L INT CHIZ X ON E EDGE	BL 2051
BASELINE (1965)	2577.105	2IN IP CONC PLUG + NAIL 8IN UP ON SW COR AVE M + FUT 160TH ST E 50FT S + 50FT W C/L INT CHIZ X ON W EDGE	BL 2052
BASELINE (1965)	2577.175	2IN IP CONC PLUG + NAIL 8IN UP ON NE COR AVE M + FUT 160TH ST E 50FT N + 50FT E C/L INT	BL 2053
BASELINE (1965)	2577.910	2IN IP CONC PLUG + NAIL FLUSH ON SW COR AVE M + FUT 165TH ST E 50FT S + 50FT W C/L INT	BL 2054A
BASELINE (1965)	2578.137	2IN IP CONC PLUG + NAIL 6IN UP ON NE COR AVE M + FUT 165TH ST E 50FT N + 50FT E C/L INT	BL 2055
HI VISTA (1972)	2561.320	CS MON IN WELL @ C/L INT 170TH ST E + AVE K-8 MKD (1/4 COR 27 28 R9W T7N)	BL 2109
HI VISTA (1972)	2531.312	CSBM MON IN CONC POST 12IN DN 33FT E C/L 150TH ST E + 17FT S C/L AVE K-8 MKD (BM 115-14 1961) 2IN IP MKR 3FT UP 2FT E	BL 2110
HI VISTA (1972)	2489.002	CS MON (NE EDGE) 8IN DN @ C/L INT AVE J + 150TH ST E MKD (SEC COR 17 18 19 20 R9W T7N)	BL 2160
HI VISTA (1972)	2489.147	CS MON IN WELL 6IN DN @ C/L INT AVE J + FUT 145TH ST E MKD (1/4 COR 18 19 R9W T7N)	BL 2161
HI VISTA (1972)	2451.815	2IN IP 6IN UP ON C/L PROD AVE G-8 50FT E C/L 140TH ST E P M ON N EDGE	BL 2162

