

FIELD COPY

1

COUNTY OF LOS ANGELES
ROAD DEPARTMENT

PRECISE
BENCH MARK LIST



OTTERBEIN QUAD

1965 ADJUSTMENT

PREFACE

The Road Department level net is composed of more than 1,000 miles of levels supporting in excess of 10,000 bench marks. In 1964-65, a major readjustment of the net was undertaken. To emphasize the complete break with previous elevations, the SY, SG & SL series bench marks have been re-labeled BY, BG & BL, respectively.

To facilitate the adjustment, indexing, and distribution of adjusted values of the net, the County territory was divided into 31 quads or areas. For identification purposes each quad was given a name, viz., "Rosemead," "La Mirada," "Santa Fe," etc. When bench marks and elevations in the Road Department net are used, the name of the quad in which the bench mark is located and the date of the adjustment of the elevation must be included in the bench mark description, e.g.,

BG 1887 --L+BN IN CONC HDWL OF DRAIN PIPE UNDER DR 218 FT
NE +18 FT SE C/L INT GRAND AVE +CAMERON AVE MKD (BM)
(COVINA --1965) ELEV. 696.238

It is expected that this general adjustment will, for the most part, remain sound for the next 8 to 12 years. As new circuits are completed, however, re-adjustment of individual quads may become advisable. It is expected that these subsequent adjustments will be in the nature of a few hundredths of a foot. When a quad is re-adjusted, new elevation lists will be published and the date of the re-adjustment will replace the "1965" at the end of the bench mark description. Two bench marks in the same quad with different adjustment dates will not normally join each other. Since all adjustments taper out to nothing at the periphery of the quad, any bench mark in one quad will join any bench mark in another quad regardless of their respective adjustment dates.

The basic accuracy of the net is reflected by an indicated field probable error of plus or minus 0.012 foot per mile of leveling as determined from 298 conditions of closure. However, many years experience in vertical control in the greater Los Angeles basin and Antelope Valley indicate that because of varying degrees of subsidence and heaving, the true datum is recovered only by obtaining substantial agreement of a number of bench marks.

The users of this net are invited to assist in its maintenance by notifying this Department of cases of obliteration, apparent mistakes in descriptions or elevations, and proven disturbance of bench marks.

DATUM: U. S. Coast and Geodetic Survey Sea Level Datum
of 1929, through the medium of the Los Angeles
County Engineer Precise Level Net, 1963 Adjust-
ment.

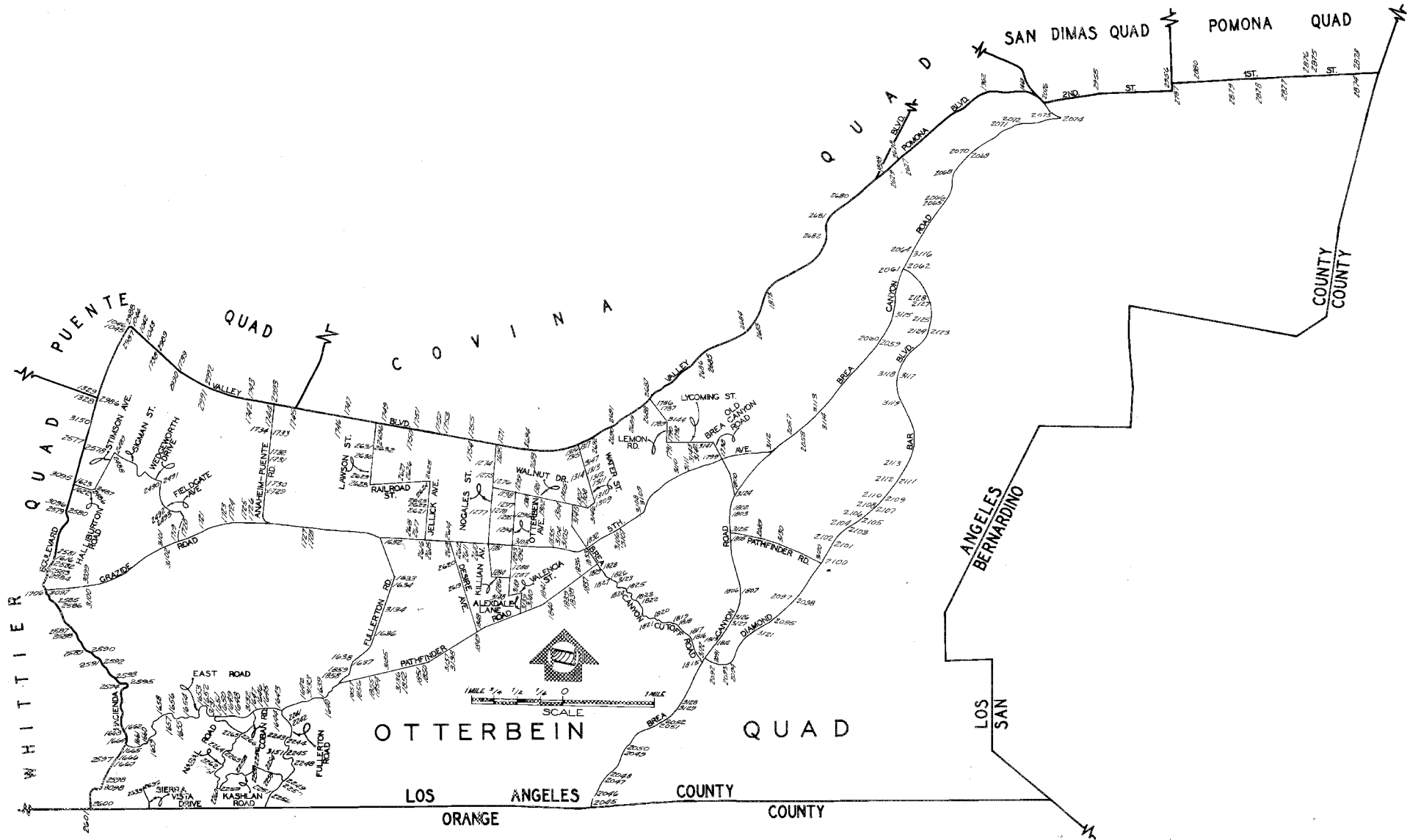

WHITTIER QUAD
PUENTE QUAD
C O V I N A
OTTERBEIN QUAD
SAN DIMAS QUAD
POMONA QUAD
LOS ANGELES COUNTY
LOS SAN ANGELES COUNTY
LOS ANGELES COUNTY

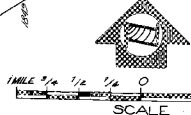

F

QUAD-YEAR	ELEV	DESCRIPTION (INCLUDE QUAD AND YEAR IN DESCRIPTION)	BM NUMBER
BASELINE (1965)	328.637	L+SPK @ CTR CB RET @ NW COR OLD VALLEY BLVD + GLENDORA AVE MKD (PS)	BG 1042
BASELINE (1965)	328.691	3IN IP + USGS CAP 8IN UP @ PUENTE STA OF SPRR 35FT S C/L OLD VALLEY BLVD + 160FT W C/L GLENDORA	BG 1043
BASELINE (1965)	324.408	L+T CONC WK 4FT S OF SW COR OF BLDG NO 15703 30F E C/L RIDGEWAY ST + 30FT N C/L OLD VALLEY BLVD	BG 1044
BASELINE (1965)	322.309	RD MON IN WELL 8IN DN @ C/L INT OLD VALLEY BLVD + HACIENDA BLVD	BG 1045
BASELINE (1965)	323.860	CS MON FLUSH 1FT E OF E CB 41FT E C/L HACIENDA BLVD + 10FT S OF S RAIL SPRR MKD (8M 11-114A)	BG 1046
BASELINE (1965)	456.320	R D MON IN WELL 10 IN DN @ C/L INT VALLEY BLVD + NOGALES ST	BG 1271
OTTRBEIN (1965)	440.746	L+BN SE COR CONC BASE OF WATER PUMP 65FT W C/L NOGALES ST + 75FT N C/L SAN JOSE AVE	BG 1274
OTTRBEIN (1965)	446.835	L+BN CTR OF CONC HDWL OF DRAIN 15FT S OF UPRR + 32FT E C/L NOGALES ST	BG 1276
OTTRBEIN (1965)	456.806	L+BN N EDGE OF OIL TANK 25FT E C/L NOGALES ST 325FT N OF HSE NO 1310 + OPP PP NO 188081E	BG 1277
OTTRBEIN (1965)	463.620	L+BN NW EDGE OF OIL TANK 22FT E C/L NOGALES ST + 170FT S OF HSE NO 1310	BG 1278
OTTRBEIN (1965)	501.422	L+BN N EDGE CONC DR TO HSE NO 1860 40FT E C/L NOGALES ST	BG 1284
OTTRBEIN (1965)	517.212	L+BN CTR W HDWL OF DR TO HSE NO 19039 20FT N C/L KILLIAN AVE	BG 1286
OTTRBEIN (1965)	527.038	L+BN TOP 24IN STANDPIPE @ NW COR KILLIAN AVE + OTTERBEIN AVE	BG 1287
OTTRBEIN (1965)	526.221	L+BN TOP 24IN STANDPIPE 25FT W C/L OTTERBEIN AVE + 100FT S OF DR TO HSE NO 1847	BG 1288
OTTRBEIN (1965)	499.433	L+T SE COR CONC PORCH FLOOR OF HSE NO 1523 OTTERBEIN AVE 45FT W C/L	BG 1294
OTTRBEIN (1965)	485.804	L+BN W CB OTTERBEIN AVE 10FT W C/L + 10FT N C/L PROD TRANBARGER ST	BG 1295
OTTRBEIN (1965)	487.961	L+BN CONC RET WALL 2FT N OF END 20FT E + 20FT N C/L INT OTTERBEIN AVE + TRANBARGER ST	BG 1296
OTTRBEIN (1965)	472.920	L+BN E EDGE OF OIL TANK 15FT S OF DR TO HSE NO 1301 + 50FT W C/L OTTERBEIN AVE	BG 1297
OTTRBEIN (1965)	462.514	L+T CTR OF 2ND STEP NE COR OF CHURCH BLDG @ SW COR WALNUT DR + OTTERBEIN AVE	BG 1298
OTTRBEIN (1965)	462.627	L+T S END OF 1ST CONC STEP TO PORCH OF STORE @ NE COR WALNUT DR + OTTERBEIN ST	BG 1299
OTTRBEIN (1965)	467.311	L+BN CTR OF HDWL OF DRAIN W SIDE OF DR TO HSE NO 15254 WALNUT DR 20FT S C/L	BG 1300
OTTRBEIN (1965)	470.632	L+BN NR E END HDWL OF CONC BLDG NO 361 10FT W OF DR TO HSE NO 19335 WALNUT DR 20FT N C/L	BG 1301
OTTRBEIN (1965)	471.269	L+BN E END HDWL OF CONC BLDG NO 361 20FT S C/L WALNUT DR OPP DR TO HSE NO 19335	BG 1302

QUAD-YEAR	ELEV	DESCRIPTION (INCLUDE QUAD AND YEAR IN DESCRIPTION)	BM NUMBER
OTTRBEIN (1965)	487.615	L+BN E EDGE OF CONC WK TO HOSPITAL CASA ALEGRE NO 19506 WALNUT DR 21FT S C/L	BG 1304
OTTRBEIN (1965)	491.688	L+T S EDGE OF CONC WK TO HSE NO 19565 WALNUT DR 3FT S OF STEP + 60FT N C/L	BG 1305
OTTRBEIN (1965)	502.450	L+T 6FT E OF W END CONC RET WALL 70FT W PP NO 47129E + 23FT N C/L WALNUT DR	BG 1307
OTTRBEIN (1965)	503.682	L+T CONC RET WALL 10FT W OF HSE NO 19734 WALNUT DR 23FT N C/L 10FT W PP NO 507758E	BG 1308
OTTRBEIN (1965)	508.579	L+T W END CONC HDWL 18FT S C/L WALNUT DR + 25FT E C/L PROD WATER ST	BG 1309
OTTRBEIN (1965)	492.781	L+BN W END CONC HDWL OF DRAIN 15FT E C/L WATER ST + 450FT N C/L WALNUT DR	BG 1310
OTTRBEIN (1965)	484.804	L+T E EDGE CONC WK 15FT N OF STEPS TO HSE NO 1111 WATER ST 45FT W C/L	BG 1311
OTTRBEIN (1965)	486.435	L+BN CTR N END OF CONC CULV 5FT N OF WK TO HSE NO 1111 WATER ST 20FT E C/L	BG 1312
OTTRBEIN (1965)	488.680	L+BN NW SIDE OF CONC BASE OF RR X SIGNAL 12FT S OF S RAIL UPRR + 15FT E C/L WATER ST MKD (NO 3-23,4)	BG 1313
OTTRBEIN (1965)	487.245	L+BN SE COR OF CONC BASE OF RR X SIGNAL BOX NO 318 12FT S OF S RAIL UPRR + 10FT W C/L WATER ST	BG 1314
OTTRBEIN (1965)	482.938	L+T WK TO HSE NO 817 25FT W WATER ST + 200FT S C/L HOWELL RD	BG 1315
BASELINE (1965)	487.479	L+BN S SIDE OF CONC BASE OF RR X SIGNAL 12FT S OF S RAIL SPRR + 25FT E C/L WATER ST	BG 1316
BASELINE (1965)	487.221	L+BN IN CONC BASE OF RR X SIGNAL 15FT N OF N RAIL SPRR + 20FT W C/L WATER ST + 60FT S C/L VALLEY BLVD MKD (50-57A)	BG 1317
BASELINE (1965)	332.668	L+T NR CTR CB RET @ SW COR GALE AVE + HACIENDA BLVD 47FT S + 47FT W C/L INT MKD (BM P)	BG 1328
BASELINE (1965)	332.052	RDBM TAG N CB 9FT E BCR @ NW COR HACIENDA BLVD + GALE AVE 36FT N + 70FT W C/L INT	BG 1329
BASELINE (1965)	785.441	BRONZE DISK IN CTR OF CONC ABUT OF SPRR CULV 8FT N OF TRACKS 250FT W INT VERNON AVE + BELLEVUE AVE	BG 1469
BASELINE (1965)	497.882	CS BRASS MON FLUSH IN CB ON SE COR HACIENDA BLVD + LOS ALTOS DR 53FT S + 80FT E C/L INT MKD (BM 38-9A 1963)	BG 1616
BASELINE (1965)	406.134	RDBM TAG S CB + 1FT W BCR @ SE COR HACIENDA BLVD + HALLIBURTON RD + 40FT S C/L + 84FT E C/L INT	BG 1622
BASELINE (1965)	405.239	RDBM TAG N CB 1FT E BCR @ NE COR HACIENDA BLVD + HALLIBURTON RD 40FT N + 72FT E C/L INT	BG 1623
OTTRBEIN (1965)	499.269	RDBM TAG S END CONC HDWL 40FT N OF DR TO ROWLAND SCHOOL 20FT E C/L FULLERTON RD + 0.5 MI S 5TH AVE	BG 1633

QUAD-YEAR	ELEV	DESCRIPTION (INCLUDE QUAD AND YEAR IN DESCRIPTION)	BM NUMBER
OTTRBEIN (1965)	502.458	CS MON IN WELL 12IN DN @ PI OF CURVE @ S ENT TO ROWLAND SCHOOL 12FT E C/L FULLERTON RD + 0.5 MI S 5TH AVE	BG 1634
OTTRBEIN (1965)	588.781	CS TAG + BRAD IN SW END CONC HDWL 50FT S OF DR TO HSE NO 2804 FULLERTON RD 28FT N C/L + 1.5 MI S 5TH AVE	BG 1637
OTTRBEIN (1965)	589.472	CS MON IN WELL 8IN DN @ PI OF CURVE 65FT FROM CONC HDWL 105FT S OF DR TO HSE NO 2804 FULLERTON RD 9FT N C/L + 1.5 MI S 5TH AVE	BG 1638
OTTRBEIN (1965)	658.919	R D MON 8IN DN ON PI OF CURVE TO SW 12FT W C/L PVMT FULLERTON RD 30FT NW PP 875077E 2.0MI S 5TH AVE	BG 1639
OTTRBEIN (1965)	653.390	RDBM TAG IN S END CONC HDWL 30FT SE C/L 18FT S PP NO 875077E + 2.0 MI S 5TH AVE	BG 1640
OTTRBEIN (1965)	708.947	R D MON 6IN DN ON EC OF CURVE TO SW 36FT S OF ENT OF DR TO HSE 2360 FULLERTON RD 2.2MI S 5TH AVE	BG 1642
OTTRBEIN (1965)	870.544	RD MON IN WELL 8IN DN 60FT N C/L PROD EAST RD 35FT NW C/L FULLERTON RD + 15FT E C/L SKYLINE DR	BG 1643
OTTRBEIN (1965)	871.190	CHIS X ON W END POST OF STEEL GUARD RAIL 22FT S C/L EAST RD + 35FT W C/L FULLERTON RD	BG 1644
OTTRBEIN (1965)	829.957	L+T CONC DR TO HSE NO 1505 EAST RD 27FT N C/L + 0.2 MI W FULLERTON RD	BG 1645
OTTRBEIN (1965)	817.854	CHIS X ON FIRE HYD 4FT UP 25FT N C/L EAST RD 9FT W OF DR TO HSE NO 1485 + 0.25 MI W FULLERTON RD	BG 1646
OTTRBEIN (1965)	779.046	L+T CONC FOUNDATION OF W BRICK GATE POST @ HSE NO 1409 EAST RD 20FT N C/L 70FT E C/L COBAN RD + 0.4 MI W FULLERTON RD	BG 1647
OTTRBEIN (1965)	746.759	RDBM TAG N WINGWALL CONC HDWL 13FT E OF ENT TO HSE NO 1276 EAST RD 15FT S C/L + 0.6 MI W FULLERTON RD	BG 1648
OTTRBEIN (1965)	748.212	L+T E SIDE BOT STEP TO HSE NO 1276 EAST RD 30FT S C/L + 0.6 MI W FULLERTON RD	BG 1649
OTTRBEIN (1965)	720.253	RDBM TAG CTR CONC HDWL @ NE COR EAST RD + VALLE DR 21FT N + 12FT E C/L INT	BG 1650
OTTRBEIN (1965)	720.091	L+T CONC DR TO HSE NO 1141 EAST RD @ NW COR VALLE DR 70FT N + 15FT W C/L INT	BG 1651
OTTRBEIN (1965)	731.922	L+T S CB OF DR TO HSE NO 1001 PAPAYA DR 20FT E C/L + 27FT N C/L PROD EAST RD	BG 1652
OTTRBEIN (1965)	716.814	RDBM TAG CTR CONC HDWL OF DROP INLET 21FT N C/L EAST RD + 300FT W C/L PAPAYA DR	BG 1653
OTTRBEIN (1965)	708.166	RDBM TAG IN CTR CONC HDWL 15FT N C/L EAST RD E PP NO 1124854E + 1.2 MI W FULLERTON RD	BG 1654
OTTRBEIN (1965)	714.581	RDBM TAG IN NE COR CONC FOOTING FOR GAS METER W SIDE HACIENDA COUNTR 80FT S C/L EAST RD + 1.4 MI W FULLERTON RD	BG 1655
OTTRBEIN (1965)	728.030	CHIS X IN W POST STEEL GUARD RAIL 17FT S C/L EAST RD 100FT E OF DR TO HSE NO 640 + 1.5 MI W FULLERTON RD	BG 1656

QUAD-YEAR	ELEV	DESCRIPTION (INCLUDE QUAD AND YEAR IN DESCRIPTION)	BM NUMBER
OTTRBEIN (1965)	727.026	L+T ON E SIDE CONC DR TO HSE NO 640 EAST RD 15FT S C/L + 1.5MI W FULLERTON RD	BG 1657
OTTRBEIN (1965)	734.363	CHIS X ON TOP FIRE HYD BET HSE NO 500 + NO 502 EAST RD 25FT S C/L + 30FT E C/L CHURCHILL RD MKD (BM)	BG 1658
OTTRBEIN (1965)	650.082	CHIS X S POST OF STEEL GUARD RAIL 15FT W C/L EAST RD + 1.9 MI W FULLERTON RD	BG 1659
OTTRBEIN (1965)	606.000	L+T NW CB EAST RD 15FT NW C/L 45FT N TP NO W1678Y + 2.0 MI W FULLERTON RD	BG 1660
OTTRBEIN (1965)	547.488	RDBM TAG CTR CONC HDWL 16FT N C/L EAST RD 50FT NW TP NO W1671Y + 1000FT W HACIENDA BLVD	BG 1661
BASELINE (1965)	605.169	CS MON IN WELL 8IN DN ON C/L ENCANADA DR 47FT W C/L HACIENDA BLVD MKD (44-13-4 1954)	BG 1662
BASELINE (1965)	605.381	CS MON FLUSH @ SW COR HACIENDA BLVD + ENCANADA DR 23FT W + 20FT S C/L INT	BG 1663
BASELINE (1965)	551.781	RDBM TAG INCTR OF S SIDE CONC VALVE BOX 12FT N + 24FT W C/L INT HACIENDA BLVD + EAST RD	BG 1664
BASELINE (1965)	555.235	L+T IN W END CONC STEP TO OFFICE @ SE COR HACIENDA BLVD + EAST RD 50FT E + 40FT S C/L INT MKD (BM)	BG 1665
BASELINE (1965)	512.744	L+BRAD 2FT S OF N END CONC HDWL OPP HSE NO 1703 HACIENDA BLVD 21FT E C/L MKD (BM)	BG 1666
BASELINE (1965)	494.150	CS MON IN WELL 12IN DN ON C/L PI 63FT NE C/L INT HACIENDA BLVD + WEST RD	BG 1667
BASELINE (1965)	552.190	L+T S CB 22FT W BCR @ SW COR HACIENDA BLVD + COLIMA RD 42FT S + 97FT W C/L INT	BG 1706
OTTRBEIN (1965)	595.866	RDBM TAG IN NW CONC FOOTING TO EDISON TOWER NO 1/3 182FT S C/L GRAZIDE RD + 4985FT W ANAHEIM-PUENTE RD	BG 1719
OTTRBEIN (1965)	562.634	RD MON IN WELL 6 IN DN 124FT NE C/L GRAZIDE RD + 4985FT W ANAHEIM-PUENTE RD 2FT S OF 2IN X 3FT GUARD PIPE	BG 1720
OTTRBEIN (1965)	457.157	RD MON IN WELL 6IN DN 110FT NE C/L GRAZIDE RD + 1765FT W ANAHEIM-PUENTE RD 2FT S OF 2IN X 3FT GUARD PIPE	BG 1724
OTTRBEIN (1965)	460.946	RDBM TAG SW COR CONC PUMP BASE 12IN UP 65FT N C/L FIFTH AVE + 415FT E C/L ANAHEIM-PUENTE RD	BG 1726
OTTRBEIN (1965)	453.486	RDBM TAG CTR HDWL 50FT S C/L FIFTH AVE @ MI POST 0.51 0.5 MI E ANAHEIM-PUENTE RD	BG 1727
OTTRBEIN (1965)	453.327	CS MON 3FT W CULV HDWL 50FT S C/L FIFTH AVE @ MI POST 0.51 0.5 MI E ANAHEIM-PUENTE RD MKD (BM 44-13 1955 RE 63)	BG 1728
OTTRBEIN (1965)	421.058	RDBM TAG N SIDE CONC DR TO HSE NO 1356 ANAHEIM-PUENTE RD 50FT E C/L + 115FT N C/L BONITA VISTA	BG 1729
OTTRBEIN (1965)	418.512	L+T ON N SIDE OF CONC WK TO HSE NO 1344 ANAHEIM-PUENTE RD 50FT E C/L + 240FT N C/L BONITA VISTA LANE MKD (BM)	BG 1730
OTTRBEIN (1965)	390.823	CS MON IN WELL 10IN DN ON C/L ANAHEIM-PUENTE RD 295FT S UPRR TRACK MKD (PUENTE RD 1-2)	BG 1731

QUAD-YEAR	ELEV	DESCRIPTION (INCLUDE QUAD AND YEAR IN DESCRIPTION)	BM NUMBER
OTTRBEIN (1965)	389.683	RDBM TAG IN S HDWL 18FT E C/L ANAHEIM-PUENTE RD + 10FT S C/L UPRR TRACK	BG 1732
OTTRBEIN (1965)	376.350	L+T CONC RIM WATER VALVE BOX 45FT W C/L ANAHEIM- PUENTE RD + 1250FT N UPRR TRACKS 200FT S OFFICE DAY + NIGHT MFG CO MKD (BM)	BG 1734
BASELINE (1965)	335.689	L+T CONC FOUNDATION OF GAS STA 33FT W C/L ALBERT ST + 50FT S C/L OLD VALLEY BLVD MKD (BM)	BG 1738
BASELINE (1965)	343.475	RDBM TAG N CB 4FT E BCR 20FT N C/L OLD VALLEY BLVD + 28FT E C/L BAJA AVE	BG 1739
BASELINE (1965)	370.330	L+BN N CONC HDWL 75FT S C/L VALLEY BLVD + 150FT W C/L WICKFORD AVE	BG 1742
BASELINE (1965)	373.088	L+T IN END OF ISL 4FT N C/L VALLEY BLVD + 60FT W C/L WICKFORD AVE	BG 1743
BASELINE (1965)	374.904	CT SPK CTR HDWL 27FT E C/L ANAHEIM-PUENTE RD + 65FT S C/L VALLEY BLVD MKD (BM 16)	BG 1744
BASELINE (1965)	379.341	RD MON IN WELL 7IN DN @ C/L INT VALLEY BLVD + PASS + COVINA RD	BG 1745
BASELINE (1965)	390.096	RD MON IN WELL 8IN DN ON C/L INT VALLEY BLVD + HAMBLEDON AVE	BG 1746
BASELINE (1965)	389.843	L+T N CB VALLEY BLVD 3FT E BCR @ NE COR HAMBLEDON AVE 36FT N + 47FT E C/L INT	BG 1747
BASELINE (1965)	398.416	L+T N CB 6FT E BCR 40FT N C/L VALLEY BLVD + 46FT E C/L GIANO AVE	BG 1749
BASELINE (1965)	412.372	L+BN IN RR SIGNAL BASE 75FT S C/L VALLEY BLVD + 35FT W C/L YORBITA RD	BG 1750
BASELINE (1965)	410.050	RDBM TAG CTR CONC HDWL 43FT N C/L VALLEY BLVD + 25FT E C/L YORBITA RD	BG 1751
BASELINE (1965)	419.894	RDBM TAG W CB 11FT N BCR 81FT N C/L VALLEY BLVD + 20FT W C/L LA SEDA RD	BG 1752
BASELINE (1965)	419.960	L+T E CB 12FT N BCR 82FT N C/L VALLEY BLVD + 20FT E C/L LA SEDA RD	BG 1753
BASELINE (1965)	429.646	L+BN E END CONC HDWL 70FT S C/L VALLEY BLVD + 0.2MI E LA SEDA RD MKD (BM 12)	BG 1754
BASELINE (1965)	432.923	RDBM TAG N CB 1FT W CATCH BASIN 40FT N VALLEY BLVD + 0.2 MI E LA SEDA RD	BG 1755
OTTRBEIN (1965)	520.789	RDBM TAG IN E CB LEMON AVE 30FT E C/L + 0.2 MI N CURRIER RD NR DRAINAGE BOX FROM WALNUT SCHOOL	BG 1786
OTTRBEIN (1965)	521.179	RDBM TAG IN S END CONC WALL OF BUS LOADING YARD @ WALNUT SCHOOL 40FT E C/L LEMON AVE + 0.2 MI N CURRIER RD	BG 1787
OTTRBEIN (1965)	527.364	RDBM TAG W END CONC HDWL 17FT S C/L CURRIER RD + 46FT E C/L LEMON RD	BG 1789
OTTRBEIN (1965)	529.080	L+T NR CTR OF CURVED CONC HDWL 24FT N C/L LYCOMING ST + 26FT E C/L LEMON RD	BG 1790
OTTRBEIN (1965)	528.888	L+T NR CTR OF CURVED CONC HDWL 28FT S C/L LYCOMING ST + 26FT E C/L LEMON RD	BG 1791

QUAD-YEAR	ELEV	DESCRIPTION (INCLUDE QUAD AND YEAR IN DESCRIPTION)	BM NUMBER
OTTRBEIN (1965)	535.473	L+BN S END CONC HDWL 23FT N C/L LYCOMING ST + 42FT W C/L BANNING WAY MKD (BM)	BG 1792
OTTRBEIN (1965)	579.870	RDBM TAG IN CONC HDWL @ OUT FIFTH AVE + OLD BREA CANYON RD 26FT N + OUT C/L INT	BG 1798
OTTRBEIN (1965)	578.610	CS MON IN WELL @ NW OUT OLD BREA CANYON RD + FIFTH AVE 11FT N + OUT C/L INT	BG 1799
OTTRBEIN (1965)	641.936	USC+GS TRI STA MON FLUSH 27FT W C/L OLD BREA CANYON RD @ INT BREA CANYON RD MKD (STOP 1938)	BG 1800
OTTRBEIN (1965)	717.344	USC+GS MON 6IN UP 50FT E C/L BREA CANYON RD + 0.3 MI S OLD BREA CANYON RD MKD (M 346)	BG 1802
OTTRBEIN (1965)	741.742	USC+GS BR MON FLUSH 50 OUT E C/L BREA CANYON RD + 0.4 MI S OLD BREA CANYON RD BR HDWL NO B 191 + 25 MKD (N 346)	BG 1803
OTTRBEIN (1965)	793.897	RDBM TAG NR N END HDWL NO B 173+89 20FT E C/L BREA CANYON RD + 0.7 MI S OLD BREA CANYON RD	BG 1805
OTTRBEIN (1965)	772.628	RDBM TAG IN CONC CATTLE UNDER PASS NO B 158+59 32FT W C/L BREA CANYON RD + 1.0 MI N BREA CANYON CUTOFF RD	BG 1806
OTTRBEIN (1965)	771.461	RDBM TAG IN S END CONC CATTLE UNDERPASS NO B 158+50 24FT E C/L BREA CANYON RD + 1.0 MI N BREA CANYON CUTOFF RD	BG 1807
OTTRBEIN (1965)	692.656	USC+GS BR MON FLUSH 26FT E C/L BREA CANYON RD + 0.2 MI N BREA CANYON CUTOFF RD MKD (F 347)	BG 1812
OTTRBEIN (1965)	692.887	RDBM TAG IN CONC HDWL NO B 118+54 20FT W C/L BREA CANYON RD + 0.2 MI N BREA CUTOFF RD	BG 1813
OTTRBEIN (1965)	681.889	USC+GS BR WITNESS COR FLUSH 44FT S + 25FT W C/L INT BREA CANYON CUTOFF RD + BREA CANYON RD MKD (SPADRA NO 1)	BG 1815
OTTRBEIN (1965)	762.537	RDBM TAG NR CTR CONC HDWL 18FT N C/L BREA CANYON CUTOFF RD + 0.3 MI N BREA CANYON RD	BG 1816
OTTRBEIN (1965)	765.956	CS BR MON 2IN UP NR 2IN WHITE WITNESS PIPE 110FT N C/L BREA CANYON CUTOFF RD + 0.3 MI N BREA CANYON RD MKD (BM 12)	BG 1817
OTTRBEIN (1965)	809.236	CS BR MON 2IN UP NR 2IN WHITE WITNESS PIPE 50FT E OF E END OF BRIDGE NO B 761 75FT N C/L BREA CANYON CUTOFF RD + 0.5 MI N BREA CANYON RD MKD (BM 11)	BG 1818
OTTRBEIN (1965)	821.619	RDBM TAG IN CONC HDWL 15FT N C/L BREA CANYON CUTOFF RD + 0.55 MI N BREA CANYON RD	BG 1819
OTTRBEIN (1965)	872.270	BT SPK IN CONC HDWL 15FT N C/L BREA CANYON CUTOFF RD + 0.75 MI N BREA CANYON RD 550FT FROM SUMMIT MKD (BM 9)	BG 1820
OTTRBEIN (1965)	874.168	2IN IP 2IN UP 50FT S C/L BREA CANYON CUTOFF RD + 0.75 MI N BREA CANYON RD 500FT FROM SUMMIT MKD (LS 2311)	BG 1821
OTTRBEIN (1965)	894.527	BT HD SPK IN CONC HDWL 21FT W C/L BREA CANYON CUTOFF RD + 0.9 N BREA CANYON RD MKD (BM 7)	BG 1822
OTTRBEIN (1965)	872.080	BT SPK IN CONC DROP INLET 15FT W C/L BREA CANYON CUTOFF RD + 1.0 MI N BREA CANYON RD MKD (BM6)	BG 1823

QUAD-YEAR	ELEV	DESCRIPTION (INCLUDE QUAD AND YEAR IN DESCRIPTION)	BM NUMBER
OTTRBEIN (1965)	772.383	BT SPK IN CONC HDWL OF CATTLE UNDERPASS 16FT SW C/L BREA CANYON CUTOFF RD + 0.75 MI S FIFTH AVE MKD (BM 3)	BG 1824
OTTRBEIN (1965)	770.153	RDBM TAG IN CONC HDWL TO CATTLE UNDERPASS 10FT NE C/L BREA CANYON CUTOFF RD + 0.75 MI S FIFTH AVE	BG 1825
OTTRBEIN (1965)	725.128	L+BN IN CONC HDWL OF DIRT RD TO WATER TANK 10FT N C/L 66FT W C/L BREA CANYON CUTOFF RD + 0.6 MI S FIFTH AVE MKD (BM)	BG 1826
OTTRBEIN (1965)	715.969	RDBM TAG CONC HDWL OF DIRT RD TO WATER TANK 36FT S C/L 25FT W C/L BREA CANYON CUTOFF RD + 0.6 MI S FIFTH AVE MKD (BM)	BG 1827
OTTRBEIN (1965)	673.466	RDBM TAG NW COR CONC HDWL 20FT W C/L BREA CANYON CUTOFF RD 50FT S OF BC + 0.4MI S FIFTH AVE	BG 1828
OTTRBEIN (1965)	652.059	CS MON IN WELL 8IN DN @ C/L INT PATHFINDER RD + BREA CANYON CUTOFF RD 0.35 MI S FIFTH AVE	BG 1829
OTTRBEIN (1965)	567.922	3/4IN IP 6IN DN @ C/L INT BREA CANYON CUTOFF RD + FIFTH AVE	BG 1832
OTTRBEIN (1965)	522.047	CS MON IN WELL 6IN DN 10FT N C/L FIFTH AVE + 0.32MI W BREA CANYON CUTOFF RD @ MI POST 3.15 MKD (BM 44-8)	BG 1835
OTTRBEIN (1965)	656.472	CS MON IN WELL 24IN DN 66FT N OF PI PATHFINDER RD 1000FT W C/L BREA CANYON CUTOFF RD	BG 1836
OTTRBEIN (1965)	647.871	CS MON IN WELL 18IN DN 34FT S OF PI PATHFINDER 1000FT W C/L BREA CANYON CUTOFF RD	BG 1837
OTTRBEIN (1965)	632.109	L+T BOTTOM CONC STEP TO GARAGE 80FT S C/L PATHFINDER RD 476FT S C/L REEDVIEW DR + 0.4MI W BREA CANYON CUTOFF RD	BG 1838
OTTRBEIN (1965)	639.229	CS MON 24IN DN 50FT S C/L PATHFINDER RD 388FT S C/L REEDVIEW DR + 0.45MI W BREA CANYON CUTOFF RD	BG 1839
OTTRBEIN (1965)	646.159	CS MON 24IN DN 50FT S RP TO POT C/L PATHFINDER RD + 1027FT E HOWELL RD (USE E EDGE)	BG 1840
OTTRBEIN (1965)	635.449	CS MON 18IN DN 50FT N RP TO POT C/L PATHFINDER RD + 1027FT E HOWELL RD (USE N EDGE)	BG 1841
OTTRBEIN (1965)	574.077	1/2IN IP 3IN UP IN CONC FTG OF 5FT CHAIN LINK FEN ON NE COR PATHFINDER + DESIRE AVE NLY + 20FT ELY APPROX C/L INT	BG 1848
OTTRBEIN (1965)	573.930	3/4IN IP + RE 248 TAG 8IN UP ALONG FENCE LINE 128FT W C/L DESIRE AVE + 0.95 MI S FIFTH AVE	BG 1849
OTTRBEIN (1965)	634.888	3/4IN IP 2IN DN 50FT N C/L PATHFINDER RD 295FT W C/L GALLIO AVE + 0.2 MI S AGUIRO ST	BG 1850
OTTRBEIN (1965)	640.200	3/4IN IP 2IN DN 50FT S C/L PATHFINDER RD 295FT W C/L GALLIO AVE + 0.2MI S AGUIRO ST	BG 1851
OTTRBEIN (1965)	647.515	CHIS X IN OIL LINE VALVE BOX CASTING 95FT S C/L PATHFINDER RD 130FT W C/L BATSON AVE + 0.25MI S AGUIRO ST	BG 1852
OTTRBEIN (1965)	629.254	3/4IN IP 2IN DN 50FT N C/L PATHFINDER RD + 1835 FT E C/L FULLERTON RD (USE N EDGE)	BG 1854

QUAD-YEAR	ELEV	DESCRIPTION (INCLUDE QUAD AND YEAR IN DESCRIPTION)	BM NUMBER
OTTRBEIN (1965)	636.627	3/4IN IP 2IN DN 50FT S C/L PATHFINDER RD + 1835 FT E C/L FULLERTON RD (USE S EDGE)	BG 1855
OTTRBEIN (1965)	632.510	3/4IN IP 3IN DN 50FT S C/L PATHFINDER RD + 780FT E C/L FULLERTON RD (USE SE EDGE)	BG 1856
OTTRBEIN (1965)	615.039	3/4IN IP 2IN DN 50FT N C/L PATHFINDER RD + 780FT E C/L FULLERTON RD (USE W EDGE)	BG 1857
OTTRBEIN (1965)	629.529	CS MON IN WELL 4FT W C/L FULLERTON RD 35FT E PI + 115FT NE PP NO 1073667E 1.75MI S FIFTH AVE	BG 1858
OTTRBEIN (1965)	629.073	L+BRAD E END OF HDWL 30FT W OF PI FULLERTON RD + 80FT E PP NO 1073667E 1.75MI S FIFTH AVE	BG 1859
BASELINE (1965)	604.209	CS MON IN WELL 30IN DN NR CTR TRAFFIC ISL @ INT VALLEY BLVD LA PUENTE RD + GRAND AVE MKD (BM 11-95)	BG 1873
BASELINE (1965)	684.146	CS MON IN WELL 12IN DN 8FT W OF W EDGE PVMT POMONA BLVD + 8FT E OF E EDGE PVMT VALLEY BLVD MKD (BM 11-91)	BG 1898
BASELINE (1965)	771.121	RD BR CAP S HDWL 8FT S OF S RAIL + 11FT NE C/L PROD POMONA + COVINA RD NR INT POMONA BLVD + POMONA + COVINA RD + SECOND ST	BG 1962
OTTRBEIN (1965)	512.043	USC+GS MON IN CONC 2IN UP 20FT E C/L BREA CANYON RD @ L A CO LINE MKD (K422-1935)	BG 2045
OTTRBEIN (1965)	516.662	USC+GS MON IN CONC 6IN UP 34FT E BREA CANYON RD + 100FT N L A CO LINE MKD (E349-1949)	BG 2046
OTTRBEIN (1965)	564.753	USC+GS MON IN CONC 4IN UP 24FT E C/L BREA CANYON RD + 1.7MI S BREA CANYON CUTOFF RD + 0.4MI N L A CO LINE MKD (Y-421-1935)	BG 2047
OTTRBEIN (1965)	566.169	USC+GS MON IN CONC 6IN UP 64FT E C/L BREA CANYON RD + 1.6MI S BREA CANYON CUTOFF RD + 0.45MI NLY OF L A CO LINE MKD (P348-1945)	BG 2048
OTTRBEIN (1965)	610.694	USC+GS MON IN CONC 3IN UP 100FT SE C/L BREA CANYON RD + 1.25MI S BREA CANYON CUTOFF RD MKD (D 348-1949)	BG 2049
OTTRBEIN (1965)	615.845	USC+GS MON IN CONC 4IN UP 82FT SE C/L BREA CANYON RD + 1.2MI S BREA CANYON CUTOFF RD MKD (C 348-1949)	BG 2050
OTTRBEIN (1965)	632.270	USC+GS MON IN CONC 2IN UP 133FT E C/L BREA CANYON RD + 0.75MI S BREA CANYON CUTOFF RD MKD (T347-1949)	BG 2051
OTTRBEIN (1965)	634.840	USC+GS MON IN CONC 2IN UP 50FT E C/L BREA CANYON RD + 0.7MI S BREA CANYON CUTOFF RD MKD (S 347-1949)	BG 2052
OTTRBEIN (1965)	620.261	USC+GS MON FLUSH 50FT W C/L BREA CANYON RD 0.3MI N FROM FIFTH AVE MKD (ROW POINT 1938-1958)	BG 2057
OTTRBEIN (1965)	627.033	RDBM TAG 1FT S N END CONC FULL NR HWY MARKER B263+00 50FT E C/L BREA CANYON RD + 0.4MI N FIFTH AVE	BG 2058
OTTRBEIN (1965)	684.306	MET WATER DIST BR CAP MKD 1FT S N END OF CONC HDWL 38FT E C/L BREA CANYON RD + 0.5MI S DIAMOND BAR BLVD NR HWY MARKER B307+00 MKD (BM 62H 1933)	BG 2059

OUT
OUT
OUT

