

**LOS ANGELES COUNTY
DEPARTMENT OF PUBLIC WORKS**

BENCH MARK LIST



OTTERBEIN QUAD

1995 ADJUSTMENT

**NAVD 88 DATUM
METRIC**

PREFACE

The Department of Public Works level net is composed of more than 1,700 miles or 2720 kilometers of levels supporting in excess of 9,000 bench marks. Previously when a major readjustment of the net was undertaken, to emphasize the complete break with previous elevations, the CY, CG, & CL, series bench marks were re-labeled DY, DG, & DL, respectively. Beginning in 1993 the baseline readjustment year will be indicated on baseline BM,s only indicated below (*). Henceforth all BM numbers will be labeled as a Y, G, or L, series that will no longer indicate the major adjustment year.

To facilitate the adjustment, indexing and distribution of adjusted values of the net, the county territory was divided into 33 quads or areas. For the identification purposes each quad was given a name, viz., "Rosemead," "La Mirada," "Santa Fe," etc. When bench marks and elevations in these quads are used, the name must be included in the bench mark description, e.g.,

* BASELINE 90.057 L&BR IN CTR OF CB RET @ NE COR Y 9191
 (1990) 295.461 LA HABRA BLVD & VALLEY HOME AVE
 10.7M N & 10.7M E/O C/L INT

It is expected that this general adjustment will for the most part remain sound for 8 to 12 years. Updating constrained adjustments will continue in the future. When a quad is readjusted, new elevations will be published and the date of readjustment will be noted in the bench mark description. Two bench marks with different adjustment dates will not normally agree with each other.

The basic accuracy of the net is reflected by an indicated field probable error of plus or minus 0.004mm per kilometer of leveling as determined from the conditions of closure. However, many years of experience in vertical control in the greater Los Angeles basin and Antelope Valley indicate that because of varying degrees of subsidence and heaving, the true datum is recovered only by obtaining substantial agreement of a number of bench marks.

The users of this net are invited to assist in its maintenance by notifying this department of cases of obliteration, apparent mistakes in description or elevations, and proven disturbance of bench marks.

=====
DATUM: North American Vertical Datum of 1988 (NAVD88)

Note: NAVD 1988 minus approximately 700mm (2.3ft) equals
Previous NGVD 1929 Datums. For more accurate equations
At individual bench marks refer to previous publications

ABBREVIATIONS USED IN BENCH MARK LISTINGS

ABUT -----	Abutment	ECR -----	End of Curb Return
ALG -----	Along	EC -----	End of Curve
ANG PT -----	Angle Point	ENT -----	Entrance
B/W -----	Back of Walk	FL -----	Floor
BCR -----	Beginning of Curb Return	FTG -----	Footing
BC -----	Beginning of Curve	FRWY -----	Freeway
BLDG -----	Building	F/W -----	Front of Walk
BM -----	Bench Mark	GAR -----	Garage
BT SPK -----	Boat or Bolt Spike	HDWL -----	Headwall
BR CAP -----	Brass or Bronze Cap	HSE -----	House
C B -----	Catch Basin	HWY -----	Highway
CTR -----	Center	INT -----	Intersection
C/L -----	Center Line	IP -----	Iron Pipe
C/L INT -----	Center Line Intersection	LT -----	Left
C/L PROD -----	Center Line Produced	LACE -----	L.A. City Engineer
CONC -----	Concrete	LACS -----	L.A. Co. Engineer
COR -----	Corner	LAFC -----	L.A. Co. Flood Control
COE -----	Corps of Engineers	L&BN -----	Lead and Bench Nail
CULV -----	Culvert	L&BR -----	Lead and Brad
CYN -----	Canyon	L&N -----	Lead and Nail
CB -----	Curb	L&SPK -----	Lead and Spike
CS MON -----	Co. Eng. Monument	L&T -----	Lead and Tack
CT SPK -----	Cut Spike	MCR -----	Middle of Curb Return
DPW -----	Dept. of Public Works	MKD -----	Marked
DR -----	Drive or Driveway	MC -----	Middle of Curve
E/O -----	East of	MON -----	Monument

ABBREVIATIONS USED IN BENCH MARKS (CON'T)

N/O ----- North of
NR ----- Near
OPP ----- Opposite
PI ----- Point of Intersection
PK&W ----- PK Nail and Washer
P/L ----- Property Line
POST ----- Point of Semi-Tangent
PP ----- Power Pole
PVMT ----- Pavement
PROD ----- Produced
RD ----- Road
RDBM ----- Road Dept. Bench Mark
RDBM TAG ----- Road Dept. Bench Mark Tag
RR ----- Railroad
RT ----- Right
R/W ----- Right of Way
SDMH ----- Storm Drain Manhole
SMH ----- Sewer Manhole
SPK ----- Spike
ST&W ----- Spike Tin and Washer
S/O ----- South of
TP ----- Telephone Pole
USC&GS ----- U.S. Coast and Geodetic Survey
USGS ----- U.S. Geological Survey
WK ----- Walk
W/O ----- West of

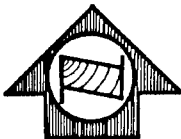
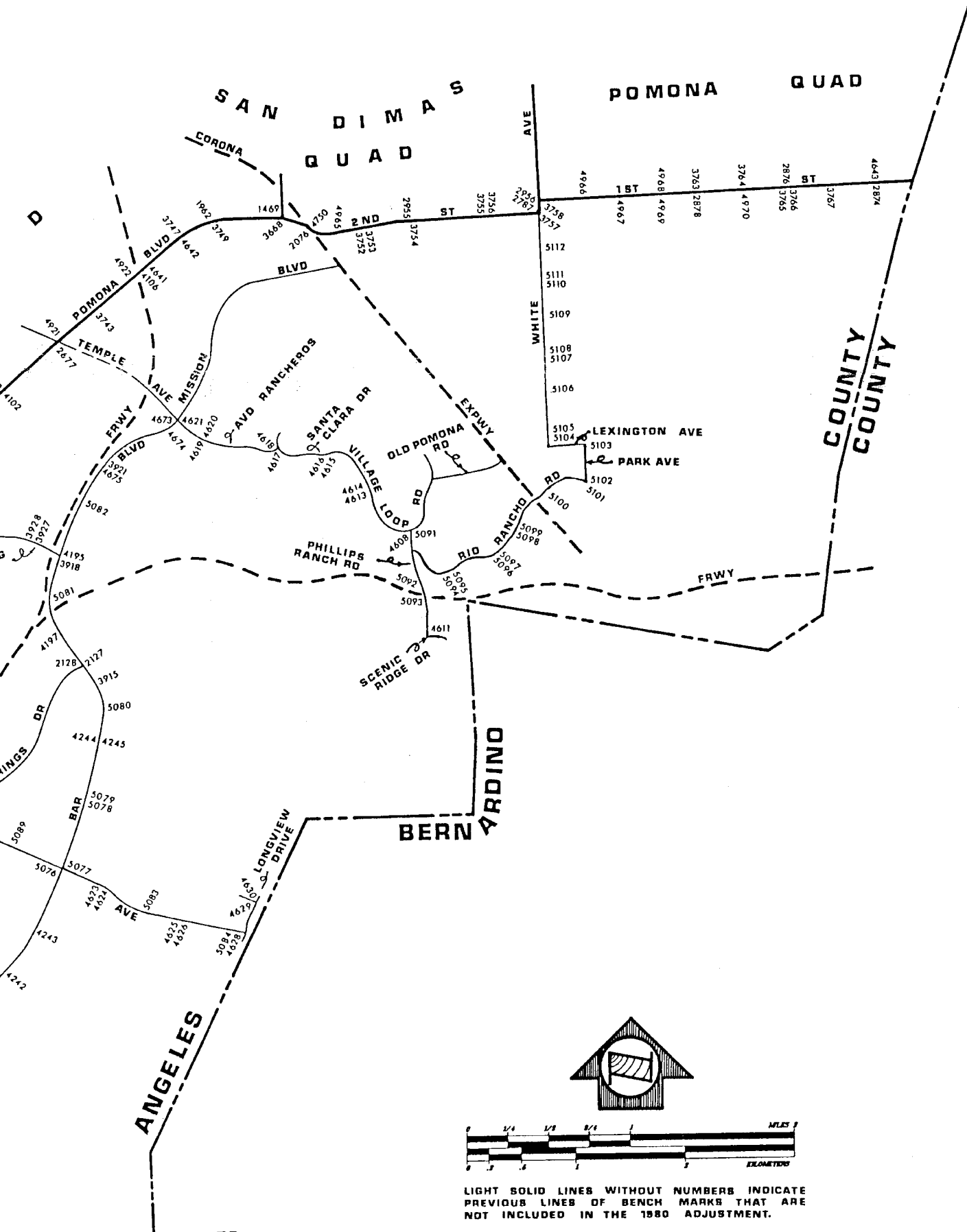

LIGHT SOLID LINES WITHOUT NUMBERS INDICATE PREVIOUS LINES OF BENCH MARKS THAT ARE NOT INCLUDED IN THE 1980 ADJUSTMENT.

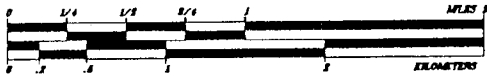
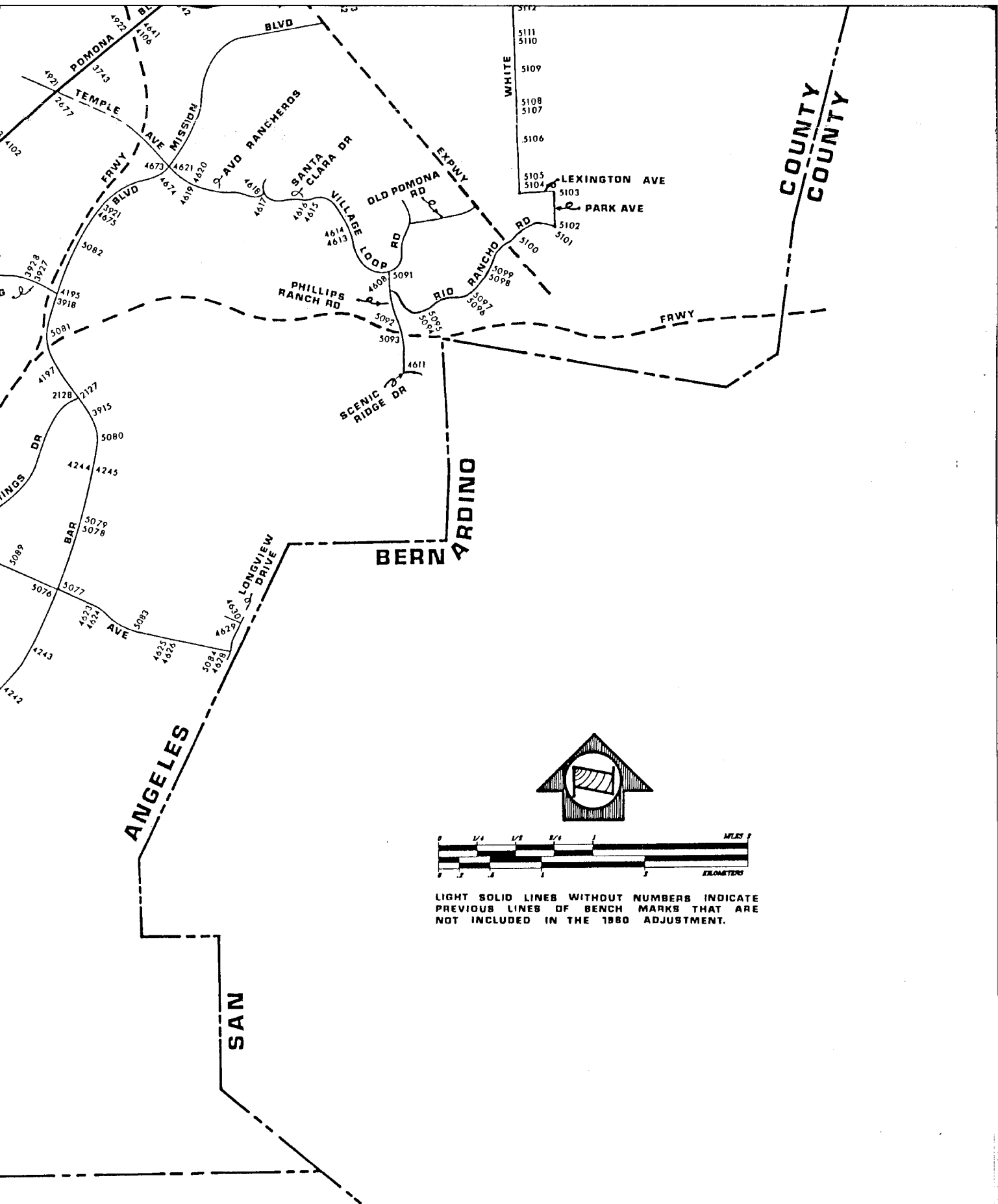

LIGHT SOLID LINES WITHOUT NUMBERS INDICATE PREVIOUS LINES OF BENCH MARKS THAT ARE NOT INCLUDED IN THE 1980 ADJUSTMENT.

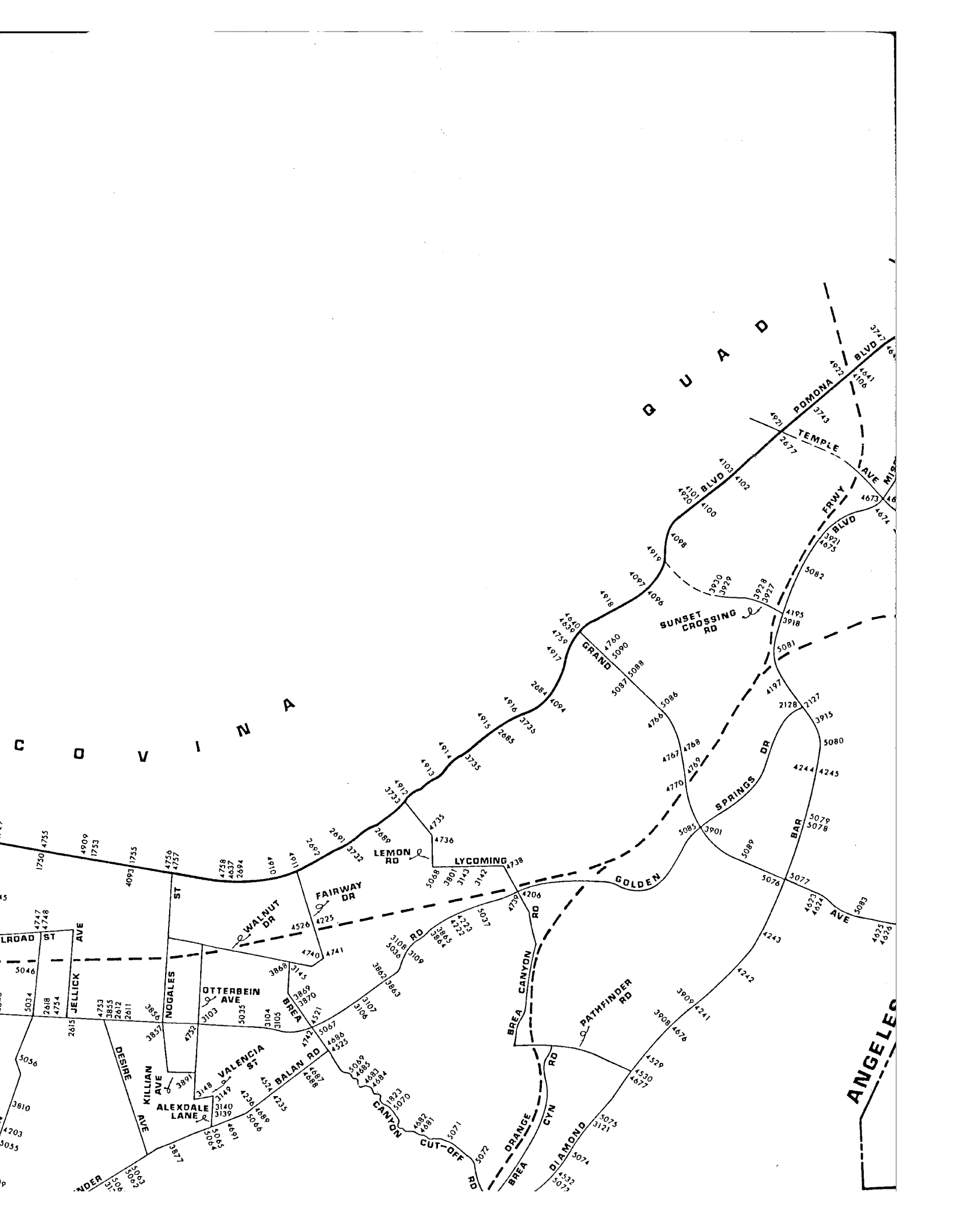

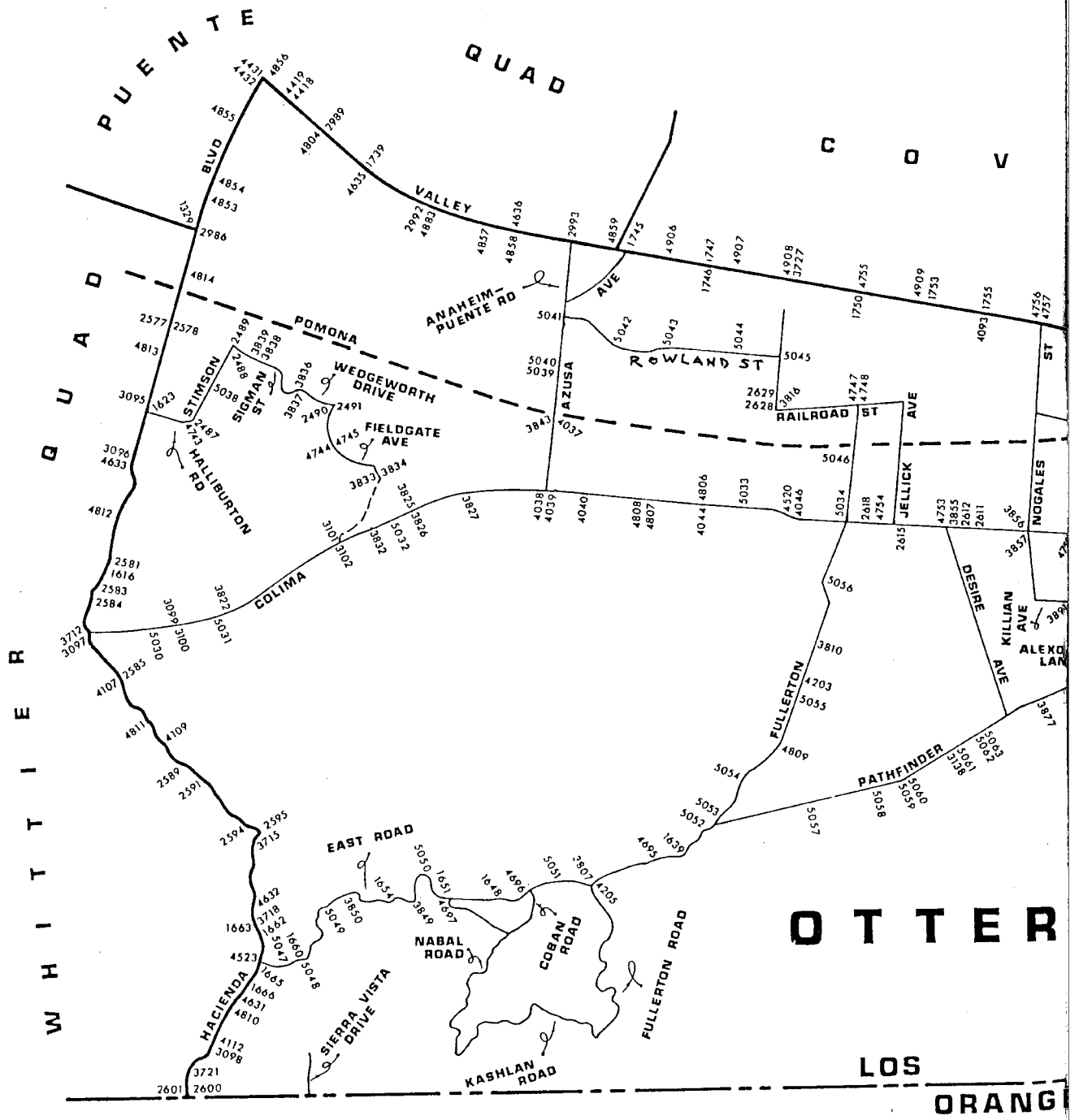

WHITTIER

P U E N T E

QUAD

C O V

OTTER

LOS ORANGE

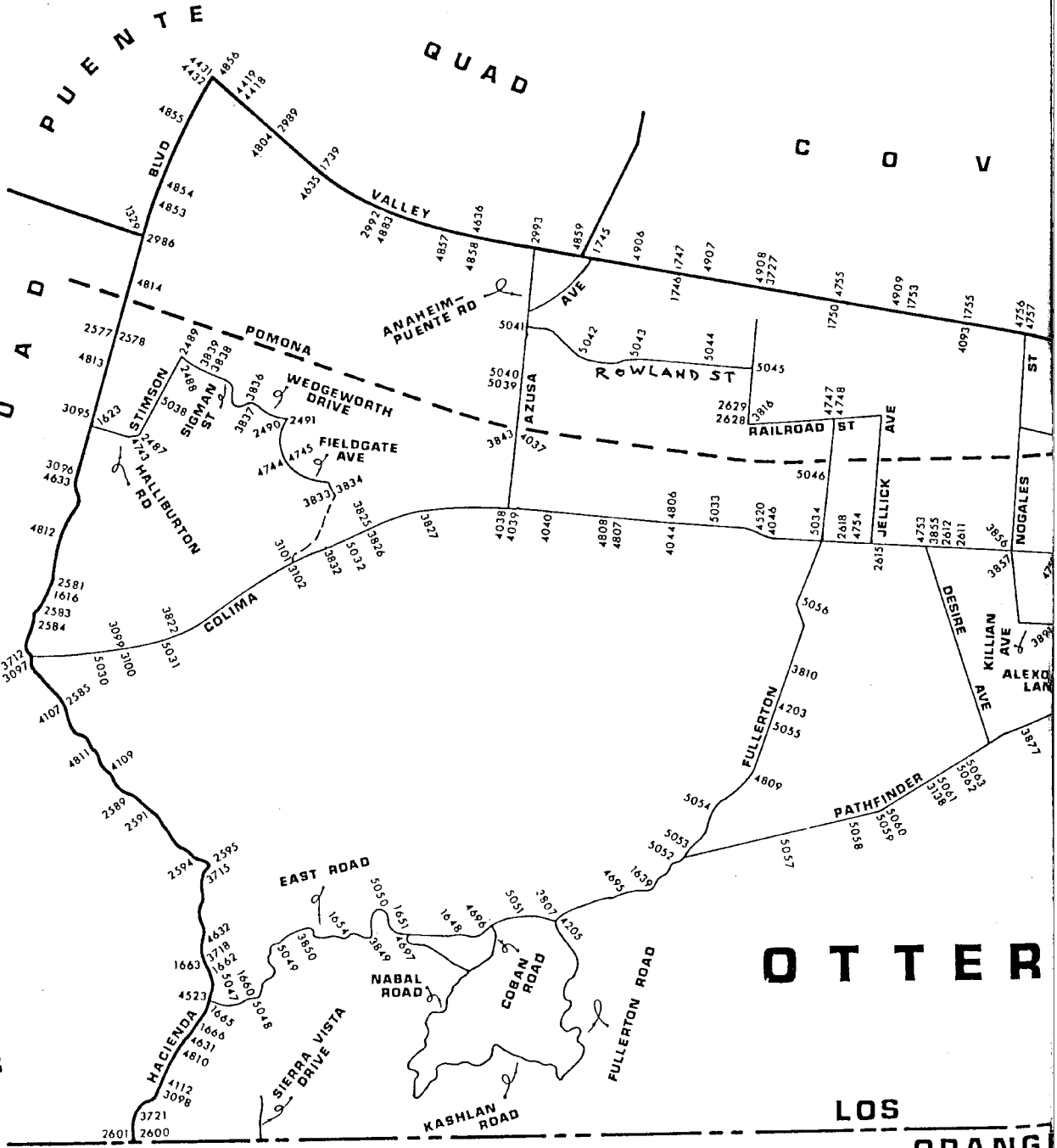

JAD-YEAR	ELEV METER/FOOT	D E S C R I P T I O N (INCLUDE QUAD AND YEAR IN DESCRIPTION)	BM NUMBER
BASELINE (1995)	0101.945 0334.465	RDBM TAG IN N CB 2.9M E/O BCR @ NW COR HACIENDA BLVD & GALE AVE 21.3M W & 11M N/O C/L INT	G 1329
BASELINE (1995)	0240.063 0787.607	MWD BR MON IN HDWL 2.4M N/O N RAIL SPRR 23M S/O C/L MT VERNON AVE & 105M ELY/O C/L ROSELAWN ST MKD (62D 1933)	G 1469
BASELINE (1995)	0152.468 0500.222	CSBM MON IN S END C B 2.4M S/O BCR @ SE COR LOS ALTOS DR & HACIENDA BLVD (SERV RD) 24.4M E & 16.2M S/O C/L INT MKD (BM 38-9A 1963 RE 5869)	G 1616
BASELINE (1995)	0124.246 0407.630	RDBM TAG IN N CB 300MM E BCR @ NE COR HACIENDA BLVD & HALLIBURTON RD 22M E & 12.2M N/O C/L INT	G 1623A
OTTERBEIN (1995)	0201.557 0661.275	RD MON IN WELL 200MM DN ON PI OF CURVE TO SW 3.7M W C/L PVMT FULLERTON RD 9M N/O PP #875077E 6M SLY/O GUY P #1684228E (390.M SLY/O HARBOR BL)	G 1639
OTTERBEIN (1995)	0228.305 0749.031	RDBM TAG IN N WINGWALL CONC HDWL 5M S C/L EAST RD 9M W/O & OPP DRWY TO HSE #1301 FULLERTON RD	G 1648
OTTERBEIN (1995)	0220.184 0722.387	L&T IN CONC DRWY TO HSE #1141 EAST RD 23M N/O C/L & 4.6M W/O C/L VALLE DR	G 1651
OTTERBEIN (1995)	0216.545 0710.448	RDBM TAG IN CTR OF CONC HDWL 4.6M N/O C/L EAST RD & 73M S/O C/L DEEP CYN RD E/O PP #1124854E	G 1654
OTTERBEIN (1995)	0185.378 0608.194	L&T IN NWLY CB EAST RD 4.6M NLY/O C/L & 78M SLY/O DRWY TO HSE #365 14M N/O PP #212079E	G 1660
OTTERBEIN (1995)	0185.098 0607.276	CSBM MON IN WELL ON C/L ENCANADA DR 14.6M W/O C/L HACIENDA BLVD MKD (BM 38-4 1964 RE 63)	G 1662
BASELINE (1995)	0185.147 0607.436	CS MON FL @ SW COR HACIENDA BLVD & ENCANADA DR 7M W & 6.1M S/O C/L INT MKD (COR 11 RE 329)	G 1663
BASELINE (1995)	0169.830 0557.184	L&T W END CONC STEP TO OFFICE @ SE COR EAST RD & HACIENDA BL 15.2M E & 12.2M S C/L INT MKD BM	G 1665
BASELINE (1995)	0156.903 0514.773	L&T IN CONC HDWL 600MM S/O N END 6.4M E/O C/L HACIENDA BLVD OPP HSE #1705 & 6.4M N/O C/L DRWY FOR HSES #1703 & #1705	G 1666
BASELINE (1995)	0105.426 0345.885	RDBM TAG IN N CB OLD VALLEY BLVD 6.1M N/O C/L @ PP# 215724E & 41.5M E/O C/L DRWY TO BLDG #16253 (128M E/O C/L VALLEY BLVD OVERPASS)	G 1739
BASELINE (1995)	0116.358 0381.751	RD MON IN WELL 200MM DN @ C/L INT VALLEY BLVD & AZUSA WAY MKD (LA CO 1959)	G 1745

JAD-YEAR	ELEV METER/FOOT	D E S C R I P T I O N (INCLUDE QUAD AND YEAR IN DESCRIPTION)	BM NUMBER
BASELINE (1995)	0119.634 0392.499	RD MON IN WELL 200MM DN ON C/L INT VALLEY BLVD & HAMBLEDON AVE MKD (1959)	G 1746
BASELINE (1995)	0119.859 0393.237	L&T IN N CB 1.5M E/O BCR @ NE COR VALLEY BLVD & HAMBLEDON AVE 15M E & 12.8M N/O C/L INT	G 1747
BASELINE (1995)	0126.416 0414.750	L&BN IN CONC BASE 3M W/O CF 1.5M S/O BCR @ SW COR VALLET BLVD & FULLERTON RD 24.7M S & 12.8M W/O C/L INT	G 1750
BASELINE (1995)	0128.745 0422.391	L&BR IN E CB 3.7M N/O BCR @ NE COR VALLEY BLVD & LA SEDA RD 27.4M N & 5.5M E/O C/L INT	G 1753
BASELINE (1995)	0132.677 0435.291	RDBM TAG IN N CB VALLEY BLVD W END C B 12.8M N C/L & 21M E/O C/L ELY MOST DRWY TO BLDG #18711	G 1755
OTTERBEIN (1995)	0266.575 0874.588	SPK&L IN E CONC HDWL 39M W/O C/L BREA CYN CUT-OFF RD & 29M N/O C/L CUT-OFF CT	G 1823
BASELINE (1995)	0235.724 0773.371	RD BR CAP IN HDWL 24M NLY C/L POMONA BLVD 2.4M S/O S RAIL SPRR 4M ELY/O C/L RIDGEWAY ST PROD 27.4M S/O C/L VERNON AVE	G 1962
BASELINE (1995)	0244.025 0800.605	CS MON IN WELL 300MM DN ON C/L 2ND ST IN MEDIAN 750MM W/O END & 95M E C/L HWY 71 MKD (BM 11-85)	G 2076
OTTERBEIN (1995)	0234.893 0770.645	RDBM TAG IN W CB DIAMOND BAR BLVD 600MM S/O BCR 12.2M W/O C/L & 21M S/O C/L GOLDEN SPRINGS DR	G 2127
OTTERBEIN (1995)	0233.224 0765.169	RDBM TAG IN W CB DIAMOND BAR BL 600MM N/O BCR 12.2M W/O C/L & 21M N/O C/L GOLDEN SPRINGS DR	G 2128
OTTERBEIN (1995)	0128.986 0423.182	CS TAG IN W CB 300MM N/O BCR @ NW COR STIMSON AVE & HALLIBURTON RD 26.5M N & 9.1M W/O C/L INT	G 2487
OTTERBEIN (1995)	0113.811 0373.395	RAM SET S CB 1M E/O BCR @ SE COR STIMSON AVE & SIGMAN ST 5.5M S & 21M E/O C/L INT	G 2488
OTTERBEIN (1995)	0113.644 0372.847	RAM SET IN N CB 1.2M E/O BCR @ NE COR STIMSON AVE & SIGMAN ST 5.5M N & 21M E/O C/L INT	G 2489
OTTERBEIN (1995)	0131.462 0431.305	RE TAG #10103 300MM N/O BCR @ SW COR WEDGEWORTH DR & FIELDGATE AVE 14M S & 5.5M W/O C/L INT	G 2490
OTTERBEIN (1995)	0130.691 0428.775	RE TAG #10103 E/O CB @ BCR & NE COR WEDGEWORTH DR & FIELDGATE AVE 14M N & 6.1M E/O C/L INT	G 2491
BASELINE (1995)	0110.734 0363.300	L&T IN W CB HACIENDA BLVD 12.8M W/O C/L @ C/L PROD SIGMAN ST	G 2577

JAD-YEAR	ELEV METER/FOOT	DESCRIPTION (INCLUDE QUAD AND YEAR IN DESCRIPTION)	BM NUMBER
BASELINE (1995)	0110.888 0363.805	RDBM TAG IN S CB 5.2M E/O BCR @ SE COR HACIENDA BLVD & SIGMAN ST 30M E & 5.5M S/O C/L INT	G 2578
BASELINE (1995)	0152.261 0499.543	L&T IN N CB 900MM E/O BCR @ NE COR HACIENDA BL & LOS ALTOS DR 24.4M E & 5.2M N/O C/L INT	G 2581
BASELINE (1995)	0159.150 0522.145	L&BN IN E CB 600MM N/O BCR @ NE COR HACIENDA BLVD & DEL PRADO DR 13.7M E & 9.1M N/O C/L INT	G 2583
BASELINE (1995)	0159.782 0524.218	L&BN IN E CB 600MM S/O BCR @ SE COR HACIENDA BLVD & DEL PRADO DR 13.7M E & 10.7M S/O C/L INT	G 2584
BASELINE (1995)	0184.462 0605.189	RD BM TAG IN NLY CB RICHVIEW DR 6M N/O C/L 9.8M ELY/O BCR & 22M ELY/O C/L HACIENDA BLVD	G 2585
BASELINE (1995)	0258.132 0846.888	L&T IN CONC WALL OF DRAIN 4.6M W/O C/L HACIENDA BLVD & 322M N/O C/L SKYLINE DR	G 2589
OTTERBEIN (1995)	0274.181 0899.542	CS BM MON IN WELL @ HACIENDA BLVD & SKYLINE DR 7.6M W & 4.3M N C/L INT MKD (BM 38-6 1954 RE 63)	G 2591
BASELINE (1995)	0240.258 0788.246	CS MON FL IN CONC BASE 136M NLY/O C/L CANADA SOMBRE RD & 9.1M W/O C/L HACIENDA BLVD 3M WLY OF EDGE PVMT (4M NLY/O PP WITH GUY POLE NO#)	G 2594
BASELINE (1995)	0228.484 0749.618	CS MON IN WELL 7.6M E/O C/L HACIENDA BL & 1.4M N/O C/L CANADA SOMBRA RD MKD (BM 38-5 1954)	G 2595
BASELINE (1995)	0131.579 0431.689	L&T IN S CB 300MM E/O BCR @ SE COR HACIENDA BLVD & JANINE DR 23M E & 4.6M S/O C/L INT	G 2600
BASELINE (1995)	0130.195 0427.148	CS MON IN WELL 450MM DN ON C/L HACIENDA BLVD 7.3M W/O ELY CF 26.5M S/O BCR @ SE COR & 41.8M S/O C/L JANINE DR MKD (LA CO + OR CO RE 2177)	G 2601
OTTERBEIN (1995)	0146.133 0479.438	RDBM TAG IN E CB 1M S/O BCR @ SE COR COLIMA RD & PASO REAL AVE 24.4M S & 5.5M E/O C/L INT	G 2611
OTTERBEIN (1995)	0146.127 0479.418	RDBM TAG IN W CB 1M S/O BCR @ SW COR COLIMA RD & PASO REAL AVE 24.4M S & 5.5M W/O C/L INT	G 2612
OTTERBEIN (1995)	0141.826 0465.307	CITY OF INDUSTRY BR DISC IN S CB 300MM W/O BCR @ SE COR COLIMA RD & JELICK AVE 16M E & 12.8M S/O C/L INT MKD (BENCH MARK 5-9)	G 2615
OTTERBEIN (1995)	0142.111 0466.243	CSBM MON IN WALK 3M E/O BCR 2.7M N/O CF @ NW COR COLIMA RD & BATSON AVE 17M N & 12.5M W/O C/L INT MKD (BM 44-11A 1963 RE 5869)	G 2618

JAD-YEAR	ELEV METER/FOOT	DESCRIPTION (INCLUDE QUAD AND YEAR IN DESCRIPTION)	BM NUMBER
OTTERBEIN (1995)	0129.026 0423.313	RDBM TAG IN W CB 300MM N/O BCR @ NW COR LAWSON ST & RAILROAD ST 14M N & 5.5M W/O C/L INT	G 2628
OTTERBEIN (1995)	0128.309 0420.960	CITY OF INDUSTRY BR MON IN W CB LAWSON ST 5.5M W C/L & 144M N/O C/L RAILROAD ST MKD (BM 5-13)	G 2629
BASELINE (1995)	0214.982 0705.320	RD MON IN WELL 325MM DN @ C/L INT POMONA BLVD & TEMPLE AVE MKD (LA CO RD DEPT 1962)	G 2677
BASELINE (1995)	0176.523 0579.143	RDBM TAG IN CONC FTG OF 125MM IP GUARD POST FOR 600MM WATER LINE 49M E/O C/L BREA CYN RD & 36M S/O C/L VALLEY BLVD	G 2684
BASELINE (1995)	0167.778 0550.452	FC BR DISC IN HDWL 2M S/O SLY SPRR TRACK 27M S/O C/L VALLEY BLVD & 156M E/O C/L PROD PIERRA RD MKD (BM 102-18 1956) 20.4M S/O S EDGE AC	G 2685
BASELINE (1995)	0157.813 0517.758	FC BR DISC IN E END HDWL 21.3M S/O C/L VALLEY BLVD & 61.3M W/O C/L PROD LEMON CREEK DR MKD (BM 102-14 1956)	G 2689
BASELINE (1995)	0156.182 0512.407	RDBM TAG IN NLY CB VALLEY BLVD 300MM E/O BCR 12.5M C/L & 23M ELY/O C/L CASTLEHILL RD	G 2691
BASELINE (1995)	0149.780 0491.403	CSBM MON IN W END C B 12.5M SLY C/L VALLEY BLVD & 82M ELY/O C/L FAIRWAY DR MKD (BM 11-100A 1962)	G 2692
BASELINE (1995)	0147.699 0484.576	RDBM TAG IN NW COR OF 900MMX900MM CONC PAD FOR VENT PIPE 17.7M SLY C/L VALLEY BLVD & 213M E/O C/L SENTOUS AVE	G 2694
BASELINE (1995)	0258.557 0848.282	L&BN IN E CB 300MM N/O BCR @ NE COR WHITE AVE & 2ND ST 18.6M N & 12.8M E/O C/L INT	G 2787
BASELINE (1995)	0274.508 0900.615	CS BR MON FL 300MM S CF & 2.4M W/O BCR @ SW COR 1ST ST & EAST END AVE 25.6M W & 6.4M S/O C/L INT MKD (BM 11-78A 1962 RE 5869)	G 2874
BASELINE (1995)	0270.341 0886.944	CS BR MON IN E CB N END C B @ NE COR RESERVOIR ST & 1ST ST 46M N & 9.1M E/O C/L INT MKD (BM 11-78A 1962 RE 5869)	G 2876
BASELINE (1995)	0267.487 0877.580	CS BM MON FL @ SW ABUT OF BRIDGE OVER TOWNE AVE 15.5M W/O C/L & 8.2M S/O C/L 1ST ST MKD (BM 11-79A 1962 RE 5869)	G 2878
BASELINE (1995)	0251.764 0825.996	CS MON IN WELL 200MM DN SW COR 2ND ST & OAK AVE 15.2M W & 9.4M S/O C/L INT MKD (BM 11-84A 1962)	G 2955

JAD-YEAR	ELEV METER/FOOT	D E S C R I P T I O N (INCLUDE QUAD AND YEAR IN DESCRIPTION)	BM NUMBER
BASELINE (1995)	0259.943 0852.830	CSBM MON IN HDWL 2.1M S/O S CF @ W END OF BRIDGE OVER WHITE AVE 25.6M W/O C/L & 8.2M S/O C/L 1ST ST MKD (BM 11-83A 1962 RE 5869)	G 2956
BASELINE (1995)	0102.176 0335.222	CS MON IN C B 400MM S/O S CF 7.3M E/O BCR @ SE COR HACIENDA BLVD & GALE AVE 32M E & 12.8M S/O C/L INT MKD (BM 38-13A 1963 RE 5869)	G 2986
BASELINE (1995)	0097.704 0320.551	RDBM TAG IN N CB VALLEY BL 14M N C/L 17.4M E/O BCR & 42M E/O C/L HACIENDA BL (NR E END C B)	G 2988
BASELINE (1995)	0102.725 0337.024	RDBM TAG IN W CB 300MM N/O BCR @ NW COR ALBERT ST & OLD VALLEY BLVD 14M N & 5.5M W/O C/L INT (NR S END C B)	G 2989
BASELINE (1995)	0108.587 0356.256	RDBM TAG IN N CB VALLEY BLVD NR W END C B 17.4M N/O C/L & 16.5M W/O APPROX C/L INT WITH OLD VALLEY BLVD (322M W/O C/L FERRERO LN)	G 2992
BASELINE (1995)	0115.419 0378.671	RDBM TAG IN N CB VALLEY BLVD @ E END OF 2 C B 12.8M N/O C/L & 157M W/O C/L LAURA AVE	G 2993
BASELINE (1995)	0123.413 0404.897	CSBM MON IN WELL 300MM E/O ELY CF 4M N/O BCR @ NE COR HACIENDA BLVD & HALLIBURTON RD 27.4M N & 13M E/O C/L INT MKD (BM 38-11A 1963 RE 5869)	G 3095
BASELINE (1995)	0133.651 0438.487	CSBM MON IN WELL 300MM W/O WLY CF @ BCR NW COR HACIENDA BLVD & TETLY ST 22.3M N & 12.8M W/O C/L INT MKD (BM 38-10A 1963 RE 5869)	G 3096
BASELINE (1995)	0169.540 0556.232	CSBM MON 300MM S/O SLY CF COLIMA RD 2M E/O BCR 12.8M S/O C/L & 18.3M E/O C/L HACIENDA BLVD MKD MKD (38-8A 1963 RE 5869) @ E END C B	G 3097
BASELINE (1995)	0150.398 0493.431	RDBM TAG IN S CB 300MM E BCR @ SE COR HACIENDA BLVD & AVOCADO CREST 14.3M E & 5M S/O C/L INT	G 3098
OTTERBEIN (1995)	0197.504 0647.978	RDBM TAG IN N CB COLIMA RD 12.8M N/O C/L & 147M E/O ALLENTON ST (NR CREST OF HILL)	G 3099
OTTERBEIN (1995)	0198.456 0651.101	RDBM TAG IN S CB COLIMA RD 12.8M S/O C/L & 163M E/O ALLENTON ST (NR CREST OF HILL)	G 3100
OTTERBEIN (1995)	0191.802 0629.270	RDBM TAG IN W CB 900MM N/O BCR @ NW COR COLIMA RD & PUNTA DEL ESTE DR 23M N & 6.1M W/O C/L INT	G 3101
OTTERBEIN (1995)	0191.861 0629.464	L&T IN N CB RET 3.7M W/O BCR @ NE COR COLIMA RD & PUNTA DEL ESTE DR 12.8M N & 11.6M E/O C/L INT	G 3102

JAD-YEAR	ELEV METER/FOOT	DESCRIPTION (INCLUDE QUAD AND YEAR IN DESCRIPTION)	BM NUMBER
OTTERBEIN (1995)	0156.053 0511.984	RDBM TAG IN N CB 2M W/O BCR @ NE COR COLIMA RD & OTTERBEIN AVE 12.8M N & 15M E/O C/L INT	G 3103
OTTERBEIN (1995)	0161.856 0531.023	RDBM TAG IN W CB 1M N/O BCR @ NW COR COLIMA RD & YBARRA DR 24.4M N & 5.5M W/O C/L INT	G 3104
OTTERBEIN (1995)	0162.024 0531.574	RDBM TAG IN E CB 300MM S/O BCR @ NE COR COLIMA RD & YBARRA DR 24.4M N & 5.5M E/O C/L INT	G 3105
OTTERBEIN (1995)	0181.102 0594.165	RDBM TAG IN W CB 300MM S/O BCR @ SW COR COLIMA RD & LAKE CYN RD 23.5M S & 9.1M W/O C/L INT	G 3106
OTTERBEIN (1995)	0181.061 0594.031	L&N IN S CB NR BCR @ SE COR COLIMA RD & LAKE CYN RD 30M E & 12.2M S/O C/L INT	G 3107
OTTERBEIN (1995)	0178.453 0585.475	RDBM TAG W CB 300MM N/O BCR @ NW COR CALBOURNE DR & GOLDEN SPRINGS RD 24M N & 5.5M W/O C/L INT	G 3108
OTTERBEIN (1995)	0178.399 0585.297	RDBM TAG E CB 300MM N/O BCR @ NE COR CALBOURNE DR & GOLDEN SPRINGS RD 24M N & 5.5M E/O C/L INT	G 3109
OTTERBEIN (1995)	0224.213 0735.605	L&T IN N CB FOUNTAIN SPRINGS RD 300MM W/O BCR 6.1M N/O C/L & 23M W/O C/L DIAMOND BAR BLVD	G 3121
OTTERBEIN (1995)	0188.502 0618.444	CE TAG IN E CB 5M S/O BCR @ SELY COR PATHFINDER RD & BLANDFORD DR 25M SLY & 6.1M ELY C/L INT	G 3138
OTTERBEIN (1995)	0187.826 0616.226	L&BN IN E CB ALEXDALE LANE OPP HSE #2277 5.5M W/O C/L & 54M N/O C/L PATHFINDER RD	G 3139
OTTERBEIN (1995)	0183.689 0602.653	RDBM TAG IN W CB ALEXDALE LN 27M S/O BCR 5.5M W/O C/L & 42M S/O C/L AGUIRO ST	G 3140
OTTERBEIN (1995)	0168.965 0554.346	RCE TAG #8244 IN S CB 300MM E/O BCR @ SE COR LYCOMING ST & PENARTH AVE 14M E & 6.1M S C/L INT	G 3142
OTTERBEIN (1995)	0168.612 0553.188	RCE TAG #8244 IN W CB 300MM S/O BCR @ SW COR LYCOMING ST & PENARTH AVE 15M S & 5.5M W C/L INT	G 3143
OTTERBEIN (1995)	0152.645 0500.803	RDBM TAG IN S CB NR BCR @ SE COR BREA CYN CUT OFF RD & WALNUT DR S 6.1M S & 18M E/O C/L INT	G 3145
OTTERBEIN (1995)	0167.182 0548.496	LS TAG #2760 IN W CB OTTERBEIN AVE 5.5M W/O C/L & 9M S/O C/L PROD VALENCIA AVE	G 3148
OTTERBEIN (1995)	0168.606 0553.168	CE TAG IN N CB VALENCIA AVE 6.1M N/O C/L ON C/L PROD ALEXDALE LN	G 3149
BASELINE (1995)	0239.517 0785.815	RDBM TAG IN SLY CB POMONA BLVD 6.4M E/O END CB 5M S/O C/L & 165M ELY/O C/L ROSELAWN ST	G 3668

JAD-YEAR	ELEV METER/FOOT	D E S C R I P T I O N (INCLUDE QUAD AND YEAR IN DESCRIPTION)	BM NUMBER
BASELINE (1995)	0169.541 0556.236	RDBM TAG IN N CB 11M E/O BCR @ NE COR HACIENDA BLVD & COLIMA RD 34.7M E & 12.2M N/O C/L INT	G 3712
BASELINE (1995)	0218.483 0716.806	L&BN IN CONC FTG 300MM N/O S END BRICK WALL @ NW COR PVT RD @ #2231 HACIENDA BLVD 10.7M W & 8M N/O C/L INT (142M S/O C/L CANADA SOMBRE RD)	G 3715
BASELINE (1995)	0185.151 0607.450	CS MON IN WELL 300MM DN @ C/L INT HACIENDA BLVD & ENCANADA DR MKD (RE 2177)	G 3718
BASELINE (1995)	0136.727 0448.578	RAMSET IN CB @ BCR 25.3M ELY & 15.2M NLY/O C/L INT ESEVERRI LN & HACIENDA BLVD (SERV RD)	G 3721
BASELINE (1995)	0121.961 0400.134	RDBM TAG IN N CB 1.5M W/O BCR @ NW COR VALLEY BLVD & GIANO AVE 14.6M W & 12.2M N/O C/L INT	G 3727
BASELINE (1995)	0155.527 0510.258	CITY INDUSTRY MON IN NLY CB VALLEY BLVD 600MM W/O BCR 12.8M N/O C/L & 22M WLY/O C/L CASTLEHILL DR MKD (V 40)	G 3732
BASELINE (1995)	0158.992 0521.626	RDBM TAG IN WLY CB LEMON AVE 1.5M S/O BCR 12.8M W/O C/L & 23.8M N/O C/L VALLEY BLVD	G 3733
BASELINE (1995)	0166.201 0545.278	RDBM TAG NR CTR OF NWLY CB RET 19.8M NLY C/L VALLEY BLVD & 13.4M WLY/O C/L PIERRE RD	G 3735
BASELINE (1995)	0172.726 0566.685	RDBM TAG IN NWLY COR CONC BASE RR SIGNAL 27M S C/L VALLEY BLVD & 7.6M E/O C/L PROD MORNINGSIDE DR (2.1M S/O S RAIL SPRR TRACKS)	G 3736
BASELINE (1995)	0217.027 0712.029	RDBM TAG IN WLY CB POMONA BLVD 9./M W/O C/L & 24M N/O C/L ENTERPRISE PL (@ S END DRWY)	G 3743
BASELINE (1995)	0230.297 0755.566	RDBM TAG IN SLY CB POMONA BLVD 9.8M S/O C/L & 53.3M WLY/O C/L PIONEER BLVD @ BLDG #2660	G 3747
BASELINE (1995)	0235.639 0773.092	RDBM TAG IN NW COR CONC GAS VAULT 18M N/O N RAIL SPRR TRACK 35M N/O N CB VALLEY BLVD 9M W/O C/L RIDGEWAY ST @ APPROX E C OF CURVE TO THE E	G 3749
BASELINE (1995)	0248.851 0816.439	RDBM TAG IN N CB 2ND ST 7M N/O C/L 2.1M W/O BOX CULV & 34M W/O SPRR TRACKS 402M W/O C/L OAK AVE	G 3752
BASELINE (1995)	0248.858 0816.462	RDBM TAG IN S CB 2ND ST 7M S/O C/L 1.8M W/O BOX CULV & 34M W/O RR TRACKS 402M W/O C/L OAK AVE	G 3753
BASELINE (1995)	0252.156 0827.282	RDBM TAG IN S CB 300MM E/O BCR @ SE COR OAK AVE & 2ND ST 16.8M E & 8.5M S/O C/L INT	G 3754

JAD-YEAR	ELEV METER/FOOT	D E S C R I P T I O N (INCLUDE QUAD AND YEAR IN DESCRIPTION)	BM NUMBER
BASELINE (1995)	0255.667 0838.801	RDBM TAG IN S CB 2.4M W/O BCR @ SW COR OAK AVE & HAMILTON BLVD 15.2M W & 7M S/O C/L INT	G 3755
BASELINE (1995)	0255.999 0839.890	RDBM TAG IN E CB 4.9M N/O BCR @ NE COR 2ND ST & HAMILTON BLVD 13.7M N & 10.7M E/O C/L INT	G 3756
BASELINE (1995)	0258.482 0848.036	RDBM TAG IN W CB 600MM S/O BCR @ SW COR 2ND ST & WHITE AVE 19.8M S & 9.8M W/O C/L INT	G 3757
BASELINE (1995)	0260.135 0853.460	RDBM TAG IN S CB @ SE COR OF BRIDGE OVER WHITE AVE 23.5M E/O C/L & 6.1M S/O C/L FIRST ST	G 3758
BASELINE (1995)	0267.345 0877.114	L&PK IN SE ABUT OF BRIDGE OVER TOWNE AVE 24.1M E/O C/L & 8.2M S/O C/L FIRST ST	G 3763
BASELINE (1995)	0268.150 0879.755	RDBM TAG IN N CB 1.8M W/O END 22M W & 6.1M N/O C/L INT FIRST ST & SAN ANTONIO AVE	G 3764
BASELINE (1995)	0269.918 0885.556	RDBM TAG IN N CB 750MM W/O END @ NW COR FIRST ST & RESERVOIR ST 28M W & 6.1M N/O C/L INT	G 3765
BASELINE (1995)	0269.700 0884.841	RDBM TAG IN S CB 600MM E/O BCR @ SE COR 1ST ST & RESERVOIR ST 18M E & 6.1M S/O C/L INT	G 3766
BASELINE (1995)	0271.500 0890.746	RDBM TAG IN S CB 1ST ST 6.1M S/O C/L @ E P/L WATER RESERVOIR 87M E/O C/L ELECTRA ST	G 3767
OTTERBEIN (1995)	0164.589 0539.989	RDBM TAG IN S CB 1.5M E/O BCR @ SE COR LYCOMING ST & GLENWICK AVE 15M E & 6.1M S/O C/L INT	G 3801
OTTERBEIN (1995)	0267.140 0876.442	RDBM MON IN WELL 200MM DN 26M N/O C/L EAST RD & 9M W/O C/L SKYLINE DR MKD (1969) 50MM IP 1M UP & 300MM W/O MON	G 3807
OTTERBEIN (1995)	0158.027 0518.460	CE TAG #10915 IN W CB 300MM N/O BCR 17M N & 9.8M W/O C/L INT FULLERTON RD & GALATINA ST	G 3810
OTTERBEIN (1995)	0144.856 0475.248	L&T IN N CB 1M W/O BCR @ NE COR COLIMA RD & FULLERTON RD 18M E & 12.8M N/O C/L INT MKD (BM)	G 3813
OTTERBEIN (1995)	0129.103 0423.565	RDBM TAG IN N CB 3M E/O BCR @ NE COR LAWSON ST & RAILROAD ST 24M E & 6.1M N/O C/L INT	G 3816
OTTERBEIN (1995)	0184.044 0603.818	RDBM TAG IN NE COR C B @ NW COR COLIMA RD & STIMSON AVE 21M W & 14M N/O C/L INT	G 3822
OTTERBEIN (1995)	0178.101 0584.320	RDBM TAG IN N CB COLIMA RD 12.8M N/O C/L & 122M W/O COUNTRY CYN RD 402M E/O PUNTA DEL ESTE DR	G 3824

JAD-YEAR	ELEV METER/FOOT	D E S C R I P T I O N (INCLUDE QUAD AND YEAR IN DESCRIPTION)	BM NUMBER
OTTERBEIN (1995)	0149.947 0491.951	RDBM TAG IN S CB 5.5M E/O BCR @ SE COR COLIMA RD & COUNTRYWOOD RD 20M E & 12.8M S/O C/L INT	G 3825
OTTERBEIN (1995)	0150.377 0493.362	RDBM TAG IN N CB 2.4M E/O BCR @ NE COR COLIMA RD & COUNTRYWOOD RD 23M E & 12.8M N/O C/L INT	G 3826
OTTERBEIN (1995)	0142.543 0467.660	RDBM TAG IN W CB 1.2M N/O BCR @ NW COR COLIMA RD & PARKLAWN RD 23M N & 6.1M W/O C/L INT	G 3827
OTTERBEIN (1995)	0179.740 0589.697	RDBM TAG IN E END C B 12.8M S/O C/L COLIMA RD & 145M W/O C/L COUNTRY CYN RD 402M E/O PUNTA DEL ESTE DR	G 3832
OTTERBEIN (1995)	0162.293 0532.456	RDBM TAG IN C B @ BCR 5.5M E/O C/L PASO VERDE DR & 15.5M S/O C/L CLEMINTINA DR	G 3833
OTTERBEIN (1995)	0161.126 0528.628	RDBM TAG IN N CB 1M E/O BCR @ NE COR PASO VERDE DR & CLEMINTINA DR 15M E & 5.5M N/O C/L INT	G 3834
OTTERBEIN (1995)	0124.698 0409.113	RE TAG #5406 IN CTR OF CONC WK @ MC 9.1M E/O C/L GLENELDER AVE & 9.4M N/O C/L WEDGEWORTH DR	G 3836
OTTERBEIN (1995)	0124.398 0408.129	RE TAG #5406 IN CTR CONC WALK @ MC HSE #16242 9.1M SLY & 9.1M WLY/O C/L INT WEDGEWORTH DR & FLAMSTEAD DR	G 3837
OTTERBEIN (1995)	0117.114 0384.232	RDBM TAG IN E CB 1.2M N/O BCR @ SE COR SIGMAN ST & EASTLEIGH AVE 12.2M S & 4.6M E/O C/L INT	G 3838
OTTERBEIN (1995)	0116.655 0382.726	RDBM TAG IN N CB SIGMAN ST E END C B 5.5M N/O C/L & 20M W/O C/L EASTLEIGH AVE	G 3839
OTTERBEIN (1995)	0133.789 0438.939	RDBM TAG W CB 7M S/O BCR 27M S & 15.8M W/O C/L INT AZUSA AVE & POMONA FRWY (E BOUND OFF-RAMP)	G 3843
OTTERBEIN (1995)	0220.703 0724.090	RDBM TAG IN W EDGE CONC DRWY TO FIRE STA 7.3M N/O C/L DEEP CYN RD & 44M W/O C/L EAST RD	G 3849
OTTERBEIN (1995)	0223.218 0732.341	RDBM TAG IN S CB OF EXIT DRWY TO HACIENDA GOLF CLUB 483M E/O WLY INT CHURCHILL RD 6M S/O C/L EAST RD (600MM S/O CB END @ ROCK PILLAR)	G 3850
OTTERBEIN (1995)	0143.838 0471.909	RCE TAG #10915 IN N CB 300MM E/O BCR @ NE COR COLIMA RD & DESIRE AVE 18M E & 12.8M N/O C/L INT	G 3855
OTTERBEIN (1995)	0148.903 0488.526	RDBM TAG IN E CB 12M N/O BCR @ NE COR COLIMA RD & NOGALES ST 34M N & 12.8M E/O C/L INT	G 3856
OTTERBEIN (1995)	0149.471 0490.389	RDBM TAG IN S CB 600MM W/O BCR @ SE COR COLIMA RD & NOGALES ST 24M E & 14M S/O C/L INT	G 3857

QUAD-YEAR	ELEV METER/FOOT	D E S C R I P T I O N (INCLUDE QUAD AND YEAR IN DESCRIPTION)	BM NUMBER
OTTERBEIN (1995)	0182.761 0599.608	L&T IN CB RET 4.6M N/O BCR @ SW COR COLIMA RD & WALNUT LEAF DR 20M S 7 6.7M W/O C/L INT	G 3862
OTTERBEIN (1995)	0182.405 0598.440	RDBM TAG IN S CB 2M E/O BCR @ SE COR COLIMA RD & WALNUT LEAF DR 19M E & 12.8M S/O C/L INT	G 3863
OTTERBEIN (1995)	0173.453 0569.070	LS TAG #3054 W CB 300MM N/O BCR @ NW COR ARKLEY DR & GOLDEN SPRING RD 24.4M N & 5.5M W/O C/L INT	G 3864
OTTERBEIN (1995)	0174.064 0571.075	LS TAG #3054 N CB 300MM W/O BCR @ NE COR ARKLEY DR & GOLDEN SPRING RD 16.5M E & 12.8M N C/L INT	G 3865
OTTERBEIN (1995)	0152.686 0500.937	RDBM TAG IN W CB 1M S/O BCR @ SW COR WALNUT DR & BREA CYN CUT OFF RD 15M S & 6.1M W/O C/L INT	G 3868
OTTERBEIN (1995)	0158.851 0521.164	LS TAG #3054 IN W CB 6.1M W/O C/L BREA CYN CUT OFF RD @ S P/L HSE #1337 39M N/O C/L SEARLS DR	G 3869
OTTERBEIN (1995)	0159.851 0524.444	L&BN IN CONC FTG OF 2M STEEL FENCE POST @ SW COR YBARRA SCHOOL YD 9M E C/L BREA CYN CUT-OFF RD & 14M S/O C/L SEARLS DR	G 3870
OTTERBEIN (1995)	0180.887 0593.460	CE TAG W CB 2.7M N/O BCR @ NW COR PATHFINDER RD & PASO REAL AVE 35M N & 6.1M W/O C/L INT	G 3877
OTTERBEIN (1995)	0160.384 0526.193	CS MON IN WELL 300MM DN @ C/L INT KILLIAN AVE & OTTERBEIN AVE	G 3891
OTTERBEIN (1995)	0225.159 0738.709	RDBM TAG IN N CB GOLDEN SPRINGS DR 300MM E/O BCR 9.8M N/O C/L & 24M E/O C/L GRAND AVE	G 3901
OTTERBEIN (1995)	0248.692 0815.917	RCE TAG #8793 IN W CB DIAMOND BAR BLVD 600MM N BCR 15.2M W/O C/L & 16M S/O C/L KIOWA CREST DR	G 3908
OTTERBEIN (1995)	0252.641 0828.873	LS TAG #2602 IN N CB ACACIA HILL DR 300MM W/O BCR 5.5M N/O C/L & 23M W/O C/L DIAMOND BAR BLVD	G 3909
OTTERBEIN (1995)	0248.789 0816.235	RDBM TAG IN W CB DIAMOND BAR BLVD @ FIRE HYD 14.6M W/O C/L & 280M S/O C/L GOLDEN SPRINGS DR	G 3915
OTTERBEIN (1995)	0212.505 0697.193	RDBM TAG IN S CB SUNSET CROSSING RD 10M E/O BCR 7.6M S/O C/L & 30M E/O C/L DIAMOND BAR BLVD	G 3918
OTTERBEIN (1995)	0234.721 0770.080	LS TAG #2825 N CB HIGHLAND VALLEY RD 300MM E/O BCR 6M N/O C/L & 25M E/O C/L DIAMOND BAR BLVD	G 3921
OTTERBEIN (1995)	0207.310 0680.150	RDBM TAG N CB 600MM W BCR @ NE COR OLD TRAIL RD & SUNSET CROSSING RD 17M E & 9.8M N/O C/L INT	G 3927

JAD-YEAR	ELEV METER/FOOT	D E S C R I P T I O N (INCLUDE QUAD AND YEAR IN DESCRIPTION)	BM NUMBER
OTTERBEIN (1995)	0206.419 0677.226	RDBM TAG S CB 1.2M W BCR OF ALLEY 9.8M S & 8.5M W/O C/L INT SUNSET CROSSING RD & OLD TRAIL RD	G 3928
OTTERBEIN (1995)	0198.959 0652.751	LS TAG #2825 N CB @ NW COR SUNSET CROSSING RD & BIG FALLS DR & 9.8M N & 8M W/O C/L INT	G 3929
OTTERBEIN (1995)	0198.183 0650.205	LS TAG #2825 IN S CB SUNSET CROSSING RD 1M E/O BCR 9.8M S & 47M W/O C/L BIG FALLS DR (@ ALLEY)	G 3930
OTTERBEIN (1995)	0133.847 0439.130	L&T IN CTR OF SE CB RET 18M E & 14M S/O C/L INT AZUSA AVE & POMONA FRWY (E BOUND OFF-RAMP)	G 4037
OTTERBEIN (1995)	0139.651 0458.172	RDBM TAG IN W CB 1.8M S/O BCR @ NW COR COLIMA RD & AZUSA AVE 27M N & 12.8M W/O C/L INT	G 4038
OTTERBEIN (1995)	0139.812 0458.700	RDBM TAG IN E CB 1.2M N/O BCR @ NE COR COLIMA RD & AZUSA AVE 33M N & 18.3M E/O C/L INT	G 4039
OTTERBEIN (1995)	0142.271 0466.767	RDBM TAG IN N CB RET COLIMA RD 2M W/O BCR 13M N C/L & 17M E/O C/L DRWY TO ROBINSONS ENT 402M E/O AZUSA AVE	G 4040
OTTERBEIN (1995)	0137.511 0451.151	CITY OF INDUSTRY MON IN SE COR C B 23M W/O BCR @ SW COR COLIMA RD & WALNUT HALL RD 38M W & 14M S/O C/L INT MKD (BM CO-4)	G 4044
OTTERBEIN (1995)	0149.139 0489.300	RDBM TAG IN S CB 600MM E/O BCR @ SE COR COLIMA RD & LARKVANE RD 14M E & 12.8M S/O C/L INT	G 4046
BASELINE (1995)	0131.678 0432.014	CITY INDUSTRY BM MON IN S END CONC HDWL 21.3M S/O C/L VALLEY BL & 5.8M W/O & OPP C/L ELY MOST DRWY TO BLDG #18711 E END	G 4093
BASELINE (1995)	0176.732 0579.828	FC DISC IN NLY WALL OF CHANNEL 1.5M E/O NE COR BRIDGE 33.5M S/O C/L VALLEY BLVD & 19M E/O C/L BREA CYN RD MKD (BM 103-00005)	G 4094
BASELINE (1995)	0198.266 0650.478	L&T IN SLY CB VALLEY BLVD 12.8M S/O C/L & 16.2M E/O C/L DRWY ENT TO BLDG #22064 (W END BLDG)	G 4096
BASELINE (1995)	0198.440 0651.049	L&T IN S CB C/L MEDIAN 2.1M S/O C/L VALLEY BLVD & 15.5M E/O C/L DRWY TO BLDG #22064 (W END BLDG)	G 4097
BASELINE (1995)	0199.573 0654.766	RDBM TAG IN ELY CB VALLEY BLVD N END C B 12.8M E/O C/L & 19M NLY/O N DRWY TO BLDG #4200	G 4098
BASELINE (1995)	0206.663 0678.027	L&T IN ELY CB VALLEY BLVD 12.8M E/O C/L & 6M S/O C/L BRIDGE OVER SAN JOSE CREEK (ON S ABUT)	G 4100

JAD-YEAR	ELEV METER/FOOT	D E S C R I P T I O N (INCLUDE QUAD AND YEAR IN DESCRIPTION)	BM NUMBER
BASELINE (1995)	0206.476 0677.413	L&T IN WLY CB VALLEY BLVD 12.8M W/O C/L & 6.2M S/O C/L BRIDGE OVER SAN JOSE CREEK (ON N ABUT)	G 4101
BASELINE (1995)	0209.167 0686.242	L&T IN WLY CB VALLEY BLVD 900MM S/O S END C B 12.8M W/O C/L & 7.6M N/O C/L DRWY TO BLDG #3745	G 4102
BASELINE (1995)	0209.442 0687.144	L&T IN ELY CB VALLEY BLVD 12.8M E/O C/L & 600MM W/O C/L PROD POMONA BLVD 1.8M N/O BCR ISLE	G 4103
BASELINE (1995)	0222.841 0731.104	RDBM TAG IN ELY CB POMONA BLVD 600MM N/O BCR 9.8M E/O C/L & 10M N/O C/L DRWY TO BLDG #2882 55M N/O C/L (57 FRWY)	G 4106
BASELINE (1995)	0184.686 0605.924	CSBM MON IN NLY END C B 12.5M WLY C/L HACIENDA BLVD & 12.2M SLY/O C/L PROD RICHVIEW DR MKD (BM 38-7A 1975 RE 7078)	G 4107
BASELINE (1995)	0248.779 0816.202	L&BN IN NE COR HDWL 6.1M W/O C/L HACIENDA BLVD & 351M N/O SKYLINE DR	G 4109
BASELINE (1995)	0150.857 0494.937	RDBM TAG IN S CB 10M E/O BCR @ SE COR HACIENDA BLVD & AVACADO CREST RD 23.8M E & 5.5M S/O C/L INT (@ W END C B)	G 4112
OTTERBEIN (1995)	0212.007 0695.560	RDBM TAG IN E CB 1.2M S/O BCR @ NE COR DIAMOND BAR BLVD & SUNSET CROSSING RD 16.5M N & 13.4M E/O C/L INT	G 4195
OTTERBEIN (1995)	0222.028 0728.437	RDBM TAG IN W CB DIAMOND BAR BLVD 9M S/O BCR 15.5M W/O C/L & 23M S/O C/L PALOMINO DR IN C B	G 4197
OTTERBEIN (1995)	0207.791 0681.728	RDBM TAG IN W CB BREA CYN RD 300MM S/O BCR 9.8M W/O C/L & 21M N/O C/L DIAMOND BAR BLVD	G 4198
OTTERBEIN (1995)	0207.849 0681.918	RDBM TAG IN S CB DIAMOND BAR BLVD 300MM W/O BCR 12.8M S/O C/L & 32M W/O C/L BREA CYN RD	G 4199
OTTERBEIN (1995)	0163.178 0535.360	RDBM TAG IN W CB 300MM N/O BCR @ NW COR MESCAL ST & FULLERTON RD 13M N & 9.8M W/O C/L INT	G 4203
OTTERBEIN (1995)	0265.136 0869.867	RDBM TAG IN E CB 300MM N/O BCR @ NE COR EAST RD & SKYLINE DR 12M NLY & 4M ELY/O C/L INT	G 4205
OTTERBEIN (1995)	0177.905 0583.677	CSBM MON IN CONC BASE OF VENT PIPE 2M N/O BCR @ NW COR BREA CYN RD & GOLDEN SPRINGS RD 31M N & 14M W/O C/L INT MKD (BM 44-4A 1971)	G 4206
OTTERBEIN (1995)	0175.130 0574.572	CSBM MON E WALL C B 12.8M N C/L GOLDEN SPRINGS RD & 39M E/O C/L LEMON AVE MKD (BM 44-5A 1975)	G 4222

JAD-YEAR	ELEV METER/FOOT	D E S C R I P T I O N (INCLUDE QUAD AND YEAR IN DESCRIPTION)	BM NUMBER
OTTERBEIN (1995)	0174.352 0572.020	RDBM TAG N CB 600MM E/O BCR @ NW COR LEMON AVE & GOLDEN SPRINGS RD 15M W & 12.8M N/O C/L INT	G 4223
OTTERBEIN (1995)	0148.170 0486.121	RDBM TAG IN W END C B 14.6M E/O BCR @ SE COR WALNUT DR N & FAIRWAY DR 38M E & 7.3M S C/L INT	G 4225
OTTERBEIN (1995)	0184.655 0605.822	RDBM TAG IN N CB BALAN RD 1.5M W/O BCR 6M N/O C/L & 15M W/O C/L PEPPERDALE DR	G 4235
OTTERBEIN (1995)	0185.728 0609.343	RDBM TAG IN N CB BALAN RD 1.5M W/O BCR 6M N/O C/L & 15.5M N/O C/L ARCDALE AVE	G 4236
OTTERBEIN (1995)	0252.089 0827.062	LS TAG #2602 IN W CB DIAMOND BAR BLVD 300MM S/O BCR 15.2M W/O C/L & 15M S/O C/L ACACIA HILL RD	G 4241
OTTERBEIN (1995)	0258.539 0848.223	RDBM TAG IN S END C B 15.5M W/O C/L DIAMOND BAR BL & 130M S/O C/L MOUNTAIN LAUREL @ HSE #1729	G 4242
OTTERBEIN (1995)	0268.212 0879.959	RDBM TAG IN E CB DIAMOND BAR BL 600MM S/O BCR 15.2M E/O C/L & 14M S/O C/L QUAIL SUMMIT DR	G 4243
OTTERBEIN (1995)	0279.156 0915.864	RCE TAG #14010 IN S CB 3.4M W BCR @ SW COR TIN DR & DIAMOND BAR BLVD 23M W & 8M S/O C/L INT	G 4244
OTTERBEIN (1995)	0279.284 0916.284	RCE TAG #14010 IN N CB 3.4M W BCR @ NW COR TIN DR & DIAMOND BAR BLVD 23M W & 8M N/O C/L INT	G 4245
BASELINE (1995)	0101.320 0332.414	RCE TAG #5828 IN E CB GLENDORA AVE 12.8M E C/L 900MM N/O BCR & 13.4M N/O C/L MAIN ST	G 4418
BASELINE (1995)	0100.972 0331.272	RDBM TAG IN W CB 300MM N BCR @ NW COR STAFFORD ST & GLENDORA AVE 25M N & 9.8M W/O C/L INT	G 4419
BASELINE (1995)	0098.688 0323.779	RDBM TAG IN E CB HACIENDA BL 14M E/O C/L 300MM S/O BCR & 30.5M S/O C/L STAFFORD ST	G 4431
BASELINE (1995)	0098.803 0324.156	RDBM TAG IN S CB STAFFORD ST 14M S/O C/L 300MM W/O BCR & 21.6M W/O C/L HACIENDA BLVD	G 4432
OTTERBEIN (1995)	0148.903 0488.526	L&T IN W CB 300MM N/O BCR @ NW COR COLIMA RD & LARKVANE RD 22M N & 6.1M W/O C/L INT	G 4520
OTTERBEIN (1995)	0174.331 0571.951	RDBM TAG W END C B 21M E/O BCR @ SE COR BREA CYN CUT-OFF RD & COLIMA RD 62M E & 12.8M S/O C/L INT	G 4521
BASELINE (1995)	0169.136 0554.907	L&T IN S END C B @ BCR OF NE COR 17.7M E/O C/L HACIENDA BLVD & 5.5M N/O C/L EAST RD	G 4523
OTTERBEIN (1995)	0184.724 0606.049	RDBM TAG IN S CB BALAN RD 300MM W/O BCR 6M S/O C/L & 14M W/O C/L PEPPERDALE DR	G 4524

