

**LOS ANGELES COUNTY
DEPARTMENT OF PUBLIC WORKS**

BENCH MARK LIST



RIVERA QUAD

1994 ADJUSTMENT

NGVD 29 DATUM

PREFACE

The Department of Public Works level net is composed of more than 1,700 miles of levels supporting in excess of 9,000 bench marks. Previously when a major readjustment of the net was undertaken, to emphasize the complete break with previous elevations, the CY, CG, & CL, series bench marks were re-labeled DY, DG, & DL, respectively.

Beginning in 1993 the baseline readjustment year will be indicated on baseline BM,s only indicated below (*). Henceforth all BM numbers will be labeled as a Y, G, or L, series that will no longer indicate the major adjustment year.

To facilitate the adjustment, indexing and distribution of adjusted values of the net, the county territory was divided into 33 quads or areas. For the identification purposes each quad was given a name, viz., "Rosemead," "La Mirada," "Santa Fe," etc. When bench marks and elevations in these quads are used, the name must be included in the bench mark description, e.g.,

* BASELINE 295.461 L&BR IN CTR OF CB RET @ NE COR Y 9191
(1990) LA HABRA BLVD & VALLEY HOME AVE
35FT N & 35FT E/O C/L INT

It is expected that this general adjustment will for the most part remain sound for 8 to 12 years. Updating constrained adjustments will continue in the future. When a quad is readjusted, new elevations will be published and the date of readjustment will be noted in the bench mark description. Two bench marks with different adjustment dates will not normally agree with each other.

The basic accuracy of the net is reflected by an indicated field probable error of plus or minus 0.012 foot per mile of leveling as determined from the conditions of closure. However, many years of experience in vertical control in the greater Los Angeles basin and Antelope Valley indicate that because of varying degrees of subsidence and heaving, the true datum is recovered only by obtaining substantial agreement of a number of bench marks.

The users of this net are invited to assist in its maintenance by notifying this department of cases of obliteration, apparent mistakes in description or elevations, and proven disturbance of bench marks.

=====
DATUM: U.S. Coast and Geodetic Survey Sea Level Datum
of 1929, through the medium of the Los Angeles
County Engineer Precise Level Net.

ABBREVIATIONS USED IN BENCH MARK LISTINGS

ABUT -----	Abutment	ECR -----	End of Curb Return
ALG -----	Along	EC -----	End of Curve
ANG PT -----	Angle Point	ENT -----	Entrance
B/W -----	Back of Walk	FL -----	Floor
BCR -----	Beginning of Curb Return	FTG -----	Footing
BC -----	Beginning of Curve	FRWY -----	Freeway
BLDG -----	Building	F/W -----	Front of Walk
BM -----	Bench Mark	GAR -----	Garage
BT SPK -----	Boat or Bolt Spike	HDWL -----	Headwall
BR CAP -----	Brass or Bronze Cap	HSE -----	House
C B -----	Catch Basin	HWY -----	Highway
CTR -----	Center	INT -----	Intersection
C/L -----	Center Line	IP -----	Iron Pipe
C/L INT -----	Center Line Intersection	LT -----	Left
C/L PROD -----	Center Line Produced	LACE -----	L.A. City Engineer
CONC -----	Concrete	LACS -----	L.A. Co. Engineer
COR -----	Corner	LAFC -----	L.A. Co. Flood Control
COE -----	Corps of Engineers	L&BN -----	Lead and Bench Nail
CULV -----	Culvert	L&BR -----	Lead and Brad
CYN -----	Canyon	L&N -----	Lead and Nail
CB -----	Curb	L&SPK -----	Lead and Spike
CS MON -----	Co. Eng. Monument	L&T -----	Lead and Tack
CT SPK -----	Cut Spike	MCR -----	Middle of Curb Return
DPW -----	Dept. of Public Works	MKD -----	Marked
DR -----	Drive or Driveway	MC -----	Middle of Curve
E/O -----	East of	MON -----	Monument

ABBREVIATIONS USED IN BENCH MARKS (CON'T)

N/O ----- North of
NR ----- Near
OPP ----- Opposite
PI ----- Point of Intersection
PK&W ----- PK Nail and Washer
P/L ----- Property Line
POST ----- Point of Semi-Tangent
PP ----- Power Pole
PVMT ----- Pavement
PROD ----- Produced
RD ----- Road
RDBM ----- Road Dept. Bench Mark
RDBM TAG ----- Road Dept. Bench Mark Tag
RR ----- Railroad
RT ----- Right
R/W ----- Right of Way
SDMH ----- Storm Drain Manhole
SMH ----- Sewer Manhole
SPK ----- Spike
ST&W ----- Spike Tin and Washer
S/O ----- South of
TP ----- Telephone Pole
USC&GS ----- U.S. Coast and Geodetic Survey
USGS ----- U.S. Geological Survey
WK ----- Walk
W/O ----- West of

CITY OF

CITY OF SAN GABRIEL

ALHAMBRA

ROSEMEAD QUAD

RIVERA

QUAD

WHITTIER

QUAD

QUAD

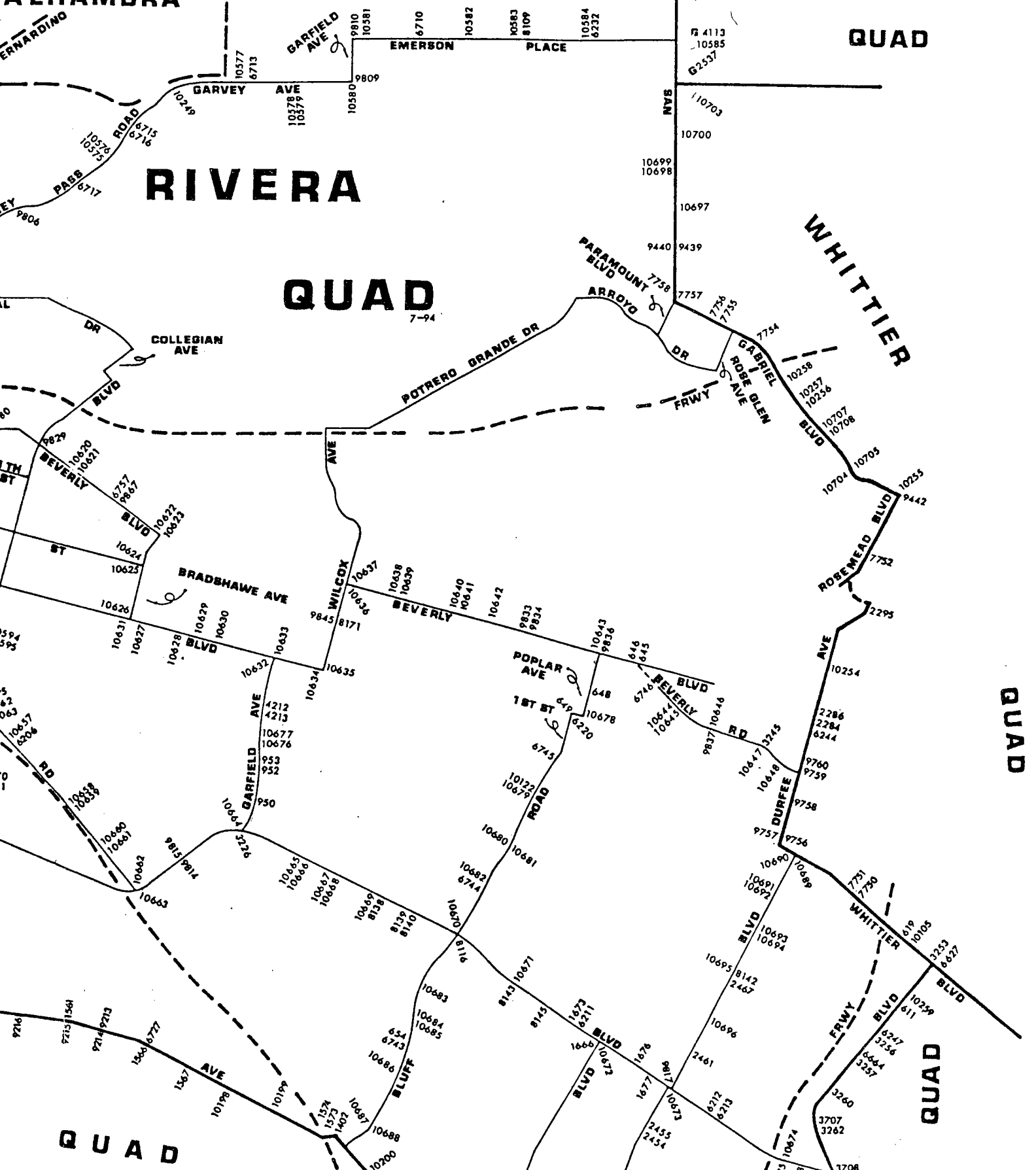

ERNARDING
ROAD
PABS
7806

COLLEGIAN AVE
BLVD

BEVERLY BLVD
ST

BRADBHAWE AVE
BLVD

POPLAR AVE
1ST ST

GARFIELD AVE
BLVD

BLUFF BLVD
AVE

QUAD

10577
6713
10578
10379

10580
10581
6710
10582

10620
10621
10622
10623
10624
10625
10626

10631
10632
10633
10634
10635

10643
10644
10645
10646
10647
10648
10649
10650

10651
10652
10653
10654
10655
10656
10657
10658

10659
10660
10661
10662
10663
10664
10665
10666

10667
10668
10669
10670
10671
10672
10673
10674

10675
10676
10677
10678
10679
10680
10681
10682

9810
10381
6710
10382

9809
10380
10381
10382

10438
10439
10440
10441
10442

10443
10444
10445
10446
10447
10448
10449
10450

10451
10452
10453
10454
10455
10456
10457
10458

10459
10460
10461
10462
10463
10464
10465
10466

10467
10468
10469
10470
10471
10472
10473
10474

10475
10476
10477
10478
10479
10480
10481
10482

10483
10484
10485
10486
10487
10488
10489
10490

9810
10381
6710
10382

9809
10380
10381
10382

9833
9834
10643
10644
10645
10646
10647
10648
10649
10650

9837
10643
10644
10645
10646
10647
10648
10649
10650

9837
10643
10644
10645
10646
10647
10648
10649
10650

9837
10643
10644
10645
10646
10647
10648
10649
10650

9837
10643
10644
10645
10646
10647
10648
10649
10650

9837
10643
10644
10645
10646
10647
10648
10649
10650

9837
10643
10644
10645
10646
10647
10648
10649
10650

10702
10701
4113
10585
62537

10703
10700
10699
10698
10697
9440
9439

7758
7757
7756
7755
7754

10258
10257
10256
10707
10708

10704
10705
10752
2295

10254
2286
2284
6244
9760
9759

9758
9756
10690
10689
10691
10692

10693
10694
10695
8142
2467
10696
2461

2453
2454
1677
9817
10673
1678

10702
10701
4113
10585
62537

10703
10700
10699
10698
10697
9440
9439

7758
7757
7756
7755
7754

10258
10257
10256
10707
10708

10704
10705
10752
2295

10254
2286
2284
6244
9760
9759

9758
9756
10690
10689
10691
10692

10693
10694
10695
8142
2467
10696
2461

2453
2454
1677
9817
10673
1678

10702
10701
4113
10585
62537

10703
10700
10699
10698
10697
9440
9439

7758
7757
7756
7755
7754

10258
10257
10256
10707
10708

10704
10705
10752
2295

10254
2286
2284
6244
9760
9759

9758
9756
10690
10689
10691
10692

10693
10694
10695
8142
2467
10696
2461

2453
2454
1677
9817
10673
1678

10702
10701
4113
10585
62537

10703
10700
10699
10698
10697
9440
9439

7758
7757
7756
7755
7754

10258
10257
10256
10707
10708

10704
10705
10752
2295

10254
2286
2284
6244
9760
9759

9758
9756
10690
10689
10691
10692

10693
10694
10695
8142
2467
10696
2461

2453
2454
1677
9817
10673
1678

10702
10701
4113
10585
62537

10703
10700
10699
10698
10697
9440
9439

7758
7757
7756
7755
7754

10258
10257
10256
10707
10708

10704
10705
10752
2295

10254
2286
2284
6244
9760
9759

9758
9756
10690
10689
10691
10692

10693
10694
10695
8142
2467
10696
2461

2453
2454
1677
9817
10673
1678

10702
10701
4113
10585
62537

10703
10700
10699
10698
10697
9440
9439

7758
7757
7756
7755
7754

10258
10257
10256
10707
10708

10704
10705
10752
2295

10254
2286
2284
6244
9760
9759

9758
9756
10690
10689
10691
10692

10693
10694
10695
8142
2467
10696
2461

2453
2454
1677
9817
10673
1678

CITY
ANGELES
ALHAMBRA
BERNARDINO

LOS

R

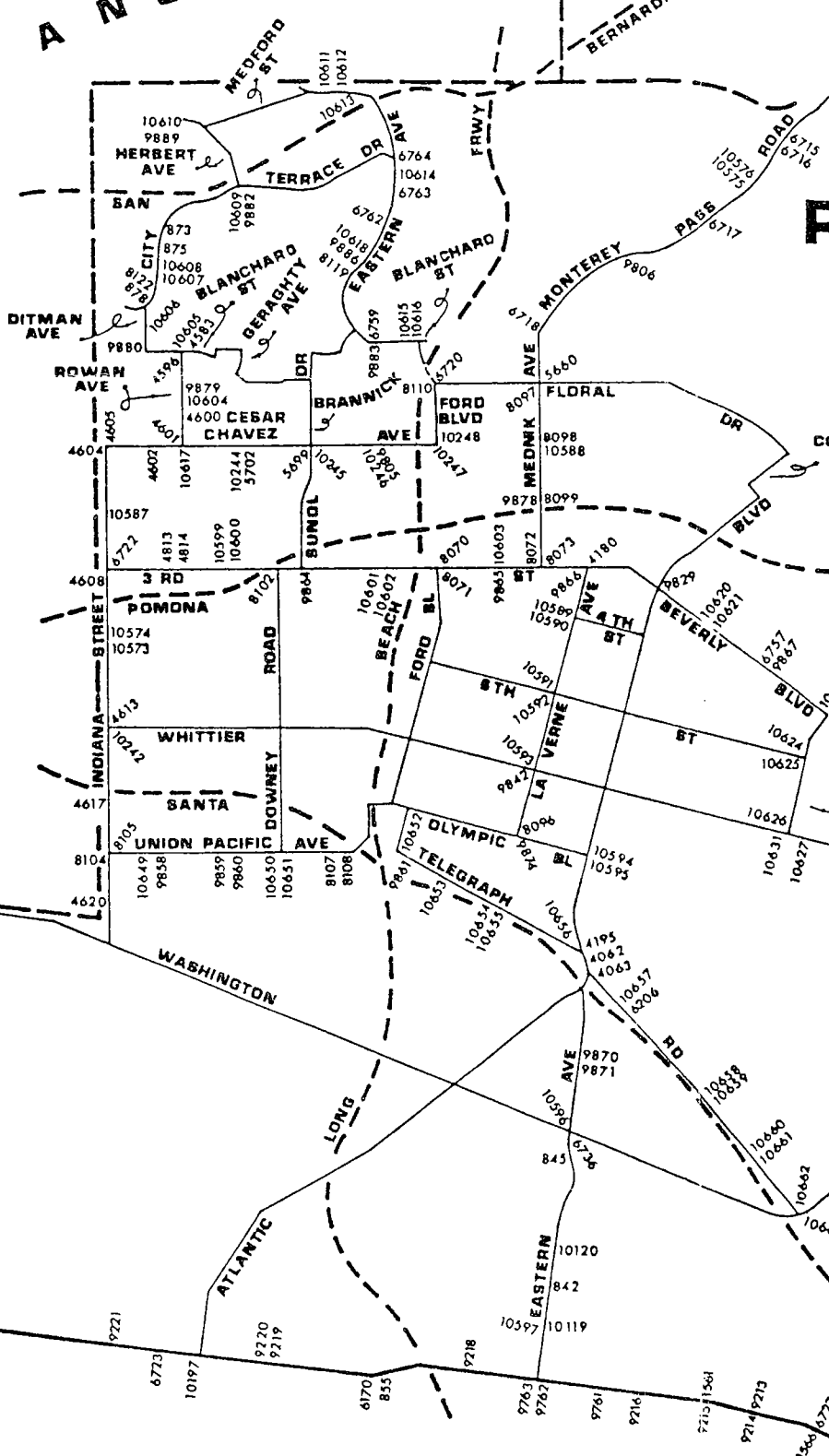

F

TS
JAD

SOUTH

GATE

QUA

ALL BM NUMBERS SHOWN WITHOUT

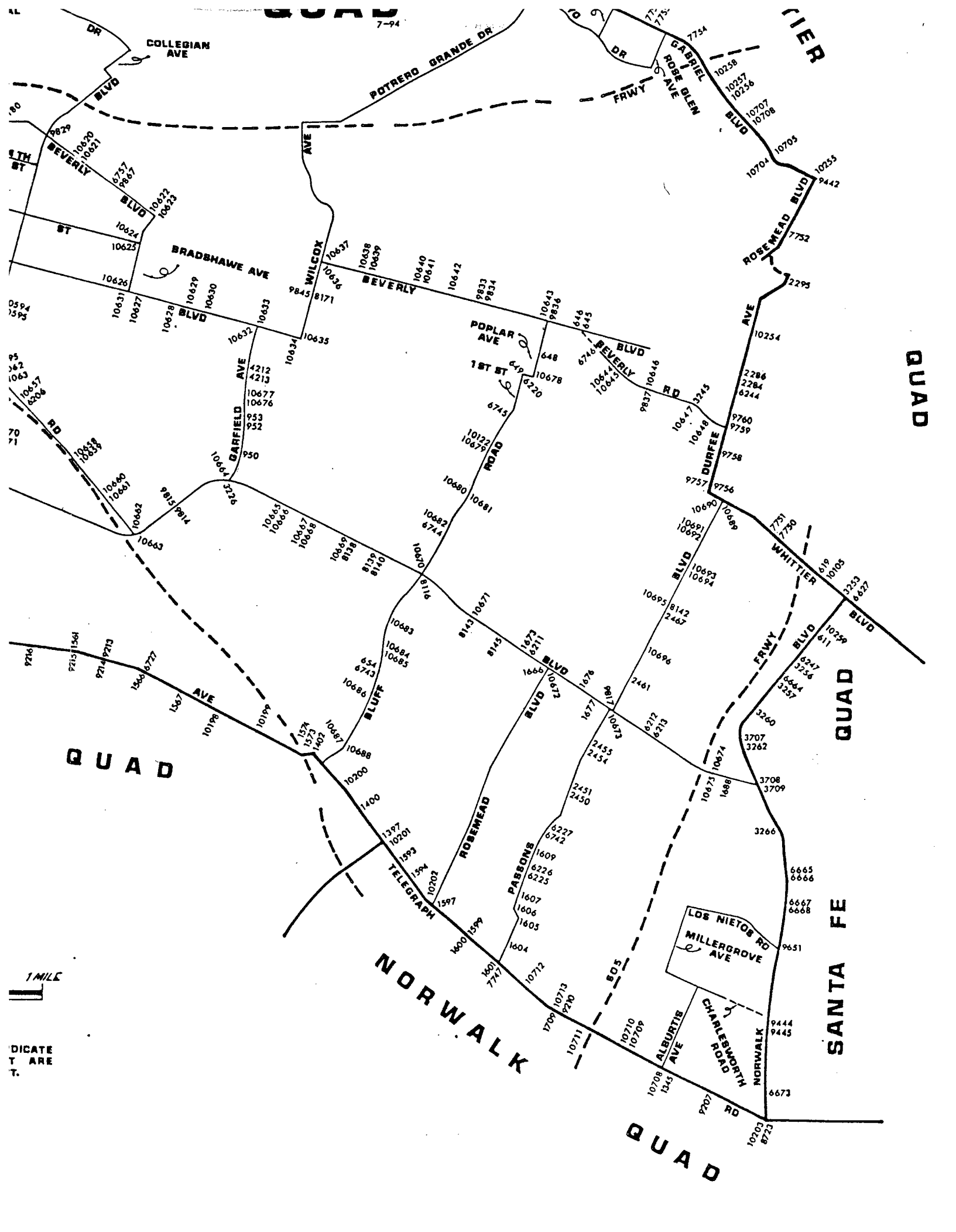

7-94

COLLEGIAN AVE

POTRERO GRANDE DR

GABRIEL ROSE AVE
FRWY

ROSEMEAD BLVD
10258
10255
10256
10707
10708
10704
10705
10253
9442

4TH ST
BEVERLY BLVD
10624
10625
10626
10631
10637
10628
10632
10633
10634
10635

BRADBHAWE AVE

WILCOX AVE
10637
10636
10635
9845
8171
10634
10633

POPLAR AVE

1ST ST

BEVERLY BLVD
648
644
645
6746
10644
10645
9837
10646

RD

2286
2284
6244
9760
9759
9758
9757
9756

RD
10657
10658
10659
10660
10661
10662
10663
10664
10665
10666
10667
10668
10669
10670

GARFIELD AVE
4212
4213
10677
10676
953
952
950
10661
10662
9236
7181
9815
9816

ROAD

10122
10679
6743
10680
10681
10682
6744
10683
10684
10685
10686
654
6743
10686
10688
1400

BLUFF BLVD
10683
10684
10685
10686
654
6743
10686
10688
1400

DURFEE BLVD
10690
10689
10691
10692
10693
10694
10695
8142
2467
10696
2461
2455
2454
2451
2450

FRWY

WHITTIER BLVD
7719
7720
619
10105
3253
6627
10279
611
6247
3256
6664
3257
3260
3707
3762
3708
3709
3266

AVE
9216
9215
1561
9214
9213
1566
1577
1567
10198
10199
1574
1573
1402
10497
10688
10200
1597
1597
10201
1599
1599
10202
10202
1597
1600
1599
1601
7147

ROSEMEAD BLVD
1666
10672
1677
1678
1677
10672
2455
2454
2451
2450

PABSONS BLVD
6227
6742
1609
6226
6225
1607
1606
1605
1604
10712
1709
10713
9290
10711

TELEGRAPH

ROSEMEAD BLVD
1666
10672
1677
1678
1677
10672
2455
2454
2451
2450

FRWY

BLVD
10690
10689
10691
10692
10693
10694
10695
8142
2467
10696
2461
2455
2454
2451
2450

FRWY

BLVD
7719
7720
619
10105
3253
6627
10279
611
6247
3256
6664
3257
3260
3707
3762
3708
3709
3266

QUAD

QUAD

NORWALK

QUAD

SANTA FE



INDICATE
T
ARE
T.

LOS NIETOS RD
MILLERGROVE AVE

CHARLESWORTH
NORWALK

ALBURTIS AVE
10708
1345
10710
10709

RD
9207
9444
9445
6673

O F

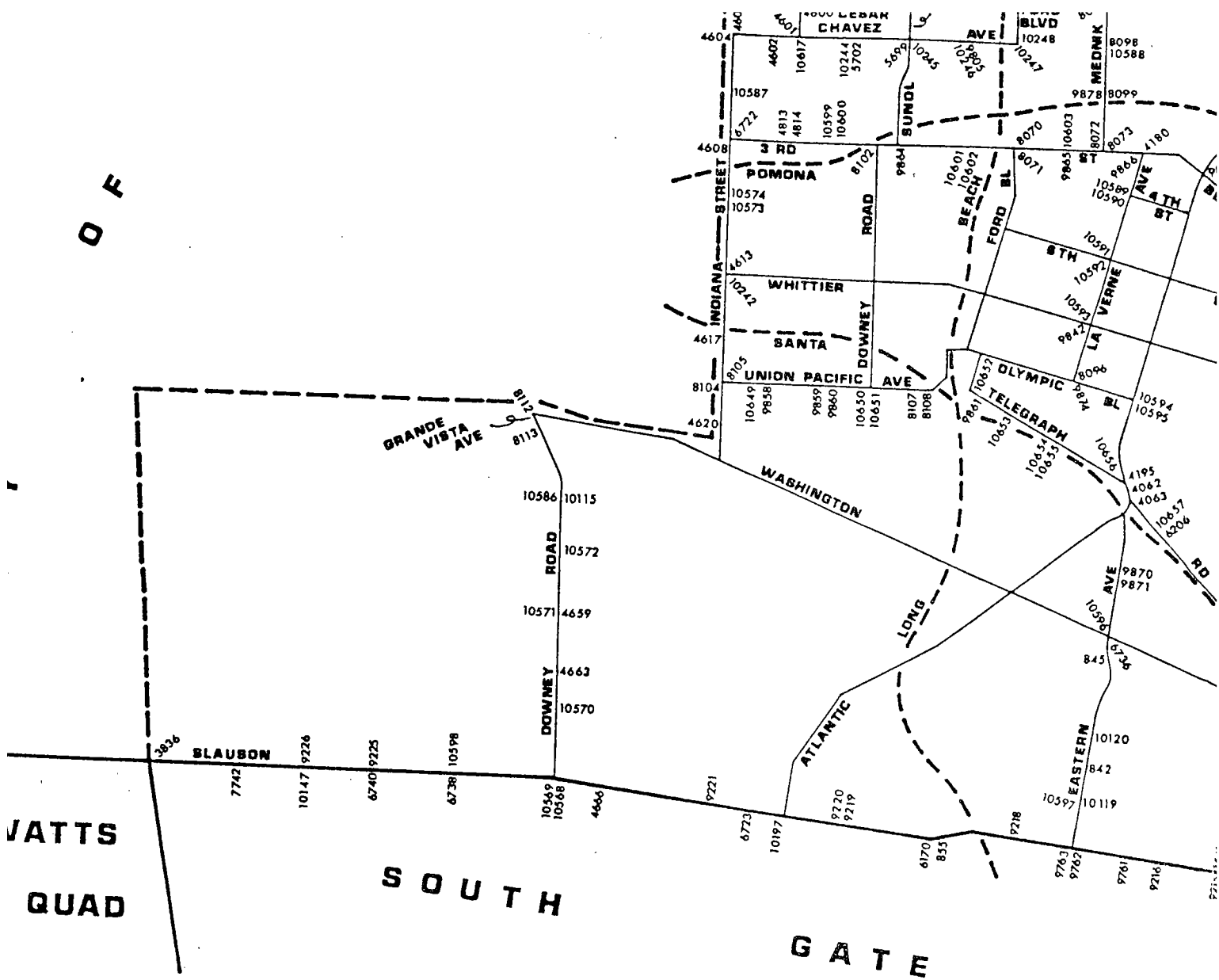

VATTS QUAD

SOUTH GATE

ALL BM NUMBERS SHOWN WITHOUT A LETTER PREFIX ARE Y BM'S

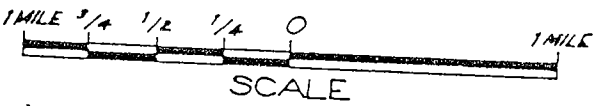
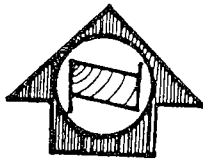

LIGHT SOLID LINES WITHOUT NUMBERS INDICATE PREVIOUS LINES OF BENCH MARKS THAT ARE NOT INCLUDED IN THE 1980 ADJUSTMENT.

QUAD-YEAR	ELEV	DESCRIPTION (INCLUDE QUAD AND YEAR IN DESCRIPTION)	BM NUMBER
BASELINE (1990)	0169.272	L&SPK IN CTR OF WK 3FT E/O FLAGPOLE @ WEST WHITTIER SCHOOL 51FT W C/L NORWALK BLVD & 250FT N/O C/L BEXLEY DR (TO THE W)	Y 611
BASELINE (1990)	0174.938	L&BR IN S CB WHITTIER BLVD 8FT N/O BCR 28FT S/O C/L ON C/L PROD REDMAN AVE (TO THE N)	Y 619
RIVERA (1994)	0205.033	L&BN IN E CB 1FT N/O BCR @ NE COR BEVERLY BLVD & N RD LEADING TO (GRANT REA MEMORIAL PARK) 75FT N & 20FT E/O C/L INT	Y 645A
RIVERA (1994)	0205.130	CS MON IN CB ON NOSE OF ISLAND N RD LEADING TO (GRANT REA MEMORIAL PARK) 49FT N/O N CB BEVERLY BLVD & 85FT W/O W EDGE BRIDGE #B976 MKD (BM 51-10A 1961)	Y 646A
RIVERA (1994)	0209.655	L&BR IN CB @ NW COR POPLAR AVE & MADISON AVE 34FT W & 20FT N/O C/L INT	Y 648
RIVERA (1994)	0208.362	L&BN IN CB 1FT W BCR @ NW COR WHITTIER BLVD & 1ST ST 37FT W & 28FT N/O C/L INT	Y 649
RIVERA (1994)	0172.617	L&BN IN W CB 1FT N/O C B 250FT N & 20FT W/O C/L INT BLUFF RD & SYCAMORE ST (NR HSE #1425)	Y 654
RIVERA (1994)	0137.622	L&BN IN E CB NR S END CB 15FT N/O JCT RR 38FT E C/L EASTERN AVE & 385FT S/O C/L BANDINI BLVD	Y 842
RIVERA (1994)	0138.410	L&T IN E CB 4FT S/O BCR @ SE COR EASTERN AVE & SHELIA ST 58FT S & 39FT E/O C/L INT	Y 845
BASELINE (1990)	0157.675	L&N IN W END OF N HDWL OF BRIDGE OVER LA RIVER 29FT N/O C/L SLAUSON AVE MKD (U S E D BM #2305)	Y 855
RIVERA (1994)	0399.767	RD MON IN WELL @ C/L INT CITY TERRACE DR & ROWAN AVE	Y 873A
RIVERA (1994)	0415.214	RD MON IN WELL @ C/L INT CITY TERRACE DR & RAMBOZ DR	Y 875A
RIVERA (1994)	0419.086	RD MON IN WELL P.O.S.T. DITMAN AVE & CITY TERRACE DR MKD (1950)	Y 878A
RIVERA (1994)	0171.817	L&BN IN E CB GARFIELD AVE 2FT N/O MC & 896FT S/O FLOTILLA ST @ BLDG #2100	Y 950A
RIVERA (1994)	0173.476	RD BM TAG IN CB 6FT E/O BCR @ SE COR GARFIELD AVE & FLOTILLA ST 81FT E & 30FT S/O C/L INT	Y 952A

QUAD-YEAR	ELEV	DESCRIPTION (INCLUDE QUAD AND YEAR IN DESCRIPTION)	BM NUMBER
RIVERA (1994)	0173.468	RD BM TAG 2FT N/O ANG PT @ BCR NW COR GARFIELD AVE & FLOTILLA ST 75FT N & 40FT W/O C/L INT	Y 953A
BASELINE (1990)	0131.013	RD BM TAG IN S CB 2FT W/O W END MAIN DRWY TO FIRE STA #4 @ 11736 TELEGRAPH RD 40FT S/O C/L & 390FT W/O C/L PIONEER BLVD	Y 1345A
BASELINE (1990)	0141.886	CS MON IN WELL 8IN DN ON C/L TELEGRAPH RD 20FT WLY OF PARAMOUNT BL MKD (BELL K4 1941 RE 2177)	Y 1397A
BASELINE (1990)	0143.611	RAM SET IN N CB 58FT E/O MOST ELY DRWY OF BLDG #8001 TELEGRAPH RD & 38FT N/O C/L (16FT E/O PP #14630Y)	Y 1400A
BASELINE (1990)	0151.584	L&T IN N CB TELEGRAPH RD 4FT E/O BCR @ NE COR SLAUSON AVE 40FT N & 105FT E/O C/L INT	Y 1402A
BASELINE (1990)	0139.872	L&T IN N CB SLAUSON AVE 13FT W/O W END C B @ WLY END OF CURVE 42FT N/O C/L & 300FT E/O C/L BOXFORD AVE	Y 1561
BASELINE (1990)	0148.334	L&T IN N CB 2FT E/O BCR @ NE COR SLAUSON AVE & GARFIELD AVE 65FT E & 38FT N/O C/L INT	Y 1566
BASELINE (1990)	0152.439	L&BN IN S CB SLAUSON AVE 38FT S/O C/L & 124FT W/O W END BLDG #7030 (3FT N/O PP #666256E)	Y 1567A
BASELINE (1990)	0152.028	L&T IN S CB TELEGRAPH RD 5FT E/O BCR @ SE COR COR SLAUSON AVE 40FT S & 48FT E/O C/L INT	Y 1573A
BASELINE (1990)	0156.901	RD MON IN WELL @ C/L INT SLAUSON AV & GAGE AVE MKD (LACO RD DEPT 1959)	Y 1574
BASELINE (1990)	0142.489	L&BN IN CB 4FT S/O BCR @ SW COR TELEGRAPH RD & BIRCHBARK AVE 80FT S & 18FT W/O C/L INT	Y 1593
BASELINE (1990)	0144.834	L&BN IN CB 4FT S/O BCR @ SW COR TELEGRAPH RD & STAMPS RD 78FT S & 18FT W/O C/L INT	Y 1594
BASELINE (1990)	0137.654	CS MON IN WELL @ C/L INT TELEGRAPH RD & LAKEWOOD BL MKD (TRAV STA BELL K-5A RE 2177 1941)	Y 1597A
BASELINE (1990)	0138.219	L&T IN S END OF W GAS ISL @ NE COR TELEGRAPH RD & SERAPIS AVE 67FT N & 61FT E/O C/L INT	Y 1599
BASELINE (1990)	0136.991	L&T IN S CB 6FT W/O BCR @ SE COR TELEGRAPH RD & SERAPIS AVE 50FT E & 40FT S/O C/L INT	Y 1600A
BASELINE (1990)	0140.980	L&BN @ BCR OF SERVICE RD N CB 36FT W/O C/L PASSONS BLVD & 50FT S/O C/L TELEGRAPH RD	Y 1601

QUAD-YEAR	ELEV	DESCRIPTION (INCLUDE QUAD AND YEAR IN DESCRIPTION)	BM NUMBER
RIVERA (1994)	0141.657	L&BN IN CB 1FT N/O BCR @ NE COR CLAYMORE ST & PASSONS BLVD 52FT N & 20FT E/O C/L INT	Y 1604
RIVERA (1994)	0145.895	L&BN IN CB 2FT N/O BCR @ NE COR SUNGLOW ST & BUHMAN AVE (TO THE N) 51FT N & 18FT E/O C/L INT	Y 1605
RIVERA (1994)	0146.451	L&BN IN CB 1FT N/O BCR @ ANG PT PASSONS BLVD & CHARLESWORTH DR 200FT S & 20FT E/O C/L INT @ HSE #8430	Y 1606
RIVERA (1994)	0148.048	L&BN IN CB 1FT N/O BCR @ NE COR PASSONS BLVD & LA DOCENA LN 45FT N & 45FT E/O C/L INT	Y 1607
RIVERA (1994)	0147.364	L&BN IN CB 1FT W/O BCR @ NW COR PASSONS BLVD & MYRON ST 45FT W & 18FT N/O C/L INT	Y 1609
RIVERA (1994)	0160.886	RD BM TAG IN N CB 50FT W/O BCR @ NW COR ROSE-MEAD BLVD & WASHINGTON BLVD 120FT W & 38FT N/O C/L INT	Y 1666A
RIVERA (1994)	0161.299	L&T IN W CB 2FT N/O BCR @ NW COR WASHINGTON BL & CROSSWAY DR 73FT N & 16FT W/O C/L INT	Y 1673A
RIVERA (1994)	0160.613	L&BN IN N CB 1FT E/O BCR @ NE COR WASHINGTON BLVD & LINDSEY AVE 56FT E & 38FT N/O C/L INT	Y 1676
RIVERA (1994)	0160.031	L&T IN CTR ISLAND CB RET @ SW COR KILGARRY AVE & WASHINGTON BLVD 45FT S & 28FT W/O C/L INT	Y 1677
RIVERA (1994)	0157.017	L&BN IN CB 1FT E/O BCR @ NE COR WASHINGTON BLVD & MORRILL AVE 35FT N & 51FT E/O C/L INT	Y 1688
BASELINE (1990)	0137.094	CS BR CAP MON @ PI 6.82FT E/O C/L INT TRUE AVE & TELEGRAPH RD	Y 1709
BASELINE (1990)	0186.431	L&BN IN E CB 15FT N/O BCR @ NE COR BEVERLY BL & DURFEE AVE 100FT N & 20FT E/O C/L INT	Y 2284
BASELINE (1990)	0190.806	SPK N END 1ST STEP TO HSE #4252 64FT E/O & 40FT N/O C/L INT DURFEE AVE & DORK ST	Y 2286
BASELINE (1990)	0194.733	L&T IN SW COR CONC LEG OF WATER & POWER TOWER #253D4 93FT N & 73FT E/O C/L INT DURFEE AVE & KRUSE RD	Y 2295
RIVERA (1994)	0153.579	L&BN IN W CB PASSONS BLVD 2FT N/O N EDGE DRWY TO HSE #7525 20FT W/O C/L PASSONS BLVD & 103FT S/O C/L PROD BASCOM ST	Y 2450

QUAD-YEAR	ELEV	DESCRIPTION (INCLUDE QUAD AND YEAR IN DESCRIPTION)	BM NUMBER
RIVERA (1994)	0153.942	L&T IN W CB PASSONS BLVD 1FT N/O N EDGE DRWY TO HSE #7503 20FT W/O C/L & 115FT N/O C/L PROD BASCOM ST	Y 2451
RIVERA (1994)	0156.185	L&T IN E CB 4FT S/O BCR @ SE COR PASSONS BLVD FOXBURY WAY 47FT S & 20FT E/O C/L INT	Y 2454
RIVERA (1994)	0157.014	L&T IN E CB PASSONS BLVD 1FT N/O N EDGE DRWY TO HSE #7202 30FT S/O C/L PROD DANBRIDGE ST	Y 2455
RIVERA (1994)	0163.257	L&T IN E CB 0.5FT N/O BCR @ NE COR PASSONS BLVD & CARRON DR 41FT N & 20FT E/O C/L INT	Y 2461
RIVERA (1994)	0167.162	L&T IN W CB 1FT N/O BCR @ SW COR PASSONS BLVD & COSGROVE ST 43FT S & 21FT W/O C/L INT	Y 2467
BASELINE (1990)	0275.823	FC BR CAP IN W WINGWALL 73FT N C/L GARVEY AVE & 225FT W C/L SAN GABRIEL BLVD MKD (BM 55-24)	G 2537
RIVERA (1994)	0167.447	L&BN @ MCR OF PARKING AREA 70FT S & 150FT W/O C/L INT WASHINGTON BLVD & GARFIELD AVE	Y 3226
RIVERA (1994)	0182.319	L&T IN E CB 6FT N/O BCR @ NE COR BEVERLY RD & ROSEMEAD BLVD 73FT N & 44FT E/O C/L INT	Y 3245
BASELINE (1990)	0175.592	CS BR CAP MON 3FT SW OF C/L INT NORWALK BLVD & WHITTIER BLVD (TO THE N) MKD (WHITTIER E-2 RE 329 1948)	Y 3253
BASELINE (1990)	0166.352	L&BR IN W CB 2FT S/O BCR @ NW COR ROSEHEDGE DR & NORWALK BL 54FT N & 33FT W/O C/L INT	Y 3256
BASELINE (1990)	0164.456	L&SPK IN E CB 5FT S/O BCR @ SE COR NORWALK BL & MINES BL 77FT S & 38FT E/O C/L INT	Y 3257
BASELINE (1990)	0161.798	L&BN IN E CB 1FT S/O BCR @ SE COR NORWALK BL & FLORY ST 54FT S & 38FT E/O C/L INT	Y 3260
BASELINE (1990)	0160.596	RE TAG #2059 @ BK OF WK 56FT S/O BCR @ SE COR NORWALK BL & CHOISSER ST 112FT S & 50FT E/O C/L INT	Y 3262
BASELINE (1990)	0153.705	L&BN IN CB 1FT N/O BCR @ NW COR NORWALK BL & WADDELL ST 60FT N & 38FT W/O C/L INT	Y 3266
BASELINE (1990)	0160.549	RAM SET NR CTR CB RET @ SE COR NORWALK BL & CHOISSER ST 45FT E & 29FT S/O C/L INT	Y 3707
BASELINE (1990)	0157.495	RAMSET IN W CB 3FT N/O BCR @ NW COR WASHINGTON BLVD & NORWALK BLVD 135FT N & 38FT W/O C/L INT	Y 3708

QUAD-YEAR	ELEV	DESCRIPTION (INCLUDE QUAD AND YEAR IN DESCRIPTION)	BM NUMBER
BASELINE (1990)	0157.891	CE BR CAP FL IN CB OF ISL @ NW COR WASHINGTON BLVD & NORWALK BLVD 81FT N & 32FT W/O C/L INT MKD (BM 2-14A 1961 RE 5869)	Y 3709
BASELINE (1990)	0178.957	CS MON IN C/L SLAUSON AVE 14FT W/O W RAIL SPRR & 20FT E/O C/L ALAMEDA ST MKD (WATTS H-2A 1938 RE 4233)	Y 3836
RIVERA (1994)	0149.299	L&BN IN N CB TELEGRAPH RD 30FT N & 125 FT E/O C/L INT TELEGRAPH RD & ATLANTIC BLVD	Y 4062
RIVERA (1994)	0149.447	L&BN IN S CB TELEGRAPH RD 30FT S & 175FT E/O C/L INT TELEGRAPH RD & ATLANTIC BLVD	Y 4063
BASELINE (1990)	0279.777	CS BM MON IN WELL 1FT N/O CB @ BCR NW COR SAN GABRIEL BLVD & EMERSON PL 59FT W & 19FT N/O C/L MKD (BM 1-25C 1970 RE 5869)	G 4113
RIVERA (1994)	0262.518	L&BN IN N CB 3RD ST 40FT N/O C/L & 11FT W/O C/L PROD LA VERNE AVE	Y 4180
RIVERA (1994)	0154.372	MOST WLY CUT SPK NR CTR CB RET @ NW COR ATLANTIC BLVD & TELEGRAPH RD 54FT N & 69FT W/O C/L INT	Y 4195
RIVERA (1994)	0193.830	L&BN IN N CB 35FT E/O BCR @ NE COR OLYMPIC BLVD & GARFIELD AVE 115FT E & 36FT N/O C/L INT	Y 4212
RIVERA (1994)	0190.906	L&T IN CB 5FT W/O BCR @ NW COR GARFIELD AVE & FAIRFIELD ST 80FT W & 20FT N/O C/L INT	Y 4213
RIVERA (1994)	0418.008	L&T IN CONC RET WALL 30FT E & 27FT S/O C/L INT BLANCHARD ST & ROWAN AVE MKD (BM)	Y 4583
RIVERA (1994)	0414.322	L&BR IN CONC WK @ NW COR ROWAN AVE & WINTER ST 30FT N & 30FT W/O C/L INT (@ HSE #3547)	Y 4596
RIVERA (1994)	0308.080	L&T IN W CB 20FT W/O C/L ROWAN AVE @ C/L PROD DOZER ST	Y 4600
RIVERA (1994)	0300.144	L&BN IN W CB 1FT S/O BCR @ SW COR ROWAN AVE & CESAR E CHAVEZ AVE 40FT S & 20FT W/O C/L INT	Y 4601
RIVERA (1994)	0297.922	L&BN IN E CB 7FT N/O BCR @ NE COR DITMAN AVE & CESAR E CHAVEZ AVE 53FT N & 20FT E/O C/L INT MKD (BM)	Y 4602
RIVERA (1994)	0290.033	CUT SPK IN E CB INDIANA ST N END C B 20FT S/O C/L PROD BROOKLYN PL	Y 4604

QUAD-YEAR	ELEV	DESCRIPTION (INCLUDE QUAD AND YEAR IN DESCRIPTION)	BM NUMBER
RIVERA (1994)	0289.501	LACE HEX BAR MON @ C/L INT BROOKLYN PL & INDIANA ST	Y 4605
RIVERA (1994)	0316.825	CUT SPK IN S CB 5FT W/O BCR @ SW COR INDIANA ST & 3RD ST 53FT W & 37FT S/O C/L INT	Y 4608
RIVERA (1994)	0222.663	CUT SPK IN N CB 7FT W/O BCR W END C B @ NW COR INDIANA ST & WHITTIER BLVD 123FT W & 30FT N/O C/L INT	Y 4613
RIVERA (1994)	0187.362	WIRE SPK IN N CB 5FT W/O BCR @ NW COR INDIANA ST & OLYMPIC BLVD 45FT W & 37FT N/O C/L INT (E END C B)	Y 4617
RIVERA (1994)	0179.432	CS BR CAP MON IN WELL 17FT E & 11FT N/O APPROX C/L INDIANA ST & NOAKES ST MKD (ALHAMBRA B-11 RE 2177)	Y 4620
RIVERA (1994)	0182.143	L&SQ BOLT IN N CB @ NW COR DOWNEY RD & LEONIS BLVD 76FT W & 28FT N/O C/L INT	Y 4659
RIVERA (1994)	0179.872	SQ HD SPK IN NW COR CONC SLAB @ SE COR DOWNEY RD & FRUITLAND AVE & 35FT S & 35FT E/O C/L INT	Y 4663
BASELINE (1990)	0162.162	CS MON IN WELL 8IN DN 2FT S & 4FT W/O C/L INT SLAUSON AVE & EVERETT AVE MKD (WATTS TRAV STA L-2B RE 4233 1938)	Y 4666
RIVERA (1994)	0311.961	L&T IN W CB 8FT S/O BCR @ SW COR 3RD ST & ROWAN AVE 75FT S & 20FT W/O C/L INT	Y 4813
RIVERA (1994)	0312.031	L&T IN E CB 11FT S/O BCR @ SE COR ROWAN AVE & 3RD ST 75FT S & 20FT E/O C/L INT	Y 4814
RIVERA (1994)	0309.719	L&BN IN E CB 34FT N/O BCR @ NE COR FLORAL DR & MENDIK AVE 87FT N & 35FT E/O C/L INT	Y 5660
RIVERA (1994)	0270.164	SQ HD SPK IN N CB @ NW COR CESAR E CHAVEZ AVE & CARMELITA AVE 191FT W & 30FT N/O C/L INT	Y 5699
RIVERA (1994)	0312.256	L&T IN N CB 2FT E/O BCR @ NE COR RECORD AVE & CESAR E CHAVEZ AVE 38FT E & 28FT N/O C/L INT	Y 5702
BASELINE (1990)	0139.471	CS BR CAP MON IN WELL 12IN DN @ NE COR SLAUSON AVE & ALAMO AVE 57FT N & 41FT E/O C/L INT MKD (BM 4-21 1951 RE 329)	Y 6170
RIVERA (1994)	0146.977	L&T SLY CB TELEGRAPH RD 40FT SLY C/L & 15FT ELY C/L PROD HOEFNER AVE (NR WLY END C B)	Y 6206

QUAD-YEAR	ELEV	DESCRIPTION (INCLUDE QUAD AND YEAR IN DESCRIPTION)	BM NUMBER
RIVERA (1994)	0161.383	L&T IN CB 1FT W/O BCR @ NE COR WASHINGTON BLVD & CROSSWAY DR 54FT E & 38FT N/O C/L INT	Y 6211
RIVERA (1994)	0155.683	L&T IN N CB (SERV RD) 25FT W/O BCR @ NW COR WASHINGTON BLVD & PICO VISTA RD 78FT N & 50FT W/O C/L INT	Y 6212
RIVERA (1994)	0156.655	L&T IN N CB @ NE COR WASHINGTON BLVD & PICO VISTA RD 55FT E & 38FT N/O C/L INT	Y 6213
RIVERA (1994)	0204.746	RD BM TAG IN N CB 1FT E/O BCR @ NE COR WHITTIER BLVD & 1ST ST 45FT E & 28FT N/O C/L INT	Y 6220
RIVERA (1994)	0148.567	L&BN IN W CB 7FT S/O ANG PT OF CB 43FT S/O C/L PROD SHADE LN (TO THE E) & 30FT W/O C/L INT PASSONS BLVD	Y 6225
RIVERA (1994)	0148.245	L&BN IN N CB 1FT E/O BCR @ NE COR PASSONS BLVD & SHADE LN 46FT E & 18FT N/O C/L INT MKD (BM)	Y 6226
RIVERA (1994)	0150.520	L&T IN N CB 1FT W/O BCR @ NE COR PASSONS BLVD & SLAUSON AVE 62FT E & 40FT N/O C/L INT	Y 6227
RIVERA (1994)	0302.056	CS BR CAP MON IN WELL @ C/L INT EMERSON PL & WILSON WAY MKD (RE)	Y 6232
BASELINE (1990)	0185.340	RD MON IN WELL @ C/L INT DURFEE AVE & BEVERLY BLVD & BEVERLY BLVD	Y 6244
BASELINE (1990)	0166.395	CO ENGR BR CAP IN NLY END C B 79FT N & 37FT W/O C/L INT ROSEHEDGE DR & NORWALK BL MKD (BM 2-16 1961 RE 5869)	Y 6247
BASELINE (1990)	0177.259	RD BM TAG IN W CB 37FT N/O BCR @ NW COR NORWALK BL & WHITTIER BL 105FT N & 29FT W/O C/L INT	Y 6627
BASELINE (1990)	0164.618	SPK IN S CB 7FT E/O BCR @ SE COR NORWALK BL & MINES BL 84FT E & 38FT S/O C/L INT	Y 6664
BASELINE (1990)	0151.778	BT SPK IN W CB 8FT N/O BCR @ NW COR NORWALK BL & SLAUSON AVE 86FT N & 40FT W/O C/L INT	Y 6665
BASELINE (1990)	0151.685	RD BM TAG IN E CB 2FT N/O BCR @ SE COR NORWALK BL & SLAUSON AVE 82FT S & 40FT E/O C/L INT	Y 6666
BASELINE (1990)	0152.938	L&T IN E CB NORWALK BL 40FT E/O C/L ON C/L PROD BURKE ST	Y 6667
BASELINE (1990)	0153.035	RD BM TAG IN E CB 2FT S/O BCR @ SE COR NORWALK BL & BURKE ST 40FT E & 35FT S/O C/L INT	Y 6668

QUAD-YEAR	ELEV	DESCRIPTION (INCLUDE QUAD AND YEAR IN DESCRIPTION)	BM NUMBER
BASELINE (1990)	0147.005	L&T IN CONC CB OF PLANTER 50FT E/O C/L NORWALK BL & 151FT N/O C/L DRWY ENT TO BLDG #10132 (0.2MI N/O TELEGRAPH RD)	Y 6673
RIVERA (1994)	0380.984	CSBM MON IN WELL @ SE COR EMERSON AVE & ALHAMBRA AVE 31FT S & 29FT E/O C/L INT MKD (BM 31-19 RE 63 1953) 4FT E/O E CB	Y 6710
RIVERA (1994)	0379.675	CSBM MON IN WELL @ SE COR GARVEY AVE & ATLANTIC BLVD 177FT E & 40FT S/O C/L INT 1FT S/O S CB MKD (BM 31-17 1953 RE 63)	Y 6713
RIVERA (1994)	0414.916	L&BN IN SLY END OF CONC PLANTER WLY TRAFFIC ISL 36FT W/O C/L MONTEREY PASS RD @ FREMONT AVE OPP FROM N SIDE PROD BLDG #508	Y 6715
RIVERA (1994)	0412.336	L&BR IN W CB MONTEREY PASS RD 35FT W/O C/L 80FT S/O BCR @ FREMONT AVE NR S SIDE PROD BLDG #509	Y 6716
RIVERA (1994)	0398.945	CS BM MON FL IN C B 1FT E/O E CB 35FT E/O C/L MONTEREY PASS RD 0.5MI S/O FREMONT AVE NR N SIDE PROD BLDG #736 MKD (BM 31-15A 1961 RE 5869)	Y 6717
RIVERA (1994)	0334.360	L&BR IN E CB MONTEREY PASS RD 35FT E & 33FT S/O B C 125FT N/O PI MONTEREY PASS RD & KERN AVE C/L @ BLDG #1350 (20FT NLY OF SLY P/L)	Y 6718
RIVERA (1994)	0312.352	CS BM MON IN WELL @ NW COR FORD BLVD & FLORAL DR 71FT N & 19FT W/O C/L INT MKD (31-12A 1961 RE 5869)	Y 6720
RIVERA (1994)	0316.803	L&T IN N CB 9FT E/O BCR @ NE COR INDIANA ST & 3RD ST 40FT N & 59FT E/O C/L INT	Y 6722
BASELINE (1990)	0150.751	CS MON IN WELL 10IN DN @ SLAUSON AV & FLORA AV 11FT E & 3FT N/O C/L INT MKD (BELL 2-A 1938 RE 4233)	Y 6723
BASELINE (1990)	0148.091	L&BN IN CB 1FT N/O BCR @ NW COR SLAUSON AVE & GARFIELD AVE 66FT N & 38FT W/O C/L INT	Y 6727
RIVERA (1994)	0139.165	L&T IN CB RET 20FT W/O BCR @ SE COR EASTERN AVE WASHINGTON BLVD 80FT E & 39FT S/O C/L INT	Y 6736
BASELINE (1990)	0165.222	CS MON IN WELL 15IN DN ON C/L STATE ST (BOYLE AVE TO THE N) 16FT S/O C/L SLAUSON AVE MKD (WATTS TRAV STA K-2A 1938 RE 4233)	Y 6738

QUAD-YEAR	ELEV	DESCRIPTION (INCLUDE QUAD AND YEAR IN DESCRIPTION)	BM NUMBER
BASELINE (1990)	0173.279	CS MON IN WELL 10IN DN ON C/L MILES AV (SOTO ST TO THE N) 14FT S/O C/L SLAUSON AV MKD (WATTS TRAV STA J-2E 1938 RE 4233)	Y 6740
RIVERA (1994)	0150.564	L&BN IN CB 2FT S/O BCR @ SW COR PASSONS BLVD & SLAUSON AVE 50FT S & 32FT W/O C/L INT MKD (BM)	Y 6742
RIVERA (1994)	0173.222	RD BM TAG IN W CB 1FT N/O BCR @ NW COR BLUFF RD & SYCAMORE AVE 62FT N & 20FT W/O C/L INT	Y 6743
RIVERA (1994)	0199.644	RAMSET IN CB 1FT S/O BCR OF S DRWY TO HSE #833 BLUFF RD & 0.1MI S/O BEACH ST	Y 6744
RIVERA (1994)	0211.316	L&BN IN CB 1FT S/O BCR @ SW COR LOS ANGELES AVE & BLUFF RD 53FT S & 20FT W/O C/L INT MKD (BM)	Y 6745
RIVERA (1994)	0175.984	L&BN IN S CB 1FT E/O BC OF CUL DE SAC 77FT E & 40FT S/O C/L INT BEVERLY RD & CULP DR	Y 6746
RIVERA (1994)	0245.782	L&BN IN CB 32FT S/O BCR @ SW COR BEVERLY BLVD & GERHART AVE 107FT S & 32FT W/O C/L INT	Y 6757
RIVERA (1994)	0326.641	CS BR CAP MON 10IN DN 60FT N & 35FT E/O C/L INT EASTERN AVE & E BLANCHARD ST (20FT N/O BCR) MKD (BM 61-2 RE 5869 1961)	Y 6759
RIVERA (1994)	0485.781	BT SPK IN E CB 1FT S/O BCR @ SE COR EASTERN AVE & E HAUCK ST 32FT E & 5FT S/O C/L INT	Y 6762
RIVERA (1994)	0502.402	BT SPK IN E CB @ NE COR EASTERN AVE & ROSILYN DR 32FT N & 32FT E/O C/L INT	Y 6763
RIVERA (1994)	0455.550	BT SPK IN E CB 17FT N/O BCR @ NE COR EASTERN AVE & E CITY TERRACE DR 70FT NLY & 32FT ELY OF C/L INT (3FT S/O NLY P/L TO HSE #1454)	Y 6764
BASELINE (1990)	0178.148	RD BM TAG IN CB 38FT S/O BCR @ SW COR SLAUSON AVE & SANTA FE AVE 104FT S & 36FT W/O C/L INT	Y 7742
BASELINE (1990)	0140.474	LACS MON IN SE COR C B 122FT N & 21FT W C/L INT TELEGRAPH RD & PASSONS BLVD MKD (BM 4-15A 1968)	Y 7747
BASELINE (1990)	0181.094	FC MON FL @ NE COR BRIDGE OVER SAN GABRIEL RIV 50FT N/O C/L WHITTIER BLVD MKD (BM 078-00010 1968)	Y 7750
BASELINE (1990)	0182.165	FC MON FL @ SW COR BRIDGE OVER SAN GABRIEL RIV 46FT S/O C/L WHITTIER BLVD MKD (BM 077-02855 1968)	Y 7751

QUAD-YEAR	ELEV	DESCRIPTION (INCLUDE QUAD AND YEAR IN DESCRIPTION)	BM NUMBER
BASELINE (1990)	0215.736	CO ENG BR CAP FL @ SE COR BRIDGE OVER WHITTIER NARROWS RIV 42FT E/O C/L ROSEMEAD BLVD & 0.4MI S/O SAN GABRIEL BL MKD (BM 1-20B 1965 RE 5869)	Y 7752
BASELINE (1990)	0308.235	RD BM TAG IN CB 1FT E/O BCR @ NW COR SAN GABRIEL BL & WALNUT GROVE AVE 78FT W & 42FT N/O C/L INT	Y 7754
BASELINE (1990)	0315.596	RD BM TAG IN CB 2FT ELY OF BCR 42FT NLY & 20FT ELY OF C/L INT SAN GABRIEL BLVD & DELTA ST	Y 7755
BASELINE (1990)	0317.744	RD BM TAG IN CB 2FT WLY OF BCR @ NWLY COR DELTA ST & SAN GABRIEL BLVD 42FT N & 87FT WLY C/L INT	Y 7756
BASELINE (1990)	0333.458	RD BM TAG IN CB 1FT W/O BCR @ SW COR HILL DR & SAN GABRIEL BLVD 64FT W & 42FT S/O C/L INT	Y 7757
BASELINE (1990)	0332.481	RD BM TAG IN CB 1FT W/O BCR @ NW COR HILL DR & SAN GABRIEL BLVD 115FT W & 42FT N/O C/L INT	Y 7758
RIVERA (1994)	0294.573	RD BM TAG IN CB 25FT W/O BCR @ SW COR 3RD ST & FORD BLVD 100FT W & 40FT S/O C/L INT	Y 8070
RIVERA (1994)	0295.196	RD BM TAG IN N CB 18FT W/O BCR @ NW COR 3RD ST & FORD BLVD 100FT W & 41FT N/O C/L INT	Y 8071
RIVERA (1994)	0279.964	CS MON IN N CB FL 1.5FT BK OF CF @ NE COR 3RD ST & KERN AVE 41FT N & 40FT E/O C/L INT MKD (BM 51-1 1957 RE 5869)	Y 8072
RIVERA (1994)	0281.881	L&T IN CB 14FT E/O BCR @ SE COR MEDNIK AVE & THIRD ST 70FT E & 40FT S/O C/L INT	Y 8073
RIVERA (1994)	0176.609	L&BN IN CONC APRON @ NE COR LA VERNE AVE & OLYMPIC BLVD 61FT N & 30FT E/O C/L INT	Y 8096
RIVERA (1994)	0308.221	L&T IN W CB 0.4FT S/O BCR @ SW COR FLORAL DR & MEDNIK AVE 65FT S & 40FT W/O C/L INT	Y 8097
RIVERA (1994)	0299.811	RD BM TAG IN CB 1FT N/O BCR @ NE COR MEDNIK AVE & CESAR E CHAVEZ AVE 55FT N & 32FT E/O C/L INT	Y 8098
RIVERA (1994)	0294.865	L&BN 5FT S/O BCR @ NE COR BRIDGE #B53-1734 55FT S & 30FT E/O C/L INT MENDIK AVE & 1ST ST	Y 8099
RIVERA (1994)	0242.751	L&N IN CB 22FT W BCR @ SW COR 3RD ST & DOWNEY RD 75FT W & 40FT S/O C/L INT	Y 8102
RIVERA (1994)	0183.261	WIRE SPK IN S CB 1FT W/O BCR @ SW COR INDIANA ST & UNION PACIFIC AVE 42FT W & 25FT S/O C/L INT	Y 8104

QUAD-YEAR	ELEV	DESCRIPTION (INCLUDE QUAD AND YEAR IN DESCRIPTION)	BM NUMBER
RIVERA (1994)	0183.666	WIRE SPK @ BCR N CB 20FT N & 43FT E/O C/L INT INDIANA ST & UNION PACIFIC AVE @ W END CB	Y 8105
RIVERA (1994)	0180.211	L&T 0.5FT S/O BCR @ SW COR UNION PACIFIC AVE & & MARIANNA AVE 37FT S & 20FT W/O C/L INT	Y 8107
RIVERA (1994)	0180.422	RD BM TAG IN CB 2FT E/O BCR @ NE COR MARIANNA AV & UNION PACIFIC AV 40FT E & 20FT N/O C/L INT	Y 8108
RIVERA (1994)	0349.324	RND HD SPK IN CB 18FT S/O C/L EMERSON PL & 14FT W/O C/L PROD STEVENS AVE	Y 8109
RIVERA (1994)	0313.949	L&T IN S CB 1FT E/O BCR @ SE COR FORD BLVD & FLORAL DR 36FT E & 32FT S/O C/L INT	Y 8110
RIVERA (1994)	0190.282	WIRE SPK&L 17FT N/O BCR 71FT N & 41FT E/O C/L INT WASHINGTON BLVD & GRANDE VISTA AVE	Y 8112
RIVERA (1994)	0190.724	L&SPK 12FT W/O BCR IN C B @ SW COR WASHINGTON BL & GRANDE VISTA AVE 40FT S & 40FT W/O C/L INT	Y 8113
RIVERA (1994)	0187.453	L&T IN CB 19FT E/O BCR @ SE COR WASHINGTON BLVD & BLUFF RD 76FT E & 40FT S/O C/L INT	Y 8116
RIVERA (1994)	0404.934	RD BM TAG IN E CB 545FT S/O BCR 606FT S & 32FT E/O C/L INT EASTERN AVE & SHERIFF RD	Y 8119
RIVERA (1994)	0422.913	LACS MON IN WELL P.O.S.T. TOWNSEND AVE & CITY TERRACE DR	Y 8122
RIVERA (1994)	0185.423	RD BM TAG IN CB 2FT N/O BCR @ NE COR GREENWOOD AVE & WASHINGTON BLVD 78FT N & 28FT E/O C/L INT	Y 8138
RIVERA (1994)	0189.841	RD BM TAG IN CB 3FT W/O BCR @ SW COR WASHINGTON BLVD & MONTEBELLO BLVD 52FT W & 42FT S/O C/L INT	Y 8139
RIVERA (1994)	0190.614	RDBM TAG IN CB 0.5FT W/O BCR @ SE COR WASHINGTON BLVD & MONTEBELLO BLVD 48FT E & 42FT S/O C/L INT	Y 8140
RIVERA (1994)	0167.863	L&T IN CB 2FT S/O BCR @ SW COR PASSONS BLVD & MINES AVE 75FT S & 20FT W/O C/L INT	Y 8142
RIVERA (1994)	0160.956	RD BM TAG IN CB 2FT S/O BCR @ SW COR WASHINGTON BLVD & PARAMOUNT BLVD 79FT S & 46FT W/O C/L INT	Y 8143
RIVERA (1994)	0161.154	L&T IN CB 43FT S/O C/L WASHINGTON BLVD & 43FT W/O C/L PROD CANDACE AVE	Y 8145
RIVERA (1994)	0216.716	L&BR IN CB @ BCR NE COR WILCOX AVE & MADISON AVE 34FT N & 25FT E/O C/L INT	Y 8171

QUAD-YEAR	ELEV	DESCRIPTION (INCLUDE QUAD AND YEAR IN DESCRIPTION)	BM NUMBER
BASELINE (1990)	0140.608	CS MON IN WELL 21FT S/O BCR @ SW COR NORWALK BLVD & TELEGRAPH RD 79FT S & 40FT W/O C/L INT MKD (BM 2-11B 1970 RE 5869) 1FT W/O CF	Y 8723
BASELINE (1990)	0124.536	RD BM TAG IN CB 40FT N/O C/L TELEGRAPH RD & 0.2 MI E/O PIONEER AVE 47FT W/O CTR OF RR BRIDGE # B 1201 (1952)	Y 9207
BASELINE (1990)	0144.280	FC MON FL @ NW COR BRIDGE MKD 1937 OVER SAN GABRIEL RIVER 27FT N/O C/L TELEGRAPH RD MKD (77-73 1952)	Y 9210
BASELINE (1990)	0144.392	CE MON FL IN E END C B 21FT E/O BCR @ NE COR SLAUSON AV & MALT AV 86FT E & 41FT N/O C/L INT	Y 9213
BASELINE (1990)	0143.998	RD BM TAG IN CB 3FT W/O BCR @ NW COR SLAUSON AVE & MALT AVE 52FT W & 40FT N/O C/L INT	Y 9214
BASELINE (1990)	0138.482	SPK IN N CB 5FT W/O BCR @ NW COR SLAUSON AVE & BOXFORD AVE 70FT W & 40FT N/O C/L INT	Y 9215
BASELINE (1990)	0135.544	CS BM MON FL @ BK OF CB 74FT W/O BCR @ NW COR SLAUSON AVE & ZAMBRANO ST 135FT W & 40FT N/O C/L INT MKD (BM 4-19B 1968 RE 5869) E END C B	Y 9216
BASELINE (1990)	0139.574	CS BR CAP MON 1IN UP @ BK OF WK ON W P/L LINE BLDG #5500 & 50FT S/O C/L SLAUSON AVE NR PP # 1007282H MKD (RE 329)	Y 9218
BASELINE (1990)	0142.900	RD BM TAG IN CB 2FT E/O BCR @ NE COR SLAUSON AVE & HELIOTROPE AVE 36FT N & 37FT E/O C/L INT	Y 9219
BASELINE (1990)	0143.028	RD BM TAG IN CB 2FT W/O BCR @ NW COR SLAUSON AVE & HELIOTROPE AVE 36FT N & 37FT W/O C/L INT	Y 9220
BASELINE (1990)	0156.795	RD BM TAG IN CB 2FT E/O BCR @ NE COR SLAUSON AVE & GIFFORD AVE 33FT E & 35FT N/O C/L INT	Y 9221
BASELINE (1990)	0173.755	RD BM TAG IN CB 2FT E/O BCR @ NE COR SLAUSON AVE & SOTO ST 65FT E & 35FT N/O C/L INT	Y 9225
BASELINE (1990)	0176.899	CS MON IN WELL DN 10IN ON C/L SLAUSON AVE 15FT W/O C/L PACIFIC AVE MKD (WATTS TRAV STA J-2B 1938 RE 4233)	Y 9226
BASELINE (1990)	0321.064	RD BM TAG E CB 1FT N/O BCR @ NE COR SAN GABRIEL BLVD & BLEEKER ST 42FT E & 41FT N/O C/L INT	Y 9439

QUAD-YEAR	ELEV	DESCRIPTION (INCLUDE QUAD AND YEAR IN DESCRIPTION)	BM NUMBER
BASELINE (1990)	0322.327	CE BM MON IN WELL 1FT W/O CF & 2FT S/O BCR @ SW COR SAN GABRIEL BLVD & BLEWETT ST 43FT W & 43FT S/O C/L INT MKD (BM 1-24C 1970 RE 5869)	Y 9440
BASELINE (1990)	0209.991	RD BM TAG IN S CB 1FT E/O BCR @ SE COR ROSEMEAD BL & SAN GABRIEL BL 85FT E & 42FT S/O C/L INT	Y 9442
BASELINE (1990)	0152.199	RD BM TAG IN W CB 40FT W/O C/L NORWALK BL & 529 FT S/O C/L PACIFIC ST N END OF MOST NLY DRWY TO BLDG #9703 14FT S/O LT STD #A-436	Y 9444
BASELINE (1990)	0152.014	RD BM TAG IN E CB NORWALK BLVD 40FT E/O C/L & 625FT S/O C/L PACIFIC ST @ S END OF C B 29FT S/O LT STD #A-437	Y 9445
BASELINE (1990)	0155.866	L&BR IN CB 3FT E/O BCR @ NW COR NORWALK BL & LOS NIETOS RD 93FT W & 32FT N/O C/L INT	Y 9651
BASELINE (1990)	0177.844	RD BM TAG IN C B 28FT N/O BCR @ NW COR DURFEE AVE & WHITTIER BL 91FT N & 28FT W/O C/L INT	Y 9757
BASELINE (1990)	0180.298	RD BM TAG IN C B @ NE COR DURFEE AVE & STEPHENS ST 76FT N & 28FT E/O C/L INT	Y 9758
BASELINE (1990)	0182.356	RD BM TAG IN CB 1FT S/O BCR @ SE COR BEVERLY RD & DURFEE AVE 73FT S & 31FT E/O C/L INT	Y 9759
BASELINE (1990)	0182.525	RD BM TAG IN C B 4FT E/O BCR @ NE COR BEVERLY RD & DURFEE AVE 83FT E & 35FT N/O C/L INT	Y 9760
BASELINE (1990)	0132.761	RD BM TAG IN E END C B @ NE COR SLAUSON AVE & ALEXANDER ST 145FT E & 40FT N/O C/L INT	Y 9761
BASELINE (1990)	0134.983	RD BM TAG IN S END C B @ NE COR EASTERN AVE & SLAUSON AVE 84FT N & 43FT E/O C/L INT	Y 9762
BASELINE (1990)	0135.362	RD BM TAG IN E END C B 15FT W/O BCR @ SW COR EASTERN AVE & SLAUSON AVE 96FT W & 38FT S/O C/L INT	Y 9763
RIVERA (1994)	0293.512	RD BM TAG S CB 3FT W/O BCR @ SW COR EASTERN AVE & CESAR E CHAVEZ AVE 70FT W & 28FT S/O C/L INT	Y 9805
RIVERA (1994)	0381.327	RD BM TAG IN S CB MONTEREY PASS RD 35FT S/O C/L & 0.3MI ELY OF INT KERN AVE @ BEG OF WK TO ENT ELY END OF BLDG #1000	Y 9806
RIVERA (1994)	0380.803	RD BM TAG IN E CB S END C B @ NE COR GARVEY AVE & GARFIELD AVE 59FT N & 30FT E/O C/L INT	Y 9809

