

COUNTY OF LOS ANGELES
ROAD DEPARTMENT

PRECISE
BENCH MARK LIST



SAN DIMAS QUAD
1965 ADJUSTMENT

PREFACE

The Road Department level net is composed of more than 1,000 miles of levels supporting in excess of 10,000 bench marks. In 1964-65, a major readjustment of the net was undertaken. To emphasize the complete break with previous elevations, the SY, SG & SL series bench marks have been re-labeled BY, BG & BL, respectively.

To facilitate the adjustment, indexing, and distribution of adjusted values of the net, the County territory was divided into 31 quads or areas. For identification purposes each quad was given a name, viz., "Rosemead," "La Mirada," "Santa Fe," etc. When bench marks and elevations in the Road Department net are used, the name of the quad in which the bench mark is located and the date of the adjustment of the elevation must be included in the bench mark description, e.g.,

BG 1887 --L+BN IN CONC HDWL OF DRAIN PIPE UNDER DR 218 FT
NE +18 FT SE C/L INT GRAND AVE +CAMERON AVE MKD (BM)
(COVINA --1965) ELEV. 696.238

It is expected that this general adjustment will, for the most part, remain sound for the next 8 to 12 years. As new circuits are completed, however, re-adjustment of individual quads may become advisable. It is expected that these subsequent adjustments will be in the nature of a few hundredths of a foot. When a quad is re-adjusted, new elevation lists will be published and the date of the re-adjustment will replace the "1965" at the end of the bench mark description. Two bench marks in the same quad with different adjustment dates will not normally join each other. Since all adjustments taper out to nothing at the periphery of the quad, any bench mark in one quad will join any bench mark in another quad regardless of their respective adjustment dates.

The basic accuracy of the net is reflected by an indicated field probable error of plus or minus 0.012 foot per mile of leveling as determined from 298 conditions of closure. However, many years experience in vertical control in the greater Los Angeles basin and Antelope Valley indicate that because of varying degrees of subsidence and heaving, the true datum is recovered only by obtaining substantial agreement of a number of bench marks.

The users of this net are invited to assist in its maintenance by notifying this Department of cases of obliteration, apparent mistakes in descriptions or elevations, and proven disturbance of bench marks.

DATUM: U. S. Coast and Geodetic Survey Sea Level Datum
of 1929, through the medium of the Los Angeles
County Engineer Precise Level Net, 1963 Adjust-
ment.

ABBREVIATIONS USED IN BENCH MARK LISTINGS

ABUT - - - - -	Abutment	EC - - - - -	End of Curve
ALG - - - - -	Along	ENT - - - - -	Entrance
ANG PT - - - - -	Angle Point	FL - - - - -	Floor
B/W - - - - -	Back of Walk	FTG - - - - -	Footing
BCR - - - - -	Beginning of Curb Return	F/W - - - - -	Front of Walk
BC - - - - -	Beginning of Curve	GAR - - - - -	Garage
BLDG - - - - -	Building	HDWL - - - - -	Headwall
BM - - - - -	Bench Mark	HSE - - - - -	House
BT SPK - - - - -	Boat or Bolt Spike	INT - - - - -	Intersection
BR CAP - - - - -	Brass or Bronze Cap	IP - - - - -	Iron Pipe
C B - - - - -	Catch Basin	LT - - - - -	Left
CTR - - - - -	Center	LACE - - - - -	L. A. City Engineer
C/L - - - - -	Center Line	LACS - - - - -	L. A. County Engineer
C/L INT - - - - -	Center Line Intersection	LAFC - - - - -	L. A. Co. Flood Control
C/L PROD - - - - -	Center Line Produced	L+BN - - - - -	Lead and Bench Nail
CONC - - - - -	Concrete	L+BR - - - - -	Lead and Brad
COR - - - - -	Corner	L+N - - - - -	Lead and Nail
COE - - - - -	Corps of Engineers	L+RDBM TAG - - - - -	Lead and Road Dept. Bench Mark Tag
CULV - - - - -	Culvert	L+SPK - - - - -	Lead and Spike
CB - - - - -	Curb	L+T - - - - -	Lead and Tack
CS MON - - - - -	County Engineer Monument	MCR - - - - -	Middle of Curb Return
CS BR CAP - - - - -	County Engineer Brass Cap	MKD - - - - -	Marked
CT SPK - - - - -	Cut Spike	MC - - - - -	Middle of Curve
DR - - - - -	Drive or Driveway	MON - - - - -	Monument
E/O - - - - -	East of	N/O - - - - -	North of
ECR - - - - -	End of Curb Return	NR - - - - -	Near

ABBREVIATIONS USED IN BENCH MARK LISTINGS * * * CONTINUED

OPP - - - - - Opposite
PI - - - - - Point of Intersection
PK+W - - - - - PK Nail and Washer
P/L - - - - - Property Line
POST - - - - - Point on Semi-Tangent
PP - - - - - Power Pole
PVMT - - - - - Pavement
PROD - - - - - Produced
RD - - - - - Road
RDBM - - - - - Road Dept. Bench Mark
RR - - - - - Railroad
RT - - - - - Right
R/W - - - - - Right of Way
SDMH - - - - - Storm Drain Manhole
SMH - - - - - Sewer Manhole
SPK - - - - - Spike
ST+W - - - - - Spike Tin and Washer
S/O - - - - - South of
TP - - - - - Telephone Pole
USC+GS - - - - - U. S. Coast and Geodetic Survey
USGS - - - - - U. S. Geological Survey
WK - - - - - Walk
W/O - - - - - West of

COVINA QUAD

COVINA QUAD

QUAD

POMONA QUAD

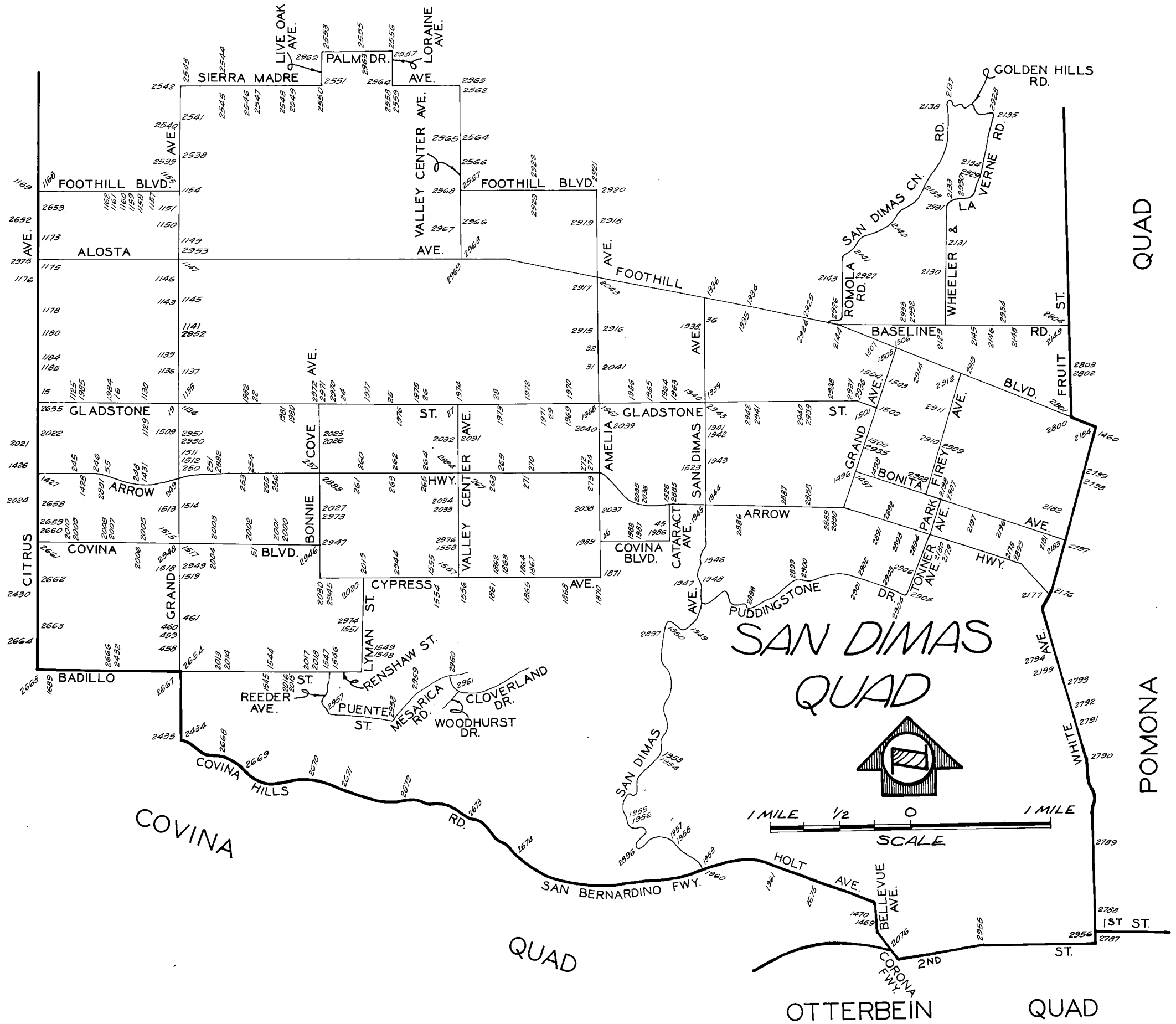

SAN DIMAS QUAD

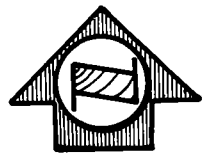

N

QUAD-YEAR	ELEV	DESCRIPTION (INCLUDE QUAD AND YEAR IN DESCRIPTION)	BM	NUMBER
BASELINE (1965)	587.368	DISC TOP OF CONC POST 1FT DN UNDER CS CASTIRON CAP 65FT E + 12FT N C/L INT CYPRESS AVE + GLADSTONE ST	BG	15
SN DIMAS (1965)	623.515	L+N IN WALL ON E SIDE BEN LOMOND AVE 35FT S C/L GLADSTONE ST	BG	16
SN DIMAS (1965)	759.602	USC+GS MON 10IN DN 11FT N +750FT E C/L INT GLADSTONE ST + BONNIE COVE AVE MKD (GLADSTONE 1923 RESET 1956 RE 5869)	BG	24
SN DIMAS (1965)	792.023	L+T N CB GLADSTONE ST NR C/L PROD SUNFLOWER AVE	BG	25
SN DIMAS (1965)	812.259	L+T N CB 28FT N + 280FT E C/L INT GLADSTONE ST + BRADFORD DR	BG	26
SN DIMAS (1965)	829.673	L+T S CB GLADSTONE ST 1FT W BCR @ SW COR VALLEY CENTER AVE 49FT W + 28FT S C/L INT	BG	27
SN DIMAS (1965)	854.592	L+T N CB GLADSTONE ST 50FT E PP NO 439596 IN FRONT HSE NO 124	BG	28
SN DIMAS (1965)	888.917	USC+GS DISC IN CULV HDWL 42FT S C/L GLADSTONE ST 25FT E C/L SFRR MKD (C96 1931)	BG	29
SN DIMAS (1965)	924.935	L+N S E COR BASE STANLEY 28FT N C/L ALLEN AVE + 30FT W C/L AMELIA AVE	BG	31
SN DIMAS (1965)	928.008	L+N SE COR OF CONC BASE TRANSMISSION TOWER NO 235 D7 60FT W C/L AMELIA AVE	BG	32
SN DIMAS (1965)	998.294	DISC IN CONC POST 20FT E C/L SAN DIMAS AVE + 200FT N C/L BASE LINE RD MKD (Y35 1923 RESET 1934)	BG	36
SN DIMAS (1965)	907.380	L+T IN CONC DR TO HSE @ NW COR COVINA BLVD + CATARACT AVE 132FT N + 35FT W C/L INT MKD (BM)	BG	45
SN DIMAS (1965)	847.084	L+N IN N EDGE GUTTER 20FT N C/L COVINA BLVD + 3FT E C/L AMELIA AVE	BG	46
SN DIMAS (1965)	673.285	L+T NR CTR CB RET @ SE COR GLENDORA AVE + COVINA BLVD 22FT S + 22FT E C/L INT	BG	51
BASELINE (1965)	564.340	BT SPK E CB 5FT S BCR @ SE COR CYPRESS AVE + CYPRESS ST 62FT S + 30FT E C/L INT MKD (SD 137)	BG	64
SN DIMAS (1965)	597.656	L+T S CB N SERVICE RD ARROW HWY ON C/L PROD FAIRVALLEY AVE	BG	245
SN DIMAS (1965)	603.696	L+T S CB N SERVICE RD ARROW HWY ON C/L PROD OAKBANK DR	BG	246
SN DIMAS (1965)	630.331	FC BR MON FLUSH IN DR 50FT N C/L ARROW HWY ON R/W OF SAN DIMAS WASH 25FT N OF E END BRIDGE + 1400FT E BEN LOMOND AVE MKD (RW 87)	BG	248
SN DIMAS (1965)	655.555	RD MON IN WELL 8IN DN @ OR NR C/L INT ARROW HWY + GRAND AVE MKD (LA CO RD DEPT 1960)	BG	249
SN DIMAS (1965)	652.774	FC MON 2IN DN ON NE COR ARROW HWY + GRAND AVE 110FT N + 59FT E C/L INT MKD (88 RW6)	BG	250
SN DIMAS (1965)	679.870	L+T IN CONC WK TO HSE W/CONC BLOCK FENCE 66FT N C/L ARROW HWY 900FT W GLENDORA AVE MKD (BM)	BG	251

QUAD-YEAR	ELEV	DESCRIPTION (INCLUDE QUAD AND YEAR IN DESCRIPTION)	BM	NUMBER
SN DIMAS (1965)	692.383	RDBM TAG S CB 1FT W BCR @ SW COR ARROW HWY + GLENDDORA AVE 42FT S + 71FT W C/L INT	BG	253
SN DIMAS (1965)	695.407	RDBM TAG N CB 6FT W BCR @ NE COR ARROW HWY + GLENDDORA AVE 42FT N + 61FT E C/L INT	BG	254
SN DIMAS (1965)	704.214	L+T IN E END OF CONC WK 53FT S C/L ARROW HWY FRONT OF HSE NO 20058	BG	255
SN DIMAS (1965)	710.310	L+BN IN E EDGE CONC WK 8FT FROM N END WK 55FT S C/L ARROW HWY FRONT OF HSE NO 20144 375FT W C/L BANNING AVE	BG	256
SN DIMAS (1965)	730.902	RD MON IN WELL 8IN DN @ DR NR C/L INT BONNIE COVE AVE + ARROW HWY MKD (LA CO RD DEPT)	BG	257
SN DIMAS (1965)	752.078	L+T N CB 42FT N C/L ARROW HWY ON C/L PROD LYMAN AVE MKD (BM)	BG	260
SN DIMAS (1965)	751.676	RD MON IN WELL 8IN DN @ DR NR C/L INT ARROW HWY + LYMAN AVE MKD (LA CO RD DEPT 1960)	BG	261
SN DIMAS (1965)	771.965	L+T E SIDE OF DOOR OF BRICK BLDG 70FT N C/L ARROW HWY @ NE COR SUNFLOWER AVE	BG	262
SN DIMAS (1965)	769.757	RD MON IN WELL 8IN DN @ DR NR C/L INT ARROW HWY + SUNFLOWER AVE MKD (LA CO RD DEPT 1960)	BG	263
SN DIMAS (1965)	796.099	RDBM TAG IN N CB 42FT N C/L ARROW HWY + 1000FT W VALLEY CENTER AVE	BG	264
SN DIMAS (1965)	795.489	RDBM TAG IN S CB 42FT S C/L ARROW HWY + 1000FT W VALLEY CENTER AVE	BG	265
SN DIMAS (1965)	810.574	L+T IN S CB 42FT S C/L ARROW HWY + 68FT E C/L VALLEY CENTER AVE MKD (BM)	BG	267
SN DIMAS (1965)	840.634	L+T CONC COVERED ROCK WALL (BROKEN) 70FT S C/L ARROW HWY RT OF DR TO HSE NO 1312	BG	268
SN DIMAS (1965)	839.522	RDBM TAG N CB 42FT N C/L ARROW HWY + 1000FT E VALLEY CENTER AVE	BG	269
SN DIMAS (1965)	859.722	RD MON IN WELL 8IN DN @ DR NR C/L INT ARROW HWY + LONE HILL AVE MKD (LA CO RD DEPT 1960)	BG	270
SN DIMAS (1965)	861.041	L+T IN S CB @ SW COR ARROW HWY + LONE HILL AVE 80FT W + 42FT S C/L INT MKD (BM)	BG	271
SN DIMAS (1965)	887.750	L+BN IN TOP OF 8IN STANDPIPE 78FT N C/L ARROW HWY 380FT W OF BC W OF AMELIA AVE	BG	272
SN DIMAS (1965)	890.730	L+T IN S CB ARROW HWY 42FT S C/L + 50FT W OF BC W OF AMELIA AVE MKD (BM)	BG	273
SN DIMAS (1965)	892.047	RDBM TAG 42FT N C/L ARROW HWY + 7FT W OF BC W OF AMELIA AVE	BG	274
SN DIMAS (1965)	590.665	L+BN W CB 1FT N BCR @ COR ADAMS PARK DR + GRAND AVE	BG	458
SN DIMAS (1965)	605.683	L+BN @ W BCR @ NW COR GRAND AVE + RUDDOCK AVE	BG	459
SN DIMAS (1965)	619.226	L+BRAD E CB 3FT S BCR @ NE COR EDGECOMB ST + GRAND AVE	BG	460
SN DIMAS (1965)	618.968	L+BN IN CTR E CONC HWY OF BRIDGE NO 131 ON GRAND AVE 155FT N COR IN BERNARDINO RD	BG	461

QUAD-YEAR	ELEV	DESCRIPTION (INCLUDE QUAD AND YEAR IN DESCRIPTION)	BM NUMBER
SN DIMAS (1965)	613.535	L+T CONC BASE S LEG OF HIGH TENSION TOWER NO 239D5 310FT E DR TO HSE NO 18725 GLADSTONE ST 75FT N C/L + 50FT W BIG DALTON WASH	BG 1125
SN DIMAS (1965)	634.011	CS MON IN WELL 10 IN DN C/L GLADSTONE ST 215FT W C/L SODERBERG AVE	BG 1129
SN DIMAS (1965)	637.807	L+T CTR CB RET @ NW COR SODERBERG AVE + GLADSTONE ST	BG 1130
SN DIMAS (1965)	666.048	L+T W CB GRAND AVE 45 FT N DR TO HSE NO 5733 100FT S C/L PROD DAWSON AVE	BG 1136
SN DIMAS (1965)	666.308	L+SPK S CB DAWSON AVE 10FT E BCR @ SE COR GRAND AVE 20FT S + 76FT E C/L INT MKD (SD 301)	BG 1137
SN DIMAS (1965)	663.854	L+BN CONC BASE OF SE LEG OF HIGH TENSION TOWER NO 238 D6 130FT N BIG DALTON WASH + 70FT W C/L GRAND AVE	BG 1139
SN DIMAS (1965)	672.243	PK IN N CB BASE LN SERVICE RD 2FT E BCR @ NE COR GRAND AVE 30FT N 100FT E C/L INT MKD (SD 304)	BG 1141
SN DIMAS (1965)	686.500	L+T S EDGE CONC WK TO HSE NO 6159 65FT W C/L GRAND AVE @ SW COR MAUNA LOA AVE	BG 1143
SN DIMAS (1965)	689.440	L+SPK S CB MAUNA LOA AVE 5FT E BCR @ SE COR GRAND AVE 18FT S + 83FT E C/L INT	BG 1145
SN DIMAS (1965)	691.995	L+T SE COR WEIR BOX 30 FT W C/L GRAND AVE + 15FT S C/L PROD COLORADO AVE	BG 1146
SN DIMAS (1965)	701.643	L+T W END OF GAS STA ISL 65FT S C/L ALOSTA AVE + 70FT E C/L GRAND AVE	BG 1147
SN DIMAS (1965)	705.716	L+BN 1FT N BCR OF SERVICE RD @ NE COR 52FT W C/L GRAND AVE + 38FT W C/L ORANGEPATH ST	BG 1149
SN DIMAS (1965)	711.119	L+T 1FT S BCR @ SW COR SERVICE RD 48FT S C/L HEBER ST + 81FT W C/L GRAND AVE	BG 1150
SN DIMAS (1965)	716.943	L+T 1FT S BCR @ SW COR GRAND AVE SERVICE RD + LOCHLEVEN ST	BG 1151
SN DIMAS (1965)	725.465	CS MON @ C/L INT FOOTHILL BLVD GRAND AVE (USE N EDGE)	BG 1154
SN DIMAS (1965)	722.055	COE STD BR CAP MON N CB FOOTBLVD 17FT W OF END CB 30FT N + 136FT W C/L INT GRAND AVE MKD (LD17-1957)	BG 1155
SN DIMAS (1965)	699.231	L+BN 1FT W BCR @ NW COR VALENTIA ST + FOOTHILL BLVD	BG 1157
SN DIMAS (1965)	692.984	L+T E CB WILDWOOD AVE 47FT S C/L FOOTHILL BLVD	BG 1158
SN DIMAS (1965)	687.384	L+T E CB CALIFORNIA AVE 55FT S C/L FOOTHILL BLVD	BG 1159
SN DIMAS (1965)	681.694	L+T W CB MARIETTA AVE 45FT S C/L FOOTHILL BLVD	BG 1160
SN DIMAS (1965)	676.147	L+T W CB BELMONT AVE 100FT S C/L FOOTHILL BLVD	BG 1161
SN DIMAS (1965)	676.502	CS MON @ C/L INT LE LOMOND AVE + FOOTHILL BLVD	BG 1162

QUAD-YEAR	ELEV	DESCRIPTION (INCLUDE QUAD AND YEAR IN DESCRIPTION)	BM NUMBER
BASELINE (1965)	655.439	CS MON @ C/L INT FOOTHILL BLVD TO E + CITRUS AVE S	BG 1168
BASELINE (1965)	655.924	L+T E WALL OF DRAIN 30FT N C/L FOOTHILL BLVD TO E 17FT W C/L PROD CITRUS AVE 25FT N DR TO HSE NO 6843	BG 1169
BASELINE (1965)	626.216	FC BR CAP W RET WALL 75FT N LITTLE DALTON WASH + 18FT W C/L CITRUS AVE	BG 1173
BASELINE (1965)	616.107	L+BN N CB ALOSTA AVE 33FT W BCR @ NW COR CITRUS AVE 100FT W + 40FT N C/L INT	BG 1175
BASELINE (1965)	616.544	L+SPK E CB CITRUS AVE 10FT S BCR @ SE COR ALOSTA AVE 30FT E + 104FT S C/L INT	BG 1176
BASELINE (1965)	609.285	RDBM TAG N CB MAUNA LOA AVE 6FT E BCR @ NE COR CITRUS AVE 18FT N + 72FT E C/L INT	BG 1178
BASELINE (1965)	599.439	L+BN E CB CITRUS AVE 23FT S BCR @ SE COR BASE LINE RD + 87FT S C/L INT	BG 1180
BASELINE (1965)	591.844	L+T N CB NEARFIELD ST 5FT E BCR @ NE COR CITRUS AVE 70FT E + 100FT N C/L INT	BG 1184
BASELINE (1965)	591.704	L+BRAD S CB NEARFIELD ST 1FT E BCR @ SE COR CITRUS AVE 64FT E + 18FT S C/L INT	BG 1185
BASELINE (1965)	578.138	C S MON @ C/L CITRUS AVE 20FT S C/L ARROW HWY MKD (SEC COR 2 1 11 12 T1S R10W)	BG 1426
BASELINE (1965)	580.676	L+T SIDE CONC BASE OF LIGHT STANDARD 50FT N C/L ARROW HWY + 54FT E C/L CITRUS AVE	BG 1427
SN DIMAS (1965)	597.052	L+BN CTR CB RET @ SE COR FAIRVALLEY AVE + ARROW HWY SERV RD	BG 1428
SN DIMAS (1965)	631.464	L+BN W END GAS PUMP ISLAND OF BLDG NO 19131 ARROW HWY 175FT N C/L + 25FT E C/L BEN LOMOND AVE	BG 1431
BASELINE (1965)	1150.342	CS MON SE COR WHITE AVE + FOOTHILL BLVD 15FT E + 51FT S C/L INT	BG 1460
BASELINE (1965)	785.441	BRONZE DISK IN CTR OF CONC ABUT OF SPRR CULV 8FT N OF TRACKS 250FT W INT VERNON AVE + BELLEVUE AVE	BG 1469
BASELINE (1965)	794.707	L+T CTR OF S CB RET @ INT OF BELLEVUE HWY OF CORONA FRWY	BG 1470
SN DIMAS (1965)	1049.369	L+BN S CB 2FT W C/L GRAND AVE + 35FT S C/L BONITA AVE + 40FT	BG 1496
SN DIMAS (1965)	1048.748	L+BN E CB GRAND AVE 20FT E C/L + 100FT S C/L BONITA AVE	BG 1497
SN DIMAS (1965)	1033.083	CS MON IN WELL 9IN DN 8FT N OF N CB PROD BONITA AVE + 31FT E OF E CB PROD GLENFIELD AVE MKD (BM 13-14 1952 RE63)	BG 1498
SN DIMAS (1965)	1061.111	L+BRAD 1FT N BCR @ NW COR JUANITA AVE + GRAND AVE	BG 1500
SN DIMAS (1965)	1071.741	L+BN W CB GRAND AVE 15FT W C/L + 55FT S C/L GLADSTONE ST	BG 1501
SN DIMAS (1965)	1072.307	CS MON IN WELL @ C/L INT GLADSTONE ST + GRAND AVE	BG 1502

QUAD-YEAR	ELEV	DESCRIPTION (INCLUDE QUAD AND YEAR IN DESCRIPTION)	BM NUMBER
SN DIMAS (1965)	1095.456	L+BN IN CONC SLAB @ THE SE COR OF A BARN 35FT W C/L GRAND AVE OPP HSE NO 860 1000 FT N C/L GLADSTONE ST	BG 1503
SN DIMAS (1965)	1096.807	L+T IN SE COR OF CONC WK TO HSE NO 906 GRAND AVE 50FT E C/L + 1000 FT N C/L GLADSTONE ST	BG 1504
SN DIMAS (1965)	1123.408	L+BN S CB 21FT W BCR @ NW COR GRAND AVE + FOOTHILL BLVD	BG 1505
SN DIMAS (1965)	1123.635	L+T N CB FOOTHILL BLVD 36FT W C/L INT PROD GRAND AVE	BG 1506
SN DIMAS (1965)	1132.417	CS MON IN WELL 5FT W C/L INT BONNELLE AVE + 5FT E C/L BASE LINE RD MKD (BM 11-51 1952 RE 63)	BG 1507
SN DIMAS (1965)	658.954	L+BN 1FT N OF SE COR OF CB AROUND OAKDALE CEMETERY 33FT N + 36FT W C/L INT GRAND AVE + JUANITA AVE	BG 1509
SN DIMAS (1965)	658.355	RDBM TAG IN N CB 15FT E OF BCR 30FT E + 18FT N C/L INT GRAND AVE + FLEETWOOD PL	BG 1511
SN DIMAS (1965)	657.370	L+BN IN E CB 3FT S BCR 58FT S + 40FT E C/L INT GRAND AVE + FLEETWOOD PL	BG 1512
SN DIMAS (1965)	646.223	CS MON IN WELL 8 IN DN @ C/L INT GRAND AVE + CIENEGA AVE MKD (RE 03) USE S EDGE	BG 1513
SN DIMAS (1965)	647.573	RDBM TAG E CB 1FT N BCR @ NW COR GRAND AVE + CIENEGA AVE 66FT N + 40FT W C/L INT	BG 1514
SN DIMAS (1965)	637.349	RDBM TAG 2FT N BCR @ NW COR COVINA BLVD + GRAND AVE 67FT N + 40FT W C/L INT	BG 1515
SN DIMAS (1965)	632.984	L+BN W CB GRAND AVE 45FT N C/L + 550FT S COVINA BLVD OPP GARAGE TO HSE NO 4708	BG 1517
SN DIMAS (1965)	627.099	F C MON 7IN DN @ C/L INT GRAND AVE + CYPRESS ST MKD (RESET 12-62)	BG 1518
SN DIMAS (1965)	623.305	NAIL IN CHIS (X) N CB HURST ST 18FT N C/L + 80FT W C/L GRAND AVE	BG 1519
SN DIMAS (1965)	951.983	CS MON IN WELL @ C/L INT OF BONITA AVE + SAN DIMAS AVE	BG 1523
SN DIMAS (1965)	921.028	L+BN W CB CATARACT AVE 20FT W C/L + 185FT N C/L ARROW HWY	BG 1526
SN DIMAS (1965)	679.459	CS MON IN WELL 15IN DN @ C/L INT BADILLO ST + REEDER ST (USE NE COR)	BG 1546
SN DIMAS (1965)	680.257	RDBM TAG IN W CB 2FT N BCR @ NW COR REEDER ST + BADILLO ST 18FT W + 51FT N C/L INT	BG 1547
SN DIMAS (1965)	696.971	1-1/2IN IP RE TAG 2699 4IN DN @ INT P/L OF 4034 + 4040 LYMAN AVE 30FT E + 200FT N OF CURVE TO W	BG 1548
SN DIMAS (1965)	699.506	L+T ON N EDGE OF CONC DR TO HSE NO 4040 LYMAN AVE 30FT E C/L + 275FT N OF BC	BG 1549
SN DIMAS (1965)	704.301	RDBM TAG IN N CB 1FT W BCR @ NW COR RUDDOCK ST + LYMAN AVE 73FT N + 60FT W C/L INT	BG 1551
SN DIMAS (1965)	752.540	CS MON IN WELL 12IN DN @ C/L INT BADILLO ST + CYPRESS AVE MKD (COVINA HIA)	BG 1554

QUAD-YEAR	ELEV	DESCRIPTION (INCLUDE QUAD AND YEAR IN DESCRIPTION)	BM NUMBER
SN DIMAS (1965)	754.885	CS MON IN WELL @ C/L INT CYPRESS AVE + VALLEY CENTER AVE	BG 1556
SN DIMAS (1965)	756.434	RDBM TAG IN CONC GUARD CORNER @ NW CYPRESS AVE + VALLEY CENTER AVE 19FT N + 16FT W, C/L INT	BG 1557
SN DIMAS (1965)	782.575	CS MON IN WELL 7IN DN @ C/L INT COVINA BLVD + VALLEY CENTER AVE	BG 1558
BASELINE (1965)	546.047	USC+GS BR DISC 4FT ABOVE WALK OUT EDGE OF BLDG @ SE COR BADILLO ST + CITRUS AVE FROM NW COR MKD (USC+GS BM NO 35)	BG 1689
SN DIMAS (1965)	764.295	L+BN IN CONC WINGWALL W SIDE FC CHANNEL 23FT S C/L CYPRESS AVE 1180FT E C/L VALLEY CENTER AVE	BG 1861
SN DIMAS (1965)	767.718	L+BN IN CONC HDWL FC CHANNEL OUT C/L CYPRESS AVE + 1265FT E C/L VALLEY CENTER AVE	BG 1862
SN DIMAS (1965)	780.457	L+BN IN S CB 18FT S C/L CYPRESS AVE 4FT W BCR OF DR TO HSE NO 1210 + 820FT W C/L LONE HILL AVE	BG 1863
SN DIMAS (1965)	796.477	L+BN N END CONC HDWL FC CHANNEL OUT 29FT N C/L CYPRESS AVE + 30FT W C/L LONE HILL AVE	BG 1864
SN DIMAS (1965)	795.738	CS MON IN WELL @ C/L INT CYPRESS AVE + LONE HILL AVE	BG 1865
SN DIMAS (1965)	807.972	L+T SW CORN CONC WK TO HSE NO OUT 1007 CYPRESS AVE 47FT N C/L + 540FT E LONE HILL AVE	BG 1867
SN DIMAS (1965)	825.793	L+BN N SIDE CONC UNDERGROUND STORAGE TANK 32FT S C/L CYPRESS AVE + 1290FT E LONE HILL AVE	BG 1868
SN DIMAS (1965)	851.026	CS MON IN WELL @ C/L INT CYPRESS AVE + AMELIA AVE	BG 1870
SN DIMAS (1965)	852.391	L+SPK IN CONC WK TO HSE NO 800 AMELIA AVE 17FT E C/L + 3FT N C/L PROD CYPRESS AVE	BG 1871
SN DIMAS (1965)	1015.658	STD BRONZE DISC IN CONC BRIDGE OVER SAN DIMAS WASH 0.2 MI E C/L SAN DIMAS AVE + 30FT N C/L FOOTHILL BLVD MKD (METROPOLITAN 51W)	BG 1934
SN DIMAS (1965)	1013.650	FC TAG IN E WINGWALL SAN DIMAS WASH 34FT S C/L FOOTHILL BLVD + 0.2MI E C/L SAN DIMAS AVE	BG 1935
SN DIMAS (1965)	1016.523	L+T IN CONC GUTTER OF ROCK RET WL NE COR SAN DIMAS AVE + FOOTHILL BLVD 60FT N + 50FT E C/L INT MKD (BM)	BG 1936
SN DIMAS (1965)	999.442	CS MON IN WELL 10IN DN NR OUT INT SAN DIMAS AVE + BASE LINE RD 10FT E + 12 FT S C/L INT MKD (BM 11-45)	BG 1938
SN DIMAS (1965)	1010.842	CS MON IN WELL 10IN DN NR C/L INT SAN DIMAS AVE + GLADSTONE AVE MKD (RE 329)	BG 1939
SN DIMAS (1965)	1011.266	SQ HD SPK W CB 6FT S BCR @ SW COR SAN DIMAS AVE + GLADSTONE AVE 25FT W + 31FT S C/L INT MKD (LV 17)	BG 1940
SN DIMAS (1965)	970.988	L+BN W CB 7FT N BCR @ NW COR SAN DIMAS AVE + 4TH ST 35FT N + 25FT W C/L INT MKD (LV 45)	BG 1941
SN DIMAS (1965)	970.179	CS MON IN WELL 10IN DN @ C/L INT SAN DIMAS AVE + 4TH ST MKD (C S MON)	BG 1942

QUAD-YEAR	ELEV	D E S C R I P T I O N (INCLUDE QUAD AND YEAR IN DESCRIPTION)	BM	NUMBER
SN DIMAS (1965)	953.074	SQ HD SPK E CB 12FT N BCR @ NE COR SAN DIMAS AVE + BONITA AVE 50FT N + 25FT E C/L INT MKD (SD 202)	BG	1943
SN DIMAS (1965)	923.144	CS MON IN WELL 8IN DN @ PT SAN DIMAS AVE 0.55MI S ARROW HWY MKD (RE 58 69)	BG	1946
SN DIMAS (1965)	944.589	CS MON IN WELL 6IN DN NR INT CANNON AVE + PUDDINGSTONE DR 0.65MI S ARROW HWY ON SAN DIMAS AVE MKD (RE 5869)	BG	1947
SN DIMAS (1965)	945.837	L+T N END CONC HDWL 20FT E C/L CANNON AVE 80FT E C/L SAN DIMAS AVE NR INT PUDDINGSTONE DR 0.65 MI S ARROW HWY ON SAN DIMAS AVE MKD (BM)	BG	1948
SN DIMAS (1965)	982.063	RDBM TAG CONC FTG OF E GATE TO BOAT LAUNCHING AREA 44FT S C/L + 1.2MI S ARROW HWY	BG	1949
SN DIMAS (1965)	981.461	RDBM TAG CONC FTG OF W GATE TO BOAT LAUNCHING AREA 35FT S C/L + 1.2MI S ARROW HWY	BG	1950
SN DIMAS (1965)	1057.217	L+T ON TOP OF ROCK WL NR INLET PIPE 20FT N C/L SAN DIMAS AVE + 2.3MI S ARROW HWY MKD (BM)	BG	1953
SN DIMAS (1965)	1057.708	L+T IN CONC FL ROCK INLET TO PIPE 3FT E OF ENT 20FT N APPROX C/L SAN DIMAS AVE + 2.3MI S ARROW HWY	BG	1954
SN DIMAS (1965)	1112.877	RD MON IN WELL 8IN DN NR ANG PT WIRE FENCE 100FT S BC + 50FT W C/L SAN DIMAS + 2.7MI S ARROW HWY (2IN IP 2FT W OF MON 3FT UP)	BG	1955
SN DIMAS (1965)	1115.100	RD MON IN WELL 8IN DN NR EXIT OF CUT 45FT FROM EC 30FT N C/L SAN DIMAS AVE + 2.7MI S ARROW HWY (2IN IP 2FT N OF MON 3FT UP)	BG	1956
SN DIMAS (1965)	892.717	RD MON IN WELL 4IN DN 36FT E C/L SAN DIMAS AVE 3FT S EC + 3.3MI S ARROW HWY (2IN IP 2FT E OF MON 3FT UP)	BG	1957
SN DIMAS (1965)	889.422	RDBM TAG IN CONC WATER TROUGH 45FT E C/L SAN DIMAS AVE 66FT S BC + 3.3MI S ARROW HWY	BG	1958
BASELINE (1965)	787.478	RDBM TAG N END OF ABUT OF BRIDGE NO 5 OVER SAN BERNARDINO FREEWAY 15FT W C/L SAN DIMAS AVE	BG	1959
BASELINE (1965)	786.503	RDBM TAG S END OF ABUT OF BRIDGE NO 5 OVER SAN BERNARDINO FREEWAY 15FT E C/L SAN DIMAS AVE	BG	1960
BASELINE (1965)	768.342	CS MON IN WELL 11IN DN @ C/L ROSECRANS ST 130FT SE C/L HOLT AVE MKD (BM 17-21 1952)	BG	1961
SN DIMAS (1965)	1016.581	CS MON IN WELL 10IN DN @ C/L INT GLADSTONE ST + CATARACT AVE MKD (RE 329)	BG	1963
SN DIMAS (1965)	1018.456	L+T IN CONC APRON OF DR N SIDE GLADSTONE ST 16FT N C/L + 65FT W C/L CATARACT AVE MKD (BM)	BG	1964
SN DIMAS (1965)	1018.315	CS MON IN WELL 8IN DN C/L INT GLADSTONE ST + PROP ACACIA ST MKD (CO SUR RE 63)	BG	1965
SN DIMAS (1965)	1011.739	CS MON IN WELL 8IN DN C/L INT GLADSTONE ST + PROP EUCLA AVE MKD (CO SUR RE 63)	BG	1966
SN DIMAS (1965)	912.314	CS MON IN WELL 10IN DN 10FT S + 10FT W C/L INT GLADSTONE ST + AMELIA AVE MKD (BM 11 42 1952 RE 63)	BG	1967

QUAD-YEAR	ELEV	DESCRIPTION (INCLUDE QUAD AND YEAR IN DESCRIPTION)	BM NUMBER
SN DIMAS (1965)	912.969	L+T N CB S SERV ISL 2FT W BCR @ SW COR GLADSTONE ST + PEARLANNA DR 35FT S + 30FT W C/L INT (AMELIA AVE)	BG 1968
SN DIMAS (1965)	901.531	L+N S CB GLADSTONE ST ON C/L PROD GRAVETON AVE 28FT S C/L INT	BG 1969
SN DIMAS (1965)	900.968	L+T N CB SERV RD IN BCR @ NW COR GLADSTONE ST + GRAVETON AVE 46FT W + 70FT N C/L INT	BG 1970
SN DIMAS (1965)	884.855	RDBM TAG S CB 28FT S C/L GLADSTONE ST 151FT W C/L SANTA FE RR TRACK NR E END OF CATCH BASIN	BG 1971
SN DIMAS (1965)	872.416	CS MON IN WELL 8IN DN NR C/L INT LONE HILL AVE + GLADSTONE ST MKD (CO SUR RE 63)	BG 1972
SN DIMAS (1965)	853.046	RDBM TAG S CB 28FT S C/L GLADSTONE ST 0.2MI W LONE HILL AVE 15FT E OF END OF BLOCK FENCE	BG 1973
SN DIMAS (1965)	829.155	CS MON IN WELL 10IN DN @ ANGLE PT NR C/L INT VALLEY CENTER AVE + GLADSTONE ST MKD (RESET 1957 TRIANG GLENDORA H-11)	BG 1974
SN DIMAS (1965)	810.220	RDBM TAG N CB GLADSTONE ST 3FT E BCR @ NE COR BRADFORD DR 28FT N + 60FT E C/L INT	BG 1975
SN DIMAS (1965)	796.358	CS MON IN WELL 10IN DN 10FT S + 200FT E C/L INT GLADSTONE ST + SUNFORD AVE MKD (BM 11 38 1952 RE 63)	BG 1976
SN DIMAS (1965)	776.235	CS MON IN WELL 8IN DN @ PI OF 1ST CURVE GLADSTONE ST NW OF SAN DIMAS CHANNEL 0.2MI NW OF BRIDGE + 300FT E C/L LYMAN AVE MKD (CO SUR RE 63)	BG 1977
SN DIMAS (1965)	732.052	L+B E CB LFT S BCR @ SE COR GLADSTONE ST + CONCORD LANE 60FT S + 18FT E C/L INT	BG 1980
SN DIMAS (1965)	730.544	L+T S CB 2FT W BCR @ SW COR GLADSTONE ST + CONCORD LANE 24FT S + 55FT W C/L INT MKD (LS 2723)	BG 1981
SN DIMAS (1965)	619.446	CS MON IN WELL @ C/L INT BEN LOMOND AVE + GLADSTONE ST MKD (GLENDORA C-11 1956)	BG 1984
SN DIMAS (1965)	612.138	FC BR CAP FLUSH 42FT N C/L GLADSTONE ST + 60FT W C/L BIG DALTON CHANNEL BRIDGE NO B1242 MKD (81-RW-215)	BG 1985
SN DIMAS (1965)	906.345	L+T CONC DR TO HSE @ NW COR COVINA BLVD + CATARACT AVE 70FT N + 27FT W C/L INT MKD (BM)	BG 1986
SN DIMAS (1965)	865.333	BT SPK E CONC WALL 10FT W OF C/L OF DR TO HSE @ NW COR COVINA BLVD + PROUDMAN ST 40FT N C/L + 1000FT W CATARACT AVE	BG 1987
SN DIMAS (1965)	866.193	L+T W CONC WALL 10FT W OF C/L OF DR TO HSE @ NW COR COVINA BLVD + PROUDMAN ST 60FT N C/L + 1000FT W CATARACT AVE MKD (BM)	BG 1988
SN DIMAS (1965)	846.694	CS MON IN WELL 13IN DN NR C/L INT COVINA BLVD + AMELIA AVE MKD (RE 329)	BG 1989
SN DIMAS (1965)	688.406	L+BRAD E CB 9FT N BCR @ NE COR COVINA BLVD + MANGROVE AVE 55FT N + 18FT E C/L INT	BG 2000
SN DIMAS (1965)	687.601	L+BRAD N CB SERV ISL 8FT W BCR @ NW COR MANGROVE AVE + COVINA BLVD 77FT W + 30FT N C/L INT	BG 2001

QUAD-YEAR	ELEV	D E S C R I P T I O N (INCLUDE QUAD AND YEAR IN DESCRIPTION)	BM NUMBER
SN DIMAS (1965)	671.317	CS MON IN WELL 8IN DN @ C/L INT COVINA BLVD + GLENORA AVE MKD (E-1RE 63)	BG 2002
SN DIMAS (1965)	655.412	RDBM TAG E END OF CUL-DE-SAC OF SERV RD N SIDE COVINA BLVD 49FT N C/L + 1200 FT W GLENORA AVE	BG 2003
SN DIMAS (1965)	654.566	RDBM TAG S CB COVINA BLVD 30FT S C/L + 1250FT W GLENORA AVE NEAR CUL-DE-SAC ON N SIDE OF BLVD	BG 2004
SN DIMAS (1965)	617.569	L+BRAD N CB COVINA BLVD 40FT N C/L ON C/L PROD STARCREST DR	BG 2005
SN DIMAS (1965)	616.769	L+BRAD W CB 6FT S BCR @ SW COR COVINA BLVD + STARCREST DR 73FT S + 18FT W C/L INT	BG 2006
SN DIMAS (1965)	601.819	L+T 1FT E BCR @ NE COR COVINA BLVD + BARRANCA AVE 67 FT E + 30FT N C/L INT	BG 2007
SN DIMAS (1965)	601.792	CS MON FLUSH 6FT BACK OF RET @ NE COR COVINA BLVD + BARRANCA AVE 55FT N + 33FT E C/L INT MKD (RM NO 1)	BG 2008
SN DIMAS (1965)	585.760	L+T E CB 7FT N BCR @ COR COVINA BLVD + FAIRVALLEY AVE 71FT N + 18FT E C/L INT	BG 2009
SN DIMAS (1965)	584.405	L+N N CB COVINA BLVD (S CB OF ISLAND) 6FT W BCR 32FT N C/L 40FT W C/L FAIRVALLEY AVE	BG 2010
SN DIMAS (1965)	607.694	L+T W EDGE OF CONC WK TO CHURCH BLDG NO 1067 BADILLO ST 118FT N C/L + 95FT E GRAND AVE	BG 2013
SN DIMAS (1965)	609.397	CS MON IN WELL C/L BADILLO ST 1000FT E GRAND AVE MKD (RE 63)	BG 2014
SN DIMAS (1965)	642.556	RDBM TAG W CB ASHTON DR 1FT S BCR @ SW COR BADILLO ST 18FT W + 55FT S C/L INT	BG 2015
SN DIMAS (1965)	642.987	RDBM TAG E CB ASHTON DR 1FT S BCR @ SE COR BADILLO ST 18FT E + 55FT S C/L INT	BG 2016
SN DIMAS (1965)	663.148	RDBM TAG IN CB BADILLO ST 1FT E BCR @ NW COR DARFIELD AVE 20FT N + 44FT W C/L INT	BG 2017
SN DIMAS (1965)	664.635	RDBM TAG N CB BADILLO ST 2FT E BCR @ NE COR DARFIELD AVE 20FT N + 48FT E C/L INT	BG 2018
SN DIMAS (1965)	718.259	CS MON IN WELL @ C/L INT LYMAN AVE + CYPRESS ST	BG 2019
SN DIMAS (1965)	717.754	L+T S CB CYPRESS ST @ BCR SW COR LYMAN AVE 55FT W + 28FT S C/L INT	BG 2020
BASELINE (1965)	584.582	FC MON IN SW WINGWALL OF BRIDGE B1237 ON CITRUS AVE OVER BIG DALTON WASH 37FT W C/L MKD (BM 81-39)	BG 2021
BASELINE (1965)	585.060	L+BRAD E CB CITRUS AVE @ NE END OF BRIDGE B1237 OVER BIG DALTON WASH 30FT E C/L	BG 2022
BASELINE (1965)	572.286	L+SPK W CB 40FT W C/L CITRUS AVE + 57FT N OF N END BRIDGE B1228 OVER SAN DIMAS WASH	BG 2024
SN DIMAS (1965)	739.773	CS MON IN WELL 8IN DN NR C/L INT BONNIE COVE AVE + JUANITA AVE MKD (RE 63)	BG 2025
SN DIMAS (1965)	740.962	L+T W CB 1FT S BCR @ SW COR BONNIE COVE AVE + JUANITA AVE 35FT S + 20FT W C/L INT	BG 2026

QUAD-YEAR	ELEV	DESCRIPTION (INCLUDE QUAD AND YEAR IN DESCRIPTION)	BM NUMBER
SN DIMAS (1965)	721.675	L+T N CB 1FT E BCR @ NE COR BONNIE COVE AVE + CIENEGA AVE 30FT N + 58FT E C/L INT	BG 2027
SN DIMAS (1965)	694.751	T+T IN WELL 16IN DN C/L INT BONNIE COVE AVE + CYPRESS ST	BG 2030
SN DIMAS (1965)	822.786	L+T S CB 2FT E BCR @ SE COR VALLEY CENTER AVE + JUANITA AVE 36FT E + 20FT S C/L INT MKD (CSBM)	BG 2031
SN DIMAS (1965)	821.264	L+T S CB 3FT W BCR @ SW COR VALLEY CENTER AVE + JUANITA AVE 37FT W + 20FT S C/L INT	BG 2032
SN DIMAS (1965)	792.131	CS MON IN WELL 8IN DN C/L INT VALLEY CENTER AVE + CIENEGA AVE MKD (RE 63)	BG 2033
SN DIMAS (1965)	791.516	RDBM TAG E CB VALLEY CENTER AVE 32FT E C/L + 190FT S C/L CIENEGA AVE NR ENT CATCH BASIN	BG 2034
SN DIMAS (1965)	895.597	RDBM TAG W CB 1FT N BCR @ NW COR EUCLA AVE + ARROW HWY 77FT N + 20FT W C/L INT	BG 2035
SN DIMAS (1965)	896.350	RDBM TAG E CB 1FT N BCR @ NE COR EUCLA AVE + ARROW HWY 80FT N + 20FT E C/L INT	BG 2036
SN DIMAS (1965)	885.455	L+T CONC WK TO HSE @ SE COR AMELIA AVE + CIENEGA AVE 40FT S + 82FT E C/L INT (BM)	BG 2037
SN DIMAS (1965)	884.372	CS MON IN WELL 15IN DN NR C/L INT AMELIA AVE + CIENEGA AVE (USE N EDGE)	BG 2038
SN DIMAS (1965)	945.851	RDBM TAG CONC HDWL @ SE COR 5TH ST + AMELIA AVE 105FT E + 12FT S C/L INT	BG 2039
SN DIMAS (1965)	944.627	CS MON IN WELL 12IN DN NR C/L INT 5TH ST + AMELIA AVE (USE S EDGE) MKD (RE 329)	BG 2040
SN DIMAS (1965)	925.114	CS MON IN WELL 8IN DN NR C/L INT AMELIA AVE + ALLEN AVE MKD (RE 63)	BG 2041
SN DIMAS (1965)	954.464	RDBM TAG E CB 1FT N BCR @ SE COR AMELIA AVE + FOOTHILL BLVD 88FT S + 20FT E C/L INT	BG 2043
BASELINE (1965)	798.270	CS MON IN WELL 13IN DN IN CTR PKWY RET @ C/L 2ND ST 96FT E C/L BELLEVUE AVE	BG 2076
SN DIMAS (1965)	1160.200	CS MON IN WELL 10IN DN @ SW COR WHEELER + LA VERNE RD + BASE LINE RD 10FT S + 10FT W C/L INT MKD (BM 11-52)	BG 2129
SN DIMAS (1965)	1231.347	CS MON FLUSH 1FT W OF CB @ NW COR WHEELER + LA VERNE RD + ALDERGATE RD 47FT N + 31FT W C/L INT MKD (BM 53-1)	BG 2130
SN DIMAS (1965)	1247.486	CS TAG CONC POST IN WELL 8IN DN C/L WHEELER + LA VERNE RD 0.2MI N ALDERSGATE RD MKD (CO ENG)	BG 2131
SN DIMAS (1965)	1296.988	CS MON IN WELL 2IN DN ON W FENCE LINE OF CO FIRE STA NO 104 36FT N C/L WHEELER + LA VERNE RD + 0.6MI N LADERSGATE RD MKD (LOT COR)	BG 2133
SN DIMAS (1965)	1323.781	CS MON 3/4IN IP IN CONC WITH TAG IN WELL 10IN DN @ C/L WHEELER + LA VERNE RD 0.9MI N ALDERSGATE RD @ C/L OF TOWER LINE	BG 2134
SN DIMAS (1965)	1407.780	CS MON IN WELL 8IN DN NR C/L INT WHEELER + LA VERNE RD + SAN DIMAS CANYON RD MKD (CO SUR)	BG 2135
SN DIMAS (1965)	1257.989	RD SPK IN 3/4IN IP IN WELL 15IN DN @ C/L SAN DIMAS CANYON RD E + 36FT E C/L SAN DIMAS CANYON RD N	BG 2137

QUAD-YEAR	ELEV	DESCRIPTION (INCLUDE QUAD AND YEAR IN DESCRIPTION)	BM NUMBER
SN DIMAS (1965)	1255.603	USGS MON IN RET WALL @ NW COR SAN DIMAS CANYON RD N + SAN DIMAS CANYON RD E 60FT N + 24FT W C/L INT MKD (GAGING STA)	BG 2138
SN DIMAS (1965)	1171.828	L+N IN S CONC FOOTING OF STEEL TOWER NO 233 D2 50FT W SAN DIMAS CANYON RD + 1.3MI N FOOTHILL BLVD	BG 2139
SN DIMAS (1965)	1132.022	FC MON 2IN DN NR S END OF SPUR RD 5FT N OF 2IN REF PIPE 25FT E C/L SAN DIMAS CANYON RD 1MI N FOOTHILL BLVD MKD (88RW 197)	BG 2140
SN DIMAS (1965)	1106.788	FC MON 2IN DN 60FT E C/L SAN DIMAS CANYON RD + 550FT N C/L RAMOLA AVE 5FT S OF 2IN REF PIPE MKD (88RW 183)	BG 2141
SN DIMAS (1965)	1090.747	CS MON 2IN DN @ SW COR SAN DIMAS CANYON RD + RAMOLA AVE 100FT S + 50FT W C/L INT MKD (NO16)	BG 2143
SN DIMAS (1965)	1113.639	USC+GS MON 1IN UP @ NE COR BASE LINE RD 100FT NE FOOTHILL BLVD + 1FT WLY STONE WALL MKD (USC+GS GARRETT 1929)	BG 2144
SN DIMAS (1965)	1168.650	FC MON @ SE END OF BRIDGE OVER WASH 13FT S C/L BASE LINE RD 180FT E MAIN ENT W LINE HEIGHTS SCHOOL 1000FT E WHEELER + LA VERNE RD MKD (94-36)	BG 2145
SN DIMAS (1965)	1162.449	CS MON IN WELL 5FT W C/L EMERALD AVE + 5FT S C/L BASELINE RD MKD (BM 11-54 1952 RE 63)	BG 2146
SN DIMAS (1965)	1159.231	CS MON IN CONC POST 6 IN UP 3FT S C/L BASE LINE RD + 555FT E EMERALD AVE	BG 2148
BASELINE (1965)	1171.085	CS MON IN WELL 8FT W C/L FRUIT ST + 100FT S C/L BASE LINE RD MKD (BM 13-11 1952 RE 63)	BG 2149
BASELINE (1965)	1037.430	CS MON IN WELL 1FT E OF 2IN REF PIPE 104FT N C/L ARROW HWY (LA VERNE RD) + 27FT E C/L WHITE AVE MKD (BM 13-7 RE 63 1952)	BG 2176
BASELINE (1965)	1037.157	RDBM TAG IN W CB WHITE AVE 15FT S BCR @ SW COR ARROW HWY 34FT W + 68FT S C/L INT	BG 2177
SN DIMAS (1965)	1044.102	L+T CONC SLAB FRONT OF AT+SF LA VERNE DEPOT @ NW COR 105FT W C/L E ST + 108FT W C/L ARROW HWY	BG 2178
SN DIMAS (1965)	1030.696	CONC NAIL S CB ARROW HWY (PALOMARES AVE) 15FT E DR TO HSE NO 1742 17FT S C/L	BG 2179
SN DIMAS (1965)	1035.562	L+BN IN SW COR CONC RR SIGNAL BASE ON S SIDE AT+SF RR 120FT E C/L PARK AVE PROD	BG 2180
SN DIMAS (1965)	1064.128	L+BN N CB BONITA AVE (4TH ST) 19FT E BCR @ SE COR G ST 25FT S + 44FT E C/L INT	BG 2181
BASELINE (1965)	1082.392	CS MON IN WELL 2FT N OF N CB 7TH ST 17FT W BCR @ SW COR WHITE AVE 18FT N + 43FT W C/L INT	BG 2182
BASELINE (1965)	1064.595	L+BN W CB WHITE AVE 10FT S BCR @ SW COR BONITA AVE 25FT W + 71FT S C/L INT	BG 2183
BASELINE (1965)	1152.388	COE MON 3IN UP @ SW COR FOOTHILL BLVD + LINCOLN AVE (WHITE AVE) 41FT S + 21FT W C/L INT	BG 2184
SN DIMAS (1965)	1048.218	L+BN S CB 3RD ST 5FT E BCR @ SE COR AVE D 28FT S + 55FT E C/L INT	BG 2196

