

COUNTY OF LOS ANGELES
ROAD DEPARTMENT

PRECISE
BENCH MARK LIST



SAN DIMAS QUAD
1970 ADJUSTMENT

PREFACE

The Road Department level net is composed of more than 1,000 miles of levels supporting in excess of 10,000 bench marks. In 1964-65, a major readjustment of the net was undertaken. To emphasize the complete break with previous elevations, the SY, SG & SL series bench marks have been re-labeled BY, BG & BL, respectively.

To facilitate the adjustment, indexing, and distribution of adjusted values of the net, the County territory was divided into 31 quads or areas. For identification purposes each quad was given a name, viz., "Rosemead," "La Mirada," "Santa Fe," etc. When bench marks and elevations in the Road Department net are used, the name of the quad in which the bench mark is located and the date of the adjustment of the elevation must be included in the bench mark description, e.g.,

BG 1887 --L+BN IN CONC HDWL OF DRAIN PIPE UNDER DR 218 FT
NE +18 FT SE C/L INT GRAND AVE +CAMERON AVE MKD (BM)
(COVINA --1965) ELEV. 696.238

It is expected that this general adjustment will, for the most part, remain sound for the next 8 to 12 years. As new circuits are completed, however, re-adjustment of individual quads may become advisable. It is expected that these subsequent adjustments will be in the nature of a few hundredths of a foot. When a quad is re-adjusted, new elevation lists will be published and the date of the re-adjustment will replace the "1965" at the end of the bench mark description. Two bench marks in the same quad with different adjustment dates will not normally join each other. Since all adjustments taper out to nothing at the periphery of the quad, any bench mark in one quad will join any bench mark in another quad regardless of their respective adjustment dates.

The basic accuracy of the net is reflected by an indicated field probable error of plus or minus 0.012 foot per mile of leveling as determined from 298 conditions of closure. However, many years experience in vertical control in the greater Los Angeles basin and Antelope Valley indicate that because of varying degrees of subsidence and heaving, the true datum is recovered only by obtaining substantial agreement of a number of bench marks.

The users of this net are invited to assist in its maintenance by notifying this Department of cases of obliteration, apparent mistakes in descriptions or elevations, and proven disturbance of bench marks.

DATUM: U. S. Coast and Geodetic Survey Sea Level Datum
of 1929, through the medium of the Los Angeles
County Engineer Precise Level Net, 1963 Adjust-
ment.

ABBREVIATIONS USED IN BENCH MARK LISTINGS

ABUT - - - - -	Abutment	EC - - - - -	End of Curve
ALG - - - - -	Along	ENT - - - - -	Entrance
ANG PT - - - - -	Angle Point	FL - - - - -	Floor
B/W - - - - -	Back of Walk	FTG - - - - -	Footing
BCR - - - - -	Beginning of Curb Return	F/W - - - - -	Front of Walk
BC - - - - -	Beginning of Curve	GAR - - - - -	Garage
BLDG - - - - -	Building	HDWL - - - - -	Headwall
EM - - - - -	Bench Mark	HSE - - - - -	House
BT SPK - - - - -	Boat or Bolt Spike	INT - - - - -	Intersection
BR CAP - - - - -	Brass or Bronze Cap	IP - - - - -	Iron Pipe
C B - - - - -	Catch Basin	LT - - - - -	Left
CTR - - - - -	Center	LACE - - - - -	L. A. City Engineer
C/L - - - - -	Center Line	LACS - - - - -	L. A. County Engineer
C/L INT - - - - -	Center Line Intersection	LAFC - - - - -	L. A. Co. Flood Control
C/L PROD - - - - -	Center Line Produced	L+BN - - - - -	Lead and Bench Nail
CONC - - - - -	Concrete	L+BR - - - - -	Lead and Brad
COR - - - - -	Corner	L+N - - - - -	Lead and Nail
COE - - - - -	Corps of Engineers	L+RDEM TAG - - - - -	Lead and Road Dept. Bench Mark Tag
CULV - - - - -	Culvert	L+SPK - - - - -	Lead and Spike
CB - - - - -	Curb	L+T - - - - -	Lead and Tack
CS MON - - - - -	County Engineer Monument	MCR - - - - -	Middle of Curb Return
CS BR CAP - - - - -	County Engineer Brass Cap	MKD - - - - -	Marked
CT SPK - - - - -	Cut Spike	MC - - - - -	Middle of Curve
DR - - - - -	Drive or Driveway	MON - - - - -	Monument
E/O - - - - -	East of	N/O - - - - -	North of
ECR - - - - -	End of Curb Return	NR - - - - -	Near

ABBREVIATIONS USED IN BENCH MARK LISTINGS . . . CONTINUED

OPP - - - - - Opposite
PI - - - - - Point of Intersection
PK+W - - - - - PK Nail and Washer
P/L - - - - - Property Line
POST - - - - - Point on Semi-Tangent
PP - - - - - Power Pole
PVMT - - - - - Pavement
PROD - - - - - Produced
RD - - - - - Road
RDEM - - - - - Road Dept. Bench Mark
RR - - - - - Railroad
RT - - - - - Right
R/W - - - - - Right of Way
SDMH - - - - - Storm Drain Manhole
SMH - - - - - Sewer Manhole
SPK - - - - - Spike
ST+W - - - - - Spike Tin and Washer
S/O - - - - - South of
TP - - - - - Telephone Pole
USC+GS - - - - - U. S. Coast and Geodetic Survey
USGS - - - - - U. S. Geological Survey
WK - - - - - Walk
W/O - - - - - West of

COVINA QUAD

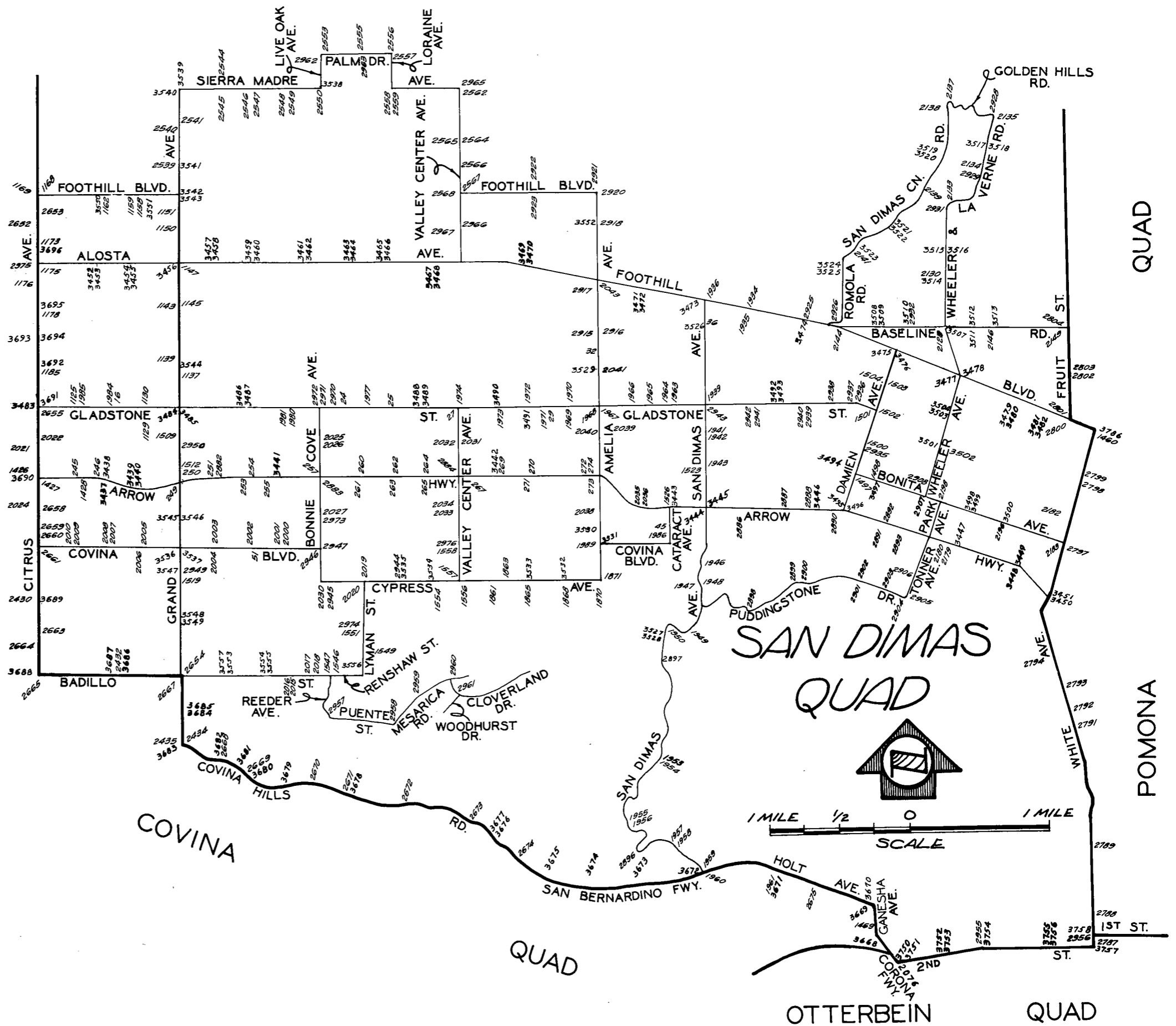

POMONA QUAD

COVINA QUAD

QUAD

OTTERBEIN QUAD

QUAD

SAN DIMAS QUAD

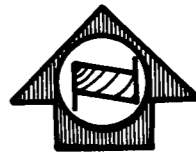

QUAD-YEAR	ELEV	D E S C R I P T I O N (INCLUDE QUAD AND YEAR IN DESCRIPTION)	BM	NUMBER
SN DIMAS (1970)	623.514	L + N IN WALL ON E SIDE BARRANCA AVE 35FT S C/L GLADSTONE ST	BG	16
SN DIMAS (1970)	759.590	USC+GS MON IN WELL 10IN DN 11FT N + 45FT W C/L INT GLADSTONE ST + STEPHORA AVE (MKD GLADSTONE 1923 RESET 1956 RE 5869)	BG	24
SN DIMAS (1970)	791.735	L+T N CB GLADSTONE ST NR C/L PROD SUNFLOWER AVE	BG	25
SN DIMAS (1970)	829.682	L+T S CB GLADSTONE ST 1FT W BCR @ SW COR VALLEY CENTER AVE 49FT W + 28FT S C/L INT	BG	27
SN DIMAS (1970)	888.928	USC+GS DISC IN CULV HDWL 42FT S C/L GLADSTONE ST 25FT E C/L SFRR MKD (C96 1931)	BG	29
SN DIMAS (1970)	928.004	L+N SE COR OF CONC BASE TRANSMISSION TOWER NO 235 D7 60FT W C/L AMELIA AVE	BG	32
SN DIMAS (1970)	998.282	DISC IN CONC POST 20FT E C/L SAN DIMAS AVE + 200FT N C/L BASE LINE RD MKD (Y35 1923 RESET 1934)	BG	36
SN DIMAS (1970)	907.386	L+T IN CONC DR TO HSE @ NW COR COVINA BLVD + CATARACT AVE 132FT N + 35FT W C/L INT MKD (BM)	BG	45
SN DIMAS (1970)	673.289	L+T NR CTR CB RET @ SE COR GLENDORA AVE + COVINA BLVD 22FT S + 22FT E C/L INT	BG	51
SN DIMAS (1970)	597.652	L+T S CB N SERVICE RD ARROW HWY ON C/L PROD FAIRVALLEY AVE	BG	245
SN DIMAS (1970)	603.695	L+T S CB N SERVICE RD ARROW HWY ON C/L PROD OAKBANK DR	BG	246
SN DIMAS (1970)	655.543	RD MON IN WELL 8IN DN @ DR NR C/L INT ARROW HWY + GRAND AVE MKD (LA CO RD DEPT 1960)	BG	249
SN DIMAS (1970)	652.759	FC MON 2IN DN ON NE COR ARROW HWY + GRAND AVE 110FT N + 59FT E C/L INT MKD (88 RW6)	BG	250
SN DIMAS (1970)	679.854	L+T IN CONC WK TO HSE W/CONC BLOCK FENCE 66FT N C/L ARROW HWY 900FT W GLENDORA AVE MKD (BM)	BG	251
SN DIMAS (1970)	692.368	RDBM TAG S CB 1FT W BCR @ SW COR ARROW HWY + GLENDORA AVE 42FT S + 71FT W C/L INT	BG	253
SN DIMAS (1970)	695.395	RDBM TAG N CB 6FT W BCR @ NE COR ARROW HWY + GLENDORA AVE 42FT N + 61FT E C/L INT	BG	254
SN DIMAS (1970)	704.151	L+T IN E END OF CONC WK 53FT S C/L ARROW HWY FRONT OF HSE NO 20058	BG	255
SN DIMAS (1970)	730.888	RD MON IN WELL 8IN DN @ DR NR C/L INT BONNIE COVE AVE + ARROW HWY MKD (LA CO RD DEPT)	BG	257
SN DIMAS (1970)	752.071	L+T N CB 42FT N C/L ARROW HWY ON C/L PROD LYMAN AVE MKD (BM)	BG	260
SN DIMAS (1970)	751.668	RD MON IN WELL 8IN DN @ DR NR C/L INT ARROW HWY + LYMAN AVE MKD (LA CO RD DEPT 1960)	BG	261
SN DIMAS (1970)	771.980	L+T E SIDE OF DOOR OF BRICK BLDG 70FT N C/L ARROW HWY @ NE COR SUNFLOWER AVE	BG	262
SN DIMAS (1970)	769.751	RD MON IN WELL 8IN DN @ DR NR C/L INT ARROW HWY + SUNFLOWER AVE MKD (LA CO RD DEPT 1960)	BG	263

QUAD-YEAR	ELEV	DESCRIPTION (INCLUDE QUAD AND YEAR IN DESCRIPTION)	BM NUMBER
SN DIMAS (1970)	796.099	RDBM TAG IN N CB 42FT N C/L ARROW HWY + 1000FT W VALLEY CENTER AVE	BG 264
SN DIMAS (1970)	795.488	RDBM TAG IN S CB 42FT S C/L ARROW HWY + 1000FT W VALLEY CENTER AVE	BG 265
SN DIMAS (1970)	810.574	L+T IN S CB 42FT S C/L ARROW HWY + 68FT E C/L VALLEY CENTER AVE MKD (BM)	BG 267
SN DIMAS (1970)	839.525	RDBM TAG N CB 42FT N C/L ARROW HWY + 1000FT E VALLEY CENTER AVE	BG 269
SN DIMAS (1970)	859.724	RD MON IN WELL 8IN DN @ OR NR C/L INT ARROW HWY + LONE HILL AVE MKD (LA CO RD DEPT 1960)	BG 270
SN DIMAS (1970)	861.041	L+T IN S CB @ SW COR ARROW HWY + LONE HILL AVE 80FT W + 42FT S C/L INT MKD (BM)	BG 271
SN DIMAS (1970)	887.753	L+BN IN TOP OF 8IN STANDPIPE 78FT N C/L ARROW HWY 380FT W OF BC W OF AMELIA AVE	BG 272
SN DIMAS (1970)	890.733	L+T IN S CB ARROW HWY 42FT S C/L + 50FT W OF BC W OF AMELIA AVE MKD (BM)	BG 273
SN DIMAS (1970)	892.047	RDBM TAG 42FT N C/L ARROW HWY + 7FT W OF BC W OF AMELIA AVE	BG 274
SN DIMAS (1970)	613.526	L + T IN CONC BASE OF HI TENSION TOWER NO 23905 75FT N C/L GLADSTONE ST + 50FT W C/L BIG DALTON WASH	BG 1125
SN DIMAS (1970)	634.006	LACS MON IN WELL 10IN DN ON C/L GLADSTONE ST 197FT W C/L SODERBERG AVE (MKD GLENDORA 11A)	BG 1129
SN DIMAS (1970)	637.810	L+T CTR CB RET @ NW COR SODERBERG AVE + GLADSTONE ST	BG 1130
SN DIMAS (1970)	666.300	L+SPK S CB DAWSON AVE 10FT E BCR @ SE COR GRAND AVE 20FT S + 76FT E C/L INT MKD (SD 301)	BG 1137
SN DIMAS (1970)	663.853	L+BN CONC BASE OF SE LEG OF HIGH TENSION TOWER NO 238 D6 130FT N BIG DALTON WASH + 70FT W C/L GRAND AVE	BG 1139
SN DIMAS (1970)	686.544	L+T S EDGE CONC WK TO HSE NO 6159 65FT W C/L GRAND AVE @ SW COR MAUNA LOA AVE	BG 1143
SN DIMAS (1970)	689.426	L+SPK S CB MAUNA LOA AVE 5FT E BCR @ SE COR GRAND AVE 18FT S + 83FT E C/L INT	BG 1145
SN DIMAS (1970)	701.643	L+T W END OF GAS STA ISL 65FT S C/L ALOSTA AVE + 70FT E C/L GRAND AVE	BG 1147
SN DIMAS (1970)	711.127	L+T 1FT S BCR @ SW COR SERVICE RD 48FT S C/L HEBER ST + 81FT W C/L GRAND AVE	BG 1150
SN DIMAS (1970)	716.951	L+T 1FT S BCR @ SW COR GRAND AVE SERVICE RD + LOCHLEVEN ST	BG 1151
SN DIMAS (1970)	692.994	L+T E CB WILDWOOD AVE 47FT S C/L FOOTHILL BLVD	BG 1158
SN DIMAS (1970)	687.387	L+T E CB CALIFORNIA AVE 55FT S C/L FOOTHILL BLVD	BG 1159
SN DIMAS (1970)	676.487	LACS MON @ C/L INT BARRANCA AVE + FOOTHILL BLVD	BG 1162

QUAD-YEAR	ELEV	DESCRIPTION (INCLUDE QUAD AND YEAR IN DESCRIPTION)	BM	NUMBER
BASELINE (1965)	655.439	CS MON @ C/L INT FOOTHILL BLVD TO E + CITRUS AVE S	BG	1168
BASELINE (1965)	655.924	L+T E WALL OF DRAIN 30FT N C/L FOOTHILL BLVD TO E 17FT W C/L PROD CITRUS AVE 25FT N DR TO HSE NO 6843	BG	1169
BASELINE (1965)	626.216	FC BR CAP W RET WALL 75FT N LITTLE DALTON WASH + 18FT W C/L CITRUS AVE	BG	1173
BASELINE (1965)	616.107	L+BN N CB ALOSTA AVE 33FT W BCR @ NW COR CITRUS AVE 100FT W + 40FT N C/L INT	BG	1175
BASELINE (1965)	616.544	L+SPK E CB CITRUS AVE 10FT S BCR @ SE COR ALOSTA AVE 30FT E + 104FT S C/L INT	BG	1176
BASELINE (1965)	609.285	RDBM TAG N CB MAUNA LOA AVE 6FT E BCR @ NE COR CITRUS AVE 18FT N + 72FT E C/L INT	BG	1178
BASELINE (1965)	591.704	L+BRAD S CB NEARFIELD ST 1FT E BCR @ SE COR CITRUS AVE 64FT E + 18FT S C/L INT	BG	1185
BASELINE (1965)	578.138	C S MON @ C/L CITRUS AVE 20FT S C/L ARROW HWY MKD (SEC COR 2 1 11 12 TIS R10W)	BG	1426
BASELINE (1965)	580.676	L+T SIDE CONC BASE OF LIGHT STANDARD 50FT N C/L ARROW HWY + 54FT E C/L CITRUS AVE	BG	1427
SN DIMAS (1970)	597.050	L+BN CTR CB RET @ SE COR FAIRVALLEY AVE + ARROW HWY SERV RD	BG	1428
BASELINE (1965)	1150.126	CS MON SE COR WHITE AVE + FOOTHILL BLVD 15FT E + 51FT S C/L INT	BG	1460
BASELINE (1965)	785.441	BRONZE DISK IN CTR OF CONC ABUT OF SPRR CULV 8FT N OF TRACKS 250FT W INT VERNON AVE + GANESHA AVE	BG	1469
SN DIMAS (1970)	1048.743	L + BN 60FT S BCR 100FT S + 20FT E C/L INT DAMIEN AVE + JUANITA AVE	BG	1497
SN DIMAS (1970)	1033.056	CS MON IN WELL 9IN DN 8FT N OF N CB PROD BONITA AVE + 31FT E OF E CB PROD GLENFIELD AVE MKD (BM 13-14 1952 RE63)	BG	1498
SN DIMAS (1970)	1061.073	L + BR 1FT N BCR 58FT N + 16FT W C/L INT DAMIEN AVE + JUANITA AVE	BG	1500
SN DIMAS (1970)	1071.717	L+BN W CB GRAND AVE 15FT W C/L + 55FT S C/L GLADSTONE ST	BG	1501
SN DIMAS (1970)	1072.286	CS MON IN WELL @ C/L INT GLADSTONE ST + GRAND AVE	BG	1502
SN DIMAS (1970)	1095.429	L + BN IN CONC SLAB @ SE COR OF BARN 35FT W C/L DAMIEN AVE + 1000FT N GLADSTONE AVE	BG	1503
SN DIMAS (1970)	1096.774	L + T IN CONC WALK 50FT E C/L DAMIEN AVE + 1000FT N GLADSTONE AVE NR S DRIVEWAY HSE NO 906	BG	1504
SN DIMAS (1970)	658.932	L+BN 1FT N OF SE COR OF CB AROUND OAKDALE CEMETERY 33FT N + 36FT W C/L INT GRAND AVE + JUANITA AVE	BG	1509
SN DIMAS (1970)	657.360	L+BN IN E CB 3FT S BCR 58FT S + 40FT E C/L INT GRAND AVE + FLEETWOOD PL	BG	1512
SN DIMAS (1970)	623.285	NAIL IN CHIS (X) N CB HURST ST 18FT N C/L + 80FT W C/L GRAND AVE	BG	1519

QUAD-YEAR	ELEV	DESCRIPTION (INCLUDE QUAD AND YEAR IN DESCRIPTION)	BM NUMBER
SN DIMAS (1970)	951.963	CS MON IN WELL @ C/L INT OF BONITA AVE + SAN DIMAS AVE	BG 1523
SN DIMAS (1970)	921.022	L+BN W CB CATARACT AVE 20FT W C/L + 185FT N C/L ARROW HWY	BG 1526
SN DIMAS (1970)	679.465	CS MON IN WELL 15IN DN @ C/L INT BADILLO ST + REEDER ST (USE NE COR)	BG 1546
SN DIMAS (1970)	680.260	RDBM TAG IN W CB 2FT N BCR @ NW COR REEDER ST + BADILLO ST 18FT W + 51FT N C/L INT	BG 1547
SN DIMAS (1970)	699.512	L+T ON N EDGE OF CONC DR TO HSE NO 4040 LYMAN AVE 30FT E C/L + 275FT N OF BC	BG 1549
SN DIMAS (1970)	704.291	RDBM TAG IN N CB 1FT W BCR @ NW COR RUDDOCK ST + LYMAN AVE 73FT N + 60FT W C/L INT	BG 1551
SN DIMAS (1970)	752.522	CS MON IN WELL 12IN DN @ C/L INT BADILLO ST + CYPRESS AVE MKD (COVINA H1A)	BG 1554
SN DIMAS (1970)	754.881	CS MON IN WELL @ C/L INT CYPRESS AVE + VALLEY CENTER AVE	BG 1556
SN DIMAS (1970)	756.424	RDBM TAG IN CONC GUARD CORNER @ NW CYPRESS AVE + VALLEY CENTER AVE 19FT N + 16FT W C/L INT	BG 1557
SN DIMAS (1970)	782.573	CS MON IN WELL 7IN DN @ C/L INT COVINA BLVD + VALLEY CENTER AVE	BG 1558
SN DIMAS (1970)	764.279	L+BN IN CONC WINGWALL W SIDE FC CHANNEL 23FT S C/L CYPRESS AVE 1180FT E C/L VALLEY CENTER AVE	BG 1861
SN DIMAS (1970)	780.439	L+BN IN S CB 18FT S C/L CYPRESS AVE 4FT W BCR OF DR TO HSE NO 1210 + 820FT W C/L LONE HILL AVE	BG 1863
SN DIMAS (1970)	795.733	CS MON IN WELL @ C/L INT CYPRESS AVE + LONE HILL AVE	BG 1865
SN DIMAS (1970)	825.800	L+BN N SIDE CONC UNDERGROUND STORAGE TANK 32FT S C/L CYPRESS AVE + 1290FT E LONE HILL AVE	BG 1868
SN DIMAS (1970)	851.038	CS MON IN WELL @ C/L INT CYPRESS AVE + AMELIA AVE	BG 1870
SN DIMAS (1970)	852.413	L+SPK IN CONC WK TO HSE NO 800 AMELIA AVE 17FT E C/L + 3FT N C/L PROD CYPRESS AVE	BG 1871
SN DIMAS (1970)	1015.641	STD BRONZE DISC IN CONC BRIDGE OVER SAN DIMAS WASH 0.2 MI E C/L SAN DIMAS AVE + 30FT N C/L FOOTHILL BLVD MKD (METROPOLITAN 51W)	BG 1934
SN DIMAS (1970)	1013.640	FC TAG IN E WINGWALL SAN DIMAS WASH 34FT S C/L FOOTHILL BLVD + 0.2MI E C/L SAN DIMAS AVE	BG 1935
SN DIMAS (1970)	1016.568	L+T IN CONC GUTTER OF ROCK RET WL NE COR SAN DIMAS AVE + FOOTHILL BLVD 60FT N + 50FT E C/L INT MKD (BM)	BG 1936
SN DIMAS (1970)	1010.842	CS MON IN WELL 10IN DN NR C/L INT SAN DIMAS AVE + GLADSTONE AVE MKD (RE 329)	BG 1939
SN DIMAS (1970)	970.973	L+BN W CB 7FT N BCR @ NW COR SAN DIMAS AVE + 4TH ST 35FT N + 25FT W C/L INT MKD (LV 45)	BG 1941
SN DIMAS (1970)	970.145	CS MON IN WELL 10IN DN @ C/L INT SAN DIMAS AVE + 4TH ST MKD (C S MON)	BG 1942

QUAD-YEAR	ELEV	DESCRIPTION (INCLUDE QUAD AND YEAR IN DESCRIPTION)	BM NUMBER
SN DIMAS (1970)	953.051	SQ HD SPK E CB 12FT N BCR @ NE COR SAN DIMAS AVE + BONITA AVE 50FT N + 25FT E C/L INT MKD (SD 202)	BG 1943
SN DIMAS (1970)	923.151	CS MON IN WELL 8IN DN @ PI SAN DIMAS AVE 0.55MI S ARROW HWY MKD (RE 58 69)	BG 1946
SN DIMAS (1970)	944.591	CS MON IN WELL 6IN DN NR INT CANNON AVE + PUDDINGSTONE DR 0.65MI S ARROW HWY ON SAN DIMAS AVE MKD (RE 5869)	BG 1947
SN DIMAS (1970)	945.841	L+T N END CONC HDWL 20FT E C/L CANNON AVE 80FT E C/L SAN DIMAS AVE NR INT PUDDINGSTONE DR 0.65 MI S ARROW HWY ON SAN DIMAS AVE MKD (BM)	BG 1948
SN DIMAS (1970)	982.060	RDBM TAG CONC FTG OF E GATE TO BOAT LAUNCHING AREA 44FT S C/L + 1.2MI S ARROW HWY	BG 1949
SN DIMAS (1970)	981.475	RDBM TAG CONC FTG OF W GATE TO BOAT LAUNCHING AREA 35FT S C/L + 1.2MI S ARROW HWY	BG 1950
SN DIMAS (1970)	1057.227	L+T ON TOP OF ROCK WL NR INLET PIPE 20FT N C/L SAN DIMAS AVE + 2.3MI S ARROW HWY MKD (BM)	BG 1953
SN DIMAS (1970)	1057.726	L+T IN CONC FL ROCK INLET TO PIPE 3FT E OF ENT 20FT N APPROX C/L SAN DIMAS AVE + 2.3MI S ARROW HWY	BG 1954
SN DIMAS (1970)	1112.896	RD MON IN WELL 8IN DN NR ANG PT WIRE FENCE 100FT S BC + 50FT W C/L SAN DIMAS + 2.7MI S ARROW HWY (2IN IP 2FT W OF MON 3FT UP)	BG 1955
SN DIMAS (1970)	1115.124	RD MON IN WELL 8IN DN NR EXIT OF CUT 45FT FROM EC 30FT N C/L SAN DIMAS AVE + 2.7MI S ARROW HWY (2IN IP 2FT N OF MON 3FT UP)	BG 1956
SN DIMAS (1970)	892.762	RD MON IN WELL 4IN DN 36FT E C/L SAN DIMAS AVE 3FT S EC + 3.3MI S ARROW HWY (2IN IP 2FT E OF MON 3FT UP)	BG 1957
SN DIMAS (1970)	889.466	RDBM TAG IN CONC WATER TROUGH 45FT E C/L SAN DIMAS AVE 66FT S BC + 3.3MI S ARROW HWY	BG 1958
BASELINE (1965)	787.505	RDBM TAG N END ABUT BRIDGE NO 53-872 OVER SAN BERNARDINO FRWY 15FT W C/L SAN DIMAS AVE	BG 1959
BASELINE (1965)	786.503	RDBM TAG S END ABUT BRIDGE NO 53-872 OVER SAN BERNARDINO FRWY 15FT E C/L SAN DIMAS AVE	BG 1960
BASELINE (1965)	768.342	CS MON IN WELL 11IN DN @ C/L ROSECRANS ST 130FT SE C/L HOLT AVE MKD (BM 17-21 1952)	BG 1961
SN DIMAS (1970)	1016.585	CS MON IN WELL 10IN DN @ C/L INT GLADSTONE ST + CATARACT AVE MKD (RE 329)	BG 1963
SN DIMAS (1970)	1018.453	L+T IN CONC APRON OF DR N SIDE GLADSTONE ST 16FT N C/L + 65FT W C/L CATARACT AVE MKD (BM)	BG 1964
SN DIMAS (1970)	1018.321	CS MON IN WELL 8IN DN C/L INT GLADSTONE ST + PROP ACACIA ST MKD (CO SUR RE 63)	BG 1965
SN DIMAS (1970)	1011.744	CS MON IN WELL 8IN DN C/L INT GLADSTONE ST + PROP EUCLA AVE MKD (CO SUR RE 63)	BG 1966
SN DIMAS (1970)	912.298	CS MON IN WELL 10IN DN 10FT S + 10FT W C/L INT GLADSTONE ST + AMELIA AVE MKD (BM 11 42 1952 RE 63)	BG 1967

QUAD-YEAR	ELEV	DESCRIPTION (INCLUDE QUAD AND YEAR IN DESCRIPTION)	BM NUMBER
SN DIMAS (1970)	912.986	L+T N CB S SERV ISL 2FT W BCR @ SW COR GLADSTONE ST + PEARLANNA DR 35FT S + 30FT W C/L INT (AMELIA AVE)	BG 1968
SN DIMAS (1970)	901.546	L+N S CB GLADSTONE ST ON C/L PROD GRAVETON AVE 28FT S C/L INT	BG 1969
SN DIMAS (1970)	900.979	L+T N CB SERV RD IN BCR @ NW COR GLADSTONE ST + GRAVETON AVE 46FT W + 70FT N C/L INT	BG 1970
SN DIMAS (1970)	884.867	RDBM TAG S CB 28FT S C/L GLADSTONE ST 151FT W C/L SANTA FE RR TRACK NR E END OF CATCH BASIN	BG 1971
SN DIMAS (1970)	872.419	CS MON IN WELL 8IN DN NR C/L INT LONE HILL AVE + GLADSTONE ST MKD (CO SUR RE 63)	BG 1972
SN DIMAS (1970)	853.053	RDBM TAG S CB 28FT S C/L GLADSTONE ST 0.2MI W LONE HILL AVE 15FT E OF END OF BLOCK FENCE	BG 1973
SN DIMAS (1970)	829.152	CS MON IN WELL 10IN DN @ ANGLE PT NR C/L INT VALLEY CENTER AVE + GLADSTONE ST MKD (RESET 1957 TRIANG GLENDORA H-11)	BG 1974
SN DIMAS (1970)	776.240	LACS MON IN WELL 8IN DN ON C/L GLADSTONE ST + 300FT E LYMAN AVE (MKD CO SUR RE 63)	BG 1977
SN DIMAS (1970)	732.047	L+B E CB LFT S BCR @ SE COR GLADSTONE ST + CONCORD LANE 60FT S + 18FT E C/L INT	BG 1980
SN DIMAS (1970)	730.537	LS TAG NO 2723 2FT W BCR 24FT S + 55FT W C/L INT GLADSTONE ST + CONCORD LN	BG 1981
SN DIMAS (1970)	619.436	LACS MON IN WELL 10IN DN @ C/L INT BARRANCA AVE + GLADSTONE ST (MKD GLENDORA C-11 1956)	BG 1984
SN DIMAS (1970)	612.128	FC BR CAP FLUSH 42FT N C/L GLADSTONE ST + 60FT W C/L BIG DALTON CHANNEL BRIDGE NO B1242 MKD (81-RW-215)	BG 1985
SN DIMAS (1970)	906.346	L+T CONC DR TO HSE @ NW COR COVINA BLVD + CATARACT AVE 70FT N + 27FT W C/L INT MKD (BM)	BG 1986
SN DIMAS (1970)	846.700	CS MON IN WELL 13IN DN NR C/L INT COVINA BLVD + AMELIA AVE MKD (RE 329)	BG 1989
SN DIMAS (1970)	688.392	L+BRAD E CB 9FT N BCR @ NE COR COVINA BLVD + MANGROVE AVE 55FT N + 18FT E C/L INT	BG 2000
SN DIMAS (1970)	687.588	L+BRAD N CB SERV ISL 8FT W BCR @ NW COR MANGROVE AVE + COVINA BLVD 77FT W + 30FT N C/L INT	BG 2001
SN DIMAS (1970)	671.322	CS MON IN WELL 8IN DN @ C/L INT COVINA BLVD + GLENDORA AVE MKD (E-1RE 63)	BG 2002
SN DIMAS (1970)	655.413	RDBM TAG E END OF CUL-DE-SAC OF SERV RD N SIDE COVINA BLVD 49FT N C/L + 1200 FT W GLENDORA AVE	BG 2003
SN DIMAS (1970)	654.561	RDBM TAG S CB COVINA BLVD 30FT S C/L + 1250FT W GLENDORA AVE NEAR CUL-DE-SAC ON N SIDE OF BLVD	BG 2004
SN DIMAS (1970)	617.568	L+BRAD N CB COVINA BLVD 40FT N C/L ON C/L PROD STARCREST DR	BG 2005
SN DIMAS (1970)	616.782	L+BRAD W CB 6FT S BCR @ SW COR COVINA BLVD + STARCREST DR 73FT S + 18FT W C/L INT	BG 2006
SN DIMAS (1970)	601.810	L+T 1FT E BCR @ NE COR COVINA BLVD + BARRANCA AVE 67 FT E + 30FT N C/L INT	BG 2007

QUAD-YEAR	ELEV	DESCRIPTION (INCLUDE QUAD AND YEAR IN DESCRIPTION)	BM NUMBER
SN DIMAS (1970)	601.781	LACS MON FL 6IN BACK CB IN CBR 55FT N + 33FT E C/L INT COVINA BLVD + BARRANCA AVE (MKD RM NO 1)	BG 2008
SN DIMAS (1970)	585.740	L+T E CB 7FT N BCR @ COR COVINA BLVD + FAIRVALLEY AVE 71FT N + 18FT E C/L INT	BG 2009
SN DIMAS (1970)	584.396	L+N N CB COVINA BLVD (S CB OF ISLAND) 6FT W BCR 32FT N C/L 40FT W C/L FAIRVALLEY AVE	BG 2010
SN DIMAS (1970)	642.549	RDBM TAG W CB ASHTON DR 1FT S BCR @ SW COR BADILLO ST 18FT W + 55FT S C/L INT	BG 2015
SN DIMAS (1970)	642.978	RDBM TAG E CB ASHTON DR 1FT S BCR @ SE COR BADILLO ST 18FT E + 55FT S C/L INT	BG 2016
SN DIMAS (1970)	663.149	RDBM TAG IN CB BADILLO ST 1FT E BCR @ NW COR DARFIELD AVE 20FT N + 44FT W C/L INT	BG 2017
SN DIMAS (1970)	664.641	RDBM TAG N CB BADILLO ST 2FT E BCR @ NE COR DARFIELD AVE 20FT N + 48FT E C/L INT	BG 2018
SN DIMAS (1970)	718.254	CS MON IN WELL @ C/L INT LYMAN AVE + CYPRESS ST	BG 2019
SN DIMAS (1970)	717.750	L+T S CB CYPRESS ST @ BCR SW COR LYMAN AVE 55FT W + 28FT S C/L INT	BG 2020
BASELINE (1965)	584.582	FC MON IN SW WINGWALL OF BRIDGE B1237 ON CITRUS AVE OVER BIG DALTON WASH 37FT W C/L MKD (BM 81-39)	BG 2021
BASELINE (1965)	585.045	L+BRAD E CB CITRUS AVE @ NE END OF BRIDGE B1237 OVER BIG DALTON WASH 30FT E C/L	BG 2022
BASELINE (1965)	572.286	L+SPK W CB 40FT W C/L CITRUS AVE + 57FT N OF N END BRIDGE B1228 OVER SAN DIMAS WASH	BG 2024
SN DIMAS (1970)	739.765	CS MON IN WELL 8IN DN NR C/L INT BONNIE COVE AVE + JUANITA AVE MKD (RE 63)	BG 2025
SN DIMAS (1970)	740.955	L+T W CB 1FT S BCR @ SW COR BONNIE COVE AVE + JUANITA AVE 35FT S + 20FT W C/L INT	BG 2026
SN DIMAS (1970)	721.664	L+T N CB 1FT E BCR @ NE COR BONNIE COVE AVE + CIENEGA AVE 30FT N + 58FT E C/L INT	BG 2027
SN DIMAS (1970)	694.743	T+T IN WELL 16IN DN C/L INT BONNIE COVE AVE + CYPRESS ST	BG 2030
SN DIMAS (1970)	822.779	L+T S CB 2FT E BCR @ SE COR VALLEY CENTER AVE + JUANITA AVE 36FT E + 20FT S C/L INT MKD (CSBM)	BG 2031
SN DIMAS (1970)	821.257	L+T S CB 3FT W BCR @ SW COR VALLEY CENTER AVE + JUANITA AVE 37FT W + 20FT S C/L INT	BG 2032
SN DIMAS (1970)	792.133	CS MON IN WELL 8IN DN C/L INT VALLEY CENTER AVE + CIENEGA AVE MKD (RE 63)	BG 2033
SN DIMAS (1970)	791.515	RDBM TAG E CB VALLEY CENTER AVE 32FT E C/L + 190FT S C/L CIENEGA AVE NR ENT CATCH BASIN	BG 2034
SN DIMAS (1970)	895.589	RDBM TAG W CB 1FT N BCR @ NW COR EUCLA AVE + ARROW HWY 77FT N + 20FT W C/L INT	BG 2035
SN DIMAS (1970)	896.349	RDBM TAG E CB 1FT N BCR @ NE COR EUCLA AVE + ARROW HWY 80FT N + 20FT E C/L INT	BG 2036
SN DIMAS (1970)	884.366	CS MON IN WELL 15IN DN NR C/L INT AMELIA AVE + CIENEGA AVE (USE N EDGE)	BG 2038

QUAD-YEAR	ELEV	DESCRIPTION (INCLUDE QUAD AND YEAR IN DESCRIPTION)	BM NUMBER
SN DIMAS (1970)	945.845	RDBM TAG CONC HDWL @ SE COR 5TH ST + AMELIA AVE 105FT E + 12FT S C/L INT	BG 2039
SN DIMAS (1970)	944.627	CS MON IN WELL 12IN DN NR C/L INT 5TH ST + AMELIA AVE (USE S EDGE) MKD (RE 329)	BG 2040
SN DIMAS (1970)	925.104	CS MON IN WELL 8IN DN NR C/L INT AMELIA AVE + ALLEN AVE MKD (RE 63)	BG 2041
SN DIMAS (1970)	954.451	RDBM TAG E CB 1FT N BCR @ SE COR AMELIA AVE + FOOTHILL BLVD 88FT S + 20FT E C/L INT	BG 2043
BASELINE (1965)	798.270	LACS MON IN WELL 13IN DN ON C/L 2ND ST IN MED ISL 2.5FT W/O END 310FT E C/L INT 2ND ST + HWY NO 71 MKD BM 11-85	BG 2076
SN DIMAS (1970)	1160.174	LACS MON IN WELL 10IN DN 10FT S + 10FT W C/L INT WHEELER AVE + BASELINE RD (MKD BM 11-52)	BG 2129
SN DIMAS (1970)	1231.314	LACS MON FL 1FT W CB 47FT N + 31FT W C/L INT WHEELER AVE + ALDERGATE DR (MKD 53-1)	BG 2130
SN DIMAS (1970)	1296.955	LACS MON @ SW P/COR L A CO FIRE STA NO 104 36FT N C/L WHEELER AVE + 258FT W OVERHOLTZER DR	BG 2133
SN DIMAS (1970)	1323.749	LACS MON IN WELL 10IN DN ON C/L WHEELER AVE 197FT S LA MESA DR	BG 2134
SN DIMAS (1970)	1407.341	LACS MON IN WELL 8IN DN @ C/L INT WHEELER AVE + GOLDEN HILLS RD (MKD 5869)	BG 2135
SN DIMAS (1970)	1257.948	RND HD SPK IN IP IN WELL 15IN DN ON C/L GOLDEN HILLS RD 36FT E SAN DIMAS CYN RD	BG 2137
SN DIMAS (1970)	1255.568	USGS MON FL IN WALL OF GAGING STA 60FT N + 24FT W C/L INT SAN DIMAS CYN RD + GOLDEN HILLS RD (MKD GAGING STA)	BG 2138
SN DIMAS (1970)	1171.807	L+N IN S CONC FOOTING OF STEEL TOWER NO 233 D2 50FT W SAN DIMAS CYN RD + 0.25MI N TERREBONNE AV	BG 2139
SN DIMAS (1970)	1106.771	LAFC MON 2IN DN 143FT S LY + 60FT E LY C/L INT SAN DIMAS CYN RD + FERNRIDGE DR ON FENCE LINE (MKD 88 RW 183)	BG 2141
SN DIMAS (1970)	1113.753	USC+GS MON 1IN UP @ NE COR BASE LINE RD 100FT NE FOOTHILL BLVD + 1FT WLY STONE WALL MKD (USC+GS GARRETT 1929)	BG 2144
SN DIMAS (1970)	1162.425	CS MON IN WELL 5FT W C/L EMERALD AVE + 5FT S C/L BASELINE RD MKD (BM 11-54 1952 RE 63)	BG 2146
BASELINE (1965)	1171.061	CS MON IN WELL 8FT W C/L FRUIT ST + 100FT S C/L BASE LINE RD MKD (BM 13-11 1952 RE 63)	BG 2149
SN DIMAS (1970)	1030.633	CONC NAIL S CB ARROW HWY (PALOMARES AVE) 15FT E DR TO HSE NO 1742 17FT S C/L	BG 2179
SN DIMAS (1970)	1035.497	L+BN IN SW COR CONC RR SIGNAL BASE ON S SIDE AT+SF RR 120FT E C/L PARK AVE PROD	BG 2180
BASELINE (1965)	1081.911	CS MON IN WELL 2FT N OF N CB 7TH ST 17FT W BCR @ SW COR WHITE AVE 18FT N + 43FT W C/L INT	BG 2182
BASELINE (1965)	1063.917	L+BN W CB WHITE AVE 10FT S BCR @ SW COR BONITA AVE 25FT W + 71FT S C/L INT	BG 2183
SN DIMAS (1970)	1047.909	L+BN S CB 3RD ST 5FT E BCR @ SE COR AVE D 28FT S + 55FT E C/L INT	BG 2196

QUAD-YEAR	ELEV	D E S C R I P T I O N (INCLUDE QUAD AND YEAR IN DESCRIPTION)	BM	NUMBER
SN DIMAS (1970)	1043.492	L+BN N CB BONITA AVE 2FT W BCR @ NW COR PARK AVE 26FT N + 57FT W C/L INT	BG	2198
BASELINE (1965)	563.803	CS MON 8IN DN ON SE COR CYPRESS AVE + CITRUS AVE 1FT BACK CB 40FT S + 31FT E C/L INT MKD (BM 17 3A)	BG	2430
BASELINE (1965)	580.218	RDBM TAG IN CB 1FT N BCR @ NE COR GRAND AVE + ROWLAND AVE 30FT N + 40FT E C/L INT	BG	2434
BASELINE (1965)	580.545	CS TAG IN CB 1FT S BCR @ NW COR GRAND AVE + ROWLAND AVE 45FT W + 55FT N C/L INT	BG	2435
SN DIMAS (1970)	731.729	L+T N CB 5FT W BCR 25FT N + 35FT W C/L INT GRAND AVE + BENNETT AVE	BG	2539
SN DIMAS (1970)	756.768	CS MON IN WELL 12IN DN N ONE OF TWO @ OR NR C/L INT GRAND AVE + LEADORA AVE MKD (CO ENG RE 5869)	BG	2540
SN DIMAS (1970)	760.176	L+T E CB 3FT N BCR 70FT N + 40FT E C/L INT GRAND AVE + LEADORA AVE	BG	2541
SN DIMAS (1970)	833.908	L+T N CB 40FT E BCR @ NE COR SIERRA MADRE AVE + PENNSYLVANIA AVE 27FT N + 55FT E C/L INT	BG	2544
SN DIMAS (1970)	832.529	L+T S CB 5FT E BCR @ SE COR SIERRA MADRE AVE + PENNSYLVANIA AVE 57FT E + 20FT S C/L INT	BG	2545
SN DIMAS (1970)	857.699	RDBM TAG W CB 1FT S FUTURE BCR @ SW COR VISTA BONITA AVE + SIERRA MADRE AVE 42FT S + 15FT W C/L INT	BG	2546
SN DIMAS (1970)	860.143	RAM SET E CB 1FT S FUTURE BCR @ SE COR VISTA BONITA AVE + SIERRA MADRE AVE 42FT S + 15FT E C/L INT	BG	2547
SN DIMAS (1970)	930.400	L+T IN CONC FTG OF 5FT LINK FENCE @ NW COR BANNA AVE + SIERRA MADRE AVE 40FT N + 24FT W C/L INT	BG	2548
SN DIMAS (1970)	930.227	L+T CONC SIDE RAIL OF 2ND STEP TO ENT OF HSE @ NE COR BANNA AVE + SIERRA MADRE AVE 16FT N + 13FT E C/L INT	BG	2549
SN DIMAS (1970)	935.747	CO ENG TAG W CB 25FT S OF BCR @ SW COR SIERRA MADRE AVE + LIVE OAK AVE 58FT S + 17FT W C/L INT	BG	2550
SN DIMAS (1970)	1022.928	CS MON IN WELL 10IN DN @ OR NR C/L INT LIVE OAK AVE + PALM DR MKD (R-9-W T-1-N 19-20-30-29)	BG	2553
SN DIMAS (1970)	1009.386	FC BR CAP MON IN N HDWL OF CHANNEL 30FT N C/L PALM DR + 1200FT E LIVE OAK AVE MKD (BM 85-67)	BG	2555
SN DIMAS (1970)	989.183	CS MON IN WELL 10IN DN @ C/L INT PALM DR + LORAIN AVE MKD (1/4 COR SEC 20-29)	BG	2556
SN DIMAS (1970)	988.768	L+T N EDGE CONC WLK TO HSE NO 7760 LORAIN AVE 37FT S + 26FT E C/L INT PALM DR + LORAIN AVE	BG	2557
SN DIMAS (1970)	953.275	RD HD SPK W CB 12FT S BCR 84FT S + 30FT W C/L INT LORAIN AVE + SIERRA MADRE AVE	BG	2558
SN DIMAS (1970)	955.860	L+T IN CONC DR TO HSE NO 1110 SIERRA MADRE AVE 1FT E OF W EDGE 114FT E + 61FT S C/L INT LORAIN AVE + SIERRA MADRE AVE	BG	2559
SN DIMAS (1970)	1002.820	L+T E SIDE SQ WEIR BOX 15FT S + 20FT W C/L INT GLEN DORA MT RD + SIERRA MADRE AVE	BG	2562

QUAD-YEAR	ELEV	DESCRIPTION (INCLUDE QUAD AND YEAR IN DESCRIPTION)	BM NUMBER
SN DIMAS (1970)	937.063	RDBM TAG E CB NR FIRE HYDT FRONT OF HSE NO 354 VALLEY CENTER AVE 1700FT S SIERRA MADRE AVE + 25FT E C/L	BG 2564
SN DIMAS (1970)	937.787	RDBM TAG E WALL OF CHANNEL IN FRONT OF HSE NO 354 VALLEY CENTER AVE 53FT W C/L + 1700FT S SIERRA MADRE AVE	BG 2565
SN DIMAS (1970)	901.926	RDBM TAG E CB @ S END CB IN FRONT OF HSE NO 170 N VALLEY CENTER AVE 18FT E C/L + 700FT N FOOTHILL BLVD	BG 2566
SN DIMAS (1970)	882.747	L+T N CB 1FT W BCR @ NE COR VALLEY CENTER AVE + FOOTHILL BLVD 30FT N + 58FT E C/L INT (NR CB)	BG 2567
SN DIMAS (1970)	882.039	CS MON IN WELL 12IN DN @ C/L INT FOOTHILL BLVD + VALLEY CENTER AVE MKD (CO SUR MON RE 63)	BG 2568
BASELINE (1965)	625.363	RD TAG IN E CB 30FT S BCR @ SE COR CITRUS AVE + FOOTHILL BLVD 80FT S + 40FT E C/L INT	BG 2652
BASELINE (1965)	625.439	CS MON NR C/L INT CITRUS AVE + FOOTHILL BLVD TO THE W	BG 2653
BASELINE (1965)	589.038	CSBM MON IN WINGWALL OF BRIDGE NO 1408 NE COR GRAND AVE + BADILLO ST 80FT N + 50FT E MKD (BM 17-8B 1963)	BG 2654
BASELINE (1965)	586.651	R D MON @ C/L INT GLADSTONE AVE + CITRUS AVE	BG 2655
BASELINE (1965)	570.698	COE BR CAP W CB 90FT N BCR + 140FT N + 40FT W C/L INT TUDOR ST + CITRUS AVE MKD (SD 6-1956)	BG 2658
BASELINE (1965)	565.441	CS TRI MON IN WELL 12IN DN @ OR NR C/L INT CITRUS AVE + COVINA BLVD MKD (COVINA BL 1957)	BG 2659
BASELINE (1965)	566.085	RD HD SPK IN W CB 67FT S BCR @ SW COR CITRUS AVE + COVINA BLVD 110FT S + 35FT W C/L INT MKD (BM NO 139)	BG 2660
BASELINE (1965)	560.759	USC+GS BR CAP S END CATCH BASIN 40FT E C/L CITRUS AVE 35FT S OF BENBOW ST MKD (K1149 1961)	BG 2661
BASELINE (1965)	553.637	RDBM TAG E CB 1FT N BCR @ NE COR SAN BERNARDINO RD + CITRUS AVE 27FT E + 44FT N C/L INT	BG 2663
BASELINE (1965)	552.851	RDBM TAG W CB 1FT S BCR @ SW COR SAN BERNARDINO RD + CITRUS AVE 27FT W + 37FT S C/L INT	BG 2664
BASELINE (1965)	541.653	CS TRI MON IN WELL 10IN DN @ OR NR C/L INT BADILLO ST + CITRUS AVE MKD (COVINA B2 1957)	BG 2665
BASELINE (1965)	587.546	RDBM TAG S CB 5FT W BCR @ SW COR GRAND AVE + BADILLO ST 40FT S + 74FT W C/L INT E END CATCH BASIN	BG 2667
BASELINE (1965)	521.982	COE BR MON IN CB OF ISLAND @ OAK CN RD 36FT S C/L COVINA HILLS RD MKD (W C 28 1957)	BG 2668
BASELINE (1965)	528.794	CS MON IN WELL 10IN DN 9FT SW + 12FT SE C/L INT COVINA HILLS RD + CHAPPARRO RD MKD (BM 17-11 1952)	BG 2669
BASELINE (1965)	635.682	CS MON 12IN WELL W/COVER 0.55MI E CHAPARRO RD + 8FT S C/L COVINA HILLS RD MKD (BM 17-12 1952 RE 63)	BG 2670

QUAD-YEAR	ELEV	DESCRIPTION (INCLUDE QUAD AND YEAR IN DESCRIPTION)	BM NUMBER
BASELINE (1965)	652.202	CS MON 12IN DN IN WELL W/COVER 20FT W + 10FT N C/L INT COVINA HILLS RD + HOLT AVE MKD (BM 17-13 1952 RE 63)	BG 2671
BASELINE (1965)	733.455	CS MON 12IN DN IN WELL W/COVER 0.4MI E C/L HOLT AVE + 8FT SE C/L COVINA HILLS RD MKD (BM 17-14 1952 RE 63)	BG 2672
BASELINE (1965)	865.999	LACS MON IN WELL 10IN DN @ C/L COVINA HILLS RD 0.25MI W LY VIA VERDE 25FT E LY DR TO HSE NO	BG 2673
BASELINE (1965)	865.667	CS MON IN WELL 10IN DN ON C/L PVMT COVINA HILLS RD NR C/O DR TO HSES NO 21542 + NO 21554 MKD (BM 17-16 1952)	BG 2674
BASELINE (1965)	774.886	COE BR MON FLUSH IN WINGWALL OF DRAIN TO SAN JOSE CR CHANNEL 36FT E C/L HOLT AVE + 100FT S BRIDGE NO 53-107 MKD (TS J 110 1960)	BG 2675
BASELINE (1965)	845.954	L+BN E CB WHITE AVE 1FT N BCR @ NE COR 2ND ST 61FT N + 42FT E C/L INT	BG 2787
BASELINE (1965)	858.274	CS MON IN WELL 7IN DN IN GUTTER @ SW COR HOLT AVE + WHITE AVE 36FT S + 55FT W C/L INT MKD (BM 13-1 1952)	BG 2788
BASELINE (1965)	884.652	CS MON 8IN DN @ SE COR WHITE AVE + ORANGE GROVE AVE 46FT E C/L WHITE AVE + 2FT S OF S CB LINE ORANGE GROVE AVE	BG 2789
BASELINE (1965)	947.575	CS MON IN LA CO FAIR GRDS 78FT ELY + 66FT SLY OF SELY COR MAIN EXHIBIT BLDG 25FT NLY OF ENTRANCE GATE	BG 2791
BASELINE (1965)	966.860	CS MON 10IN DN IN LA CO FAIR GRDS 88FT NLY FROM NELY COR MAIN EXHIBIT BLDG + 39FT WLY FROM FIRE HYDRANT	BG 2792
BASELINE (1965)	987.435	CS MON 7IN DN 40FT SWLY FROM NELY COR BARN NO 11 + 30FT SLY FROM 14IN COTTONWOOD TREE	BG 2793
BASELINE (1965)	1000.959	L+PK E CB WHITE AVE 12FT S OF S EDGE CONC APRON OF GATE 14 TO LA CO FAIR GRDS 0.4MI S ARROW HWY 40FT E C/L WHITE AVE	BG 2794
BASELINE (1965)	1064.711	L+BN S CB BONITA AVE 0.5FT W BCR @ SE COR WHITE AVE 37FT E @ 25FT S C/L INT	BG 2797
BASELINE (1965)	1102.349	L+BN E CB WHITE AVE 1FT S BCR @ SE COR KENDALL ST 50FT S + 40FT E C/L INT	BG 2798
BASELINE (1965)	1104.056	L+BN E CB WHITE AVE 1FT N BCR @ NE COR KENDALL ST 45FT N + 40FT E C/L INT	BG 2799
BASELINE (1965)	1135.736	BT SPK N CB FOOTHILL BLVD 0.8FT W BCR @ NW COR FRUIT ST 107FT W 61FT N C/L INT	BG 2800
BASELINE (1965)	1139.292	BT SPK W CB FOOTHILL BLVD 61FT N BCR @ NW COR FOOTHILL BLVD + FRUIT ST	BG 2801
BASELINE (1965)	1155.393	CS MON C/L FRUIT ST 1300FT N C/L FOOTHILL BLVD @ HSE NO 3835 MKD (RE 5869)	BG 2802
BASELINE (1965)	1160.789	CS MON 10IN DN @ C/L INT FRUIT ST + BOWDOIN ST MKD (RE 5869)	BG 2803
BASELINE (1965)	1173.755	CS MON 10IN DN @ C/L INT BASELINE RD + FRUIT ST	BG 2804

