

**COUNTY OF LOS ANGELES
ROAD DEPARTMENT**

**PRECISE
BENCH MARK LIST**



**LA MIRADA QUAD
NORWALK QUAD
SANTA FE QUAD**

1980 ADJUSTMENT

P R E F A C E
1980 Adjustment

The Road Department level net published in 1975 consisted of more than 1500 miles of levels supporting in excess of 18,000 bench marks. For reasons of economy, this 1980 adjustment is reduced to about 55% of the bench marks previously published. Reductions were made by increasing the spacing between level lines in unincorporated territory, and eliminating lines in non-contract cities and areas where the probability of future engineering projects appears slight. The 1980 adjustment is an update of the remainder of the 1975 bench marks, not including baselines. Data from previous adjustments is available without inferring any responsibility for the current reliability of the data or the actual existence of the bench marks. Elevations of bench marks with the same quad name, but different adjustment dates, are not normally compatible.

To facilitate the adjustment, indexing, and distribution of adjusted values of the net, the County territory is divided into 34 quads or areas. For identification purposes each quad is given a name, viz., "Rosemead," "La Mirada," "Santa Fe," etc. When bench marks and elevations in the Road Department net are used, the name of the quad in which the bench mark is located and the date of the elevation adjustment must be included in the bench mark description, e.g.,

CY 6901 - RDEM TAG S CB 11FT E BCR @ SE COR LA CIENEGA
BLVD & LENNOX BLVD 32FT S & 73FT E C/L INT
(HAWTHORNE - 1980) ELEV. 82.549

The precision of the net is reflected by an indicated field probable error of plus or minus 0.012 foot per mile of leveling as determined from over 300 conditions of closure. However, many years experience in vertical control in the greater Los Angeles basin and Antelope Valley indicate that because of varying degrees of subsidence and heaving, the true datum is recovered only by obtaining substantial agreement between a number of bench marks.

The users of this net are invited to assist in its maintenance by notifying this Department of cases of obliteration, apparent mistakes in descriptions or elevations, and proven disturbance of bench marks.

DATUM: U. S. Coast and Geodetic Survey Sea Level Datum
of 1929, through the medium of the Los Angeles
County Engineer Precise Level Net.

ABBREVIATIONS USED IN BENCH MARK LISTINGS

ABUT - - - - -	Abutment	EC - - - - -	End of Curve
ALG - - - - -	Along	ENT - - - - -	Entrance
ANG PT - - - - -	Angle Point	FL - - - - -	Floor
B/W - - - - -	Back of Walk	FTG - - - - -	Footing
BCR - - - - -	Beginning of Curb Return	FRWY - - - - -	Freeway
BC - - - - -	Beginning of Curve	F/W - - - - -	Front of Walk
BLDG - - - - -	Building	GAR - - - - -	Garage
EM - - - - -	Bench Mark	HDWL - - - - -	Headwall
BT SPK - - - - -	Boat or Bolt Spike	HSE - - - - -	House
BR CAP - - - - -	Brass or Bronze Cap	HWY - - - - -	Highway
C B - - - - -	Catch Basin	INT - - - - -	Intersection
CTR - - - - -	Center	IP - - - - -	Iron Pipe
C/L - - - - -	Center Line	LT - - - - -	Left
C/L INT - - - - -	Center Line Intersection	LACE - - - - -	L. A. City Engineer
C/L PROD - - - - -	Center Line Produced	LACS - - - - -	L. A. Co. Engineer
CONC - - - - -	Concrete	LAFC - - - - -	L. A. Co. Flood Control
COR - - - - -	Corner	L&BN - - - - -	Lead and Bench Nail
COE - - - - -	Corps of Engineers	L&BR - - - - -	Lead and Brad
CULV - - - - -	Culvert	L&N - - - - -	Lead and Nail
CYN - - - - -	Canyon	L&SPK - - - - -	Lead and Spike
CB - - - - -	Curb	L&T - - - - -	Lead and Tack
CS MON - - - - -	Co. Engineer Monument	MCR - - - - -	Middle of Curb Return
CT SPK - - - - -	Cut Spike	MKD - - - - -	Marked
DR - - - - -	Drive or Driveway	MC - - - - -	Middle of Curve
E/O - - - - -	East of	MON - - - - -	Monument
ECR - - - - -	End of Curb Return	N/O - - - - -	North of

ABBREVIATIONS USED IN BENCH MARK LISTINGS . . . CONTINUED

NR - - - - - Near
OPP - - - - - Opposite
PI - - - - - Point of Intersection
PK&W - - - - - FK Nail and Washer
P/L - - - - - Property Line
POST - - - - - Point on Semi-Tangent
PP - - - - - Power Pole
PVMT - - - - - Pavement
PROD - - - - - Produced
RD - - - - - Road
RDEM - - - - - Road Dept. Bench Mark
RDEM TAG - - - - Road Dept. Bench Mark Tag
RR - - - - - Railroad
RT - - - - - Right
R/W - - - - - Right of Way
SDMH - - - - - Storm Drain Manhole
SMH - - - - - Sewer Manhole
SPK - - - - - Spike
ST&W - - - - - Spike Tin and Washer
S/O - - - - - South of
TP - - - - - Telephone Pole
USC&GS - - - - - U. S. Coast and Geodetic Survey
USGS - - - - - U. S. Geological Survey
WK - - - - - Walk
W/O - - - - - West of

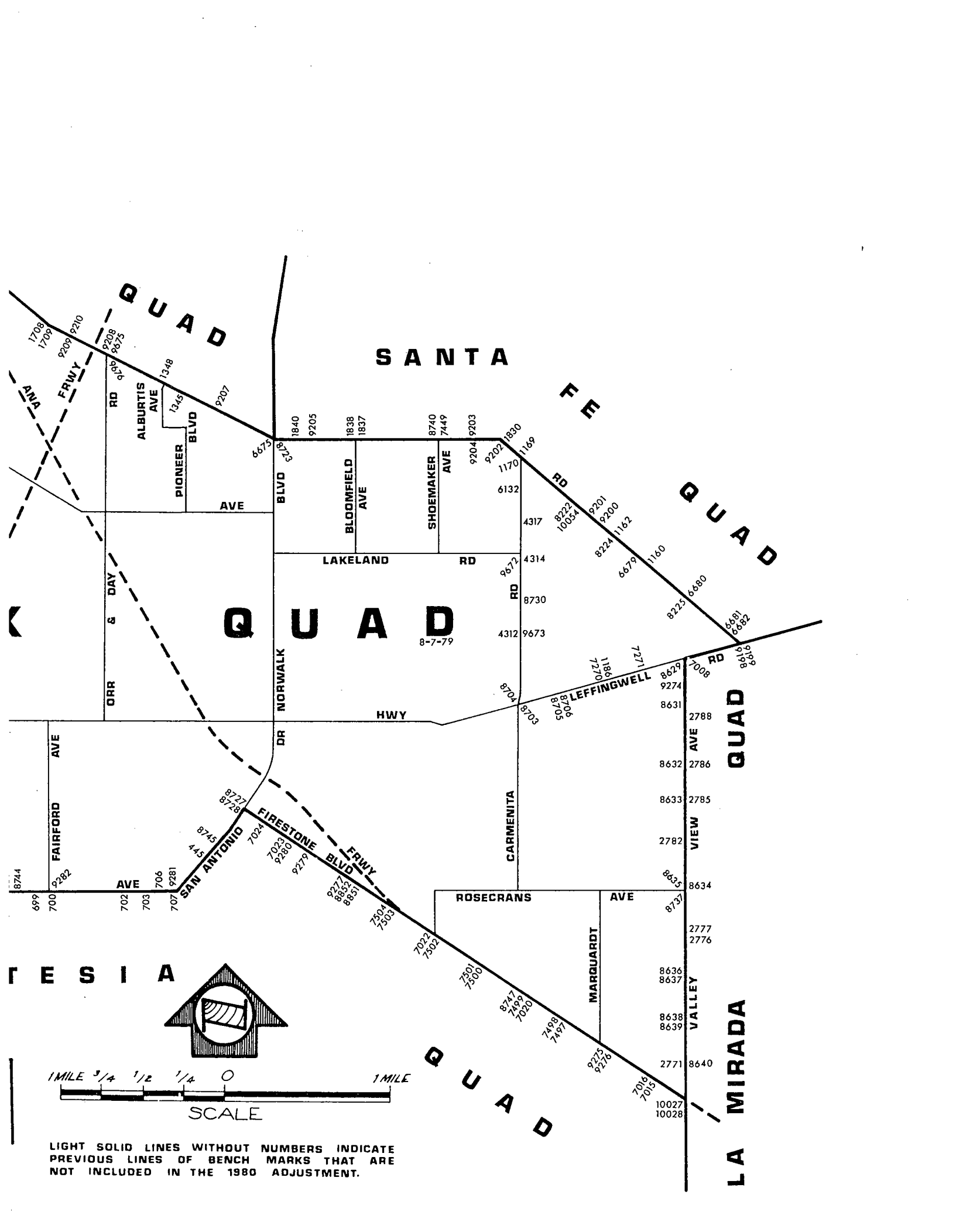

SANTA FE

QUAD

FE

QUAD

QUAD

QUAD

LA MIRADA

RESIA

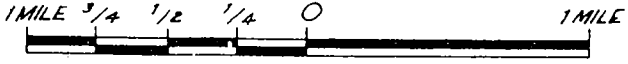
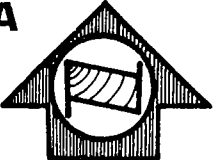

LIGHT SOLID LINES WITHOUT NUMBERS INDICATE PREVIOUS LINES OF BENCH MARKS THAT ARE NOT INCLUDED IN THE 1980 ADJUSTMENT.

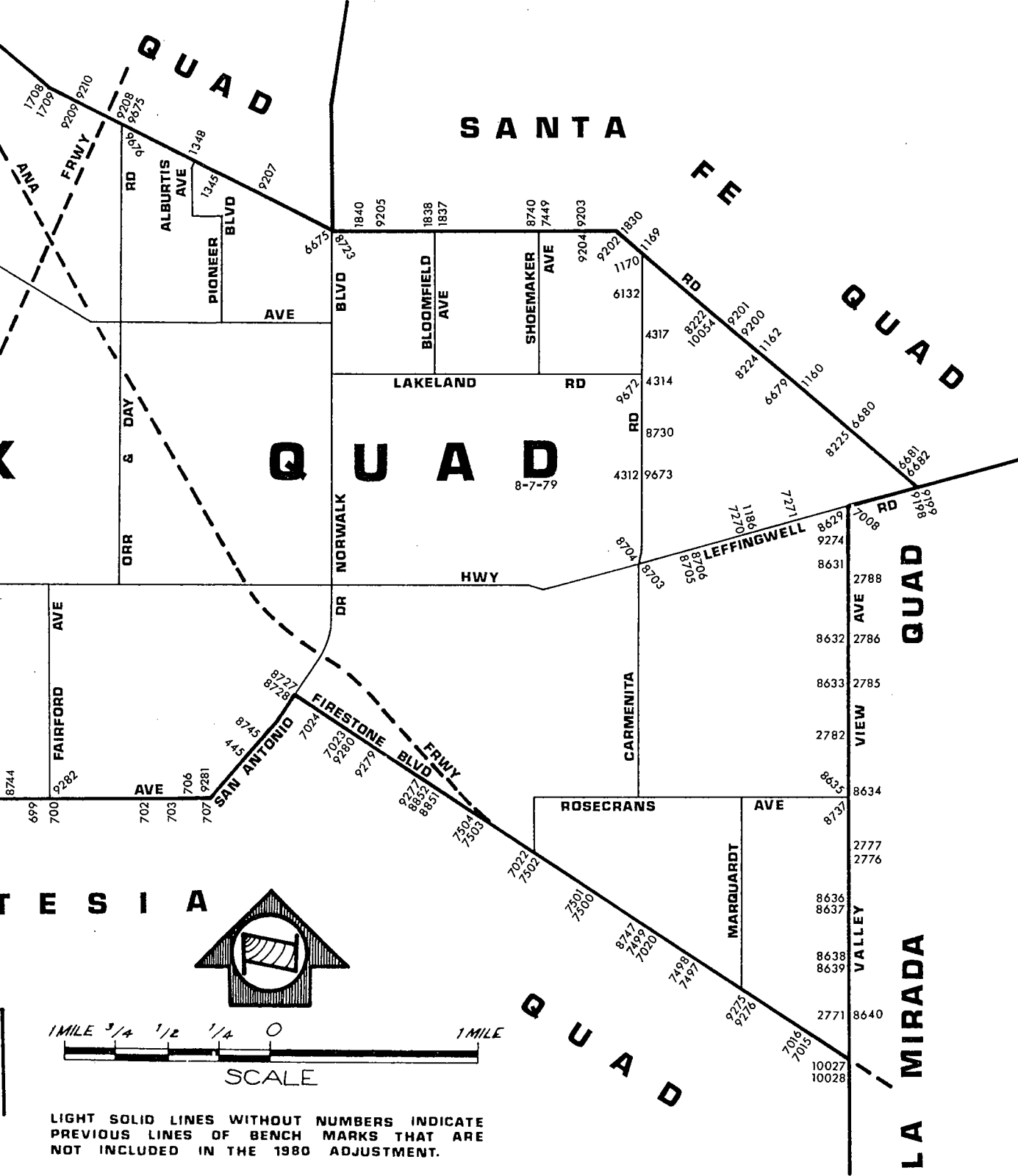

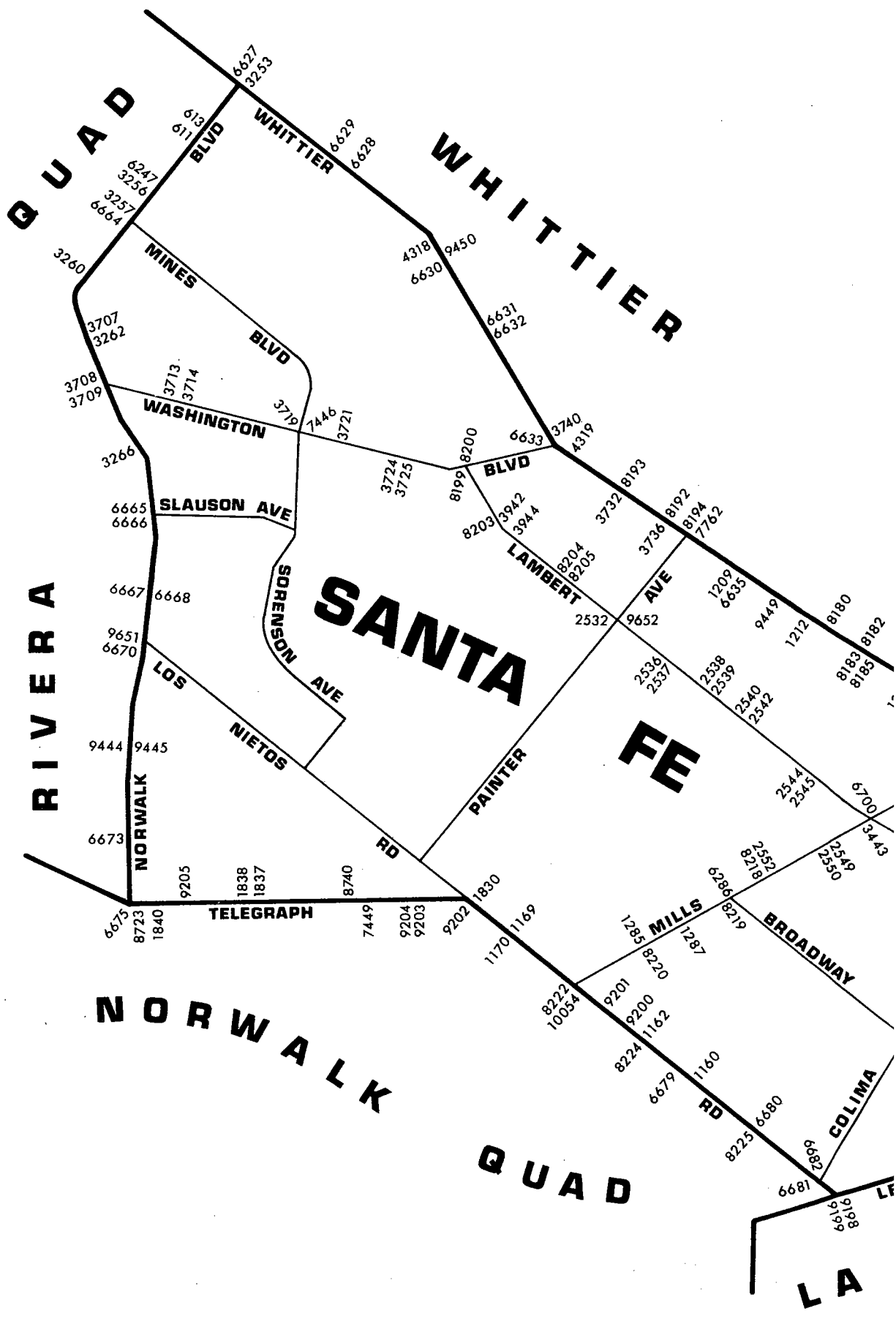

QUAD
6627
3233
613
611
6247
3256
3257
6664
3260

WHITTIER
6629
6628
4318
9450
6631
6632

MINES
BLVD
3707
3262
3708
3709
3713
3714
3719
7446
3721

WHITTIER
6633
3740
4319

WASHINGTON
3266
6665
6666
6667
6668
9651
6670

BLVD
8199
8200
6633
3740
4319
8203
3942
3944
8204
8205
3732
8193
3736
8192
8194
7762
1209
6635
9449
1212
8180
8183
8182

RIVERA
SANTA FE
LOS NIETOS
RD
9444
9445
6673
9205
1838
1837
8740
7449
9204
9203
9202
1830
1170
1169

SORENSEN
AVE
2532
9652
2536
2537
2538
2539
2540
2542
2544
2545
6700
3443
2549
2550
2552
8218
6286
8219
8222
10054
9201
9200
8224
1162
6679
1160
8225
6680
6682
6681
916
8016
8185

NORWALK
6675
8723
1840
TELEGRAPH
RD
7449
9204
9203
9202
1830
1170
1169

PAINTER
RD
8222
10054
9201
9200
8224
1162
6679
1160
8225
6680
6682
6681
916
8016
8185

NORWALK QUAD
8222
10054
9201
9200
8224
1162
6679
1160
8225
6680
6682
6681
916
8016
8185

MILLS
RD
1285
8220
1287
8224
1162
6679
1160
8225
6680
6682
6681
916
8016
8185

BROADWAY
RD
6681
916
8016
8185

COLIMA
RD
6681
916
8016
8185

LA

QUAD-YEAR	ELEV	DESCRIPTION (INCLUDE QUAD AND YEAR IN DESCRIPTION)	BM NUMBER
BASELINE (1975)	73.432	4.5 IN IP WITH L&T 6IN BACK WK ON SE COR PARAMOUNT BLVD & ROSECRANS AVE 244FT S C/L 50FT E C/L INT MKD (LAC 32)	CY 288
BASELINE (1975)	92.748	L&T 5FT E CB RET @ NE COR SYCAMORE ST & SAN ANTONIO DR 74FT E & 18FT N C/L INT	CY 445
BASELINE (1975)	73.117	CS REF MON IN WELL 14IN DN ON NE COR ALONDRA BLVD & WOODRUFF AVE 56FT N & 60FT E/O C/L INT MKD (CLEARWATER K 2A)	CY 473
BASELINE (1975)	73.744	CSBM MON FL ON NW COR ALONDRA BLVD & WOODRUFF AVE 39FT N & 180FT W C/L INT MKD (BM 6-6A1958)	CY 474
BASELINE (1975)	74.723	L&N 18FT E C/L ENCALYPTUS AVE & 80FT S C/L ALONDRA BL	CY 477
BASELINE (1975)	75.185	L & T 15FT E C/L LEAHY AVE & 80FT N C/L ALONDRA BL	CY 478
BASELINE (1975)	75.165	L & T 15FT W C/L LEAHY AVE & 80FT N C/L ALONDRA BL	CY 479
BASELINE (1975)	169.546	L&SPK CTR OF WK 3FT E FLAGPOLE @ WEST WHITTIER SCHOOL 51FT W C/L NORWALK BLVD & 250FT N C/L BEXLEY DR TO THE W	CY 611
BASELINE (1975)	169.691	L&T W CB 3FT N BCR @ NW COR LOCH AVON DR TO THE W & NORWALK BLVD 45FT N & 28FT W/O C/L INT	CY 613
BASELINE (1975)	80.782	RD HD SPK&L W CB 28FT N BCR @ NW COR WOODRUFF AVE & WASHINGTON ST 70FT N & 40FT W C/L INT MKD (MV 26)	CY 695
BASELINE (1975)	87.493	FC BRONZE DISC @ SW COR DAIRY PLATFORM 75FT N C/L ROSECRANS AVE 300FT E SAN GABRIEL RIVER BRIDGE (BM 75-9C)	CY 697
BASELINE (1975)	84.396	L&N 1FT E BCR @ SE COR ROSECRANS AVE & CROSSDALE AVE 40FT S & 50FT E C/L INT	CY 699
BASELINE (1975)	84.684	L&N 1FT E BCR @ SE COR ROSECRANS AVE & ELMCROFT AVE 40FT S & 50FT E C/L INT	CY 700
BASELINE (1975)	85.053	L&N 1FT E BCR @ SE COR ROSECRANS AVE & GARD AVE 38FT S & 50FT E C/L INT	CY 702
BASELINE (1975)	86.646	L&N 1FT S BCR @ SE COR ROSECRANS AVE & JERSEY AVE 68FT S & 18FT E C/L INT	CY 703

QUAD-YEAR	ELEV	DESCRIPTION (INCLUDE QUAD AND YEAR IN DESCRIPTION)	BM NUMBER
BASELINE (1975)	86.391	CS MON IN WELL 13IN DN ON NW COR ROSECRANS AVE & PICNEER BLVD 86FT N & 40FT W C/L INT MKD (WHITTIER C 124 1959)	CY 706
BASELINE (1975)	86.923	RDBM MON FLUSH IN CONC SQ POST ON SW COR ROSECRANS AVE & ARLEE AVE 83FT S & 20FT W C/L INT MKD (BM 184)	CY 707
BASELINE (1975)	71.783	L&T 2FT W CB RET NW COR RYON AVE & ALONDRA BLVD 38FT N & 32FT W C/L INT	CY 763
BASELINE (1975)	73.661	L&BN S CB ALONDRA BLVD 6IN E CB RET @ SE COR ALONDRA BLVD & PACIFIC AVE 70FT W PERR	CY 765
BASELINE (1975)	68.586	L & SPK 4FT E CB RET @ NE COR CLARK AVE & ALONDRA BLVD 38FT N & 59FT E C/L INT	CY 766
BASELINE (1975)	69.592	L&T C/L INT VIRGINIA DR & ALONDRA BLVD	CY 767
BASELINE (1975)	68.374	L&T C/L INT PITTS AVE & ALONDRA BLVD	CY 769
BASELINE (1975)	108.417	L&SPK IN WK 55FT N/O C/L COLE ST & 50FT W/O C/L PARAMOUNT BLVD MKD (0-31)	CY 773
BASELINE (1975)	104.856	L&T 14FT E C/L PARAMOUNT BLVD 11FT N C/L SPRINGER ST PROD IN CONC PVMT	CY 777
BASELINE (1975)	103.961	L&T IN CONC 14FT E C/L PARAMOUNT BLVD 4FT N C/L QUILL DR PROD	CY 778
BASELINE (1975)	90.416	L & T 1FT N BCR @ NE COR PARAMOUNT BLVD & ADOREE AVE 58FT N & 38FT E C/L INT	CY 779
BASELINE (1975)	82.561	CS MON 16FT W & 5FT S INT PARAMOUNT BLVD & GARDENDALE ST	CY 783
BASELINE (1975)	77.754	L & T 10FT S BCR INTO CB RET @ NE COR PARAMOUNT BLVD & CENTURY BLVD 2FT N & 41FT E C/L INT	CY 791
BASELINE (1975)	76.271	BT SPK 1FT S BCR @ SW COR PARAMOUNT BLVD & PEARLE ST 32FT S & 38FT W C/L INT MKD (H-110)	CY 792
BASELINE (1975)	75.489	BT SPK BCR @ SW COR PARAMOUNT BLVD & HOWE ST 30FT S & 38FT W C/L INT	CY 793
BASELINE (1975)	76.316	BT SPK CTR CB RET @ NW COR PARAMOUNT BLVD & ROSE ST 18FT N & 40FT W C/L INT MKD (H 112)	CY 794
BASELINE (1975)	71.548	L & T IN CB 38FT W C/L PARAMOUNT BLVD ON THIRD ST C/L PRGD	CY 795

QUAD-YEAR	ELEV	DESCRIPTION (INCLUDE QUAD AND YEAR IN DESCRIPTION)	BM NUMBER
BASELINE (1975)	72.315	CS MON 17FT W/O C/L PARAMOUNT BLVD ON C/L COMPTON BLVD MKD (RE 2177 CLEARWATER)	CY 797
BASELINE (1975)	68.556	L&T W CB PARAMOUNT BLVD 2FT N CB RET @ NW COR MADISON ST & PARAMOUNT BLVD	CY 799
BASELINE (1975)	73.494	L&T IN S CB ALONDRA BLVD 1FT E INTO RET 68FT W C/L WOODRUFF AVE & 38FT S/O C/L ALONDRA BLVD	CY 960
LAMIRADA (1980)	256.772	CS MON IN WELL 12IN DN @ OR NR C/L INT IMPERIAL HWY & SANTA GERTRUDES AVE MKD (AUX LA HABRA A 10 A)	CY 1140
LAMIRADA (1980)	256.376	RDBM TAG IN W CB 1FT S/O BCR @ SW COR FIRST AVE & SHARONHILL DR 32FT W & 60FT S C/L INT	CY 1146
BASELINE (1975)	241.277	L&BN IN CB 36FT E BCR @ NE COR LEFFINGWELL RD & SANTA GERTRUDES AVE 40FT N & 145FT E C/L INT 1FT W/O ENT CATCH BASIN	CY 1150
BASELINE (1975)	234.470	L&BN IN CB 40FT S C/L LEFFINGWELL RD & 36 FT E C/L PROD EL ARCO DR OPP PP NO 1173876E	CY 1151
BASELINE (1975)	228.493	CS MON IN WELL 12IN DN 40FT S/O C/L LEFFINGWELL RD 2FT S/O S CB & 619FT E/O C/L SCOTT AVE MKD (RM 2 LA HABRA A 9 1960)	CY 1154
BASELINE (1975)	212.402	C S MON IN WELL ON C/L LEFFINGWELL RD 100FT W HSE NO 14701 & GPP PP NO 662000E MKD (WHITTIER J 9 AUX 1 1960)	CY 1156
BASELINE (1975)	175.276	L&SPK N BCR @ NE COR TELEGRAPH RD & CERES ST 61FT N & 20FT E C/L INT MKD (WZ 399)	CY 1160
BASELINE (1975)	134.408	L&T N CB 1FT W BCR @ NW COR TELEGRAPH RD & VICTORIA AVE 42FT N & 48FT W C/L INT	CY 1162
BASELINE (1975)	157.074	L&T N CB 3FT E OF BCR @ NE COR TELEGRAPH RD & CARMENITA RD 38FT N & 50FT E C/L INT	CY 1169
BASELINE (1975)	156.199	CS MON IN WELL 14IN DN 15FT S & 25FT E C/L INT TELEGRAPH RD & CARMENITA RD MKD (WHITTIER G 8 1942)	CY 1170
NORWALK (1980)	109.115	L&T ELY CB 7FT NLY BCR @ NELY COR LEFFINGWELL RD & MEYER RD 48FT NLY & 40FT ELY APPROX C/L INT	CY 1186
BASELINE (1975)	238.105	RDBM TAG IN CONC RETAINING WALL 6FT S CB FACE 54FT S & 45FT W C/L INT WHITTIER BLVD & LAUREL	CY 1209

QUAD-YEAR	ELEV	DESCRIPTION (INCLUDE QUAD AND YEAR IN DESCRIPTION)	BM NUMBER
BASELINE (1975)	236.484	L&T IN N CB PKWY @ BCR 48FT S & 30FT W/O C/L INT WHITTIER BLVD & BOYER AVE	CY 1212
BASELINE (1975)	266.222	L&SPK S CB WHITTIER BLVD 40FT S/O C/L & 136FT E/O C/L PROD CATALINA AVE MKD (WZ127)	CY 1215
BASELINE (1975)	264.306	L & T 1FT W BCR 40FT S & 30FT W C/L INT AVE & WHITTIER BLVD	CY 1216
SANTA FE (1980)	204.747	L&T W CB COLIMA RD 35FT S/O C/L & 42FT W/O C/L CARNELL AVE	CY 1224
SANTA FE (1980)	137.944	L & T NE COR CONC WK @ SW COR MILLS AVE & CLOSE ST 100FT W & 53 S C/L INT	CY 1285
SANTA FE (1980)	142.426	L & T 2FT S BCR @ SE COR MILLS AVE & ANOLA ST 30FT E & 37FT S C/L INT	CY 1287
BASELINE (1975)	125.802	RDBM TAG N CB 1FT E BCR @ NE COR PARAMOUNT BLVD & FLORENCE AVE 40FT N & 68FT E C/L INT	CY 1299
BASELINE (1975)	131.157	RDBM TAG IN S CB TELEGRAPH RD 2FT W/O SW CB RET @ MAIN DRWY TO SANTA FE SPRINGS FIRE STA BLDG NO 11736 40FT S/O C/L TELEGRAPH RD & 390FT W/O C/L PIONEER BLVD	CY 1345
BASELINE (1975)	131.516	CS MON IN WELL @ C/L INT TELEGRAPH RD & ALBURTIS AVE NLY MKD (LACS CON SYS TRA STA WHITTIER B-7 RE2177 1941)	CY 1348
BASELINE (1975)	124.480	CS BR CAP CONC MON IN WELL @ C/L INT PARAMOUNT BLVD & FLORENCE AVE	CY 1386
BASELINE (1975)	127.200	L & BRAD CTR CB RET SE COR LUBEC ST & PARAMOUNT BLVD 25FT S & 52FT E C/L INT	CY 1387
BASELINE (1975)	127.420	L & BRAD CTR CB RET NE COR LUBEC ST & PARAMOUNT BLVD 27FT N & 52FT E C/L INT	CY 1388
BASELINE (1975)	130.387	L&BN W CB PARAMOUNT BLVD @ NLY P L HSE NO 9603 33FT W/O C/L PARAMOUNT BLVD	CY 1389
BASELINE (1975)	131.832	L & T CONC CB @ BCR SE COR SUVA ST & PARAMOUNT BLVD 48FT S & 38FT E C/L INT MKD (BM)	CY 1390
BASELINE (1975)	134.278	L & T IN CONC CB @ BCR @ SW COR GALLATIN RD & PARAMOUNT BLVD 53FT S & 38FT W C/L INT	CY 1392
BASELINE (1975)	138.485	SQ HD SPK W CB OF SERVICE RD OF PARAMOUNT BLVD 12FT N C/L PROD BROOKGREEN RD	CY 1394

QUAD-YEAR	ELEV	DESCRIPTION (INCLUDE QUAD AND YEAR IN DESCRIPTION)	BM NUMBER
BASELINE (1975)	139.448	L&BR E CB 1FT S/O BCR @ SE COR PARAMOUNT BLVD & VISTA DEL ROSA SERVICE ISLAND 40FT E & 50FT S C/L INT	CY 1395
BASELINE (1975)	142.010	CS MON IN WELL 8IN DN ON C/L TELEGRAPH RD 20FT WLY C/L PARAMOUNT BLVD MKD (BELL K4 1941)	CY 1397
BASELINE (1975)	142.613	L&BN 4FT S BCR @ SW COR BIRCHBARK AVE & TELEGRAPH RD 80FT S & 18FT W/O C/L INT	CY 1593
BASELINE (1975)	144.974	L&BN 4FT S BCR @ SW COR STAMPS RD & TELEGRAPH RD 78FT S & 18FT W/O C/L INT	CY 1594
BASELINE (1975)	138.576	RAM SET CTR CB RET SE COR LAKEWOOD BLVD & TELEGRAPH RD 55FT S & 55FT E C/L INT	CY 1596
BASELINE (1975)	137.775	CS MON MKD (LACO SUR TRAVERSE STA BELL K-5A RE2177 1941) IN WELL W/COVER @ CL INT TELEGRAPH RD & LAKEWOOD BLVD	CY 1597
BASELINE (1975)	138.368	L&T S END W GAS ISLAND NE COR TELEGRAPH RD & SERAPIS AVE 67FT N & 61FT E/O C/L INT	CY 1599
BASELINE (1975)	137.134	L&T IN S CB TELEGRAPH RD 6FT W/O CB RET @ SE COR SERAPIS AVE 40FT S & 50FT E/O C/L INT	CY 1600
BASELINE (1975)	141.124	L&BN 1FT FROM BCR SERVICE RD N CB @ PASSONS BLVD & TELEGRAPH RD 50FT S C/L TELEGRAPH RD	CY 1601
BASELINE (1975)	138.138	L&B W ECR @ SW COR TRUE AVE & TELEGRAPH RD (SERVICE RD) 47FT W & 15FT S/O C/L INT TRUE AVE & TELEGRAPH RD (SERVICE RD)	CY 1708
BASELINE (1975)	137.232	CS BR CAP CONC MON IN CASING & COVER PI 6.82FT E C/L INT TRUE AVE & TELEGRAPH RD	CY 1709
BASELINE (1975)	157.383	L&T W CB 18FT N/O BCR @ NW COR TELEGRAPH RD & LAUREL AVE 68FT N & 20FT W C/L INT	CY 1830
BASELINE (1975)	151.281	CS MON IN WELL 8IN DN @ OR NR C/L INT TELEGRAPH RD & BLOOMFIELD AVE MKD (WHITTIER E7-A)	CY 1837
BASELINE (1975)	153.136	L&T 1FT N SE COR 1ST CONC STEP 70FT N C/L TELEGRAPH RD & 67FT W C/L BLOOMFIELD AVE	CY 1838
BASELINE (1975)	143.396	L & BN NE COR CONC BASE OIL DERRICK SW COR WILLIS ST & TELEGRAPH RD 40FT S & 43FT W C/L INT	CY 1840
BASELINE (1975)	89.914	RDBM TAG S CB ROSECRANS AVE 40FT S C/L @ ANG PT OF CB TO BRIDGE OVER SAN GABRIEL RIVER 500FT W BRIDGE	CY 1989

QUAD-YEAR	ELEV	DESCRIPTION (INCLUDE QUAD AND YEAR IN DESCRIPTION)	BM NUMBER
BASELINE (1975)	83.353	L & T 6FT W BCR @ SW COR PARAMOUNT BLVD & GARDENDALE ST 35FT S & 59FT W C/L INT	CY 2041
BASELINE (1975)	66.220	L&T CTR CB RET @ SE COR ALONDRA BLVD & DOWNEY AVE 48FT S & 47FT E C/L INT	CY 2343
BASELINE (1975)	98.713	L&BN N CB ROSECRANS AVE NE COR BRIDGE OVER SAN GABRIEL RIV 1FT W OF E END OF BRIDGE 23FT N C/L ROSECRANS AVE	CY 2495
BASELINE (1975)	101.072	L&BN N CB ROSECRANS AVE @ NW COR BRIDGE OVER SAN GABRIEL RIV 1FT E OF W END OF BRIDGE 23FT N C/L ROSECRANS AVE	CY 2496
SANTA FE (1980)	175.339	CS MON IN WELL 12IN DN @ OR NR C/L INT LAMBERT RD & PAINTER AVE MKD (CO ENG MON RE 5869) USE ELY EDGE	CY 2532
SANTA FE (1980)	176.593	L&T W CB 1FT S BCR @ SW COR LAMBERT RD & LAUREL AVE 65FT S & 20FT W C/L INT	CY 2536
SANTA FE (1980)	177.404	L & BN 1FT E BCR @ SE COR LAMBERT RD & LAUREL AVE 32FT S & 65FT E C/L INT	CY 2537
SANTA FE (1980)	178.335	RDBM TAG S CB LAMBERT RD 32FT S/O C/L & 8FT W/O C/L PROD TARRYTON AVE	CY 2538
SANTA FE (1980)	177.220	L & BN 1FT W BCR @ SW COR LAMBERT RD & COACHMAN AVE 32FT S & 55FT W C/L INT	CY 2539
SANTA FE (1980)	179.740	L & BN S CB LAMBERT RD 32FT S C/L 3FT W C/L PROD EDMARU AVE 310FT W C/L CALMADA AVE	CY 2540
SANTA FE (1980)	180.910	RDBM TAG W CB 1FT S/O BCR @ SW COR LAMBERT RD & CALMADA AVE 75FT S & 18FT W/O C/L INT	CY 2542
SANTA FE (1980)	190.652	RDBM TAG S CB 1FT W BCR @ SW COR LAMBERT RD & GUNN AVE 30FT S & 66FT W C/L INT	CY 2544
SANTA FE (1980)	191.928	L & BN 60FT E BCR @ SE COR LAMBERT RD & GUNN AVE 30FT S & 85FT E C/L INT	CY 2545
SANTA FE (1980)	185.462	L & T NE COR CONC STEP HSE NO 9665 60FT W C/L MILLS AVE & 550FT S LAMBERT RD	CY 2549
SANTA FE (1980)	176.520	L&T NE COR CONC STEP HSE NO 9753 MILLS AVE 60FT W C/L 1050FT S LAMBERT RD	CY 2550
SANTA FE (1980)	156.248	L&T N CB 6FT W BCR @ NW COR MILLS AVE & MULBERRY DR 40FT N & 68FT W C/L INT	CY 2552

QUAD-YEAR	ELEV	DESCRIPTION (INCLUDE QUAD AND YEAR IN DESCRIPTION)	BM NUMBER
BASELINE (1975)	67.421	L&T NR W END OF CONC WK AROUND HSE #8700 ALONDRA BLVD 57FT S & 25FT E C/L INT ALONDRA BLVD & HAYTER ST	CY 2589
BASELINE (1975)	67.392	LACS MON 30FT N & 70FT E C/L INT ALONDRA BLVD & CLARK AVE MKD (BM 6-8 1951)	CY 2596
BASELINE (1975)	73.279	L&T N CB 4FT W CB RET @ NW COR ALONDRA BLVD & BLAINE AVE 38FT N & 35FT W C/L INT	CY 2597
BASELINE (1975)	73.411	L&T IN N CB 3FT E CB RET @ NE COR ALONDRA BLVD & BLAINE AVE 38FT N & 32FT E C/L INT	CY 2598
BASELINE (1975)	74.110	L&BN S CB 1FT W CB RET @ SW COR ALONDRA BLVD & BELLFLOWER BLVD 46FT W & 38FT S C/L INT	CY 2600
BASELINE (1975)	216.571	L&T IN DEP CB DRWY TO GAS STATION 2FT E/O BCR @ NW COR LA MIRADA BLVD & LEFFINGWELL RD 40FT N & 60FT W/O C/L INT	CY 2738
BASELINE (1975)	216.689	L & T IN S CB 7FT E BCR 41FT S & 50FT W C/L INT LEFFINGWELL RD & LA MIRADA BLVD	CY 2739
BASELINE (1975)	191.456	L&BN W END CATCH BASIN N SIDE LEFFINGWELL RD 40FT N C/L & 450FT W C/L LA MIRADA BLVD 500FT E C/L ARROYO DR	CY 2740
BASELINE (1975)	186.266	L&BN 1FT W BCR @ SW COR LEFFINGWELL RD & ARROYO DR 40FT S & 50FT W C/L INT	CY 2741
BASELINE (1975)	65.358	L&BN W CB 7FT N OF BCR @ SW COR ALONDRA BLVD & VALLEY VIEW AVE 68FT S & 40FT W C/L INT	CY 2771
BASELINE (1975)	94.678	L&SPK N CB 4FT E BCR @ NE COR VALLEY VIEW AVE & STAGE RD 30FT N & 60FT E C/L INT CB MKD (RBM 1)	CY 2776
BASELINE (1975)	94.712	USC&GS MON FLUSH ON NE COR VALLEY VIEW AVE & STAGE RD 31.5FT N & 87FT E C/L INT 1.5FT N CB MKD (K 778-1945)	CY 2777
BASELINE (1975)	94.210	L&BN NR CTR OF BRIDGE NO 1273 40FT E/O C/L VALLEY VIEW AVE 800FT S FOSTER RD 137FT N C/L MAZSA DR	CY 2782
BASELINE (1975)	94.655	CS MON IN WELL 10IN DN ON NE COR VALLEY VIEW AVE & FOSTER RD 62FT N & 41FT E C/L INT 1FT BACK CB MKD (BM 1#6A 1961)	CY 2785
BASELINE (1975)	105.922	L&BN E CB 1FT N BCR @ NE COR VALLEY VIEW AVE & ADOREE ST TO THE E 57FT N & 38FT E/O C/L INT	CY 2786

QUAD-YEAR	ELEV	DESCRIPTION (INCLUDE QUAD AND YEAR IN DESCRIPTION)	BM NUMBER
BASELINE (1975)	115.829	L&BN E CB 1FT S BCR @ SE COR VALLEY VIEW AVE & IMPERIAL HWY 76FT S & 38FT E C/L INT	CY 2788
BASELINE (1975)	104.350	L & T 18FT S C/L SPRINGER ST & 70FT W C/L PARAMOUNT BLVD 8FT W BCR @ SW COR IN CB	CY 3168
BASELINE (1975)	110.277	L & B 1FT W BCR @ SW COR DE PALMA ST & PARAMOUNT BLVD 18FT S & 74FT W C/L INT	CY 3173
BASELINE (1975)	111.336	L & BRAD 1FT W BCR @ NW COR CLETA ST & PARAMOUNT BLVD 18FT N & 75FT W C/L INT	CY 3174
BASELINE (1975)	112.152	L&T 2FT W/O BCR @ SW COR BROOKMILL RD & PARAMOUNT BLVD 18FT S & 77FT W/O C/L INT	CY 3175
BASELINE (1975)	115.822	LACS MON IN WELL @ C/L INT 2ND ST & PARAMOUNT BLVD (USE S EDGE)	CY 3182
BASELINE (1975)	123.950	L & T 2FT S BCR @ SW COR PARAMOUNT BLVD & FARM ST 55FT S & 38FT W C/L INT	CY 3183
BASELINE (1975)	175.876	CS BR CAP MON 3FT SW OF C/L INT NORWALK BLVD & WHITTIER BLVD TO THE N MKD (WHITTIER B-2 RE 329 1949)	CY 3253
BASELINE (1975)	166.617	L&BR W CB 2FT S/O BCR @ NW COR ROSEHEDGE DR & NORWALK BLVD 54FT N & 33FT W/O C/L INT	CY 3256
BASELINE (1975)	164.690	L&SPK E CB 5FT S BCR @ SE COR DUNLAP CROSSING RD (MINES BLVD) & NORWALK BLVD 38FT E & 77FT S C/L INT	CY 3257
BASELINE (1975)	162.031	L&BN E CB 1FT S BCR @ SE COR FLORY ST & NORWALK BLVD 54FT S & 38FT E/O C/L INT	CY 3260
BASELINE (1975)	160.827	RE TAG NO 2059 6FT NW OF WALK TO HSE NO 7608 50FT E/O & 112FT S/O C/L INT NORWALK BLVD & CHOISSER ST	CY 3262
BASELINE (1975)	153.957	L&BN W CB 1FT N BCR @ NW COR WADDELL ST & NORWALK BLVD 38FT W & 60FT N C/L INT	CY 3266
BASELINE (1975)	83.725	L&T 1FT N BCR @ NW COR STUDEBAKER RD & ROSECRANS AVE 81FT N & 52FT W C/L INT	CY 3364
SANTA FE (1980)	194.499	L&BRAD E CB 4FT SO OF BCR @ SE COR MILLS AVE & LAMBERT RD 52FT SO & 30FT E C/L INT	CY 3443
SANTA FE (1980)	196.567	RD HD SPK E CB 8FT SO OF BCR @ SE COR LAMBERT RD & BONAVISTA LANE 85FT SO & 18FT E C/L INT MKD (W2 455)	CY 3446

QUAD-YEAR	ELEV	DESCRIPTION (INCLUDE QUAD AND YEAR IN DESCRIPTION)	BM NUMBER
SANTA FE (1980)	227.819	L & T 4FT W BCR @ SW COR LAMBERT RD & KIBBE AVE 32FT S & 55FT W C/L INT	CY 3460
BASELINE (1975)	291.296	C S MON 100FT S C/L WHITTIER BLVD & 5FT E C/L FIRST AVE MKD (BM 3-17 1961)	CY 3471
BASELINE (1975)	292.123	L & SPK 48FT W BCR 40FT S & 90FT W C/L INT WHITTIER BLVD & FIRST AVE MKD (BM NO 2)	CY 3472
BASELINE (1975)	332.930	CS BM MON 1FT BACK OF CB @ NE COR WHITTIER BLVD & VALLEY HOME AVE 52FT N & 24FT E/O C/L INT MKD (38-1 1964)	CY 3475
BASELINE (1975)	333.948	L & BN @ S END C B 1FT N BCR 55FT N & 20FT E C/L INT WHITTIER BLVD & VALLEY HOME AVE	CY 3476
BASELINE (1975)	248.797	STATE BR CAP E END CATCH BASIN 40FT N C/L WHITTIER BLVD 266FT E C/L SCOTT AVE	CY 3491
BASELINE (1975)	262.829	L&T NE COR CONC WK AROUND GAS STA NO 15020 120FT S C/L WHITTIER BLVD 60FT W C/L COLE RD	CY 3494
BASELINE (1975)	248.885	L&SPK N CB OF SERVICE RD 18FT E BCR @ NE COR LA ENTRADA AVE & WHITTIER BLVD 15FT N & 61 FT E/O C/L INT SERV RD	CY 3498A
BASELINE (1975)	160.785	RAM SET NR CTR CB RET ON SE COR CHOISSER ST & NORWALK BLVD 29FT S & 45FT E/O C/L INT	CY 3707
BASELINE (1975)	157.715	RAMSET IN W CB 3FT N/O BCR @ NW COR WASHINGTON BLVD & NORWALK BLVD 135FT N & 38FT W/O C/L INT	CY 3708
BASELINE (1975)	158.106	CE BR CAP FL IN ISL NW COR WASHINGTON BLVD & NORWALK BLVD 81FT N & 32FT W/O C/L INT MKD (BM 2-14A 1961 RE 5869)	CY 3709
SANTA FE (1980)	154.572	L&T 15FT ELY BCR @ NW COR BROADWAY & WASHINGTON BLVD 44FT N & 40FT W/O C/L INT MKD (BM)	CY 3713
SANTA FE (1980)	154.281	L & T 5FT NLY CTR CB RET ON SE COR BROADWAY & WASHINGTON BLVD 44FT S & 40FT E C/L INT	CY 3714
SANTA FE (1980)	154.286	L&T WLY CB 9FT SLY BCR @ NWLY COR SORENSEN AVE & WASHINGTON BLVD 68FT NLY & 40FT WLY C/L INT MKD (BM)	CY 3719
SANTA FE (1980)	154.209	RDBM TAG 1FT W/O BCR @ NW COR 40FT N & 51FT W/O C/L INT WASHINGTON BLVD & APPLIEDALE AVE MKD (SD 152)	CY 3721
SANTA FE (1980)	156.181	L & BN 1FT W BCR IN N CB OF PKWY @ NW COR 50FT N & 37FT W C/L INT CROWDALE AVE & WASHINGTON BD	CY 3724

QUAD-YEAR	ELEV	DESCRIPTION (INCLUDE QUAD AND YEAR IN DESCRIPTION)	BM NUMBER
SANTA FE (1980)	156.739	L & BN 1FT E BCR @ NE COR 38FT N & 52FT E C/L INT CROWDALE AVE & WASHINGTON BLVD	CY 3725
BASELINE (1975)	220.390	RD BM TAG CB 1FT N ECR @ SE COR WHITTIER BLVD & COMSTOCK AVE 74FT S & 18FT W C/L INT	CY 3732
BASELINE (1975)	231.557	RD BM TAG CB 3FT N ECR @ SE COR WHITTIER BLVD & WASHINGTON AVE 72FT S & 15FT E C/L INT	CY 3736
BASELINE (1975)	213.012	STATE HWY BR MON FL IN ISLAND @ BC OF CURVE 200FT WLY C/L WASHINGTON BLVD 4FT NLY S CB OF ISLAND CN WHITTIER BLVD	CY 3740A
SANTA FE (1980)	170.210	L&BN IN CB ON SW COR LAMBERT RD & SANTA FE SPRINGS RD 30FT S & 94FT W C/L INT	CY 3942
SANTA FE (1980)	171.614	RAM-SET 2FT E CB RET @ NE COR NEWLIN AVE & LAMBERT RD 52FT E/O C/L NEWLIN AVE & 30FT N/O LAMBERT RD	CY 3944
LAMIRADA (1980)	300.590	RD BM TAG S CB 1FT E BCR @ SE COR IMPERIAL HWY & FIRST AVE 40FT S & 56FT E C/L INT	CY 3997
LAMIRADA (1980)	299.952	CS TRI MON IN WELL 10IN DN @ OR NEAR C/L INT IMPERIAL HWY & FIRST AVE MKD (LA HABRA B-10-A)	CY 3998
LAMIRADA (1980)	268.135	L & T IN S CB 40FT S & 48FT W/O C/L INT IMPERIAL HWY & CLEARGLEN AVE IN FRONT P P NO 1254813E MKD (BM)	CY 3999
LAMIRADA (1980)	255.791	RD BM TAG E CB 1FT S BCR @ SE COR FIRST AVE & AMBER VALLEY DR 56FT S & 30 E C/L INT	CY 4006
LAMIRADA (1980)	268.659	L&BN N END CONC APRON TO GARAGE OF HSE NO 13117 80FT W & 15FT S/O C/L INT SANTA GERTRUDES AVE & GLAZEBROOK DR.	CY 4029
LAMIRADA (1980)	223.188	L&BRAD S CB 11FT E BCR @ SE COR ALICANTE RD & SANTA GERTRUDES AVE 30FT S & 95FT E C/L INT	CY 4032
NORWALK (1980)	158.748	L&SPK NR SE COR CONC WK 66FT W CARMENITA RD & 81FT N C/L BEATY AVE NR SE COR OF BLDG	CY 4312
NORWALK (1980)	166.672	L&BR IN S CB LAKELAND RD 10FT W/O BCR 32FT S & 77FT W/O C/L INT LAKELAND RD & CARMENITA RD	CY 4314
NORWALK (1980)	168.681	L&T NR S EDGE OF CONC DRWY HSE NO 10762 CARMENITA RD 124FT N/O SUNDANCE AVE & 57FT E/O C/L CARMENITA RD MKD (BM)	CY 4317

QUAD-YEAR	ELEV	DESCRIPTION (INCLUDE QUAD AND YEAR IN DESCRIPTION)	BM NUMBER
BASELINE (1975)	231.869	CS MON IN WELL 13FT S OF N CB WHITTIER BLVD & 50FT W APPROX C/L SORENSEN AVE MKD (WHITTIER G-3 1948)	CY 4318
BASELINE (1975)	210.644	RDBM TAG CONC @ SW COR CTR CONC PIER UPRR BRIDGE OVER WHITTIER BLVD 150FT ELY C/L WASHINGTON BLVD	CY 4319
BASELINE (1975)	279.117	RD BM TAG SLY END RETAINING WALL ENT DR IN MARKET 36FT NLY C/L RUSSELL ST & 125FT ELY C/L INT WHITTIER BLVD & SANTA GERTRUDES AVE	CY 4321
BASELINE (1975)	279.200	STATE HWY BR CAP W END CATCH BASIN 40FT N C/L WHITTIER BLVD & 18FT W C/L PROD VIRGINIA AVE	CY 4322
NORWALK (1980)	163.360	RDBM TAG 40FT W C/L CARMENITA RD ON S P/L HSE NO 10615 400FT S/O BARRETT ST IN FRONT OF PP # W4623Y	CY 6132
BASELINE (1975)	166.653	LA CO ENGR BR CAP NLY END C B 79FT N & 37FT W/O C/L INT ROSEHEDGE DR & NORWALK BLVD MKD (BM 2-16 1961 RE 5869)	CY 6247
SANTA FE (1980)	149.812	L&T S CB 1FT E BCR @ SE COR MILLS AVE & BROADWAY 20FT S & 50FT E C/L INT MKD (WZ 169)	CY 6286
SANTA FE (1980)	206.455	LA CO RD DEPT BM TAG W CB @ NO END OF CATCH BASIN 20FT W C/L COLE RD & 73FT S C/L DITTMAR DR	CY 6290
LAMIRADA (1980)	257.525	L&BN CTR CB RET @ NE COR IMPERIAL HWY & SANTA GERTRUDES AVE 50FT N & 40FT E C/L INT	CY 6308
LAMIRADA (1980)	280.796	L&T 1FT W/O BCR IN N CB S SE RD @ SW COR IMPERIAL HWY & BREEZEWOOD DR 58FT S & 35FT W/O C/L INT MKD (8M)	CY 6309
LAMIRADA (1980)	263.265	L&BRAD E CB SERVICE RD 5FT N BCR @ SE COR SANTA GERTRUDES AVE & FOSTER RD 33FT S & 71FT E/O C/L INT MKD (8M)	CY 6320
LAMIRADA (1980)	263.395	L&T E CB SERVICE RD 5FT N BCR @ NE COR SANTA GERTRUDES AVE & FOSTER RD 45FT N & 74FT E C/L INT MKD (8M)	CY 6321
LAMIRADA (1980)	250.766	CS BM BRASS DISK IN SW COR CULVERT 33FT E C/L FIRST AVE & 236FT N/O AMBER VALLEY DR MKD (BM3-15A 1961)	CY 6326
LAMIRADA (1980)	273.469	RD BM TAG W CB 1FT N BCR @ NW COR FIRST AVE & CANDLELIGHT DR 58FT N & 32FT W C/L INT	CY 6327

QUAD-YEAR	ELEV	DESCRIPTION (INCLUDE QUAD AND YEAR IN DESCRIPTION)	BM NUMBER
LAMIRADA (1980)	276.739	RD BM TAG E CB 1FT S BCR @ SE COR FIRST AVE & CANDLELIGHT DR 56FT S & 32FT E C/L INT	CY 6328
BASELINE (1975)	177.549	RDBM TAG W CB 40FT N BCR @ NW COR WHITTIER BLVD & NORWALK BLVD 105FT N & 27FT W C/L INT	CY 6627
BASELINE (1975)	201.531	CS MON FL 1FT BACK E CB BROADWAY 29FT E C/L & 108FT N C/L WHITTIER BLVD MKD (BM 1-15A 1961)	CY 6628
BASELINE (1975)	198.651	L&T N CB 0.5FT E BCR @ NW COR BROADWAY & WHITTIER BLVD 27FT N & 66FT W C/L INT	CY 6629
BASELINE (1975)	233.402	RDBM TAG S CB @ C B 18FT E BCR @ SE COR WHITTIER BLVD & SORENSEN AVE 27FT S & 70FT E APPROX C/L INT	CY 6630
BASELINE (1975)	229.809	RDBM TAG N CB S SERV RD WHITTIER BLVD 125FT S C/L @ DR NR C/L PROD PENN ST	CY 6631
BASELINE (1975)	233.204	CS MON FL 1FT BACK S CB WHITTIER BLVD 31FT S/O C/L & 25FT E/O C/L PENN ST MKD (BM 1-14C 1961)	CY 6632
BASELINE (1975)	213.038	LACS MON FL IN SW COR C B 18FT N C/L N BBL WHITTIER BLVD & 86FT W C/L PICKERING AVE MKD (BM 1-14 AB 1961)	CY 6633
BASELINE (1975)	234.312	CAL HWY BR DISC @ W END OF C B 65FT W & 38FT S/O C/L INT BARTON RD & WHITTIER BLVD	CY 6635
BASELINE (1975)	248.539	LACS BM MON IN WELL 10IN DN IN DIVIDER STRIP 49FT N & 48FT E/O C/L INT WHITTIER BLVD & LA ENTRADA AVE MKD (1-11A)	CY 6636
BASELINE (1975)	274.102	CAL HWY MON FL IN SE COR C B ON N SIDE WHITTIER BLVD @ NW COR SANTA GERTRUDES AVE & RUSSELL ST 118FT N WHITTIER BLVD & 40FT E OF SANTA GERTRUDES AVE	CY 6637
BASELINE (1975)	164.866	SPK IN S CB 7FT E BCR @ SE COR MINES BLVD & NORWALK BLVD 84FT E & 38FT S C/L INT MKD (KW-28)	CY 6664
BASELINE (1975)	151.983	BT SPK W CB 8FT N BCR @ NW COR NORWALK BLVD & SLAUSON AVE 86FT N & 40FT W C/L INT	CY 6665
BASELINE (1975)	151.898	RDBM TAG E CB 2FT N BCR @ SE COR NORWALK BLVD & SLAUSON AVE 40FT E & 82FT S C/L INT	CY 6666
BASELINE (1975)	153.117	L&T E CB NORWALK BLVD 40FT E C/L ON C/L PROD BURKE ST	CY 6667

