

**LOS ANGELES COUNTY
DEPARTMENT OF PUBLIC WORKS**

BENCH MARK LIST



GARDENA QUAD

NGVD 29 DATUM

1994 ADJUSTMENT

PREFACE

The Department of Public Works level net is composed of more than 1,700 miles of levels supporting in excess of 9,000 bench marks. Previously when a major readjustment of the net was undertaken, to emphasize the complete break with previous elevations, the CY, CG, & CL, series bench marks were re-labeled DY, DG, & DL, respectively.

Beginning in 1993 the baseline readjustment year will be indicated on baseline BM,s only indicated below (*). Henceforth all BM numbers will be labeled as a Y, G, or L, series that will no longer indicate the major adjustment year.

To facilitate the adjustment, indexing and distribution of adjusted values of the net, the county territory was divided into 33 quads or areas. For the identification purposes each quad was given a name, viz., "Rosemead," "La Mirada," "Santa Fe," etc. When bench marks and elevations in these quads are used, the name must be included in the bench mark description, e.g.,

* BASELINE 295.461 L&BR IN CTR OF CB RET @ NE COR Y 9191
(1990) LA HABRA BLVD & VALLEY HOME AVE
35FT N & 35FT E/O C/L INT

It is expected that this general adjustment will for the most part remain sound for 8 to 12 years. Updating constrained adjustments will continue in the future. When a quad is readjusted, new elevations will be published and the date of readjustment will be noted in the bench mark description. Two bench marks with different adjustment dates will not normally agree with each other.

The basic accuracy of the net is reflected by an indicated field probable error of plus or minus 0.012 foot per mile of leveling as determined from the conditions of closure. However, many years of experience in vertical control in the greater Los Angeles basin and Antelope Valley indicate that because of varying degrees of subsidence and heaving, the true datum is recovered only by obtaining substantial agreement of a number of bench marks.

The users of this net are invited to assist in its maintenance by notifying this department of cases of obliteration, apparent mistakes in description or elevations, and proven disturbance of bench marks.

=====

DATUM: U.S. Coast and Geodetic Survey Sea Level Datum
of 1929, through the medium of the Los Angeles
County Engineer Precise Level Net.

ABBREVIATIONS USED IN BENCH MARK LISTINGS

ABUT -----	Abutment	ECR -----	End of Curb Return
ALG -----	Along	EC -----	End of Curve
ANG PT -----	Angle Point	ENT -----	Entrance
B/W -----	Back of Walk	FL -----	Floor
BCR -----	Beginning of Curb Return	FTG -----	Footing
BC -----	Beginning of Curve	FRWY -----	Freeway
BLDG -----	Building	F/W -----	Front of Walk
BM -----	Bench Mark	GAR -----	Garage
BT SPK -----	Boat or Bolt Spike	HDWL -----	Headwall
BR CAP -----	Brass or Bronze Cap	HSE -----	House
C B -----	Catch Basin	HWY -----	Highway
CTR -----	Center	INT -----	Intersection
C/L -----	Center Line	IP -----	Iron Pipe
C/L INT -----	Center Line Intersection	LT -----	Left
C/L PROD -----	Center Line Produced	LACE -----	L.A. City Engineer
CONC -----	Concrete	LACS -----	L.A. Co. Engineer
COR -----	Corner	LAFC -----	L.A. Co. Flood Control
COE -----	Corps of Engineers	L&BN -----	Lead and Bench Nail
CULV -----	Culvert	L&BR -----	Lead and Brad
CYN -----	Canyon	L&N -----	Lead and Nail
CB -----	Curb	L&SPK -----	Lead and Spike
CS MON -----	Co. Eng. Monument	L&T -----	Lead and Tack
CT SPK -----	Cut Spike	MCR -----	Middle of Curb Return
DPW -----	Dept. of Public Works	MKD -----	Marked
DR -----	Drive or Driveway	MC -----	Middle of Curve
E/O -----	East of	MON -----	Monument

ABBREVIATIONS USED IN BENCH MARKS (CON'T)

N/O ----- North of
NR ----- Near
OPP ----- Opposite
PI ----- Point of Intersection
PK&W ----- PK Nail and Washer
P/L ----- Property Line
POST ----- Point of Semi-Tangent
PP ----- Power Pole
PVMT ----- Pavement
PROD ----- Produced
RD ----- Road
RDBM ----- Road Dept. Bench Mark
RDBM TAG ----- Road Dept. Bench Mark Tag
RR ----- Railroad
RT ----- Right
R/W ----- Right of Way
SDMH ----- Storm Drain Manhole
SMH ----- Sewer Manhole
SPK ----- Spike
ST&W ----- Spike Tin and Washer
S/O ----- South of
TP ----- Telephone Pole
USC&GS ----- U.S. Coast and Geodetic Survey
USGS ----- U.S. Geological Survey
WK ----- Walk
W/O ----- West of

W A T T S

Q U A D

SOUTH QUAD GATE

VECRANS 3548 3547 6975 547 7886 7887 7884 7885 7882 7883 7880 7881 9326 7879 5718 5717 5716 7875 7877 7876 7875 7874 7872 7971 7970 1085 10163 1083 8191 1081 7889 1078 10162 7867 1076 1074 1073 1072 1071 1070 10161 7866 10161 10160 6973 1067 1066

GARDENA

NGVD 29 DATUM



QUAD

SAN DIEGO

188 TH

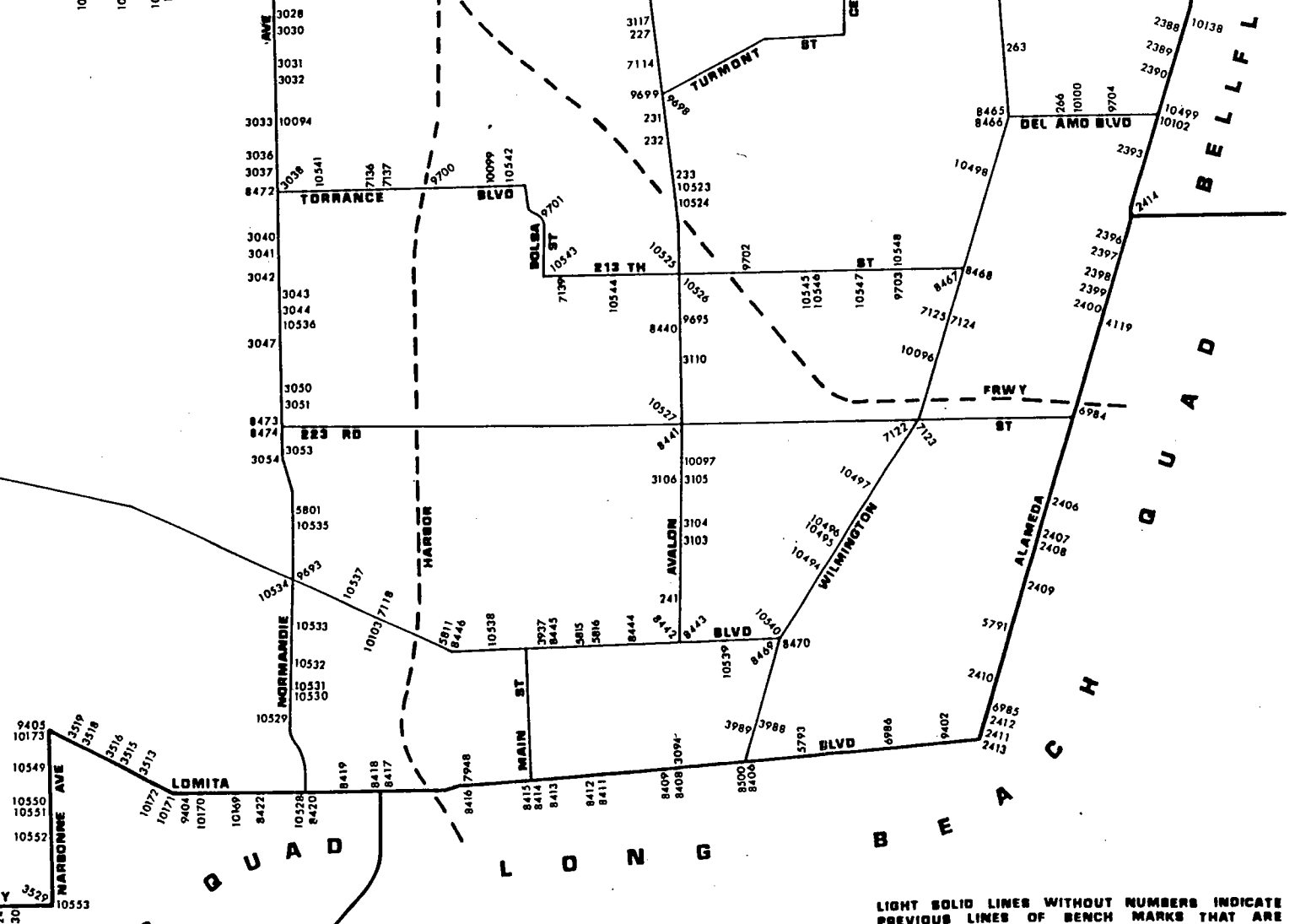

2356 2358 2361 2362 10140 2365 5783 2367 5784 2368 2369 2370 2374 10139 2377 2378 2379 5785 2380 2381 2382 5787 2385 2388 10138 2389 2390 10499 10102 2393 2396 2397 2398 2399 2400 4119 2411 2414 2406 2407 2408 2409 5791 2410 6985 2412 2411 2411 2413

BELFLOWER B E A C H

9405 10173 3519 3518 10549 3516 3515 3513 10550 10551 10552 3529 10553 9404 10170 10171 10172 10199 8422 10228 8420 8419 8418 8417 8416 7948 8415 8414 8413 8412 8411 8409 8408 3094 8500 8406 3989 3988 5793 6986 9402 6985 2412 2411 2411 2413

R D E S QUAD

L O N G

B E A C H

LIGHT SOLID LINES WITHOUT NUMBERS INDICATE PREVIOUS LINES OF BENCH MARKS THAT ARE NOT INCLUDED IN THE 1980 ADJUSTMENT.

HAWTHORNE QUAD

W A T T S

Q U A D

GARDENA

NGVD 29 DATUM



G U A D

T O R R A N C E

P A L O S

V E R D E S

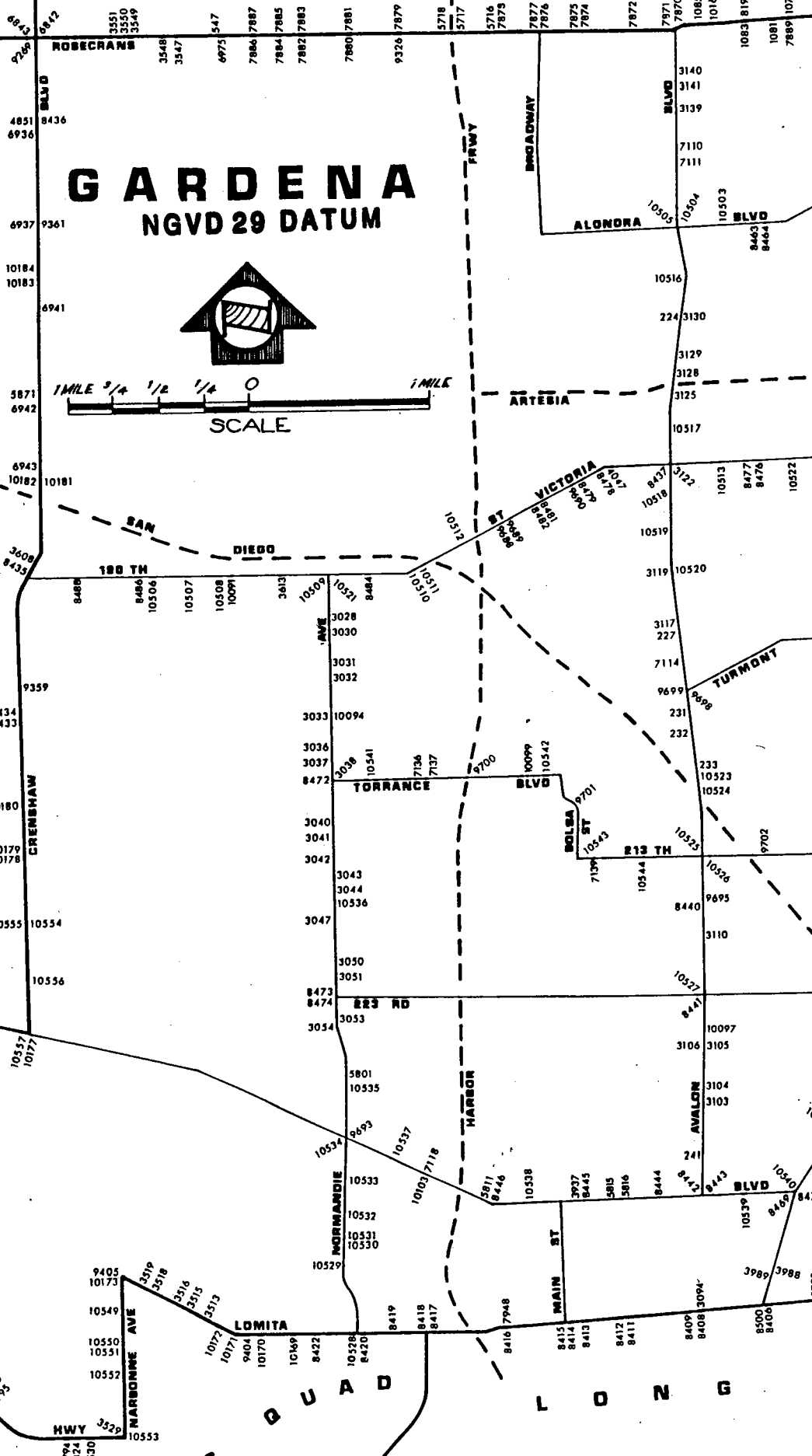

VERDES QUAD

LONG

LOS ANGELES COUNTY PUBLIC WORKS
SURVEY SECTION

QUAD YEAR	ELEV FOOT/METER	DESCRIPTION	BM NUMBER
GARDENA (1994)	48.340 14.734	L&T IN NLY COR CONC WALL AROUND TOWER #1338 @ C/L INT AVALON BLVD & 94M S/O C/L 169TH ST	Y 224
GARDENA (1994)	15.125 4.610	BT SPK IN CONC BASE @ SW COR TOWER #1350 3.4M W C/L AVALON BLVD & 110M N/O C/L ELSMERE DR	Y 227
GARDENA (1994)	12.871 3.923	L&SCREW IN CONC BASE @ NE COR TOWER #1354 3.4M E/O C/L AVALON BLVD & 50M N/O C/L CARSON PLAZA ST (TO THE N)	Y 231A
GARDENA (1994)	37.864 11.541	L&T IN W CB 300MM S/O BCR @ SW COR AVALON BLVD & IDABEL AVE 21M S & 11.6M W/O C/L INT	Y 241
GARDENA (1994)	27.920 8.510	L&BN N CB DEL AMO BLVD 12M N/O C/L & 232M E/O C/L WILMINGTON AVE 7M W/O C/L DRWY TO BLDG #2021	Y 266A
BASELINE (1990)	47.296 14.416	L&T IN CB 300MM S/O BCR @ NE COR WESTERN AVE & ROSECRANS AVE 19.5M N & 12.2M E/O C/L INT	Y 547A
BASELINE (1990)	75.905 23.136	CS MON IN WELL 11.6M N C/L ROSECRANS AVE & 50M E/O C/L DWIGHT ST 11.6M W/O NW COR BRIDGE OVER COMPTON CREEK MKD (CS MON BM 21-2 1952 RE 63)	Y 1073A
BASELINE (1990)	77.369 23.582	L&BN IN N CB 600MM E/O BCR @ NE COR ROSECRANS AVE & DWIGHT ST 11.6M N & 10.7M E/O C/L INT	Y 1074A
BASELINE (1990)	85.088 25.935	L&BN IN CB NR BCR @ SE COR ROSECRANS AVE & TAJAUTA AVE 19.8M S & 7M E/O C/L INT	Y 1076
BASELINE (1990)	100.371 30.593	CS MON IN WELL 1.2M N CF 9.8M E/O BCR @ NE COR ROSECRANS AVE & CENTRAL AVE 32M E & 13.4M N/O C/L INT MKD (BM 21-3 1952 RE 63)	Y 1078A
BASELINE (1990)	105.439 32.138	L&BN IN E CB NR BCR @ SE COR ROSECRANS AVE & KEENE AVE 32.3M S & 7.3M E/O C/L INT	Y 1081
BASELINE (1990)	109.905 33.499	L&T IN S CB ROSECRANS AVE (SER RD) 300MM E/O BCR 23.2M S & 16.8M E/O C/L INT ROSECRANS AVE & CAHITA AVE MKD (BM)	Y 1083A
BASELINE (1990)	114.081 34.772	L&BN IN N CB 300MM W/O BCR @ NW COR ROSECRANS AVE & STANFORD AVE 12.2M N & 15.8M W/O C/L INT	Y 1085A
BASELINE (1990)	68.425 20.856	L&BN 8.5M N/O C/L COMPTON BLVD & 18.3M W/O C/L ALAMEDA ST (E BBL) 3.9M E/O E RAIL SPRR	Y 2356
BASELINE (1990)	68.628 20.918	L&BN IN S CB 8.5M W/O BCR @ SW COR ALAMEDA ST (E BBL) & COMPTON BL 21.3M W & 8.5M S/O C/L INT (1.5M E/O E RAIL SPRR)	Y 2357
BASELINE (1990)	65.230 19.882	L&T IN W CB 7.6M W/O C/L ALAMEDA ST (E BBL) ON C/L PROD LAUREL ST (FR THE E)	Y 2358
BASELINE (1990)	64.938 19.793	CS MON IN WELL 250MM DN 8.2M W/O C/L ALAMEDA ST (E BBL) & 5.5M S/O C/L PROD MYRRH ST (TO THE E) 15.2M E/O C/L SPRR MKD (BM 5-22A)	Y 2361A
BASELINE (1990)	64.429 19.638	L&BN IN W CB ALAMEDA ST (E BBL) 7.6M W/O C/L & 13.4M S/O C/L NLY MOST DRWY TO BLDG #550-A	Y 2362
BASELINE (1990)	62.467 19.040	L&T IN E CB ALAMEDA ST (W BBL) 8.2M E/O C/L ON C/L PROD RAYMOND AVE	Y 2365

NGVD 29 DATUM

LOS ANGELES COUNTY PUBLIC WORKS
SURVEY SECTION

QUAD YEAR	ELEV FOOT/METER	DESCRIPTION	BM NUMBER
BASELINE (1990)	61.863 18.856	L&T IN E CB ALAMEDA ST (W BBL) 8.2M E/O C/L ON C/L PROD TICHNOR ST	Y 2367
BASELINE (1990)	61.614 18.780	L&T IN E CB ALAMEDA ST (W BBL) 7.9M E/O C/L ON C/L PROD CALDELL ST	Y 2368
BASELINE (1990)	61.237 18.665	L&T IN E CB ALAMEDA ST (W BBL) 8.2M E/O C/L ON C/L PROD JOHNSON ST	Y 2369
BASELINE (1990)	61.010 18.596	L&T IN E CB ALAMEDA ST (W BBL) 8.2M E/O C/L ON C/L PROD BENNET ST	Y 2370
BASELINE (1990)	59.695 18.195	USC&GS DISC IN CONC POST 900MM N/O PP MKD #495 11.6M E/O C/L SPRR 34.4M E/O C/L ALAMEDA ST (W BBL) 241M S/O GREENLEAF BLVD MKD (Q 768 1945)	Y 2374
BASELINE (1990)	62.818 19.147	L&BN IN E CB ALAMEDA ST @ ANGLE PT OF WINGWALL @ NE COR BRIDGE #774 OVER COMPTON CREEK 6.7M E/O C/L & 53M N/O C/L CHANNEL & 122M S/O C/L ARTESIA BLVD	Y 2377
BASELINE (1990)	58.077 17.702	FC BR CAP IN S END OF WINGWALL @ NE COR SPRR BRIDGE 27.4M E/O C/L ALAMEDA ST & 137M S/O C/L ARTESIA BLVD MKD (RBM 44-33)	Y 2378
BASELINE (1990)	62.857 19.159	FC BR DISC 1.5M S ANGLE PT OF WINGWALL @ SW COR BRIDGE #774 ON ALAMEDA ST OVER COMPTON CREEK 8.5 M W/O C/L & 183M S/O ARTESIA BL MKD (BM 44-33)	Y 2379
BASELINE (1990)	51.338 15.648	FC BR DISC IN E CB 212M S & 6.7M E/O C/L INT ALAMEDA ST & HOMESTEAD PL 93M N/O C/L ENT TO DOMINGUEZ SEMINARY #18127 MKD (RBM 44-32)	Y 2380
BASELINE (1990)	52.743 16.076	FC BR DISC IN SE COR 2.4MX2.4M CONC VALVE BOX 21.3M S & 38M E/O C/L INT ALAMEDA ST & HOMESTEAD PL 90M N/O C/L ENT TO DOMINGUEZ SEMINARY #18127 MKD (BM 44-32)	Y 2381
BASELINE (1990)	50.453 15.378	L&BN IN W CB ALAMEDA ST 6.7M W/O C/L & 7.3M N/O C/L NLY MOST DRWY TO SO CALIF EDISON SUB-STA 520M S/O HOMESTEAD PL	Y 2382
BASELINE (1990)	45.837 13.971	L&BN IN E CB ALAMEDA ST (W BBL) 6.7M E/O C/L 402M N/O LAUREL PARK RD 77.4M S/O C/L PROD SANTA FE AVE	Y 2385
BASELINE (1990)	42.926 13.084	USGS DISC IN CONC POST 9.1M E C/L SPRR & 16.8M W/O C/L ALAMEDA ST (E BBL) 1:2M N/O PP LU OPP BLDG #19600 AMO BLVD MKD (P 768 1945)	Y 2388
BASELINE (1990)	41.375 12.611	L&BN IN E CB ALAMEDA ST (W BBL) 6.7M E/O C/L & 161M N/O VISTA INDUSTRIA OPP BLDG #19722	Y 2389
BASELINE (1990)	40.915 12.471	CUT SPK IN E CB ALAMEDA ST (W BBL) 6.7M E & 35M S/O C/L VISTA INDUSTRIA (402M N/O DEL AMO BLVD)	Y 2390
BASELINE (1990)	32.684 9.962	L&SPK IN E CB ALAMEDA ST (W BBL) 6.7M E/O C/L & 84M N/O C/L EL PRESIDIO ST (402M S DEL AMO BL)	Y 2393
BASELINE (1990)	29.783 9.078	L&T IN W CB ALAMEDA ST 12.2M W/O C/L ON C/L PROD HARRISON ST ST	Y 2396
BASELINE (1990)	28.865 8.798	L&BN IN W CB ALAMEDA ST 12.2M W/O C/L INT ON C/L PROD JACKSON ST	Y 2397

NGVD 29 DATUM

LOS ANGELES COUNTY PUBLIC WORKS
SURVEY SECTION

QUAD YEAR	ELEV FOOT/METER	DESCRIPTION	BM NUMBER
BASELINE (1990)	28.117 8.570	L&BN IN W CB ALAMEDA ST 12.2M W/O C/L ON C/L PROD MADISON ST	Y 2398
BASELINE (1990)	27.247 8.305	L&BN IN W CB ALAMEDA ST 12.2M W/O C/L ON C/L PROD ADAMS ST	Y 2399
BASELINE (1990)	26.873 8.191	L&BN IN W CB 1.4M N/O BCR @ NW COR ALAMEDA ST & CARSON ST 14.3M N & 12.2M W/O C/L INT	Y 2400
BASELINE (1990)	20.285 6.183	L&BN IN W CB 6.7M W/O C/L ALAMEDA ST & 79M N/O C/L NLY MOST DRWY ENT TO BLDG #23000 & 966M N/O SEPULVEDA BLVD (OPP PP #60270H E SIDE ST)	Y 2406
BASELINE (1990)	17.854 5.442	CSBM MON IN WELL 300MM W/O W CB ALAMEDA ST 11.9 M W/O C/L & 10.4M N/O N END CONC BRIDGE OVER DOMINGUEZ CHANNEL 805M N/O SEPULVEDA BLVD MKD (BM 5-40A 1960 RE 5869)	Y 2407A
BASELINE (1990)	19.537 5.955	FC MON 1.2M E/O E CB ALAMEDA ST 13.4M E C/L @ SE COR BRIDGE #1113 OVER DOMINGUEZ CHANNEL 805M N/O SEPULVEDA BLVD MKD (111-93 1960)	Y 2408A
BASELINE (1990)	17.726 5.403	L&BN IN E CB ALAMEDA ST 12.2M E/O C/L 600MM S/O PP #1108824E & 6.7M S/O S END SLY MOST DRWY TO BLDG #23320 (AIR PRODUCTS/SPECIALTY GAS)	Y 2409
BASELINE (1990)	18.963 5.780	L&BN IN W CB ALAMEDA ST 6.7M W C/L & 19.5M N/O PP (NO #) 366M S/O C/L SEPULVEDA BLVD OPP S EDGE OF STORAGE TANK (PETRO #100061)	Y 2410
BASELINE (1990)	36.345 11.078	RDBM MON 125MM DN IN CONC 600MM W/O W CF ALAMEDA ST 7.3M W/O C/L & 8.2M N/O L.A CITY BDRY SIGN MKD (BM #1) 800M S/O SEPULVEDA BLVD	Y 2411A
BASELINE (1990)	36.611 11.159	L&BN IN W CB ALAMEDA ST 6.7M W C/L & 18.3M N/O CB END 18M S/O PP (NO #) 6.7M S/O ELEC METER BOX ON 1M BY 600MM CONC SLAB 1.8M UP 800M S/O SEPULVEDA BLVD	Y 2412
BASELINE (1990)	36.699 11.186	L&SPK IN W CB ALAMEDA ST 6.7M W C/L & 1.1M N/O CB END 6.1M N/O LA CITY BDRY SIGN 1.4M NE/O LA CITY MON WELL 800M S/O SEPULVEDA BLVD	Y 2413
BASELINE (1990)	31.686 9.658	L&T NR MCR @ SE COR ALAMEDA ST (E BARREL) & DOMINGUEZ ST 6.7M S & 13.7M E/O C/L INT	Y 2414
GARDENA (1994)	47.543 14.491	L&T IN W CB NORMANDIE AVE 9.1M W/O C/L @ C/L PROD KNOX ST (TO THE EAST)	Y 3028
GARDENA (1994)	47.356 14.434	USC&GS MON IN CONC 600MM W/O CF 9.8M W/O C/L NORMANDIE AVE & 32M S/O C/L PROD KNOX ST	Y 3030
GARDENA (1994)	46.568 14.194	RD HD SPK IN W CB NORMANDIE AVE 9M W/O C/L & 119M N/O C/L FRANCISCO ST	Y 3031
GARDENA (1994)	41.870 12.762	CS MON IN WELL 11M W/O W CF NORMANDIE AVE 20.4M W C/L & 110M S/O C/L JON ST 5.4M S PP #279573M NEAR EDISON LINES	Y 3033
GARDENA (1994)	40.827 12.444	L&T IN W CB NORMANDIE AVE ON C/L PROD MILTON ST 9.1M W/O C/L INT	Y 3036

NGVD 29 DATUM

LOS ANGELES COUNTY PUBLIC WORKS
SURVEY SECTION

QUAD YEAR	ELEV FOOT/METER	DESCRIPTION	BM NUMBER
GARDENA (1994)	40.751 12.421	LACE MON 600MM W/O W CF 12.2M S & 9.8M W/O C/L INT NORMANDIE AVE & MILTON ST	Y 3037
GARDENA (1994)	35.984 10.968	L&T IN W CB 19.8M S/O S DRWY TO BLDG #21000 ON C/L PROD 211TH ST 9.1M W/O C/L NORMANDIE AVE	Y 3040
GARDENA (1994)	35.879 10.936	RDBM TAG IN W CB (SER ISL) 300MM N/O BCR @ NE COR NORMANDIE AVE & LEVINSON ST 9.8M N & 9.8M E/O C/L INT	Y 3043A
GARDENA (1994)	37.611 11.464	RDBM TAG IN W CB (SER ISL) @ SE COR NORMANDIE AVE & LEVINSON ST 18.3M S & 9.8M E/O C/L INT	Y 3044A
GARDENA (1994)	45.964 14.010	RDBM MON 50MM DN 600MM W/O CF 16M S/O BCR @ SW COR CARSON ST & NORMANDIE AVE 38.7M S & 9.8M W/O C/L INT MKD (BM 49)	Y 3047A
GARDENA (1994)	44.915 13.690	L&SPK IN W CB NORMANDIE AVE 9.1M W/O C/L ON C/L PROD 221ST ST	Y 3051
BASELINE (1990)	43.563 13.278	LACE MON IN WELL @ C/L INT AVALON BLVD & LOMITA BLVD MKD (CITY OF LA DPW)	Y 3094
GARDENA (1994)	36.168 11.024	L&SPK E CB PKWY 600MM N/O BCR @ NW COR AVALON BLVD & BAYPORT ST 11.6M W & 15.8M N/O C/L INT	Y 3103
GARDENA (1994)	36.332 11.074	L&T IN W CB AVALON BLVD (E CB PKWY) 900MM S/O BCR @ SW COR ALLEY 244M N/O BAYPORT ST & 11.6M W/O C/L AVALON BLVD	Y 3104
GARDENA (1994)	36.253 11.050	L&T IN S CB 10M W/O BCR @ SW COR AVALON BLVD & 228TH ST 30.5M W & 5.5M S/O C/L INT	Y 3105
GARDENA (1994)	36.273 11.056	L&T IN N CB 8.5M W/O BCR @ NW COR AVALON BLVD & 228TH ST 30.5M W & 5.5M N/O C/L INT	Y 3106
GARDENA (1994)	35.613 10.855	CS MON IN WELL @ SW COR AVALON BL & BAYPORT ST 24.4M S & 12.2M W/O C/L INT MKD (BM 23-11 RE 68 1962)	Y 3107A
GARDENA (1994)	21.945 6.689	L&T IN SW COR CONC WK IN FRONT OF BLDG #21808 AVALON BLVD 18.9M E C/L AVALON BLVD & 178M S/O C/L CARSON ST (1.2M W/O BLDG)	Y 3110
GARDENA (1994)	17.815 5.430	L&BN IN CONC BASE OF NE LEG EDISON TOWER #1349 3.4M E/O C/L AVALON BLVD & 49M S/O C/L 192ND ST	Y 3117
GARDENA (1994)	18.632 5.679	CS MON IN WELL 200MM DN 4.6M W C/L TOWER #1348 AVALON BLVD ON APPROX C/L PROD UNIVERSITY DR	Y 3119A
GARDENA (1994)	45.157 13.764	L&BN IN CONC BASE OF NE LEG EDISON TOWER #1344 C/L AVALON BLVD 21.3M S/O C/L VICTORIA ST	Y 3122
GARDENA (1994)	42.024 12.809	L&T IN CONC BASE NE LEG OF EDISON TOWER #1341 3.4M E C/L AVALON BL & 29.3M N C/L ALBERTONI ST	Y 3125
GARDENA (1994)	48.337 14.733	L&PK IN CONC BASE OF NE LEG EDISON TOWER #1340 3.4M E/O C/L AVALON BLVD & 76M N/O (91) FRWY	Y 3128A
GARDENA (1994)	51.539 15.709	L&SPK IN CONC BASE OF SE LEG EDISON TOWER #1339 3.4M E C/L AVALON BL & 38.1M N/O C/L WALNUT ST	Y 3129

NGVD 29 DATUM

LOS ANGELES COUNTY PUBLIC WORKS
SURVEY SECTION

QUAD YEAR	ELEV FOOT/METER	DESCRIPTION	BM NUMBER
GARDENA (1994)	47.080 14.350	L&T IN CONC BASE OF NE LEG EDISON TOWER #1338 3.4M E C/L AVALON BL & 98M S/O C/L 169TH ST	Y 3130
GARDENA (1994)	88.202 26.884	WIRE SPK IN W CB 1.2M N/O BCR @ NW COR AVALON BLVD & COMPTON BLVD 19.2M N & 12.2M W/O C/L INT	Y 3139A
GARDENA (1994)	95.177 29.010	L&BN IN W CB AVALON BLVD 12.2M W/O C/L & 317M N/O C/L COMPTON BLVD MKD (BM) S/O BLDG #14733	Y 3140A
GARDENA (1994)	95.298 29.047	L&BN IN E CB AVALON BL 12.2M E/O C/L & 320M N/O COMPTON BLVD (OPP & S/O BLDG #14733)	Y 3141A
BASELINE (1990)	55.853 17.024	CS MON IN WELL @ C/L INT LOMITA BL & WALNUT AVE MKD (CO ENG RE 5869)	Y 3513A
BASELINE (1990)	63.871 19.468	CS MON IN WELL @ C/L INT LOMITA BLVD & ESHELMAN AVE MKD (CO ENG RE 5869)	Y 3516A
BASELINE (1990)	68.822 20.977	L&T IN W CB 1M S/O BCR @ SW COR LOMITA BL & OAK ST 20.3M S & 4.6M W/O C/L INT	Y 3518
BASELINE (1990)	69.081 21.056	L&BN IN S CB 300MM E/O BCR @ SE COR WOODWARD AVE & LOMITA BLVD 18M E & 13.7M S/O C/L INT	Y 3519
BASELINE (1990)	121.210 36.945	L&BN IN N CB 300MM W BCR @ NW COR NARBONNE AVE & PACIFIC COAST HWY 17.7M W & 11.3M N/O C/L INT	Y 3529
BASELINE (1990)	131.371 40.042	L&BN IN N CB 600MM W/O BCR @ NW COR PACIFIC COAST HWY & CYPRESS ST 11M N & 13.7M W/O C/L INT	Y 3530
BASELINE (1990)	44.879 13.679	L&T IN S CB 300MM E/O BCR @ SE COR ROSECRANS AVE & GRAMERCY PL 12.2M E & 12.2M S/O C/L INT	Y 3547A
BASELINE (1990)	44.573 13.586	L&T IN W CB 300MM S/O BCR @ SW COR ROSECRANS AVE & GRAMERCY PL 18.3M S & 5.5M W/O C/L INT	Y 3548A
BASELINE (1990)	45.046 13.730	RDBM TAG IN S CB 1.2M E BCR @ SE COR ROSECRANS AVE & VAN NESS AVE 20.7M E & 12.2M S/O C/L INT	Y 3549A
BASELINE (1990)	46.197 14.081	RDBM TAG IN W CB 1.2M N/O BCR @ NW COR VAN NESS AVE & ROSECRANS AVE 23.5M N & 9.1M W/O C/L INT	Y 3550A
BASELINE (1990)	44.295 13.501	CS MON 450MM W/O CF @ SW COR ROSECRANS AVE & VAN NESS AVE 27.4M S & 9.1M W/O C/L INT MKD (BM 21-10 1952 RE 63)	Y 3551
BASELINE (1990)	56.033 17.079	SPK IN W CB (SER RD) 5.5M S BCR @ SW COR 189TH ST & CRENSHAW BL 18.3M S & 23.5M W/O C/L INT	Y 3608A
GARDENA (1994)	40.554 12.361	LACE TAG IN N CB 1.5M E BCR @ NW COR SEPULVEDA BLVD & MAIN ST 20.4M W & 13.4M N/O C/L INT	Y 3937A
GARDENA (1994)	40.102 12.223	L&BN IN CONC BASE OF NE LEG TOWER #1378 15.2M W/O C/L WILMINGTON AVE (1ST TOWER S/O SPRR)	Y 3989
GARDENA (1994)	23.376 7.125	L&BR 300MM S/O BCR @ SW COR WALL ST & VICTORIA ST (SERVICE RD) 33.8M S & 5.5M W/O C/L INT	Y 4047
BASELINE (1990)	50.541 15.405	RD HD SPK 1.8M N/O BCR @ NW COR CRENSHAW BLVD & MARINE AVE 18.3M N & 11.6M W/O C/L INT	Y 4851

NGVD 29 DATUM

LOS ANGELES COUNTY PUBLIC WORKS
SURVEY SECTION

QUAD YEAR	ELEV FOOT/METER	DESCRIPTION	BM NUMBER
BASELINE (1990)	99.659 30.376	LACE MON IN WELL @ OR NR C/L INT FIGUEROA ST & ROSECRANS AVE MKD (TRAV STA WATTS C 12 B 1946)	Y 5716
BASELINE (1990)	90.453 27.570	BT SPK IN N CB HARBOR FRWY OVERPASS 10.8M W BCR 12.8M N C/L ROSECRANS AVE & 21.3M E/O C/L FRWY	Y 5717
BASELINE (1990)	89.117 27.163	L&SPK IN N CB 600MM E/O BCR @ NE COR ROSECRANS AVE & HOOVER ST 12.8M N & 7M E/O C/L INT 48.5M W/O C/L HARBOR (110) FRWY	Y 5718
BASELINE (1990)	63.852 19.462	RD MON IN N END OF CONC HDWL CULV 13.7M W/O C/L ALAMEDA ST (E BBL) & 5.2M S/O C/L PROD RAYMOND ST 8.2M E/O C/L MAIN TRACK SPRR MKD (BM 19)	Y 5783
BASELINE (1990)	63.694 19.414	USC&GS MON IN S END CULV HDWL 3M W/O C/L SPRR & 21.3M E/O C/L ALAMEDA ST (W BBL) 27.4M N/O C/L PROD CALDWELL ST MKD (T 615 1941)	Y 5784
BASELINE (1990)	54.810 16.706	MWD MON 900MM E/O E CB ALAMEDA ST 7.9M E/O C/L & 34.4M S/O C/L PROD HOMESTEAD PL MKD (56Z 1933)	Y 5785
BASELINE (1990)	49.212 15.000	USC&GS MON IN N END SFRR CULV HDWL 2.4M W C/L TRACKS 20.4M E/O C/L ALAMEDA ST & 106M N/O C/L AC DRWY W ENT TO FIRE STA MKD (F 52 1926) 644M N/O LAUREL PARK RD	Y 5787
BASELINE (1990)	16.424 5.006	RD BR CAP IN W CB ALAMEDA ST 10.7M W C/L & 13.7 M S/O C B MKD (BM X) 88M N/O C/L SEPULVEDA BLVD	Y 5791
BASELINE (1990)	137.050 41.773	L&BN IN S CB PACIFIC COAST HWY 11.6M S/O C/L & 5.5M W/O C/L PROD REED DR	Y 5794
BASELINE (1990)	139.117 42.403	L&SCREW IN N CB 300MM E/O BCR @ NE COR PACIFIC COAST HWY & CRENSHAW BLVD 23.2M E & 12.2M N/O C/L INT	Y 5795
BASELINE (1990)	140.541 42.837	RDBM TAG IN N CB 300MM E/O BCR @ NW COR PACIFIC COAST HWY & CRENSHAW BLVD 19.8M W & 12.2M N/O C/L INT	Y 5796
BASELINE (1990)	94.846 28.909	CS BR CAP MON IN WELL @ C/L INT PACIFIC COAST HWY & HAWTHORNE BL MKD (TOR K-12 1942 RE 2177)	Y 5799
GARDENA (1994)	37.159 11.326	L&T IN N CB 300MM W/O BCR @ NW COR SEPULVEDA BLVD & DELORES ST 12.8M N & 17.1M W/O C/L INT	Y 5815
GARDENA (1994)	37.484 11.425	L&BN IN E CB 7.6M N/O BCR @ NE COR SEPULVEDA BLVD & DOLORES ST 28.7M N & 8.5M E/O C/L INT	Y 5816
BASELINE (1990)	53.596 16.336	LACE BR CAP MON IN WELL @ C/L INT ARTESIA BLVD & CRENSHAW BLVD MKD (TORRANCE M-4)	Y 5871
GARDENA (1994)	97.684 29.774	L&T IN CB RET 4.3M E/O BCR @ NW COR ALONDRA BL & CENTRAL AVE 12.2M N & 16.8M W/O C/L INT	Y 5878
GARDENA (1994)	96.653 29.460	L&SPK IN CB 900MM W/O BCR @ SE COR ALONDRA BLVD & CENTRAL AVE 23.2M E & 11.6M S/O C/L INT	Y 5879
GARDENA (1994)	94.084 28.677	L&T IN E CB 1.8M S/O BCR @ SE COR CENTRAL AVE & CALDWELL ST 21M S & 11.6M E/O C/L INT	Y 5881

NGVD 29 DATUM

LOS ANGELES COUNTY PUBLIC WORKS
SURVEY SECTION

QUAD YEAR	ELEV FOOT/METER	DESCRIPTION	BM NUMBER
BASELINE (1990)	50.023 15.247	CS BM MON IN E WALL FC CHANNEL 1.8M N/O CF 14M N & 58.2M E/O C/L INT ROSECRANS AVE & CRENSHAW AVE MKD (21-11A 1964 RE 5869)	Y 6842
BASELINE (1990)	49.751 15.164	L&BN IN E CB 300MM N/O BCR @ NE COR CRENSHAW BL & ROSECRANS AVE 23.2M N & 11.6M E/O C/L INT	Y 6843
BASELINE (1990)	97.477 29.711	L&BN IN E CB 1M S/O BCR 19.2M S/O PACIFIC COAST HWY & 16.4M SELY/O C/L HAWTHORNE BLVD	Y 6922
BASELINE (1990)	49.400 15.057	CS BR MON IN WELL 600MM W/O CF @ SW COR MARINE AVE & CRENSHAW BLVD 12.2M W/O & 58.2M S/O C/L INT MKD (BM 22-1A 1953 RE 63)	Y 6936
BASELINE (1990)	47.306 14.419	SPK IN S CB 2.1M W/O BCR @ SW COR CRENSHAW BL & MANHATTAN BEACH BL 26M W & 13M S/O C/L INT	Y 6937
BASELINE (1990)	38.770 11.817	CS BR CAP MON IN WELL 300MM N/O CF 600MM E/O BCR @ NE COR 166TH ST ATKINSON AVE 5.5M N & 11.8M E/O C/L INT MKD (BM 22-3A 1960 RE 5869)	Y 6941
BASELINE (1990)	55.128 16.803	L&BN IN W CB 600MM N/O BCR @ SW COR CRENSHAW BLVD & ARTESIA BLVD 20M S & 11.6M W/O C/L INT	Y 6942
BASELINE (1990)	63.307 19.296	L&BR IN S CB 900MM W/O BCR @ SW COR CRENSHAW BLVD & 181ST ST 24.4M W & 5.5M S/O C/L INT	Y 6943
BASELINE (1990)	78.376 23.889	CS BM MON IN WELL 225MM DN ON C/L MEDIAN 37.8M N & 1.5M E/O C/L INT HAWTHORNE BLVD & 230TH ST MKD (BM 22-15A 1960 RE 5869)	Y 6955
BASELINE (1990)	70.371 21.449	CS MON 200MM DN @ NE COR ROSECRANS AV & OLEANDER ST 21.6M E & 11.9M N C/L INT MKD (BM 21-1 1952)	Y 6973
BASELINE (1990)	45.889 13.987	CS MON 250MM DN 300MM N/O CF @ NE COR ROSECRANS AVE & WESTERN AVE 54.6M E & 12.5M N/O C/L INT MKD (BM 21-9A 1960 RE 5869)	Y 6975
BASELINE (1990)	34.491 10.513	CS BM IN CONC 767M W C/L ALAMEDA ST & 18.3M E/O C/L BLINN AVE 600MM S/O 1.8M CH LINK FENCE TO TANK FARM MKD (BM 5-80 1964 RE 5869) 50MM MKR POST 900MM UP & 600MM S/O MON	Y 6986
GARDENA (1994)	73.254 22.328	RDBM TAG IN W CB 300MM S/O BCR @ SW COR AVALON BL & 154TH ST 15.5M S & 12.2M W/O APPROX C/L INT	Y 7110
GARDENA (1994)	73.218 22.317	RD HD SPK IN E CB 4.6M S/O BCR @ SE COR AVALON BL & 154TH ST 20.1M S & 12.2M E/O APPROX C/L INT	Y 7111
GARDENA (1994)	12.986 3.958	FC BR CAP FL IN SW COR EDISON TOWER #1351 3.4M W/O C/L AVALON BLVD & 107M S/O C/L ELSMERE DR MKD (BM 112-02120 1964)	Y 7114
GARDENA (1994)	26.749 8.153	L&BN IN E CB 18.3M S/O BCR @ SE COR SEPULVEDA BLVD & VERMONT AVE 12.8M E & 57.6M S/O C/L INT	Y 7118
GARDENA (1994)	23.363 7.121	FC MON @ SELY COR WILMINGTON AVE & 223RD ST 29M E & 13.7M S/O APPROX C/L INT MKD (BM 111-13445) @ E END OF BRIDGE	Y 7122
GARDENA (1994)	22.759 6.937	RDBM TAG IN CB 300MM E BCR @ NE COR WILMINGTON AVE & 223RD ST 12.8M N & 23M E APPROX C/L INT	Y 7123

NGVD 29 DATUM

LOS ANGELES COUNTY PUBLIC WORKS
SURVEY SECTION

QUAD YEAR	ELEV FOOT/METER	DESCRIPTION	BM NUMBER
GARDENA (1994)	22.320 6.803	RDBM TAG IN S CB 300MM E/O BCR @ SE COR CARSON ST & WILMINGTON AVE 13.7M S & 17.7M E/O C/L INT	Y 7124
GARDENA (1994)	22.526 6.866	RDBM TAG IN S CB 10.7M E/O BCR @ SE COR VERMONT AVE & TORRANCE BLVD 9.1M S & 33.5M E/O APPROX C/L INT	Y 7137
GARDENA (1994)	24.209 7.379	RE TAG #1316 IN S CB 900MM E BCR @ SE COR 213TH ST & ORRICK AVE 6.1M S & 14.3M E APPROX C/L INT	Y 7139
BASELINE (1990)	72.165 21.996	L&BN IN S CB 1.5M E/O BCR @ SE COR ROSECRANS AVE & ARANBE AVE 11.6M S & 10.7M E/O C/L INT	Y 7866
BASELINE (1990)	85.374 26.022	L&T IN S CB 2.7M W/O BCR @ SW COR ROSECRANS AVE TAJAUTA AVE 20.7M W & 12.2M S/O C/L INT	Y 7867
BASELINE (1990)	113.953 34.733	RDBM TAG IN CB RET 1.5M N/O BCR @ SE COR AVALON BL & ROSECRANS AVE 19.8M S & 12.5M E/O C/L INT	Y 7870
BASELINE (1990)	112.798 34.381	RDBM TAG IN S CB 1.2M W BCR @ SW COR ROSECRANS AVE & AVALON BLVD 24.4M W & 12.2M S/O C/L INT	Y 7871
BASELINE (1990)	105.482 32.151	RDBM TAG IN E CB 1.2M S BCR @ SE COR ROSECRANS AVE & SAN PEDRO ST 26.2M S & 9.8M E/O C/L INT	Y 7872
BASELINE (1990)	112.424 34.267	RD BM TAG IN N CB 900MM E/O BCR @ NE COR MAIN & ROSECRANS AVE 23.2M E & 12.2M N/O C/L INT	Y 7874
BASELINE (1990)	112.182 34.193	CS MON IN WELL 200MM DN 600MM W/O CF @ SW COR ROSECRANS AVE & MAIN ST 22.6M S & 12.8M W/O C/L INT MKD (BM 21-5A 1970 RE 5869)	Y 7875
BASELINE (1990)	113.947 34.731	RDBM TAG IN W CB 1.2M S BCR @ SW COR ROSECRANS AVE & BROADWAY 24.4M S & 12.2M W/O C/L INT	Y 7877
BASELINE (1990)	100.679 30.687	RDBM TAG IN CB 600MM S/O BCR @ SE COR ROSECRANS AVE & FIGUEROA ST 19.8M S & 12.2M E/O C/L INT	Y 7878
BASELINE (1990)	60.000 18.288	RDBM TAG IN S CB 900MM W BCR @ SW COR ROSECRANS AVE & VERMONT AVE (W BBL) 14.6M W & 12.8M S/O C/L INT	Y 7879
BASELINE (1990)	52.014 15.854	RDBM TAG IN S CB 300MM E BCR @ SE COR ROSECRANS AVE & BUDLONG AVE 13.7M E & 12.2M S/O C/L INT	Y 7880
BASELINE (1990)	51.391 15.664	RDBM TAG IN W CB 300MM S BCR @ SW COR ROSECRANS AVE & BUDLONG AVE 20.1M S & 5.5M W/O C/L INT	Y 7881
BASELINE (1990)	47.234 14.397	RDBM TAG IN E CB 12.2M S BCR @ SE COR ROSECRANS AVE & NORMANDIE AVE 32.9M S & 9.1M E/O C/L INT	Y 7882
BASELINE (1990)	46.985 14.321	RDBM TAG IN CB 900MM E/O BCR @ SW COR ROSECRANS AVE & NORMANDIE AVE 18.9M W & 12.2M S/O C/L INT	Y 7883
BASELINE (1990)	45.938 14.002	RDBM TAG IN S CB 7M E/O BCR @ SE COR ROSECRANS AVE & HALLDALE AVE 20.1M E & 12.2M S/O C/L INT	Y 7884
BASELINE (1990)	45.728 13.938	RDBM TAG IN W CB 1.5M S BCR @ SW COR ROSECRANS AVE & HALLDALE AVE 21.6M S & 5.5M W/O C/L INT	Y 7885
BASELINE (1990)	45.184 13.772	RDBM TAG IN CB 300MM N/O BCR @ SE COR ROSECRANS AVE & DENKER AVE 19.5M S & 5.5M E/O C/L INT	Y 7886

NGVD 29 DATUM

LOS ANGELES COUNTY PUBLIC WORKS
SURVEY SECTION

QUAD YEAR	ELEV FOOT/METER	DESCRIPTION	BM NUMBER
BASELINE (1990)	45.702 13.930	RDBM TAG IN S CB 1.5M W BCR @ SW COR ROSECRANS AVE & DENKER AVE 14.9M W & 12.2M S/O C/L INT	Y 7887
BASELINE (1990)	35.423 10.797	CITY LA MON IN SE COR C B @ NE COR LOMITA BLVD & FIGUEROA ST 22.6M N & 13.1M E/O C/L INT MKD (PBM 21-02860 1967)	Y 7948
BASELINE (1990)	110.938 33.814	L&T IN S CB ROSECRANS AVE (N CB ISLE) 12.8M S & 16M W/O C/L INT ROSECRANS AVE & CAHITA AVE	Y 8191
BASELINE (1990)	42.018 12.807	CITY LA DPW BM DISC IN PORCH OF DEPT WATER & POWER BLDG #900 LOMITA BLVD 18M S/O C/L & 61M E/O C/L WILMINGTON AVE	Y 8406
BASELINE (1990)	44.088 13.438	RDBM TAG IN E CB 300MM S/O BCR @ NE COR LOMITA BLVD & AVALON BLVD 12.2M E & 21.6M N/O C/L INT	Y 8408
BASELINE (1990)	44.009 13.414	RDBM TAG IN N CB 300MM W/O BCR @ NW COR LOMITA BLVD & AVALON BLVD 12.2M N & 19.2M W/O C/L INT	Y 8409
BASELINE (1990)	41.355 12.605	L&SPK IN CB 7M W/O BCR @ SW COR LOMITA BLVD & BAY VIEW AVE 11.6M S & 21.3M W/O C/L INT	Y 8412
BASELINE (1990)	40.420 12.320	LACE MON 3M S/O C/L LOMITA BLVD ON C/L GULF AVE MKD (LA CITY 1970)	Y 8413
BASELINE (1990)	40.564 12.364	LACE MON FL 5.5M S/O BCR @ SW COR LOMITA BLVD & WILMINGTON BLVD (MAIN ST) 29.3M S & 8.5M W/O C/L INT MKD (PBM 21-03269 1967)	Y 8414
BASELINE (1990)	40.148 12.237	SPK&L 1.2M W/O BCR @ NW COR LOMITA BLVD & MAIN ST (WILMINGTON BLVD) 12.8M N & 24.4M W/O C/L INT	Y 8415
BASELINE (1990)	35.430 10.799	RDBM TAG IN CB 300MM W/O BCR @ NW COR LOMITA BL & FIGUEROA ST 12.8M N & 25.6M W/O C/L INT	Y 8416
BASELINE (1990)	33.392 10.178	RD BM TAG IN CB 1.2M S/O BCR @ SE COR LOMITA BLVD & VERMONT AVE 24.2M S & 12.8M E/O C/L INT	Y 8417
BASELINE (1990)	36.106 11.005	LACE MON FL 1.2M S/O CF @ SW COR LOMITA BLVD & VERMOUNT BLVD 14M S & 23.2M W/O C/L INT MKD (PBM 21-06880)	Y 8418
BASELINE (1990)	55.640 16.959	LACE MON FL 1.2M W/O CF @ SW COR LOMITA BLVD & PETROLEUM AVE 22.3M S & 7M W/O C/L INT MKD (PBM 21-06881)	Y 8419
BASELINE (1990)	68.172 20.779	RDBM TAG IN CB 600MM E/O BCR @ SE COR LOMITA BL & NORMANDIE AVE 12.8M S & 24.1M E/O C/L INT	Y 8420
BASELINE (1990)	69.219 21.098	HEX DRILL IN WELL 4.6M S/O C/L INT LOMITA BLVD ON C/L BELLE PORTE AVE	Y 8422
BASELINE (1990)	137.959 42.050	USC&GS MON 600MM W/O BCR @ SW COR PACIFIC COAST HWY & VIANA AVE 11.6M S & 12.2M W/O C/L INT MKD (E 767 RESET 1960)	Y 8424
BASELINE (1990)	76.493 23.315	CE MON IN WELL 87M N/O C/L 238TH ST & 12.5M E/O C/L HAWTHORNE BL MKD (TOR K11 RESET 1961 RE5869)	Y 8425
BASELINE (1990)	77.434 23.602	CS BM MON IN WELL 1.8M E/O C/L HAWTHORNE BL & 30.5M N/O C/L SKYPARK DR (TO THE W) IN MEDIAN MKD (BM 22-16B 1965 RE 5869)	Y 8426
BASELINE (1990)	77.349 23.576	RDBM TAG IN E CB 600MM N/O BCR @ NE COR LOMITA BLVD & HAWTHORNE BLVD 17 E & 21M N/O C/L INT	Y 8428

NGVD 29 DATUM

LOS ANGELES COUNTY PUBLIC WORKS
SURVEY SECTION

QUAD YEAR	ELEV FOOT/METER	DESCRIPTION	BM NUMBER
BASELINE (1990)	78.271 23.857	RAM SET IN CB 300MM S/O BCR @ NE COR HAWTHORNE BLVD & 230TH ST 12.2M N & 16.8M E/O C/L INT	Y 8429
BASELINE (1990)	78.966 24.069	CS MON IN C B 300MM S/O CF @ SE COR SEPULVEDA BL & MADRONA AVE 31M E & 13.7M S/O C/L INT MKD (BM 22-12B 1970 RE 5869)	Y 8430
BASELINE (1990)	83.448 25.435	L&BR IN CB RET 300MM E/O BCR @ SW COR SEPULVEDA BLVD & MAPLE AVE 11.6M S & 19.2M W/O C/L INT	Y 8431
BASELINE (1990)	68.701 20.940	RDBM TAG IN E CB 2.4M S/O BCR @ SE COR CRENSHAW BLVD & DEL AMO BLVD 31.4M S & 12.5M E/O C/L INT	Y 8433
BASELINE (1990)	68.517 20.884	RDBM TAG IN E CB 600MM N BCR @ NE COR CRENSHAW BLVD & DEL AMO BLVD 20.7M N & 12.5M E/O C/L INT	Y 8434
BASELINE (1990)	49.908 15.212	CS MON 50MM DN 600MM W/O CF @ SW COR MARINE AVE & CRENSHAW BLVD 23.8M S & 12.2M W/O C/L INT MKD (BM 22-1 1952 RE 63)	Y 8436
GARDENA (1994)	44.616 13.599	L&BR IN CB 150MM S/O BCR @ SE COR AVALON BLVD & VICTORIA ST 22.3M S & 19.5M E/O C/L INT	Y 8437
GARDENA (1994)	20.718 6.315	LACE MON FL 13.4M S/O C/L CARSON ST & 39.6M W/O C/L AVALON BLVD MKD (PBM 21-07711 1969)	Y 8440
GARDENA (1994)	29.383 8.956	L&BN IN N CB NR BCR @ NE COR AVALON BLVD 223RD ST 12.8M N & 22.9M E/O C/L INT	Y 8441
GARDENA (1994)	37.424 11.407	L&SPK IN CB 19.2M W/O BCR @ SW COR AVALON BLVD & SEPULVEDA BLVD 12.8M S & 43.6M W/O C/L INT	Y 8443
GARDENA (1994)	36.306 11.066	L&SPK IN N CB 4.3M E/O BCR @ NE COR SEPULVEDA BLVD & PANAMA AVE 12.8M N & 18.3M E/O C/L INT	Y 8444
GARDENA (1994)	41.014 12.501	L&BN IN E CB OF ISLAND 25M N/O C/L SEPULVEDA BLVD & 1.5M E/O C/L MAIN ST	Y 8445
GARDENA (1994)	21.411 6.526	SPK IN NE COR OF C B @ NE COR SEPULVEDA BLVD & FIGUEROA ST 23.2M N & 11.6M E/O C/L INT	Y 8446
GARDENA (1994)	91.004 27.738	RDBM TAG IN S CB 300MM W/O BCR @ SW COR ALONDRA BLVD & CASWELL AVE 11.6M S & 19M W/O C/L INT	Y 8463
GARDENA (1994)	92.848 28.300	L&SPK IN S CB 2.4M E/O BCR @ SE COR CASWELL AVE & ALONDRA BLVD 11.6M S & 19M E/O C/L INT	Y 8464
GARDENA (1994)	25.837 7.875	L&BR IN N CB 20.4M W/O BCR @ NW COR WILMINGTON AVE & DEL AMO BLVD 12.2M N & 48M W/O C/L INT	Y 8465
GARDENA (1994)	25.810 7.867	L&BR IN S CB 34.7M W/O BCR @ SW COR WILMINGTON AVE & DEL AMO BLVD 13.7M S & 64M W/O C/L INT	Y 8466
GARDENA (1994)	23.615 7.198	RDBM TAG IN N CB 300MM W/O BCR @ NW COR 213TH ST & WILMINGTON AVE 6.1M N & 19.8M W/O C/L INT	Y 8467
GARDENA (1994)	23.054 7.027	L&BN IN W CB 600MM S/O BCR @ SW COR WILMINGTON AVE & 213TH ST 25.6M S & 12.2M W/O C/L INT	Y 8468

NGVD 29 DATUM

LOS ANGELES COUNTY PUBLIC WORKS
SURVEY SECTION

QUAD YEAR	ELEV FOOT/METER	DESCRIPTION	BM NUMBER
GARDENA (1994)	39.029 11.896	RDBM TAG IN W CB 600MM N BCR @ NW COR NORMANDIE AVE & TORRANCE BLVD 16.8M N & 9.1M W/O C/L INT	Y 8472
GARDENA (1994)	46.001 14.021	RDBM TAG IN W CB 600MM S/O BCR @ SW COR 223RD ST & NORMANDIE AVE 19.2M S & 9.1M W/O C/L INT	Y 8474
GARDENA (1994)	90.161 27.481	L&BR IN CB RET 1.8M E/O BCR @ NW COR VICTORIA ST & TAMCLIFF AVE 13.1M N & 11.6M W/O C/L INT	Y 8477
GARDENA (1994)	18.711 5.703	MWD TAG IN CB 900MM W/O BCR @ SE COR VICTORIA ST & CAIRO AVE 22.9M S & 13.7M E/O C/L INT MKD (22046)	Y 8478
GARDENA (1994)	23.822 7.261	L&BN IN E CB 19.2M S/O BCR @ SE COR VICTORIA ST & MAIN ST 33.5M S & 13.1M E/O C/L INT	Y 8479
GARDENA (1994)	22.369 6.818	LACE MON IN C B @ NE COR VICTORIA ST & BROADWAY 12.8M N & 38M E/O C/L INT MKD PBM 21-08189 1968	Y 8481
GARDENA (1994)	22.825 6.957	L&BN 300MM W/O CB FACE @ NW COR VICTORIA ST & BROADWAY 11.9M W & 21.3M N/O C/L INT	Y 8482
GARDENA (1994)	39.944 12.175	RDBM TAG IN N CB 190TH ST 12M N/O C/L & 32M W/O C/L PROD PACIFIC GATEWAY DR	Y 8484
GARDENA (1994)	62.444 19.033	CS BM MON IN WELL @ NE COR 190TH ST & VAN NESS AVE 16.2M N & 13.1M E/O C/L INT MKD (TOR 5.1)	Y 8486
BASELINE (1990)	40.689 12.402	RD HD SPK IN N CB 600MM W/O BCR @ NW COR LOMITA BL & WILMINGTON AVE 12.2M N & 13.7M W/O C/L INT	Y 8500
BASELINE (1990)	51.014 15.549	CS BM MON IN SLY WALL DOMINGUEZ CHANNEL 300MM SW/O SW COR BRIDGE #1276 @ SW COR ROSECRANS AVE CRENSHAW BLVD 73.5M S & 13.1M W/O C/L INT MKD (21-12A 1964 RE 5869)	Y 9269
BASELINE (1990)	62.546 19.064	RDBM TAG IN N CB 300MM E BCR @ NE COR ROSECRANS AVE & VERMONT AVE (E BBL) 15.2M E & 12.8M N/O C/L INT	Y 9326
BASELINE (1990)	65.384 19.929	CS BR DISC IN S END C B 300MM E/O CF 12.5M E/O C/L CRENSHAW BLVD & 322M N/O C/L DEL AMO BLVD MKD (BM 22-7D 1970 RE 5869)	Y 9359
BASELINE (1990)	47.749 14.554	CS BM MON IN W END C B 9.8M E/O BCR @ SE COR CRENSHAW BLVD & MANHATTAN BEACH BLVD 32.6M E & 13.1M S/O C/L INT MKD (BM 22-2B 1974 RE 7078)	Y 9361
BASELINE (1990)	49.642 15.131	RD BM TAG IN N CB 9.6M E/O BCR @ NE COR LOMITA BLVD & WESTERN AVE 12.2M N & 33.5M E/O C/L INT	Y 9404
BASELINE (1990)	69.629 21.223	L&BR IN CB RET 4.6M E/O BCR @ NW COR LOMITA BL NARBONNE AVE 15.2M W & 13.7M N/O C/L INT	Y 9405
BASELINE (1990)	132.529 40.395	RDBM TAG IN N CB 600MM E/O BCR @ NE COR PACIFIC COAST HWY & ROBINSON WAY (TO THE N) 12.2M N & 20.1M E/O C/L INT	Y 9408
BASELINE (1990)	130.495 39.775	RDBM TAG IN CB RET 600MM E BCR @ NW COR PACIFIC COAST HWY & ROBINSON WAY (TO THE N) 12.2M N & 19.8M W/O C/L INT	Y 9409
BASELINE (1990)	125.781 38.338	L&BR 600MM W/O BCR @ SW COR PACIFIC COAST HWY & WINLOCK DR 15.8M W & 11M S/O C/L INT	Y 9410

NGVD 29 DATUM

LOS ANGELES COUNTY PUBLIC WORKS
SURVEY SECTION

QUAD YEAR	ELEV FOOT/METER	DESCRIPTION	BM NUMBER
GARDENA (1994)	156.971 47.845	RDBM TAG IN E CB 300MM N BCR @ NE COR VICTORIA ST & WILMINGTON AVE 20.4M N & 12.8M E/O C/L INT	Y 9682
GARDENA (1994)	124.406 37.919	RDBM TAG ELY CB NR THE SELY COR OF BRIDGE OVER FRWY 13M E & 49M N/O APPROX C/L INT WILMINGTON AVE & SLY SERV RD TO (91) FRWY	Y 9683
GARDENA (1994)	123.953 37.781	RDBM TAG IN ELY CB NR THE NELY COR BRIDGE OVER FRWY 12.8M E & 128M N/O APPROX C/L WILMINGTON AVE SLY (SERV RD) TO REDONDO BEACH FRWY (91)	Y 9684
GARDENA (1994)	26.381 8.041	RDBM TAG IN N CB 300MM W BCR @ NW COR 190TH ST & FIGUEROA ST 12.2M N & 14M W/O C/L INT	Y 9688
GARDENA (1994)	25.804 7.865	RDBM TAG 300MM E/O BCR @ SE COR VICTORIA ST & FIGUEROA ST 12.2M S & 14.3M E/O C/L INT	Y 9689
GARDENA (1994)	24.117 7.351	RDBM TAG IN CB 300MM E/O BCR @ NE COR VICTORIA ST & MAIN ST 12.8M N & 38.4M E/O C/L INT	Y 9690
GARDENA (1994)	56.099 17.099	RDBM TAG IN CB 300MM E/O BCR @ SE COR SEPULVEDA BLVD NORMANDIE AVE 13.4M S & 32M E/O C/L INT	Y 9693
GARDENA (1994)	20.367 6.208	BR CAP MON IN CONC FL WITH WALK @ NE COR AVALON BL & CARSON ST 18.3M N & 18.3M E/O C/L INT MKD (CITY OF CARSON-ELEVATION-FEBRUARY 20)	Y 9695
GARDENA (1994)	10.758 3.279	RDBM TAG IN E CB 3M S/O BCR @ SE COR AVALON BL & TURMONT ST 20.1M E & 15.2M S/O C/L INT	Y 9698
GARDENA (1994)	11.138 3.395	RDBM TAG IN W CB AVALON BLVD 20M W/O C/L & 6M S/O C/L PROD TURMONT ST	Y 9699
GARDENA (1994)	26.762 8.157	RDBM TAG IN N CB 600MM E BCR @ NE COR FIGUEROA ST & TORRANCE BLVD 9.8M N & 33.8M E/O C/L INT	Y 9700
GARDENA (1994)	16.837 5.132	RDBM TAG IN CB 1.5M S/O BCR @ SE COR BOLSA ST & DOMINGUEZ ST 19.2M S & 6.1M E/O C/L INT	Y 9701
GARDENA (1994)	19.196 5.851	RDBM TAG IN SLY CB @ SELY COR BRIDGE ABUT OVER DOMINGUEZ CHANNEL 4.9M S & 19.8M W/O C/L INT 213TH ST & CHICO ST	Y 9702
GARDENA (1994)	21.224 6.469	RDBM TAG IN S CB 600MM E/O BCR @ SE COR 213TH ST & MARTIN ST 18.6M E & 6.1M S/O C/L INT	Y 9703
GARDENA (1994)	33.077 10.082	RDBM TAG IN E CB 1.5M S/O BCR @ SE COR DEL AMO BLVD & FORDYCE AVE 25.9M S & 10.4M E/O C/L INT	Y 9704
GARDENA (1994)	91.220 27.804	RDBM TAG IN W CB CENTRAL AVE 10.4M W/O C/L & 15.2M N/O C/L PROD GREENLEAF BLVD	Y 9708
GARDENA (1994)	93.258 28.425	RDBM TAG IN W CB CENTRAL AVE 300MM S/O C B 13M W/O C/L & 18.3M S/O C/L PROD GREENLEAF BLVD	Y 9709
GARDENA (1994)	95.256 29.034	RDBM TAG IN CB 3M E/O BCR @ NE COR GREENLEAF ST & NORTHWOOD AVE 16.2M E & 6.7M N/O C/L INT	Y 9710
GARDENA (1994)	175.502 53.493	RDBM TAG IN N CB @ BLDG #1111 W VICTORIA ST 79M E & 9.8M N/O C/L INT VICTORIA ST & S SEQUOIA DR	Y 10092

NGVD 29 DATUM

LOS ANGELES COUNTY PUBLIC WORKS
SURVEY SECTION

QUAD YEAR	ELEV FOOT/METER	DESCRIPTION	BM NUMBER
GARDENA (1994)	170.361 51.926	RDBM TAG N CB @ BLDG #1055 W VICTORIA ST 198M E & 10M N/O C/L INT VICTORIA ST & S SEQUOIA DR	Y 10093
GARDENA (1994)	42.917 13.081	LACE MON IN W CB N END C B 9M W C/L NORMANDIE AVE & 88M S/O C/L JON ST MKD (PBM 21-02252 1979) OPP BLDG #20220	Y 10094
GARDENA (1994)	21.391 6.520	RDBM TAG IN CB 900MM S/O BCR @ NW COR 220TH ST & WILMINGTON AVE 8.8M N & 12.8M W/O C/L INT	Y 10096
GARDENA (1994)	34.747 10.591	CS BR CAP IN W CB AVALON BLVD 12M W/O C/L & 4.3M N/O C/L PROD WATSON CTR RD MKD (BM 23-10 1974 RE 7078)	Y 10097
GARDENA (1994)	20.656 6.296	L&T IN W CB 300MM N/O BCR @ NW COR TORRANCE BLVD & MAIN ST 21.3M N & 12.8M W/O C/L INT	Y 10099
GARDENA (1994)	30.987 9.445	RDBM TAG IN N CB DEL AMO BLVD 12.8M N/O C/L & 11.3M E/O C/L PROD REEVES AVE	Y 10100
BASELINE (1990)	38.127 11.621	L&BR IN CTR CB RET @ NE COR DEL AMO BLVD & ALAMEDA ST (W BBL) 13.7M E & 16.8M N/O C/L INT	Y 10102
BASELINE (1990)	46.230 14.091	LS TAG #2760 IN CB NR C/L PROD LAUREL PARK RD (FR THE WEST) IN THE E CB OF ALAMEDA ST (W BBL)	Y 10138
BASELINE (1990)	59.842 18.240	RDBM TAG IN CB 600MM N BCR @ NE COR ALAMEDA ST (W BBL) & AUTO DR S 19.8M N & 12.2M E/O C/L INT	Y 10139
BASELINE (1990)	64.485 19.655	L&T IN N CB 1.5M E/O BCR @ NE COR ALONDRA BLVD & ALAMEDA ST (W BBL) 15.2M E & 9.1M N/O C/L INT	Y 10140
BASELINE (1990)	71.273 21.724	RDBM TAG IN N CB 600MM W BCR @ NW COR ROSECRANS AVE & OLEANDER AVE 11.6M N & 10.7M W/O C/L INT	Y 10160
BASELINE (1990)	72.411 22.071	RD BM TAG IN NW COR C B 1.8M W/O BCR @ NW COR ROSECRANS AVE & ARANBE AVE 12.8M N & 10.7M W/O C/L INT	Y 10161
BASELINE (1990)	95.977 29.254	RD BM TAG IN NW COR C B 2.7M W/O BCR @ NW COR ROSECRANS AVE & PARMELEE AVE 18.3M W & 13.4M N/O C/L INT	Y 10162
BASELINE (1990)	113.432 34.574	RDBM TAG IN S CB 5.2M E BCR @ SE COR ROSECRANS AVE & STANFORD AVE & 21.6M E & 12.2M S/O C/L INT	Y 10163
BASELINE (1990)	50.148 15.285	L&SPK IN N CB 4M E/O BCR @ NE COR LOMITA BLVD & PRESIDENTE AVE 17.7M E & 12.2M N/O C/L INT	Y 10169
BASELINE (1990)	50.987 15.541	L&BR IN CB RET 4.6M E/O BCR @ NW COR LOMITA BL & WESTERN AVE 18.3M W & 11.3M N/O C/L INT	Y 10170
BASELINE (1990)	55.020 16.770	RDBM TAG IN S CB 300MM W/O BCR @ SW COR LOMITA BLVD & EBONY LN 28M W & 12.8M S/O C/L INT	Y 10171
BASELINE (1990)	56.050 17.084	RD BM TAG IN S CB 300MM W/O BCR @ SW COR LOMITA BLVD & WALNUT ST 11M S & 10.4M W/O C/L INT	Y 10172
BASELINE (1990)	69.803 21.276	L&BR IN CB RET 4.9M W/O BCR @ SE COR LOMITA BL & NARBONNE AVE 14.3M S & 15.2M E/O C/L INT	Y 10173
BASELINE (1990)	126.607 38.590	RDBM TAG IN N CB 300MM ELY BCR @ NE COR AERO & PACIFIC COAST HWY 22.6M ELY & 11.6M NLY C/L INT	Y 10174

NGVD 29 DATUM

LOS ANGELES COUNTY PUBLIC WORKS
SURVEY SECTION

QUAD YEAR	ELEV FOOT/METER	DESCRIPTION	BM NUMBER
BASELINE (1990)	83.766 25.532	L&T IN S CB 300MM W/O BCR @ SW COR SEPULVEDA BLVD & ERIEL AVE 16.8M W & 13.7M S/O C/L INT	Y 10176
BASELINE (1990)	86.896 26.486	RDBM TAG IN E CB 300MM N BCR @ NE COR CRENSHAW BLVD & TORRANCE BLVD 26.5M N & 14M E/O C/L INT	Y 10178
BASELINE (1990)	86.374 26.327	L&SPK IN C B 1.8M W/O BCR @ NW COR CRENSHAW BL & TORRANCE BL 26.8M W & 12.5M N/O C/L INT	Y 10179
BASELINE (1990)	75.722 23.080	RDBM TAG IN S CB 300MM E BCR @ SE COR CRENSHAW BLVD & DOMINGUEZ ST 29M E & 6.1M S/O C/L INT	Y 10180
BASELINE (1990)	61.033 18.603	RDBM TAG IN W CB 300MM S BCR @ SW COR CRENSHAW BLVD & 182ND ST 16.8M S & 11.6M W/O C/L INT	Y 10181
BASELINE (1990)	60.686 18.497	RDBM TAG IN CB 300MM S/O BCR @ NW COR CRENSHAW BLVD & 182ND ST 16.4M N & 11.6M W/O C/L INT	Y 10182
BASELINE (1990)	42.090 12.829	RDBM TAG IN E CB 300MM S BCR @ SE COR CRENSHAW BL & REDONDO BEACH BL 18.6M S & 12.2M E C/L INT	Y 10183
BASELINE (1990)	42.461 12.942	RDBM TAG IN CB 2.7M S/O BCR @ NE COR CRENSHAW BL & REDONDO BEACH BL 23.8M N & 10.7M E C/L INT	Y 10184
GARDENA (1994)	33.553 10.227	L&N IN W CB 4.9M N/O BCR @ NW COR WILMINGTON AVE & 233RD ST 24.4M N & 12.8M W/O C/L INT	Y 10494
GARDENA (1994)	30.777 9.381	DPW BM TAG IN N CB 3M W/O BCR @ NW COR 230TH ST & WILMINGTON AVE 24.4M W & 9M N/O C/L INT	Y 10495
GARDENA (1994)	30.233 9.215	DPW BM TAG IN E CB 12.8M E/O C/L WILMINGTON AVE & 15.2M N/O C/L PROD 230TH ST	Y 10496
GARDENA (1994)	23.520 7.169	L&N IN W CB 4M N/O BCR @ NW COR WILMINGTON AVE & WATSON CENTER RD 24M N & 13.4M W/O C/L INT	Y 10497
GARDENA (1994)	25.325 7.719	DPW BM TAG IN E CB 1.5M S/O BCR @ S EDGE OF ENT GATE TO #20720 S WILMINGTON AVE 322M N/O C/L DOMINGUEZ ST NR LT STD #4023087E	Y 10498
BASELINE (1990)	38.143 11.626	DPW BM TAG IN S CB 3M E BCR @ SE COR DEL AMO BL & ALAMEDA ST (W BBL) 13.7M S & 11.3M E/O C/L INT	Y 10499
GARDENA (1994)	135.138 41.190	DPW BM TAG IN E CB 1.5M S BCR @ SE COR CASHDAN ST & WILMINGTON AVE 22.6M S & 12.8M E/O C/L INT	Y 10500
GARDENA (1994)	143.153 43.633	DPW BM TAG IN E CB 1.5M N BCR @ NE COR CASHDAN ST & WILMINGTON AVE 22.6M N & 12.8M E/O C/L INT	Y 10501
GARDENA (1994)	88.356 26.931	DPW BM TAG IN CB 1.5M W BCR @ NE COR WILMINGTON AVE & GREENLEAF BLVD 18.3M E & 8M N/O C/L INT	Y 10502
GARDENA (1994)	67.323 20.520	DPW BM TAG IN CB 3M E/O BCR @ NE COR ALONDRA BLVD & HASKINS LN 20.4M E & 12.2M N/O C/L INT	Y 10503
GARDENA (1994)	57.333 17.475	DPW BM TAG IN CB RET 3M W BCR @ NE COR ALONDRA BLVD & AVALON BLVD 19.8M E & 12.8M N/O C/L INT	Y 10504
GARDENA (1994)	55.961 17.057	DPW BM TAG IN N CB 600MM W BCR @ NW COR ALONDRA BLVD & AVALON BLVD 22.6M W & 12.8M N/O C/L INT	Y 10505

NGVD 29 DATUM