

**COUNTY OF LOS ANGELES**  
**ROAD DEPARTMENT**



**RIVERA QUAD**  
**BENCH MARKS**  
**1960**

## PREFACE

The Road Department level net is composed of more than 1,000 miles of levels supporting in excess of 10,000 bench marks. In 1964-65, a major readjustment of the net was undertaken. To emphasize the complete break with previous elevations, the SY, SG & SL series bench marks have been re-labeled BY, BG & BL, respectively.

To facilitate the adjustment, indexing, and distribution of adjusted values of the net, the County territory was divided into 31 quads or areas. For identification purposes each quad was given a name, viz., "Rosemead," "La Mirada," "Santa Fe," etc. When bench marks and elevations in the Road Department net are used, the name of the quad in which the bench mark is located and the date of the adjustment of the elevation must be included in the bench mark description, e.g.,

BG 1887 --L+BN IN CONC HDWL OF DRAIN PIPE UNDER DR 218 FT  
NE +18 FT SE C/L INT SAN JOSE HILLS RD +CAMERON AVE MKD (BM)  
(COVINA --1965) ELEV. 696.238

It is expected that this general adjustment will, for the most part, remain sound for the next 8 to 12 years. As new circuits are completed, however, re-adjustment of individual quads may become advisable. It is expected that these subsequent adjustments will be in the nature of a few hundredths of a foot. When a quad is re-adjusted, new elevation lists will be published and the date of the re-adjustment will replace the "1965" at the end of the bench mark description. Two bench marks in the same quad with different adjustment dates will not normally join each other. Since all adjustments taper out to nothing at the periphery of the quad, any bench mark in one quad will join any bench mark in another quad regardless of their respective adjustment dates.

The basic accuracy of the net is reflected by an indicated field probable error of plus or minus 0.012 foot per mile of leveling as determined from 298 conditions of closure. However, many years experience in vertical control in the greater Los Angeles basin and Antelope Valley indicate that because of varying degrees of subsidence and heaving, the true datum is recovered only by obtaining substantial agreement of a number of bench marks.

The users of this net are invited to assist in its maintenance by notifying this Department of cases of obliteration, apparent mistakes in descriptions or elevations, and proven disturbance of bench marks.

---

DATUM: U. S. Coast and Geodetic Survey Sea Level Datum  
of 1929, through the medium of the Los Angeles  
County Engineer Precise Level Net, 1963 Adjust-  
ment.

## Abbreviations Used in Bench Mark Listings

ABUT--Abutment	L+BN--Lead and Bench Mark Nail
ANG PT--Angle Point	L+BR--Lead and Brad
BC--Beginning of Curve	L+N--Lead and Nail
BCR--Beginning of Curb Return	L+PK--Lead and PK Nail
BLDG--Building	L+SPK--Lead and Spike
BT SPK--Boat or Bolt Spike	L+T--Lead and Tack
CB RET--Curb Return	MCR--Middle of Curb Return
C/L INT--Center Line Intersection	MKD--Marked
C/L PROD--Center Line Produced	NR--Near
COE--Corps of Engineers	OPP--Opposite
CONC--Concrete	PI--Point of Intersection
CS MON--County Surveyor Monument	PK+W--PK Nail and Washer
CS BR CAP--County Surveyor Brass Cap Monument	P/L--Property Line
CT SPK--Cut Spike	P O S T--Point on Semi-tangent
CTR--Center	PP--Power Pole
DN--Down	PVMT--Pavement
DR--Driveway	R D--Road Department
EC--End of Curve	RDBM--Road Department Bench Mark
ENT--Entrance	RR--Railroad
FC--Flood Control (Dept. LA County)	SPK T+W--Spike, Tin and Washer
FTG--Footing	USC+GS--United States Coast and Geodetic Survey
HDWL--Headwall	USGS--United States Geological Survey
HSE--House	WK--Walk
IP--Iron Pipe	±--Plus or Minus
LACE--Los Angeles City Engineer	+--And

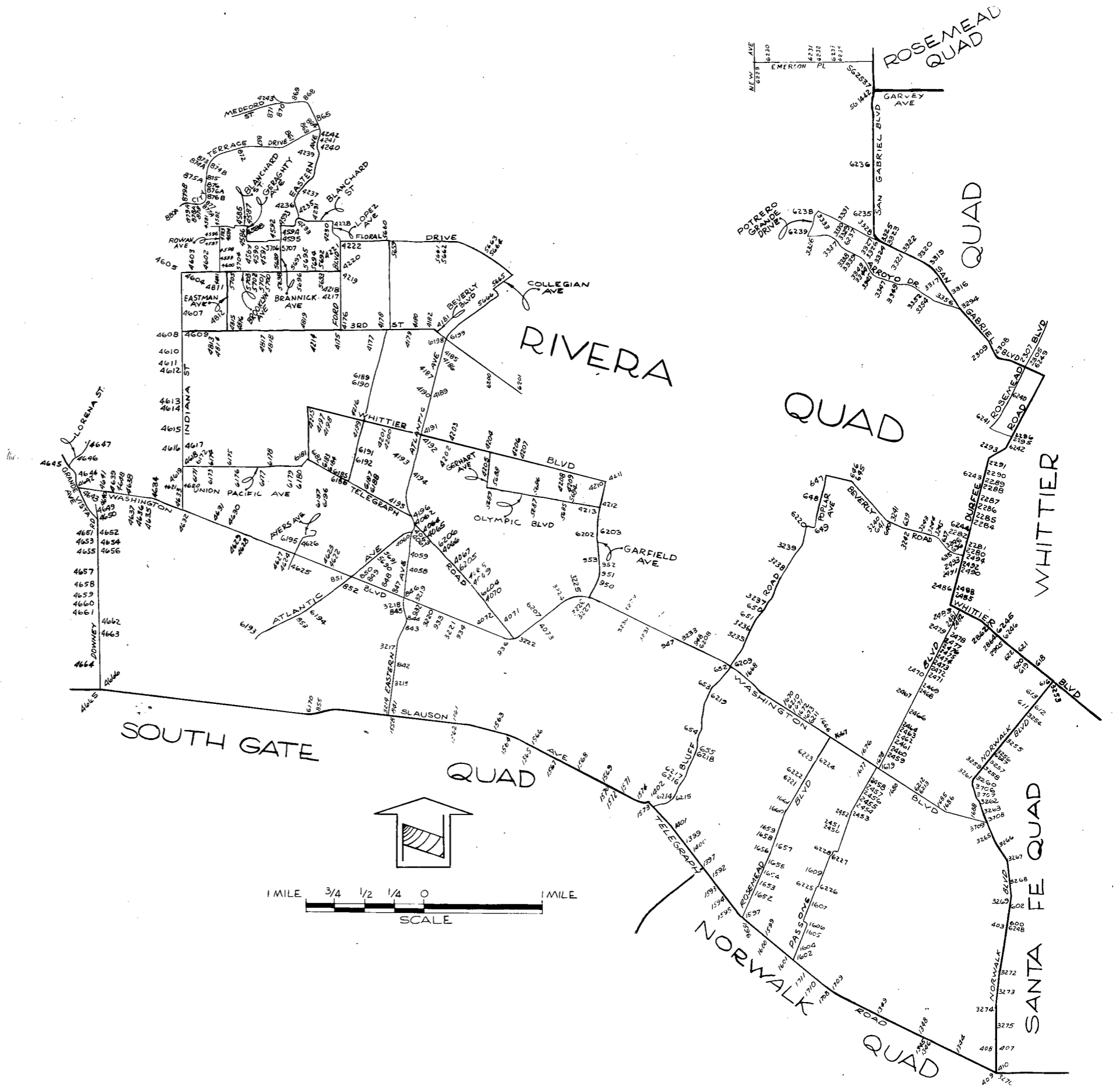

QUAD-YEAR	ELEV	DESCRIPTION (INCLUDE QUAD AND YEAR IN DESCRIPTION)	BM NUMBER
BASELINE (1955)	271.710	CS MON IN WELL 23FT S C/L GARVEY AVE + 14FT W C/L SAN GABRIEL BLVD	SG 1442
BASELINE (1955)	276.063	FC BR CAP IN W WINGWALL 73FT N C/L GARVEY AVE + 225FT W C/L SAN GABRIEL BLVD MKD (BM 55-24)	SG 2537
BASELINE (1955)	143.270	CUT SPK N END CULV HDWL 16FT E C/L NORWALK BLVD + 720FT N C/L TELEGRAPH RD	SY 407A
BASELINE (1955)	143.193	CUT SPK S END CULV HDWL 15FT W C/L NORWALK BLVD + 900FT N TELEGRAPH RD	SY 408A
BASELINE (1955)	169.992	L+SPK CTR OF WK 3FT E FLAGPOLE @ WEST WHITTIER SCHOOL 51FT W C/L NORWALK BLVD + 250FT N C/L BEXLEY DR	SY 611
BASELINE (1955)	169.853	L+T N CB 13FT N C/L LOCH LOMOND DR + 60FT E C/L NORWALK BLVD	SY 612A
BASELINE (1955)	170.153	L+T W CB 3FT N BCR @ NW COR LOCH AVON DR TO THE W + NORWALK BLVD 28FT W + 42FT N C/L INT	SY 613A
BASELINE (1955)	176.255	L+T E CB 1FT N BCR @ NE COR WHITTIER BLVD + MCNEES AVE 15FT E + 52FT N C/L INT	SY 618
BASELINE (1955)	175.699	L+T S CB WHITTIER BLVD 28FT S C/L + ON C/L PROD REDMAN AVE TO THE N	SY 619
RIVERA (1960)	183.599	L+N S CB BEVERLY RD 35FT S PI NR OLYMPIC BLVD	SY 635
RIVERA (1960)	184.946	L+SPK 5FT W BCR BEVERLY RD 122FT W C/L OLYMPIC BLVD	SY 636
RIVERA (1960)	183.063	L+T PI 150FT E INT ROSEMEAD BLVD + BEVERLY RD	SY 637
RIVERA (1960)	179.696	S L+T OF 2 @ PI E OF INT LEXINGTON RD + BEVERLY RD	SY 639
RIVERA (1960)	178.894	L+T PI 11FT S C/L BEVERLY RD 100FT W HOOVER DAM POWER LINE	SY 640
RIVERA (1960)	178.095	L+T CONC PVMT ON C/L PINE ST 19FT S C/L BEVERLY RD	SY 641
RIVERA (1960)	205.878	L+BN E CB 1FT N BCR @ NE COR BEVERLY BLVD + RD LEADING TO (GRANT REA MEMORIAL PARK) 75FT N + 20FT E C/L INT MKD (BM)	SY 645A
RIVERA (1960)	205.984	CS MON N CB @ ANG PT OF ROAD DIVIDER LEADING TO (GRANT REA MEMORIAL PARK) 49FT N OF N CB BEVERLY BLVD + 85FT W OF W EDGE OF BRIDGE NO B 976 MKD (BM 51 10 A 1961)	SY 646A
RIVERA (1960)	207.441	L+N E CB POPLAR AVE NR S END BCR @ SE COR BEVERLY RD + POPLAR AVE	SY 647A
RIVERA (1960)	210.391	L+T 3FT W BCR @ NW COR POPLAR AVE + WASHINGTON AVE	SY 648A
RIVERA (1960)	209.062	L+N 1FT W BCR @ NW COR WHITTIER BLVD + 1ST ST	SY 649A
RIVERA (1960)	207.735	L+N W CB FRONT OF HSE NO 637 BLUFF RD	SY 650
RIVERA (1960)	205.367	L+T NR S END BCR @ SW COR HUGHES AVE + BLUFF RD	SY 651

QUAD-YEAR	ELEV	DESCRIPTION (INCLUDE QUAD AND YEAR IN DESCRIPTION)	BM NUMBER
RIVERA (1960)	190.220	L+N SW COR RIO HONDO BRIDGE @ WASHINGTON BLVD + BLUFF RD	SY 652
RIVERA (1960)	178.724	L+N 1FT N CATCH BASIN W SIDE BLUFF RD NR HSE NO 1217	SY 653
RIVERA (1960)	173.025	L+N 1FT N CATCH BASIN W SIDE BLUFF RD NR HSE NO 1425	SY 654
RIVERA (1960)	164.483	L+N SW COR SIGNAL BASE ON S SIDE AT+SFRR E SIDE OF BLUFF RD 100FT S C/L SCYMORE AVE	SY 655
RIVERA (1960)	138.071	L+N E CB EASTERN AVE 30FT N OF N LINE CONSOLIDATED STEEL CO NR S END CB 15FT JCT RR	SY 842
RIVERA (1960)	143.221	L+N 1FT FROM S END E CB ON EASTERN AVE 35FT N C/L AT+SFRR (MAIN LINE) NR 26TH ST	SY 843
RIVERA (1960)	139.614	L+T NR CTR CB RET @ NE COR EASTERN AVE + EASTLAND AVE 12FT S OF N END BCR	SY 844
RIVERA (1960)	138.887	L+T E CB EASTERN AVE 4FT S BCR @ SE COR SHEILA ST + EASTERN AVE	SY 845
RIVERA (1960)	139.782	L+T NR CTR CB RET @ NE COR WASHINGTON BLVD + EASTERN AVE	SY 846A
RIVERA (1960)	140.466	L+T NR CTR CB RET @ SE COR WASHINGTON BLVD + FITZGERALD ST	SY 847
RIVERA (1960)	141.455	L+N N CB NR E END BCR @ NE COR O NEIL AVE + WASHINGTON BLVD	SY 848A
RIVERA (1960)	143.119	CUT SPK E CB 5FT N BCR @ NE COR STRONG AVE + WASHINGTON BLVD	SY 849
RIVERA (1960)	144.617	CUT SPK E CB 5FT N BCR @ NE COR WILMA AVE + WASHINGTON BLVD	SY 850
RIVERA (1960)	146.400	L+T S CB 70FT W BCR @ SW COR WASHINGTON BLVD + ATLANTIC BLVD 40FT S + 160FT W C/L INT	SY 851A
RIVERA (1960)	146.341	L+T N CB 6FT FROM BCR @ NW COR ATLANTIC BLVD + SHEILA ST	SY 852A
RIVERA (1960)	149.093	L+T NR BCR @ SE COR ATLANTIC BLVD + BANDINI BLVD 100FT E + 35FT S C/L INT	SY 853A
BASELINE (1955)	158.084	U S E D L+N W END N HDWL LA RIVER BRIDGE ON SLAUSON AVE	SY 855A
RIVERA (1960)	430.711	L+N 25FT N BCR @ NE COR CARMELITA AVE + CITY TERRACE DR	SY 861
RIVERA (1960)	447.043	L+N 20FT N BCR @ NE COR MCGILVREY AVE + CITY TERRACE DR	SY 863
RIVERA (1960)	443.864	L+TW CB 5FT N BCR @ SW COR EASTERN AVE + ROGERS ST 31FT W + 30FT S C/L INT	SY 865A
RIVERA (1960)	447.737	L+N 1FT E BCR @ NE COR TIM AVE + EASTERN AVE + S OF BARNETT RD	SY 868
RIVERA (1960)	423.810	L+N @ BCR @ NW COR EASTERN AVE + LANSDOWNE AVE	SY 869
RIVERA (1960)	413.433	L+T S CB 11FT E BCR @ SE COR EASTERN AVE + MEDFORD ST 35FT S + 45FT E C/L INT	SY 870A

QUAD-YEAR	ELEV	D E S C R I P T I O N (INCLUDE QUAD AND YEAR IN DESCRIPTION)	BM NUMBER
RIVERA (1960)	400.719	L+N CONC WK 47FT S OF S CB MEDFORD ST + 33FT E OF E CB MILLER AVE	SY 871
RIVERA (1960)	424.217	L+N CONC WALK 21FT S BCR @ SW COR HERBERT AVE + RAMONA BLVD	SY 872
RIVERA (1960)	399.689	R D MON IN WELL C/L INT ROWAN AVE + CITY TERRACE DR	SY 873A
RIVERA (1960)	403.377	L+T E CB CITY TERRACE DR @ C/L PROCD MARENGO ST	SY 874A
RIVERA (1960)	402.967	R D MON IN WELL C/L INT MARENGO ST + CITY TERRACE DR	SY 874B
RIVERA (1960)	419.928	L+N 20FT E BCR N CB RAMBOZ DR + CITY TERRACE DR	SY 875
RIVERA (1960)	415.162	R D MON IN WELL C/L INT RAMBOZ DR + CITY TERRACE DR	SY 875A
RIVERA (1960)	441.761	L+N NE CB TRIANGULAR ISLAND 20FT E BCR POMEROY ST + CITY TERRACE DR	SY 876
RIVERA (1960)	439.710	R D MON IN WELL C/L INT POMEROY ST + CITY TERRACE DR	SY 876A
RIVERA (1960)	440.073	R D MON IN WELL C/L INT MEISNER ST + CITY TERRACE DR	SY 876B
RIVERA (1960)	426.540	L+N N CB TOWNSEND AVE 70FT E C/L CITY TERRACE DR	SY 877
RIVERA (1960)	423.090	R D MON IN WELL P O S T TOWNSEND AVE + CITY TERRACE DR	SY 877A
RIVERA (1960)	415.678	L+N E CB OF N DITMAN AVE 20FT S BCR @ SE COR DITMAN AVE + CITY TERRACE DR	SY 878
RIVERA (1960)	419.066	R D MON IN WELL P O S T DITMAN AVE + CITY TERRACE DR	SY 878A
RIVERA (1960)	420.660	L+T CONC WK FRONT OF STORE N SIDE CITY TERRACE DR NO 3259 45FT N C/L CITY TERRACE DR @ HICKS ST	SY 879A
RIVERA (1960)	416.958	R D MON IN WELL P O S T @ HICKS ST + CITY TERRACE DR	SY 879B
RIVERA (1960)	409.483	R D MON IN WELL P O S T @ DOBINSON ST + CITY TERRACE DR	SY 880A
RIVERA (1960)	138.026	L+T 2FT NW MARKER @ SW COR EASTLAND AVE + WASHINGTON BLVD	SY 932
RIVERA (1960)	140.002	L+N 4FT NW MARKER @ SW COR ELKGROVE AVE + WASHINGTON BLVD	SY 933
RIVERA (1960)	143.177	L+SPK 5FT W BCR @ SW COR FIDELIA AVE + WASHINGTON BLVD	SY 934A
RIVERA (1960)	147.994	LACE TAG IN W CB OF TRIANGLE SHAPED ISLAND @ SW COR TELEGRAPH RD + WASHINGTON BLVD 63FT S + 56FT W C/L INT	SY 936A
RIVERA (1960)	185.750	L+T CTR CB RET @ SW COR GREENWOOD AVE + WASHINGTON BLVD	SY 947

QUAD-YEAR	ELEV	DESCRIPTION (INCLUDE QUAD AND YEAR IN DESCRIPTION)	BM NUMBER
RIVERA (1960)	190.259	L+T W SIDE CONC DRWY FRONT HSE NO 800 WASHINGTON BLVD 40FT N C/L @ NW COR WASHINGTON BLVD + MONTEBELLO BLVD	SY 948
RIVERA (1960)	172.324	L+BN E CB GARFIELD AVE 2FT N MC 2100FT S C/L FERGUSON DR	SY 950A
RIVERA (1960)	172.015	R D MON IN WELL 8IN DN POST 318FT S BC 25FT E C/L GARFIELD AVE 1924FT S C/L FERGUSON DR	SY 951A
RIVERA (1960)	173.986	RDBM TAG @ SE COR GARFIELD AVE + FLOTILLA ST 30FT S + 81FT W C/L INT 6FT E BCR	SY 952A
RIVERA (1960)	173.982	RDBM TAG @NW COR GARFIELD AVE + FLOTILLA ST 2FT N ANG PT @ BCR 40FT W + 75FT N C/L INT	SY 953A
BASELINE (1955)	131.842	RDBM TAG IN S CB TELEGRAPH RD 2FT# W/O SW CB RET @ MIAN DRWY TO SANTA FE SPRINGS FIRE STA BLDG NO 11736 40FT# S/O C/L TELEGRAPH RD + 390FT# W/O C/L PIONEER BLVD	SY 1345A
BASELINE (1955)	131.198	L+BN 6IN CONC RETAINING WALL 55FT# S C/L TELEGRAPH RD 300FT# W C/L PIONEER BLVD	SY 1346A
BASELINE (1955)	132.177	CS MON IN WELL @ C/L INT TELEGRAPH RD + ALBURTIS AVE NLY MKD (LACS CON SYS TRA STA WHITTIER B-7 RE2177 1941)	SY 1348A
BASELINE (1955)	133.241	L+T NEAR CTR CB RT @ NE COR TELEGRAPH RD + ORR + DAY RD	SY 1349A
BASELINE (1955)	133.111	RDBM TAG IN W CB 1FT# S BCR 68FT# S + 38FT# W C/L INT TELEGRAPH RD + ORR + DAY RD	SY 1350A
BASELINE (1955)	142.240	CS MON IN WELL 8IN DN ON C/L TELEGRAPH RD 20FT# WLY C/L PARAMOUNT BLVD MKD (BELL K4 1941)	SY 1397A
BASELINE (1955)	143.927	RAM NAIL IN N CB TELEGRAPH RD 16FT# E/O CB END 38FT# N/O C/L TELEGRAPH RD + 110FT# W/O C/L CRIDER AVE	SY 1400A
BASELINE (1955)	145.817	RAM SET NAIL IN CONC ISLAND @ CTR OF DRWY TO KAYNAR CO BLDG 7875 42FT# N OF C/L TELEGRAPH RD + 4IN# E OF C/L INT SLAUSON AVE + TELEGRAPH RD 300FT# E OF E END BRIDGE 53-212 OVER RIO HONDO	SY 1401A
BASELINE (1955)	151.909	L+T IN N CB TELEGRAPH RD 4FT# E OF CB RET @ NE COR SLAUSON AVE 40 FT# N + 105FT#E OF C/L INT	SY 1402A
BASELINE (1955)	135.775	L+T CTR CB RET SE COR EASTERN AVE + SLAUSON AVE	SY 1558
BASELINE (1955)	140.217	L+T N CB SLAUSON AVE @ WLY END OF CURVE 42FT# N C/L SLAUSON AVE + 300FT# E BOXFORD AVE	SY 1561A
BASELINE (1955)	140.294	L+T CONC WK TO (THOR POWER TOOL CO) OFFICE BLDG NO 6200 48FT# S C/L SLAUSON AVE @ WLY END CURVE 300FT# E BOXFORD AVE	SY 1562A
BASELINE (1955)	142.545	L+LS 1742 TAG W CB MALT AVE 1FT# N CB RET @ NW COR SLAUSON AVE 50FT# S + 26FT# W C/L INT	SY 1563A
BASELINE (1955)	146.107	L+T S CB SLAUSON AVE @ WLY END OF CURVE 38FT# S C/L SLAUSON AVE + 620FT# E MALT AVE	SY 1564A
BASELINE (1955)	148.466	L+T 3FT# E CTR CB RET @ SE COR SLAUSON AVE + GARFIELD AVE 41FT# S + 53FT# E C/L INT	SY 1565



QUAD-YEAR	ELEV	DESCRIPTION (INCLUDE QUAD AND YEAR IN DESCRIPTION)	BM NUMBER
BASELINE (1955)	148.687	L+T N CB SLAUSON AVE 2FT± E CB RET @ NE COR GARFIELD AVE 38FT± N + 65FT± E C/L INT	SY 1566
BASELINE (1955)	152.781	L+BN S CB SLAUSON AVE 3FT± N PP NO 666256E ON LINE W/CHAIN LINK FENCE @ ELY P/L APEX STEEL CO 0.4MI± E GARFIELD AVE	SY 1567A
BASELINE (1955)	159.464	L+T RETAINING WALL N SIDE SLAUSON AVE FRONT OLIVE MEMORIAL PK 50FT± N C/L SLAUSON AVE 5FT± W OF E P/L OF PARK	SY 1568
BASELINE (1955)	158.337	RD MON IN WELL W/COVER ON C/L SLAUSON AVE 25FT± W C/L GREENWOOD AVE	SY 1569
BASELINE (1955)	159.426	L+T S CB 3FT± E BCR @ SE COR SLAUSON AVE + GREENWOOD AVE	SY 1570
BASELINE (1955)	158.115	CS MON IN WELL C/L INT TODD AVE + SLAUSON AVE	SY 1571
BASELINE (1955)	159.148	L+BN 5FT± S BCR @ SW COR TODD AVE + SLAUSON AVE	SY 1572
BASELINE (1955)	152.510	L+T IN S CB TELEGRAPH RD 5FT6IN± E/O CB RET @ SE COR SLAUSON AV 40FT± S + 48FT± E OF C/L INT	SY 1573A
BASELINE (1955)	157.196	TOP RD MON IN WELL C/L INT GAGE AVE + SLAUSON AVE	SY 1574A
BASELINE (1955)	140.657	L+T 1FT± E BCR @ NE COR FERNADEL ST + TELEGRAPH RD (IN SERVICE RD CB)	SY 1592
BASELINE (1955)	142.851	L+BN 4FT± S BCR @ SW COR BIRCHBARK AVE + TELEGRAPH RD	SY 1593
BASELINE (1955)	145.227	L+BN 4FT± S BCR @ SW COR STAMPS RD + TELEGRAPH RD	SY 1594
BASELINE (1955)	142.440	L+BN 30FT± S BCR @ SW COR STOAKES AVE + TELEGRAPH RD	SY 1595
BASELINE (1955)	138.869	RAM SET CTR CB RET SE COR LAKEWOOD BLVD + TELEGRAPH RD 55FT± S + 55FT± E C/L INT	SY 1596
BASELINE (1955)	138.066	CS MON MKD (LACO SUR CONT SUST TRA STA BELL K-5A RE2177 1941) IN WELL W/COVER @ CL INT TELEGRAPH RD + LAKEWOOD BLVD	SY 1597A
BASELINE (1955)	138.724	L+T S END W GAS ISLAND NE COR TELEGRAPH RD + SERAPIS AVE	SY 1599A
BASELINE (1955)	137.421	L+T IN S CB TELEGRAPH RD 6FT± W/O CB RET @ SE COR SERAPIS AVE 40FT± S + 50FT± E/O C/L INT	SY 1600/
BASELINE (1955)	141.486	L+BN 1FT FROM BCR SERVICE RD N CB @ PASSONS BLVD + TELEGRAPH RD 50FT± S C/L TELEGRAPH RD	SY 1601/
BASELINE (1955)	140.274	CS MON IN WELL @ C/L INT TELEGRAPH RD + PASSONS BLVD MKD (LA CO SUR CONT SYST TRA STA BELL 1-6 RE 2177 1941)	SY 1602
RIVERA (1960)	142.159	L+BN 1FT N BCR @ NE COR CLAYMORE ST + PASSONS BLVD	SY 1604
RIVERA (1960)	146.377	L+BN 2FT N BCR @ NE COR SUNGLOW ST + PASSONS BLVD	SY 1605
RIVERA (1960)	146.914	L+BN 1FT N BCR @ NE COR PASSONS BLVD FRONT HSE NO 8430 PASSONS BLVD	SY 1606

QUAD-YEAR	ELEV	DESCRIPTION (INCLUDE QUAD AND YEAR IN DESCRIPTION)	BM NUMBER
RIVERA (1960)	148.512	L+BN 1FT N BCR @ NE COR PASSONS BLVD + LA DOCEÑA LANE	SY 1607
RIVERA (1960)	147.852	L+BN 1FT W BCR @ NW COR MYRON ST + PASSONS BLVD	SY 1609
RIVERA (1960)	142.148	RAM SET CTR CB RET @ NE COR TERRADELL AVE + ROSEMEAD BLVD	SY 1652
RIVERA (1960)	143.453	RAM SET 5FT S CTR CB RET @ SE COR MAXINE AVE + ROSEMEAD BLVD	SY 1653
RIVERA (1960)	145.348	RAM SET E CB ROSEMEAD BLVD 45FT S C/L SHADE LANE	SY 1654
RIVERA (1960)	146.758	L+BN 1FT E BCR @ NE COR AERO DR + ROSEMEAD BLVD	SY 1655
RIVERA (1960)	150.698	L+BN SE COR GAS CO VALVE BOX 45FT N C/L PERR W SIDE ROSEMEAD BLVD (PE LA HABRA LINE)	SY 1656
RIVERA (1960)	149.495	RAM SET W CB ROSEMEAD BLVD 30FT S C/L PROD BURKE ST	SY 1657
RIVERA (1960)	149.917	L+T SW CB RET 15FT N BCR @ SW COR SLAUSON AVE + ROSEMEAD BLVD 50FT S+ 40FT W C/L INT	SY 1658A
RIVERA (1960)	150.020	L+T NW CB RET 12FT E BCR @ NW COR SLAUSON AVE + ROSEMEAD BLVD 40FT N + 50FT W C/L INT	SY 1659A
RIVERA (1960)	151.543	L+BN S END W RETAINING WALL SANTA FE RR BRIDGE 75 FT N HSE NO 7679 ON ROSEMEAD BLVD	SY 1660
RIVERA (1960)	156.382	SPK SW COR CONC SPILLWAY OF UNDERPASS DRAIN PUMP NW SIDE SFRR UNDERPASS @ ROSEMEAD BLVD	SY 1661
RIVERA (1960)	161.308	RDBM TAG N CB 50FT W BCR @ NW COR ROSEMEAD BLVD + WASHINGTON BLVD 38FT N + 120FT W C/L INT	SY 1666A
RIVERA (1960)	161.391	RDBM TAG E CB 30FT N BCR @ NE COR ROSEMEAD BLVD + WASHINGTON BLVD 108FT N + 40FT E C/L INT	SY 1667A
RIVERA (1960)	172.938	FC COPPER DISC TOP CONC ABUT @ NE COR BRIDGE NO 799 OVER TH RIO HONDD RIV 27FT N C/L WASHINGTON BLVD + 512FT E C/L BLUFF RD MKD (BM 53 40)	SY 1668
RIVERA (1960)	161.316	L+BN N CB 1FT W BCR @ NW COR PARAMOUNT BLVD + WASHINGTON BLVD 45FT N + 70FT W C/L INT	SY 1670A
RIVERA (1960)	161.529	L+BN N CB 1FT E BCR @ NE COR CANDACE AVE + WASHINGTON BLVD 38FT N + 41FT E C/L INT	SY 1671
RIVERA (1960)	162.117	L+BN N CB 1FT W BCR @ NW COR BOLLINGBACKER DR + WASHINGTON BLVD 38FT N + 51FT W C/L INT	SY 1672
RIVERA (1960)	161.725	L+T W CB 2FT N BCR @ NW COR CROSSWAY DR + WASHINGTON BLVD 73FT N + 16FT W C/L INT	SY 1673A
RIVERA (1960)	161.064	L+BN N CB 1FT E BCR @ NE COR LINDSEY AVE + WASHINGTON BLVD 38FT N + 56FT E C/L INT	SY 1676
RIVERA (1960)	160.485	L+T CTR ISLAND CB RET @ SW COR KILGARRY AVE + WASHINGTON BLVD 45FT S + 28FT W C/L INT	SY 1677
RIVERA (1960)	160.384	RDBM TAG N CB 1FT W BCR @ NW COR PASSONS BLVD + WASHINGTON BLVD 38FT N + 18FT W C/L INT	SY 1678A

QUAD-YEAR	ELEV	DESCRIPTION (INCLUDE QUAD AND YEAR IN DESCRIPTION)	BM NUMBER
RIVERA (1960)	159.922	RDBM TAG N CB 1FT E BCR @ NE COR PASSONS BLVD + WASHINGTON BLVD 38FT N + 120FT E C/L INT	SY 1679A
RIVERA (1960)	158.211	L+T S CB 1FT W BCR @ SW COR WASHINGTON BLVD + HASTY AVE 38FT S + 35FT W C/L INT MKD (SY 1680)	SY 1680
RIVERA (1960)	158.376	L+BN 1FT E BCR @ NE COR WASHINGTON BLVD + PIIONEER BLVD 35FT N + 75FT E C/L INT	SY 1686
RIVERA (1960)	157.621	L+BN 1FT E BCR @ NE COR WASHINGTON BLVD + MORRILL AVE 35FT N + 51FT E C/L INT	SY 1688
BASELINE (1955)	138.596	L+B W ECR @ SW COR TRUE AVE + TELEGRAPH RD (SERVICE RD)	SY 1708A
BASELINE (1955)	137.695	CS BR CAP CONC MDN IN CASING + COVER PI 6.82FT E C/L INT TRUE AVE + TELEGRAPH RD	SY 1709
BASELINE (1955)	140.164	L+BN 1FT± E ECR SERVICE RD N CB NE COR SONGFEST DR + TELEGRAPH RD	SY 1710
BASELINE (1955)	140.524	L+T 2FT± S BCR @ SW COR HASTY AVE + TELEGRAPH RD	SY 1711
BASELINE (1955)	183.690	L+SPK S CB 7FT E BCR @ SE COR BARTOLO AVE + DURFEE AVE 15FT S + 63FT E C/L INT	SY 2280
BASELINE (1955)	184.179	L+T W CB 4FT N BCR @ NW COR DURFEE AVE + FIRST ALLEY N BARTOLO AVE TO THE E 20FT W + 184FT N C/L INT DURFEE AVE + BARTOLO AVE	SY 2281
BASELINE (1955)	185.463	L+BN W CB DURFEE AVE 20FT W C/L 35FT N DRWY TO HSE NO 4503 + 400FT S BEVERLY BLVD	SY 2282A
BASELINE (1955)	187.218	L+BN E CB 15FT N BCR @ NE COR BEVERLY BLVD + DURFEE AVE 20FT E + 100FT N C/L INT	SY 2284
BASELINE (1955)	188.946	L+BN S CB 2FT E BCR @ SE COR TILMONT ST + DURFEE AVE 15FT S + 48FT E C/L INT	SY 2285
BASELINE (1955)	190.624	SPK N END FIRST STEP HSE NO 4252 60FT E + 40FT N C/L INT DURFEE AVE + DORK ST	SY 2286A
BASELINE (1955)	191.022	L+T E CB 2FT N BCR @ NE COR HARRELL AVE + DURFEE AVE 20FT E + 48FT N C/L INT	SY 2287A
BASELINE (1955)	192.600	L+T CTR CB RET @ NE COR DURFEE AVE + BANTA RD 26FT N + 28FT E C/L INT	SY 2288A
BASELINE (1955)	193.389	L+T E CB 28FT E C/L DURFEE AVE + 18FT S C/L PROD ISORA ST	SY 2289A
BASELINE (1955)	196.057	L+T 1FT FROM NW COR CONC DRWY HSE NO 3918 35FT E + 40FT S C/L INT GALLATIN RD + DURFEE AVE	SY 2290A
BASELINE (1955)	195.074	L+T CTR CONC WK TO HSE 3860 DURFEE AVE 68FT E + 30FT N C/L INT FRIENDSHIP AVE + DURFEE AVE	SY 2291A
BASELINE (1955)	195.967	L+T NR CTR CONC DRWY TO HSE NO 3754 DURFEE AVE 53FT E C/L DURFEE AVE + 6FT E BEG OF DRWY	SY 2293A
BASELINE (1955)	195.060	L+T CONC FOUNDATION OF SW LEG BP+L TOWER NO 253D4 73FT E C/L DURFEE AVE + 93FT N C/L KRUSE RD	SY 2295A
BASELINE (1955)	195.042	BR CAP IN CONC 4IN UP 6FT NE OF SW LEG OF BP+L TOWER NO 253D4 75FT E C/L DURFEE AVE + 95FT N C/L KRUSE RD MKD (U S E D WN 31949)	SY 2296A

QUAD-YEAR	ELEV	DESCRIPTION (INCLUDE QUAD AND YEAR IN DESCRIPTION)	BM NUMBER
BASELINE (1955)	206.326	RDBM TAG NR E END OF CULV HDWL @ NE COR SAN GABRIEL BLVD + ROSEMEAD BLVD 35FT N + 95FT E C/L INT	SY 2305A
BASELINE (1955)	202.050	L+SPK NR CTR HDWL UNDER EDISON TOWER NO M3T5 40FT N C/L SAN GABRIEL BLVD + 350FT W C/L ROSEMEAD BLVD	SY 2307A
BASELINE (1955)	206.774	FLT HD SPK 3FT E OF W END OF ABANDONED OIL WELL PUMP BASE 43FT NE C/L SAN GABRIEL BLVD + 355FT SE LINCOLN AVE	SY 2308A
BASELINE (1955)	218.033	L+BR CONC WK TO (SITE OF MISSION VIEJA) HISTORICAL MON 85FT NW C/L LINCOLN AVE + 33FT SW C/L SAN GABRIEL BLVD	SY 2309A
RIVERA (1960)	154.026	L+BN W CB PASSONS BLVD 2FT N OF N EDGE OF DRWY HSE NO 7525	SY 2450A
RIVERA (1960)	154.378	L+TW CB PASSONS BLVD 1FT N OF N EDGE DRWY TO HSE NO 7503 24FT S OF END OF CB	SY 2451
RIVERA (1960)	154.879	L+T CTR CB RET @ NE COR PASSONS BLVD + REX AVE	SY 2452
RIVERA (1960)	155.939	L+T E CB PASSONS BLVD 3FT N OF S P/L HSE NO 7276 @ SPLIT OF ANG PT OF PI 3FT N PP NO 784138E	SY 2453
RIVERA (1960)	156.635	L+T E CB 4FT S BCR @ SE COR FOXBURY WAY + PASSONS BLVD	SY 2454
RIVERA (1960)	157.470	L+T E CB PASSONS BLVD 1FT N OF N EDGE DRWY HSE NO 7202 30FT S C/L PROD DANBRIDGE ST	SY 2455
RIVERA (1960)	158.493	L+T CTR CB RET @ NE COR PASSONS BLVD + BERT ST	SY 2456
RIVERA (1960)	158.853	L+T CTR CB RET @ NE COR PASSONS BLVD + NAN ST	SY 2457
RIVERA (1960)	159.200	L+T E CB 2FT S BCR @ SE COR LOCHINVAR ST + PASSONS BLVD	SY 2458
RIVERA (1960)	162.507	L+T E CB 1FT N ECR @ NE COR PASSONS BLVD + GOODBEE ST	SY 2459
RIVERA (1960)	163.103	L+T E CB 1FT N BCR @ NE COR PASSONS BLVD + HAMPLER ST	SY 2460
RIVERA (1960)	163.739	L+T E CB 6FT N BCR @ NE COR PASSONS BLVD + CARRON DR	SY 2461
RIVERA (1960)	164.017	L+T E CB 1FT N BCR @ NE COR PASSONS BLVD + HOMEBROOK ST	SY 2462
RIVERA (1960)	164.165	L+T N CB 1FT E ECR @ NE COR PASSONS BLVD + HANEY ST	SY 2463
RIVERA (1960)	164.727	L+T N CB 2FT E BCR @ NE COR PASSONS BLVD + MARJORIE ST	SY 2464
RIVERA (1960)	166.272	L+T CTR CB RET @ NE COR PASSONS BLVD + BALFOUR ST	SY 2466
RIVERA (1960)	167.721	L+T W CB 1FT N ECR @ SW COR PASSONS BLVD + COSGROVE ST	SY 2467

QUAD-YEAR	ELEV	DESCRIPTION (INCLUDE QUAD AND YEAR IN DESCRIPTION)	BM NUMBER
RIVERA (1960)	168.888	L+T E CR @ BCR NE COR PASSONS BLVD + DUNLAP CROSSING RD	SY 2468
RIVERA (1960)	169.555	L+T 12FT S BCR @ NE COR PASSONS BLVD + ALDRICH ST	SY 2469
RIVERA (1960)	171.294	L+T W CB 2FT N BCR @ NW COR PASSONS BLVD + ROSE HEDGE DR	SY 2470
RIVERA (1960)	172.022	L+T E CB PASSONS BLVD ON C/L PROD REICHLING LANE	SY 2471
RIVERA (1960)	173.146	L+T CTR CB RET @ SE COR PASSONS BLVD + TOWNLEY DR	SY 2472
RIVERA (1960)	173.983	L+BR CTR CB RET @ NE COR BEXLEY DR + PASSONS BLVD	SY 2473
RIVERA (1960)	174.550	L+BR CTR CB RET @ NE COR HAVENWOOD ST + PASSONS BLVD	SY 2474
RIVERA (1960)	175.362	L+BR CTR CB RET @ NE COR LOCH LOMOND DR + PASSONS BLVD	SY 2475
RIVERA (1960)	176.174	L+BR CTR CB RET @ NE COR LOCH AVON DR + PASSONS BLVD	SY 2476
RIVERA (1960)	177.006	L+BR CTR CB RET @ NE COR HOLBROOK ST + PASSONS BLVD	SY 2477
RIVERA (1960)	177.077	CS MON NR INT ALMO ST + PASSONS BLVD TO THE W 22FT N C/L INT GLENCANNON DR + PASSONS BLVD	SY 2478
RIVERA (1960)	177.630	L+T 12FT N BCR @ SW COR ALMO ST + PASSONS BLVD	SY 2479
BASELINE (1955)	179.319	L+SPK @ CTR CB RET @ SE COR PASSONS BLVD + WHITTIER BLVD MKD (BM 2B)	SY 2481
BASELINE (1955)	179.372	L+SPK S CB 2FT E BCR @ SE COR PASSONS BLVD + WHITTIER BLVD MKD (P145)	SY 2482
BASELINE (1955)	179.399	L+T CTR CB RET @ SW COR PASSONS BLVD + WHITTIER BLVD	SY 2483
BASELINE (1955)	178.152	CS MON 150FT N C/L INT DURFEE AVE + WHITTIER BLVD	SY 2485
BASELINE (1955)	178.779	L+SPK W CE 6FT N BCR @ NW COR DURFEE AVE + FIRST ALLEY N WHITTIER BLVD MKD (P 28)	SY 2486
BASELINE (1955)	179.643	L+SPK S CB 10FT W BCR @ SW COR DURFEE AVE + WEST BLVD TO THE W MKD (P 27)	SY 2488
BASELINE (1955)	181.880	L+SPK S CB 6FT E BCR @ SE COR DURFEE AVE + WALNUT AVE MKD (P 59)	SY 2490
BASELINE (1955)	182.804	CS MON @ C/L INT DURFEE AVE + OLYMPIC BLVD	SY 2491
BASELINE (1955)	182.856	L+SPK S CB 3FT E BCR @ SE COR DURFEE AVE + OLYMPIC BLVD MKD (P 60)	SY 2492
RIVERA (1960)	183.012	L+BN W CB 25FT S BCR @ SE COR DURFEE AVE + BEVERLY BLVD 5FT S OF S EDGE OF N DRWY TO MOBIL GAS STA NO 9254 E BEVERLY BLVD	SY 2493
BASELINE (1955)	176.666	L+BN N CB WHITTIER BLVD NR E SIDE (PICO PALACE SALES) BLDG NO 9561 30FT N C/L WHITTIER BLVD CB IS AROUND STREET LIGHT NO 65 FOUNDATION	SY 2862

QUAD-YEAR	ELEV	DESCRIPTION (INCLUDE QUAD AND YEAR IN DESCRIPTION)	BM NUMBER
BASELINE (1955)	181.731	L+N S CB @ SW COR BRIDGE NO 53 06 OVER SAN GABRIEL RIV 22FT S C/L WHITTIER BLVD + 550FT W SPRR BRIDGE OVER WHITTIER BLVD	SY 2864
BASELINE (1955)	181.379	L+BN NE COR CONC WALK @ SE COR WHITTIER BLVD BRIDGE ACROSS SAN GABRIEL RIVER	SY 2905
BASELINE (1955)	135.722	FC BR DISC 2FT± E OF E CB EASTERN AVE OPP THE END CB RET @ NE COR SLAUSON AVE + EASTERN AVE FLUSH W/MAC PKWY MKD (BM 5-130)	SY 3214
RIVERA (1960)	136.738	L+BN E CB EASTERN AVE 4FT W TP NO 404008H 1000FT N SLAUSON AVE	SY 3215
RIVERA (1960)	137.899	L+BN SE COR CONC CATCH BASIN C/L ENT TO HELI AIR FORCE ON EASTERN AVE 60FT W C/L + 800FT S SFATTR	SY 3217
RIVERA (1960)	139.616	L+T 20FT W BCR @ SE COR WASHINGTON BLVD + EASTERN AVE	SY 3218
RIVERA (1960)	139.043	L+T CTR CB RET @ SW COR DANIEL AVE + WASHINGTON BLVD	SY 3219
RIVERA (1960)	138.384	L+T 4FT NW OF MC IN CB RET @ SW COR WASHINGTON BLVD + SENTA ST	SY 3220
RIVERA (1960)	141.799	L+T CTR CB RET @ SW COR WASHINGTON BLVD + LEO ST	SY 3221
RIVERA (1960)	148.861	L+T CTR CB RET @ NE COR WASHINGTON BLVD + TELEGRAPH RD	SY 3222E
RIVERA (1960)	160.738	BR CAP C/L WASHINGTON BLVD @ BC FLUSH 153FT S C/L GAYHART ST	SY 3224
RIVERA (1960)	167.246	BR CAP C/L WASHINGTON BLVD @ MC FLUSH 357FT W C/L GARFIELD AVE	SY 3225
RIVERA (1960)	167.990	L+BN CTR CB RET PARKING AREA @ N COR GOODYEAR TIRE CO PROP 70FT S C/L WASHINGTON BLVD + 150FT W C/L GARFIELD AVE	SY 3226
RIVERA (1960)	168.356	GARFIELD AVE L+T S CB 1FT W BCR @ SW COR WASHINGTON BLVD +	SY 3227A
RIVERA (1960)	174.786	RDBM TAG N CB 1FT W BCR @ NW COR WASHINGTON BLVD + VAIL AVE 38FT N + 45FT W C/L INT	SY 3229A
RIVERA (1960)	173.638	RD MON IN WELL 8IN DN @ C/L INT WASHINGTON BLVD + VAIL AVE MKD (LA RD DEPT 1954)	SY 3230A
RIVERA (1960)	175.954	RD MON IN WELL 8IN DN @ C/L INT WASHINGTON BLVD + MAPLE AVE MKD (LA RD DEPT 1954)	SY 3231A
RIVERA (1960)	177.023	L+T CTR CB RET ON NE COR WASHINGTON BLVD + MAPLE AVE 35FT N + 25FT E C/L INT MKD (BM 1A)	SY 3232A
RIVERA (1960)	185.834	L+T CB RET 12FT W BCR @ NE COR WASHINGTON BLVD + GREENWOOD AVE	SY 3233A
RIVERA (1960)	200.465	L+N CTR 2FT CONC WK TO HSE NO 837 BLUFF RD 8FT W OF W CB	SY 3235
RIVERA (1960)	202.924	L+T 1FT N BCR @ NW COR BEACH ST + BLUFF RD	SY 3236
RIVERA (1960)	211.362	L+N W CO 1FT S BCR @ SW COR MINES AVE + BLUFF RD	SY 3237A

