

**LOS ANGELES COUNTY
DEPARTMENT OF PUBLIC WORKS**

BENCH MARK LIST



OFFICE COPY

RIVERA QUAD

1990 ADJUSTMENT

PREFACE 1990

The Department of Public Works level net is composed of more than 1,700 miles of levels supporting in excess of 9,000 bench marks. In 1990, a major readjustment of the Baseline and nets was undertaken. To emphasize the complete break with previous elevations, the CY, CG & CL series bench marks have been relabeled DY, DG, & DL, respectively.

To facilitate the adjustment, indexing, and distribution of adjusted values of the net, the County territory is divided into 33 quads or areas. For identification purposes each quad is given a name, viz., "Rosemead," "La Mirada," "Santa Fe", etc. When bench marks and elevations in these nets are used, the name of the quad and the date of the adjustment must be included in the bench mark description, e.g.,

DY 9701 - RDBM TAG IN CB 5FT S/O BCR @ SE COR BOLSA ST & DOMINGUEZ ST
63FT S & 20FT E/O C/L INT
(GARDENA - 1990)

ELEV. 16.704

Experience indicates that this general adjustment will, for the most part, remain sound for the next 10 years. Updating constrained adjustments will be made in 5 years. It is expected that these updating adjustments will be in the nature of a few hundredths of a foot. When a quad is readjusted, new elevation lists will be published and the date of the readjustment will be noted in the bench mark description. Two bench marks with different adjustment dates will not normally agree with each other.

The basic accuracy of the net is reflected by an indicated field probable error of plus or minus 0.012 foot per mile of leveling as determined from over 600 conditions of closure. However, many years experience in vertical control in the greater Los Angeles basin and Antelope Valley indicate that because of varying degrees of subsidence and heaving, the true datum is recovered only by obtaining substantial agreement of a number of bench marks.

The users of this net are invited to assist in its maintenance by notifying this Department of cases of obliteration, apparent mistakes in descriptions or elevations, and proven disturbance of bench marks.

DATUM: U.S. Coast and Geodetic Survey Sea Level Datum
of 1929, through the medium of the Los Angeles
County Engineer Precise Level Net.

ABBREVIATIONS USED IN BENCH MARK LISTINGS

ABUT -----	Abutment	ECR -----	End of Curb Return
ALG -----	Along	EC -----	End of Curve
ANG PT -----	Angle Point	ENT -----	Entrance
B/W -----	Back of Walk	FL -----	Floor
BCR -----	Beginning of Curb Return	FTG -----	Footing
BC -----	Beginning of Curve	FRWY -----	Freeway
BLDG -----	Building	F/W -----	Front of Walk
BM -----	Bench Mark	GAR -----	Garage
BT SPK -----	Boat or Bolt Spike	HDWL -----	Headwall
BR CAP -----	Brass or Bronze Cap	HSE -----	House
C B -----	Catch Basin	HWY -----	Highway
CTR -----	Center	INT -----	Intersection
C/L -----	Center Line	IP -----	Iron Pipe
C/L INT -----	Center Line Intersection	LT -----	Left
C/L PROD -----	Center Line Produced	LACE -----	L.A. City Engineer
CONC -----	Concrete	LACS -----	L.A. Co. Engineer
COR -----	Corner	LAFC -----	L.A. Co. Flood Control
COE -----	Corps of Engineers	L&BN -----	Lead and Bench Nail
CULV -----	Culvert	L&BR -----	Lead and Brad
CYN -----	Canyon	L&N -----	Lead and Nail
CB -----	Curb	L&SPK -----	Lead and Spike
CS MON -----	Co. Eng. Monument	L&T -----	Lead and Tack
CT SPK -----	Cut Spike	MCR -----	Middle of Curb Return
DPW -----	Dept. of Public Works	MKD -----	Marked
DR -----	Drive or Driveway	MC -----	Middle of Curve
E/O -----	East of	MON -----	Monument

ABBREVIATIONS USED IN BENCH MARKS (CON'T)

N/O ----- North of
NR ----- Near
OPP ----- Opposite
PI ----- Point of Intersection
PK&W ----- PK Nail and Washer
P/L ----- Property Line
POST ----- Point of Semi-Tangent
PP ----- Power Pole
PVMT ----- Pavement
PROD ----- Produced
RD ----- Road
RDBM ----- Road Dept. Bench Mark
RDBM TAG ----- Road Dept. Bench Mark Tag
RR ----- Railroad
RT ----- Right
R/W ----- Right of Way
SDMH ----- Storm Drain Manhole
SMH ----- Sewer Manhole
SPK ----- Spike
ST&W ----- Spike Tin and Washer
S/O ----- South of
TP ----- Telephone Pole
USC&GS ----- U.S. Coast and Geodetic Survey
USGS ----- U.S. Geological Survey
WK ----- Walk
W/O ----- West of

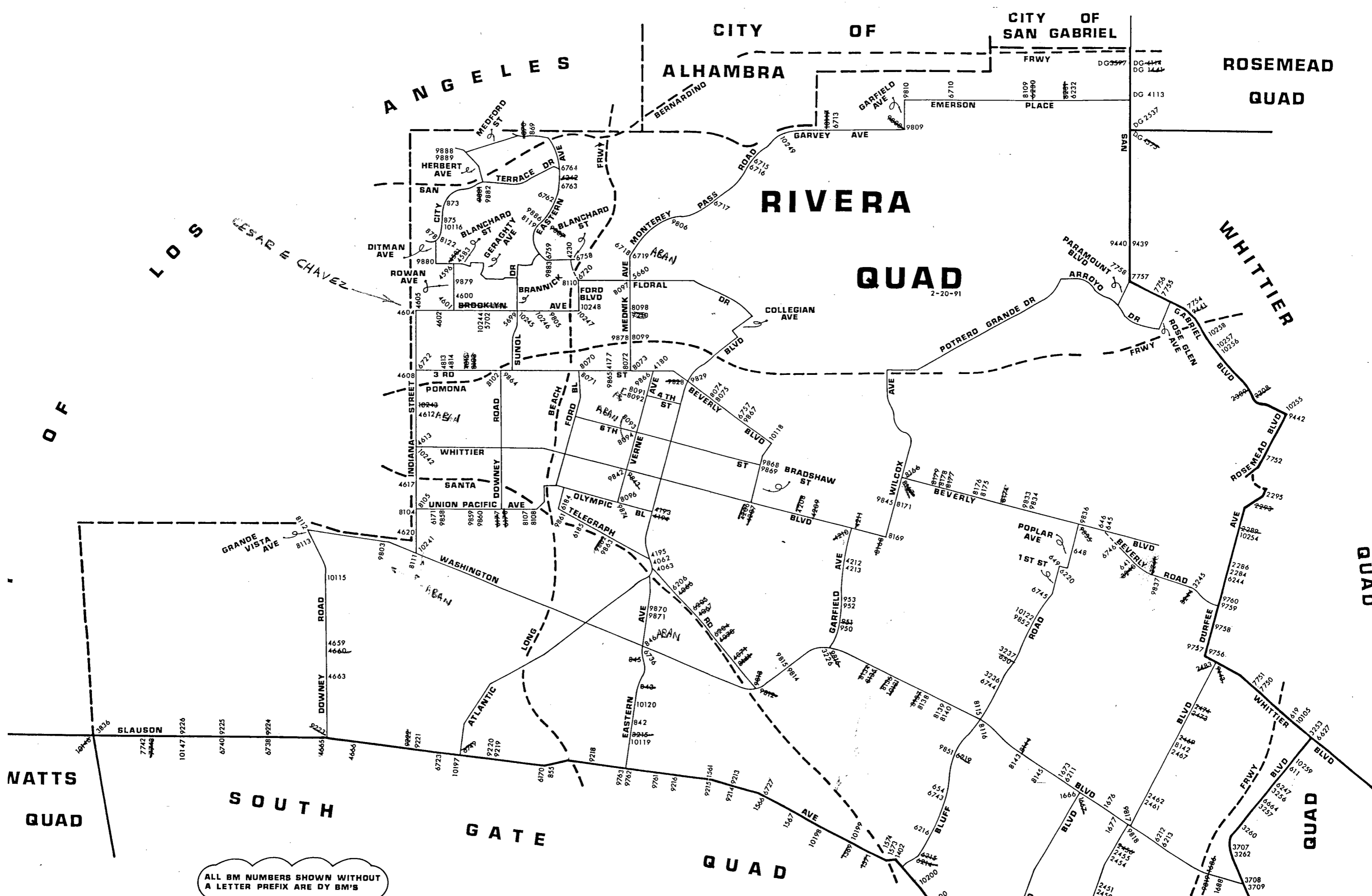

ALL BM NUMBERS SHOWN WITHOUT A LETTER PREFIX ARE BY BM'S

CITY OF

WATTS QUAD

SOUTH

GATE

QUAD

QUAD

QUAD

SANTA FE

QUAD

ALL BM NUMBERS SHOWN WITHOUT A LETTER PREFIX ARE BY BM'S



LIGHT SOLID LINES WITHOUT NUMBERS INDICATE PREVIOUS LINES OF BENCH MARKS THAT ARE NOT INCLUDED IN THE 1880 ADJUSTMENT.

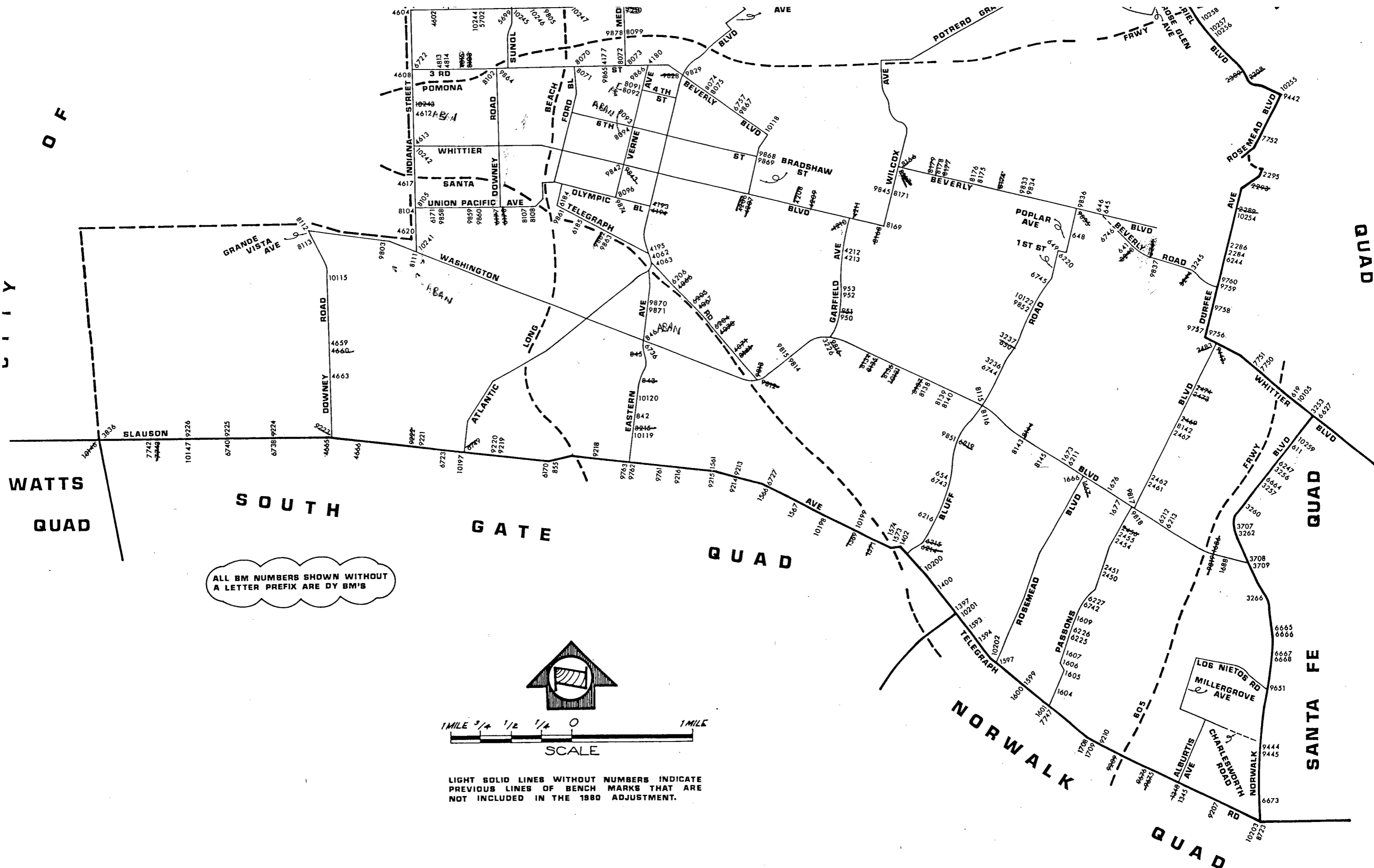

QUAD-YEAR	ELEV	D E S C R I P T I O N (INCLUDE QUAD AND YEAR IN DESCRIPTION)	BM NUMBER
BASELINE (1990)	293.644	L&T IN E CB SAN GABRIEL BLVD 38FT E C/L & 85FT S C/L HELLMAN AVE	DG 1441
BASELINE (1990)	275.844	FC BR CAP IN W WINGWALL 73FT N C/L GARVEY AVE & 225FT W C/L SAN GABRIEL BLVD MKD (BM 55-24)	DG 2537
BASELINE (1990)	294.675	RDBM TAG 2FT N/O BCR 44FT N & 45FT W C/L INT SAN GABRIEL BLVD & HELLMAN AVE	DG 3597
BASELINE (1990)	279.802	CSBM MON IN WELL 1FT N/O CB @ BCR NW COR SAN GABRIEL BLVD & EMERSON PL 59FT W & 19FT N C/L INT MKD (BM 1-25C 1970 RE 5869)	DG 4113
BASELINE (1990)	294.099	CSBM MON IN WELL 50FT W & 46FT N C/L INT SAN GABRIEL BLVD & HELLMAN AVE MKD (BM 1-25D 1970 RE5869)	DG 4114
BASELINE (1990)	273.553	DPW BM TAG IN CB @ SW COR SAN GABRIEL BLVD & GARVEY AVE 40FT S & 77FT W/O C/L INT (1FT W/O BCR)	DG 4575

QUAD-YEAR	ELEV	DESCRIPTION (INCLUDE QUAD AND YEAR IN DESCRIPTION)	BM NUMBER
BASELINE (1990)	169.272	L&SPK CTR OF WK 3FT E FLAGPOLE @ WEST WHITTIER SCHOOL 51FT W C/L NORWALK BLVD & 250FT N C/L BEXLEY DR TO THE W	DY 611
WHITTIER (1990)	174.938	L&BR S CB WHITTIER BLVD 28FT S/O C/L & ON C/L PROD REDMAN AVE TO THE N	DY 619
RIVERA (1990)	177.312	L&T CONC PVMT ON C/L PINE ST 19FT S C/L BEVERLY RD	DY 641
RIVERA (1990)	205.089	L&BN E CB 1FT N BCR @ NE COR BEVERLY BLVD & RD LEADING TO (GRANT REA MEMORIAL PARK) 75FT N & 20FT E C/L INT MKD (BM)	DY 645
RIVERA (1990)	205.185	CS MON IN CB ON NOSE OF ROAD DIVIDER LEADING TO (GRANT REA MEMORIAL PARK) 49FT N OF N CB BEVERLY BLVD & 85FT W OF W EDGE OF BRIDGE NO B 976 MKD (BM 51 10 A 1961)	DY 646
RIVERA (1990)	209.706	L&BR @ NW COR POPLAR AVE & MADISON AVE 34FT W & 20FT N/O C/L INT	DY 648
RIVERA (1990)	208.415	L&BN 1FT W BCR @ NW COR WHITTIER BLVD & 1ST ST 28FT N & 37FT W/O C/L INT	DY 649
RIVERA (1990)	207.491	L&BR W CB FROM HSE NO 637 BLUFF RD 0.1MI S/O MINES AVE 1 FT S/O CTR DWY	DY 650
RIVERA (1990)	172.599	L&BN 1FT N CATCH BASIN W SIDE BLUFF RD NR HSE NO 1425 250FT N/O SYCAMORE ST	DY 654
RIVERA (1990)	137.653	L&BN E CB EASTERN AVE NR S END CB 15FT N/O JCT RR 38FT E/O C/L EASTERN AVE & 385FT S/O C/L BANDINI BLVD	DY 842
RIVERA (1990)	142.704	L&N 1FT FROM S END E CB ON EASTERN AVE 35FT N/O (MAIN LINE) STR NR 26TH ST 38FT E/O C/L EASTERN AVE	DY 843
RIVERA (1990)	138.289	L&T E CB EASTERN AVE 4FT S BCR @ SE COR SHEILA ST & EASTERN AVE	DY 845
RIVERA (1990)	139.263	L&T NR CTR CB RET @ NE COR WASHINGTON BLVD & EASTERN AVE 44FT N & 33FT E/O C/L INT	DY 846
BASELINE (1990)	157.675	U S E D L&N W END N HDWL LA RIVER BRIDGE NO 2305 ON SLAUSON AVE 29FT N/O C/L SLAUSON AVE	DY 855
RIVERA (1990)	423.898	L&BN @ BCR @ NW COR EASTERN AVE & LANSDOWNE AVE 84FT W/O C/L LANSDOWNE AVE & 35FT N/O C/L EASTERN AVE	DY 869

QUAD-YEAR	ELEV	DESCRIPTION (INCLUDE QUAD AND YEAR IN DESCRIPTION)	BM NUMBER
RIVERA (1990)	413.514	L&T S CB 1111 B BCR @ SE COR EASTERN AVE & MEDFORD ST 35FT S & 45FT E C/L INT	DY 870
RIVERA (1990)	399.749	R D MON IN WELL C/L INT ROWAN AVE & CITY TERRACE DR	DY 873
RIVERA (1990)	415.214	R D MON IN WELL C/L INT RAMBOZ DR & CITY TERRACE DR	DY 875
RIVERA (1990)	419.102	R D MON IN WELL P O S T DITMAN AVE & CITY TERRACE DR	DY 878
RIVERA (1990)	171.832	L&BN E CB GARFIELD AVE 2FT N MC 896 S/O FLOTILLA ST @ BLDG NO 2100 GARFIELD AVE	DY 950
RIVERA (1990)	171.520	R D MON IN WELL 8IN DN P O S T 318FT S BC & 25FT E/O C/L GARFIELD AVE 700FT S/O FLOTILLA ST @ BLDG NO 2100 GARFIELD AVE	DY 951
RIVERA (1990)	173.477	RDBM TAG @ SE COR GARFIELD AVE & FLOTILLA ST 30FT S & 81FT W C/L INT 6FT E BCR	DY 952
RIVERA (1990)	173.469	RDBM TAG @ NW COR GARFIELD AVE & FLOTILLA ST 2FT N ANG PT @ BCR 40FT W & 75FT N C/L INT	DY 953
BASELINE (1990)	131.013	RDBM TAG IN S CB TELEGRAPH RD 2FT W/O SW CB RET @ MAIN DRWY TO SANTA FE SPRINGS FIRE STA BLDG NO 11736 40FT S/O C/L TELEGRAPH RD & 390FT W/O C/L PIONEER BLVD	DY 1345
BASELINE (1990)	131.376	CS MON IN WELL @ C/L INT TELEGRAPH RD & ALBURTIS AVE NLY MKD (LACS CON SYS TRA STA WHITTIER B-7 RE2177 1941)	DY 1348
BASELINE (1990)	141.886	CS MON IN WELL 8IN DN ON C/L TELEGRAPH RD 20FT WLY C/L PARAMOUNT BLVD MKD (BELL K4 1941)	DY 1397
BASELINE (1990)	143.611	RAM NAIL IN N CB TELEGRAPH RD 16FT E/O PP NO 14630Y 38FT N/O C/L TELEGRAPH RD & 110FT W/O C/L CRIDER AVE	DY 1400
BASELINE (1990)	151.584	L&T IN N CB TELEGRAPH RD 4FT E OF CB RET @ NE COR SLAUSON AVE 40 FT N & 105FT E OF C/L INT	DY 1402
BASELINE (1990)	139.872	L&T N CB SLAUSON AVE @ WLY END OF CURVE 42FT N C/L SLAUSON AVE & 300FT E BOXFORD AVE (13FT W/O W END C B)	DY 1561
BASELINE (1990)	148.334	L&T N CB SLAUSON AVE 2FT E CB RET @ NE COR GARFIELD AVE 38FT N & 65FT E C/L INT	DY 1566

QUAD-YEAR	ELEV	DESCRIPTION (INCLUDE QUAD AND YEAR IN DESCRIPTION)	BM NUMBER
BASELINE (1990)	152.439	L & BN IN S CB SLAUSON AVE 3FT N PP NO 666256E 0.2MI E GARFIELD AVE 32FT E/O DR TO BLDG NO 7000	DY 1567
BASELINE (1990)	158.040	RD MON IN WELL W/COVER ON C/L SLAUSON AVE 25FT W C/L GREENWOOD AVE (USE SE EDGE)	DY 1569
BASELINE (1990)	157.832	CS MON IN WELL C/L INT TODD AVE & SLAUSON AVE	DY 1571
BASELINE (1990)	152.028	L&T IN S CB TELEGRAPH RD 5FT6IN E/O CB RET @ SE COR SLAUSON AV 40FT S & 48FT E OF C/L INT	DY 1573
BASELINE (1990)	156.901	RD MON IN WELL C/L INT GAGE AVE & SLAUSON AVE	DY 1574
BASELINE (1990)	142.489	L&BN 4FT S BCR @ SW COR BIRCHBARK AVE & TELEGRAPH RD 80FT S & 18FT W/O C/L INT	DY 1593
BASELINE (1990)	144.834	L&BN 4FT S BCR @ SW COR STAMPS RD & TELEGRAPH RD 78FT S & 18FT W/O C/L INT	DY 1594
BASELINE (1990)	137.654	CS MON MKD (LACO SUR TRAVERSE STA BELL K-5A RE2177 1941) IN WELL W/COVER @ CL INT TELEGRAPH RD & LAKEWOOD BLVD	DY 1597
BASELINE (1990)	138.219	L&T S END W GAS ISLAND NE COR TELEGRAPH RD & SERAPIS AVE 67FT N & 61FT E/O C/L INT MKD (AT 31)	DY 1599
BASELINE (1990)	136.991	L&T IN S CB TELEGRAPH RD 6FT W/O CB RET @ SE COR SERAPIS AVE 40FT S & 50FT E/O C/L INT	DY 1600
BASELINE (1990)	140.980	L&BN 1FT FROM BCR SERVICE RD N CB @ PASSONS BLVD & TELEGRAPH RD 50FT S C/L TELEGRAPH RD	DY 1601
RIVERA (1990)	141.655	L&BN 1FT N BCR @ NE COR CLAYMORE ST & PASSONS BLVD 52FT N/O C/L CLAYMORE ST & 20FT E/O C/L PASSONS BLVD	DY 1604
RIVERA (1990)	145.892	L&BN 2FT N BCR @ NE COR SUNGLOW ST & PASSONS BLVD (BUHMAN AVE TO N)51FT N/O C/L SUNGLOW ST & 18FT E/O BUHMAN AVE	DY 1605
RIVERA (1990)	146.440	L&BN 1FT N/O BCR @ ANG PT PASSONS BLVD FRONT OF HSE NO 8430 200FT S/O C/L CHARLESWORTH DR 20FT E/O C/L PASSONS BLVD	DY 1606
RIVERA (1990)	148.042	L&BN 1FT N BCR @ NE COR PASSONS BLVD & LA DOCENA LANE 45FT N/O C/L LA DOCENA LANE & 45FT E/O C/L PASSONS BLVD	DY 1607

QUAD-YEAR	ELEV	DESCRIPTION (INCLUDE QUAD AND YEAR IN DESCRIPTION)	BM NUMBER
RIVERA (1990)	147.373	L&BN 1FT W BCR @ NW COR MYRON ST & PASSONS BLVD 18FT N/O C/L PASSONS BLVD 45FT W/O C/L MYRON ST	DY 1609
RIVERA (1990)	160.887	RDBM TAG N CB 50FT W/O BCR @ 38FT N/O C/L WASHINGTON BLVD & 120FT W/O C/L ROSEMEAD BLVD	DY 1666
RIVERA (1990)	160.974	RDBM TAG E CB 40FT N/O BCR @ NE COR ROSEMEAD BLVD & WASHINGTON BLVD 108FT N & 40FT E/O C/L INT	DY 1667
RIVERA (1990)	161.304	L&T W CB 2FT N BCR @ NW COR CROSSWAY DR & WASHINGTON BLVD 73FT N & 16FT W C/L INT	DY 1673
RIVERA (1990)	160.611	L&BN N CB 1FT E/O BCR 56FT E/O C/L LINDSEY AVE & 38FT N/O C/L WASHINGTON BLVD	DY 1676
RIVERA (1990)	160.032	L&T CTR ISLAND CB RET @ SW COR KILGARRY AVE & WASHINGTON BLVD 45FT S & 28FT W C/L INT	DY 1677
RIVERA (1990)	157.777	L&BN 1FT E BCR @ NE COR WASHINGTON BLVD & PIONEER BLVD 35FT N & 75FT E C/L INT	DY 1686
RIVERA (1990)	157.014	L&BN 1FT E BCR @ NE COR WASHINGTON BLVD & MORRILL AVE 35FT N & 51FT E C/L INT	DY 1688
BASELINE (1990)	137.016	L&B W ECR @ SW COR TRUE AVE & TELEGRAPH RD (SERVICE RD) 47FT W & 15FT S/O C/L INT TRUE AVE & TELEGRAPH RD (SERVICE RD)	DY 1708
BASELINE (1990)	137.094	CS BR CAP CONC MON IN CASING & COVER PI 6.82FT E C/L INT TRUE AVE & TELEGRAPH RD	DY 1709
BASELINE (1990)	186.431	L&BN E CB 15FT N BCR @ NE COR BEVERLY BLVD & DURFEE AVE 20FT E & 100FT N C/L INT	DY 2284
BASELINE (1990)	189.806	SPK N END 1ST STEP TO HSE NO 4252 64FT E/O & 40FT N/O C/L INT DURFEE AVE & DORK ST	DY 2286
BASELINE (1990)	192.565	L&T E CB 20FT E/O C/L DURFEE AVE & 18FT S/O C/L PROD ISORA ST	DY 2289
BASELINE (1990)	195.180	L&T IN CONC DR 53FT E/O C/L DURFEE AVE & 21FT S/O C/L SUNDOWN RD 6FT E/O BEGINNING OF DR & 7FT S/O N EDGE OF DR	DY 2293
BASELINE (1990)	194.733	L&T CONC LEG @ SW COR OF CITY OF LA DEPT OF WATER & POWER TOWER NO 253D4 73FT E/O C/L DURFEE AVE & 93FT N/O C/L KRUSE RD	DY 2295
BASELINE (1990)	206.022	FLT HD SPK 3FT E OF W END OF ABANDONED OIL WELL PUMP BASE 43FT NE C/L SAN GABRIEL BLVD & 355FT SE LINCOLN AVE	DY 2308

QUAD-YEAR	ELEV	DESCRIPTION (INCLUDE QUAD AND YEAR IN DESCRIPTION)	BM NUMBER
BASELINE (1990)	217.295	L&BR CONC WK TO (SITE OF MISSION VIEJA) HISTORICAL MON 65FT NW C/L LINCOLN AVE & 33FT SW C/L SAN GABRIEL BLVD	DY 2309
RIVERA (1990)	153.604	L&BN W CB PASSONS BLVD 2FT N/O N EDGE DRWY TO HSE NO 7525 20FT W/O C/L PASSONS BLVD & 103FT S/O C/L PROD BASCOM ST	DY 2450
RIVERA (1990)	153.956	L&T W CB PASSONS BLVD 1FT N/O N EDGE DR HSE NO 7503 20FT W/O C/L PASSONS BLVD 115FT N/O C/L BASCOM ST PROD	DY 2451
RIVERA (1990)	156.202	L&T E CB 4FT S BCR @ SE COR FOXBURY WAY & PASSONS BLVD	DY 2454
RIVERA (1990)	157.025	L&T E CB PASSONS BLVD 1FT N OF N EDGE DRWY HSE NO 7202 30FT S C/L PROD DANBRIDGE ST	DY 2455
RIVERA (1990)	158.040	L&T CTR CB RET @ NE COR PASSONS BLVD & BERT ST 25FT N/O C/L BERT ST & 27FT E/O C/L PASSONS BLVD	DY 2456
RIVERA (1990)	163.244	L&T E CB 0.5FT N/O BCR NE COR PASSONS BLVD & CARRON DR 41FT N/O C/L CARRON DR & 20FT E/O C/L PASSONS BLVD	DY 2461
RIVERA (1990)	163.503	L&T 1FT N/O BCR @ NE COR PASSONS BLVD & HOMEBROOK ST 48FT N/O C/L HOMEBROOK ST & 20FT E/O C/L PASSONS BLVD	DY 2462
RIVERA (1990)	167.156	L&T W CB 1FT N BCR @ SW COR PASSONS BLVD & COSGROVE ST 43FT S/O C/L COSGROVE ST & 21FT W/O C/L PASSONS BLVD	DY 2467
RIVERA (1990)	168.963	L&T 12FT S BCR @ NE COR PASSONS BLVD & ALDRICH ST 32FT N/O C/L ALDRICH ST & 24FT E/O C/L PASSONS BLVD	DY 2469
RIVERA (1990)	173.353	L&BR CTR CB RET @ NE COR BEXLEY DR & PASSONS BLVD 20FT N/O C/L BEXLEY DR & 30FT E/O C/L PASSONS BLVD	DY 2473
RIVERA (1990)	173.909	L&BR CTR CB RET @ NE COR HAVENWOOD ST & PASSONS BLVD 16FT N/O C/L HAVENWOOD & 31FT E/O C/L PASSONS BLVD	DY 2474
BASELINE (1990)	178.568	L&T CTR CB RET @ SW COR PASSONS BLVD & WHITTIER BLVD 30FT W 15FT S/O C/L INT	DY 2483
RIVERA (1990)	167.457	L & BN @ MCR PARKING AREA 70FT S & 150FT W C/L WASHINGTON BLVD & GARFIELD AVE	DY 3226

QUAD-YEAR	ELEV	DESCRIPTION (INCLUDE QUAD AND YEAR IN DESCRIPTION)	BM NUMBER
RIVERA (1990)	202.452	L&T 1FT N BCR @ NW COR BEACH ST & BLUFF RD 30FT N/O C/L BEACH ST & 12FT W/O C/L BLUFF RD	DY 3236
RIVERA (1990)	210.849	SPK IN LEAD 1FT S/O BCR SW COR MINES AVE & BLUFF RD RD 32FT S/O C/L MINES AVE & 21FT W/O C/L BLUFF RD	DY 3237
RIVERA (1990)	179.081	L&BN @ N END 1FT RETAINING WALL 85FT S C/L BEVERLY RD 25FT W C/L PINE ST 2FT S END OF WALL	DY 3240
RIVERA (1990)	178.511	L&BN CONC BASE @ SW COR HIGH VOLTAGE POWER LINE 75FT N/O C/L BEVERLY RD BETWEEN PINE ST & PARAMOUNT BLVD POWER NO 255-D1	DY 3241
RIVERA (1990)	181.366	L&T CTR CB RET @ NW COR 69FT W/O C/L ROSEMEAD BLVD & 47FT N/O BEVERLY RD	DY 3244
RIVERA (1990)	182.331	L&T E CB ROSEMEAD BLVD 6FT N BCR @ NE COR ROSEMEAD BLVD & BEVERLY RD 44FT E & 73FT N/O C/L INT	DY 3245
BASELINE (1990)	175.592	CS BR CAP MON 3FT SW OF C/L INT NORWALK BLVD & WHITTIER BLVD TO THE N MKD (WHITTIER B-2 RE 329 1949)	DY 3253
BASELINE (1990)	166.352	L&BR W CB 2FT S/O BCR @ NW COR ROSEHEDGE DR & NORWALK BLVD 54FT N & 33FT W/O C/L INT	DY 3256
BASELINE (1990)	164.456	L&SPK E CB 5FT S BCR @ SE COR DUNLAP CROSSING RD (MINES BLVD) & NORWALK BLVD 38FT E & 77FT S C/L INT	DY 3257
BASELINE (1990)	161.798	L&BN E CB 1FT S BCR @ SE COR FLORY ST & NORWALK BLVD 54FT S & 38FT E/O C/L INT	DY 3260
BASELINE (1990)	160.596	RE TAG NO 2059 6FT NW OF WALK TO HSE NO 7608 50FT E/O & 112FT S/O C/L INT NORWALK BLVD & CHOISSER ST	DY 3262
BASELINE (1990)	153.705	L&BN W CB 1FT N BCR @ NW COR WADDELL ST & NORWALK BLVD 38FT W & 60FT N C/L INT	DY 3266
BASELINE (1990)	160.549	RAM SET NR CTR CB RET ON SE COR CHOISSER ST & NORWALK BLVD 29FT S & 45FT E/O C/L INT	DY 3707
BASELINE (1990)	157.495	RAMSET IN W CB 3FT N/O BCR @ NW COR WASHINGTON BLVD & NORWALK BLVD 135FT N & 38FT W/O C/L INT	DY 3708
BASELINE (1990)	157.891	CE BR CAP FL IN ISL NW COR WASHINGTON BLVD & NORWALK BLVD 81FT N & 32FT W/O C/L INT MKD (BM 2-14A 1961 RE 5869)	DY 3709

QUAD-YEAR	ELEV	DESCRIPTION (INCLUDE QUAD AND YEAR IN DESCRIPTION)	BM NUMBER
BASELINE (1990)	178.957	CS MON C/L SLAUSON AVE 14FT W OF W RAIL SPRR 20FT E C/L ALAMEDA ST MKD (WATTS H-2A 1939)	DY 3836
RIVERA (1990)	149.297	L&BN N CB TELEGRAPH RD 30FT N & 125 FT E C/L INT TELEGRAPH RD & ATLANTIC BLVD	DY 4062
RIVERA (1990)	149.403	L&BN S CB TELEGRAPH RD 30FT S & 175FT E C/L INT TELEGRAPH RD & ATLANTIC BLVD	DY 4063
RIVERA (1990)	146.807	L&SPK N CB TELEGRAPH RD 39FT E/O BCR 64FT E/O C/L HOEFNER AVE 35FT N C/L TELEGRAPH RD	DY 4066
RIVERA (1990)	148.181	L&SPK N CB TELEGRAPH RD 35FT W C/L OPPOSITE MAIN ENT TO UNIROYAL TUBE CO 900FT W/O GASPAR AVE	DY 4067
RIVERA (1990)	149.733	RD BM TAG CB 38FT N C/L TELEGRAPH RD & 5FT W DRWY TO OWENS CORNING FIBERGLASS BLDG NO5933 TELEGRAPH RD APPROX STA 122&40	DY 4070
RIVERA (1990)	148.081	L&BN FOUNDATION STEEL FENCE POST @ W ENT BRASS WELL MOTOR FREIGHT LINES 62FT N C/L TELEGRAPH RD & 105FT E/O C/L TUBEWAY AVE	DY 4071
RIVERA (1990)	262.513	L&BN N CB 3RD ST 40FT N C/L & 11FT W C/L PROD LA VERNE AVE	DY 4180
RIVERA (1990)	174.193	L&BN CONC AROUND TRAFFIC SIGNAL POLE CTR OF RET @ NW COR ATLANTIC BLVD & OLYMPIC BLVD 42FT N & 51FT W C/L INT	DY 4193
RIVERA (1990)	173.230	L&BN CONC AROUND SIGNAL POLE @ SE COR ATLANTIC BLVD & OLYMPIC BLVD 36FT S & 52FT E C/L INT	DY 4194
RIVERA (1990)	154.327	MOST NLY CUT SPK NR CTR CB RET @ NW COR ATLANTIC BLVD & TELEGRAPH RD 54FT N & 69FT W C/1 INT MKD (ZZZ)	DY 4195
RIVERA (1990)	189.163	SQ HD SPK @ NE COR WHITTIER BLVD & LEONARD AVE 27FT N & 34FT E C/L INT 7FT E BCR	DY 4207
RIVERA (1990)	192.669	L&BN @ SE COR WHITTIER BLVD & WESTSIDE DR 27FT S & 78FT E C/L INT 6FT E BCR	DY 4208
RIVERA (1990)	194.415	CUT SPK @ SE COR WHITTIER BLVD & SAYBROOK AVE 27FT S & 66FT E C/L INT (1FT E/O BCR)	DY 4209
RIVERA (1990)	201.300	L&BN @ SW COR WHITTIER BLVD & GARFIELD AVE 72FT S & 30FT W C/L INT (1FT S/O BCR)	DY 4210
RIVERA (1990)	201.058	CT SPK N CB 10FT W BCR @ NE COR GARFIELD AVE & WHITTIER BLVD 30FT N & 65FT E C/L INT	DY 4211

QUAD-YEAR	ELEV	DESCRIPTION (INCLUDE QUAD AND YEAR IN DESCRIPTION)	BM NUMBER
RIVERA (1990)	193.826	L&BN N CB 35FT E BCR @ NE COR OLYMPIC BLVD & GARFIELD AVE 36FT N & 115FT E C/L INT	DY 4212
RIVERA (1990)	190.891	L&T @ NW COR GARFIELD AVE & FAIRFIELD ST 20FT N & 80FT W C/L INT 5FT W ECR	DY 4213
RIVERA (1990)	317.643	L&T W CB HUMPHREYS AVE 1FT S CB RET @ SW COR HUMPHREYS AVE & BLANCHARD ST 31FT S & 15FT W/O C/L INT	DY 4230
RIVERA (1990)	473.583	RDBM TAG OM CB DRWY OF OLD LA CO FIRE DEPT ENGIN CO NO32 3FT E BLDG 50 FT W C/L EASTERN AVE 90FT N C/L WOOLWINE DR @ ADDRESS #1407 EASTERN AVE	DY 4242
RIVERA (1990)	408.300	L&T CONC STEP HSE NO901 TOWNSEND AVE 30FT W C/L & 45FT N C/L BLANCHARD ST MKD (BM)	DY 4581
RIVERA (1990)	418.049	L&T CONC RET WALL @ 27FT S C/L BLANCHARD ST & 30FT E C/L ROWAN AVE MKD (BM)	DY 4583
RIVERA (1990)	414.354	L&BR CONC WK @ HSE NO 3547 WINTER ST 30FT N C/L & 30FT W C/L ROWAN AVE	DY 4596
RIVERA (1990)	308.142	L&T W CB 20FT W C/L ROWAN AVE C/L PROD DOZIER ST	DY 4600
RIVERA (1990)	300.183	L&BN W CB 1FT S BCR 20FT W/O C/L ROWAN AVE 40FT S/O C/L BROOKLYN AVE	DY 4601
RIVERA (1990)	297.955	L&BN E CB 7FT N/O BCR 20FT E/O C/L DITMAN AVE 53FT N C/L BROOKLYN AVE MKD (BM)	DY 4602
RIVERA (1990)	290.070	CUT SPK E CB INDIANA ST 20FT S C/L PROD BROOKLYN PL (N END C B)	DY 4604
RIVERA (1990)	289.550	LACE HEX BAR MON @ C/L INT INDIANA ST & BROOKLYN PL	DY 4605
RIVERA (1990)	316.875	CUT SPK IN CB 5FT W/O BCR & 37FT S/O C/L 3RD ST 53FT W/O C/L INDIANA ST	DY 4608
RIVERA (1990)	276.347	WIRE SPK IN CB 7FT W/O BCR 20FT S C/L 6TH ST & 35FT W/O C/L INDIANA ST	DY 4612
RIVERA (1990)	222.700	CUT SPK N CB 7FT W/O BCR W END C B NW COR INDIANA ST & WHITTIER BLVD 123FT W & 30FT N/O C/L INT	DY 4613
RIVERA (1990)	187.375	WIRE SPK N CB E END C B 45FT W/O C/L INDIANA ST & 37FT N/O C/L OLYMPIC BLVD	DY 4617

QUAD-YEAR	ELEV	DESCRIPTION (INCLUDE QUAD AND YEAR IN DESCRIPTION)	BM NUMBER
RIVERA (1990)	179.433	CS BR CP MON IN WELL NE COR INDIANA ST & NOAKES ST 10FT N & 17FT E/O C/L INT MKD (ALHAMBRA B-11 RE 2177)	DY 4620
RIVERA (1990)	182.159	L&SQ BOLT N CB LEONIS BLVD 28FT N/O C/L & 76FT W/O INT DOWNEY RD	DY 4659
RIVERA (1990)	181.981	L&SQ BOLT IN OUT OF LEONIS BLVD 28FT S/O C/L & 67FT W/O INT DOWNEY RD	DY 4660
RIVERA (1990)	179.893	SQ HD SPK @ NW COR CONC SLAB 35FT S/O C/L FRUITLAND AVE & 35FT E/O C/L DOWNEY RD	DY 4663
BASELINE (1990)	164.867	L&T S CB SLAUSON AVE 192FT W & 21FT S C/L INT DOWNEY RD & SLAUSON AVE FRONT OF POWER POLE	DY 4665
BASELINE (1990)	162.162	CS MON IN WELL 8IN DN 2FT S & 4FT W/O C/L INT SLAUSON AVE & EVERETT AVE MKD (LA CO SUR CONTROL SYS TRAVERSE STA WATTS L-2B RE4233)	DY 4666
RIVERA (1990)	309.743	L&BN E CB 34FT N/O BCR NE COR FLORAL DR & MEDNIK AVE 87FT N & 35FT E/O C/L INT	DY 5660
RIVERA (1990)	270.203	SQ HD SPK N CB BROOKLYN AVE 30FT N/O C/L 191FT W/O INT CARMELITA AVE	DY 5699
RIVERA (1990)	312.309	L&T N CB 2FT E BCR @ NE COR BROOKLYN AVE & RECORD AVE 28FT N & 38FT E C/L INT	DY 5702
BASELINE (1990)	139.471	MON IN WELL 12IN DN 57FT N/O & 41FT E/O C/L INT OF SLAUSON AVE & ALAMO AVE MKD (BM 4-21 1951)	DY 6170
RIVERA (1990)	188.588	L&BR S CB UNION PACIFIC AVE 20FT S C/L & 20FT W C/L DITMAN AVE	DY 6171
RIVERA (1990)	189.059	RD BM TAG S CB 1.5FT W BCR @ SW COR UNION PACIFIC AVE & DOWNEY RD 20FT S & 33FT W C/L INT	DY 6177
RIVERA (1990)	189.251	L& T N CB 0.5FT E BCR @ NE COR UNION PACIFIC AVE & DOWNEY RD 20FT N & 30FT E C/L INT	DY 6178
RIVERA (1990)	173.561	RAM SET N CB 8FT E/O BCR NE COR TELEGRAPH RD & DUNCAN AVE 35FT N & 26FT E C/L INT MKD (BM 6-D)	DY 6184
RIVERA (1990)	165.286	RD BM TAG N CB TELEGRAPH RD 35FT N C/L & 200FT W C/L KERN AVE OPP LIGHT STD	DY 6185
RIVERA (1990)	150.840	L&BN SELY COR CONC SLAB MH & FIRE SPRINKLER PLUG 51FT N/O C/L TELEGRAPH RD & 750FT E/O C/L GASPAR AVE NR BLDG NO 5901	DY 6204

QUAD-YEAR	ELEV	DESCRIPTION (INCLUDE QUAD AND YEAR IN DESCRIPTION)	BM NUMBER
RIVERA (1990)	148.315	L&T NLY CB TELEGRAPH RD 35FT N C/L 110FT ELY ENT DY TO UNIROYAL TIRE CO BLDG 800FT WLY C/L GASPAR AVE	6205
RIVERA (1990)	146.942	L&T SLY CB TELEGRAPH RD 40FT SLY C/L & 15FT ELY DY PROD HOEFNER AVE NEAR WLY ENT CB	6206
RIVERA (1990)	161.383	L&T NO CB 1.0FT W BCR 38FT N & 54FT E C/L INT DY CROSSWAY DR & WASHINGTON BLVD	6211
RIVERA (1990)	155.686	L&T N CB SERVICE RD WASHINGTON BLVD 78FT N DY C/L 25FT W BCR & 50FT W C/L PICOVISTA RD	6212
RIVERA (1990)	156.678	L&T N CB WASHINGTON BLVD 38FT N C/L & 55FT DY E C/L PROD PICOVISTA	6213
RIVERA (1990)	155.535	L&T SLY CB SLAUSON AVE 25FT SLY C/L & ON C/L DY PROD BLUFF RD	6214
RIVERA (1990)	157.959	2IN STEEL HEX BAR IN CONC MON 6IN UP NWLY COR DY BRIDGE NO B1045 OVER RIO HONDU RIVER 35FT N/O C/L SLAUSON AVE & 75FT E/O C/L BLUFF RD (USE S EDGE)	6215
RIVERA (1990)	161.666	L&B CONC STEP ENT BLDG NO1629 BLUFF RD 24FT W DY C/L & 0.2MI N/O C/L SLAUSON AVE MKD (BM)	6216
RIVERA (1990)	178.018	RDBM TAG 1FT N C B 20FT E/O C/L BLUFF RD & 270FT DY S/O C/L DATE ST NR USE NO 1217	6219
RIVERA (1990)	204.790	RDBM TAG N CB 1FT E/O BCR @ NE COR WHITTIER BLVD DY & 1ST ST 28FT N & 45FT E/O C/L INT BLUFF RD TO THE SO & WHITTIER BLVD	6220
RIVERA (1990)	148.576	L&BN W CB 7FT S/O ANG PT OF CB 43FT S/O C/L PROD DY SHADE LANE TO E & 30FT W/O C/L INT PASSONS BLVD	6225
RIVERA (1990)	148.244	L&BN N CB 1FT E BCR @ NE COR PASSONS BLVD & DY SHADE LANE 18FT N & 46FT E C/L INT MKD (BM)	6226
RIVERA (1990)	150.515	L&T N CB 1FT W BCR @ NE COR PASSONS BLVD & DY SLAUSON AVE 40FT N & 62FT E C/L INT	6227
RIVERA (1990)	349.365	CSBM MON N END C B 43FT N & 15FT E/O C/L INT DY EMERSON PL & STEVENS AVE MKD (BM 31-20A 1961 RE 5869)	6230
RIVERA (1990)	304.994	SPK E CB 22FT N/O BCR NE COR EMERSON PL TO E & DY DEL MAR AVE 55FT N & 20FT E/O C/L INT MKD (BM A-59)	6231

QUAD-YEAR	ELEV	DESCRIPTION (INCLUDE QUAD AND YEAR IN DESCRIPTION)	BM NUMBER
RIVERA (1990)	302.087	CS BR CP MON IN WELL C/L INT EMERSON PL & WILSON WAY USE W EDGE	DY 6232
BASELINE (1990)	185.340	RD MON IN WELL C/L INT DURFEE AVE & BEVERLY BLVD	DY 6244
BASELINE (1990)	166.395	LA CO ENGR BR CAP NLY END C B 79FT N & 37FT W/O NORWALK BLVD & ROSEHEDGE DR MKD (BM 2-16 1961 RE 5869)	DY 6247
BASELINE (1990)	177.259	RDBM TAG W CB 40FT N BCR @ NW COR WHITTIER BLVD & NORWALK BLVD 107FT N & 29FT W/O C/L INT	DY 6627
BASELINE (1990)	164.618	SPK IN S CB 7FT E BCR @ SE COR MINES BLVD & NORWALK BLVD 84FT E & 38FT S C/L INT MKD (KW-28)	DY 6664
BASELINE (1990)	151.778	BT SPK W CB 8FT N BCR @ NW COR NORWALK BLVD & SLAUSON AVE 86FT N & 40FT W C/L INT	DY 6665
BASELINE (1990)	151.685	RDBM TAG E CB 2FT N BCR @ SE COR NORWALK BLVD & SLAUSON AVE 40FT E & 82FT S C/L INT	DY 6666
BASELINE (1990)	152.938	L&T E CB NORWALK BLVD 40FT E C/L ON C/L PROD BURKE ST	DY 6667
BASELINE (1990)	153.035	RDBM TAG E CB 2FT S BCR @ SE COR NORWALK BLVD & BURKE ST 40FT E & 35FT S C/L INT	DY 6668
BASELINE (1990)	147.005	L&T CONC CB NR S SIDE OF BLDG @ 10122 NORWALK BLVD 50FT E C/L & 0.2MI N TELEGRAPH RD MKD (BM)	DY 6673
RIVERA (1990)	381.014	CSBM MON IN WELL SE COR EMERSON AVE & ALHAMBRA AVE 31FT S & 29FT E/O C/L INT 4FT E/O E CB MKD (BM 31-19 1953 RE 63)	DY 6710
RIVERA (1990)	379.705	CSBM MON IN WELL @ SE COR GARVEY AVE & ATLANTIC BLVD 40FT S & 177FT E/O C/L INT 1FT S OF S CB MKD (BM31-17 1953 RE 63)	DY 6713
RIVERA (1990)	414.903	L&BN SLY POINT OF CONC PLANTER WLY TRAFFIC ISL 36FT W/O C/L MONTEREY PASS RD @ FREMONT AVE ACROSS FROM N SIDE PROD BLDG NO 508	DY 6715
RIVERA (1990)	412.362	L&BR W CB MONTEREY PASS RD 35FT W/O C/L 80FT S/O BCR @ FREMONT AVE NR S SIDE PROD BLDG NO 509	DY 6716
RIVERA (1990)	398.969	CSBM MON FL IN C B 1FT E/O E CB & 35FT E/O C/L MONTEREY PASS RD 0.5MI S/O FREMONT AVE NR N SIDE PROD BLDG NO 736 MKD (BM31-15A 1961 RE 5869)	DY 6717

QUAD-YEAR	ELEV	DESCRIPTION (INCLUDE QUAD AND YEAR IN DESCRIPTION)	BM NUMBER
RIVERA (1990)	334.379	L&BR E CB MONTEREY PASS RD 35FT E & 33FT S/O BC 125FT N/O PI MONTEREY PASS RD & KERN AVE C/L IN FR OF BLDG NO 1350 & 20FT NLY OF SLY P/L	DY 6718
RIVERA (1990)	330.322	CSBM MON IN WELL 21FT NWLY C/L INT MONTEREY PASS RD PI & KERN AVE C/L IN WLY GUTTER MKD (BM 31- 14 1953 RE 1963	DY 6719
RIVERA (1990)	312.400	CSBM MON IN WELL NW COR FLORAL DR & FORD BLVD 71FT N & 19FT W/O C/L INT MKD (31-12A 1961 RE 5869)	DY 6720
RIVERA (1990)	316.876	L&T IN N CB 9FT E/O BCR @ NE COR INDIANA ST & 3RD ST 40FT N & 59FT E/O C/L INT	DY 6722
BASELINE (1990)	150.751	CS MON IN WELL 10IN DN 41FT NLY S CB SLAUSON AVE & 7FT WLY E CB FLORA AVE MKD (BELL 2-A 1938)	DY 6723
BASELINE (1990)	148.091	L&BN IN CB @ NW COR SLAUSON AVE & GARFIELD AVE 66FT N & 38FT W/O C/L INT (1FT N/O BCR)	DY 6727
RIVERA (1990)	139.130	L&T SE CB 80FT E & 39FT S/O C/L INT WASHINGTON BLVD & EASTERN AVE 20FT W/O BCR (INTO RETURN)	DY 6736
BASELINE (1990)	165.222	CS MON 15IN DN ON C/L BOYLE AVE (STATE ST) 17FT S C/L SLAUSON AVE MKD (WATTS K-2A RE 4233)	DY 6738
BASELINE (1990)	173.279	CS MON 8IN DN ON C/L MILES AVE (SOTO ST) 14FT S C/L SLAUSON AVE MKD (WATTS J-2E 1938)	DY 6740
RIVERA (1990)	150.569	L&BN 2FT S BCR @ SW COR PASSONS BLVD & SLAUSON AVE 32FT W & ABT 50FT S C/L INT MKD (BM)	DY 6742
RIVERA (1990)	173.202	RDBM TAG W CB 1FT N BCR @ NW COR S BLUFF RD & SYCAMORE AVE 22FT N & 20FT W C/L INT	DY 6743
RIVERA (1990)	199.646	RAMSET IN CB 1FT S BCR OF SO DRWY TO HSE NO 833 BLUFF RD 0.1MI S/O BEACH ST	DY 6744
RIVERA (1990)	211.355	L&BN 1FT S BCR @ SW COR LOS ANGELES AVE & BLUFF RD 53FT S & 20FT W C/L INT MKD (BM)	DY 6745
RIVERA (1990)	176.048	L&BN 1FT E/O BC CUL DE SAC S SIDE BEVERLY RD @ END ROAD 37FT E/O FLOOD CONTROL FENCE & 77FT W/O C/L PROD CULP DR MKD (BM)	DY 6746
BASELINE (1990)	149.217	L&BN W CB @ NW COR ATLANTIC BLVD & SLAUSON AVE 35FT W & 97FT N C/L INT	DY 6749
RIVERA (1990)	245.763	L&BN 32FT S/O BCR @ SW COR BEVERLY BLVD & GERHART AVE 28FT W 107FT S/O C/L INT	DY 6757

QUAD-YEAR	ELEV	DESCRIPTION (INCLUDE QUAD AND YEAR IN DESCRIPTION)	BM NUMBER
RIVERA (1990)	304.867	L&T CTR CB RET SW COR BLANCHARD ST & N LOPEZ AVE 20FT S & 25FT W C/L INT	DY 6758
RIVERA (1990)	326.668	CS BR CAP MON 10IN DN 60FT N & 35FT E C/L INT EASTERN AVE & E BLANCHARD ST 20FT N BCR MKD (BM 61-2 RE 5869-1961)	DY 6759
RIVERA (1990)	485.818	BT SPK E CB 1FT S BCR @ SE COR EASTERN AVE & E HAUCK ST 32FT E & 5FT S C/L INT	DY 6762
RIVERA (1990)	502.440	BT SPK E CB EASTERN AVE 32FT N & 32FT E C/L INT EASTERN AVE & ROSILYN DR	DY 6763
RIVERA (1990)	455.554	BT SPK E CB 17FT N BCR @ NE COR E CITY TERRACE DR & EASTERN AVE 70FT N'LY & 32FT E'LY C/L INT 3FT S/O N'LY P/L TO HSE #1454	DY 6764
RIVERA (1990)	299.284	L&T CTR CB RET @ SE COR BROOKLYN AVE & MEDNIK AVE 40FT S & 40FT E C/L INT	DY 7210
BASELINE (1990)	178.148	RDBM TAG 38FT S BCR 104FT S & 36FT W C/L INT SLAUSON AVE & SANTA FE AVE	DY 7742
BASELINE (1990)	177.878	RDBM TAG 44FT S BCR 104FT S & 36FT E C/L INT SLAUSON AVE & SANTA FE AVE	DY 7743
BASELINE (1990)	140.474	LACS MON IN SE COR C B 122FT N & 21FT W C/L INT TELEGRAPH RD & PASSONS BLVD MKD (BM 4-15A 1968)	DY 7747
BASELINE (1990)	181.094	L AFC MON FL @ NE COR BRIDGE NO 53-06 OVER SAN GABRIEL RIVER 50FT N C/L WHITTIER BLVD & 105FT W SPRR OVERPASS MKD (BM 07800010-1968)	DY 7750
BASELINE (1990)	182.165	L AFC MON FL @ SW COR BRIDGE NO 53-06 OVER SAN GABRIEL RIVER 46FT S C/L WHITTIER BLVD MKD (BM 077 02855 1968)	DY 7751
BASELINE (1990)	215.736	LACO ENG BR CAP FL @ SE COR BRIDGE NO 53-534 OVER WHITTIER NARROWS RIVER 42FT E/O C/L ROSEMEAD BLVD & 0.4MI S/O INT SAN GABRIEL BLVD MKD (BM 1-20B 1965 RE 5869)	DY 7752
BASELINE (1990)	308.235	RDBM TAG 1FT E/O BCR 42FT N & 78FT W C/L INT SAN GABRIEL BLVD & WALNUT GROVE AVE	DY 7754
BASELINE (1990)	315.596	RDBM TAG 2FT ELY OF BCR 42FT NLY & 20FT ELY OF C/L INT SAN GABRIEL BLVD & DELTA ST	DY 7755
BASELINE (1990)	317.744	RDBM TAG 2FT W LY BCR 42FT N LY & 87FT W LY C/L INT SAN GABRIEL BLVD & DELTA ST	DY 7756

QUAD-YEAR	ELEV	DESCRIPTION (INCLUDE QUAD AND YEAR IN DESCRIPTION)	BM NUMBER
BASELINE (1990)	333.458	RDBM TAG 1FT W/O BCR 42FT S & 64FT W/O C/L INT SAN GABRIEL BLVD & HILL DR	DY 7757
BASELINE (1990)	332.481	RDBM TAG 1FT W/O BCR 42FT N & 115FT W/O C/L INT SAN GABRIEL BLVD & HILL DR	DY 7758
RIVERA (1990)	279.971	LACS MON 1FT BACK CB 41FT N & 40FT E C/L INT THIRD ST & KERN AVE MKD (BM S-1-1)	DY 8072
RIVERA (1990)	281.885	L&T IN CB 14FT E/O BCR 40FT S & 70FT E/O C/L INT THIRD ST & MEDNIK AVE	DY 8073
RIVERA (1990)	231.345	L & T NR MCR 49FT S & 40FT W C/L INT BEVERLY BLVD & MARGARET AVE	DY 8074
RIVERA (1990)	232.523	L & T NR MCR 49FT N & 40FT E C/L INT BEVERLY BLVD & MARGARET AVE	DY 8075
RIVERA (1990)	245.509	L & BN IN N EDGE CONC WK 43FT S & 39FT W C/L INT FOURTH ST & LA VERNE AVE	DY 8091
RIVERA (1990)	245.819	L & BN IN N EDGE CONC WK 40FT S & 38FT E C/L INT FOURTH ST & LA VERNE AVE	DY 8092
RIVERA (1990)	214.107	L & BN IN CONC WK 44FT N & 33FT W C/L INT SIXTH ST & LA VERNE AVE	DY 8093
RIVERA (1990)	214.796	L & T IN S EDGE CONC DRWY 76FT N & 40FT E C/L INT SIXTH ST & LA VERNE AVE	DY 8094
RIVERA (1990)	176.572	L&BN IN CONC APRON 61FT N & 30FT E/O C/L INT OLYMPIC BLVD & LA VERNE AVE	DY 8096
RIVERA (1990)	308.236	L&T IN W CB 0.4FT S/O BCR 65FT S & 40FT W/O C/L INT FLORAL DR & MEDNIK AVE	DY 8097
RIVERA (1990)	299.825	RDBM TAG 1FT N BCR 55FT N & 32FT E C/L INT MEDNIK AVE & BROOKLYN AVE	DY 8098
RIVERA (1990)	294.882	L & BN 5FT S BCR @ NE COR BRIDGE NO B53-1734 55FT S/O & 30FT E/O C/L INT 1ST & MEDNIK AVE	DY 8099
RIVERA (1990)	183.341	WIRE SPK 1FT W/O BCR S CB 25FT S & 42FT W/O C/L INT INDIANA ST & UNION PACIFIC AVE	DY 8104
RIVERA (1990)	183.692	WIRE SPK 6FT E/O BCR N CB 20FT N & 43FT E/O C/L INT INDIANA ST & UNION PACIFIC AVE @ W ENT TO CATCH BASIN	DY 8105
RIVERA (1990)	180.196	L & T 0.5FT S BCR 37FT S & 20FT W C/L INT UNION PACIFIC AVE & MARIANNA AVE	DY 8107

QUAD-YEAR	ELEV	DESCRIPTION (INCLUDE QUAD AND YEAR IN DESCRIPTION)	BM NUMBER
RIVERA (1990)	180.407	RDBM TAG 2FT E BCR 20FT N & 40FT E C/L INT UNION PACIFIC AVE & MARIANNA AVE	DY 8108
RIVERA (1990)	349.357	RND HD SPK IN CB 18FT S/O C/L EMERSON PL & 14FT W/O C/L PROD STEVENS AVE CB MKD (BM A-80)	DY 8109
RIVERA (1990)	314.005	L&T 1FT E/O BCR 32FT S & 36FT E/O C/L INT FLORAL DR & FORD BLVD	DY 8110
RIVERA (1990)	177.383	L&T 13FT S/O BCR 78FT S & 24FT E/O C/L INT WASHINGTON BLVD & INDIANA ST	DY 8111
RIVERA (1990)	190.282	L & WIRE SPK 17FT N/O BCR 71FT N & 41FT E/O C/L INT WASHINGTON BLVD & GRANDE VISTA AVE	DY 8112
RIVERA (1990)	190.732	L&SPK 12FT W/O BCR @ ENT TO C B 40FT S & 40FT W/O C/1 INT WASHINGTON BLVD & GRANDE VISTA AVE	DY 8113
RIVERA (1990)	191.063	L & BN 27FT N BCR 98FT N & 20FT W C/L INT WASHINGTON BLVD & BLUFF RD	DY 8115
RIVERA (1990)	187.469	L & T 19FT E BCR 40FT S & 76FT E C/L INT BLUFF RD & WASHINGTON BLVD	DY 8116
RIVERA (1990)	404.961	RDBM TAG 545FT S/O BCR 606FT S & 32FT E/O C/L INT EASTERN AVE & SHERIFF RD	DY 8119
RIVERA (1990)	422.928	LACS MON IN WELL POST TOWNSEND AVE & CITY TERRACE DR	DY 8122
RIVERA (1990)	174.501	RDBM TAG 10FT W/O BCR 38FT S & 60FT W/O C/L INT WASHINGTON BLVD & VAIL AVE (1FT W/O CB)	DY 8134
RIVERA (1990)	174.371	L&T 2FT W/O BCR 18FT N & 54FT W/O C/L INT WASHINGTON BLVD & VAIL AVE	DY 8135
RIVERA (1990)	176.218	L&BN @ NW COR CONC FTG OF SIGN 52FT S & 45FT W/O C/L INT WASHINGTON BLVD & MAPLE AVE	DY 8136
RIVERA (1990)	185.412	RDBM TAG 1FT E BCR 40FT S & 59FT E C/L INT WASHINGTON BLVD & GREENWOOD AVE	DY 8137
RIVERA (1990)	185.150	RDBM TAG 2FT N BCR 78FT N & 28FT E C/L INT WASHINGTON BLVD & GREENWOOD AVE	DY 8138
RIVERA (1990)	189.872	RDBM TAG 3FT W BCR 42FT S & 52FT W C/L INT WASHINGTON BLVD & MONTEBELLO BLVD	DY 8139
RIVERA (1990)	190.605	RDBM TAG 0.5FT W BCR 42FT S & 48FT E C/L INT WASHINGTON BLVD & MONTEBELLO BLVD	DY 8140

